

ConocoPhillips Company  
CONSTRUCTION LAYOUT FOR  
RESERVE #3-65 35-34 1H  
SECTION 35, T3S, R65W, 6th P.M.  
660' FNL 400' FEL

FIGURE #1

SCALE: 1" = 60'  
DATE: 08-30-13  
DRAWN BY: J.S.  
REVISED: 10-25-13 J.L.H.

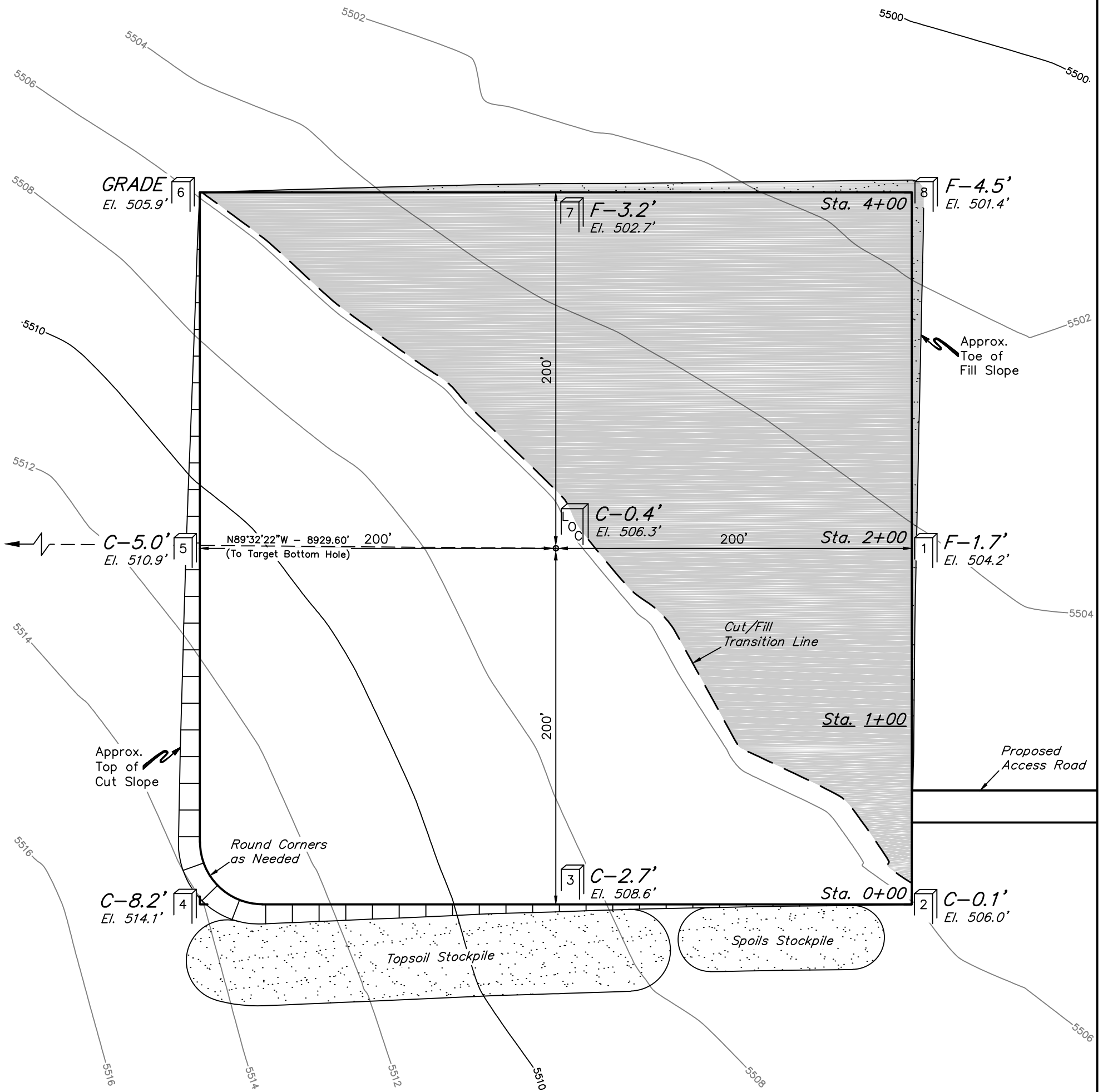

Elev. Ungraded Ground At Loc. Stake = 5506.3'  
FINISHED GRADE ELEV. AT LOC. STAKE = 5505.9'

UINTAH ENGINEERING & LAND SURVEYING  
85 So. 200 East \* Vernal, Utah 84078 \* (435) 789-1017

1" = 40'  
X-Section  
Scale  
1" = 100'  
DATE: 08-30-13  
DRAWN BY: J.S.

ConocoPhillips Company  
CONSTRUCTION LAYOUT CROSS SECTIONS FOR  
RESERVE #3-65 35-34 1H  
SECTION 35, T3S, R65W, 6th P.M.  
660' FNL 400' FEL

FIGURE #2

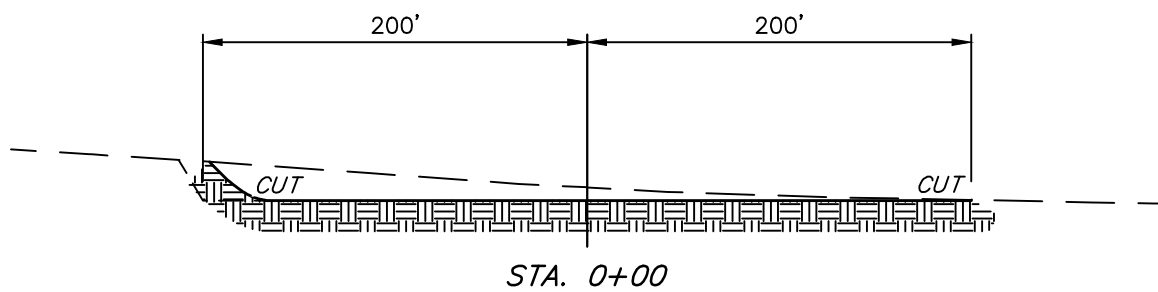
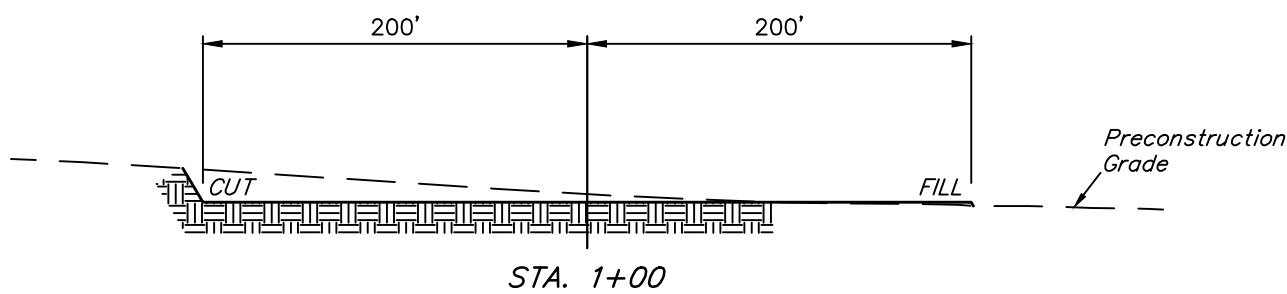
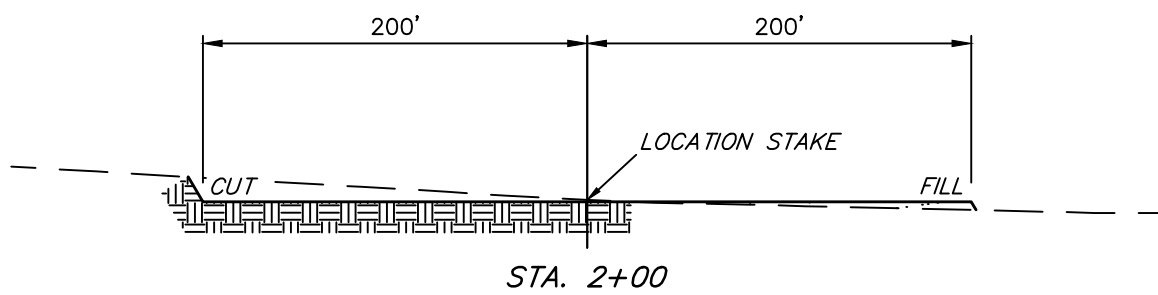
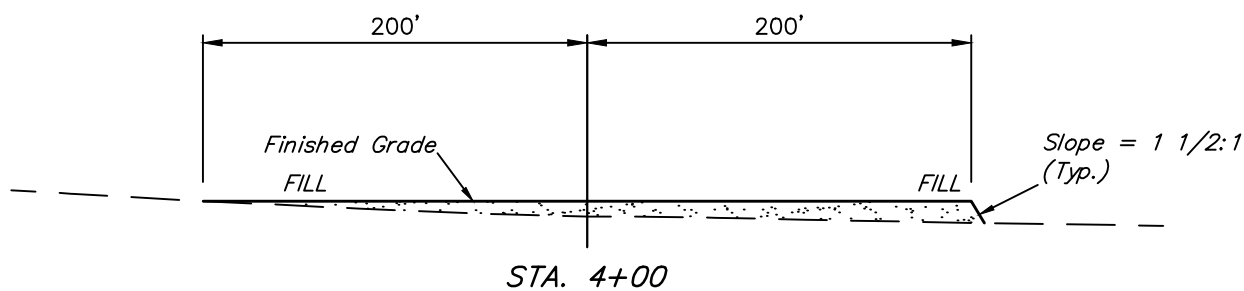

NOTE:  
Topsoil should not be  
Stripped Below Finished  
Grade on Substructure Area.

\* NOTE:  
FILL QUANTITY INCLUDES  
10% FOR COMPACTION

APPROXIMATE YARDAGES

(6") Topsoil Stripping = 3,100 Cu. Yds.  
Remaining Location = 7,100 Cu. Yds.  
TOTAL CUT = 10,200 CU. YDS.  
FILL = 6,560 CU. YDS.

EXCESS MATERIAL = 3,640 Cu. Yds.  
Topsoil = 3,100 Cu. Yds.  
EXCESS UNBALANCE = 540 Cu. Yds.  
(After Interim Rehabilitation)

APPROXIMATE ACREAGE

WELL SITE DISTURBANCE = ± 4.211 ACRES  
ACCESS ROAD DISTURBANCE = ± 0.129 ACRES  
TOTAL = ± 4.340 ACRES

UINTAH ENGINEERING & LAND SURVEYING  
85 So. 200 East \* Vernal, Utah 84078 \* (435) 789-1017