

Anadarko Petroleum Corp.

Weld County, CO (NAD 83)

Sec. 18-T3N-R67W

Sekich State 40N-17HZ

Plan A

Plan: Rev A0 Permit

Sperry Drilling Services

Proposal Report

04 December, 2013

Well Coordinates: 1,325,202.80 N, 3,156,259.65 E (40° 13' 29.01" N, 104° 56' 25.40" W)

Ground Level: 4,849.00 usft

Local Coordinate Origin:

Viewing Datum:

TVDs to System:

North Reference:

Unit System:

Geodetic Scale Factor Applied

Version: 5000.1 Build: 70

Centered on Well Sekich State 40N-17HZ

RKB = 17' @ 4866.00usft (Drilling Rig)

N

True

Dec-Deg - API - US Survey Feet - Custom

HALLIBURTON

Project: Weld County, CO (NAD 83)
Site: Sec. 18-T3N-R67W
Well: Sekich State 40N-17HZ
Wellbore: Plan A
Design: Rev A0 Permit

Anadarko Petroleum Corp.

HALLIBURTON
Sperry Drilling

SECTION DETAILS

Sec	MD	Inc	Azi	TVD	+N/-S	+E/-W	Dleg	TFace	VSect	Target
1	0.00	0.00	0.00	0.00	0.00	0.00	0.00	0.00	0.00	
2	3800.00	0.00	0.00	3800.00	0.00	0.00	0.00	0.00	0.00	
3	4300.00	10.00	0.00	4297.47	43.52	0.00	2.00	0.00	0.00	
4	5810.00	10.00	0.00	5784.53	305.73	0.00	0.00	0.00	0.00	
5	6310.00	0.00	0.00	6281.99	349.25	0.00	2.00	180.00	0.00	
6	6431.05	0.00	0.00	6403.04	349.25	0.00	0.00	0.00	0.00	
7	7331.97	90.09	90.00	6976.00	349.25	573.88	10.00	90.00	573.88	
8	16692.57	90.09	90.00	6961.00	349.18	9934.47	0.00	0.00	9934.47	Sekich State 40N-17HZ_BHL

WELLBORE TARGET DETAILS (LAT/LONG)

Name	TVD	+N/-S	+E/-W	Latitude	Longitude	Polygon
Sekich State 40N-17HZ_SEC	0.00	0.00	0.00	40.224726	-104.940388	
Sekich State 40N-17HZ_SHL	0.00	0.00	0.00	40.224726	-104.940388	
Sekich State 40N-17HZ_BHL	6961.00	349.18	9934.47	40.225679	-104.904811	

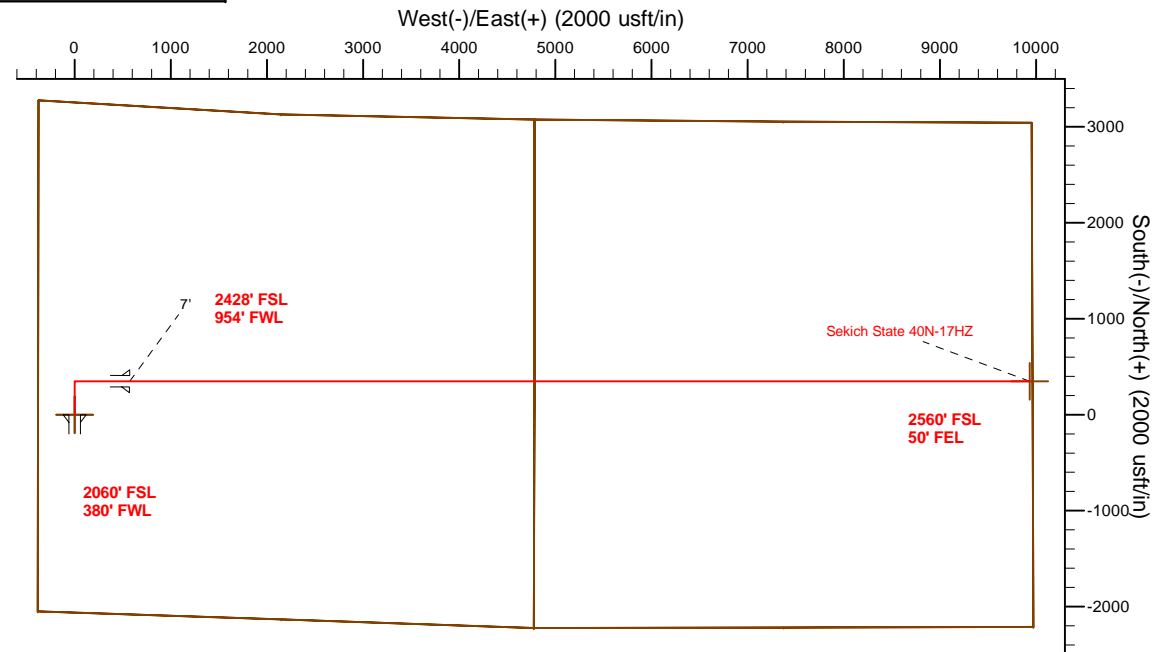
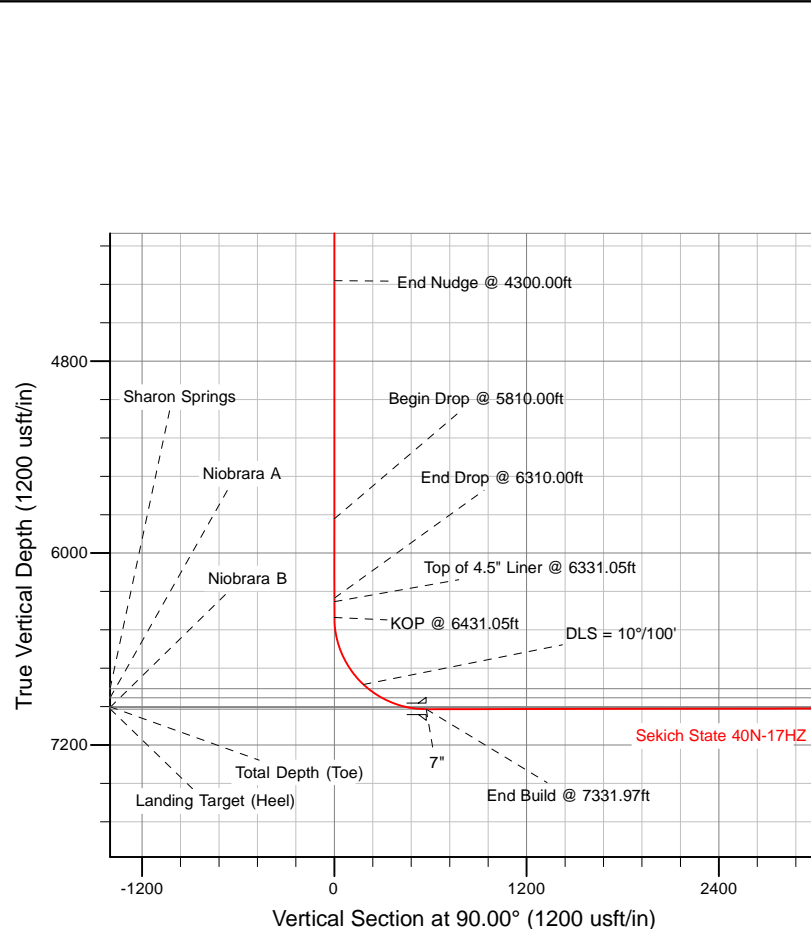

TVD MD

6303.04 6331.05 Top of 4.5" Liner @ 6331.05ft
6403.04 6431.05 KOP @ 6431.05ft

WELL DETAILS: Sekich State 40N-17HZ

Ground Level: 4849.00
RKB = 17' @ 4866.00usft (Drilling Rig)

Plan: Rev A0 Permit (Sekich State 40N-17HZ/Plan A)

Created By: Clint Eshelman Date: 12/4/2013
Reviewed: Date:

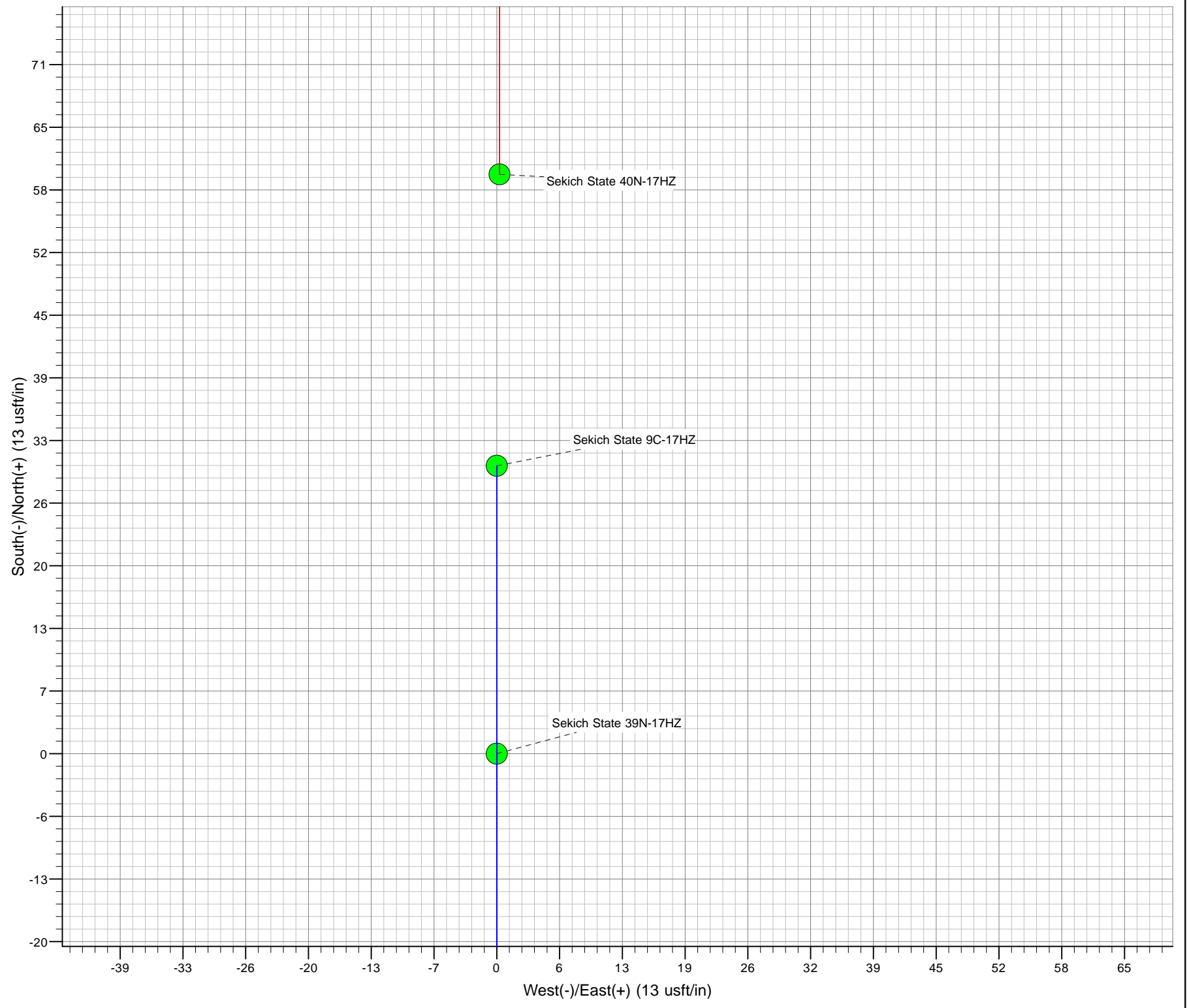

Plan Report for Sekich State 40N-17HZ - Rev A0 Permit

Measured Depth (usft)	Inclination (°)	Azimuth (°)	Vertical Depth (usft)	+N/-S (usft)	+E/-W (usft)	Vertical Section (usft)	Dogleg Rate (°/100usft)	Build Rate (°/100usft)	Turn Rate (°/100usft)	Toolface Azimuth (°)
0.00	0.00	0.00	0.00	0.00	0.00	0.00	0.00	0.00	0.00	0.00
Sekich State 40N-17HZ_SEC - Sekich State 40N-17HZ_SHL										
100.00	0.00	0.00	100.00	0.00	0.00	0.00	0.00	0.00	0.00	0.00
200.00	0.00	0.00	200.00	0.00	0.00	0.00	0.00	0.00	0.00	0.00
300.00	0.00	0.00	300.00	0.00	0.00	0.00	0.00	0.00	0.00	0.00
400.00	0.00	0.00	400.00	0.00	0.00	0.00	0.00	0.00	0.00	0.00
500.00	0.00	0.00	500.00	0.00	0.00	0.00	0.00	0.00	0.00	0.00
600.00	0.00	0.00	600.00	0.00	0.00	0.00	0.00	0.00	0.00	0.00
700.00	0.00	0.00	700.00	0.00	0.00	0.00	0.00	0.00	0.00	0.00
800.00	0.00	0.00	800.00	0.00	0.00	0.00	0.00	0.00	0.00	0.00
900.00	0.00	0.00	900.00	0.00	0.00	0.00	0.00	0.00	0.00	0.00
993.00	0.00	0.00	993.00	0.00	0.00	0.00	0.00	0.00	0.00	0.00
Fox Hills Marker										
1,000.00	0.00	0.00	1,000.00	0.00	0.00	0.00	0.00	0.00	0.00	0.00
1,043.00	0.00	0.00	1,043.00	0.00	0.00	0.00	0.00	0.00	0.00	0.00
9 5/8"										
1,100.00	0.00	0.00	1,100.00	0.00	0.00	0.00	0.00	0.00	0.00	0.00
1,200.00	0.00	0.00	1,200.00	0.00	0.00	0.00	0.00	0.00	0.00	0.00
1,300.00	0.00	0.00	1,300.00	0.00	0.00	0.00	0.00	0.00	0.00	0.00
1,400.00	0.00	0.00	1,400.00	0.00	0.00	0.00	0.00	0.00	0.00	0.00
1,500.00	0.00	0.00	1,500.00	0.00	0.00	0.00	0.00	0.00	0.00	0.00
1,600.00	0.00	0.00	1,600.00	0.00	0.00	0.00	0.00	0.00	0.00	0.00
1,700.00	0.00	0.00	1,700.00	0.00	0.00	0.00	0.00	0.00	0.00	0.00
1,800.00	0.00	0.00	1,800.00	0.00	0.00	0.00	0.00	0.00	0.00	0.00
1,900.00	0.00	0.00	1,900.00	0.00	0.00	0.00	0.00	0.00	0.00	0.00
2,000.00	0.00	0.00	2,000.00	0.00	0.00	0.00	0.00	0.00	0.00	0.00
2,100.00	0.00	0.00	2,100.00	0.00	0.00	0.00	0.00	0.00	0.00	0.00
2,200.00	0.00	0.00	2,200.00	0.00	0.00	0.00	0.00	0.00	0.00	0.00
2,300.00	0.00	0.00	2,300.00	0.00	0.00	0.00	0.00	0.00	0.00	0.00
2,400.00	0.00	0.00	2,400.00	0.00	0.00	0.00	0.00	0.00	0.00	0.00
2,500.00	0.00	0.00	2,500.00	0.00	0.00	0.00	0.00	0.00	0.00	0.00
2,600.00	0.00	0.00	2,600.00	0.00	0.00	0.00	0.00	0.00	0.00	0.00
2,700.00	0.00	0.00	2,700.00	0.00	0.00	0.00	0.00	0.00	0.00	0.00
2,800.00	0.00	0.00	2,800.00	0.00	0.00	0.00	0.00	0.00	0.00	0.00
2,900.00	0.00	0.00	2,900.00	0.00	0.00	0.00	0.00	0.00	0.00	0.00
3,000.00	0.00	0.00	3,000.00	0.00	0.00	0.00	0.00	0.00	0.00	0.00
3,100.00	0.00	0.00	3,100.00	0.00	0.00	0.00	0.00	0.00	0.00	0.00
3,200.00	0.00	0.00	3,200.00	0.00	0.00	0.00	0.00	0.00	0.00	0.00
3,300.00	0.00	0.00	3,300.00	0.00	0.00	0.00	0.00	0.00	0.00	0.00
3,400.00	0.00	0.00	3,400.00	0.00	0.00	0.00	0.00	0.00	0.00	0.00
3,500.00	0.00	0.00	3,500.00	0.00	0.00	0.00	0.00	0.00	0.00	0.00
3,541.00	0.00	0.00	3,541.00	0.00	0.00	0.00	0.00	0.00	0.00	0.00
Parkman										
3,600.00	0.00	0.00	3,600.00	0.00	0.00	0.00	0.00	0.00	0.00	0.00
3,700.00	0.00	0.00	3,700.00	0.00	0.00	0.00	0.00	0.00	0.00	0.00
3,800.00	0.00	0.00	3,800.00	0.00	0.00	0.00	0.00	0.00	0.00	0.00
Begin Nudge @ 3800.00ft										
3,900.00	2.00	0.00	3,899.98	1.75	0.00	0.00	2.00	2.00	0.00	0.00
4,000.00	4.00	0.00	3,999.84	6.98	0.00	0.00	2.00	2.00	0.00	0.00
4,100.00	6.00	0.00	4,099.45	15.69	0.00	0.00	2.00	2.00	0.00	0.00
4,140.80	6.82	0.00	4,140.00	20.25	0.00	0.00	2.00	2.00	0.00	0.00
Sussex										
4,200.00	8.00	0.00	4,198.70	27.88	0.00	0.00	2.00	2.00	0.00	0.00
4,300.00	10.00	0.00	4,297.47	43.52	0.00	0.00	2.00	2.00	0.00	0.00
End Nudge @ 4300.00ft										
4,400.00	10.00	0.00	4,395.95	60.89	0.00	0.00	0.00	0.00	0.00	0.00
4,500.00	10.00	0.00	4,494.43	78.25	0.00	0.00	0.00	0.00	0.00	0.00

Plan Report for Sekich State 40N-17HZ - Rev A0 Permit

Measured Depth (usft)	Inclination (°)	Azimuth (°)	Vertical Depth (usft)	+N/-S (usft)	+E/-W (usft)	Vertical Section (usft)	Dogleg Rate (°/100usft)	Build Rate (°/100usft)	Turn Rate (°/100usft)	Toolface Azimuth (°)
4,600.00	10.00	0.00	4,592.91	95.62	0.00	0.00	0.00	0.00	0.00	0.00
4,700.00	10.00	0.00	4,691.39	112.98	0.00	0.00	0.00	0.00	0.00	0.00
4,800.00	10.00	0.00	4,789.87	130.35	0.00	0.00	0.00	0.00	0.00	0.00
4,900.00	10.00	0.00	4,888.35	147.71	0.00	0.00	0.00	0.00	0.00	0.00
5,000.00	10.00	0.00	4,986.83	165.08	0.00	0.00	0.00	0.00	0.00	0.00
5,100.00	10.00	0.00	5,085.31	182.44	0.00	0.00	0.00	0.00	0.00	0.00
5,200.00	10.00	0.00	5,183.79	199.81	0.00	0.00	0.00	0.00	0.00	0.00
5,300.00	10.00	0.00	5,282.27	217.17	0.00	0.00	0.00	0.00	0.00	0.00
5,400.00	10.00	0.00	5,380.75	234.54	0.00	0.00	0.00	0.00	0.00	0.00
5,500.00	10.00	0.00	5,479.23	251.90	0.00	0.00	0.00	0.00	0.00	0.00
5,600.00	10.00	0.00	5,577.72	269.27	0.00	0.00	0.00	0.00	0.00	0.00
5,700.00	10.00	0.00	5,676.20	286.63	0.00	0.00	0.00	0.00	0.00	0.00
5,800.00	10.00	0.00	5,774.68	303.99	0.00	0.00	0.00	0.00	0.00	0.00
5,810.00	10.00	0.00	5,784.53	305.73	0.00	0.00	0.00	0.00	0.00	0.00
Begin Drop @ 5810.00ft										
5,900.00	8.20	0.00	5,873.39	319.96	0.00	0.00	2.00	-2.00	0.00	180.00
6,000.00	6.20	0.00	5,972.60	332.50	0.00	0.00	2.00	-2.00	0.00	180.00
6,100.00	4.20	0.00	6,072.18	341.56	0.00	0.00	2.00	-2.00	0.00	180.00
6,200.00	2.20	0.00	6,172.02	347.14	0.00	0.00	2.00	-2.00	0.00	180.00
6,300.00	0.20	0.00	6,271.99	349.24	0.00	0.00	2.00	-2.00	0.00	180.00
6,310.00	0.00	0.00	6,281.99	349.25	0.00	0.00	2.00	-2.00	0.00	-180.00
End Drop @ 6310.00ft										
6,331.05	0.00	0.00	6,303.04	349.25	0.00	0.00	0.00	0.00	0.00	0.00
Top of 4.5" Liner @ 6331.05ft										
6,400.00	0.00	0.00	6,371.99	349.25	0.00	0.00	0.00	0.00	0.00	0.00
6,431.05	0.00	0.00	6,403.04	349.25	0.00	0.00	0.00	0.00	0.00	0.00
KOP @ 6431.05ft										
6,500.00	6.90	90.00	6,471.82	349.25	4.14	4.14	10.00	10.00	0.00	90.00
6,600.00	16.90	90.00	6,569.55	349.25	24.73	24.73	10.00	10.00	0.00	0.00
6,700.00	26.90	90.00	6,662.22	349.25	61.97	61.97	10.00	10.00	0.00	0.00
6,800.00	36.90	90.00	6,747.02	349.25	114.74	114.74	10.00	10.00	0.00	0.00
6,900.00	46.90	90.00	6,821.36	349.25	181.43	181.43	10.00	10.00	0.00	0.00
DLS = 10°/100'										
6,940.55	50.95	90.00	6,848.00	349.25	212.00	212.00	10.00	10.00	0.00	0.00
Sharon Springs										
7,000.00	56.90	90.00	6,882.99	349.25	260.02	260.02	10.00	10.00	0.00	0.00
7,040.72	60.97	90.00	6,904.00	349.25	294.89	294.89	10.00	10.00	0.00	0.00
Niobrara A										
7,100.00	66.90	90.00	6,930.04	349.25	348.12	348.12	10.00	10.00	0.00	0.00
7,200.00	76.90	90.00	6,961.08	349.25	443.05	443.05	10.00	10.00	0.00	0.00
7,213.59	78.25	90.00	6,964.00	349.25	456.32	456.32	10.00	10.00	0.00	0.00
Niobrara B										
7,300.00	86.90	90.00	6,975.16	349.25	541.92	541.92	10.00	10.00	0.00	0.00
7,331.97	90.09	90.00	6,976.00	349.25	573.88	573.88	10.00	10.00	0.00	0.00
End Build @ 7331.97ft - Landing Target (Heel) - 7"										
7,400.00	90.09	90.00	6,975.89	349.25	641.91	641.91	0.00	0.00	0.00	0.00
7,500.00	90.09	90.00	6,975.73	349.25	741.91	741.91	0.00	0.00	0.00	0.00
7,600.00	90.09	90.00	6,975.57	349.25	841.91	841.91	0.00	0.00	0.00	0.00
7,700.00	90.09	90.00	6,975.41	349.25	941.91	941.91	0.00	0.00	0.00	0.00
7,800.00	90.09	90.00	6,975.25	349.25	1,041.91	1,041.91	0.00	0.00	0.00	0.00
7,900.00	90.09	90.00	6,975.09	349.25	1,141.91	1,141.91	0.00	0.00	0.00	0.00
8,000.00	90.09	90.00	6,974.93	349.24	1,241.91	1,241.91	0.00	0.00	0.00	0.00
8,100.00	90.09	90.00	6,974.77	349.24	1,341.91	1,341.91	0.00	0.00	0.00	0.00
8,200.00	90.09	90.00	6,974.61	349.24	1,441.91	1,441.91	0.00	0.00	0.00	0.00
8,300.00	90.09	90.00	6,974.45	349.24	1,541.91	1,541.91	0.00	0.00	0.00	0.00
8,400.00	90.09	90.00	6,974.29	349.24	1,641.91	1,641.91	0.00	0.00	0.00	0.00
8,500.00	90.09	90.00	6,974.13	349.24	1,741.91	1,741.91	0.00	0.00	0.00	0.00
8,600.00	90.09	90.00	6,973.97	349.24	1,841.91	1,841.91	0.00	0.00	0.00	0.00
8,700.00	90.09	90.00	6,973.81	349.24	1,941.91	1,941.91	0.00	0.00	0.00	0.00

Plan Report for Sekich State 40N-17HZ - Rev A0 Permit

Measured Depth (usft)	Inclination (°)	Azimuth (°)	Vertical Depth (usft)	+N/-S (usft)	+E/-W (usft)	Vertical Section (usft)	Dogleg Rate (°/100usft)	Build Rate (°/100usft)	Turn Rate (°/100usft)	Toolface Azimuth (°)
8,800.00	90.09	90.00	6,973.65	349.24	2,041.91	2,041.91	0.00	0.00	0.00	0.00
8,900.00	90.09	90.00	6,973.49	349.24	2,141.91	2,141.91	0.00	0.00	0.00	0.00
9,000.00	90.09	90.00	6,973.33	349.24	2,241.91	2,241.91	0.00	0.00	0.00	0.00
9,100.00	90.09	90.00	6,973.16	349.24	2,341.91	2,341.91	0.00	0.00	0.00	0.00
9,200.00	90.09	90.00	6,973.00	349.24	2,441.91	2,441.91	0.00	0.00	0.00	0.00
9,300.00	90.09	90.00	6,972.84	349.23	2,541.91	2,541.91	0.00	0.00	0.00	0.00
9,400.00	90.09	90.00	6,972.68	349.23	2,641.91	2,641.91	0.00	0.00	0.00	0.00
9,500.00	90.09	90.00	6,972.52	349.23	2,741.91	2,741.91	0.00	0.00	0.00	0.00
9,600.00	90.09	90.00	6,972.36	349.23	2,841.90	2,841.90	0.00	0.00	0.00	0.00
9,700.00	90.09	90.00	6,972.20	349.23	2,941.90	2,941.90	0.00	0.00	0.00	0.00
9,800.00	90.09	90.00	6,972.04	349.23	3,041.90	3,041.90	0.00	0.00	0.00	0.00
9,900.00	90.09	90.00	6,971.88	349.23	3,141.90	3,141.90	0.00	0.00	0.00	0.00
10,000.00	90.09	90.00	6,971.72	349.23	3,241.90	3,241.90	0.00	0.00	0.00	0.00
10,100.00	90.09	90.00	6,971.56	349.23	3,341.90	3,341.90	0.00	0.00	0.00	0.00
10,200.00	90.09	90.00	6,971.40	349.23	3,441.90	3,441.90	0.00	0.00	0.00	0.00
10,300.00	90.09	90.00	6,971.24	349.23	3,541.90	3,541.90	0.00	0.00	0.00	0.00
10,400.00	90.09	90.00	6,971.08	349.23	3,641.90	3,641.90	0.00	0.00	0.00	0.00
10,500.00	90.09	90.00	6,970.92	349.23	3,741.90	3,741.90	0.00	0.00	0.00	0.00
10,600.00	90.09	90.00	6,970.76	349.23	3,841.90	3,841.90	0.00	0.00	0.00	0.00
10,700.00	90.09	90.00	6,970.60	349.22	3,941.90	3,941.90	0.00	0.00	0.00	0.00
10,800.00	90.09	90.00	6,970.44	349.22	4,041.90	4,041.90	0.00	0.00	0.00	0.00
10,900.00	90.09	90.00	6,970.28	349.22	4,141.90	4,141.90	0.00	0.00	0.00	0.00
11,000.00	90.09	90.00	6,970.12	349.22	4,241.90	4,241.90	0.00	0.00	0.00	0.00
11,100.00	90.09	90.00	6,969.96	349.22	4,341.90	4,341.90	0.00	0.00	0.00	0.00
11,200.00	90.09	90.00	6,969.80	349.22	4,441.90	4,441.90	0.00	0.00	0.00	0.00
11,300.00	90.09	90.00	6,969.64	349.22	4,541.90	4,541.90	0.00	0.00	0.00	0.00
11,400.00	90.09	90.00	6,969.48	349.22	4,641.90	4,641.90	0.00	0.00	0.00	0.00
11,500.00	90.09	90.00	6,969.32	349.22	4,741.90	4,741.90	0.00	0.00	0.00	0.00
11,600.00	90.09	90.00	6,969.16	349.22	4,841.90	4,841.90	0.00	0.00	0.00	0.00
11,700.00	90.09	90.00	6,969.00	349.22	4,941.90	4,941.90	0.00	0.00	0.00	0.00
11,800.00	90.09	90.00	6,968.84	349.22	5,041.90	5,041.90	0.00	0.00	0.00	0.00
11,900.00	90.09	90.00	6,968.68	349.22	5,141.90	5,141.90	0.00	0.00	0.00	0.00
12,000.00	90.09	90.00	6,968.52	349.21	5,241.90	5,241.90	0.00	0.00	0.00	0.00
12,100.00	90.09	90.00	6,968.36	349.21	5,341.90	5,341.90	0.00	0.00	0.00	0.00
12,200.00	90.09	90.00	6,968.20	349.21	5,441.90	5,441.90	0.00	0.00	0.00	0.00
12,300.00	90.09	90.00	6,968.04	349.21	5,541.90	5,541.90	0.00	0.00	0.00	0.00
12,400.00	90.09	90.00	6,967.88	349.21	5,641.90	5,641.90	0.00	0.00	0.00	0.00
12,500.00	90.09	90.00	6,967.72	349.21	5,741.90	5,741.90	0.00	0.00	0.00	0.00
12,600.00	90.09	90.00	6,967.56	349.21	5,841.90	5,841.90	0.00	0.00	0.00	0.00
12,700.00	90.09	90.00	6,967.40	349.21	5,941.90	5,941.90	0.00	0.00	0.00	0.00
12,800.00	90.09	90.00	6,967.24	349.21	6,041.90	6,041.90	0.00	0.00	0.00	0.00
12,900.00	90.09	90.00	6,967.08	349.21	6,141.90	6,141.90	0.00	0.00	0.00	0.00
13,000.00	90.09	90.00	6,966.92	349.21	6,241.90	6,241.90	0.00	0.00	0.00	0.00
13,100.00	90.09	90.00	6,966.76	349.21	6,341.90	6,341.90	0.00	0.00	0.00	0.00
13,200.00	90.09	90.00	6,966.60	349.21	6,441.90	6,441.90	0.00	0.00	0.00	0.00
13,300.00	90.09	90.00	6,966.44	349.20	6,541.90	6,541.90	0.00	0.00	0.00	0.00
13,400.00	90.09	90.00	6,966.28	349.20	6,641.90	6,641.90	0.00	0.00	0.00	0.00
13,500.00	90.09	90.00	6,966.12	349.20	6,741.90	6,741.90	0.00	0.00	0.00	0.00
13,600.00	90.09	90.00	6,965.95	349.20	6,841.90	6,841.90	0.00	0.00	0.00	0.00
13,700.00	90.09	90.00	6,965.79	349.20	6,941.90	6,941.90	0.00	0.00	0.00	0.00
13,800.00	90.09	90.00	6,965.63	349.20	7,041.90	7,041.90	0.00	0.00	0.00	0.00
13,900.00	90.09	90.00	6,965.47	349.20	7,141.90	7,141.90	0.00	0.00	0.00	0.00
14,000.00	90.09	90.00	6,965.31	349.20	7,241.90	7,241.90	0.00	0.00	0.00	0.00
14,100.00	90.09	90.00	6,965.15	349.20	7,341.90	7,341.90	0.00	0.00	0.00	0.00
14,200.00	90.09	90.00	6,964.99	349.20	7,441.90	7,441.90	0.00	0.00	0.00	0.00
14,300.00	90.09	90.00	6,964.83	349.20	7,541.90	7,541.90	0.00	0.00	0.00	0.00
14,400.00	90.09	90.00	6,964.67	349.20	7,641.90	7,641.90	0.00	0.00	0.00	0.00
14,500.00	90.09	90.00	6,964.51	349.20	7,741.90	7,741.90	0.00	0.00	0.00	0.00
14,600.00	90.09	90.00	6,964.35	349.20	7,841.90	7,841.90	0.00	0.00	0.00	0.00
14,700.00	90.09	90.00	6,964.19	349.19	7,941.90	7,941.90	0.00	0.00	0.00	0.00

Plan Report for Sekich State 40N-17HZ - Rev A0 Permit

Measured Depth (usft)	Inclination (°)	Azimuth (°)	Vertical Depth (usft)	+N/-S (usft)	+E/-W (usft)	Vertical Section (usft)	Dogleg Rate (°/100usft)	Build Rate (°/100usft)	Turn Rate (°/100usft)	Toolface Azimuth (°)
14,800.00	90.09	90.00	6,964.03	349.19	8,041.90	8,041.90	0.00	0.00	0.00	0.00
14,900.00	90.09	90.00	6,963.87	349.19	8,141.90	8,141.90	0.00	0.00	0.00	0.00
15,000.00	90.09	90.00	6,963.71	349.19	8,241.90	8,241.90	0.00	0.00	0.00	0.00
15,100.00	90.09	90.00	6,963.55	349.19	8,341.90	8,341.90	0.00	0.00	0.00	0.00
15,200.00	90.09	90.00	6,963.39	349.19	8,441.90	8,441.90	0.00	0.00	0.00	0.00
15,300.00	90.09	90.00	6,963.23	349.19	8,541.90	8,541.90	0.00	0.00	0.00	0.00
15,400.00	90.09	90.00	6,963.07	349.19	8,641.90	8,641.90	0.00	0.00	0.00	0.00
15,500.00	90.09	90.00	6,962.91	349.19	8,741.90	8,741.90	0.00	0.00	0.00	0.00
15,600.00	90.09	90.00	6,962.75	349.19	8,841.90	8,841.90	0.00	0.00	0.00	0.00
15,700.00	90.09	90.00	6,962.59	349.19	8,941.90	8,941.90	0.00	0.00	0.00	0.00
15,800.00	90.09	90.00	6,962.43	349.19	9,041.90	9,041.90	0.00	0.00	0.00	0.00
15,900.00	90.09	90.00	6,962.27	349.19	9,141.90	9,141.90	0.00	0.00	0.00	0.00
16,000.00	90.09	90.00	6,962.11	349.18	9,241.90	9,241.90	0.00	0.00	0.00	0.00
16,100.00	90.09	90.00	6,961.95	349.18	9,341.90	9,341.90	0.00	0.00	0.00	0.00
16,200.00	90.09	90.00	6,961.79	349.18	9,441.90	9,441.90	0.00	0.00	0.00	0.00
16,300.00	90.09	90.00	6,961.63	349.18	9,541.90	9,541.90	0.00	0.00	0.00	0.00
16,400.00	90.09	90.00	6,961.47	349.18	9,641.90	9,641.90	0.00	0.00	0.00	0.00
16,500.00	90.09	90.00	6,961.31	349.18	9,741.90	9,741.90	0.00	0.00	0.00	0.00
16,600.00	90.09	90.00	6,961.15	349.18	9,841.90	9,841.90	0.00	0.00	0.00	0.00
16,692.57	90.09	90.00	6,961.00	349.18	9,934.47	9,934.47	0.00	0.00	0.00	0.00

TD Well @ 16692.57ft - Total Depth (Toe) - Sekich State 40N-17HZ_BHL

Plan Annotations

Measured Depth (usft)	Vertical Depth (usft)	Local Coordinates +N/-S (usft)	+E/-W (usft)	Comment
3,800.00	3,800.00	0.00	0.00	Begin Nudge @ 3800.00ft
4,300.00	4,297.47	43.52	0.00	End Nudge @ 4300.00ft
5,810.00	5,784.53	305.73	0.00	Begin Drop @ 5810.00ft
6,310.00	6,281.99	349.25	0.00	End Drop @ 6310.00ft
6,331.05	6,303.04	349.25	0.00	Top of 4.5" Liner @ 6331.05ft
6,431.05	6,403.04	349.25	0.00	KOP @ 6431.05ft
6,900.00	6,821.36	349.25	181.43	DLS = 10°/100'
7,331.97	6,976.00	349.25	573.88	End Build @ 7331.97ft
16,692.57	6,961.00	349.18	9,934.47	TD Well @ 16692.57ft

Vertical Section Information

Angle Type	Target	Azimuth (°)	Origin Type	Origin +N/_S (usft)	+E/-W (usft)	Start TVD (usft)
User	No Target (Freehand)	90.00	Slot	0.00	0.00	0.00

Survey tool program

From (usft)	To (usft)	Survey/Plan	Survey Tool
0.00	7,331.97	Rev A0 Permit	MWD
7,331.97	16,692.57	Rev A0 Permit	MWD

Plan Report for Sekich State 40N-17HZ - Rev A0 Permit

Casing Details

Measured Depth (usft)	Vertical Depth (usft)	Name	Casing Diameter (")	Hole Diameter (")
1,043.00	1,043.00	9 5/8"	9-5/8	13-1/2
7,331.97	6,976.00	7"	7	8-3/4

Formation Details

Measured Depth (usft)	Vertical Depth (usft)	Name	Lithology	Dip (°)	Dip Direction (°)
993.00	993.00	Fox Hills Marker		0.00	
3,541.00	3,541.00	Parkman		0.00	
4,140.80	4,140.00	Sussex		0.00	
6,940.55	6,848.00	Sharon Springs		0.00	
7,040.72	6,904.00	Niobrara A		0.00	
7,213.59	6,964.00	Niobrara B		0.00	
7,331.97	6,976.00	Landing Target (Heel)		0.00	
16,692.57	6,961.00	Total Depth (Toe)		0.00	

Targets associated with this wellbore

Target Name	TVD (usft)	+N/-S (usft)	+E/-W (usft)	Shape
Sekich State 40N-17HZ_SEC	0.00	0.00	0.00	Polygon
Sekich State 40N-17HZ_SHL	0.00	0.00	0.00	Point
Sekich State 40N-17HZ_BHL	6,961.00	349.18	9,934.47	Point

Directional Difficulty Index

Average Dogleg over Survey:	0.66 °/100usft	Maximum Dogleg over Survey:	10.00 °/100usft at 7,331.97 usft
Net Tortousity applicable to Plans:	0.66 °/100usft	Directional Difficulty Index:	6.656

Audit Info

North Reference Sheet for Sec. 18-T3N-R67W - Sekich State 40N-17HZ - Plan A

All data is in US Feet unless otherwise stated. Directions and Coordinates are relative to True North Reference.
Vertical Depths are relative to RKB = 17' @ 4866.00usft (Drilling Rig). Northing and Easting are relative to Sekich State 40N-17HZ
Coordinate System is US State Plane 1983, Colorado Northern Zone using datum North American Datum 1983, ellipsoid GRS 1980
Projection method is Lambert Conformal Conic (2 parallel)
Central Meridian is -105.50°, Longitude Origin:0.000000°, Latitude Origin:40.783333°
False Easting: 3,000,000.00usft, False Northing: 1,000,000.00usft, Scale Reduction: 0.99995695

Grid Coordinates of Well: 1,325,202.80 usft N, 3,156,259.65 usft E
Geographical Coordinates of Well: 40° 13' 29.01" N, 104° 56' 25.40" W
Grid Convergence at Surface is: 0.36°

Based upon Minimum Curvature type calculations, at a Measured Depth of 16,692.57usft
the Bottom Hole Displacement is 9,940.60usft in the Direction of 87.99° (True).
Magnetic Convergence at surface is: -8.29° (4 December 2013, , BGGM2013)

