

WELL SITE 34-11
COLORADO NORTH ZONE
NAD83 STATE PLANE COORDINATES
N. 1455197.74
E. 2551854.43

NAD27 STATE PLANE COORDINATES
N. 455196.36
E. 1552012.32

LATITUDE/LONGITUDE
NAD83
N. 40°34'18.2154" : 40.571727°
E. -107°06'47.721" : -107.113256°

NAD27
N. 40°34'18.3106" : 40.571753°
E. -107°06'45.5222" : -107.112645°

BOTTOM HOLE LOCATION
COLORADO NORTH ZONE
NAD83 STATE PLANE COORDINATES
N. 1457022.98
E. 2553168.42

NAD27 STATE PLANE COORDINATES
N. 457021.60
E. 1553326.31

LATITUDE/LONGITUDE
NAD83
N. 40°34'36.48466" : 40.576801°
E. -107°06'31.12517" : -107.108646°

NAD27
N. 40°34'36.5800" : 40.576828°
E. -107°06'28.9270" : -107.108035°

NOTES:

- OBSERVED PDOP OF 1.8. OBSERVATIONS ARE IN COMPLIANCE WITH RULE NO. 215.
- SITE IS MIXED QUAKING ASPEN AND SCRUB OAK
NO IMPROVEMENTS WITHIN 200' OF SITE.

NOTICE: According to Colorado Law, you must commence any legal action based on any defect in this survey within three years after you first discover such defect, in no event may any action be commenced more than ten years from the date of certification shown hereon.

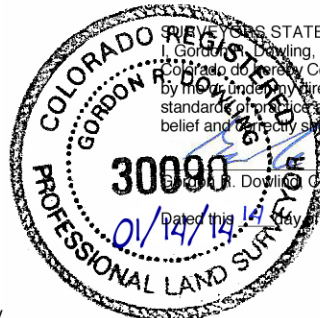

REVIEWER'S STATEMENT

I, Gordon R. Dowling, a duly registered Professional Land Surveyor in the State of Colorado, do hereby Certify that the survey represented by this drawing was done by me or under my direct supervision and is in accordance with the applicable standards of practice and is accurate based upon my knowledge, information, and belief and I correctly show the location of Pirtlaw Partners, Ltd. 34-11.

Gordon R. Dowling Colorado P.L.S. No. 30090

Dated this 14th day of January, 2014

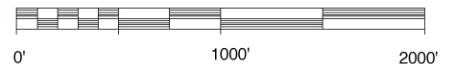

Quicksilver Resources Inc.

PIRTLAW PARTNERS, LTD. 34-11

SW1/4 SE1/4
SECTION 11, T7N R87W, 6th P.M.
ROUTT COUNTY, COLORADO

177.3' FSL 1913.2' FEL

DOWLING LAND SURVEYORS, LLC
P.O. BOX 954
HAYDEN, COLORADO 81639
(970) 276-3613
dowling@plotz.biz

SCALE	DRG	DATE	FILE
1" = 1000'	GRD	1/14/14	QR3411P4