



GUNNISON ENERGY CORPORATION

Project: Gunnison County, CO
Site: Deadman Gulch Unit
Well: DGU 18-43 CS#2
Wellbore: OH
Design: Plan #3



CATHEDRAL

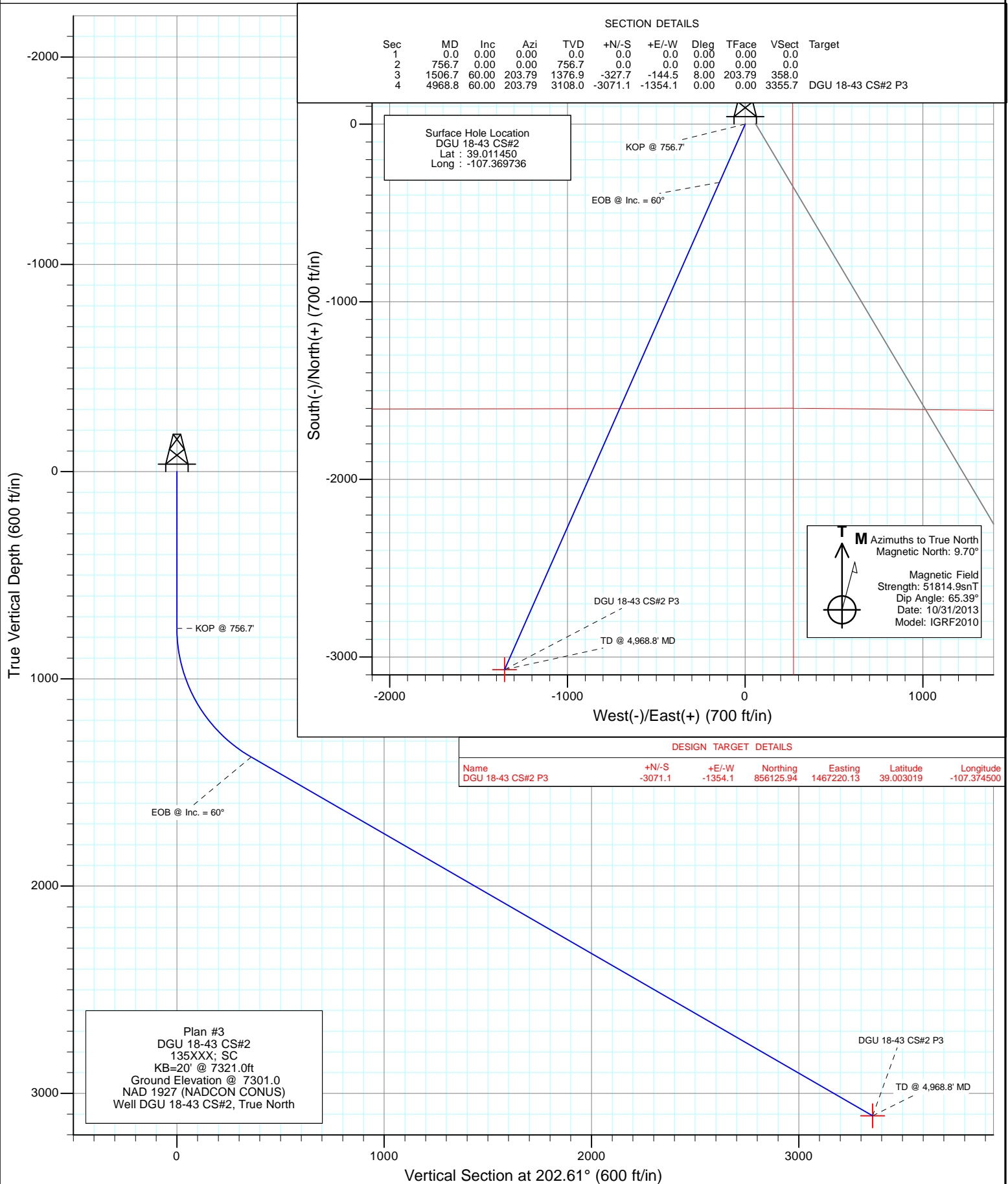

Cathedral Energy Services

Planning Report

Database:	USA EDM 5000 Multi Users DB	Local Co-ordinate Reference:	Well DGU 18-43 CS#2
Company:	Gunnison Energy Corporation	TVD Reference:	KB=20' @ 7321.0ft
Project:	Gunnison County, CO	MD Reference:	KB=20' @ 7321.0ft
Site:	Deadman Gulch Unit	North Reference:	True
Well:	DGU 18-43 CS#2	Survey Calculation Method:	Minimum Curvature
Wellbore:	OH		
Design:	Plan #3		

Project	Gunnison County, CO		
Map System:	US State Plane 1927 (Exact solution)	System Datum:	Mean Sea Level
Geo Datum:	NAD 1927 (NADCON CONUS)		
Map Zone:	Colorado South 503		

Site		Deadman Gulch Unit			
Site Position:		Northing:	861,395.66 ft	Latitude:	39.017439
From:	Lat/Long	Easting:	1,466,432.79 ft	Longitude:	-107.377642
Position Uncertainty:	0.0 ft	Slot Radius:	13.200 in	Grid Convergence:	-1.15 °

Well	DGU 18-43 CS#2					
Well Position	+N/-S	0.0 ft	Northing:	859,169.34 ft	Latitude:	39.011450
	+E/-W	0.0 ft	Easting:	1,468,635.48 ft	Longitude:	-107.369736
Position Uncertainty		0.0 ft	Wellhead Elevation:	ft	Ground Level:	7,301.0 ft

Wellbore	OH				
Magnetics	Model Name	Sample Date	Declination	Dip Angle	Field Strength
			(°)	(°)	(nT)
	IGRF2010	10/31/2013	9.70	65.39	51,815

Design	Plan #3			
Audit Notes:				
Version:	Phase:	PLAN	Tie On Depth:	0.0
Vertical Section:	Depth From (TVD)	+N/-S	+E/-W	Direction
	(ft)	(ft)	(ft)	(°)
	0.0	0.0	0.0	202.61

Plan Sections										
Measured Depth	Inclination	Azimuth	Vertical Depth	+N/-S	+E/-W	Dogleg Rate	Build Rate	Turn Rate	TFO	Target
(ft)	(°)	(°)	(ft)	(ft)	(ft)	(°/100ft)	(°/100ft)	(°/100ft)	(°)	
0.0	0.00	0.00	0.0	0.0	0.0	0.00	0.00	0.00	0.00	
756.7	0.00	0.00	756.7	0.0	0.0	0.00	0.00	0.00	0.00	
1,506.7	60.00	203.79	1,376.9	-327.7	-144.5	8.00	8.00	0.00	203.79	
4,968.8	60.00	203.79	3,108.0	-3,071.1	-1,354.1	0.00	0.00	0.00	0.00	DGU 18-43 CS#2 P3

Cathedral Energy Services

Planning Report

Database:	USA EDM 5000 Multi Users DB	Local Co-ordinate Reference:	Well DGU 18-43 CS#2
Company:	Gunnison Energy Corporation	TVD Reference:	KB=20' @ 7321.0ft
Project:	Gunnison County, CO	MD Reference:	KB=20' @ 7321.0ft
Site:	Deadman Gulch Unit	North Reference:	True
Well:	DGU 18-43 CS#2	Survey Calculation Method:	Minimum Curvature
Wellbore:	OH		
Design:	Plan #3		

Planned Survey

Measured Depth (ft)	Inclination (°)	Azimuth (°)	Vertical Depth (ft)	+N/-S (ft)	+E/-W (ft)	Vertical Section (ft)	Dogleg Rate (°/100ft)	Build Rate (°/100ft)	Comments / Formations
0.0	0.00	0.00	0.0	0.0	0.0	0.0	0.00	0.00	
100.0	0.00	0.00	100.0	0.0	0.0	0.0	0.00	0.00	
200.0	0.00	0.00	200.0	0.0	0.0	0.0	0.00	0.00	
300.0	0.00	0.00	300.0	0.0	0.0	0.0	0.00	0.00	
400.0	0.00	0.00	400.0	0.0	0.0	0.0	0.00	0.00	
500.0	0.00	0.00	500.0	0.0	0.0	0.0	0.00	0.00	
600.0	0.00	0.00	600.0	0.0	0.0	0.0	0.00	0.00	
700.0	0.00	0.00	700.0	0.0	0.0	0.0	0.00	0.00	
756.7	0.00	0.00	756.7	0.0	0.0	0.0	0.00	0.00	KOP @ 756.7'
800.0	3.47	203.79	800.0	-1.2	-0.5	1.3	8.00	8.00	
850.0	7.47	203.79	849.7	-5.6	-2.4	6.1	8.00	8.00	
900.0	11.47	203.79	899.0	-13.1	-5.8	14.3	8.00	8.00	
950.0	15.47	203.79	947.7	-23.7	-10.5	25.9	8.00	8.00	
1,000.0	19.47	203.79	995.3	-37.5	-16.5	40.9	8.00	8.00	
1,050.0	23.47	203.79	1,041.9	-54.2	-23.9	59.2	8.00	8.00	
1,100.0	27.47	203.79	1,087.0	-73.9	-32.6	80.7	8.00	8.00	
1,150.0	31.47	203.79	1,130.5	-96.4	-42.5	105.3	8.00	8.00	
1,200.0	35.47	203.79	1,172.2	-121.6	-53.6	132.9	8.00	8.00	
1,250.0	39.47	203.79	1,211.9	-149.4	-65.9	163.3	8.00	8.00	
1,300.0	43.47	203.79	1,249.4	-179.7	-79.2	196.3	8.00	8.00	
1,350.0	47.47	203.79	1,284.4	-212.3	-93.6	232.0	8.00	8.00	
1,400.0	51.47	203.79	1,316.9	-247.1	-108.9	270.0	8.00	8.00	
1,450.0	55.47	203.79	1,346.7	-283.8	-125.1	310.1	8.00	8.00	
1,500.0	59.47	203.79	1,373.6	-322.4	-142.1	352.3	8.00	8.00	
1,506.7	60.00	203.79	1,376.9	-327.7	-144.5	358.0	8.00	8.00	EOB @ Inc. = 60°
1,600.0	60.00	203.79	1,423.6	-401.6	-177.1	438.8	0.00	0.00	
1,700.0	60.00	203.79	1,473.6	-480.9	-212.0	525.4	0.00	0.00	
1,800.0	60.00	203.79	1,523.6	-560.1	-247.0	612.0	0.00	0.00	
1,900.0	60.00	203.79	1,573.6	-639.3	-281.9	698.6	0.00	0.00	
2,000.0	60.00	203.79	1,623.6	-718.6	-316.8	785.2	0.00	0.00	
2,100.0	60.00	203.79	1,673.6	-797.8	-351.8	871.7	0.00	0.00	
2,200.0	60.00	203.79	1,723.6	-877.1	-386.7	958.3	0.00	0.00	
2,300.0	60.00	203.79	1,773.6	-956.3	-421.7	1,044.9	0.00	0.00	
2,400.0	60.00	203.79	1,823.6	-1,035.5	-456.6	1,131.5	0.00	0.00	
2,500.0	60.00	203.79	1,873.6	-1,114.8	-491.5	1,218.1	0.00	0.00	
2,600.0	60.00	203.79	1,923.6	-1,194.0	-526.5	1,304.7	0.00	0.00	
2,700.0	60.00	203.79	1,973.6	-1,273.3	-561.4	1,391.2	0.00	0.00	
2,800.0	60.00	203.79	2,023.6	-1,352.5	-596.4	1,477.8	0.00	0.00	
2,900.0	60.00	203.79	2,073.6	-1,431.7	-631.3	1,564.4	0.00	0.00	
3,000.0	60.00	203.79	2,123.6	-1,511.0	-666.2	1,651.0	0.00	0.00	
3,100.0	60.00	203.79	2,173.6	-1,590.2	-701.2	1,737.6	0.00	0.00	
3,200.0	60.00	203.79	2,223.6	-1,669.5	-736.1	1,824.2	0.00	0.00	
3,300.0	60.00	203.79	2,273.6	-1,748.7	-771.1	1,910.8	0.00	0.00	
3,400.0	60.00	203.79	2,323.6	-1,828.0	-806.0	1,997.3	0.00	0.00	
3,500.0	60.00	203.79	2,373.6	-1,907.2	-840.9	2,083.9	0.00	0.00	
3,600.0	60.00	203.79	2,423.6	-1,986.4	-875.9	2,170.5	0.00	0.00	
3,700.0	60.00	203.79	2,473.6	-2,065.7	-910.8	2,257.1	0.00	0.00	
3,800.0	60.00	203.79	2,523.6	-2,144.9	-945.8	2,343.7	0.00	0.00	
3,900.0	60.00	203.79	2,573.6	-2,224.2	-980.7	2,430.3	0.00	0.00	
4,000.0	60.00	203.79	2,623.6	-2,303.4	-1,015.6	2,516.8	0.00	0.00	
4,100.0	60.00	203.79	2,673.6	-2,382.6	-1,050.6	2,603.4	0.00	0.00	
4,200.0	60.00	203.79	2,723.6	-2,461.9	-1,085.5	2,690.0	0.00	0.00	

Cathedral Energy Services

Planning Report

Database:	USA EDM 5000 Multi Users DB	Local Co-ordinate Reference:	Well DGU 18-43 CS#2
Company:	Gunnison Energy Corporation	TVD Reference:	KB=20' @ 7321.0ft
Project:	Gunnison County, CO	MD Reference:	KB=20' @ 7321.0ft
Site:	Deadman Gulch Unit	North Reference:	True
Well:	DGU 18-43 CS#2	Survey Calculation Method:	Minimum Curvature
Wellbore:	OH		
Design:	Plan #3		

Planned Survey

Measured Depth (ft)	Inclination (°)	Azimuth (°)	Vertical Depth (ft)	+N/-S (ft)	+E/-W (ft)	Vertical Section (ft)	Dogleg Rate (°/100ft)	Build Rate (°/100ft)	Comments / Formations
4,300.0	60.00	203.79	2,773.6	-2,541.1	-1,120.5	2,776.6	0.00	0.00	
4,400.0	60.00	203.79	2,823.6	-2,620.4	-1,155.4	2,863.2	0.00	0.00	
4,500.0	60.00	203.79	2,873.6	-2,699.6	-1,190.3	2,949.8	0.00	0.00	
4,600.0	60.00	203.79	2,923.6	-2,778.9	-1,225.3	3,036.3	0.00	0.00	
4,700.0	60.00	203.79	2,973.6	-2,858.1	-1,260.2	3,122.9	0.00	0.00	
4,800.0	60.00	203.79	3,023.6	-2,937.3	-1,295.2	3,209.5	0.00	0.00	
4,900.0	60.00	203.79	3,073.6	-3,016.6	-1,330.1	3,296.1	0.00	0.00	
4,968.8	60.00	203.79	3,108.0	-3,071.1	-1,354.1	3,355.7	0.00	0.00	TD @ 4,968.8' MD

Targets

Target Name	Dip Angle (°)	Dip Dir. (°)	TVD (ft)	+N/-S (ft)	+E/-W (ft)	Northing (ft)	Easting (ft)	Latitude	Longitude
- hit/miss target									
- Shape									
DMGU 18-43 CS#2	0.00	358.85	2,991.0	-2,938.2	-1,223.7	856,256.26	1,467,353.24	39.003384	-107.374041
- plan misses target center by 67.3ft at 4759.4ft MD (3003.3 TVD, -2905.1 N, -1281.0 E)									
- Point									
DGU 18-43 CS#2 P3	0.00	358.85	3,108.0	-3,071.1	-1,354.1	856,125.94	1,467,220.13	39.003019	-107.374500
- plan hits target center									
- Point									

Plan Annotations

Measured Depth (ft)	Vertical Depth (ft)	Local Coordinates		Comment
		+N/-S (ft)	+E/-W (ft)	
756.7	756.7	0.0	0.0	KOP @ 756.7'
1,506.7	1,376.9	-327.7	-144.5	EOB @ Inc. = 60°
4,968.8	3,108.0	-3,071.1	-1,354.1	TD @ 4,968.8' MD

Gunnison Energy Corporation

Gunnison County, CO

Deadman Gulch Unit

DGU 18-43 CS#2

OH

Plan #3

Anticollision Report

18 December, 2013

Cathedral Energy Services

Anticollision Report

Company:	Gunnison Energy Corporation	Local Co-ordinate Reference:	Well DGU 18-43 CS#2
Project:	Gunnison County, CO	TVD Reference:	KB=20' @ 7321.0ft
Reference Site:	Deadman Gulch Unit	MD Reference:	KB=20' @ 7321.0ft
Site Error:	0.0ft	North Reference:	True
Reference Well:	DGU 18-43 CS#2	Survey Calculation Method:	Minimum Curvature
Well Error:	0.0ft	Output errors are at	2.00 sigma
Reference Wellbore	OH	Database:	USA EDM 5000 Multi Users DB
Reference Design:	Plan #3	Offset TVD Reference:	Offset Datum

Reference	Plan #3		
Filter type:	NO GLOBAL FILTER: Using user defined selection & filtering criteria		
Interpolation Method:	MD Interval 100.0ft	Error Model:	Systematic Ellipse
Depth Range:	Unlimited	Scan Method:	Closest Approach 3D
Results Limited by:	Maximum center-center distance of 500.0ft	Error Surface:	Elliptical Conic
Warning Levels Evaluated at:	2.00 Sigma		

Survey Tool Program		Date	12/18/2013		
From (ft)	To (ft)	Survey (Wellbore)	Tool Name	Description	
0.0	4,968.8	Plan #3 (OH)	MWD	MWD	

Summary						
Site Name	Reference	Offset	Distance		Separation	Warning
	Measured	Measured	Between	Between		
Offset Well - Wellbore - Design	Depth	Depth	Centres	Ellipses	Factor	
	(ft)	(ft)	(ft)	(ft)		
Deadman Gulch Unit						
DGU 18-43 CS#3 - OH - Plan #3	700.0	717.0	60.0	57.6	24.952	CC, ES
DGU 18-43 CS#3 - OH - Plan #3	900.0	915.6	67.1	64.0	21.556	SF

Offset Design		Deadman Gulch Unit - DGU 18-43 CS#3 - OH - Plan #3											Offset Site Error:	0.0 ft	
Survey Program: 0-MWD													Offset Well Error:	0.0 ft	
Reference		Offset		Semi Major Axis			Distance								
Measured Depth (ft)	Vertical Depth (ft)	Measured Depth (ft)	Vertical Depth (ft)	Reference (ft)	Offset (ft)	Highside Toolface (°)	Offset Wellbore Centre +N/-S (ft)	+E/-W (ft)	Between Centres (ft)	Between Ellipses (ft)	Total Uncertainty Axis	Separation Factor	Warning		
0.0	0.0	17.0	17.0	0.0	0.0	89.99	0.0	60.0	60.0						
100.0	100.0	117.0	117.0	0.1	0.2	89.99	0.0	60.0	60.0	59.7	0.31	194.106			
200.0	200.0	217.0	217.0	0.3	0.3	89.99	0.0	60.0	60.0	59.3	0.66	91.136			
300.0	300.0	317.0	317.0	0.5	0.5	89.99	0.0	60.0	60.0	59.0	1.01	59.547			
400.0	400.0	417.0	417.0	0.7	0.7	89.99	0.0	60.0	60.0	58.6	1.36	44.220			
500.0	500.0	517.0	517.0	0.8	0.9	89.99	0.0	60.0	60.0	58.3	1.71	35.168			
600.0	600.0	617.0	617.0	1.0	1.0	89.99	0.0	60.0	60.0	57.9	2.05	29.192			
700.0	700.0	717.0	717.0	1.2	1.2	89.99	0.0	60.0	60.0	57.6	2.40	24.952	CC, ES		
736.6	736.6	753.6	753.6	1.3	1.3	-114.16	0.0	60.0	60.1	57.6	2.53	23.757			
800.0	800.0	817.0	817.0	1.4	1.4	-114.90	0.0	60.0	60.5	57.8	2.75	21.984			
900.0	899.0	915.6	915.6	1.6	1.6	-124.35	-0.1	60.0	67.1	64.0	3.11	21.556	SF		
1,000.0	995.3	1,010.5	1,010.0	1.9	1.7	-132.35	-7.1	64.2	86.3	82.7	3.52	24.540			
1,100.0	1,087.0	1,103.2	1,100.5	2.5	2.0	-134.71	-24.2	74.4	118.0	113.9	4.08	28.942			
1,200.0	1,172.2	1,192.1	1,184.2	3.3	2.4	-133.68	-49.9	89.7	160.3	155.3	4.93	32.490			
1,300.0	1,249.4	1,276.1	1,259.3	4.4	2.9	-130.88	-82.2	108.8	212.0	205.8	6.15	34.449			
1,400.0	1,316.9	1,354.4	1,324.9	5.7	3.6	-126.98	-119.0	130.7	271.9	264.2	7.72	35.222			
1,500.0	1,373.6	1,427.1	1,381.2	7.2	4.4	-122.18	-158.3	154.1	338.8	329.2	9.61	35.245			
1,600.0	1,423.6	1,496.7	1,430.6	8.8	5.2	-122.37	-200.5	179.2	409.2	397.7	11.49	35.625			
1,700.0	1,473.6	1,565.7	1,474.6	10.3	6.2	-121.70	-246.2	206.3	479.9	466.4	13.54	35.441			

CC - Min centre to center distance or convergent point, SF - min separation factor, ES - min ellipse separation

Cathedral Energy Services

Anticollision Report

Company:	Gunnison Energy Corporation	Local Co-ordinate Reference:	Well DGU 18-43 CS#2
Project:	Gunnison County, CO	TVD Reference:	KB=20' @ 7321.0ft
Reference Site:	Deadman Gulch Unit	MD Reference:	KB=20' @ 7321.0ft
Site Error:	0.0ft	North Reference:	True
Reference Well:	DGU 18-43 CS#2	Survey Calculation Method:	Minimum Curvature
Well Error:	0.0ft	Output errors are at	2.00 sigma
Reference Wellbore	OH	Database:	USA EDM 5000 Multi Users DB
Reference Design:	Plan #3	Offset TVD Reference:	Offset Datum

Reference Depths are relative to KB=20' @ 7321.0ft

Offset Depths are relative to Offset Datum

Central Meridian is -105.500000 °

Coordinates are relative to: DGU 18-43 CS#2

Coordinate System is US State Plane 1927 (Exact solution), Colorado South 503

Grid Convergence at Surface is: -1.15°

Ladder Plot

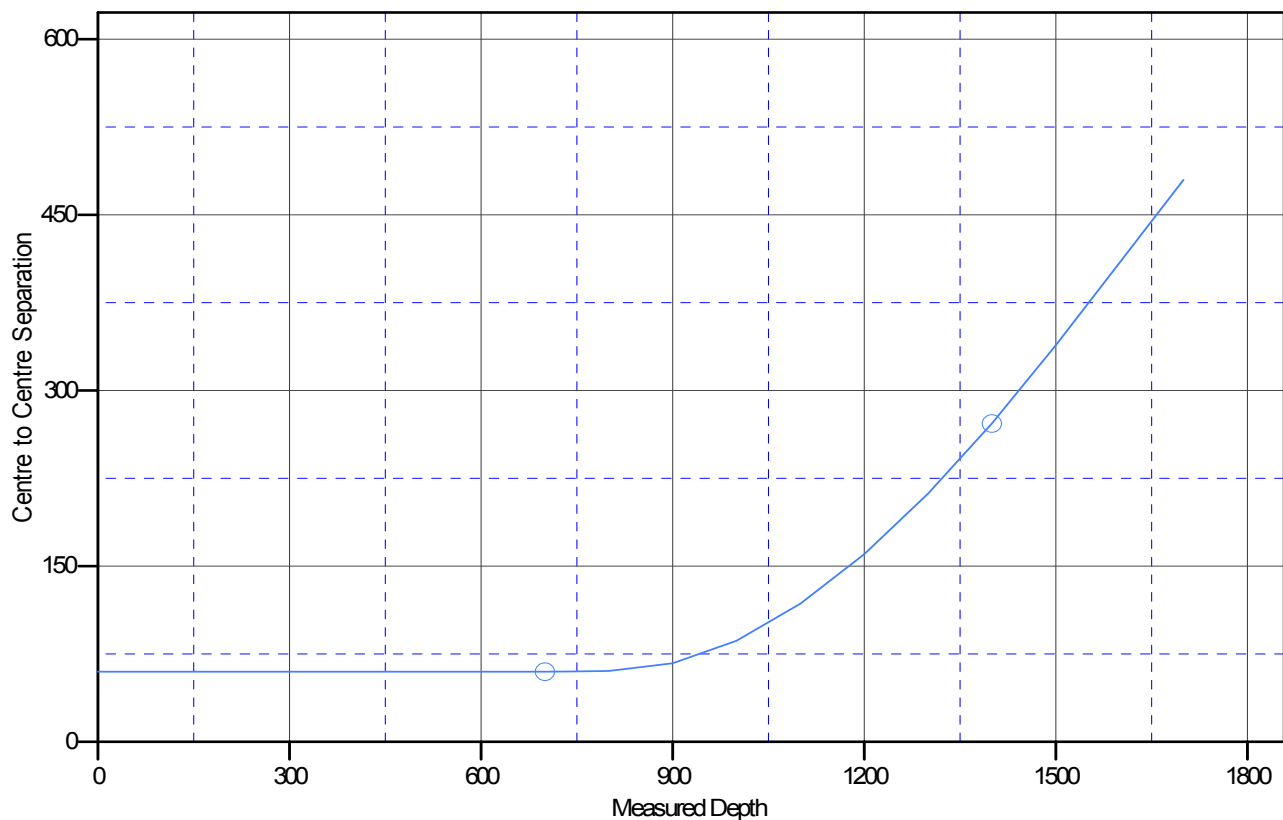

LEGEND

—○— DGU 18-43 CS#3, OH, Plan #3 V0

Gunnison Energy Corporation

Gunnison County, CO

Deadman Gulch Unit

DGU 18-43 CS#2

OH

Plan: Plan #3

Standard Planning Report - Geographic

18 December, 2013

Cathedral Energy Services

Planning Report - Geographic

Database:	USA EDM 5000 Multi Users DB	Local Co-ordinate Reference:	Well DGU 18-43 CS#2
Company:	Gunnison Energy Corporation	TVD Reference:	KB=20' @ 7321.0ft
Project:	Gunnison County, CO	MD Reference:	KB=20' @ 7321.0ft
Site:	Deadman Gulch Unit	North Reference:	True
Well:	DGU 18-43 CS#2	Survey Calculation Method:	Minimum Curvature
Wellbore:	OH		
Design:	Plan #3		

Project	Gunnison County, CO		
Map System:	US State Plane 1927 (Exact solution)	System Datum:	Mean Sea Level
Geo Datum:	NAD 1927 (NADCON CONUS)		
Map Zone:	Colorado South 503		

Site		Deadman Gulch Unit			
Site Position:		Northing:	861,395.65 ft	Latitude:	39.017439
From:	Lat/Long	Easting:	1,466,432.79 ft	Longitude:	-107.377642
Position Uncertainty:	0.0 ft	Slot Radius:	13.200 in	Grid Convergence:	-1.15 °

Well		DGU 18-43 CS#2				
Well Position	+N/-S	0.0 ft	Northing:	859,169.34 ft	Latitude:	39.011450
	+E/-W	0.0 ft	Easting:	1,468,635.48 ft	Longitude:	-107.369736
Position Uncertainty		0.0 ft	Wellhead Elevation:		Ground Level:	7,301.0 ft

Wellbore	OH				
Magnetics	Model Name	Sample Date	Declination (°)	Dip Angle (°)	Field Strength (nT)
	IGRF2010	10/31/2013	9.70	65.39	51,815

Design	Plan #3			
Audit Notes:				
Version:	Phase:	PLAN	Tie On Depth:	0.0
Vertical Section:	Depth From (TVD) (ft)	+N/-S (ft)	+E/-W (ft)	Direction (°)
	0.0	0.0	0.0	202.61

Plan Sections										
Measured Depth (ft)	Inclination (°)	Azimuth (°)	Vertical Depth (ft)	+N/-S (ft)	+E/-W (ft)	Dogleg Rate (°/100ft)	Build Rate (°/100ft)	Turn Rate (°/100ft)	TFO (°)	Target
0.0	0.00	0.00	0.0	0.0	0.0	0.00	0.00	0.00	0.00	
756.7	0.00	0.00	756.7	0.0	0.0	0.00	0.00	0.00	0.00	
1,506.7	60.00	203.79	1,376.9	-327.7	-144.5	8.00	8.00	0.00	203.79	
4,968.8	60.00	203.79	3,108.0	-3,071.1	-1,354.1	0.00	0.00	0.00	0.00	DGU 18-43 CS#2 P3

Cathedral Energy Services

Planning Report - Geographic

Database:	USA EDM 5000 Multi Users DB	Local Co-ordinate Reference:	Well DGU 18-43 CS#2
Company:	Gunnison Energy Corporation	TVD Reference:	KB=20' @ 7321.0ft
Project:	Gunnison County, CO	MD Reference:	KB=20' @ 7321.0ft
Site:	Deadman Gulch Unit	North Reference:	True
Well:	DGU 18-43 CS#2	Survey Calculation Method:	Minimum Curvature
Wellbore:	OH		
Design:	Plan #3		

Planned Survey									
Measured Depth (ft)	Inclination (°)	Azimuth (°)	Vertical Depth (ft)	+N/-S (ft)	+E/-W (ft)	Map Northing (ft)	Map Easting (ft)	Latitude	Longitude
0.0	0.00	0.00	0.0	0.0	0.0	859,169.34	1,468,635.48	39.011450	-107.369736
100.0	0.00	0.00	100.0	0.0	0.0	859,169.34	1,468,635.48	39.011450	-107.369736
200.0	0.00	0.00	200.0	0.0	0.0	859,169.34	1,468,635.48	39.011450	-107.369736
300.0	0.00	0.00	300.0	0.0	0.0	859,169.34	1,468,635.48	39.011450	-107.369736
400.0	0.00	0.00	400.0	0.0	0.0	859,169.34	1,468,635.48	39.011450	-107.369736
500.0	0.00	0.00	500.0	0.0	0.0	859,169.34	1,468,635.48	39.011450	-107.369736
600.0	0.00	0.00	600.0	0.0	0.0	859,169.34	1,468,635.48	39.011450	-107.369736
700.0	0.00	0.00	700.0	0.0	0.0	859,169.34	1,468,635.48	39.011450	-107.369736
756.7	0.00	0.00	756.7	0.0	0.0	859,169.34	1,468,635.48	39.011450	-107.369736
KOP @ 756.7'									
800.0	3.47	203.79	800.0	-1.2	-0.5	859,168.16	1,468,634.93	39.011447	-107.369738
850.0	7.47	203.79	849.7	-5.6	-2.4	859,163.84	1,468,632.92	39.011435	-107.369745
900.0	11.47	203.79	899.0	-13.1	-5.8	859,156.38	1,468,629.45	39.011414	-107.369757
950.0	15.47	203.79	947.7	-23.7	-10.5	859,145.83	1,468,624.55	39.011385	-107.369773
1,000.0	19.47	203.79	995.3	-37.5	-16.5	859,132.22	1,468,618.22	39.011347	-107.369794
1,050.0	23.47	203.79	1,041.9	-54.2	-23.9	859,115.64	1,468,610.51	39.011301	-107.369820
1,100.0	27.47	203.79	1,087.0	-73.9	-32.6	859,096.15	1,468,601.44	39.011247	-107.369851
1,150.0	31.47	203.79	1,130.5	-96.4	-42.5	859,073.85	1,468,591.07	39.011185	-107.369886
1,200.0	35.47	203.79	1,172.2	-121.6	-53.6	859,048.85	1,468,579.45	39.011116	-107.369925
1,250.0	39.47	203.79	1,211.9	-149.4	-65.9	859,021.28	1,468,566.63	39.011040	-107.369968
1,300.0	43.47	203.79	1,249.4	-179.7	-79.2	858,991.27	1,468,552.67	39.010957	-107.370015
1,350.0	47.47	203.79	1,284.4	-212.3	-93.6	858,958.96	1,468,537.64	39.010867	-107.370066
1,400.0	51.47	203.79	1,316.9	-247.1	-108.9	858,924.51	1,468,521.62	39.010772	-107.370120
1,450.0	55.47	203.79	1,346.7	-283.8	-125.1	858,888.09	1,468,504.68	39.010671	-107.370177
1,500.0	59.47	203.79	1,373.6	-322.4	-142.1	858,849.87	1,468,486.91	39.010565	-107.370236
1,506.7	60.00	203.79	1,376.9	-327.7	-144.5	858,844.64	1,468,484.48	39.010550	-107.370245
EOB @ Inc. = 60°									
1,600.0	60.00	203.79	1,423.6	-401.6	-177.1	858,771.36	1,468,450.40	39.010347	-107.370359
1,700.0	60.00	203.79	1,473.6	-480.9	-212.0	858,692.83	1,468,413.88	39.010130	-107.370482
1,800.0	60.00	203.79	1,523.6	-560.1	-247.0	858,614.31	1,468,377.36	39.009912	-107.370605
1,900.0	60.00	203.79	1,573.6	-639.3	-281.9	858,535.78	1,468,340.84	39.009695	-107.370728
2,000.0	60.00	203.79	1,623.6	-718.6	-316.8	858,457.25	1,468,304.32	39.009477	-107.370851
2,100.0	60.00	203.79	1,673.6	-797.8	-351.8	858,378.73	1,468,267.80	39.009260	-107.370974
2,200.0	60.00	203.79	1,723.6	-877.1	-386.7	858,300.20	1,468,231.28	39.009042	-107.371097
2,300.0	60.00	203.79	1,773.6	-956.3	-421.7	858,221.67	1,468,194.76	39.008825	-107.371220
2,400.0	60.00	203.79	1,823.6	-1,035.5	-456.6	858,143.15	1,468,158.25	39.008607	-107.371343
2,500.0	60.00	203.79	1,873.6	-1,114.8	-491.5	858,064.62	1,468,121.73	39.008390	-107.371466
2,600.0	60.00	203.79	1,923.6	-1,194.0	-526.5	857,986.10	1,468,085.21	39.008172	-107.371589
2,700.0	60.00	203.79	1,973.6	-1,273.3	-561.4	857,907.57	1,468,048.69	39.007955	-107.371712
2,800.0	60.00	203.79	2,023.6	-1,352.5	-596.4	857,829.04	1,468,012.17	39.007737	-107.371834
2,900.0	60.00	203.79	2,073.6	-1,431.7	-631.3	857,750.52	1,467,975.65	39.007520	-107.371957
3,000.0	60.00	203.79	2,123.6	-1,511.0	-666.2	857,671.99	1,467,939.13	39.007302	-107.372080
3,100.0	60.00	203.79	2,173.6	-1,590.2	-701.2	857,593.47	1,467,902.61	39.007084	-107.372203
3,200.0	60.00	203.79	2,223.6	-1,669.5	-736.1	857,514.94	1,467,866.09	39.006867	-107.372326
3,300.0	60.00	203.79	2,273.6	-1,748.7	-771.1	857,436.41	1,467,829.58	39.006649	-107.372449
3,400.0	60.00	203.79	2,323.6	-1,828.0	-806.0	857,357.89	1,467,793.06	39.006432	-107.372572
3,500.0	60.00	203.79	2,373.6	-1,907.2	-840.9	857,279.36	1,467,756.54	39.006214	-107.372695
3,600.0	60.00	203.79	2,423.6	-1,986.4	-875.9	857,200.83	1,467,720.02	39.005997	-107.372818
3,700.0	60.00	203.79	2,473.6	-2,065.7	-910.8	857,122.31	1,467,683.50	39.005779	-107.372941
3,800.0	60.00	203.79	2,523.6	-2,144.9	-945.8	857,043.78	1,467,646.98	39.005562	-107.373064
3,900.0	60.00	203.79	2,573.6	-2,224.2	-980.7	856,965.26	1,467,610.46	39.005344	-107.373187
4,000.0	60.00	203.79	2,623.6	-2,303.4	-1,015.6	856,886.73	1,467,573.94	39.005127	-107.373309
4,100.0	60.00	203.79	2,673.6	-2,382.6	-1,050.6	856,808.20	1,467,537.42	39.004909	-107.373432
4,200.0	60.00	203.79	2,723.6	-2,461.9	-1,085.5	856,729.68	1,467,500.90	39.004692	-107.373555

Cathedral Energy Services

Planning Report - Geographic

Database:	USA EDM 5000 Multi Users DB	Local Co-ordinate Reference:	Well DGU 18-43 CS#2
Company:	Gunnison Energy Corporation	TVD Reference:	KB=20' @ 7321.0ft
Project:	Gunnison County, CO	MD Reference:	KB=20' @ 7321.0ft
Site:	Deadman Gulch Unit	North Reference:	True
Well:	DGU 18-43 CS#2	Survey Calculation Method:	Minimum Curvature
Wellbore:	OH		
Design:	Plan #3		

Planned Survey										
Measured Depth (ft)	Inclination (°)	Azimuth (°)	Vertical Depth (ft)	+N/-S (ft)	+E/-W (ft)	Map Northing (ft)	Map Easting (ft)	Latitude	Longitude	
4,300.0	60.00	203.79	2,773.6	-2,541.1	-1,120.5	856,651.15	1,467,464.39	39.004474	-107.373678	
4,400.0	60.00	203.79	2,823.6	-2,620.4	-1,155.4	856,572.62	1,467,427.87	39.004257	-107.373801	
4,500.0	60.00	203.79	2,873.6	-2,699.6	-1,190.3	856,494.10	1,467,391.35	39.004039	-107.373924	
4,600.0	60.00	203.79	2,923.6	-2,778.9	-1,225.3	856,415.57	1,467,354.83	39.003821	-107.374047	
4,700.0	60.00	203.79	2,973.6	-2,858.1	-1,260.2	856,337.05	1,467,318.31	39.003604	-107.374170	
4,800.0	60.00	203.79	3,023.6	-2,937.3	-1,295.2	856,258.52	1,467,281.79	39.003386	-107.374293	
4,900.0	60.00	203.79	3,073.6	-3,016.6	-1,330.1	856,179.99	1,467,245.27	39.003169	-107.374416	
4,968.8	60.00	203.79	3,108.0	-3,071.1	-1,354.1	856,125.94	1,467,220.14	39.003019	-107.374500	
TD @ 4,968.8' MD										

Design Targets										
Target Name	Dip Angle (°)	Dip Dir. (°)	TVD (ft)	+N/-S (ft)	+E/-W (ft)	Northing (ft)	Easting (ft)	Latitude	Longitude	
- hit/miss target										
- Shape										
DGU 18-43 CS#2 P3	0.00	358.85	3,108.0	-3,071.1	-1,354.1	856,125.94	1,467,220.14	39.003019	-107.374500	
- plan hits target center										
- Point										

Plan Annotations					
Measured Depth (ft)	Vertical Depth (ft)	Local Coordinates			
		+N/-S (ft)	+E/-W (ft)	Comment	
756.7	756.7	0.0	0.0	KOP @ 756.7'	
1,506.7	1,376.9	-327.7	-144.5	EOB @ Inc. = 60°	
4,968.8	3,108.0	-3,071.1	-1,354.1	TD @ 4,968.8' MD	