

Kerr 36C-25HZ

Lease Descriptions

****Lease(s) along wellbore where it is presumed the heel will land:**

Lease #: CO-000011071/001

Lands: Township 2 North, Range 66 West, 6th P.M.

Section 18: All that portion of Lot 8 out of the S/2SW/4, according to Map of Division No. 1 of The Lupton Meadows Land Company, recorded in Book 5 of Maps, Page 13, lying West of the center line of the South Platte River.

Section 19: That portion of the W/2NE/4 described as follows:
Beginning at the Northwest corner of the SW/4NE/4 of said Section 19; thence North 89°11' East 300 feet; thence South 10°30' West 1353.2 feet; Thence West 50 feet; thence North 0°19' West 1313.2 feet to the point of beginning.

Section 30: That portion of the NW/4 being all of Lots 1 and 2, excepting from said Lot 2 a strip of land 9.78 rods in width off the East portion thereof, according to Division No. 3 Map as filed by The Lupton Meadows Land Company in Book 5 of Maps, Page 1, also excepting 4.89 acres in the Northeast corner of Lot 2, said 4.89 acres being more fully described as Parcels A thru E in deed recorded in Book 616, Reception No. 1538431 of Weld County Records.

Township 2 North, Range 67 West, 6th P.M.

Section 14: S/2SW/4

Section 24: That portion of the NE/4 being Lots 7, 11, and 12, except 4.66 acres off the extreme North end of said Lot 11, according to Division No. 3 Map as filed by The Lupton Meadows Land Company in Book 5 of Maps at Page 1.

Section 25: That portion of NE/4 being Lots 1, 2, and 3, according to Division No. 3 Map as filed by The Lupton Meadows Land Company in Book 5 of Maps, at Page 1.

Containing 374.45 acres, m/l

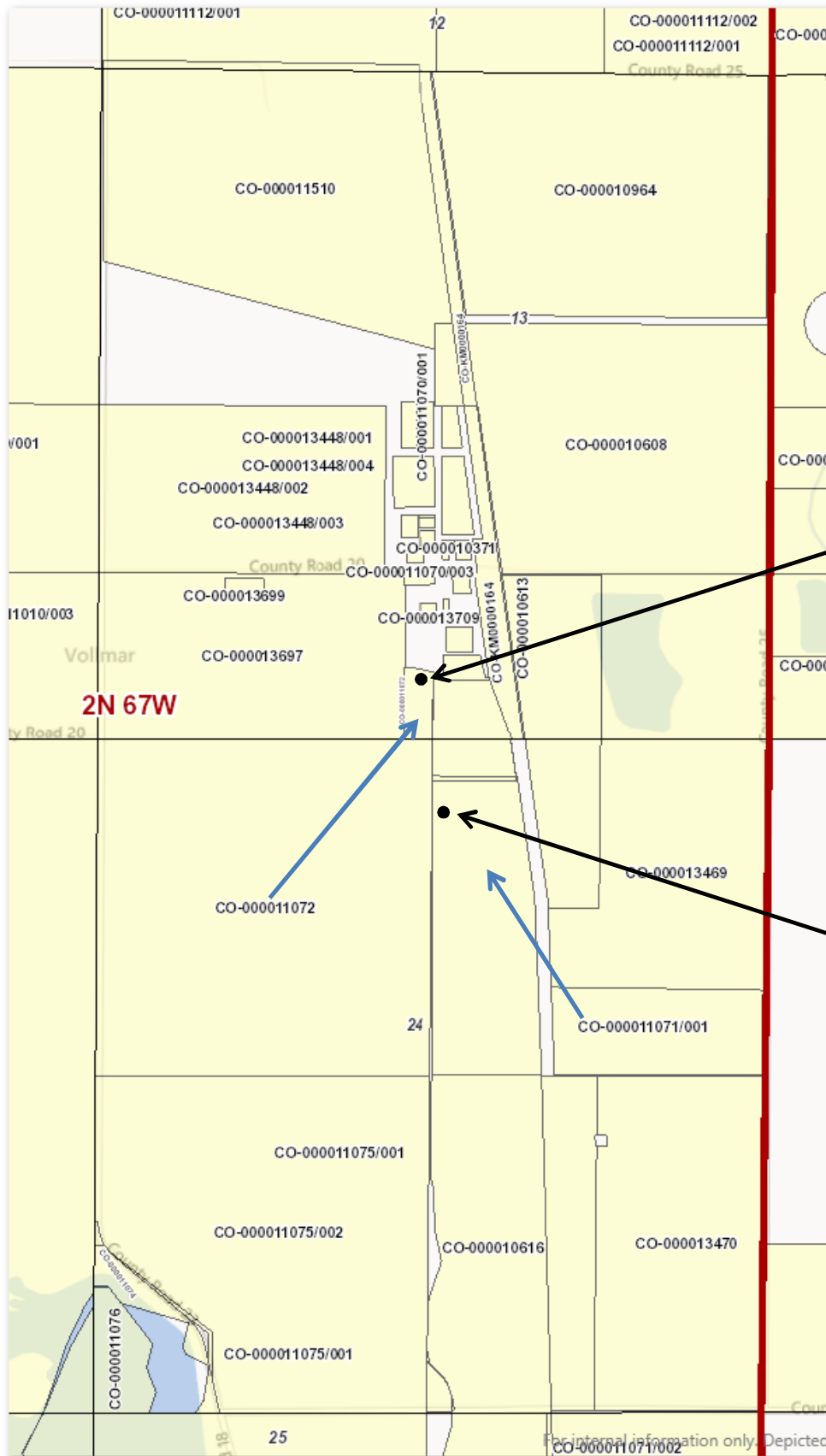

Approx. heel location of the Kerr 28N-12HZ

Approx. heel location of the Kerr 36C-25HZ