

STATE OF COLORADO  
DIVISION OF WATER RESOURCES  
OFFICE OF THE STATE ENGINEER

Index No. 145  
IDWD 7-31  
Completion use  
Yield \_\_\_\_\_  
Checked By \_\_\_\_\_

## MAP AND STATEMENT FOR WATER WELL FILING

PERMIT NUMBER **46826**

STATE OF COLORADO ) SS

CLAIMANT (s) Marian Worford

being duly sworn upon oath deposes and says that he (they) is (are) the owner (s) of the well described hereon; the total number of acres

of land irrigated from this well is domestic; work was commenced on this well by actual construction on theSummer day of \_\_\_\_\_ 1922 the sustainedyield from said well is 10 gpm, for which claim is hereby madefor domestic purpose (s);

the average annual amount to be diverted is \_\_\_\_\_ acre-feet; this map and statement is filed in compliance with law; he (they) has (have) read the statements made hereon; knows the content thereof; and that the same are true of his (their) own knowledge.

Signature (s) Marian WorfordAddress: Route 1Ignacio, Colorado 81137Subscribed and sworn to before me on this 3 dayof June, 1971My Commission expires: 1-15-1974

(Seal)

T. W. Van Den Berg  
Notary Public

## WELL DATA

Date Completed Summer 1922Static Water Level 12 ftTotal Depth of Well 18 ft.

## WELL LOCATION

La Plata CountySE  $\frac{1}{4}$  of NE  $\frac{1}{4}$ , sec. 10T. 33 N. R. 8 W. N.M., P.M.

## INDICATE WELL LOCATION ON DIAGRAM

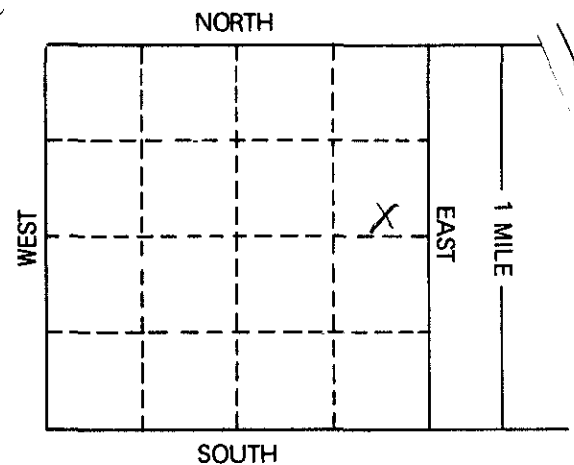

WELL SHALL BE LOCATED WITH REFERENCE TO GOVERNMENT SURVEY CORNERS OR MONUMENTS, OR SECTION LINES BY DISTANCE AND BEARING.

\_\_\_\_\_ ft. from \_\_\_\_\_ section line.  
(North or South)\_\_\_\_\_ ft. from \_\_\_\_\_ section line.  
(East or West)on east bank of Rio Grande  
Ground Water Basin \_\_\_\_\_Water Management  
District \_\_\_\_\_

Domestic wells may be located by the following:

LOT \_\_\_\_\_, BLOCK \_\_\_\_\_

SUBDIVISION \_\_\_\_\_

FILING # \_\_\_\_\_

ACCEPTED FOR FILING IN THE OFFICE OF THE STATE ENGINEER OF COLORADO ON THIS 22 DAYOF June, 1971.

STATE ENGINEER

NO. GW 12416

FORM TO BE MADE OUT IN QUADRUPLICATE: WHITE FORM must be an original copy on both sides and signed. WHITE AND GREEN copies must be filed with the State Engineer within 30 days after the well is completed or within 7 days after expiration date of the permit, whichever is sooner; PINK COPY is for the Owner and YELLOW COPY is for the Driller.

From	To	Type & Color of Material	Water Loc.

Use additional paper if necessary to complete log.

Type Drilling by hand & bucket

\_\_\_\_\_ in.      from \_\_\_\_\_ ft.      to \_\_\_\_\_ ft.  
 \_\_\_\_\_ in.      from \_\_\_\_\_ ft.      to \_\_\_\_\_ ft.  
 \_\_\_\_\_ in.      from \_\_\_\_\_ ft.      to \_\_\_\_\_ ft.

Size Rocked <sup>Plain Casing</sup> up 42 in. <sup>1</sup>ft. to    ft.

Size\_\_\_\_, kind\_\_\_\_\_from\_\_\_\_\_ft. to\_\_\_\_\_ft.

Size\_\_\_\_, kind\_\_\_\_\_from\_\_\_\_\_ft. to\_\_\_\_\_ft.

## Placement Method \_\_\_\_\_

## Size \_\_\_\_\_ Interval \_\_\_\_\_

Drawdown \_\_\_\_\_

The undersigned, being duly sworn, deposes and says: he is the driller of the well hereon described; he has read the statement made hereon; knows the content thereof, and the same is true of his own knowledge.

License No. \_\_\_\_\_

Subscribed and sworn to before me this \_\_\_\_\_ day of \_\_\_\_\_, 19\_\_\_\_

My Commission expires \_\_\_\_\_, 19\_\_\_\_.

Notary Public