

Physical Address: 345 Comanche St.
Mail to: Box 384, Kiowa, CO 80117
Ph. 303-621-8672 - Fax 303-621-7749
www.highprairiesurvey.com

Job: 08246-Aloha Mula #4 (Re-Entry)

Inv # 2917

High Prairie Surveying of Kiowa, Colorado has in accordance with a request from **Wiepking Fullerton Energy** has determined the location of **Aloha Mula #4 (Re-Entry)** to be **670 feet FSL**, and **730 feet FWL**, (90° off Section lines) of SECTION **19**, Township **10s**, Range **55w** of the 6th Principal Meridian, **Lincoln County**, Colorado.

Date: Staked on 12/30/2013 drawn on 12/30/2013

Re: Staked by Elijah Frane

Drawn: Drawn by Dustin Cotter

1000' Hydrology Map

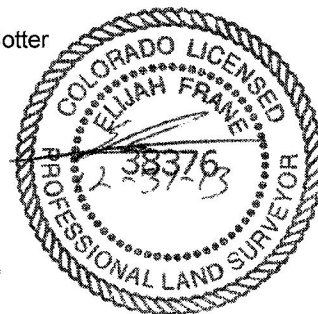

There is an area of indicated surface water approx. 931' Southeast of proposed well pad.

Wiepking Fullerton
SW1/4 Sec. 19-10s-55w
Aloha Mula #4 (Re-Entry)
Lincoln, Co., Colorado

