



Physical Address: 345 Comanche St.  
Mail to: Box 384, Kiowa, CO 80117  
Ph. 303-621-8672 - Fax 303-621-7749  
www.highprairiesurvey.com

Job # 13171 Big Wampum #3

Inv # 2877

High Prairie Surveying of Kiowa, Colorado, in accordance with a request from **Wiepking Fullerton**, has determined the location of **Big Wampum #3** to be **760 feet FNL**, and **660 feet FEL**, (90° off Section lines) of **SECTION 23**, Township **10s**, Range **56w** of the 6th Principal Meridian, **Lincoln County**, Colorado.

**Date:** Staked on 12/16/2013 drawn on 12/17/2013.

**Re:** Staked by Elijah Frane

**Drawn:** Drawn by Dustin Cotter

**Basis of Elevation Spot:** USGS BM = E 25, PID = KJ0219, H-Order = First, V-Order = First, Station ID = 1.90, Sats = 8 US NAD 83 CO-C, Lat. = 39.21461, Long. = W103.60209 = 5248.17 gr. (us FT)

**Notes:** See Location Drawing for improvements.

The ground elevation at staked location = 5328.89' gr.

This drawing does not represent a monumented survey or Land Survey Plat.

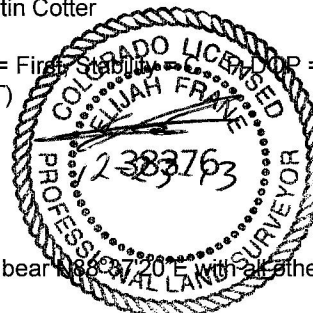

**Basis of Bearing:** Bearings were determined based on the North line of Section 23 to bear N88°37'20"E with all other bearings contained herein relative thereto.

