

State of Colorado
Oil and Gas Conservation Commission

1120 Lincoln Street, Suite 801, Denver, Colorado 80203 (303)894-2100 Fax: (303)894-2109



FOR OGCC USE ONLY

RECEIVED
12/19/2013

SPILL/RELEASE REPORT

This form is to be submitted by the party responsible for the oil and gas spill or release. Any spill or release which may impact waters of the State must be reported as soon as practicable; any spill over 20 bbls must be reported within 24 hours and all spills over five bbls must be reported within ten days. Submit a Site Investigation and Remediation Workplan (Form 27) when requested by the Director.

Spill report taken by:

FACILITY ID:

OPERATOR INFORMATION

Name of Operator: <u>Whiting Oil and Gas Corporation</u>	OGCC Operator No: <u>96155</u>	Phone Numbers
Address: <u>1700 Broadway, Suite 2300</u>		No: <u>(303) 518-6254</u>
City: <u>Denver</u>	State: <u>CO</u> Zip: <u>80290</u>	Fax: <u>(303) 390-1324</u>
Contact Person: <u>Joseph Houghton</u>		E-Mail: <u>joseph.houghton@whiting.com</u>

DESCRIPTION OF SPILL OR RELEASE

Date of Incident: <u>12/17/2013</u>	Facility Name & No.: <u>Horsetail #16-1610B Well Pad (433159)</u>	County: <u>Weld #123</u>
Type of Facility (well, tank battery, flow line, pit): <u>Well</u>		QtrQtr: <u>NW/NE</u> Section: <u>16</u>
Well Name and Number: <u>Horsetail #16-1610B</u>		Township: <u>10N</u> Range: <u>57W</u>
API Number: <u>05-123-37508</u>		Meridian: <u>6PM</u>

Specify volume spilled and recovered (in bbls) for the following materials:

Oil spilled: 7 Oil recov'd: 2 Water spilled: 3 Water recov'd: 1 Other spilled: 0 Other recov'd: 0

Ground Water impacted? ☐ Yes ☒ No

Surface Water impacted? ☐ Yes ☒ No

Contained within berm? ☒ Yes ☐ No

Area and vertical extent of spill: 50' x 75' x up to 4" deep

Current land use: Wellpad Weather conditions: sunny and dry

Soil/geology description: Compacted fill dirt associated with well pad

IF LESS THAN A MILE, report distance IN FEET to nearest.... Surface water: 1600 ft wetlands: > 1 mile buildings: > 1 mile

Livestock: water wells: > 1 mile Depth to shallowest ground water:

Cause of spill (e.g., equipment failure, human error, etc.): human error Detailed description of the spill/release incident:

The pumper shut the flowline valve but failed to isolate the entire wellhead by closing all wellhead valves. This resulted in the jet pump surface equipment pressuring up from the well. The low pressure hose between the power fluid vessel and the triplex pump ruptured.

CORRECTIVE ACTION

Describe immediate response (how stopped, contained and recovered):

The wellhead valves were shut. The released liquids were contained within the site-wide perimeter berm. 20 percent of the oil/water mix was recovered by a vac truck. The impacted soil is currently being excavated and will be placed on a tarp on location.

Describe any emergency pits constructed:

Excavated soil was set on a tarp on location.

How was the extent of contamination determined:

Visual

Further remediation activities proposed (attach separate sheet if needed):

None, unless needed.

Describe measures taken to prevent problem from reoccurring:

The pumper has been trained on the proper procedure for shutting down a jet pump and isolating the wellhead valves.

OTHER NOTIFICATIONS

List the parties and agencies notified (County, BLM, EPA, DOT, Local Emergency Planning Coordinator or other).

Date	Agency	Contact	Phone	Response

Spill/Release Tracking No: 2147274

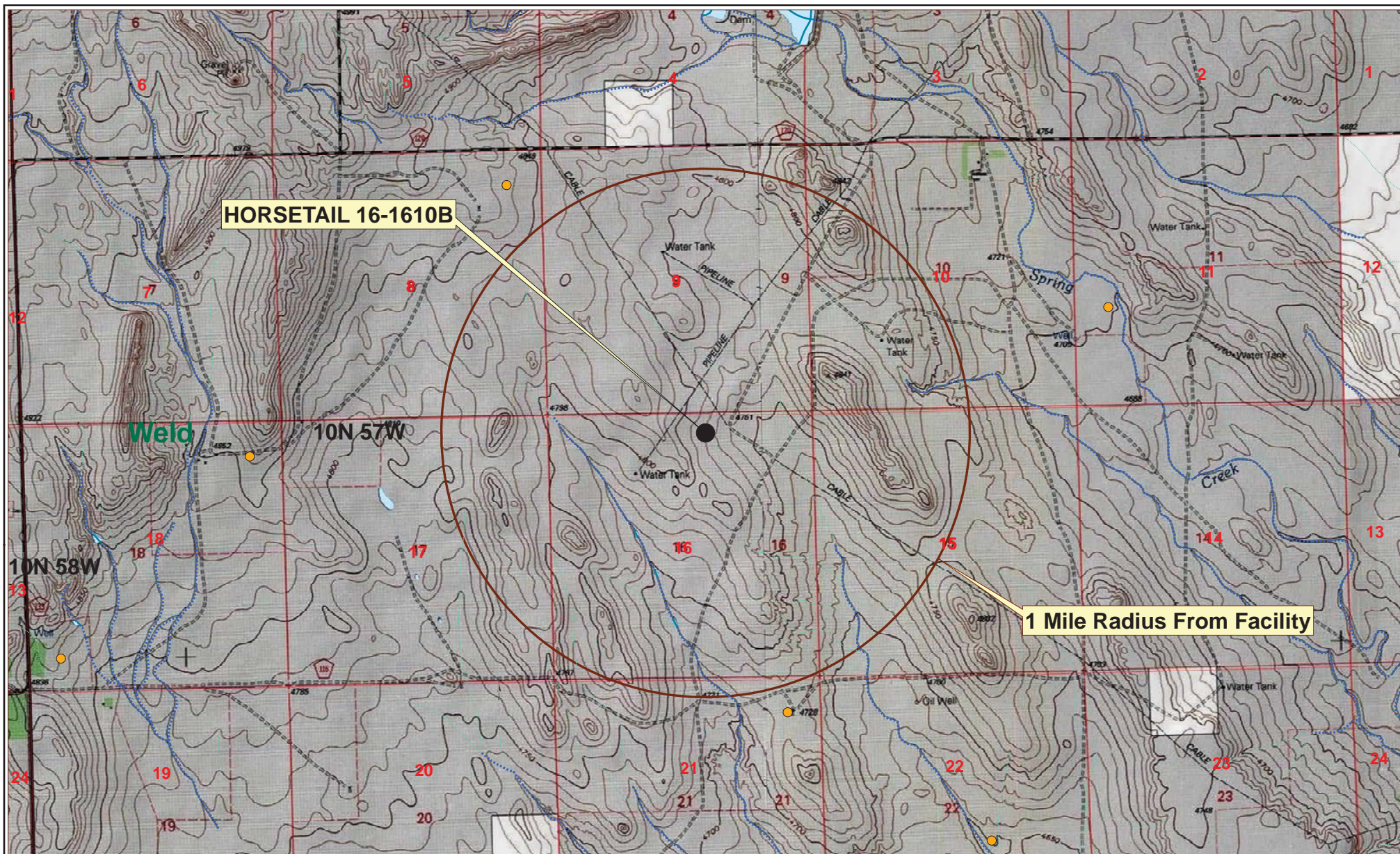

Legend

- HORSETAIL 16-1610B
- Water Well
- 1 Mile Radius From Facility
- USA Sections
- USA Townships
- USA Counties
- Estuary
- Ice Mass
- Lake/Pond
- Playa
- Reservoir
- Swamp/Marsh
- Artificial Path
- Canal Ditch
- Connector
- Pipeline
- Stream/River
- Stream/River: Ephemeral
- Stream/River: Intermittent
- Stream/River: Perennial
- Underground Conduit
- Limited Access
- Highway
- Major Road

Figure 1: Release Site Location Map
HORSETAIL 16-1610B
Terrace South Field
Weld County, CO
NW1/4 of NE1/4 Section 16 T10N R57W
Latitude: 40.845272 Longitude: -103.754508
Review 0

0 0.4 0.8 1.6 Miles

Date: 12/18/2013



Whiting Oil and Gas Corporation
 NHD Flowline and Waterbody source data
 Coordinate System: NAD 1983 UTM Zone 13N