

**Geologist Information**  
 General: New location, 9 new wells  
 Ownership: Private Surface, Fed Minerals  
 SUA Status: Have SUA  
 Spacing Units: 640 acre MV

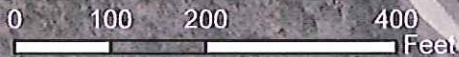
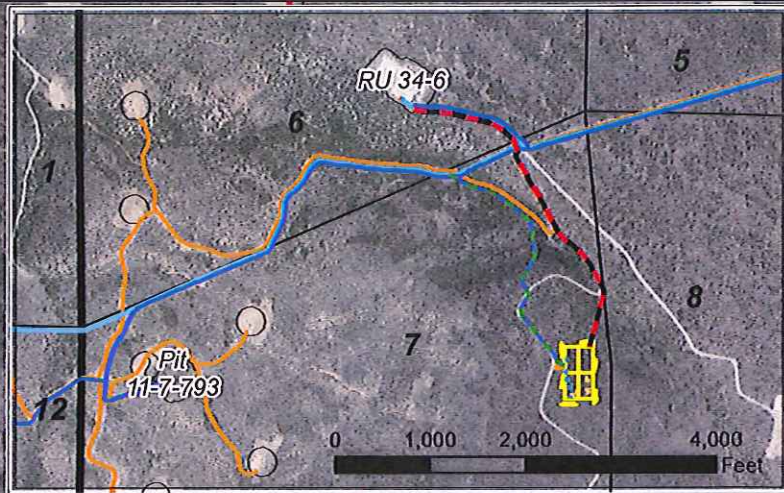

YOUBERG  
BEAVER  
CREEK RANCH

7S 93W

BAUER,  
GEORGE R

**Plan of Development**

Access: New access  
 Drilling: Efficiency Rig  
 Cuttings: Cuttings will be managed on surface.  
 SIMOPS: Yes  
 Completions: Completions will frac from the RU 34-6 pad. 3-4.5" surface frac lines will run from the RU 42-7 pad to the RU 34-6 pad. Water will be stored in the RU 11-7 frac pit. Water supply lines already exist.  
 Flowback: From RU 34-6  
 Production: Production equipment to be place on the southwest edge of the pad.  
 Pipeline: A new 8" buried gas, 6" buried water line & 6" buried completions water line will be installed from the pad to the tie-in in the main road.

**Legend**

- Temporary Surface Frac Lines
- Proposed 8" Gas & 2-6" Water
- Waterline
- Existing Frac Water Supply
- Parcel Ownership (from Garfield County)
- Proposed Road
- Proposed Cuttings Management Area
- Proposed Production Equipment Area
- Proposed Daylight Line
- Proposed Pad or Pit

WPX Energy Rocky Mountain, LLC

RU 42-7 Plan of Development  
 T7S R93W, Section 7

Date Prepared: December 3, 2013

