

Location:	COLORADO	Slot:	SLOT#15 GRIFFITHS 35C-20HZ (465'FNL & 1787'FWL, SEC.17)
Field:	WELD COUNTY (KERR MCGEE)	Well:	GRIFFITHS 35C-20HZ
Facility:	SEC.17-T1N-R67W	Wellbore:	GRIFFITHS 35C-20HZ PWB

True vertical depths are referenced to H&P 307 (RKB)	Grid System: NAD83 / Lambert Colorado SP, Northern Zone (501), US feet
Measured depths are referenced to H&P 307 (RKB)	North Reference: True north
H&P 307 (RKB) to Mean Sea Level: 5081 feet	Scale: True distance
Mean Sea Level to Mud line (At Slot: SLOT#15 GRIFFITHS 35C-20HZ (465FNL & 1787FWL, SEC. 17)): 0 feet	Depths are in feet
Coordinates are in feet referenced to Slot	Created by: robalo01 on 14/Oct/2013

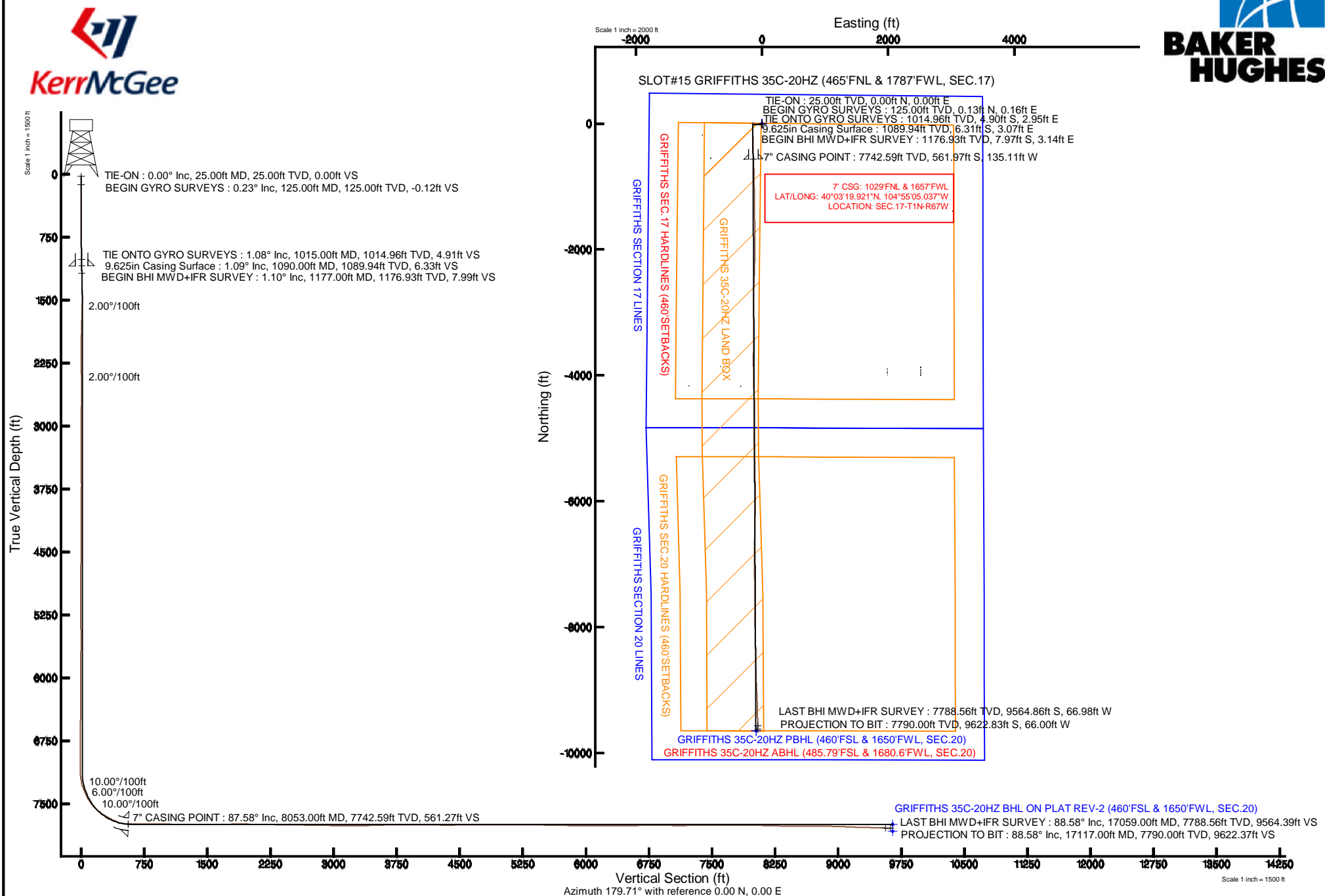

### REFERENCE WELLPATH IDENTIFICATION

Operator	KERR-MCGEE OIL & GAS ONSHORE LP	Slot	SLOT#15 GRIFFITHS 35C-20HZ (465'FNL & 1787'FWL, SEC.17)
Area	COLORADO	Well	GRIFFITHS 35C-20HZ
Field	WELD COUNTY (KERR MCGEE)	Wellbore	GRIFFITHS 35C-20HZ AWB
Facility	SEC.17-T1N-R67W		

### REPORT SETUP INFORMATION

Projection System	NAD83 / Lambert Colorado SP, Northern Zone (501), US feet	Software System	WellArchitect® 4.0.0
North Reference	True	User	Robiale01
Scale	0.999963	Report Generated	14/Oct/2013 at 12:07
Convergence at slot	n/a	Database/Source file	WA_ANADARKO/GRIFFITHS_35C-20HZ_AWB.xml

### WELLPATH LOCATION

	Local coordinates		Grid coordinates		Geographic coordinates	
	North[ft]	East[ft]	Easting[US ft]	Northing[US ft]	Latitude	Longitude
Slot Location	2190.13	-846.84	3163028.47	1264173.62	40°03'25.474"N	104°55'03.299"W
Facility Reference Pt			3163889.72	1261989.21	40°03'03.831"N	104°54'52.408"W
Field Reference Pt			3197771.84	1268891.29	40°04'09.600"N	104°47'36.000"W

### WELLPATH DATUM

Calculation method	Minimum curvature	H&P 307 (RKB) to Facility Vertical Datum	5081.00ft
Horizontal Reference Pt	Slot	H&P 307 (RKB) to Mean Sea Level	5081.00ft
Vertical Reference Pt	H&P 307 (RKB)	H&P 307 (RKB) to Mud Line at Slot (SLOT#15 GRIFFITHS 35C-20HZ (465'FNL & 1787'FWL, SEC.17))	5081.00ft
MD Reference Pt	H&P 307 (RKB)	Section Origin	N 0.00, E 0.00 ft
Field Vertical Reference	Mean Sea Level	Section Azimuth	180.39°

# Actual Wellpath Report

## GRIFFITHS 35C-20HZ AWP

Page 2 of 7

### REFERENCE WELLPATH IDENTIFICATION

Operator	KERR-MCGEE OIL & GAS ONSHORE LP	Slot	SLOT#15 GRIFFITHS 35C-20HZ (465'FNL & 1787'FWL, SEC.1'
Area	COLORADO	Well	GRIFFITHS 35C-20HZ
Field	WELD COUNTY (KERR MCGEE)	Wellbore	GRIFFITHS 35C-20HZ AWB
Facility	SEC.17-T1N-R67W		

### WELLPATH DATA (169 stations) † = interpolated/extrapolated station

MD [ft]	Inclination [°]	Azimuth [°]	TVD [ft]	Vert Sect [ft]	North [ft]	East [ft]	Latitude	Longitude	DLS [°/100ft]	Comments
0.00†	0.000	51.350	0.00	0.00	0.00	0.00	40°03'25.474"N	104°55'03.299"W	0.00	
25.00	0.000	51.350	25.00	0.00	0.00	0.00	40°03'25.474"N	104°55'03.299"W	0.00	TIE-ON
125.00	0.230	51.350	125.00	-0.13	0.13	0.16	40°03'25.475"N	104°55'03.297"W	0.23	BEGIN GYRO SURVEYS
225.00	0.160	159.850	225.00	-0.12	0.12	0.36	40°03'25.475"N	104°55'03.294"W	0.32	
325.00	0.080	254.870	325.00	0.03	-0.03	0.34	40°03'25.474"N	104°55'03.295"W	0.19	
425.00	0.130	253.410	425.00	0.08	-0.08	0.17	40°03'25.473"N	104°55'03.297"W	0.05	
525.00	0.230	128.800	525.00	0.24	-0.24	0.21	40°03'25.472"N	104°55'03.296"W	0.32	
625.00	0.540	100.340	625.00	0.44	-0.45	0.83	40°03'25.470"N	104°55'03.288"W	0.36	
725.00	0.270	137.200	724.99	0.70	-0.71	1.46	40°03'25.467"N	104°55'03.280"W	0.36	
825.00	0.840	150.090	824.99	1.50	-1.51	1.98	40°03'25.459"N	104°55'03.273"W	0.58	
925.00	1.190	164.930	924.97	3.13	-3.15	2.62	40°03'25.443"N	104°55'03.265"W	0.43	
1015.00	1.080	174.220	1014.96	4.88	-4.90	2.95	40°03'25.426"N	104°55'03.261"W	0.24	TIE ONTO GYRO SURVEYS
1177.00	1.100	178.390	1176.93	7.95	-7.97	3.14	40°03'25.395"N	104°55'03.259"W	0.05	BEGIN BHI MWD+IFR SURVEY
1270.00	1.300	189.640	1269.91	9.88	-9.90	2.99	40°03'25.376"N	104°55'03.261"W	0.33	
1364.00	2.390	233.450	1363.86	12.11	-12.12	1.24	40°03'25.354"N	104°55'03.283"W	1.82	
1458.00	2.720	276.170	1457.77	13.07	-13.05	-2.55	40°03'25.345"N	104°55'03.332"W	2.01	
1551.00	4.720	277.560	1550.57	12.37	-12.31	-8.54	40°03'25.352"N	104°55'03.409"W	2.15	
1644.00	6.690	285.470	1643.11	10.48	-10.36	-17.56	40°03'25.372"N	104°55'03.525"W	2.28	
1738.00	8.040	283.030	1736.33	7.62	-7.42	-29.24	40°03'25.401"N	104°55'03.675"W	1.47	
1831.00	9.460	281.700	1828.25	4.70	-4.40	-43.06	40°03'25.430"N	104°55'03.853"W	1.54	
1925.00	8.790	272.000	1921.06	2.98	-2.59	-57.80	40°03'25.448"N	104°55'04.042"W	1.78	
2019.00	8.800	270.590	2013.96	2.76	-2.26	-72.17	40°03'25.452"N	104°55'04.227"W	0.23	
2114.00	8.750	269.530	2107.85	2.84	-2.25	-86.66	40°03'25.452"N	104°55'04.413"W	0.18	
2208.00	8.260	270.680	2200.81	2.91	-2.22	-100.56	40°03'25.452"N	104°55'04.592"W	0.55	
2303.00	7.080	267.510	2294.96	3.17	-2.40	-113.24	40°03'25.450"N	104°55'04.755"W	1.32	
2397.00	5.720	265.290	2388.37	3.88	-3.03	-123.69	40°03'25.444"N	104°55'04.890"W	1.47	
2491.00	4.200	269.530	2482.02	4.35	-3.45	-131.80	40°03'25.440"N	104°55'04.994"W	1.66	
2586.00	2.640	273.880	2576.85	4.27	-3.33	-137.47	40°03'25.441"N	104°55'05.067"W	1.66	
2680.00	1.880	255.840	2670.77	4.53	-3.56	-141.12	40°03'25.439"N	104°55'05.114"W	1.10	
2775.00	1.210	322.910	2765.75	4.12	-3.14	-143.24	40°03'25.443"N	104°55'05.141"W	1.89	
2869.00	1.120	330.390	2859.73	2.54	-1.55	-144.29	40°03'25.459"N	104°55'05.155"W	0.19	
2964.00	0.470	245.250	2954.72	1.90	-0.90	-145.10	40°03'25.465"N	104°55'05.165"W	1.24	
3247.00	0.330	254.050	3237.71	2.62	-1.61	-146.94	40°03'25.458"N	104°55'05.189"W	0.05	
3531.00	0.770	244.730	3521.70	3.68	-2.65	-149.45	40°03'25.448"N	104°55'05.221"W	0.16	
3813.00	0.770	283.360	3803.68	4.07	-3.02	-153.01	40°03'25.444"N	104°55'05.267"W	0.18	
3907.00	0.760	0.840	3897.67	3.31	-2.25	-153.61	40°03'25.452"N	104°55'05.275"W	1.02	
4001.00	0.790	6.280	3991.66	2.04	-0.99	-153.53	40°03'25.464"N	104°55'05.273"W	0.08	
4096.00	0.580	70.980	4086.65	1.23	-0.18	-153.01	40°03'25.472"N	104°55'05.267"W	0.79	
4378.00	0.440	91.730	4368.64	0.78	0.25	-150.58	40°03'25.476"N	104°55'05.235"W	0.08	
4661.00	0.910	318.380	4651.63	-0.86	1.90	-150.98	40°03'25.493"N	104°55'05.241"W	0.44	
4755.00	0.910	55.510	4745.63	-1.85	2.88	-150.86	40°03'25.502"N	104°55'05.239"W	1.45	
4850.00	0.280	66.780	4840.62	-2.37	3.40	-150.03	40°03'25.508"N	104°55'05.228"W	0.67	
5133.00	0.410	133.150	5123.62	-1.96	2.98	-148.65	40°03'25.503"N	104°55'05.211"W	0.14	
5416.00	0.370	116.070	5406.61	-0.88	1.89	-147.09	40°03'25.493"N	104°55'05.191"W	0.04	
5699.00	0.340	63.430	5689.60	-0.86	1.86	-145.52	40°03'25.492"N	104°55'05.170"W	0.11	

### REFERENCE WELLPATH IDENTIFICATION

Operator	KERR-MCGEE OIL & GAS ONSHORE LP	Slot	SLOT#15 GRIFFITHS 35C-20HZ (465'FNL & 1787'FWL, SEC.1'
Area	COLORADO	Well	GRIFFITHS 35C-20HZ
Field	WELD COUNTY (KERR MCGEE)	Wellbore	GRIFFITHS 35C-20HZ AWB
Facility	SEC.17-T1N-R67W		

### WELLPATH DATA (169 stations) † = interpolated/extrapolated station

MD [ft]	Inclination [°]	Azimuth [°]	TVD [ft]	Vert Sect [ft]	North [ft]	East [ft]	Latitude	Longitude	DLS [°/100ft]	Comments
5982.00	0.400	54.990	5972.60	-1.81	2.80	-143.96	40°03'25.502"N	104°55'05.150"W	0.03	
6265.00	0.440	344.990	6255.59	-3.43	4.42	-143.43	40°03'25.518"N	104°55'05.144"W	0.17	
6548.00	0.790	26.180	6538.58	-6.24	7.22	-142.86	40°03'25.545"N	104°55'05.136"W	0.19	
6831.00	0.190	1.310	6821.57	-8.46	9.44	-141.98	40°03'25.567"N	104°55'05.125"W	0.22	
7113.00	0.410	234.490	7103.56	-8.34	9.32	-142.79	40°03'25.566"N	104°55'05.135"W	0.19	
7160.00	3.430	193.690	7150.53	-6.87	7.86	-143.26	40°03'25.552"N	104°55'05.141"W	6.66	
7208.00	8.220	188.020	7198.27	-2.07	3.06	-144.08	40°03'25.504"N	104°55'05.152"W	10.04	
7255.00	12.990	184.770	7244.46	6.53	-5.54	-144.99	40°03'25.419"N	104°55'05.164"W	10.22	
7302.00	17.580	183.250	7289.78	18.89	-17.89	-145.83	40°03'25.297"N	104°55'05.174"W	9.80	
7349.00	20.780	184.020	7334.17	34.31	-33.30	-146.82	40°03'25.145"N	104°55'05.187"W	6.83	
7396.00	24.450	181.090	7377.55	52.36	-51.35	-147.59	40°03'24.967"N	104°55'05.197"W	8.17	
7445.00	27.790	178.960	7421.54	73.93	-72.92	-147.58	40°03'24.753"N	104°55'05.197"W	7.08	
7491.00	31.510	178.140	7461.51	96.67	-95.66	-146.99	40°03'24.529"N	104°55'05.189"W	8.13	
7538.00	36.690	177.670	7500.41	122.98	-121.98	-146.02	40°03'24.269"N	104°55'05.177"W	11.04	
7585.00	43.240	177.920	7536.42	153.12	-152.13	-144.86	40°03'23.971"N	104°55'05.162"W	13.94	
7632.00	49.960	178.530	7568.69	187.23	-186.25	-143.82	40°03'23.633"N	104°55'05.149"W	14.33	
7679.00	52.900	177.900	7597.99	223.94	-222.97	-142.67	40°03'23.271"N	104°55'05.134"W	6.34	
7726.00	55.690	177.820	7625.42	262.07	-261.11	-141.24	40°03'22.894"N	104°55'05.115"W	5.94	
7773.00	59.060	177.920	7650.75	301.61	-300.66	-139.77	40°03'22.503"N	104°55'05.097"W	7.17	
7820.00	62.060	178.490	7673.85	342.50	-341.56	-138.49	40°03'22.099"N	104°55'05.080"W	6.47	
7868.00	64.970	179.260	7695.26	385.45	-384.51	-137.65	40°03'21.674"N	104°55'05.069"W	6.23	
7915.00	68.850	179.880	7713.69	428.67	-427.74	-137.33	40°03'21.247"N	104°55'05.065"W	8.34	
7962.00	74.250	179.410	7728.55	473.23	-472.30	-137.05	40°03'20.807"N	104°55'05.062"W	11.53	
8009.00	81.160	178.540	7738.56	519.11	-518.19	-136.23	40°03'20.353"N	104°55'05.051"W	14.81	
8030.00	84.950	178.640	7741.10	539.94	-539.03	-135.72	40°03'20.147"N	104°55'05.044"W	18.05	
8053.00†	87.581	178.334	7742.59	562.88	-561.97	-135.11	40°03'19.921"N	104°55'05.037"W	11.51	7" CASING POINT
8094.00	92.270	177.790	7742.65	603.83	-602.93	-133.72	40°03'19.516"N	104°55'05.019"W	11.51	
8157.00	91.660	178.020	7740.49	666.74	-665.85	-131.42	40°03'18.894"N	104°55'04.989"W	1.03	
8251.00	90.030	178.640	7739.10	760.66	-759.80	-128.68	40°03'17.965"N	104°55'04.954"W	1.86	
8346.00	89.530	179.210	7739.47	855.63	-854.78	-126.90	40°03'17.027"N	104°55'04.931"W	0.80	
8440.00	88.520	178.250	7741.06	949.57	-948.74	-124.82	40°03'16.098"N	104°55'04.904"W	1.48	
8534.00	88.920	178.900	7743.16	1043.50	-1042.69	-122.48	40°03'15.170"N	104°55'04.874"W	0.81	
8628.00	89.690	180.000	7744.30	1137.48	-1136.67	-121.58	40°03'14.241"N	104°55'04.862"W	1.43	
8723.00	89.590	180.010	7744.90	1232.48	-1231.67	-121.59	40°03'13.302"N	104°55'04.863"W	0.11	
8817.00	89.320	178.490	7745.80	1326.45	-1325.66	-120.36	40°03'12.374"N	104°55'04.847"W	1.64	
8912.00	89.940	179.410	7746.41	1421.42	-1420.64	-118.62	40°03'11.435"N	104°55'04.824"W	1.17	
9006.00	90.180	178.430	7746.31	1515.39	-1514.62	-116.84	40°03'10.506"N	104°55'04.802"W	1.07	
9100.00	90.310	179.440	7745.91	1609.35	-1608.60	-115.10	40°03'09.577"N	104°55'04.779"W	1.08	
9194.00	91.010	179.260	7744.83	1703.33	-1702.59	-114.03	40°03'08.649"N	104°55'04.765"W	0.77	
9289.00	90.740	179.560	7743.38	1798.31	-1797.57	-113.05	40°03'07.710"N	104°55'04.753"W	0.42	
9383.00	89.970	179.930	7742.79	1892.30	-1891.57	-112.63	40°03'06.781"N	104°55'04.747"W	0.91	
9477.00	89.320	180.490	7743.38	1986.29	-1985.57	-112.98	40°03'05.852"N	104°55'04.752"W	0.91	
9572.00	89.050	180.450	7744.73	2081.28	-2080.55	-113.76	40°03'04.914"N	104°55'04.762"W	0.29	
9666.00	88.950	181.890	7746.37	2175.26	-2174.52	-115.68	40°03'03.985"N	104°55'04.787"W	1.54	
9760.00	89.320	181.500	7747.79	2269.22	-2268.46	-118.46	40°03'03.057"N	104°55'04.822"W	0.57	

### REFERENCE WELLPATH IDENTIFICATION

Operator	KERR-MCGEE OIL & GAS ONSHORE LP	Slot	SLOT#15 GRIFFITHS 35C-20HZ (465'FNL & 1787'FWL, SEC.1'
Area	COLORADO	Well	GRIFFITHS 35C-20HZ
Field	WELD COUNTY (KERR MCGEE)	Wellbore	GRIFFITHS 35C-20HZ AWB
Facility	SEC.17-T1N-R67W		

### WELLPATH DATA (169 stations)

MD [ft]	Inclination [°]	Azimuth [°]	TVD [ft]	Vert Sect [ft]	North [ft]	East [ft]	Latitude	Longitude	DLS [°/100ft]	Comments
9853.00	88.530	181.920	7749.53	2362.18	-2361.41	-121.23	40°03'02.138"N	104°55'04.858"W	0.96	
9949.00	89.780	182.350	7750.95	2458.12	-2457.33	-124.81	40°03'01.190"N	104°55'04.904"W	1.38	
10043.00	89.230	182.380	7751.76	2552.07	-2551.24	-128.69	40°03'00.262"N	104°55'04.954"W	0.59	
10137.00	88.820	180.970	7753.36	2646.03	-2645.19	-131.43	40°02'59.334"N	104°55'04.989"W	1.56	
10232.00	89.720	181.030	7754.57	2741.01	-2740.16	-133.09	40°02'58.395"N	104°55'05.010"W	0.95	
10326.00	89.690	179.760	7755.05	2835.01	-2834.16	-133.74	40°02'57.466"N	104°55'05.019"W	1.35	
10420.00	87.810	179.270	7757.10	2928.97	-2928.13	-132.94	40°02'56.538"N	104°55'05.009"W	2.07	
10515.00	88.360	179.390	7760.28	3023.90	-3023.07	-131.83	40°02'55.599"N	104°55'04.994"W	0.59	
10609.00	89.440	179.540	7762.08	3117.87	-3117.04	-130.96	40°02'54.671"N	104°55'04.983"W	1.16	
10703.00	90.300	180.530	7762.30	3211.87	-3211.04	-131.01	40°02'53.742"N	104°55'04.984"W	1.40	
10798.00	91.170	180.520	7761.08	3306.86	-3306.03	-131.88	40°02'52.803"N	104°55'04.995"W	0.92	
10892.00	91.200	180.370	7759.13	3400.84	-3400.01	-132.61	40°02'51.874"N	104°55'05.004"W	0.16	
10987.00	91.990	180.690	7756.49	3495.80	-3494.96	-133.49	40°02'50.936"N	104°55'05.016"W	0.90	
11081.00	91.720	181.770	7753.45	3589.74	-3588.89	-135.51	40°02'50.008"N	104°55'05.041"W	1.18	
11176.00	90.640	180.330	7751.49	3684.71	-3683.85	-137.25	40°02'49.069"N	104°55'05.064"W	1.89	
11271.00	90.210	179.790	7750.79	3779.70	-3778.85	-137.35	40°02'48.131"N	104°55'05.065"W	0.73	
11365.00	90.460	179.310	7750.24	3873.69	-3872.84	-136.61	40°02'47.202"N	104°55'05.056"W	0.58	
11460.00	90.060	178.890	7749.80	3968.66	-3967.83	-135.12	40°02'46.263"N	104°55'05.036"W	0.61	
11554.00	89.170	179.160	7750.44	4062.63	-4061.81	-133.52	40°02'45.334"N	104°55'05.016"W	0.99	
11649.00	89.160	178.470	7751.82	4157.59	-4156.78	-131.55	40°02'44.396"N	104°55'04.991"W	0.73	
11744.00	89.100	179.200	7753.26	4252.54	-4251.75	-129.62	40°02'43.457"N	104°55'04.966"W	0.77	
11838.00	89.880	179.660	7754.10	4346.52	-4345.74	-128.69	40°02'42.528"N	104°55'04.954"W	0.96	
11933.00	90.920	180.470	7753.44	4441.52	-4440.74	-128.80	40°02'41.590"N	104°55'04.955"W	1.39	
12027.00	90.490	179.920	7752.28	4535.51	-4534.73	-129.12	40°02'40.661"N	104°55'04.959"W	0.74	
12122.00	90.680	179.620	7751.31	4630.50	-4629.72	-128.73	40°02'39.722"N	104°55'04.954"W	0.37	
12217.00	91.200	179.380	7749.75	4725.47	-4724.71	-127.91	40°02'38.783"N	104°55'04.944"W	0.60	
12311.00	89.420	179.460	7749.24	4819.45	-4818.70	-126.95	40°02'37.855"N	104°55'04.931"W	1.90	
12406.00	89.200	178.920	7750.39	4914.43	-4913.68	-125.61	40°02'36.916"N	104°55'04.914"W	0.61	
12501.00	90.450	179.860	7750.68	5009.41	-5008.67	-124.60	40°02'35.977"N	104°55'04.901"W	1.65	
12590.00	91.070	179.060	7749.50	5098.39	-5097.66	-123.76	40°02'35.098"N	104°55'04.890"W	1.14	
12685.00	89.570	177.900	7748.97	5193.33	-5192.62	-121.24	40°02'34.159"N	104°55'04.858"W	2.00	
12779.00	88.860	178.600	7750.25	5287.25	-5286.57	-118.37	40°02'33.231"N	104°55'04.821"W	1.06	
12874.00	89.320	177.550	7751.76	5382.16	-5381.50	-115.18	40°02'32.293"N	104°55'04.780"W	1.21	
12968.00	89.070	179.800	7753.08	5476.10	-5475.46	-113.01	40°02'31.364"N	104°55'04.752"W	2.41	
13063.00	89.530	178.880	7754.24	5571.08	-5570.44	-111.91	40°02'30.426"N	104°55'04.738"W	1.08	
13158.00	88.450	179.060	7755.92	5666.03	-5665.41	-110.21	40°02'29.487"N	104°55'04.716"W	1.15	
13252.00	88.890	179.150	7758.10	5759.99	-5759.37	-108.74	40°02'28.559"N	104°55'04.697"W	0.48	
13347.00	89.290	178.250	7759.61	5854.93	-5854.34	-106.58	40°02'27.620"N	104°55'04.669"W	1.04	
13442.00	89.010	179.030	7761.02	5949.87	-5949.30	-104.33	40°02'26.682"N	104°55'04.640"W	0.87	
13536.00	89.190	180.570	7762.50	6043.86	-6043.28	-104.00	40°02'25.753"N	104°55'04.636"W	1.65	
13631.00	90.400	181.890	7762.83	6138.84	-6138.26	-106.04	40°02'24.814"N	104°55'04.662"W	1.88	
13725.00	90.950	182.380	7761.73	6232.79	-6232.19	-109.54	40°02'23.886"N	104°55'04.707"W	0.78	
13820.00	90.550	181.320	7760.48	6327.75	-6327.13	-112.61	40°02'22.948"N	104°55'04.747"W	1.19	
13915.00	90.330	181.160	7759.75	6422.74	-6422.10	-114.66	40°02'22.009"N	104°55'04.773"W	0.29	
13972.00	90.870	180.350	7759.16	6479.73	-6479.09	-115.41	40°02'21.446"N	104°55'04.783"W	1.71	



# Actual Wellpath Report

GRIFFITHS 35C-20HZ AWP

Page 5 of 7

## REFERENCE WELLPATH IDENTIFICATION

Operator	KERR-MCGEE OIL & GAS ONSHORE LP	Slot	SLOT#15 GRIFFITHS 35C-20HZ (465'FNL & 1787'FWL, SEC.1
Area	COLORADO	Well	GRIFFITHS 35C-20HZ
Field	WELD COUNTY (KERR MCGEE)	Wellbore	GRIFFITHS 35C-20HZ AWB
Facility	SEC.17-T1N-R67W		

## WELLPATH DATA (169 stations)

MD [ft]	Inclination [°]	Azimuth [°]	TVD [ft]	Vert Sect [ft]	North [ft]	East [ft]	Latitude	Longitude	DLS [°/100ft]	Comments
14066.00	89.880	180.750	7758.54	6573.73	-6573.08	-116.32	40°02'20.517"N	104°55'04.794"W	1.14	
14161.00	90.580	180.880	7758.16	6668.72	-6668.07	-117.67	40°02'19.579"N	104°55'04.812"W	0.75	
14256.00	89.750	180.740	7757.89	6763.72	-6763.06	-119.01	40°02'18.640"N	104°55'04.829"W	0.89	
14350.00	90.340	180.460	7757.81	6857.72	-6857.06	-120.00	40°02'17.711"N	104°55'04.842"W	0.69	
14445.00	89.510	179.180	7757.94	6952.71	-6952.05	-119.70	40°02'16.772"N	104°55'04.838"W	1.61	
14539.00	89.570	179.950	7758.69	7046.70	-7046.05	-118.98	40°02'15.843"N	104°55'04.829"W	0.82	
14610.00	90.030	179.200	7758.94	7117.69	-7117.04	-118.46	40°02'15.142"N	104°55'04.822"W	1.24	
14704.00	90.890	179.270	7758.19	7211.67	-7211.03	-117.20	40°02'14.213"N	104°55'04.806"W	0.92	
14799.00	90.150	179.090	7757.32	7306.64	-7306.02	-115.84	40°02'13.274"N	104°55'04.788"W	0.80	
14894.00	89.350	179.480	7757.74	7401.62	-7401.01	-114.66	40°02'12.335"N	104°55'04.773"W	0.94	
14988.00	90.700	179.980	7757.70	7495.61	-7495.00	-114.21	40°02'11.407"N	104°55'04.767"W	1.53	
15083.00	90.180	179.600	7756.97	7590.60	-7590.00	-113.87	40°02'10.468"N	104°55'04.763"W	0.68	
15177.00	90.120	180.150	7756.72	7684.60	-7684.00	-113.66	40°02'09.539"N	104°55'04.760"W	0.59	
15272.00	89.230	179.210	7757.26	7779.59	-7779.00	-113.13	40°02'08.600"N	104°55'04.753"W	1.36	
15367.00	90.000	179.760	7757.90	7874.57	-7873.99	-112.28	40°02'07.661"N	104°55'04.742"W	1.00	
15461.00	89.780	178.680	7758.08	7968.55	-7967.98	-111.00	40°02'06.733"N	104°55'04.726"W	1.17	
15555.00	90.000	179.220	7758.26	8062.52	-8061.96	-109.27	40°02'05.804"N	104°55'04.704"W	0.62	
15650.00	88.060	178.650	7759.87	8157.47	-8156.93	-107.51	40°02'04.865"N	104°55'04.681"W	2.13	
15744.00	88.800	178.850	7762.44	8251.40	-8250.87	-105.46	40°02'03.937"N	104°55'04.655"W	0.82	
15839.00	89.290	178.640	7764.03	8346.34	-8345.83	-103.38	40°02'02.999"N	104°55'04.628"W	0.56	
15933.00	89.930	178.870	7764.67	8440.30	-8439.81	-101.34	40°02'02.070"N	104°55'04.602"W	0.72	
16028.00	89.810	178.670	7764.88	8535.26	-8534.78	-99.30	40°02'01.131"N	104°55'04.576"W	0.25	
16122.00	89.870	178.370	7765.14	8629.21	-8628.75	-96.87	40°02'00.203"N	104°55'04.544"W	0.33	
16217.00	90.090	178.880	7765.18	8724.17	-8723.73	-94.59	40°01'59.264"N	104°55'04.515"W	0.58	
16311.00	88.650	178.180	7766.21	8818.11	-8817.69	-92.18	40°01'58.336"N	104°55'04.484"W	1.70	
16405.00	88.710	178.220	7768.38	8912.02	-8911.61	-89.23	40°01'57.407"N	104°55'04.446"W	0.08	
16500.00	88.410	176.870	7770.76	9006.87	-9006.49	-85.16	40°01'56.470"N	104°55'04.394"W	1.46	
16594.00	87.580	177.140	7774.05	9100.64	-9100.31	-80.25	40°01'55.543"N	104°55'04.331"W	0.93	
16688.00	87.470	177.890	7778.11	9194.44	-9194.13	-76.18	40°01'54.615"N	104°55'04.278"W	0.81	
16782.00	88.760	178.710	7781.20	9288.32	-9288.04	-73.39	40°01'53.687"N	104°55'04.242"W	1.63	
16877.00	88.730	178.810	7783.28	9383.26	-9382.99	-71.34	40°01'52.749"N	104°55'04.216"W	0.11	
16971.00	88.020	178.340	7785.95	9477.17	-9476.92	-69.00	40°01'51.821"N	104°55'04.186"W	0.91	
17059.00	88.580	179.030	7788.56	9565.09	-9564.86	-66.98	40°01'50.952"N	104°55'04.160"W	1.01	LAST BHI MWD+IFR SURVEY
17117.00	88.580	179.030	7790.00	9623.06	-9622.83	-66.00	40°01'50.379"N	104°55'04.147"W	0.00	PROJECTION TO BIT

### REFERENCE WELLPATH IDENTIFICATION

Operator	KERR-MCGEE OIL & GAS ONSHORE LP	Slot	SLOT#15 GRIFFITHS 35C-20HZ (465'FNL & 1787'FWL, SEC.1
Area	COLORADO	Well	GRIFFITHS 35C-20HZ
Field	WELD COUNTY (KERR MCGEE)	Wellbore	GRIFFITHS 35C-20HZ AWP
Facility	SEC.17-T1N-R67W		

### HOLE & CASING SECTIONS - Ref Wellbore: GRIFFITHS 35C-20HZ AWP Ref Wellpath: GRIFFITHS 35C-20HZ AWP

String/Diameter	Start MD [ft]	End MD [ft]	Interval [ft]	Start TVD [ft]	End TVD [ft]	Start N/S [ft]	Start E/W [ft]	End N/S [ft]	End E/W [ft]
13.5in Open Hole	25.00	1090.00	1065.00	25.00	1089.94	0.00	0.00	-6.31	3.07
9.625in Casing Surface	25.00	1090.00	1065.00	25.00	1089.94	0.00	0.00	-6.31	3.07
8.75in Open Hole	1090.00	8079.00	6989.00	1089.94	7743.02	-6.31	3.07	-587.95	-134.28
7in Casing Intermediate	25.00	8053.00	8028.00	25.00	7742.59	0.00	0.00	-561.97	-135.11
6.125in Open Hole	8079.00	17117.00	9038.00	7743.02	7790.00	-587.95	-134.28	-9622.83	-66.00

### TARGETS

Name	MD [ft]	TVD [ft]	North [ft]	East [ft]	Grid East [US ft]	Grid North [US ft]	Latitude	Longitude	Shape
GRIFFITHS SECTION 17 LINES		0.00	0.00	0.00	3163028.47	1264173.61	40°03'25.474"N	104°55'03.299"W	polygon
GRIFFITHS SECTION 20 LINES		0.00	0.00	0.00	3163028.47	1264173.61	40°03'25.474"N	104°55'03.299"W	polygon
GRIFFITHS 35C-20HZ BHL ON PLAT REV-1 (460'FSL & 1650'FWL, SEC.20)		7828.00	-9648.62	-96.60	3162995.25	1254524.95	40°01'50.124"N	104°55'04.541"W	point
GRIFFITHS 35C-20HZ LAND BOX		7850.00	0.00	0.00	3163028.47	1264173.61	40°03'25.474"N	104°55'03.299"W	polygon
GRIFFITHS SEC.17 HARDLINES (460'SETBACKS)		7900.00	0.00	0.00	3163028.47	1264173.61	40°03'25.474"N	104°55'03.299"W	polygon
GRIFFITHS SEC.20 HARDLINES (460'SETBACKS)		7900.00	0.00	0.00	3163028.47	1264173.61	40°03'25.474"N	104°55'03.299"W	polygon

### WELLPATH COMPOSITION - Ref Wellbore: GRIFFITHS 35C-20HZ AWP Ref Wellpath: GRIFFITHS 35C-20HZ AWP

Start MD [ft]	End MD [ft]	Positional Uncertainty Model	Log Name/Comment	Wellbore
25.00	1015.00	Generic gyro - continuous (Standard)	MS GYRODATA SURVEYS <125-1015>	GRIFFITHS 35C-20HZ AWP
1015.00	8030.00	NaviTrak (MAGCORR,IFR)	BHI NAVITRAK MWD+IFR 8 3/4" <1177-8030>	GRIFFITHS 35C-20HZ AWP
8030.00	17059.00	OnTrak (MAGCORR,IFR)	BHI ONTRAK MWD+IFR 6 1/8" <8094-17059>	GRIFFITHS 35C-20HZ AWP
17059.00	17117.00	Blind Drilling (std)	Projection to bit	GRIFFITHS 35C-20HZ AWP

## REFERENCE WELLPATH IDENTIFICATION

Operator	KERR-MCGEE OIL & GAS ONSHORE LP	Slot	SLOT#15 GRIFFITHS 35C-20HZ (465'FNL & 1787'FWL, SEC.1'
Area	COLORADO	Well	GRIFFITHS 35C-20HZ
Field	WELD COUNTY (KERR MCGEE)	Wellbore	GRIFFITHS 35C-20HZ AWB
Facility	SEC.17-T1N-R67W		

## WELLPATH COMMENTS

MD [ft]	Inclination [°]	Azimuth [°]	TVD [ft]	Comment
25.00	0.000	51.350	25.00	TIE-ON
125.00	0.230	51.350	125.00	BEGIN GYRO SURVEYS
1015.00	1.080	174.220	1014.96	TIE ONTO GYRO SURVEYS
1177.00	1.100	178.390	1176.93	BEGIN BHI MWD+IFR SURVEY
8053.00	87.581	178.334	7742.59	7" CASING POINT
17059.00	88.580	179.030	7788.56	LAST BHI MWD+IFR SURVEY
17117.00	88.580	179.030	7790.00	PROJECTION TO BIT