



WHITING OIL & GAS CORP.

LOCATION DRAWING FOR

HORSETAIL #29G-2009A, #29G-2010B, #29G-2011A, #29G-2012B,
#29G-3209A, #29G-3210B, #29G-3211A & #29G-3212B
SECTION 29, T10N, R57W, 6th P.M.
SW 1/4 NE 1/4

SCALE: 1" = 300'
DATE: 08-08-13
DRAWN BY: A.D.

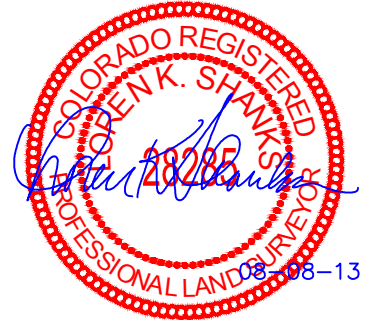

500' Offset
from Edge of
Disturbance

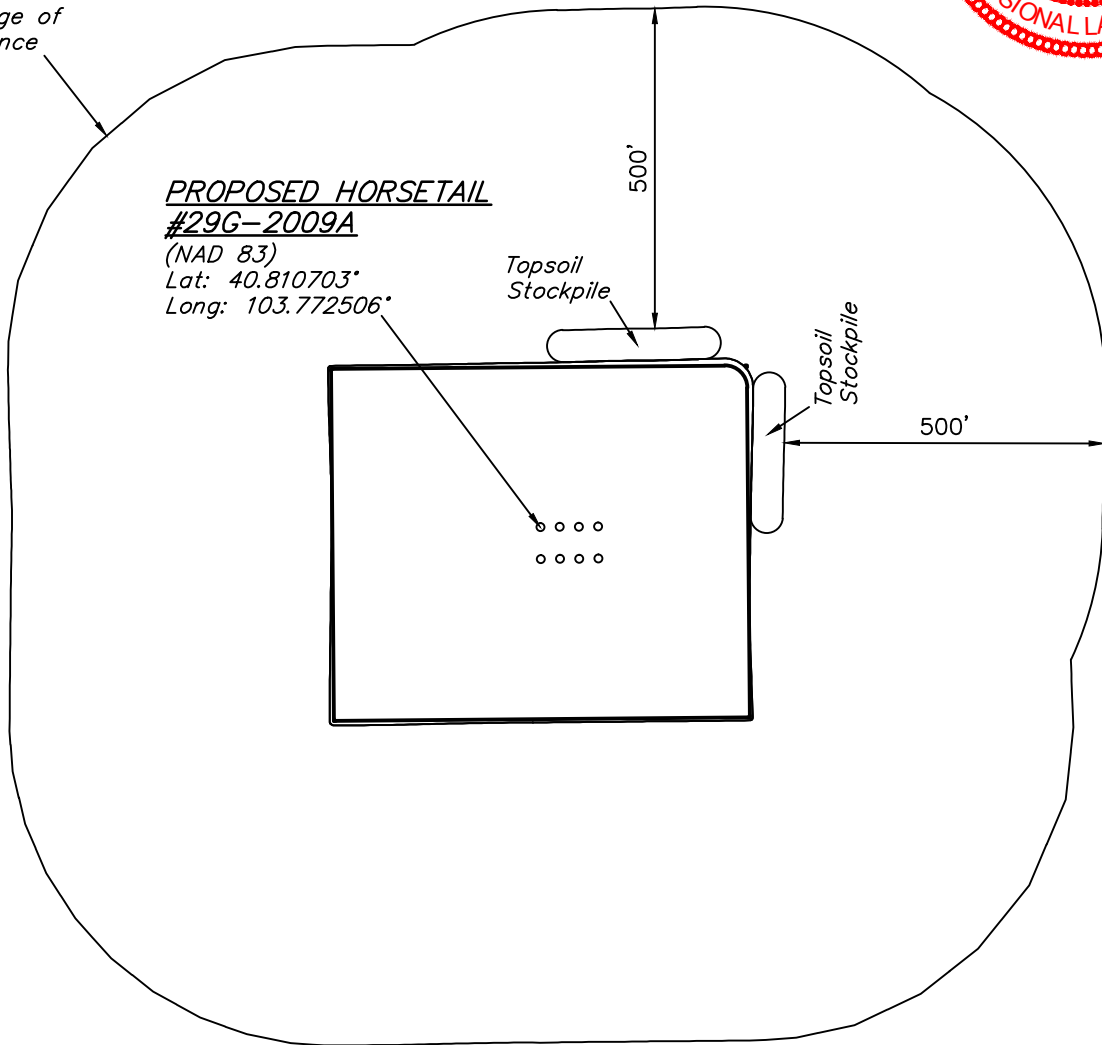

NOTE:
THERE ARE NO EXISTING
IMPROVEMENTS WITHIN 500' OF
THE PROPOSED DISTURBANCE