

WHITING OIL & GAS CORP.

LOCATION DRAWING FOR

HORSETAIL #29F-2005A, #29F-2006B, #29F-2007A, #29F-2008B,
#29F-3205A, #29F-3206B, #29F-3207A & #29F-3208B
SECTION 29, T10N, R57W, 6th P.M.
SE 1/4 NW 1/4

SCALE: 1" = 200'
DATE: 06-29-12
DRAWN BY: H.K.W.
REVISED: 11-27-12
REV: 08-06-13 B.D.H.



500' Offset
from Edge of
Disturbance

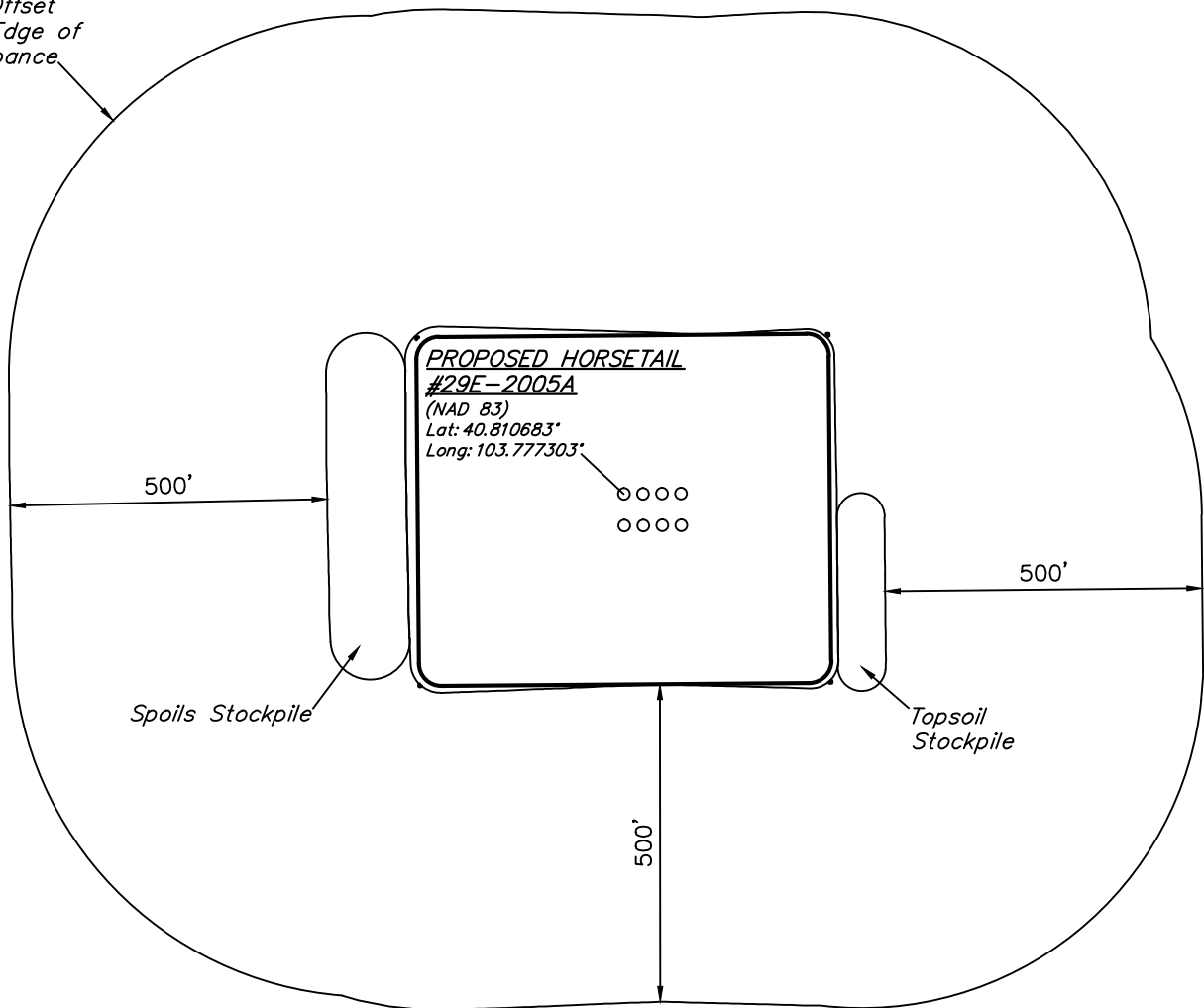

NOTE:
THERE ARE NO EXISTING
IMPROVEMENTS WITHIN 500' OF
THE PROPOSED DISTURBANCE