



WHITING OIL & GAS CORP.

LOCATION DRAWING FOR

HORSETAIL #30F-1948, #30F-1947, #30F-1946, #30F-1945,

#30F-1944, #30F-1943, #30F-1942 & #30F-1941

SECTION 30, T10N, R57W, 6th P.M.

SE 1/4 NW 1/4

SCALE: 1" = 300'

DATE SURVEYED: 10-14-13

SURVEYED BY: DAVE SWANSON

DATE DRAWN: 10-25-13

DRAWN BY: J.S.

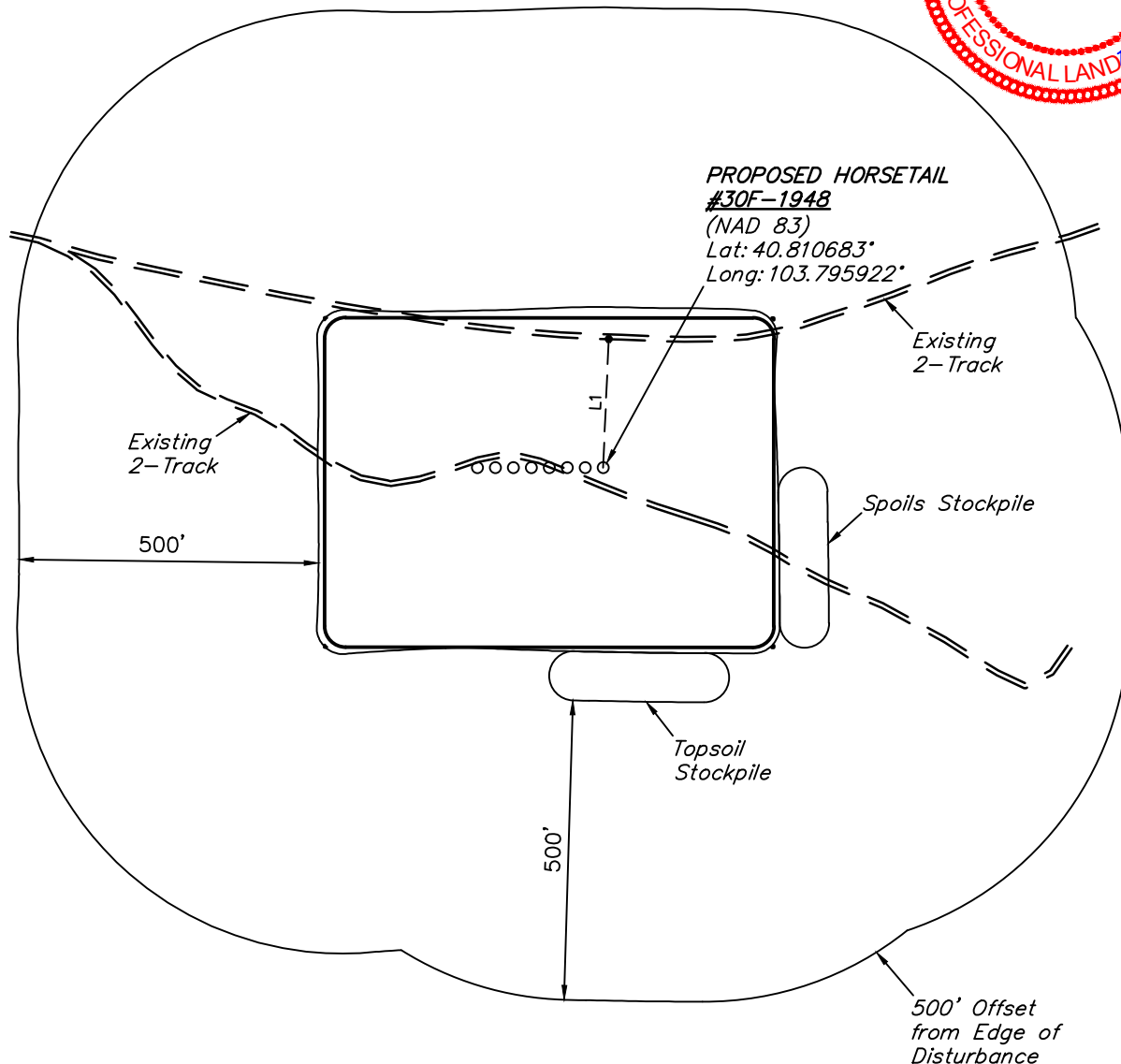

LINE TABLE		
LINE	DIRECTION	LENGTH
L1	N03°E	215'