



Lat40°, Inc. 1635 Foxtrail Drive, Suite 325 Loveland, CO 970-776-3321

# CUT & FILL DIAGRAM

MERRITT 6-66-9 PAD

SECTION: 9  
TOWNSHIP: 6N  
RANGE: 66W

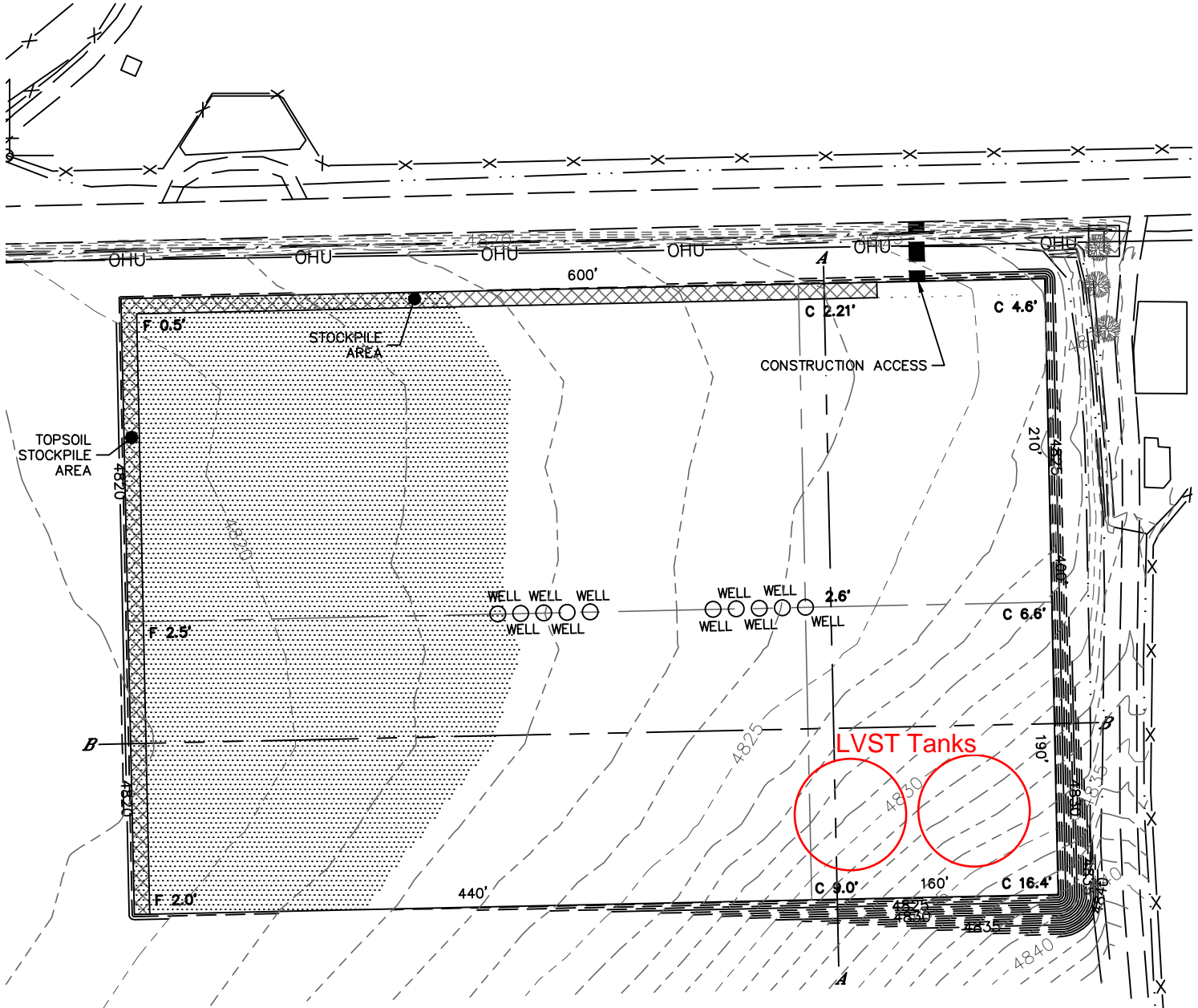

**OPERATOR: BILL BARRETT CORP**  
**LOCATION: 260' FNL, 1955' FEL**  
**EXISTING ELEV=4824.3'**  
**PROPOSED ELEV=4821.7'**  
**DISTURBANCE= 5.8 ACRES**

**ESTIMATED EARTHWORK:**  
**TOPSOIL= 9,422 CY**  
**CUT= 19,984 CY**  
**FILL= 4,342 CY**  
**STOCKPILE:**  
**EXCESS= 15,642 CY**

**NOTE:**

- 1) Ground elevations are based on an observed GPS elevation (NAVD 1988 DATUM).
- 2) No allowance has been made for soil expansion or compaction
- 3) Proposed elevation does not account for top soil removal.
- 4) Top soil volume assumes 12" depth across entire location.
- 5) Fill slopes 2:1
- 6) Cut slopes 1.5:1

**LEGEND**

EX. CONTOUR	---
PRO. CONTOUR	---
FILL AREA	

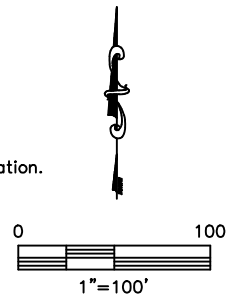

DATE: 6/13/2013  
 PROJECT#: 2012112