



Lat40°, Inc. 1635 Foxtrail Drive, Suite 325 Loveland, CO 970-776-3321

CUT & FILL DIAGRAM

ANTELOPE T-18 PAD

SECTION: 18
TOWNSHIP: 5N
RANGE: 62W

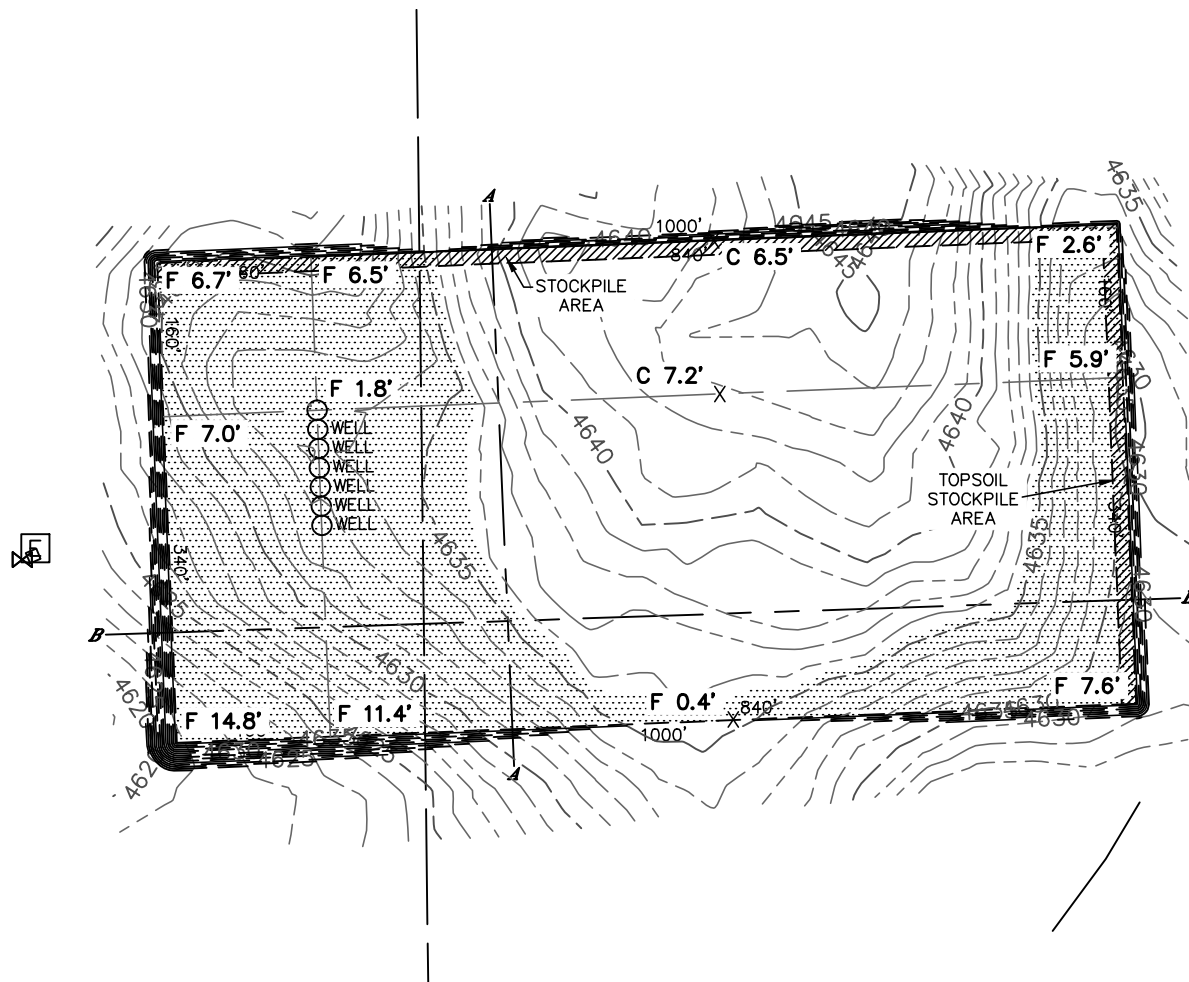

OPERATOR: BONANZA CREEK ENERGY, INC.

LOCATION: 650' FSL, 1397' FEL

EXISTING ELEV= 4633.9'

PROPOSED ELEV= 4635.7'

DISTURBANCE= 12.4 ACRES

ESTIMATED EARTHWORK:

TOPSOIL= 19,944 CY

CUT= 42,619 CY

FILL= 42,609 CY

STOCKPILE:

EXCESS= 10 CY

NOTE:

- 1) Ground elevations are based on an observed GPS elevation (NAVD 1988 DATUM).
- 2) No allowance has been made for soil expansion or compaction
- 3) Proposed elevation does not account for top soil removal.
- 4) Top soil volume assumes 12" depth across entire location.
- 5) Fill slopes 2:1
- 6) Cut slopes 1.5:1

LEGEND

EX. CONTOUR	---
PRO. CONTOUR	---
FILL AREA	

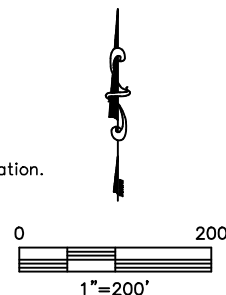

DATE: 10/8/2013
PROJECT#: 2012071



Lat40°, Inc. 1635 Foxtrail Drive, Suite 325 Loveland, CO 970-776-3321

CROSS SECTION DIAGRAM

ANTELOPE T-18 PAD

SECTION: 18
TOWNSHIP: 5N
RANGE: 62W

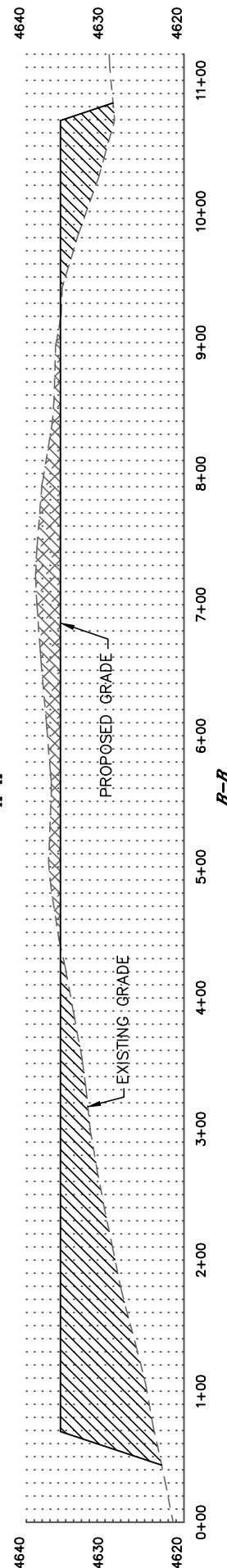
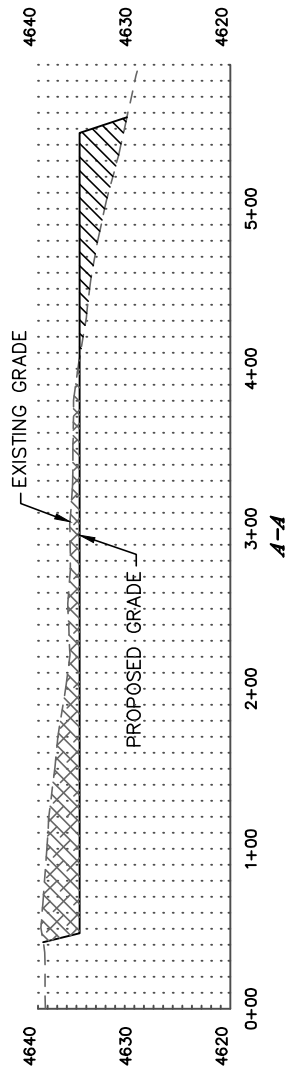

HORIZONTAL SCALE: 1"=120', VERTICAL SCALE: 1"=20'

DATE: 10/8/2013
PROJECT#: 2012071