

ConocoPhillips Company
CONSTRUCTION LAYOUT FOR
SUNSET #4-65 21-22 1H &
GRIMM MOTOCROSS #4-65 23-24 1H
SECTION 22, T4S, R65W, 6th P.M.
SE 1/4 SE 1/4

FIGURE #1
SCALE: 1" = 60'
DATE: 08-22-13
DRAWN BY: J.W.
REVISED: 08-28-13

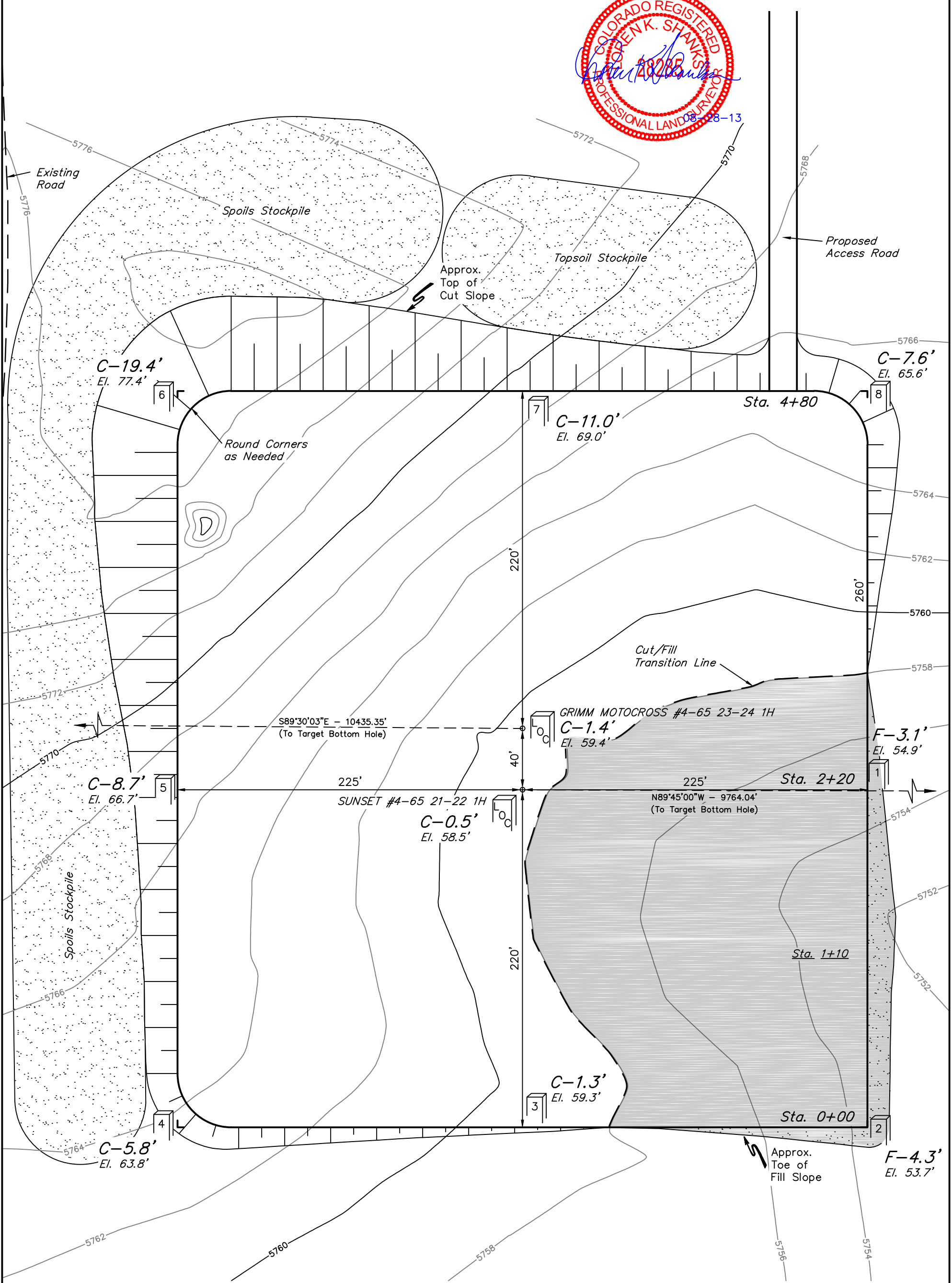
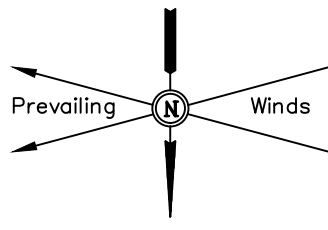

Elev. Ungraded Ground At SUNSET #4-65 21-22 1H Loc. Stake = 5758.5'
FINISHED GRADE ELEV. AT SUNSET #4-65 21-22 1H LOC. STAKE = 5758.0'

UINTAH ENGINEERING & LAND SURVEYING
85 So. 200 East * Vernal, Utah 84078 * (435) 789-1017

1" = 40'
X-Section
Scale
1" = 100'
DATE: 08-22-13
DRAWN BY: J.W.

ConocoPhillips Company
CONSTRUCTION LAYOUT CROSS SECTIONS FOR
SUNSET #4-65 21-22 1H &
GRIMM MOTOCROSS #4-65 23-24 1H
SECTION 22, T4S, R65W, 6th P.M.
SE 1/4 SE 1/4

FIGURE #2

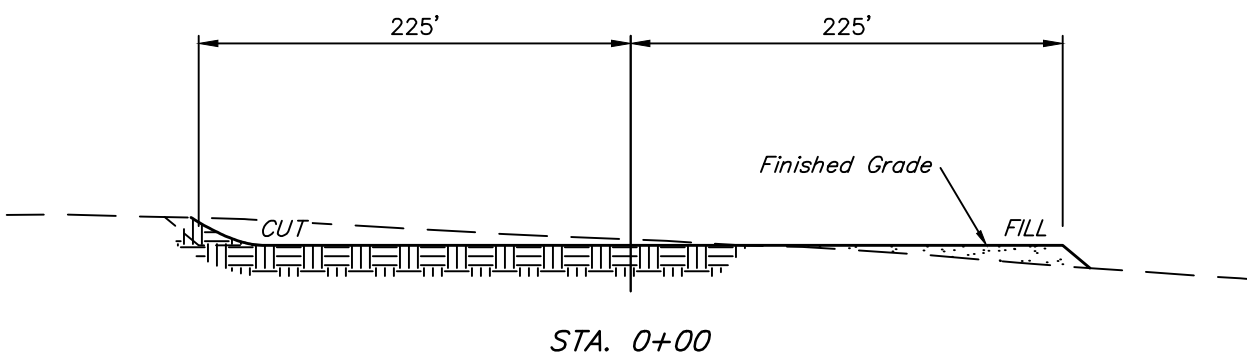
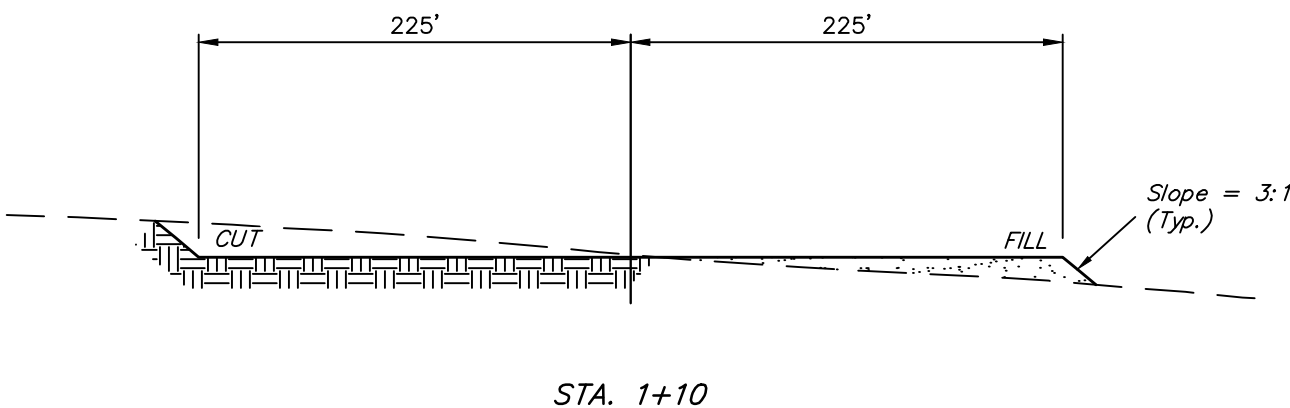
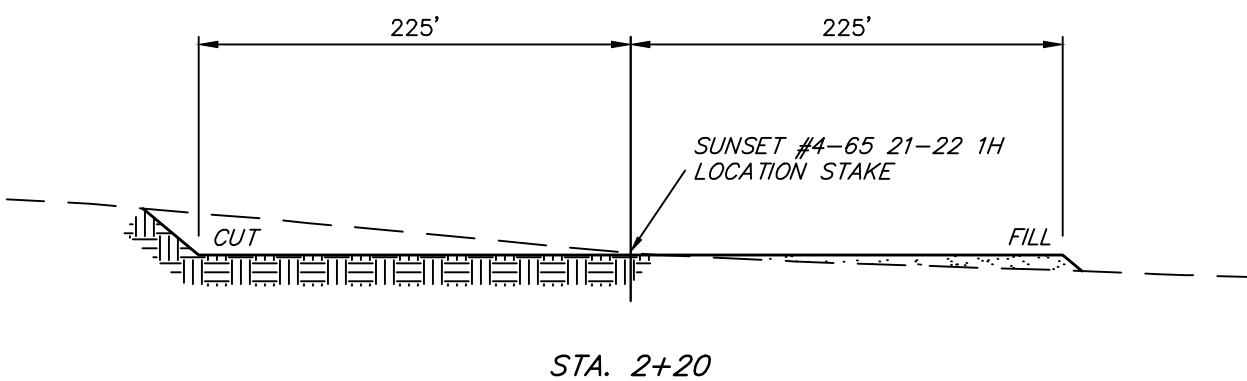
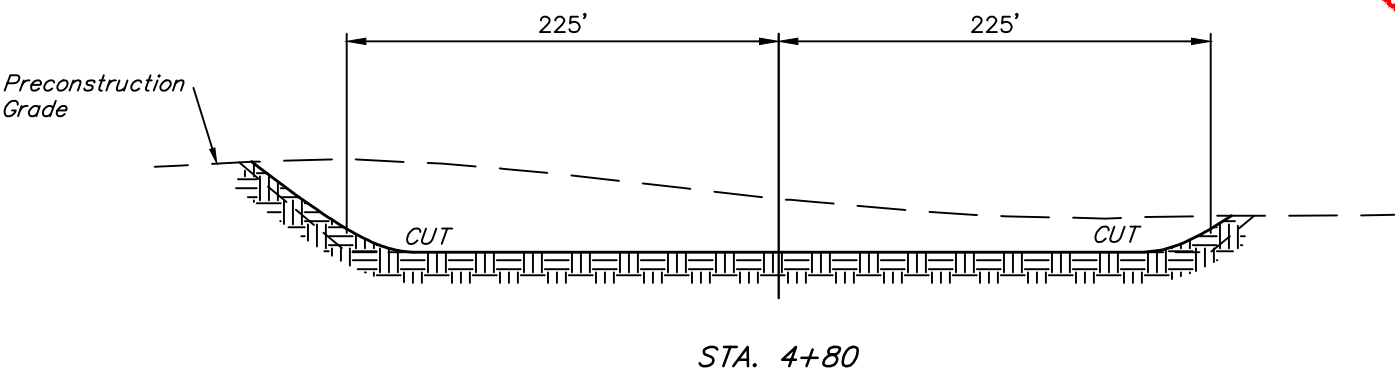

NOTE:
Topsoil should not be
Stripped Below Finished
Grade on Substructure Area.

* NOTE:
FILL QUANTITY INCLUDES
10% FOR COMPACTION

APPROXIMATE YARDAGES

(6") Topsoil Stripping = 4,870 Cu. Yds.
Remaining Location = 41,590 Cu. Yds.
TOTAL CUT = 46,460 CU. YDS.
FILL = 6,550 CU. YDS.

EXCESS MATERIAL = 39,910 Cu. Yds.
Topsoil = 4,870 Cu. Yds.
EXCESS UNBALANCE = 35,040 Cu. Yds.
(After Interim Rehabilitation)

APPROXIMATE ACREAGE

WELL SITE DISTURBANCE = ± 7.963 ACRES
ACCESS ROAD DISTURBANCE = ± 0.499 ACRES
TOTAL = ± 8.462 ACRES

UINTAH ENGINEERING & LAND SURVEYING
85 So. 200 East * Vernal, Utah 84078 * (435) 789-1017