

Location Drawing

WICKSTROM - 67N59W

Lots 3 & 4 SECTION 6, TOWNSHIP 7 NORTH, RANGE 59 WEST OF THE 6TH PRINCIPAL MERIDIAN

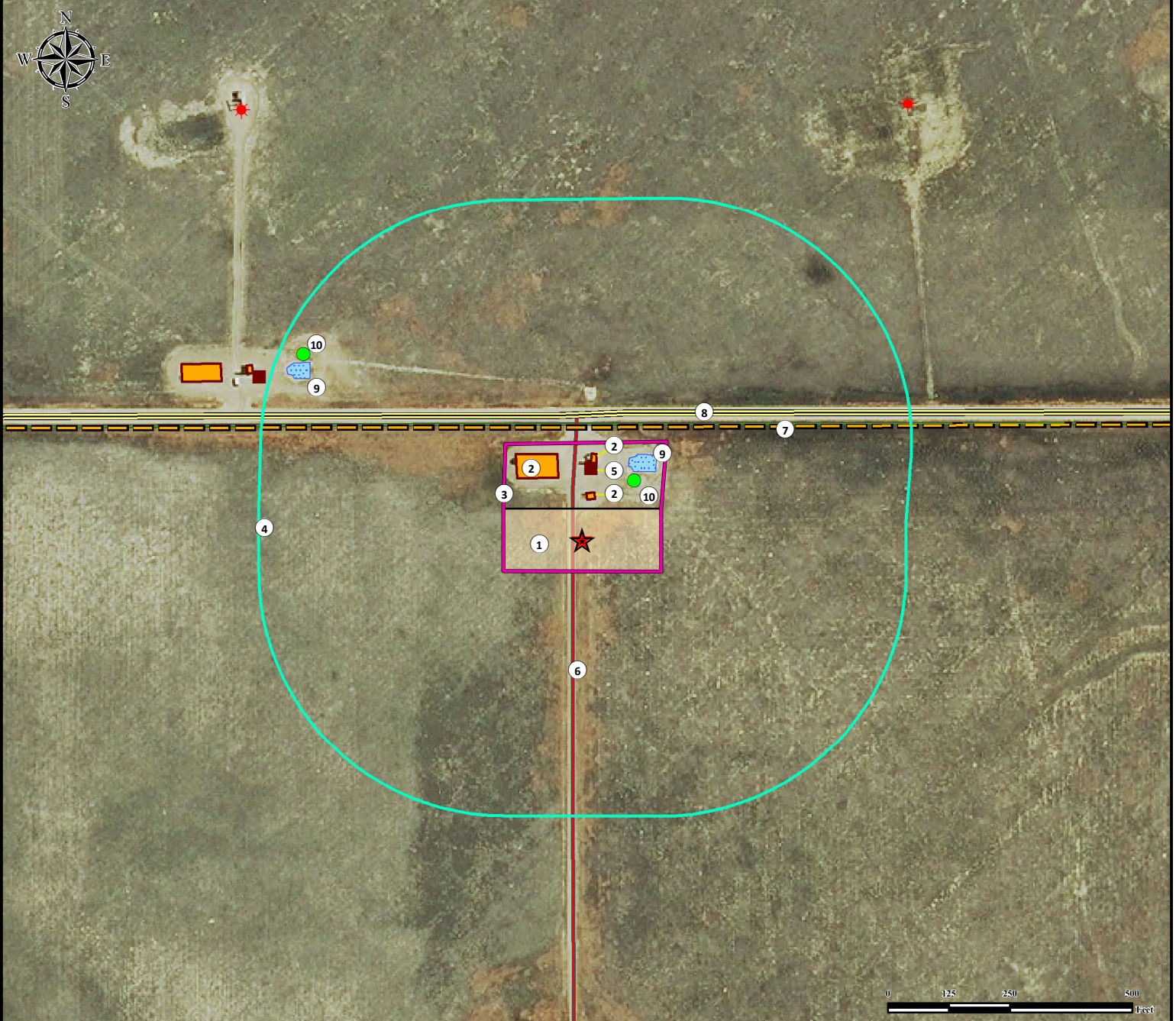

- | | |
|---|--|
| <p>1. Proposed WICKSTROM 67N59W Facility Expansion.</p> <p>2. Existing Facilities are ±84' N, ±134' NW and ± 153' NE.</p> <p>3. Operational Disturbance Area.</p> <p>4. 500' Radius.</p> <p>5. ECD is ±147' NE.</p> | <p>6. Private Road is ±19' W.</p> <p>7. Fence is ±230' N.</p> <p>8. Co Rd 86 is ±257' N.</p> <p>9. Produced Water Pits are ±176' NE and ±648' NW.</p> <p>10. Flares are ±161' NE and ±685' NW.</p> |
|---|--|

Legend 			Reference Location ** All measurements are made from Reference Point ★ ** Lat: 40.610860° Long: -104.025991° (NAD83) Elevation: 4968 Feet															
	<table border="1" style="width: 100%; border-collapse: collapse;"> <tr><td>Building (Residence) -</td><td>>5280' E</td></tr> <tr><td>Public Road - (County Road 86)</td><td>±257' N</td></tr> <tr><td>Property Line - (Wickstrom Donald L)</td><td>±247' N</td></tr> <tr><td>Utility (Power Line) -</td><td>>5280' W</td></tr> <tr><td>Surface Water(Produced Water Pit)-</td><td>±176' NE</td></tr> <tr><td>Railroad -</td><td>>5280' NE</td></tr> <tr><td>Water Well - ±2240' NE</td><td>SWL = 123'</td></tr> <tr><td>Permit: 120874,</td><td>Receipt: 9066344</td></tr> </table>	Building (Residence) -	>5280' E	Public Road - (County Road 86)	±257' N	Property Line - (Wickstrom Donald L)	±247' N	Utility (Power Line) -	>5280' W	Surface Water(Produced Water Pit)-	±176' NE	Railroad -	>5280' NE	Water Well - ±2240' NE	SWL = 123'	Permit: 120874,	Receipt: 9066344	Current Surface Use: Rangeland Future Surface Use: Rangeland
Building (Residence) -	>5280' E																	
Public Road - (County Road 86)	±257' N																	
Property Line - (Wickstrom Donald L)	±247' N																	
Utility (Power Line) -	>5280' W																	
Surface Water(Produced Water Pit)-	±176' NE																	
Railroad -	>5280' NE																	
Water Well - ±2240' NE	SWL = 123'																	
Permit: 120874,	Receipt: 9066344																	
Use our resources to find yours! www.petro-fs.com (303) 928-7128	Field Date: 10/11/2013 Drafting Date: 10/15/2013 Drafter: JLF Revision:	Data Sources: - Aerial courtesy of NAIP (2013)	Disturbance Acreage: 1.96 Acres Drilling Operations 1.96 Acres Interim Reclaim															