

## Arthur Koepsell - DNR

---

**From:** AWeinberg@nobleenergyinc.com  
**Sent:** Monday, October 14, 2013 10:26 AM  
**To:** arthur.koepsell@state.co.us  
**Subject:** Re: WELLS RANCH PC USX AA Sundry noitce (Doc # 400492161)  
**Attachments:** Access Postcard.pdf; ATT00079.txt

Arthur,

Our consultant received a denied access post card from Wells Ranch on 3/25/2013 for water wells located in Section 18, Township 6 North, Range 62 West (attached). Shortly thereafter, we received verbal notification from our land people in Greeley that wells Ranch did not want to receive anymore post cards and denied access for any future water well sampling. Do we need to prepare a letter that states Wells Ranch denies access for any future water well sampling events in pursuit of Rule 318A/609 compliance? This would be a blanket statement that could be used for all Wells Ranch Variance Requests. Thanks,

Asher Weinberg  
Senior Environmental Specialist  
direct: 720.587.2198  
cell: 970.573.8946  
nobleenergyinc.com



From: "Koepsell - DNR, Arthur" <[arthur.koepsell@state.co.us](mailto:arthur.koepsell@state.co.us)>  
To: [aweinberg@nobleenergyinc.com](mailto:aweinberg@nobleenergyinc.com)  
Date: 10/10/2013 02:07 PM  
Subject: EXTERNAL: WELLS RANCH PC USX AA Sundry noitce (Doc # 400492161)

---

Asher,

There are two wells water that may be used as water sources under rule 318ae4. One is in the NE quarter of section 24 (permit # 77005-F) and the other is in the SW quarter of section 24 (permit #77137-F). Both of the wells appear to be owned by Wells Ranch. In order to process the sundry we will need proof of your good faith efforts to collect samples from the wells.

Something to keep in mind when looking for wells under 318Ae4 is that the 1/2 mile radius is trying to find 1/4 sections that contain water wells not necessarily the water wells themselves.

In the figure below I tried to highlight how the COGCC interprets rule 318 Ae4. There is the 1/2 mile radius around the well with the 1/4 sections that it comes into contact with highlighted. Any water well in the

highlighted 1/4 sections could be sampled to meet 318ae4. The exception to this is the SE 1/4 of section 14, because there is already an established sample location. Since there is a sample location established in that 1/4 section it is necessary to look for a different 1/4 section and well.

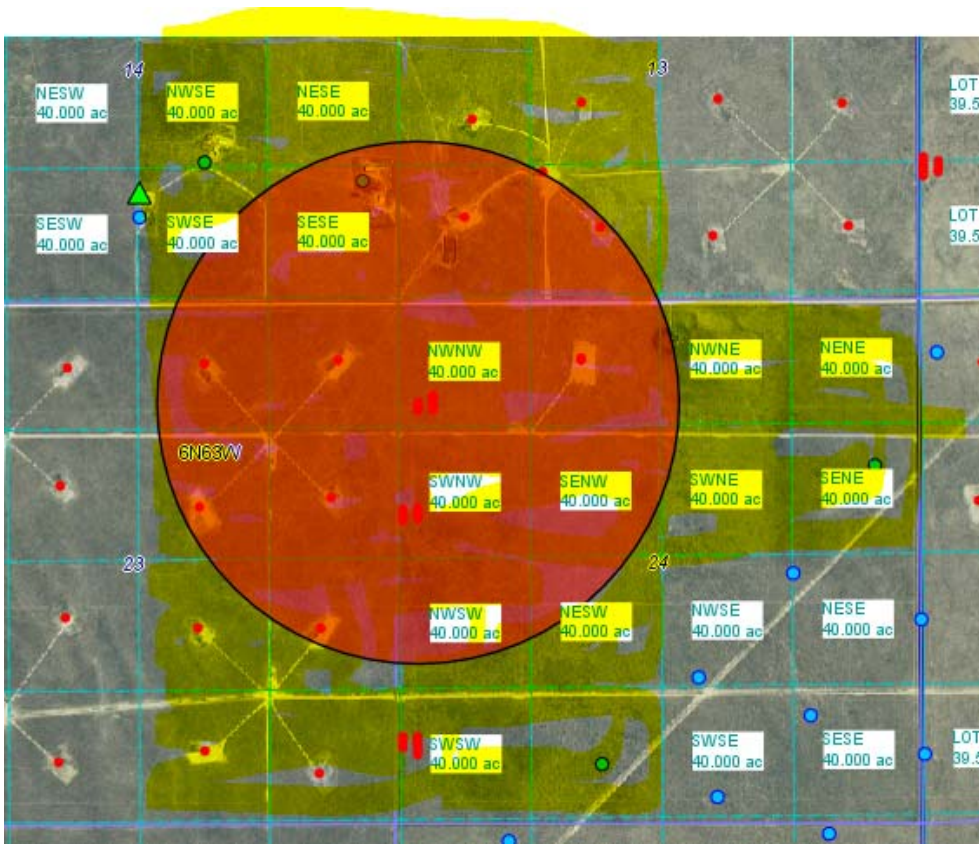

Please call if you have any questions.  
Thanks,

Arthur

--

Arthur W. Koepsell, P.G.

Environmental Data Analyst

Colorado Oil and Gas Conservation Commission

1120 Lincoln St. Suite 801

Denver Colorado 80203

Phone (303) 894-2100 ext. 5148

