

WPX Energy Rocky Mountain, LLC

PLAT #1 LOCATION LAYOUT FOR RILEY GULCH TANK FARM
SECTION 34, T6S, R96W, 6th P.M.

SCALE: 1" = 20'
DATE: 06-28-13
DRAWN BY: M.D.
REV: 07-25-13 H.K.W.
REV: 10-11-13 M.D.

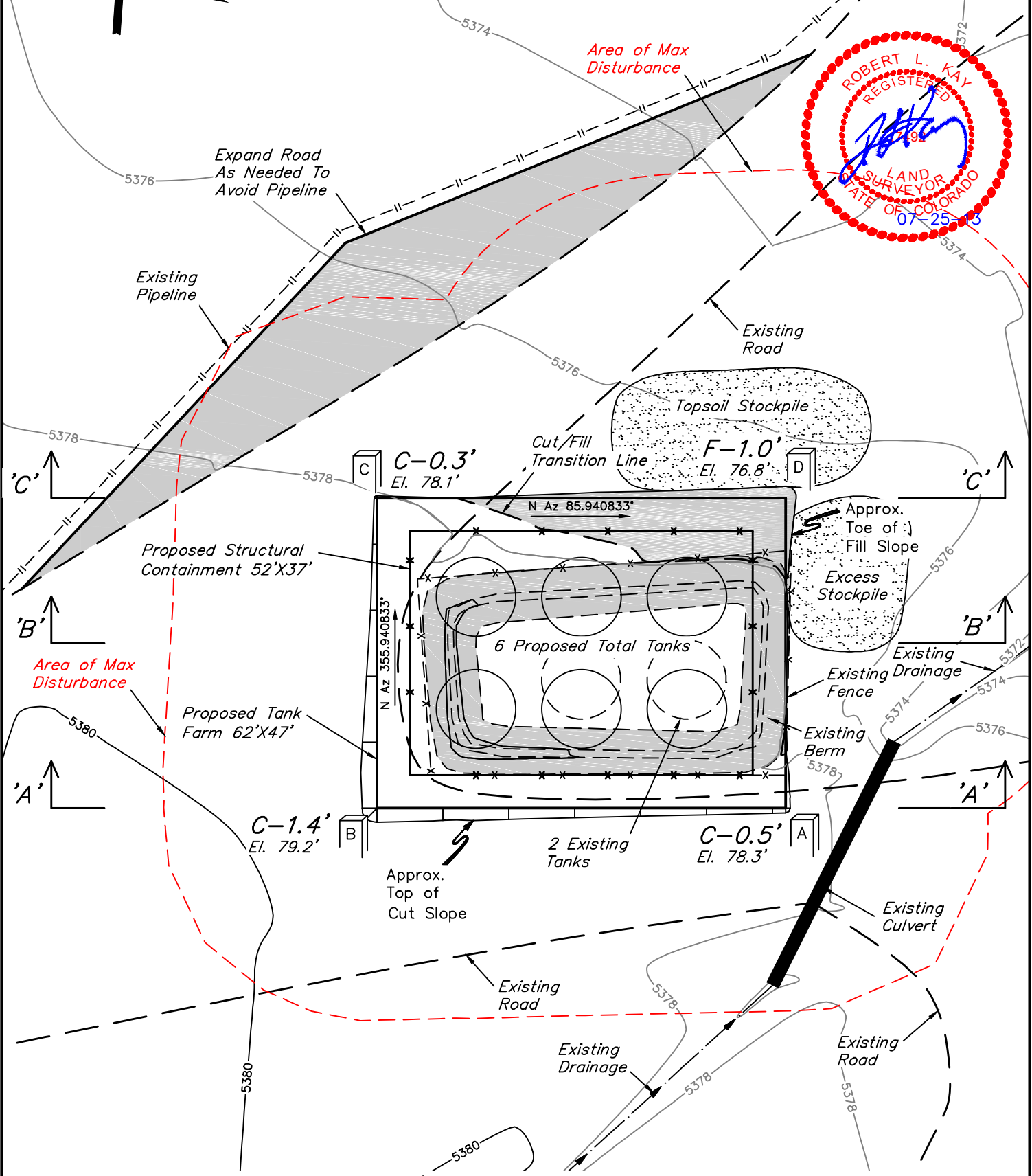
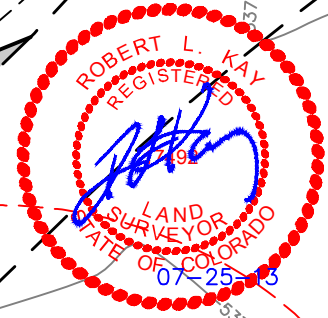
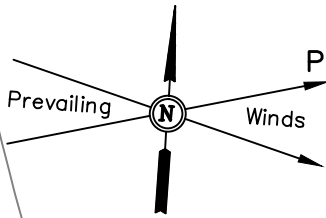

Elev. Ungraded Ground At Corner B = 5379.2'
FINISHED GRADE ELEV. AT CORNER B = 5377.8'

UINTAH ENGINEERING & LAND SURVEYING
85 So. 200 East * Vernal, Utah 84078 * (435) 789-1017

WPX Energy Rocky Mountain, LLC

PLAT #2 CROSS SECTIONS FOR RILEY GULCH TANK FARM
SECTION 34, T6S, R96W, 6th P.M.

1" = 8'
X-Section Scale
1" = 20'

DATE: 06-28-13
DRAWN BY: M.D.
REV: 07-25-13 H.K.W.
REV: 10-13-13 M.D.

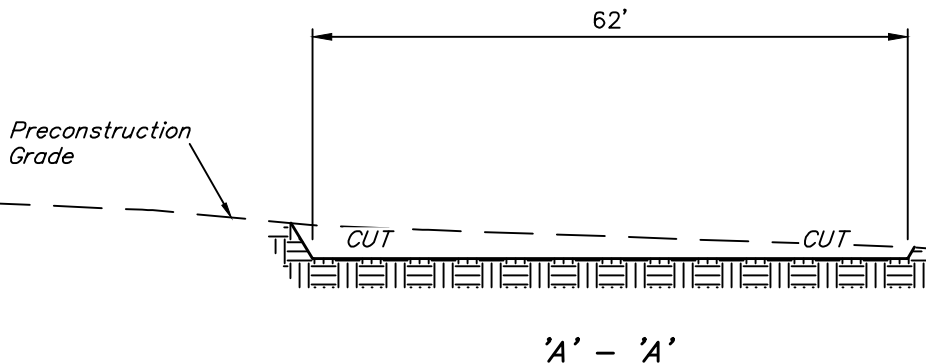
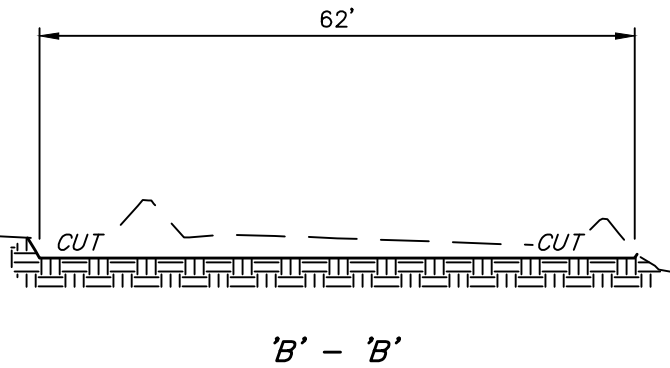
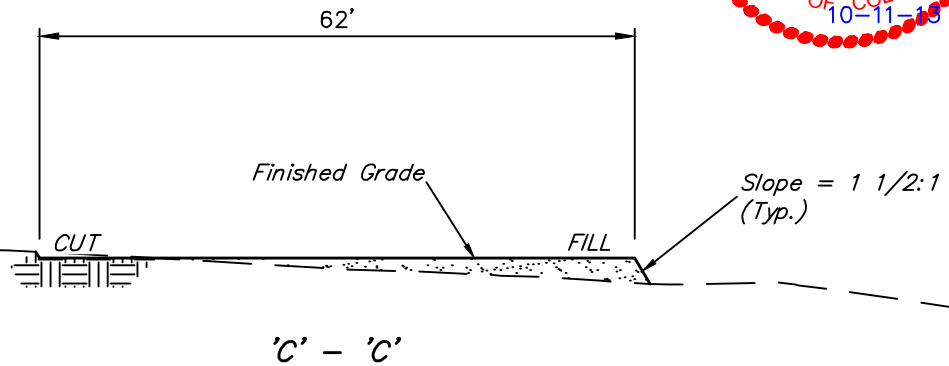

APPROXIMATE ACREAGE

PAD & STOCKPILE DISTURBANCE = ± 0.351 ACRES

APPROXIMATE YARDAGES

(6") Topsoil Stripping	=	60 Cu. Yds.
Remaining Location	=	50 Cu. Yds.
TOTAL CUT	=	110 CU. YDS.
FILL	=	20 CU. YDS.

EXCESS MATERIAL	=	90 Cu. Yds.
Topsoil	=	60 Cu. Yds.
TOTAL EXCESS UNBALANCE	=	30 Cu. Yds.
(After Interim Rehabilitation)		