

# TEKTON WINDSOR, LLC

Location	Windsor, CO, USA(Imported)	Slot	Slot #9
Field	Windsor Project		
Installation	Frye Farms	Wellbore	FRYE FARMS #13

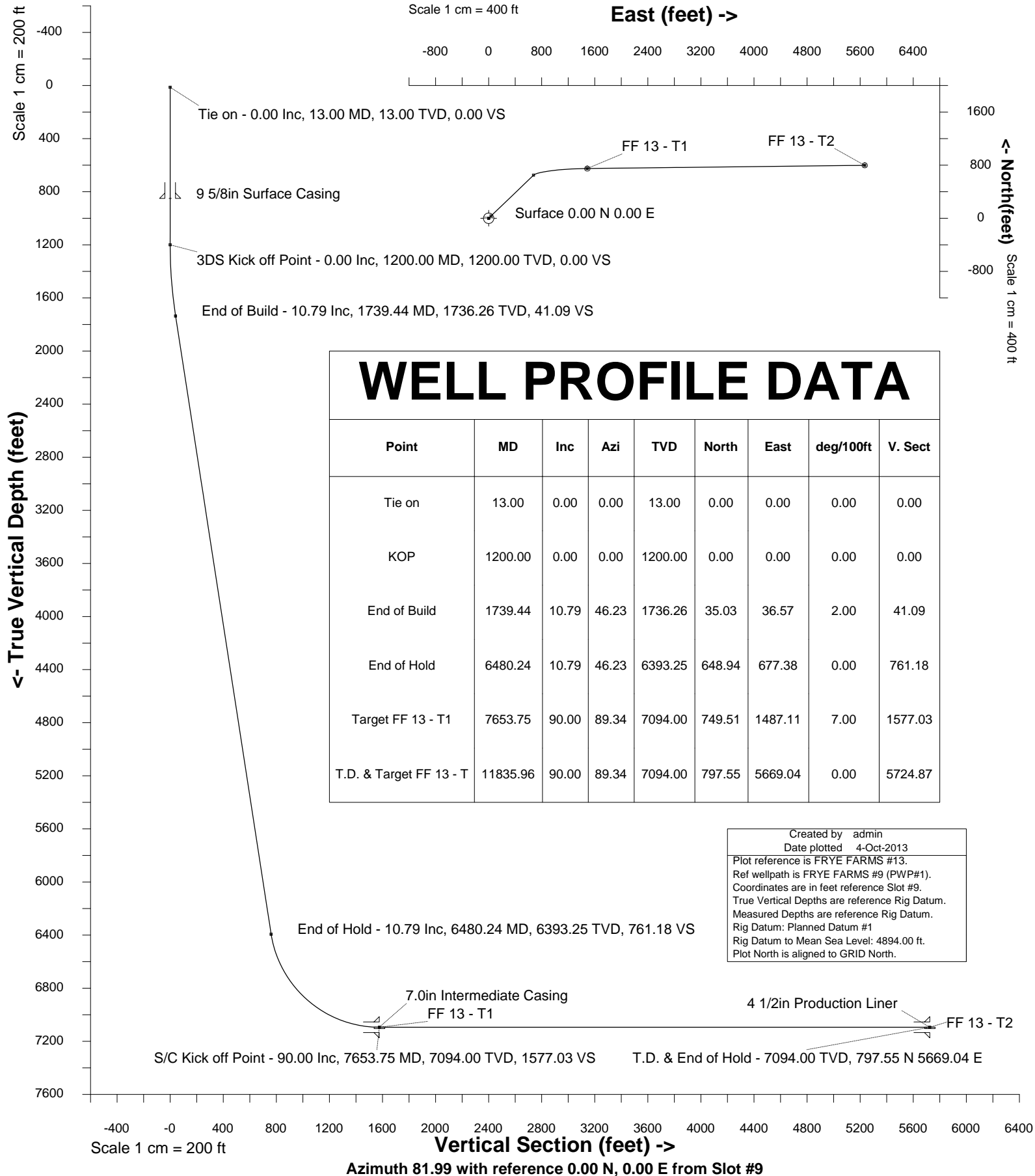



INTEGRATED PETROLEUM TECHNOLOGIES, INC  
SYSDRILL  
Well Design Combined Report  
Wellbore: FRYE FARMS #13

Wellhead Details							
Name	Northing	Easting	Latitude	Longitude	North	East	Elevation Above Inst.
Slot #9	1403469.7217	3164030.2993	40.43942999	-104.91069708	95.68N	85.00W	-0.00

Declination			
Date	Source	Time	
17-Oct-2012	IGRF Model [1900.0-2015.0]	17:08	
25-Oct-2012	IGRF Model [1900.0-2015.0]	11:33	
25-Oct-2012	IGRF Model [1900.0-2015.0]	11:47	

Site Details				
Name	Northing	Easting	Coord System Name	North Alignment
Frye Farms	1403374.0431	3164115.2936	CO83-NF on NORTH AMERICAN DATUM 1983 datum	Grid

Summary Wellpath									
MD[ft]	Inc[deg]	Azi[deg]	TVD[ft]	North[ft]	East[ft]	Dogleg [deg/100ft]	Vertical Section[ft]	Northing	Easting
13.00	0.00	0.000	13.00	0.00N	0.00E		0.00	1403469.72	3164030.30
1200.00	0.00	0.000	1200.00	0.00N	0.00E	==>	0.00	1403469.72	3164030.30
1739.44	10.79	46.230	1736.26	35.03N	36.57E	2.00	41.09	1403504.75	3164066.86
6480.24	10.79	46.230	6393.25	648.94N	677.38E	==>	761.18	1404118.63	3164707.65
7653.75	90.00	89.340	7094.00	749.51N	1487.11E	7.00	1577.03	1404219.20	3165517.35
11835.96	90.00	89.340	7094.00	797.55N	5669.04E	==>	5724.87	1404267.24	3169699.12

Interpolated Wellpath									
MD[ft]	Inc[deg]	Azi[deg]	TVD[ft]	North[ft]	East[ft]	Dogleg [deg/100ft]	Vertical Section[ft]	Northing	Easting
0.00	0.00	0.000	0.00	0.00N	0.00E		0.00	1403469.72	3164030.30
13.00	0.00	0.000	13.00	0.00N	0.00E	==>	0.00	1403469.72	3164030.30
100.00	0.00	0.000	100.00	0.00N	0.00E	==>	0.00	1403469.72	3164030.30
200.00	0.00	0.000	200.00	0.00N	0.00E	==>	0.00	1403469.72	3164030.30
300.00	0.00	0.000	300.00	0.00N	0.00E	==>	0.00	1403469.72	3164030.30
400.00	0.00	0.000	400.00	0.00N	0.00E	==>	0.00	1403469.72	3164030.30
500.00	0.00	0.000	500.00	0.00N	0.00E	==>	0.00	1403469.72	3164030.30
600.00	0.00	0.000	600.00	0.00N	0.00E	==>	0.00	1403469.72	3164030.30
700.00	0.00	0.000	700.00	0.00N	0.00E	==>	0.00	1403469.72	3164030.30
800.00	0.00	0.000	800.00	0.00N	0.00E	==>	0.00	1403469.72	3164030.30
900.00	0.00	0.000	900.00	0.00N	0.00E	==>	0.00	1403469.72	3164030.30
1000.00	0.00	0.000	1000.00	0.00N	0.00E	==>	0.00	1403469.72	3164030.30
1100.00	0.00	0.000	1100.00	0.00N	0.00E	==>	0.00	1403469.72	3164030.30
1187.00	0.00	0.000	1187.00	0.00N	0.00E	==>	0.00	1403469.72	3164030.30
1200.00	0.00	0.000	1200.00	0.00N	0.00E	==>	0.00	1403469.72	3164030.30
1287.00	1.74	46.230	1286.99	0.91N	0.95E	2.00	1.07	1403470.64	3164031.25
1387.00	3.74	46.230	1386.87	4.22N	4.41E	2.00	4.95	1403473.94	3164034.70
1487.00	5.74	46.230	1486.52	9.94N	10.37E	2.00	11.66	1403479.66	3164040.67
1587.00	7.74	46.230	1585.82	18.06N	18.85E	2.00	21.18	1403487.78	3164049.15
1687.00	9.74	46.230	1684.66	28.57N	29.82E	2.00	33.51	1403498.29	3164060.12
1739.44	10.79	46.230	1736.26	35.03N	36.57E	2.00	41.09	1403504.75	3164066.86
1800.00	10.79	46.230	1795.75	42.87N	44.75E	==>	50.29	1403512.59	3164075.05
1900.00	10.79	46.230	1893.98	55.82N	58.27E	==>	65.48	1403525.54	3164088.57
2000.00	10.79	46.230	1992.21	68.77N	71.79E	==>	80.67	1403538.49	3164102.08
2100.00	10.79	46.230	2090.44	81.72N	85.30E	==>	95.86	1403551.44	3164115.60
2200.00	10.79	46.230	2188.68	94.67N	98.82E	==>	111.05	1403564.39	3164129.12
2300.00	10.79	46.230	2286.91	107.62N	112.34E	==>	126.23	1403577.34	3164142.63
2400.00	10.79	46.230	2385.14	120.57N	125.85E	==>	141.42	1403590.29	3164156.15
2500.00	10.79	46.230	2483.37	133.52N	139.37E	==>	156.61	1403603.24	3164169.66
2600.00	10.79	46.230	2581.61	146.47N	152.89E	==>	171.80	1403616.18	3164183.18
2700.00	10.79	46.230	2679.84	159.42N	166.41E	==>	186.99	1403629.13	3164196.70
2800.00	10.79	46.230	2778.07	172.37N	179.92E	==>	202.18	1403642.08	3164210.21
2900.00	10.79	46.230	2876.30	185.32N	193.44E	==>	217.37	1403655.03	3164223.73
3000.00	10.79	46.230	2974.54	198.27N	206.96E	==>	232.56	1403667.98	3164237.25
3100.00	10.79	46.230	3072.77	211.22N	220.47E	==>	247.75	1403680.93	3164250.76
3200.00	10.79	46.230	3171.00	224.17N	233.99E	==>	262.94	1403693.88	3164264.28

All data is in Feet unless otherwise stated  
Coordinates are from Slot MD's are from Rig and TVD's are from Rig ( Planned Datum #1 4894.0ft above Mean Sea Level )  
Vertical Section is from 0.00N 0.00E on azimuth 81.990 degrees  
Bottom hole distance is 5724.87 Feet on azimuth 81.99 degrees from Wellhead  
Calculation method uses Minimum Curvature method  
Prepared by Integrated Petroleum Technologies, Inc.  
Date Printed: 4-Oct-2013



INTEGRATED PETROLEUM TECHNOLOGIES, INC  
SYSDRILL

Well Design Combined Report  
Wellbore: FRYE FARMS #13

Interpolated Wellpath									
MD[ft]	Inc[deg]	Azi[deg]	TVD[ft]	North[ft]	East[ft]	Dogleg [deg/100ft]	Vertical Section[ft]	Northing	Easting
3300.00	10.79	46.230	3269.23	237.11N	247.51E	==>	278.13	1403706.83	3164277.80
3400.00	10.79	46.230	3367.47	250.06N	261.02E	==>	293.32	1403719.78	3164291.31
3500.00	10.79	46.230	3465.70	263.01N	274.54E	==>	308.51	1403732.73	3164304.83
3600.00	10.79	46.230	3563.93	275.96N	288.06E	==>	323.69	1403745.67	3164318.35
3700.00	10.79	46.230	3662.16	288.91N	301.58E	==>	338.88	1403758.62	3164331.86
3800.00	10.79	46.230	3760.40	301.86N	315.09E	==>	354.07	1403771.57	3164345.38
3900.00	10.79	46.230	3858.63	314.81N	328.61E	==>	369.26	1403784.52	3164358.90
4000.00	10.79	46.230	3956.86	327.76N	342.13E	==>	384.45	1403797.47	3164372.41
4100.00	10.79	46.230	4055.09	340.71N	355.64E	==>	399.64	1403810.42	3164385.93
4200.00	10.79	46.230	4153.32	353.66N	369.16E	==>	414.83	1403823.37	3164399.44
4300.00	10.79	46.230	4251.56	366.61N	382.68E	==>	430.02	1403836.32	3164412.96
4400.00	10.79	46.230	4349.79	379.56N	396.19E	==>	445.21	1403849.27	3164426.48
4500.00	10.79	46.230	4448.02	392.51N	409.71E	==>	460.40	1403862.21	3164439.99
4600.00	10.79	46.230	4546.25	405.46N	423.23E	==>	475.59	1403875.16	3164453.51
4700.00	10.79	46.230	4644.49	418.41N	436.75E	==>	490.78	1403888.11	3164467.03
4800.00	10.79	46.230	4742.72	431.36N	450.26E	==>	505.96	1403901.06	3164480.54
4900.00	10.79	46.230	4840.95	444.31N	463.78E	==>	521.15	1403914.01	3164494.06
5000.00	10.79	46.230	4939.18	457.26N	477.30E	==>	536.34	1403926.96	3164507.58
5100.00	10.79	46.230	5037.42	470.20N	490.81E	==>	551.53	1403939.91	3164521.09
5200.00	10.79	46.230	5135.65	483.15N	504.33E	==>	566.72	1403952.86	3164534.61
5300.00	10.79	46.230	5233.88	496.10N	517.85E	==>	581.91	1403965.81	3164548.13
5400.00	10.79	46.230	5332.11	509.05N	531.36E	==>	597.10	1403978.75	3164561.64
5500.00	10.79	46.230	5430.35	522.00N	544.88E	==>	612.29	1403991.70	3164575.16
5600.00	10.79	46.230	5528.58	534.95N	558.40E	==>	627.48	1404004.65	3164588.68
5700.00	10.79	46.230	5626.81	547.90N	571.92E	==>	642.67	1404017.60	3164602.19
5800.00	10.79	46.230	5725.04	560.85N	585.43E	==>	657.86	1404030.55	3164615.71
5900.00	10.79	46.230	5823.28	573.80N	598.95E	==>	673.05	1404043.50	3164629.22
6000.00	10.79	46.230	5921.51	586.75N	612.47E	==>	688.24	1404056.45	3164642.74
6100.00	10.79	46.230	6019.74	599.70N	625.98E	==>	703.42	1404069.40	3164656.26
6200.00	10.79	46.230	6117.97	612.65N	639.50E	==>	718.61	1404082.35	3164669.77
6300.00	10.79	46.230	6216.20	625.60N	653.02E	==>	733.80	1404095.30	3164683.29
6400.00	10.79	46.230	6314.44	638.55N	666.53E	==>	748.99	1404108.24	3164696.81
6480.24	10.79	46.230	6393.25	648.94N	677.38E	==>	761.18	1404118.63	3164707.65
6500.00	11.83	50.890	6412.64	651.50N	680.29E	7.00	764.41	1404121.19	3164710.56
6600.00	17.81	65.430	6509.30	664.34N	702.18E	7.00	787.88	1404134.03	3164732.45
6700.00	24.33	72.600	6602.58	676.87N	735.78E	7.00	822.91	1404146.57	3164766.05
6800.00	31.05	76.850	6691.08	688.91N	780.61E	7.00	868.97	1404158.61	3164810.88
6900.00	37.86	79.700	6773.49	700.28N	835.99E	7.00	925.39	1404169.98	3164866.25
7000.00	44.73	81.790	6848.58	710.81N	901.09E	7.00	991.33	1404180.50	3164931.35
7100.00	51.62	83.420	6915.23	720.34N	974.95E	7.00	1065.79	1404190.03	3165005.21
7200.00	58.53	84.770	6972.44	728.73N	1056.46E	7.00	1147.68	1404198.42	3165086.71
7300.00	65.46	85.930	7019.37	735.85N	1144.40E	7.00	1235.76	1404205.54	3165174.66
7400.00	72.39	86.970	7055.31	741.60N	1237.48E	7.00	1328.73	1404211.29	3165267.73
7500.00	79.33	87.940	7079.72	745.89N	1334.29E	7.00	1425.19	1404215.58	3165364.54
7600.00	86.27	88.860	7092.25	748.66N	1433.40E	7.00	1523.73	1404218.35	3165463.65
7653.75	90.00	89.340	7094.00	749.51N	1487.11E	7.00	1577.03	1404219.20	3165517.35
7700.00	90.00	89.340	7094.00	750.04N	1533.36E	==>	1622.89	1404219.73	3165563.60
7800.00	90.00	89.340	7094.00	751.19N	1633.35E	==>	1722.07	1404220.88	3165663.58
7900.00	90.00	89.340	7094.00	752.34N	1733.34E	==>	1821.25	1404222.03	3165763.57
8000.00	90.00	89.340	7094.00	753.48N	1833.34E	==>	1920.43	1404223.18	3165863.56
8100.00	90.00	89.340	7094.00	754.63N	1933.33E	==>	2019.61	1404224.33	3165963.55
8200.00	90.00	89.340	7094.00	755.78N	2033.32E	==>	2118.79	1404225.47	3166063.54
8300.00	90.00	89.340	7094.00	756.93N	2133.32E	==>	2217.96	1404226.62	3166163.53
8400.00	90.00	89.340	7094.00	758.08N	2233.31E	==>	2317.14	1404227.77	3166263.52
8500.00	90.00	89.340	7094.00	759.23N	2333.30E	==>	2416.32	1404228.92	3166363.51
8600.00	90.00	89.340	7094.00	760.38N	2433.30E	==>	2515.50	1404230.07	3166463.50
8700.00	90.00	89.340	7094.00	761.53N	2533.29E	==>	2614.68	1404231.22	3166563.49
8800.00	90.00	89.340	7094.00	762.67N	2633.28E	==>	2713.86	1404232.37	3166663.48
8900.00	90.00	89.340	7094.00	763.82N	2733.28E	==>	2813.03	1404233.51	3166763.47
9000.00	90.00	89.340	7094.00	764.97N	2833.27E	==>	2912.21	1404234.66	3166863.46
9100.00	90.00	89.340	7094.00	766.12N	2933.26E	==>	3011.39	1404235.81	3166963.45
9200.00	90.00	89.340	7094.00	767.27N	3033.26E	==>	3110.57	1404236.96	3167063.44

All data is in Feet unless otherwise stated  
Coordinates are from Slot MD's are from Rig and TVD's are from Rig ( Planned Datum #1 4894.0ft above Mean Sea Level )  
Vertical Section is from 0.00N 0.00E on azimuth 81.990 degrees  
Bottom hole distance is 5724.87 Feet on azimuth 81.99 degrees from Wellhead  
Calculation method uses Minimum Curvature method  
Prepared by Integrated Petroleum Technologies, Inc.  
Date Printed: 4-Oct-2013



INTEGRATED PETROLEUM TECHNOLOGIES, INC  
SYSDRILL

Well Design Combined Report  
Wellbore: FRYE FARMS #13

Interpolated Wellpath									
MD[ft]	Inc[deg]	Azi[deg]	TVD[ft]	North[ft]	East[ft]	Dogleg [deg/100ft]	Vertical Section[ft]	Northing	Easting
9300.00	90.00	89.340	7094.00	768.42N	3133.25E	==>	3209.75	1404238.11	3167163.43
9400.00	90.00	89.340	7094.00	769.57N	3233.24E	==>	3308.93	1404239.26	3167263.42
9500.00	90.00	89.340	7094.00	770.71N	3333.24E	==>	3408.10	1404240.41	3167363.41
9600.00	90.00	89.340	7094.00	771.86N	3433.23E	==>	3507.28	1404241.55	3167463.39
9700.00	90.00	89.340	7094.00	773.01N	3533.23E	==>	3606.46	1404242.70	3167563.38
9800.00	90.00	89.340	7094.00	774.16N	3633.22E	==>	3705.64	1404243.85	3167663.37
9900.00	90.00	89.340	7094.00	775.31N	3733.21E	==>	3804.82	1404245.00	3167763.36
10000.00	90.00	89.340	7094.00	776.46N	3833.21E	==>	3904.00	1404246.15	3167863.35
10100.00	90.00	89.340	7094.00	777.61N	3933.20E	==>	4003.17	1404247.30	3167963.34
10200.00	90.00	89.340	7094.00	778.76N	4033.19E	==>	4102.35	1404248.45	3168063.33
10300.00	90.00	89.340	7094.00	779.90N	4133.19E	==>	4201.53	1404249.60	3168163.32
10400.00	90.00	89.340	7094.00	781.05N	4233.18E	==>	4300.71	1404250.74	3168263.31
10500.00	90.00	89.340	7094.00	782.20N	4333.17E	==>	4399.89	1404251.89	3168363.30
10600.00	90.00	89.340	7094.00	783.35N	4433.17E	==>	4499.07	1404253.04	3168463.29
10700.00	90.00	89.340	7094.00	784.50N	4533.16E	==>	4598.24	1404254.19	3168563.28
10800.00	90.00	89.340	7094.00	785.65N	4633.15E	==>	4697.42	1404255.34	3168663.27
10900.00	90.00	89.340	7094.00	786.80N	4733.15E	==>	4796.60	1404256.49	3168763.26
11000.00	90.00	89.340	7094.00	787.95N	4833.14E	==>	4895.78	1404257.64	3168863.25
11100.00	90.00	89.340	7094.00	789.09N	4933.13E	==>	4994.96	1404258.78	3168963.24
11200.00	90.00	89.340	7094.00	790.24N	5033.13E	==>	5094.14	1404259.93	3169063.23
11300.00	90.00	89.340	7094.00	791.39N	5133.12E	==>	5193.31	1404261.08	3169163.21
11400.00	90.00	89.340	7094.00	792.54N	5233.11E	==>	5292.49	1404262.23	3169263.20
11500.00	90.00	89.340	7094.00	793.69N	5333.11E	==>	5391.67	1404263.38	3169363.19
11600.00	90.00	89.340	7094.00	794.84N	5433.10E	==>	5490.85	1404264.53	3169463.18
11700.00	90.00	89.340	7094.00	795.99N	5533.09E	==>	5590.03	1404265.68	3169563.17
11800.00	90.00	89.340	7094.00	797.13N	5633.09E	==>	5689.21	1404266.82	3169663.16
11835.96	90.00	89.340	7094.00	797.55N	5669.04E	==>	5724.87	1404267.24	3169699.12

All data is in Feet unless otherwise stated  
Coordinates are from Slot MD's are from Rig and TVD's are from Rig ( Planned Datum #1 4894.0ft above Mean Sea Level )  
Vertical Section is from 0.00N 0.00E on azimuth 81.990 degrees  
Bottom hole distance is 5724.87 Feet on azimuth 81.99 degrees from Wellhead  
Calculation method uses Minimum Curvature method  
Prepared by Integrated Petroleum Technologies, Inc.  
Date Printed: 4-Oct-2013



INTEGRATED PETROLEUM TECHNOLOGIES, INC  
SYSDRILL  
Well Design Combined Report  
Wellbore: FRYE FARMS #13

Hole Sections								
Diameter [in]	Start MD[ft]	Start TVD[ft]	Start North[ft]	Start East[ft]	End MD[ft]	End TVD[ft]	End North[ft]	End East[ft]
12 1/4	13.00	13.00	0.00N	0.00E	850.00	850.00	0.00N	0.00E
8 3/4	850.00	850.00	0.00N	0.00E	7653.00	7094.00	749.50N	1486.36E
6 1/8	7653.00	7094.00	749.50N	1486.36E	11835.96	7094.00	797.55N	5669.04E

Casings								
Name	Top MD[ft]	Top TVD[ft]	Top North[ft]	Top East[ft]	Shoe MD[ft]	Shoe TVD[ft]	Shoe North[ft]	Shoe East[ft]
9 5/8in Surface Casing	13.00	13.00	0.00N	0.00E	850.00	850.00	0.00N	0.00E
7.0in Intermediate Casing	13.00	13.00	0.00N	0.00E	7653.00	7094.00	749.50N	1486.36E
4 1/2in Production Liner	6480.00	6393.02	648.91N	677.35E	11835.96	7094.00	797.55N	5669.04E

Targets								
Name	North[ft]	East[ft]	TVD[ft]	Latitude	Longitude	Northing	Easting	Last Revised
FF 13 - T1	749.51N	1487.11E	7094.00	40.44146000	-104.90533673	1404219.20	3165517.35	8-Mar-2013
FF 13 - T2	797.55N	5669.04E	7094.00	40.44151391	-104.89031195	1404267.24	3169699.12	8-Mar-2013

Survey Tool Program						
Reference	Survey Name	MD[ft]	TVD[ft]	Survey Tool	Error Model	
65062	Planned	11835.96	7094.00	WdW Rate Gyro	Standard	

Notes

All data is in Feet unless otherwise stated  
Coordinates are from Slot MD's are from Rig and TVD's are from Rig ( Planned Datum #1 4894.0ft above Mean Sea Level )  
Vertical Section is from 0.00N 0.00E on azimuth 81.990 degrees  
Bottom hole distance is 5724.87 Feet on azimuth 81.99 degrees from Wellhead  
Calculation method uses Minimum Curvature method  
Prepared by Integrated Petroleum Technologies, Inc.  
Date Printed: 4-Oct-2013



SYSDRILL  
Closest Approach + Clearance Factor Summary Report  
Wellbore: FRYE FARMS #13

Ellipse separations are reported ONLY if BOTH wells have uncertainty data  
Only Depth and Magnetic Reference Field error terms are correlated across tie points  
Scan limit is calculated on CENTRE to CENTRE distance

Summary data uses Closest Approach clearance calculation for all minima  
Hole size/Casings ARE included  
Hole size/Casings are NOT subtracted from Centre-Centre distance  
Confidence limit of 95.00% / 2.80 SD.

Wellbore		
Name	Created	Last Revised
FRYE FARMS #13	2-Oct-2013	4-Oct-2013

Well		
Name	Government ID	Last Revised
FRYE FARMS #9		16-May-2013

Slot						
Name	Grid Northing	Grid Easting	Latitude	Longitude	North	East
Slot #9	1403469.7217	3164030.2993	40.43942999	-104.91069708	95.68N	85.00W

Installation					
Name	Easting	Northing	Coord System Name	North Alignment	
Frye Farms	3164115.2936	1403374.0431	CO83-NF on NORTH AMERICAN DATUM 1983 datum	Grid	

Field					
Name	Easting	Northing	Coord System Name	North Alignment	
Windsor Project	3162710.0707	1407271.6545	CO83-NF on NORTH AMERICAN DATUM 1983 datum	Grid	

Clearance Summary										
Offset WellName	Offset Wellbore	Offset Slot	Offset Structure	Separation [ft]	MD[ft]	Diverging From[ft]	Ellipse Separation [ft]	Ellipse MD[ft]	Clearance Factor	Clearance MD[ft]
FRYE FARMS #8	FRYE FARMS #8	Slot #8	Frye Farms	15.93	1013.66	11835.96	13.65	1046.46	2.93	11835.96
FRYE FARMS #10	FRYE FARMS #9	Slot #10	Frye Farms	15.93	1030.06	11799.93	13.60	1062.87	2.71	11824.02
FRYE FARMS #11	FRYE FARMS #10	Slot #11	Frye Farms	32.01	1000.00	11727.88	29.76	1030.06	5.18	11774.81
FRYE FARMS #7	FRYE FARMS #7	Slot #7	Frye Farms	32.02	1013.66	11835.96	29.75	1013.66	5.39	11835.96
FRYE FARM 7-5-32	FRYE FARM 7-5-32 (AWB)	FRYE FARMS #7-5-32	Frye Farms	43.66	842.22	842.22	40.30	849.61	12.93	849.61
FRYE FARMS #12	FRYE FARMS #11	Slot #12	Frye Farms	47.94	1000.00	11692.79	45.68	849.61	8.73	11813.00
FRYE FARMS #6	FRYE FARMS #6	Slot #6	Frye Farms	48.00	1013.66	11835.96	45.73	1013.66	8.47	11835.96
FRYE FARMS #13	FRYE FARMS #12	Slot #13	Frye Farms	63.87	1000.00	11693.86	61.61	849.61	11.82	11835.96
CENTER POINT #7	CENTER POINT #7	Slot #7	Center Point	85.30	7282.60	7282.60	58.10	7263.66	2.72	7230.85
FRYE FARMS #9-5-32	FRYE FARMS #9-5-32 (AWB)	FRYE FARMS #9-5-32	Frye Farms	90.91	505.13	505.13	88.87	513.00	33.31	849.61
FRYE	FRYE	FRYE	Frye Farms	109.99	244.30	244.30	108.44	244.30	58.33	849.61

All data is in Feet unless otherwise stated  
Coordinates are from Slot MD's are from Rig and TVD's are from Rig ( Planned Datum #1 4894.0ft above Mean Sea Level )  
Vertical Section is from 0.00N 0.00E on azimuth 81.990 degrees  
Prepared by Integrated Petroleum Technologies, Inc.  
Date Printed: 4-Oct-2013



SYSDRILL  
Closest Approach + Clearance Factor Summary Report  
Wellbore: FRYE FARMS #13

Clearance Summary										
Offset WellName	Offset Wellbore	Offset Slot	Offset Structure	Separation [ft]	MD[ft]	Diverging From[ft]	Ellipse Separation [ft]	Ellipse MD[ft]	Clearance Factor	Clearance MD[ft]
FARMS #9-7-32	FARMS #9-7-32 (AWB)	FARMS #9-7-32								
CENTER POINT #5	CENTER POINT #5	Slot #5	Center Point	111.68	7009.16	7009.16	79.30	7034.00	3.19	7050.40
RANCHO WATER VALLEY #9	RANCHO WATER VALLEY #9	Slot #09	Rancho Water Valley	302.93	11835.96	11835.96	232.26	11835.96	4.29	11835.96
Pavistma South 1 #1-5-32-09 0-4-NH	Pavistma South 1 #1-5-32-090-4 -NH (PWB)	Slot #1	Pavistma South	315.56	6866.38	6866.38	293.37	6866.38	14.22	6866.38
PAVISTMA #5	PAVISTMA #5	Slot #5	Pavistma	387.91	6870.90	6870.90	348.12	6870.90	9.70	6902.76
RANCHO WATER VALLEY #8	RANCHO WATER VALLEY #8	Slot #08	Rancho Water Valley	459.84	11835.96	11835.96	427.27	11835.96	14.12	11835.96
Pavistma South 2 #1-5-32-09 0-4-CH	Pavistma South 2 #1-5-32-090-4 -CH (PWB)	Slot #2	Pavistma South	496.84	6984.78	6984.78	463.88	6984.78	15.05	7001.19
RANCHO WATER VALLEY #13	RANCHO WATER VALLEY #13 (AWB)	Slot #13	Rancho Water Valley	644.05	7823.04	11835.96	457.59	7837.80	3.45	7854.21
RANCHO WATER VALLEY #13	RANCHO WATER VALLEY #13	Slot #13	Rancho Water Valley	652.59	11835.96	11835.96	593.65	11835.96	11.07	11835.96
PAVISTMA #6	PAVISTMA #6	Slot #6	Pavistma	702.67	6869.96	6869.96	659.39	6869.96	16.23	6886.36
PAVISTMA #7	PAVISTMA #7	Slot #7	Pavistma	711.92	11690.24	11690.24	577.84	11709.19	5.30	11742.00
PAVISTMA #4	PAVISTMA #4	Slot #4	Pavistma	800.17	6874.18	6874.18	748.91	6886.36	15.46	6951.98
Pavistma South 3 #1-6-32-09 0-4-NH	Pavistma South 3 #1-6-32-090-4 -NH (PWB)	Slot #3	Pavistma South	857.63	6886.36	6886.36	806.26	6886.36	16.58	6951.98
PAVISTMA #8	PAVISTMA #8	Slot #8	Pavistma	1070.61	6888.50	6888.50	1022.29	6888.50	22.06	6951.98
RANCHO WATER VALLEY #12	RANCHO WATER VALLEY #12	Slot #12	Rancho Water Valley	1174.76	11835.96	11835.96	987.45	7931.25	6.21	7931.25
RANCHO WATER VALLEY #11	RANCHO WATER VALLEY 11 #7-7-33-270-6 -CH (AWB)	Slot #11	Rancho Water Valley	1283.61	9449.05	11679.43	1110.95	7985.44	6.91	7985.44
RANCHO WATER VALLEY #11	RANCHO WATER VALLEY #11	Slot #11	Rancho Water Valley	1305.55	11835.96	11835.96	1246.57	11835.96	22.14	11835.96
PAVISTMA #10	PAVISTMA #10	Slot #10	Pavistma	1372.12	11695.07	11695.07	1237.78	11725.60	10.12	11835.96
PAVISTMA	PAVISTMA	Slot #9	Pavistma	1375.06	6913.00	6913.00	1324.72	6919.17	27.08	7034.00

All data is in Feet unless otherwise stated  
Coordinates are from Slot MD's are from Rig and TVD's are from Rig ( Planned Datum #1 4894.0ft above Mean Sea Level )  
Vertical Section is from 0.00N 0.00E on azimuth 81.990 degrees  
Prepared by Integrated Petroleum Technologies, Inc.  
Date Printed: 4-Oct-2013



SYSDRILL  
Closest Approach + Clearance Factor Summary Report  
Wellbore: FRYE FARMS #13

Clearance Summary										
Offset WellName	Offset Wellbore	Offset Slot	Offset Structure	Separation [ft]	MD[ft]	Diverging From[ft]	Ellipse Separation [ft]	Ellipse MD[ft]	Clearance Factor	Clearance MD[ft]
#9	#9									
Pavistma South 4 #1-7-32-09 0-4-CH	Pavistma South 4 #1-7-32-090-4 -CH (PWB)	Slot #4	Pavistma South	1478.23	7061.71	7061.71	1424.05	7083.21	26.68	7280.06
RANCHO WATER VALLEY #10	RANCHO WATER VALLEY #10	Slot #10	Rancho Water Valley	1498.48	11835.96	11835.96	1440.13	11835.96	25.68	11835.96
HILLSIDE #17	HILLSIDE #17	Slot #17	Hillside	1537.46	11696.07	11696.07	1427.16	11709.19	13.92	11742.00
PAVISTMA #11	PAVISTMA #11	Slot #11	Pavistma	1688.80	6935.57	6935.57	1637.36	6951.98	32.26	7148.83
Pavistma South 5 #1-8-32-09 0-4-NH	Pavistma South 5 #1-8-32-090-4 -NH (PWB)	Slot #5	Pavistma South	1691.66	6820.74	6820.74	1639.36	6853.55	30.21	7362.08
RANCHO WATER VALLEY #7	RANCHO WATER VALLEY #7	Slot #07	Rancho Water Valley	1863.09	6892.17	6892.17	1804.78	6902.76	31.90	6984.78
HILLSIDE #18	HILLSIDE #18	Slot #18	Hillside	1865.20	11697.58	11697.58	1754.98	11713.00	16.87	11807.62
RANCHO WATER VALLEY #7	RANCHO WATER VALLEY #7 REV 1	Slot #07	Rancho Water Valley	1891.54	8116.67	8116.67	1833.13	11835.96	31.95	11835.96
PAVISTMA #12	PAVISTMA #12	Slot #12	Pavistma	2007.33	6955.29	6955.29	1955.06	6968.38	37.31	7280.06
RANCHO WATER VALLEY #6	RANCHO WATER VALLEY #6	Slot #06	Rancho Water Valley	2008.37	6713.18	6713.18	1949.87	6722.32	34.26	6837.15
HILLSIDE #15	HILLSIDE #15	Slot #15	Hillside	2035.64	11701.14	11701.14	1925.39	11713.00	18.38	11835.96
RANCHO WATER VALLEY #6	RANCHO WATER VALLEY #6 REV 1	Slot #06	Rancho Water Valley	2066.28	11835.96	11835.96	2007.33	11835.96	35.05	11835.96
RAINDANCE #6	RAINDANCE #6	Slot #6	Raindance	2165.94	7045.47	7045.47	1980.09	7034.00	11.63	6968.38
HILLSIDE #14	HILLSIDE #14	Slot #14	Hillside	2196.61	11701.90	11701.90	2086.18	11725.60	19.77	11835.96
RAINDANCE #5	RAINDANCE #5	Slot #5	Raindance	2300.82	6977.73	6977.73	2110.60	6968.38	12.07	6886.36
RANCHO WATER VALLEY #4	RANCHO WATER VALLEY #4	Slot #04	Rancho Water Valley	2394.80	8083.87	8083.87	2199.93	8078.50	12.29	8078.50
CENTER POINT #2	CENTER POINT #2	Slot #2	Center Point	2525.93	11703.53	11703.53	2443.74	11725.60	30.52	11835.96
RAINDANCE #4	RAINDANCE #4	Slot #4	Raindance	2621.15	6994.76	6994.76	2428.25	6984.78	13.58	6935.57
RANCHO WATER VALLEY #2-6-4	RANCHO WATER VALLEY #2-6-4 (AWB)	Slot #03	Rancho Water Valley	2646.67	10790.56	10790.56	2559.42	10790.56	30.29	10888.98
RANCHO	RANCHO	Slot #02	Rancho	2681.41	11835.96	11835.96	2616.56	11835.96	41.35	11835.96

All data is in Feet unless otherwise stated  
Coordinates are from Slot MD's are from Rig and TVD's are from Rig ( Planned Datum #1 4894.0ft above Mean Sea Level )  
Vertical Section is from 0.00N 0.00E on azimuth 81.990 degrees  
Prepared by Integrated Petroleum Technologies, Inc.  
Date Printed: 4-Oct-2013





SYSDRILL  
Closest Approach + Clearance Factor Summary Report  
Wellbore: FRYE FARMS #13

Clearance Summary										
Offset WellName	Offset Wellbore	Offset Slot	Offset Structure	Separation [ft]	MD[ft]	Diverging From[ft]	Ellipse Separation [ft]	Ellipse MD[ft]	Clearance Factor	Clearance MD[ft]
WATER VALLEY #2-8-4	WATER VALLEY 2-8-4 (AWB)		Water Valley							
CENTER POINT #1	CENTER POINT #1	Slot #1	Center Point	2695.63	11704.74	11704.74	2613.25	11725.60	32.46	11835.96
RAINDANCE CE #3	RAINDANCE #3	Slot #3	Raindance	2801.51	7066.81	7066.81	2609.01	7066.81	14.55	7034.00
PAVISTMA 11-32	PAVISTMA 11-32 (AWB)	PAVISTMA 11-32	Pavistma (Anadarko)	2826.64	5266.46	5266.46	2803.53	5266.46	114.89	6476.25
CENTER POINT #3	CENTER POINT #3	Slot #3	Center Point	2855.84	11709.19	11709.19	2773.64	11725.60	34.43	11835.96
RAINDANCE CE #2	RAINDANCE #2	Slot #2	Raindance	2942.66	7013.00	7013.00	2748.07	7001.19	15.12	6968.38
RANCHO WATER VALLEY #5	RANCHO WATER VALLEY #5	Slot #05	Rancho Water Valley	3051.71	8018.25	8018.25	2856.59	8011.33	15.64	8011.33
CENTER POINT #4	CENTER POINT #4	Slot #4	Center Point	3095.78	11709.19	11709.19	3013.37	11725.60	37.19	11835.96
HILLSIDE #11	HILLSIDE #11	Slot #11	Hillside	3177.92	6984.78	6984.78	3116.00	7001.19	48.78	7788.59
CENTER POINT #6	CENTER POINT #6	Slot #6	Center Point	3205.57	11709.19	11709.19	3123.43	11742.00	38.62	11835.96
RAINDANCE CE #9	RAINDANCE #9	Slot #9	Raindance	3213.00	7022.05	7022.05	3156.38	7034.00	55.97	7378.49
CENTER POINT #8 REV	CENTER POINT #8 REV (PWB)	Slot #8	Center Point	3264.39	11713.00	11713.00	3181.92	11742.00	39.17	11835.96
CENTER POINT #8	CENTER POINT #8	Slot #8	Center Point	3275.72	11713.00	11713.00	3193.26	11742.00	39.31	11835.96
HILLSIDE #16	HILLSIDE #16 (PWB)	Slot #16	Hillside	3313.28	6755.13	6755.13	3289.01	6771.53	107.70	8575.99
HILLSIDE #9	HILLSIDE #9	Slot #9	Hillside	3314.38	6755.13	6755.13	3265.32	6755.13	63.66	7640.95
HILLSIDE #10	HILLSIDE #10	Slot #10	Hillside	3333.33	6897.14	6897.14	3275.02	6913.00	53.56	8051.06
RANCHO WATER VALLEY #3-9-4	RANCHO WATER VALLEY #3-9-4 (AWB)	Slot #01	Rancho Water Valley	3384.97	11835.96	11835.96	3320.89	11835.96	52.83	11835.96
RAINDANCE CE #8	RAINDANCE #8	Slot #8	Raindance	3387.78	7083.21	7083.21	3330.87	7099.61	58.35	7493.31
HILLSIDE #7	HILLSIDE #7	Slot #7	Hillside	3395.00	6813.00	6813.00	3371.36	6820.74	114.71	8559.59
PAVISTMA 19-32	PAVISTMA 19-32 (AWB)	PAVISTMA 19-32	Pavistma (Anadarko)	3413.43	4732.33	4732.33	3388.70	4770.22	121.67	6525.47
RAINDANCE CE #7	RAINDANCE #7	Slot #7	Raindance	3430.09	7034.00	7034.00	3373.37	7034.00	59.19	7526.12
HILLSIDE #13	HILLSIDE #13 (PWB)	Slot #13	Hillside	3431.36	6705.91	6705.91	3409.22	6713.00	121.37	8625.20
Poudre #36-28	Poudre #36-28 (AWB)	Poudre #36-28	Poudre (Kerr-McGee Oil & Gas)	3431.92	9636.12	9636.12	3384.46	9658.67	68.01	10692.13

All data is in Feet unless otherwise stated  
Coordinates are from Slot MD's are from Rig and TVD's are from Rig ( Planned Datum #1 4894.0ft above Mean Sea Level )  
Vertical Section is from 0.00N 0.00E on azimuth 81.990 degrees  
Prepared by Integrated Petroleum Technologies, Inc.  
Date Printed: 4-Oct-2013



SYSDRILL  
Closest Approach + Clearance Factor Summary Report  
Wellbore: FRYE FARMS #13

Clearance Summary										
Offset WellName	Offset Wellbore	Offset Slot	Offset Structure	Separation [ft]	MD[ft]	Diverging From[ft]	Ellipse Separation [ft]	Ellipse MD[ft]	Clearance Factor	Clearance MD[ft]
HILLSIDE #8	HILLSIDE #8	Slot #8	Hillside	3432.45	6705.91	6705.91	3391.10	6713.00	77.31	7640.95
PAVISTMA 5-3-32	PAVISTMA 5-3-32 (AWB)	PAVISTMA 5-3-32	Pavistma	3444.54	4540.81	4540.81	3417.20	4540.81	122.70	5163.92
HILLSIDE #5	HILLSIDE #5	Slot #5	Hillside	3543.19	6673.10	6673.10	3509.05	6673.10	95.16	8001.85
HILLSIDE #12	HILLSIDE #12 (PWB)	Slot #12	Hillside	3543.50	6662.81	6662.81	3523.42	6673.10	137.08	8658.01
HILLSIDE #6	HILLSIDE #6	Slot #6	Hillside	3659.05	6613.00	6613.00	3633.27	6623.89	121.32	8149.48
HILLSIDE #6	HILLSIDE #6 REV	Slot #6	Hillside	3671.29	6607.49	6607.49	3653.63	6613.00	156.45	8690.82
HILLSIDE #3	HILLSIDE #3	Slot #3	Hillside	3679.73	6591.08	6591.08	3657.14	6591.08	138.56	8264.31
Anderson #1	Anderson #1 (AWB)	Anderson #1	Anderson (J.K. Wadley)	3812.51	1200.00	1200.00	3810.89	1200.00	696.26	6525.47
HILLSIDE #2	HILLSIDE #2	Slot #2	Hillside	3889.05	6492.66	6492.66	3875.29	6509.06	197.54	8969.69
HILLSIDE #9	HILLSIDE #9 REV	Slot #9	Hillside	3921.00	4721.01	4721.01	3910.04	5049.09	194.95	8772.84
HILLSIDE #4	HILLSIDE #4	Slot #4	Hillside	3930.58	6049.75	6049.75	3917.70	6345.02	203.12	9051.71
PAVISTMA 4-2-32	PAVISTMA 4-2-32 (AWB)	PAVISTMA 4-2-32	Pavistma	3943.86	1325.34	1325.34	3938.03	1374.55	110.89	6558.28
PAVISTMA 12-32	PAVISTMA 12-32 (AWB)	PAVISTMA 12-32	Pavistma (Anadarko)	3950.66	13.00	4914.60	3948.42	275.47	299.78	6722.32
HILLSIDE #1	HILLSIDE 2-4-32 (PWB)	Slot #1	Hillside	3953.86	3474.29	3474.29	3937.13	3638.33	114.53	6853.55
Poudre #14-28	Poudre #14-28 (AWB)	Poudre #14-28	Poudre (Kerr-McGee Oil & Gas)	3956.63	8955.16	8955.16	3924.11	9002.50	87.44	11167.86
HILLSIDE #8	HILLSIDE #8 REV (PWB)	Slot #8	Hillside	3976.24	866.02	866.02	3974.14	849.61	227.78	8083.87
HILLSIDE #5	HILLSIDE #5 REV (PWB)	Slot #5	Hillside	3992.72	966.00	966.00	3990.53	766.00	222.12	8346.33
PAVISTMA 5-1-32	PAVISTMA 5-1-32 (AWB)	PAVISTMA 5-1-32	Pavistma	4001.50	13.00	13.00	4000.30	13.00	239.66	6738.72
HILLSIDE #4	HILLSIDE #4 REV (PWB)	Slot #4	Hillside	4009.21	1062.87	2063.52	4006.90	1062.87	212.29	8543.18
HILLSIDE #1	HILLSIDE #1 (PWB)	Slot #1	Hillside	4010.61	2867.33	2867.33	4004.47	3064.18	208.06	8740.03
Poudre #15-28	Poudre #15-28 (AWB)	Poudre #15-28	Poudre (Kerr-McGee Oil & Gas)	4021.55	10207.57	10207.57	3957.37	10249.22	58.45	11299.09
Lind #13-32	Lind #13-32 (AWB)	Lind #13-32	Lind (Anadarko)	4052.38	4770.22	4770.22	4024.85	4819.43	137.67	6509.06
W Great Western #27-14	W Great Western #27-14 (AWB)	Great Western #27-14	Great Western (Great Western Oil & Gas)	4064.16	11835.96	11835.96	4015.82	11835.96	84.07	11835.96
Poudre	Poudre	Poudre	Poudre	4684.62	9517.92	9517.92	4642.58	9576.65	84.25	11835.96

All data is in Feet unless otherwise stated  
Coordinates are from Slot MD's are from Rig and TVD's are from Rig ( Planned Datum #1 4894.0ft above Mean Sea Level )  
Vertical Section is from 0.00N 0.00E on azimuth 81.990 degrees  
Prepared by Integrated Petroleum Technologies, Inc.  
Date Printed: 4-Oct-2013



SYSDRILL  
Closest Approach + Clearance Factor Summary Report  
Wellbore: FRYE FARMS #13

Clearance Summary										
Offset WellName	Offset Wellbore	Offset Slot	Offset Structure	Separation [ft]	MD[ft]	Diverging From[ft]	Ellipse Separation [ft]	Ellipse MD[ft]	Clearance Factor	Clearance MD[ft]
#23-28	#23-28 (AWB)	#23-28	(Kerr-McGee Oil & Gas)							
Poudre #19-28	Poudre #19-28 (AWB)	Poudre #19-28	Poudre (Kerr-McGee Oil & Gas)	4704.15	8313.52	8313.52	4663.38	8346.33	95.23	10396.86
W Great Western # 27-53	W Great Western # 27-53 (AWB)	Great Western # 27-53	Great Western (Great Western Oil & Gas)	4903.17	11835.96	11835.96	4856.71	11835.96	105.54	11835.96
Poudre #10-28	Poudre #10-28 (AWB)	Poudre #10-28	Poudre (Kerr-McGee Oil & Gas)	5318.32	10216.41	10216.41	5251.26	10282.03	65.04	11835.96
Poudre #11-28	Poudre #11-28 (AWB)	Poudre #11-28	Poudre (Kerr-McGee Oil & Gas)	5345.80	8953.29	8953.29	5308.80	9002.50	99.24	11835.96
Great Western 27-13	W #12 Great Western 27-13 (AWB)	Great Western #27-13	Great Western (Great Western Oil & Gas)	5397.06	11835.96	11835.96	5347.76	11835.96	109.47	11835.96
W Great Western #27-23	W Great Western #27-23 (AWB)	Great Western #27-23	Great Western (Great Western Oil & Gas)	5644.19	11835.96	11835.96	5599.43	11835.96	126.10	11835.96
Kodak #15	Kodak #15	Slot #15	Kodak	5804.47	9561.01	9561.01	5739.38	9593.05	87.66	11835.96
Poudre #25-28	Poudre #25-28 (AWB)	Poudre #25-28	Poudre (Kerr-McGee Oil & Gas)	5857.52	144.23	9524.70	5840.73	9593.05	82.32	11835.96
Kodak #14	Kodak #14	Slot #14	Kodak	5982.98	11800.33	11800.33	5917.40	11835.96	91.17	11835.96
RAINDAN CE 1 #1-1-32	RAINDANCE 1 #1-1-32 (PWB)	Slot #1	Raindance	6090.69	6469.02	6469.02	6074.87	6480.24	324.54	8953.29
Kodak #13	Kodak #13	Slot #13	Kodak	6145.28	11813.00	11813.00	6079.75	11835.96	93.69	11835.96
Kodak #12	Kodak #12	Slot #12	Kodak	6474.96	11835.96	11835.96	6409.74	11835.96	99.28	11823.33
Kodak #11	Kodak #11	Slot #11	Kodak	6641.84	11835.96	11835.96	6576.90	11835.96	102.27	11835.96
W Great Western #27-12	W Great Western #27-12 (AWB)	Great Western #27-12	Great Western 66N67W	6701.65	11835.96	11835.96	6651.81	11835.96	134.45	11835.96
W Great Western #27-22	W Great Western #27-22 (AWB)	Great Western #27-22	Great Western 66N67W	6754.53	11835.96	11835.96	6708.97	11835.96	148.25	11835.96
Kodak #10	Kodak #10	Slot #10	Kodak	6804.45	11835.96	11835.96	6739.53	11835.96	104.81	11835.96
Kodak #9	Kodak #9	Slot #9	Kodak	7133.61	11835.96	11835.96	7069.20	11835.96	110.76	11835.96
Kodak #8	Kodak #8	Slot #8	Kodak	7299.18	11835.96	11835.96	7235.59	11835.96	114.51	11613.00
H-Y #29-51	H-Y #29-51 (AWB)	H-Y #29-51	Great Western H-Y Pad	7434.19	6935.57	6935.57	7405.93	6951.98	169.12	11742.00
Kodak #7	Kodak #7	Slot #7	Kodak	7461.90	11835.96	11835.96	7398.36	11835.96	117.13	11613.00
W Great Western #27-52	W Great Western #27-52 (AWB)	Great Western #27-52	Great Western 66N67W	7468.71	11835.96	11835.96	7419.99	11835.96	153.29	11835.96

All data is in Feet unless otherwise stated  
Coordinates are from Slot MD's are from Rig and TVD's are from Rig ( Planned Datum #1 4894.0ft above Mean Sea Level )  
Vertical Section is from 0.00N 0.00E on azimuth 81.990 degrees  
Prepared by Integrated Petroleum Technologies, Inc.  
Date Printed: 4-Oct-2013



SYSDRILL  
Closest Approach + Clearance Factor Summary Report  
Wellbore: FRYE FARMS #13

Clearance Summary										
Offset WellName	Offset Wellbore	Offset Slot	Offset Structure	Separation [ft]	MD[ft]	Diverging From[ft]	Ellipse Separation [ft]	Ellipse MD[ft]	Clearance Factor	Clearance MD[ft]
H-Y #29-31-8	H-Y #29-31-8 (AWB)	H-Y #29-31-8	Great Western H-Y Pad	7780.91	6673.10	6673.10	7763.62	6673.10	219.78	11835.96
Kodak #6	Kodak #6	Slot #6	Kodak	7784.81	11835.96	11835.96	7724.00	11835.96	122.42	11594.36
Great Western 27-31-8	Great Western 27-31-8 (AWB)	Great Western 27-31-8	Great Western Diamond Valley	7873.10	11835.96	11835.96	7827.78	11835.96	173.72	11835.96
Kodak #5	Kodak #5	Slot #5	Kodak	7924.01	11835.96	11835.96	7864.63	11835.96	125.11	11430.32
W Great Western #27-11	W Great Western #27-11 (AWB)	Great Western #27-11	Great Western 66N67W	8011.84	11835.96	11835.96	7961.68	11835.96	159.71	11835.96
Kodak #4	Kodak #4	Slot #4	Kodak	8080.83	11835.96	11835.96	8021.62	11835.96	127.71	11364.71
H-Y #29-31	H-Y #29-31 (AWB)	H-Y #29-31	Great Western H-Y Pad	8259.96	6787.93	6787.93	8236.42	6787.93	188.39	11835.96
H-Y #29-52	H-Y #29-52 (AWB)	H-Y #29-52	Great Western H-Y Pad	8262.72	6574.68	6574.68	8243.59	6574.68	237.49	11835.96
W Great Western #27-21	W Great Western #27-21 (AWB)	Great Western #27-21	Great Western 66N67W	8304.40	11835.96	11835.96	8256.76	11835.96	174.30	11835.96
Kodak #3	Kodak #3	Slot #3	Kodak	8349.20	11835.96	11835.96	8290.80	11835.96	133.09	10954.60
Kodak #2	Kodak #2	Slot #2	Kodak	8451.73	11835.96	11835.96	8393.84	11835.96	135.74	7362.08
H-Y #29-21	H-Y #29-21 (AWB)	H-Y #29-21	Great Western H-Y Pad	8493.15	6623.89	6623.89	8460.90	6640.30	176.36	11835.96
Kodak #1	Kodak #1	Slot #1	Kodak	8594.95	11835.96	11835.96	8537.48	11835.96	138.19	7345.68
DVE #1	DVE #1 (PWB)	Slot #1	Diamond Valley East	8653.39	11835.96	11835.96	8559.47	11835.96	92.14	11835.96
H-Y #29-31-2	H-Y #29-31-2 (AWB)	H-Y #29-31-2	Great Western H-Y Pad	8794.92	6951.98	6951.98	8764.65	6984.78	161.73	11835.96
DVE #2	DVE #2 (PWB)	Slot #2	Diamond Valley East	8816.11	11835.96	11835.96	8722.07	11835.96	93.75	11835.96
H-Y #20-54	H-Y #20-54 (AWB)	H-Y #20-54	Great Western H-Y Pad	8915.87	313.00	2132.22	8914.55	357.49	160.50	11835.96
H-Y #29-21-4	H-Y #29-21-4 (AWB)	H-Y #29-21-4	Great Western H-Y Pad	8918.63	313.00	313.00	8917.32	324.68	257.70	11835.96
W H-Y #20-34	W H-Y #20-34 (AWB)	H-Y #20-34	Great Western H-Y Pad	8930.47	313.00	2034.35	8929.15	324.68	180.29	11835.96
H-Y #20-53	H-Y #20-53 (AWB)	H-Y #20-53	Great Western H-Y Pad	8933.80	313.00	313.00	8932.49	324.68	313.65	11835.96
H-Y #29-21-3	H-Y #29-21-3 (AWB)	H-Y #29-21-3	Great Western H-Y Pad	8945.65	313.00	6722.32	8944.33	324.68	209.84	11835.96
H-Y #20-24	H-Y #20-24 (AWB)	H-Y #20-24	Great Western H-Y Pad	8947.97	326.00	326.00	8946.63	341.08	227.97	11835.96

All data is in Feet unless otherwise stated  
Coordinates are from Slot MD's are from Rig and TVD's are from Rig ( Planned Datum #1 4894.0ft above Mean Sea Level )  
Vertical Section is from 0.00N 0.00E on azimuth 81.990 degrees  
Prepared by Integrated Petroleum Technologies, Inc.  
Date Printed: 4-Oct-2013



SYSDRILL  
Closest Approach + Clearance Factor Summary Report  
Wellbore: FRYE FARMS #13

Clearance Summary										
Offset WellName	Offset Wellbore	Offset Slot	Offset Structure	Separation [ft]	MD[ft]	Diverging From[ft]	Ellipse Separation [ft]	Ellipse MD[ft]	Clearance Factor	Clearance MD[ft]
H-Y #20-23-18	H-Y #20-23-18 (AWB)	H-Y #20-23-18	Great Western H-Y Pad	8959.70	313.00	313.00	8958.38	324.68	233.31	11835.96
H-Y #20-23	H-Y #20-23 (AWB)	H-Y #20-23	Great Western H-Y Pad	8963.73	313.00	313.00	8962.41	324.68	301.71	11835.96
Great Western 27-21-3	Great Western 27-21-3 (AWB)	Great Western 27-21-3	Great Western Diamond Valley	9096.81	11835.96	11835.96	9050.25	11835.96	195.37	11835.96
DIAMOND VALLEY SW #1	DIAMOND VALLEY SW #1	Slot #1	Diamond Valley SW	9112.07	11835.96	11835.96	9038.74	11835.96	124.25	11835.96
DIAMOND VALLEY SW #1	DIAMOND VALLEY SW #1 REV	Slot #1	Diamond Valley SW	9114.92	11835.96	11835.96	9042.01	11835.96	124.98	7345.68
DVE #3	DVE #3 (PWB)	Slot #3	Diamond Valley East	9144.83	11835.96	11835.96	9050.53	11835.96	96.97	11835.96
Great Western 27-41-10	Great Western 27-41-10 (AWB)	Great Western 27-41-10	Great Western Diamond Valley	9180.11	11835.96	11835.96	9142.62	11835.96	244.88	11835.96
DIAMOND VALLEY SW #2	DIAMOND VALLEY SW #2	Slot #2	Diamond Valley SW	9278.35	11835.96	11835.96	9204.99	11835.96	126.48	11835.96
DIAMOND VALLEY SW #2	DIAMOND VALLEY SW #2 REV	Slot #2	Diamond Valley SW	9281.10	11835.96	11835.96	9208.19	11835.96	127.25	7345.68
DVE #4	DVE #4 (PWB)	Slot #4	Diamond Valley East	9310.72	11835.96	11835.96	9216.28	11835.96	98.59	11835.96
DIAMOND VALLEY SW #5	DIAMOND VALLEY SW 8-2-22 (PWB)	Slot #5	Diamond Valley SW	9316.48	11835.96	11835.96	9228.37	11835.96	105.74	11835.96
DIAMOND VALLEY SW #3	DIAMOND VALLEY SW #3	Slot #3	Diamond Valley SW	9442.15	11835.96	11835.96	9368.84	11835.96	128.78	11835.96
DIAMOND VALLEY SW #3	DIAMOND VALLEY SW #3 REV	Slot #3	Diamond Valley SW	9444.84	11835.96	11835.96	9371.96	11835.96	129.48	7345.68
DVE #5	DVE #5 (PWB)	Slot #5	Diamond Valley East	9473.64	11835.96	11835.96	9379.09	11835.96	100.19	11835.96
DIAMOND VALLEY SW #2	DIAMOND VALLEY SW 8-4-22 (PWB)	Slot #2	Diamond Valley SW	9558.02	11835.96	11835.96	9504.87	11835.96	179.81	11835.96
Great Western 27-31-2	Great Western 27-31-2 (AWB)	Great Western 27-31-2	Great Western Diamond Valley	9603.15	11835.96	11835.96	9559.68	11835.96	220.92	11835.96
DIAMOND VALLEY SW #4	DIAMOND VALLEY SW #4	Slot #4	Diamond Valley SW	9771.87	11835.96	11835.96	9698.58	11835.96	133.35	11835.96
DIAMOND VALLEY SW #4	DIAMOND VALLEY SW #4 REV	Slot #4	Diamond Valley SW	9774.76	11835.96	11835.96	9701.87	11835.96	133.96	7345.68
DVE #6	DVE #6 (PWB)	Slot #6	Diamond Valley East	9802.53	11835.96	11835.96	9707.72	11835.96	103.39	11835.96

All data is in Feet unless otherwise stated  
Coordinates are from Slot MD's are from Rig and TVD's are from Rig ( Planned Datum #1 4894.0ft above Mean Sea Level )  
Vertical Section is from 0.00N 0.00E on azimuth 81.990 degrees  
Prepared by Integrated Petroleum Technologies, Inc.  
Date Printed: 4-Oct-2013



SYSDRILL  
Closest Approach + Clearance Factor Summary Report  
Wellbore: FRYE FARMS #13

Clearance Summary										
Offset WellName	Offset Wellbore	Offset Slot	Offset Structure	Separation [ft]	MD[ft]	Diverging From[ft]	Ellipse Separation [ft]	Ellipse MD[ft]	Clearance Factor	Clearance MD[ft]
Diamond Valley 22-34	Diamond Valley 22-34 (AWB)	Diamond Valley 22-34	Great Western Diamond Valley	9861.91	11835.96	11835.96	9816.36	11835.96	216.50	11835.96
Altergott #1	Altergott #1 (AWB)	Altergott #1	DVE Offset	9911.88	11835.96	11835.96	9860.27	11835.96	192.04	11835.96
DIAMOND VALLEY SW #5	DIAMOND VALLEY SW #5	Slot #5	Diamond Valley SW	9938.24	11835.96	11835.96	9864.96	11835.96	135.61	11835.96
DIAMOND VALLEY SW #5	DIAMOND VALLEY SW #5 REV	Slot #5	Diamond Valley SW	9941.11	11835.96	11835.96	9868.19	11835.96	136.23	7345.68
DVE #7	DVE #7 (PWB)	Slot #7	Diamond Valley East	9968.39	11835.96	11835.96	9873.45	11835.96	105.00	11835.96
DIAMOND VALLEY SW #7	DIAMOND VALLEY SW 7-3-22 (PWB)	Slot #7	Diamond Valley SW	10064.67	11835.96	11835.96	9992.49	11835.96	139.44	11835.96
DIAMOND VALLEY SW #6	DIAMOND VALLEY SW #6 REV	Slot #6	Diamond Valley SW	10084.40	11835.96	11835.96	10021.37	11835.96	132.33	7772.19
DVE #8	DVE #8 (PWB)	Slot #8	Diamond Valley East	10131.48	11835.96	11835.96	10036.42	11835.96	106.59	11835.96
DIAMOND VALLEY SW #6	DIAMOND VALLEY SW #6	Slot #6	Diamond Valley SW	10144.22	11835.96	11835.96	10072.54	11835.96	132.26	7739.38
Great Western 27-41-1	Great Western 27-41-1 (AWB)	Great Western 27-41-1	Great Western Diamond Valley	10261.27	11835.96	11835.96	10221.21	11835.96	256.15	11835.96
Diamond Valley 22-23-18	Diamond Valley 22-23-18 (AWB)	Diamond Valley 22-23-18	Great Western Diamond Valley	10369.08	11835.96	11835.96	10321.66	11835.96	218.65	11835.96
DIAMOND VALLEY SW #7	DIAMOND VALLEY SW #7 REV	Slot #7	Diamond Valley SW	10402.03	11835.96	11835.96	10340.54	11835.96	142.91	7329.27
DIAMOND VALLEY SW #7	DIAMOND VALLEY SW #7	Slot #7	Diamond Valley SW	10431.62	11835.96	11835.96	10358.23	11835.96	142.13	11835.96
DVE #9	DVE #9 (PWB)	Slot #9	Diamond Valley East	10460.49	11835.96	11835.96	10365.18	11835.96	109.76	11835.96
DIAMOND VALLEY SW #8	DIAMOND VALLEY SW 6-2-22 (PWB)	Slot #8	Diamond Valley SW	10478.96	11835.96	11835.96	10396.43	11835.96	126.96	11835.96
Diamond Valley 22-44	Diamond Valley 22-44 (AWB)	Diamond Valley 22-44	Great Western Diamond Valley	10503.95	11835.96	11835.96	10461.32	11835.96	246.38	11835.96
DIAMOND VALLEY SW #8	DIAMOND VALLEY SW #8 REV	Slot #8	Diamond Valley SW	10512.46	11835.96	11835.96	10451.85	11835.96	145.16	7345.68
DIAMOND VALLEY SW #8	DIAMOND VALLEY SW #8	Slot #8	Diamond Valley SW	10597.94	11835.96	11835.96	10524.48	11835.96	144.28	11835.96
DVE #10	DVE #10 (PWB)	Slot #10	Diamond Valley East	10626.33	11835.96	11835.96	10530.90	11835.96	111.36	11835.96

All data is in Feet unless otherwise stated  
Coordinates are from Slot MD's are from Rig and TVD's are from Rig ( Planned Datum #1 4894.0ft above Mean Sea Level )  
Vertical Section is from 0.00N 0.00E on azimuth 81.990 degrees  
Prepared by Integrated Petroleum Technologies, Inc.  
Date Printed: 4-Oct-2013



SYSDRILL  
Closest Approach + Clearance Factor Summary Report  
Wellbore: FRYE FARMS #13

Clearance Summary										
Offset WellName	Offset Wellbore	Offset Slot	Offset Structure	Separation [ft]	MD[ft]	Diverging From[ft]	Ellipse Separation [ft]	Ellipse MD[ft]	Clearance Factor	Clearance MD[ft]
DIAMOND VALLEY SW #9	DIAMOND VALLEY SW #9 REV	Slot #9	Diamond Valley SW	10650.07	11835.96	11835.96	10590.06	11835.96	147.33	7345.68
Diamond Valley 22-54	Diamond Valley 22-54 (AWB)	Diamond Valley 22-54	Great Western Diamond Valley	10710.17	11835.96	11835.96	10666.88	11835.96	247.40	11835.96
DIAMOND VALLEY SW #9	DIAMOND VALLEY SW #9	Slot #9	Diamond Valley SW	10761.70	11835.96	11835.96	10688.22	11835.96	146.46	11835.96
DIAMOND VALLEY SW 10	DIAMOND VALLEY SW 6-4-22 (PWB)	Slot #10	Diamond Valley SW	10761.75	11835.96	11835.96	10703.20	11835.96	183.80	11835.96
DVE #11	DVE #11 (PWB)	Slot #11	Diamond Valley East	10789.56	11835.96	11835.96	10694.01	11835.96	112.92	11835.96
Diamond Valley 22-22-13	Diamond Valley 22-22-13 (AWB)	Diamond Valley 22-22-13	Great Western Diamond Valley	10873.82	11835.96	11835.96	10833.03	11835.96	266.55	11835.96
Diamond Valley 22-33	Diamond Valley 22-33 (AWB)	Diamond Valley 22-33	Great Western Diamond Valley	10930.24	11835.96	11835.96	10889.12	11835.96	265.76	11835.96
Diamond Valley 22-32-12	Diamond Valley 22-32-12 (AWB)	Diamond Valley 22-32-12	Great Western Diamond Valley	11025.73	11835.96	11835.96	10985.99	11835.96	277.47	11835.96
Diamond Valley 22-43	Diamond Valley 22-43 (AWB)	Diamond Valley 22-43	Great Western Diamond Valley	11071.66	11835.96	11835.96	11032.37	11835.96	281.77	11835.96
DVE #12	DVE #12 (PWB)	Slot #12	Diamond Valley East	11118.68	11835.96	11835.96	11022.89	11835.96	116.06	11835.96
DIAMOND VALLEY SW 10	DIAMOND VALLEY SW 10 #3-4-22-270-6 -NH (PWB)	Slot #10	Diamond Valley SW	11191.02	11835.96	11835.96	11141.06	11835.96	154.15	7345.68
DVE #13	DVE #13 (PWB)	Slot #13	Diamond Valley East	11278.36	11835.96	11835.96	11182.45	11835.96	117.59	11835.96
WINDER #1-9	WINDER #1-9 (AWB)	WINDER #1-9	WINDER OFFSETS	24168.57	11713.00	11713.00	24115.01	11835.96	448.30	11835.96