

Well Name: **Booth 24-26**

Surface Location: Booth 9 Pad Sec.26-T7N-R65W  
 North American Datum 1983 US State Plane 1983 Colorado Northern Zone

Ground Elevation: 4893.0

+N/-S	+E/-W	Northing	Easting	Latitude	Longitude	Slot
0.0	0.0	1444950.06	3242064.77	40.551524	-104.628898	
Original Well Elev WELL @ 4909.0ft (Original Well Elev)						

## BAYSWATER EXPLORATION & PRODUCTION

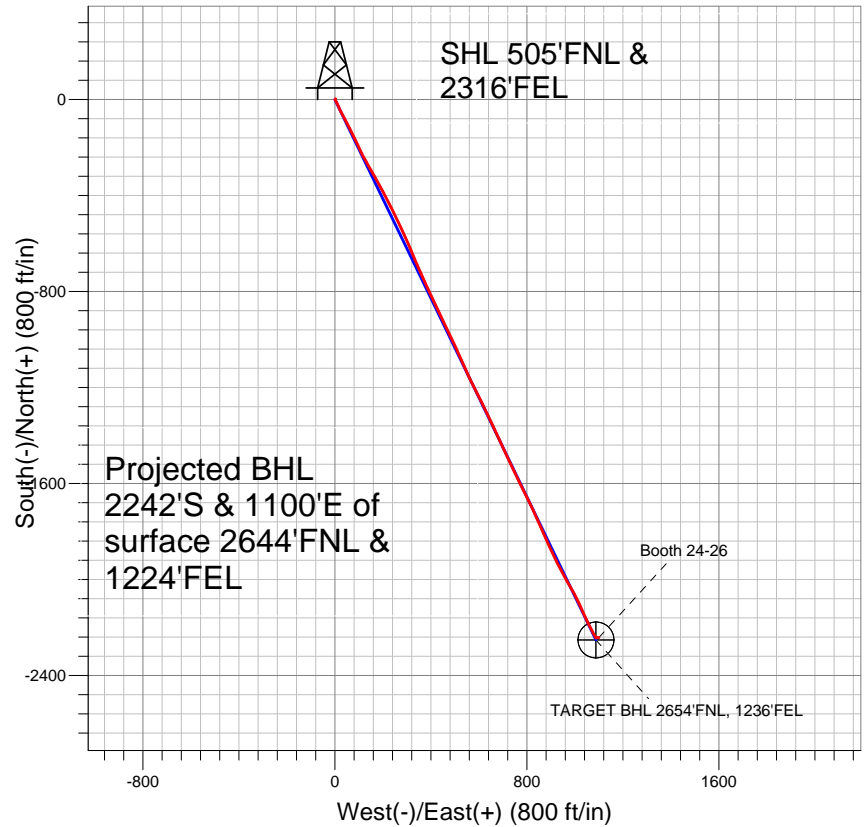
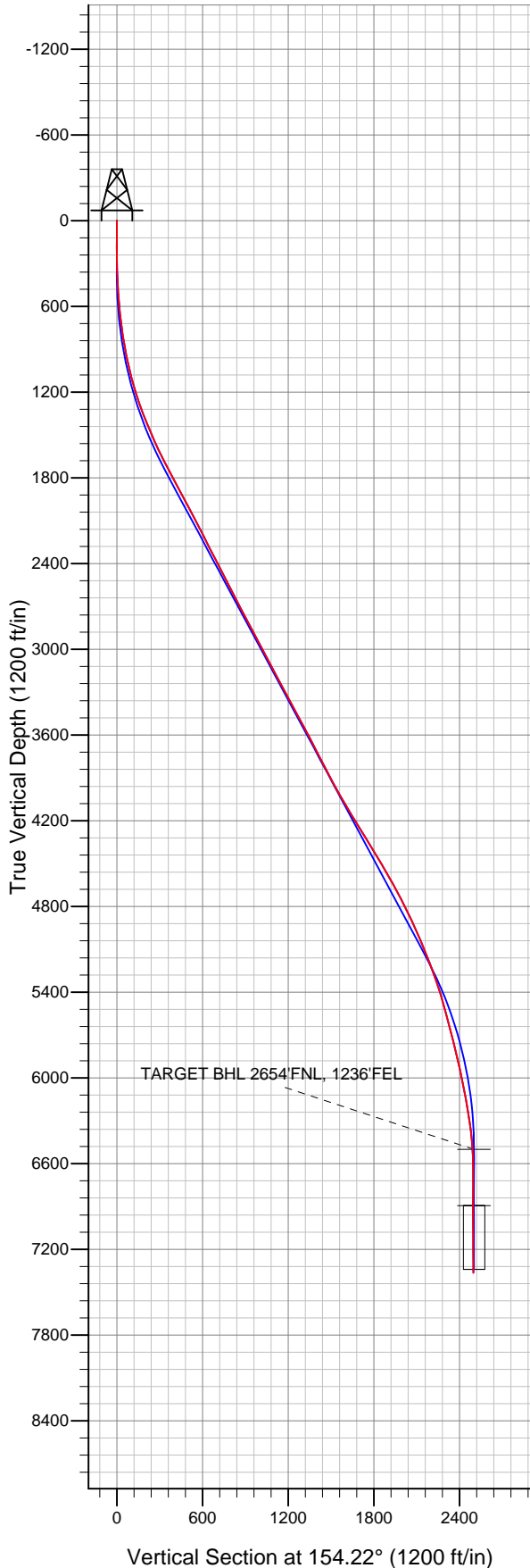

### LEGEND

- ◆ Booth 24-26, Wellbore #1, Plan #1 (10-18-12) R V0
- Wellbore #1
- Survey #1

## Final Survey Plot

Projected Final Survey -  
 7920'MD & 7364'TVD @ 2497'VS  
 0.7 deg Inc 120.6 deg AZ

Project: SEC.26-T7N-R65W  
 Site: Booth 9 Pad Sec.26-T7N-R65W  
 Well: Booth 24-26  
 Plan: Wellbore #1



## **Directional**

# **BAYSWATER EXPLORATION & PRODUCTION**

**SEC.26-T7N-R65W**

**Booth 9 Pad Sec.26-T7N-R65W**

**Booth 24-26**

**Wellbore #1**

**Survey: Survey #1**

## **Standard Survey Report**

**29 October, 2012**

Survey										
	Measured Depth (ft)	Inclination (°)	Azimuth (°)	Vertical Depth (ft)	+N/-S (ft)	+E/-W (ft)	Vertical Section (ft)	Dogleg Rate (°/100ft)	Build Rate (°/100ft)	Turn Rate (°/100ft)
Survey	0.0	0.00	0.00	0.0	0.0	0.0	0.0	0.00	0.00	0.00
	96.0	1.00	36.10	96.0	0.7	0.5	-0.4	1.04	1.04	0.00
	183.0	0.90	57.50	183.0	1.7	1.5	-0.8	0.42	-0.11	24.60
	273.0	0.90	181.30	273.0	1.3	2.1	-0.3	1.76	0.00	137.56
	364.0	1.40	195.00	364.0	-0.5	1.8	1.2	0.62	0.55	15.05
	455.0	2.60	163.40	454.9	-3.5	2.1	4.1	1.74	1.32	-34.73
	546.0	5.30	147.90	545.7	-9.0	4.9	10.3	3.16	2.97	-17.03
	639.0	6.70	153.30	638.2	-17.5	9.6	20.0	1.62	1.51	5.81
	733.0	7.60	156.90	731.4	-28.2	14.5	31.7	1.07	0.96	3.83
	831.0	9.10	153.50	828.4	-41.0	20.5	45.9	1.61	1.53	-3.47
	924.0	10.90	154.00	920.0	-55.5	27.7	62.0	1.94	1.94	0.54
	1,018.0	12.10	152.40	1,012.1	-72.3	36.1	80.8	1.32	1.28	-1.70

<b>Company:</b>	BAYSWATER EXPLORATION & PRODUCTION	<b>Local Co-ordinate Reference:</b>	Well Booth 24-26
<b>Project:</b>	SEC.26-T7N-R65W	<b>TVD Reference:</b>	WELL @ 4909.0ft (Original Well Elev)
<b>Site:</b>	Booth 9 Pad Sec.26-T7N-R65W	<b>MD Reference:</b>	WELL @ 4909.0ft (Original Well Elev)
<b>Well:</b>	Booth 24-26	<b>North Reference:</b>	True
<b>Wellbore:</b>	Wellbore #1	<b>Survey Calculation Method:</b>	Minimum Curvature
<b>Design:</b>	Wellbore #1	<b>Database:</b>	Landmark

Survey									
Measured Depth (ft)	Inclination (°)	Azimuth (°)	Vertical Depth (ft)	+N/-S (ft)	+E/-W (ft)	Vertical Section (ft)	Dogleg Rate (°/100ft)	Build Rate (°/100ft)	Turn Rate (°/100ft)
1,112.0	14.50	153.50	1,103.6	-91.5	46.0	102.4	2.57	2.55	1.17
1,205.0	17.10	152.10	1,193.0	-114.0	57.6	127.7	2.83	2.80	-1.51
1,299.0	19.70	152.80	1,282.2	-140.3	71.3	157.4	2.78	2.77	0.74
1,393.0	21.60	154.90	1,370.2	-170.1	85.8	190.5	2.17	2.02	2.23
1,487.0	22.90	154.70	1,457.2	-202.3	101.0	226.1	1.39	1.38	-0.21
1,580.0	23.60	152.40	1,542.6	-235.2	117.4	262.8	1.23	0.75	-2.47
1,674.0	25.90	149.80	1,628.0	-269.6	136.4	302.1	2.71	2.45	-2.77
1,768.0	28.00	151.50	1,711.8	-306.7	157.3	344.6	2.38	2.23	1.81
1,861.0	28.30	151.20	1,793.8	-345.2	178.3	388.4	0.36	0.32	-0.32
1,955.0	28.80	150.70	1,876.4	-384.5	200.1	433.3	0.59	0.53	-0.53
2,049.0	27.60	152.60	1,959.2	-423.6	221.2	477.6	1.59	-1.28	2.02
2,142.0	27.20	154.00	2,041.8	-461.8	240.5	520.4	0.82	-0.43	1.51
2,236.0	27.30	154.90	2,125.3	-500.6	259.0	563.5	0.45	0.11	0.96
2,330.0	27.30	155.40	2,208.9	-539.8	277.1	606.6	0.24	0.00	0.53
2,423.0	27.30	154.70	2,291.5	-578.4	295.1	649.2	0.35	0.00	-0.75
2,517.0	27.30	157.00	2,375.0	-617.8	312.8	692.3	1.12	0.00	2.45
2,611.0	27.80	157.70	2,458.4	-657.9	329.5	735.7	0.63	0.53	0.74
2,704.0	27.30	156.80	2,540.8	-697.6	346.1	778.7	0.70	-0.54	-0.97
2,798.0	26.70	155.90	2,624.6	-736.7	363.2	821.3	0.77	-0.64	-0.96
2,892.0	27.20	154.50	2,708.4	-775.3	381.1	863.9	0.86	0.53	-1.49
2,986.0	28.00	154.90	2,791.7	-814.7	399.7	907.5	0.87	0.85	0.43
3,079.0	27.90	153.80	2,873.8	-854.0	418.6	951.0	0.56	-0.11	-1.18
3,173.0	28.20	155.90	2,956.8	-894.0	437.4	995.2	1.10	0.32	2.23
3,267.0	27.40	155.00	3,039.9	-933.9	455.6	1,039.1	0.96	-0.85	-0.96
3,360.0	28.70	154.00	3,122.0	-973.3	474.4	1,082.8	1.49	1.40	-1.08
3,454.0	27.80	154.00	3,204.8	-1,013.3	493.9	1,127.3	0.96	-0.96	0.00
3,548.0	28.80	156.30	3,287.6	-1,053.8	512.6	1,171.8	1.57	1.06	2.45
3,641.0	28.00	155.10	3,369.4	-1,094.1	530.8	1,216.1	1.06	-0.86	-1.29
3,735.0	28.00	156.30	3,452.4	-1,134.3	549.0	1,260.2	0.60	0.00	1.28
3,829.0	28.40	154.00	3,535.2	-1,174.6	567.7	1,304.6	1.23	0.43	-2.45
3,922.0	27.80	152.90	3,617.3	-1,213.8	587.2	1,348.4	0.85	-0.65	-1.18
4,016.0	27.90	153.80	3,700.4	-1,253.0	606.9	1,392.3	0.46	0.11	0.96
4,110.0	26.90	154.50	3,783.8	-1,292.0	625.8	1,435.5	1.12	-1.06	0.74
4,204.0	26.70	154.20	3,867.7	-1,330.2	644.1	1,477.9	0.26	-0.21	-0.32
4,297.0	28.70	155.40	3,950.1	-1,369.3	662.5	1,521.1	2.23	2.15	1.29
4,391.0	30.20	155.60	4,031.9	-1,411.3	681.7	1,567.3	1.60	1.60	0.21
4,485.0	31.30	154.90	4,112.7	-1,455.0	701.8	1,615.4	1.23	1.17	-0.74
4,578.0	31.70	154.00	4,192.0	-1,498.8	722.8	1,664.0	0.66	0.43	-0.97
4,672.0	31.30	154.50	4,272.2	-1,543.1	744.1	1,713.1	0.51	-0.43	0.53
4,766.0	31.00	154.90	4,352.6	-1,587.0	764.9	1,761.7	0.39	-0.32	0.43
4,859.0	31.00	153.60	4,432.3	-1,630.1	785.7	1,809.6	0.72	0.00	-1.40
4,953.0	30.50	153.60	4,513.1	-1,673.2	807.1	1,857.7	0.53	-0.53	0.00
5,047.0	29.90	155.40	4,594.4	-1,715.9	827.4	1,905.0	1.16	-0.64	1.91
5,140.0	28.80	155.70	4,675.4	-1,757.4	846.3	1,950.5	1.19	-1.18	0.32
5,234.0	27.60	155.70	4,758.3	-1,797.8	864.6	1,994.9	1.28	-1.28	0.00
5,328.0	25.80	155.70	4,842.2	-1,836.3	882.0	2,037.2	1.91	-1.91	0.00
5,421.0	24.60	155.90	4,926.4	-1,872.5	898.2	2,076.7	1.29	-1.29	0.22
5,515.0	23.70	154.70	5,012.2	-1,907.4	914.3	2,115.2	1.09	-0.96	-1.28
5,609.0	21.90	151.00	5,098.8	-1,939.8	930.8	2,151.6	2.45	-1.91	-3.94
5,703.0	21.50	152.40	5,186.1	-1,970.4	947.3	2,186.3	0.70	-0.43	1.49
5,796.0	19.80	151.90	5,273.2	-1,999.4	962.6	2,219.1	1.84	-1.83	-0.54
5,890.0	18.00	149.40	5,362.1	-2,026.0	977.5	2,249.5	2.10	-1.91	-2.66
5,984.0	16.30	151.40	5,451.9	-2,050.0	991.2	2,277.1	1.91	-1.81	2.13

<b>Company:</b>	BAYSWATER EXPLORATION & PRODUCTION	<b>Local Co-ordinate Reference:</b>	Well Booth 24-26
<b>Project:</b>	SEC.26-T7N-R65W	<b>TVD Reference:</b>	WELL @ 4909.0ft (Original Well Elev)
<b>Site:</b>	Booth 9 Pad Sec.26-T7N-R65W	<b>MD Reference:</b>	WELL @ 4909.0ft (Original Well Elev)
<b>Well:</b>	Booth 24-26	<b>North Reference:</b>	True
<b>Wellbore:</b>	Wellbore #1	<b>Survey Calculation Method:</b>	Minimum Curvature
<b>Design:</b>	Wellbore #1	<b>Database:</b>	Landmark

Survey									
Measured Depth (ft)	Inclination (°)	Azimuth (°)	Vertical Depth (ft)	+N/-S (ft)	+E/-W (ft)	Vertical Section (ft)	Dogleg Rate (°/100ft)	Build Rate (°/100ft)	Turn Rate (°/100ft)
6,077.0	15.10	151.50	5,541.4	-2,072.1	1,003.3	2,302.2	1.29	-1.29	0.11
6,171.0	15.00	152.80	5,632.2	-2,093.7	1,014.7	2,326.6	0.37	-0.11	1.38
6,265.0	14.00	157.70	5,723.2	-2,115.1	1,024.5	2,350.1	1.68	-1.06	5.21
6,358.0	13.50	155.70	5,813.6	-2,135.4	1,033.3	2,372.2	0.74	-0.54	-2.15
6,452.0	12.80	155.20	5,905.1	-2,154.8	1,042.2	2,393.6	0.75	-0.74	-0.53
6,546.0	12.10	154.90	5,996.9	-2,173.2	1,050.7	2,413.9	0.75	-0.74	-0.32
6,639.0	10.60	153.80	6,088.1	-2,189.7	1,058.6	2,432.2	1.63	-1.61	-1.18
6,733.0	10.40	152.10	6,180.5	-2,205.0	1,066.4	2,449.3	0.39	-0.21	-1.81
6,827.0	8.40	151.40	6,273.2	-2,218.5	1,073.7	2,464.6	2.13	-2.13	-0.74
6,921.0	7.20	150.30	6,366.4	-2,229.6	1,079.9	2,477.4	1.29	-1.28	-1.17
7,014.0	5.50	149.10	6,458.8	-2,238.5	1,085.0	2,487.6	1.83	-1.83	-1.29
7,056.0	3.80	148.78	6,500.6	-2,241.4	1,086.8	2,491.0	4.04	-4.04	-0.76
TARGET BHL 2654'FNL, 1236'FEL									
7,108.0	1.70	147.50	6,552.6	-2,243.6	1,088.1	2,493.5	4.04	-4.04	-2.46
7,202.0	0.50	67.70	6,646.6	-2,244.6	1,089.2	2,494.9	1.79	-1.28	-84.89
7,295.0	0.50	48.90	6,739.6	-2,244.2	1,089.9	2,494.8	0.18	0.00	-20.22
7,389.0	0.70	58.20	6,833.6	-2,243.6	1,090.7	2,494.7	0.24	0.21	9.89
7,449.3	0.96	59.75	6,893.9	-2,243.1	1,091.5	2,494.6	0.43	0.43	2.57
TARGET CIRCLE 2654'FNL & 1236'FEL									
7,483.0	1.10	60.30	6,927.5	-2,242.8	1,092.0	2,494.5	0.43	0.43	1.63
7,576.0	1.60	80.90	7,020.5	-2,242.2	1,094.0	2,494.8	0.74	0.54	22.15
7,670.0	1.10	90.40	7,114.5	-2,242.0	1,096.2	2,495.6	0.58	-0.53	10.11
7,764.0	0.80	87.00	7,208.5	-2,242.0	1,097.8	2,496.3	0.32	-0.32	-3.62
7,858.0	0.80	98.10	7,302.5	-2,242.0	1,099.1	2,496.9	0.16	0.00	11.81
7,920.0	0.70	120.60	7,364.5	-2,242.3	1,099.9	2,497.4	0.50	-0.16	36.29

Checked By: \_\_\_\_\_ Approved By: \_\_\_\_\_ Date: \_\_\_\_\_