

MENDELL ENERGY, LLC

Location	ADAMS COUNTY, CO	Slot	Slot #4
Field	SPINDLE	Well	AFTON #12-16H-4
Installation	AFTON	Wellbore	AFTON #12-16H-4 (PWB)

<- West (feet) : East (feet) ->

Scale 1 cm = 200 ft -400 0 400

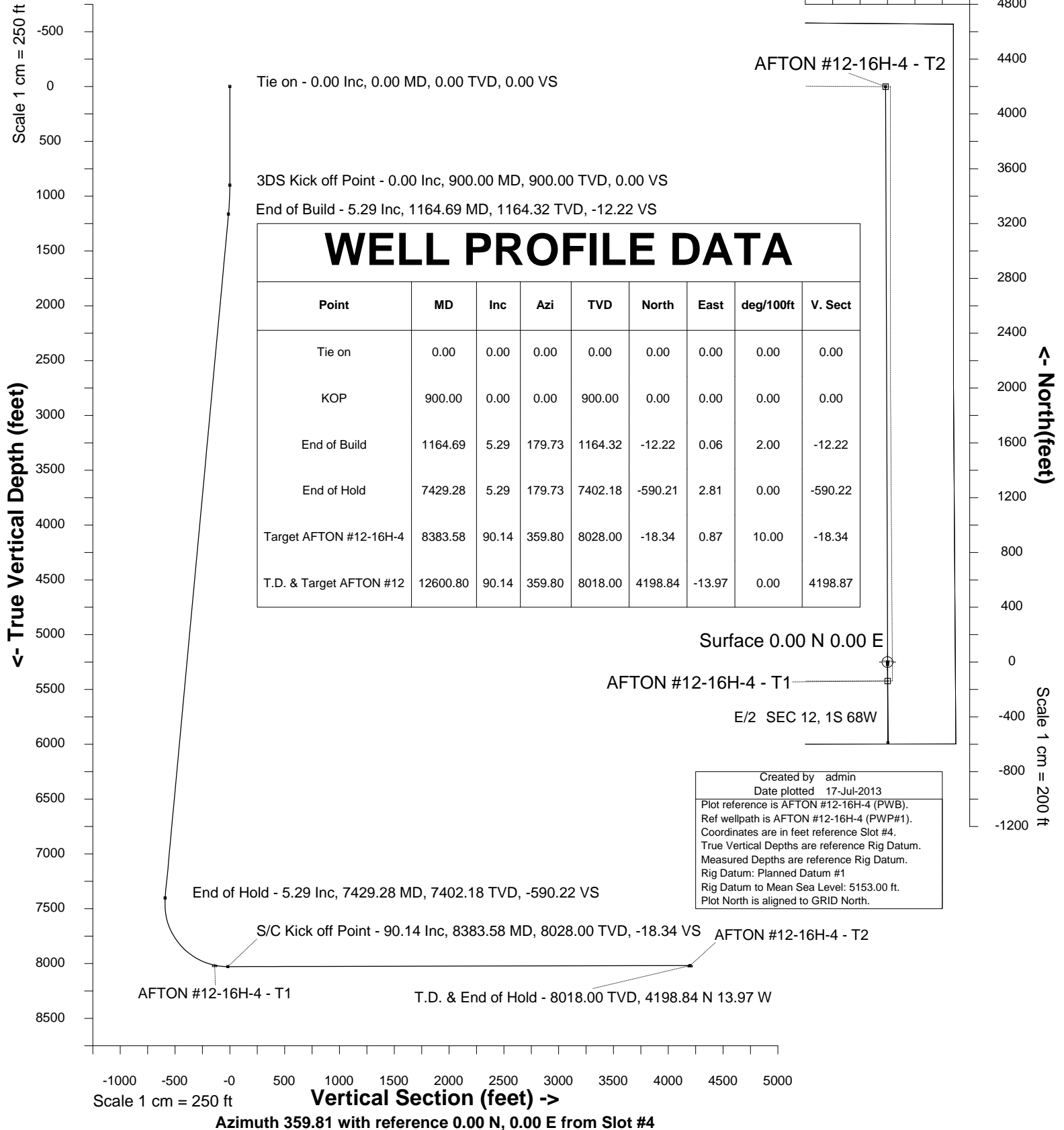



INTEGRATED PETROLEUM TECHNOLOGIES, INC
SYSDRILL
Well Design Combined Report
Wellbore: AFTON #12-16H-4 (PWB)

Wellhead Details							
Name	Northing	Easting	Latitude	Longitude	North	East	Elevation Above Inst.
Slot #4	1233718.6800	3156372.0400	39.97359097	-104.94204698	0.01S	47.88E	-0.00

Declination			
Date	Source	Time	
	8-Jul-2013	IGRF Model [1900.0-2015.0]	08:51

Site Details				
Name	Northing	Easting	Coord System Name	North Alignment
AFTON	1233718.6871	3156324.1590	CO83-NF on NAD83 datum	Grid

Summary Wellpath									
MD[ft]	Inc[deg]	Azi[deg]	TVD[ft]	North[ft]	East[ft]	Dogleg [deg/100ft]	Vertical Section[ft]	Northing	Easting
0.00	0.00	0.000	0.00	0.00N	0.00E		0.00	1233718.68	3156372.04
900.00	0.00	0.000	900.00	0.00N	0.00E	==>	0.00	1233718.68	3156372.04
1164.69	5.29	179.730	1164.32	12.22S	0.06E	2.00	-12.22	1233706.46	3156372.10
7429.28	5.29	179.730	7402.18	590.21S	2.81E	==>	-590.22	1233128.49	3156374.85
8383.58	90.14	359.800	8028.00	18.34S	0.87E	10.00	-18.34	1233700.34	3156372.90
12600.80	90.14	359.800	8018.00	4198.84N	13.97W	==>	4198.87	1237917.38	3156358.07

Interpolated Wellpath									
MD[ft]	Inc[deg]	Azi[deg]	TVD[ft]	North[ft]	East[ft]	Dogleg [deg/100ft]	Vertical Section[ft]	Northing	Easting
0.00	0.00	0.000	0.00	0.00N	0.00E		0.00	1233718.68	3156372.04
100.00	0.00	0.000	100.00	0.00N	0.00E	==>	0.00	1233718.68	3156372.04
200.00	0.00	0.000	200.00	0.00N	0.00E	==>	0.00	1233718.68	3156372.04
300.00	0.00	0.000	300.00	0.00N	0.00E	==>	0.00	1233718.68	3156372.04
400.00	0.00	0.000	400.00	0.00N	0.00E	==>	0.00	1233718.68	3156372.04
500.00	0.00	0.000	500.00	0.00N	0.00E	==>	0.00	1233718.68	3156372.04
600.00	0.00	0.000	600.00	0.00N	0.00E	==>	0.00	1233718.68	3156372.04
700.00	0.00	0.000	700.00	0.00N	0.00E	==>	0.00	1233718.68	3156372.04
800.00	0.00	0.000	800.00	0.00N	0.00E	==>	0.00	1233718.68	3156372.04
900.00	0.00	0.000	900.00	0.00N	0.00E	==>	0.00	1233718.68	3156372.04
1000.00	2.00	179.730	999.98	1.75S	0.01E	2.00	-1.75	1233716.93	3156372.05
1100.00	4.00	179.730	1099.84	6.98S	0.03E	2.00	-6.98	1233711.70	3156372.07
1164.69	5.29	179.730	1164.32	12.22S	0.06E	2.00	-12.22	1233706.46	3156372.10
1200.00	5.29	179.730	1199.47	15.48S	0.07E	==>	-15.48	1233703.20	3156372.11
1300.00	5.29	179.730	1299.05	24.70S	0.12E	==>	-24.70	1233693.98	3156372.16
1400.00	5.29	179.730	1398.62	33.93S	0.16E	==>	-33.93	1233684.75	3156372.20
1500.00	5.29	179.730	1498.19	43.16S	0.21E	==>	-43.16	1233675.53	3156372.25
1600.00	5.29	179.730	1597.77	52.38S	0.25E	==>	-52.38	1233666.30	3156372.29
1700.00	5.29	179.730	1697.34	61.61S	0.29E	==>	-61.61	1233657.07	3156372.33
1800.00	5.29	179.730	1796.91	70.83S	0.34E	==>	-70.84	1233647.85	3156372.38
1900.00	5.29	179.730	1896.49	80.06S	0.38E	==>	-80.06	1233638.62	3156372.42
2000.00	5.29	179.730	1996.06	89.29S	0.42E	==>	-89.29	1233629.40	3156372.46
2100.00	5.29	179.730	2095.63	98.51S	0.47E	==>	-98.51	1233620.17	3156372.51
2200.00	5.29	179.730	2195.21	107.74S	0.51E	==>	-107.74	1233610.94	3156372.55
2300.00	5.29	179.730	2294.78	116.97S	0.56E	==>	-116.97	1233601.72	3156372.60
2400.00	5.29	179.730	2394.35	126.19S	0.60E	==>	-126.19	1233592.49	3156372.64
2500.00	5.29	179.730	2493.93	135.42S	0.64E	==>	-135.42	1233583.27	3156372.68
2600.00	5.29	179.730	2593.50	144.65S	0.69E	==>	-144.65	1233574.04	3156372.73
2700.00	5.29	179.730	2693.07	153.87S	0.73E	==>	-153.87	1233564.81	3156372.77
2800.00	5.29	179.730	2792.65	163.10S	0.78E	==>	-163.10	1233555.59	3156372.82
2900.00	5.29	179.730	2892.22	172.32S	0.82E	==>	-172.33	1233546.36	3156372.86
3000.00	5.29	179.730	2991.80	181.55S	0.86E	==>	-181.55	1233537.14	3156372.90
3100.00	5.29	179.730	3091.37	190.78S	0.91E	==>	-190.78	1233527.91	3156372.95
3200.00	5.29	179.730	3190.94	200.00S	0.95E	==>	-200.01	1233518.68	3156372.99
3300.00	5.29	179.730	3290.52	209.23S	0.99E	==>	-209.23	1233509.46	3156373.03
3400.00	5.29	179.730	3390.09	218.46S	1.04E	==>	-218.46	1233500.23	3156373.08
3500.00	5.29	179.730	3489.66	227.68S	1.08E	==>	-227.68	1233491.01	3156373.12
3600.00	5.29	179.730	3589.24	236.91S	1.13E	==>	-236.91	1233481.78	3156373.17

All data is in Feet unless otherwise stated
Coordinates are from Slot MD's are from Rig and TVD's are from Rig (Planned Datum #1 5153.0ft above Mean Sea Level)
Vertical Section is from 0.00N 0.00E on azimuth 359.810 degrees
Bottom hole distance is 4198.87 Feet on azimuth 359.81 degrees from Wellhead
Calculation method uses Minimum Curvature method
Prepared by Integrated Petroleum Technologies, Inc.
Date Printed: 17-Jul-2013



INTEGRATED PETROLEUM TECHNOLOGIES, INC
SYSDRILL
Well Design Combined Report
Wellbore: AFTON #12-16H-4 (PWB)

Interpolated Wellpath									
MD[ft]	Inc[deg]	Azi[deg]	TVD[ft]	North[ft]	East[ft]	Dogleg [deg/100ft]	Vertical Section[ft]	Northing	Easting
3700.00	5.29	179.730	3688.81	246.14S	1.17E	==>	-246.14	1233472.55	3156373.21
3800.00	5.29	179.730	3788.38	255.36S	1.21E	==>	-255.36	1233463.33	3156373.25
3900.00	5.29	179.730	3887.96	264.59S	1.26E	==>	-264.59	1233454.10	3156373.30
4000.00	5.29	179.730	3987.53	273.81S	1.30E	==>	-273.82	1233444.87	3156373.34
4100.00	5.29	179.730	4087.10	283.04S	1.35E	==>	-283.04	1233435.65	3156373.39
4200.00	5.29	179.730	4186.68	292.27S	1.39E	==>	-292.27	1233426.42	3156373.43
4300.00	5.29	179.730	4286.25	301.49S	1.43E	==>	-301.50	1233417.20	3156373.47
4400.00	5.29	179.730	4385.82	310.72S	1.48E	==>	-310.72	1233407.97	3156373.52
4500.00	5.29	179.730	4485.40	319.95S	1.52E	==>	-319.95	1233398.74	3156373.56
4600.00	5.29	179.730	4584.97	329.17S	1.56E	==>	-329.18	1233389.52	3156373.60
4700.00	5.29	179.730	4684.54	338.40S	1.61E	==>	-338.40	1233380.29	3156373.65
4800.00	5.29	179.730	4784.12	347.62S	1.65E	==>	-347.63	1233371.07	3156373.69
4900.00	5.29	179.730	4883.69	356.85S	1.70E	==>	-356.85	1233361.84	3156373.74
5000.00	5.29	179.730	4983.26	366.08S	1.74E	==>	-366.08	1233352.61	3156373.78
5100.00	5.29	179.730	5082.84	375.30S	1.78E	==>	-375.31	1233343.39	3156373.82
5200.00	5.29	179.730	5182.41	384.53S	1.83E	==>	-384.53	1233334.16	3156373.87
5300.00	5.29	179.730	5281.98	393.76S	1.87E	==>	-393.76	1233324.94	3156373.91
5400.00	5.29	179.730	5381.56	402.98S	1.92E	==>	-402.99	1233315.71	3156373.96
5500.00	5.29	179.730	5481.13	412.21S	1.96E	==>	-412.21	1233306.48	3156374.00
5600.00	5.29	179.730	5580.70	421.44S	2.00E	==>	-421.44	1233297.26	3156374.04
5700.00	5.29	179.730	5680.28	430.66S	2.05E	==>	-430.67	1233288.03	3156374.09
5800.00	5.29	179.730	5779.85	439.89S	2.09E	==>	-439.89	1233278.81	3156374.13
5900.00	5.29	179.730	5879.43	449.11S	2.13E	==>	-449.12	1233269.58	3156374.17
6000.00	5.29	179.730	5979.00	458.34S	2.18E	==>	-458.35	1233260.35	3156374.22
6100.00	5.29	179.730	6078.57	467.57S	2.22E	==>	-467.57	1233251.13	3156374.26
6200.00	5.29	179.730	6178.15	476.79S	2.27E	==>	-476.80	1233241.90	3156374.31
6300.00	5.29	179.730	6277.72	486.02S	2.31E	==>	-486.02	1233232.68	3156374.35
6400.00	5.29	179.730	6377.29	495.25S	2.35E	==>	-495.25	1233223.45	3156374.39
6500.00	5.29	179.730	6476.87	504.47S	2.40E	==>	-504.48	1233214.22	3156374.44
6600.00	5.29	179.730	6576.44	513.70S	2.44E	==>	-513.70	1233205.00	3156374.48
6700.00	5.29	179.730	6676.01	522.93S	2.49E	==>	-522.93	1233195.77	3156374.53
6800.00	5.29	179.730	6775.59	532.15S	2.53E	==>	-532.16	1233186.55	3156374.57
6900.00	5.29	179.730	6875.16	541.38S	2.57E	==>	-541.38	1233177.32	3156374.61
7000.00	5.29	179.730	6974.73	550.60S	2.62E	==>	-550.61	1233168.09	3156374.66
7100.00	5.29	179.730	7074.31	559.83S	2.66E	==>	-559.84	1233158.87	3156374.70
7200.00	5.29	179.730	7173.88	569.06S	2.70E	==>	-569.06	1233149.64	3156374.74
7300.00	5.29	179.730	7273.45	578.28S	2.75E	==>	-578.29	1233140.42	3156374.79
7400.00	5.29	179.730	7373.03	587.51S	2.79E	==>	-587.52	1233131.19	3156374.83
7429.28	5.29	179.730	7402.18	590.21S	2.81E	==>	-590.22	1233128.49	3156374.85
7500.00	1.78	0.010	7472.82	592.38S	2.82E	10.00	-592.38	1233126.32	3156374.86
7600.00	11.78	359.830	7572.00	580.59S	2.79E	10.00	-580.60	1233138.11	3156374.83
7700.00	21.78	359.810	7667.62	551.76S	2.70E	10.00	-551.77	1233166.94	3156374.74
7800.00	31.78	359.810	7756.78	506.76S	2.55E	10.00	-506.77	1233211.93	3156374.59
7900.00	41.78	359.810	7836.78	446.97S	2.35E	10.00	-446.97	1233271.73	3156374.39
8000.00	51.78	359.800	7905.17	374.19S	2.10E	10.00	-374.20	1233344.50	3156374.14
8100.00	61.78	359.800	7959.89	290.64S	1.82E	10.00	-290.65	1233428.05	3156373.86
8200.00	71.78	359.800	7999.27	198.86S	1.50E	10.00	-198.86	1233519.83	3156373.54
8300.00	81.78	359.800	8022.11	101.63S	1.16E	10.00	-101.64	1233617.05	3156373.20
8383.58	90.14	359.800	8028.00	18.34S	0.87E	10.00	-18.34	1233700.34	3156372.90
8400.00	90.14	359.800	8027.96	1.92S	0.81E	==>	-1.92	1233716.76	3156372.85
8500.00	90.14	359.800	8027.72	98.08N	0.46E	==>	98.08	1233816.76	3156372.50
8600.00	90.14	359.800	8027.49	198.08N	0.10E	==>	198.08	1233916.75	3156372.14
8700.00	90.14	359.800	8027.25	298.08N	0.25W	==>	298.08	1234016.75	3156371.79
8800.00	90.14	359.800	8027.01	398.08N	0.60W	==>	398.08	1234116.75	3156371.44
8900.00	90.14	359.800	8026.78	498.08N	0.95W	==>	498.08	1234216.74	3156371.09
9000.00	90.14	359.800	8026.54	598.08N	1.30W	==>	598.08	1234316.74	3156370.74
9100.00	90.14	359.800	8026.30	698.08N	1.66W	==>	698.08	1234416.73	3156370.38
9200.00	90.14	359.800	8026.06	798.08N	2.01W	==>	798.08	1234516.73	3156370.03
9300.00	90.14	359.800	8025.83	898.07N	2.36W	==>	898.08	1234616.72	3156369.68
9400.00	90.14	359.800	8025.59	998.07N	2.71W	==>	998.08	1234716.72	3156369.33
9500.00	90.14	359.800	8025.35	1098.07N	3.06W	==>	1098.08	1234816.72	3156368.98

All data is in Feet unless otherwise stated
Coordinates are from Slot MD's are from Rig and TVD's are from Rig (Planned Datum #1 5153.0ft above Mean Sea Level)
Vertical Section is from 0.00N 0.00E on azimuth 359.810 degrees
Bottom hole distance is 4198.87 Feet on azimuth 359.81 degrees from Wellhead
Calculation method uses Minimum Curvature method
Prepared by Integrated Petroleum Technologies, Inc.
Date Printed: 17-Jul-2013



INTEGRATED PETROLEUM TECHNOLOGIES, INC
SYSDRILL
Well Design Combined Report
Wellbore: AFTON #12-16H-4 (PWB)

Interpolated Wellpath									
MD[ft]	Inc[deg]	Azi[deg]	TVD[ft]	North[ft]	East[ft]	Dogleg [deg/100ft] ==>	Vertical Section[ft] 1198.08	Northing	Easting
9600.00	90.14	359.800	8025.12	1198.07N	3.42W			1234916.71	3156368.63
9700.00	90.14	359.800	8024.88	1298.07N	3.77W	==>	1298.08	1235016.71	3156368.27
9800.00	90.14	359.800	8024.64	1398.07N	4.12W	==>	1398.08	1235116.70	3156367.92
9900.00	90.14	359.800	8024.40	1498.07N	4.47W	==>	1498.08	1235216.70	3156367.57
10000.00	90.14	359.800	8024.17	1598.07N	4.82W	==>	1598.08	1235316.69	3156367.22
10100.00	90.14	359.800	8023.93	1698.07N	5.17W	==>	1698.08	1235416.69	3156366.87
10200.00	90.14	359.800	8023.69	1798.07N	5.53W	==>	1798.07	1235516.69	3156366.51
10300.00	90.14	359.800	8023.46	1898.07N	5.88W	==>	1898.07	1235616.68	3156366.16
10400.00	90.14	359.800	8023.22	1998.06N	6.23W	==>	1998.07	1235716.68	3156365.81
10500.00	90.14	359.800	8022.98	2098.06N	6.58W	==>	2098.07	1235816.67	3156365.46
10600.00	90.14	359.800	8022.74	2198.06N	6.93W	==>	2198.07	1235916.67	3156365.11
10700.00	90.14	359.800	8022.51	2298.06N	7.29W	==>	2298.07	1236016.67	3156364.75
10800.00	90.14	359.800	8022.27	2398.06N	7.64W	==>	2398.07	1236116.66	3156364.40
10900.00	90.14	359.800	8022.03	2498.06N	7.99W	==>	2498.07	1236216.66	3156364.05
11000.00	90.14	359.800	8021.80	2598.06N	8.34W	==>	2598.07	1236316.65	3156363.70
11100.00	90.14	359.800	8021.56	2698.06N	8.69W	==>	2698.07	1236416.65	3156363.35
11200.00	90.14	359.800	8021.32	2798.06N	9.04W	==>	2798.07	1236516.64	3156363.00
11300.00	90.14	359.800	8021.08	2898.06N	9.40W	==>	2898.07	1236616.64	3156362.64
11400.00	90.14	359.800	8020.85	2998.06N	9.75W	==>	2998.07	1236716.64	3156362.29
11500.00	90.14	359.800	8020.61	3098.05N	10.10W	==>	3098.07	1236816.63	3156361.94
11600.00	90.14	359.800	8020.37	3198.05N	10.45W	==>	3198.07	1236916.63	3156361.59
11700.00	90.14	359.800	8020.14	3298.05N	10.80W	==>	3298.07	1237016.62	3156361.24
11800.00	90.14	359.800	8019.90	3398.05N	11.16W	==>	3398.07	1237116.62	3156360.88
11900.00	90.14	359.800	8019.66	3498.05N	11.51W	==>	3498.07	1237216.61	3156360.53
12000.00	90.14	359.800	8019.42	3598.05N	11.86W	==>	3598.07	1237316.61	3156360.18
12100.00	90.14	359.800	8019.19	3698.05N	12.21W	==>	3698.07	1237416.61	3156359.83
12200.00	90.14	359.800	8018.95	3798.05N	12.56W	==>	3798.07	1237516.60	3156359.48
12300.00	90.14	359.800	8018.71	3898.05N	12.92W	==>	3898.07	1237616.60	3156359.13
12400.00	90.14	359.800	8018.48	3998.05N	13.27W	==>	3998.07	1237716.59	3156358.77
12500.00	90.14	359.800	8018.24	4098.05N	13.62W	==>	4098.07	1237816.59	3156358.42
12600.00	90.14	359.800	8018.00	4198.04N	13.97W	==>	4198.07	1237916.58	3156358.07
12600.80	90.14	359.800	8018.00	4198.84N	13.97W	==>	4198.87	1237917.38	3156358.07

All data is in Feet unless otherwise stated
Coordinates are from Slot MD's are from Rig and TVD's are from Rig (Planned Datum #1 5153.0ft above Mean Sea Level)
Vertical Section is from 0.00N 0.00E on azimuth 359.810 degrees
Bottom hole distance is 4198.87 Feet on azimuth 359.81 degrees from Wellhead
Calculation method uses Minimum Curvature method
Prepared by Integrated Petroleum Technologies, Inc.
Date Printed: 17-Jul-2013



INTEGRATED PETROLEUM TECHNOLOGIES, INC
SYSDRILL
Well Design Combined Report
Wellbore: AFTON #12-16H-4 (PWB)

Targets								
Name	North[ft]	East[ft]	TVD[ft]	Latitude	Longitude	Northing	Easting	Last Revised
AFTON #12-16H-4 - T1	138.34S	0.87E	8016.00	39.97321120	-104.94204700	1233580.34	3156372.90	8-Jul-2013
AFTON #12-16H-4 - T2	4198.84N	13.97W	8018.00	39.98511723	-104.94200257	1237917.38	3156358.07	8-Jul-2013

Survey Tool Program					
Reference	Survey Name	MD[ft]	TVD[ft]	Survey Tool	Error Model
54724	Planned	12600.80	8018.00	WdW Rate Gyro	Standard

Notes



SYSDRILL
Closest Approach + Clearance Factor Summary Report
Wellbore: AFTON #12-16H-4 (PWB)

Ellipse separations are reported ONLY if BOTH wells have uncertainty data
Only Depth and Magnetic Reference Field error terms are correlated across tie points
Scan limit is calculated on CENTRE to CENTRE distance

Summary data uses Closest Approach clearance calculation for all minima
Hole size/Casings ARE included
Hole size/Casings are NOT subtracted from Centre-Centre distance
Confidence limit of 95.00% / 2.80 SD.

Wellbore		
Name	Created	Last Revised
AFTON #12-16H-4 (PWB)	9-Jul-2013	11-Jul-2013

Well		
Name	Government ID	Last Revised
AFTON #12-16H-4		9-Jul-2013

Slot						
Name	Grid Northing	Grid Easting	Latitude	Longitude	North	East
Slot #4	1233718.6800	3156372.0400	39.97359097	-104.94204698	0.01S	47.88E

Installation					
Name	Easting	Northing	Coord System Name	North Alignment	
AFTON	3156324.1590	1233718.6871	CO83-NF on NORTH AMERICAN DATUM 1983 datum	Grid	

Field					
Name	Easting	Northing	Coord System Name	North Alignment	
SPINDLE	3156324.1590	1233718.6871	CO83-NF on NORTH AMERICAN DATUM 1983 datum	Grid	

Clearance Summary										
Offset WellName	Offset Wellbore	Offset Slot	Offset Structure	Separation [ft]	MD[ft]	Diverging From[ft]	Ellipse Separation [ft]	Ellipse MD[ft]	Clearance Factor	Clearance MD[ft]
AFTON #12-16H-3	AFTON #12-16H-3 (PWB)	Slot #3	AFTON	15.98	800.00	12600.80	14.69	800.00	7.58	12600.80
PULIS #12-8	PULIS #12-8 (AWB)	PULIS #12-8	Offsets	124.14	902.23	8433.12	121.67	935.04	38.77	1935.70
DARLOW UNIT #12-16B	DARLOW UNIT #12-16B (AWB)	DARLOW UNIT #12-16B	Offsets	252.68	8471.18	8471.18	239.08	8471.18	18.57	8480.97
ELMS #2	ELMS #2 (AWB)	ELMS #2	Offsets	293.18	11364.24	11364.24	258.84	11368.11	8.53	11384.51
BARKER #12-9	BARKER #12-9 (AWB)	BARKER #12-9	Offsets	418.23	9758.84	9758.84	397.17	9760.50	19.72	9800.00
MALLO #1	MALLO #1 (AWB)	MALLO #1	Offsets	1341.18	918.64	8480.97	1338.64	1000.66	148.98	5331.36
Ruby #1	Ruby #1 (AWB)	Ruby #1	Offsets	1379.95	935.04	8419.63	1367.08	8419.63	96.60	9055.12
Ruby #2	Ruby #2 (AWB)	Ruby #2	Offsets	1380.58	918.64	9779.61	1379.03	1049.87	51.12	10170.60
TUDEX REINHOLT #NC4	TUDEX REINHOLT #NC4 (AWB)	TUDEX REINHOLT #NC4	Offsets	1445.42	12150.49	12150.49	1404.30	12155.51	34.31	12385.17
DARLOW #12-2	DARLOW #12-2 (AWB)	DARLOW #12-2	Offsets	1446.78	902.23	9794.88	1444.34	902.23	211.04	11072.83
BELLINGE	BELLINGER #12-7	BELLINGE	Offsets	1942.10	902.23	9800.00	1939.61	902.23	188.73	11466.54

All data is in Feet unless otherwise stated
Coordinates are from Slot MD's are from Rig and TVD's are from Rig (Planned Datum #1 5153.0ft above Mean Sea Level)
Vertical Section is from 0.00N 0.00E on azimuth 359.810 degrees
Prepared by Integrated Petroleum Technologies, Inc.
Date Printed: 17-Jul-2013



SYSDRILL
Closest Approach + Clearance Factor Summary Report
Wellbore: AFTON #12-16H-4 (PWB)

Clearance Summary										
Offset WellName	Offset Wellbore	Offset Slot	Offset Structure	Separation [ft]	MD[ft]	Diverging From[ft]	Ellipse Separation [ft]	Ellipse MD[ft]	Clearance Factor	Clearance MD[ft]
R #12-7	(AWB)	R #12-7								
TUDEX BRINK #S-2	TUDEX BRINK #S-2 (AWB)	TUDEX BRINK #S-2	Offsets	2413.94	180.45	10468.83	2412.86	902.23	177.44	11745.41
ELMS #12-4	ELMS #12-4 (AWB)	ELMS #12-4	Offsets	2658.95	902.23	11018.84	2656.45	902.23	170.07	12024.28
SEVENS #1	SEVENS #1 (AWB)	SEVENS #1	Offsets	2968.72	12422.30	12422.30	2950.47	12434.38	159.23	12600.80
CROFF #12-5	CROFF #12-5 (AWB)	CROFF #12-5	Offsets	3004.09	902.23	11082.31	3001.57	902.23	152.70	12417.98
LENART #S-1	LENART #S-1 (AWB)	LENART #S-1	Offsets	3100.47	11800.00	11800.00	3080.68	11811.02	145.92	12600.80
REINHOLT #12-6	REINHOLT #12-6 (AWB)	REINHOLT #12-6	Offsets	3269.71	12188.32	12188.32	3246.79	12200.00	134.51	12600.80