

ConocoPhillips Company
CONSTRUCTION LAYOUT FOR
COTTONWOOD CREEK #4-65 27-1H
SECTION 27, T4S, R65W, 6th P.M.
1750' FNL 325' FWL

FIGURE #1

SCALE: 1" = 60'
DATE: 07-17-13
DRAWN BY: A.D.
REV: 09-09-13

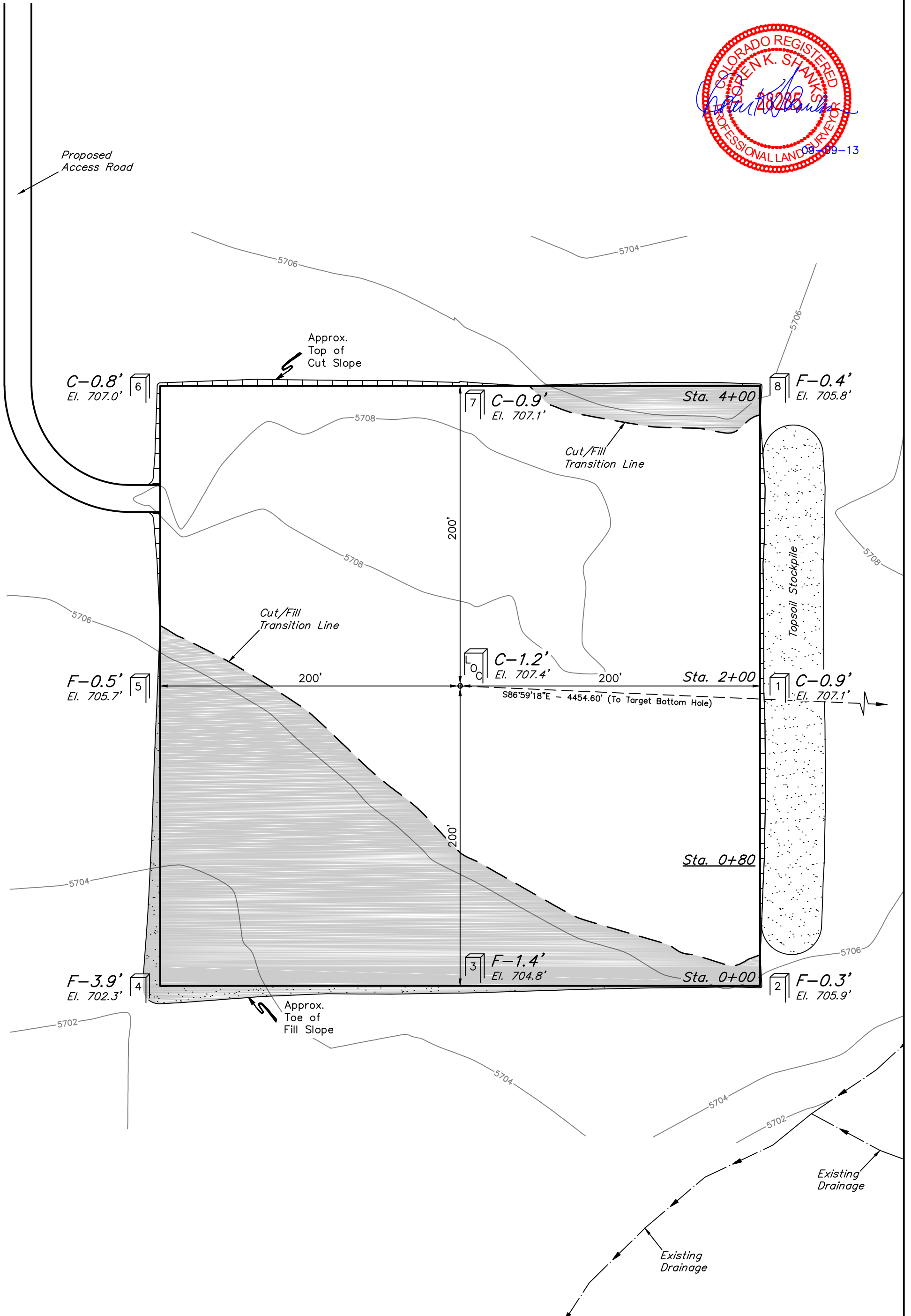

Elev. Ungraded Ground At Loc. Stake = 5707.4'
FINISHED GRADE ELEV. AT LOC. STAKE = 5706.2'

UINTAH ENGINEERING & LAND SURVEYING
85 So. 200 East * Vernal, Utah 84078 * (435) 789-1017

1" = 40'
X-Section
Scale
1" = 100'
DATE: 07-17-13
DRAWN BY: A.D.
REV: 09-09-13

ConocoPhillips Company
CONSTRUCTION LAYOUT CROSS SECTIONS FOR
COTTONWOOD CREEK #4-65 27-1H
SECTION 27, T4S, R65W, 6th P.M.
1750' FNL 325' FWL

FIGURE #2

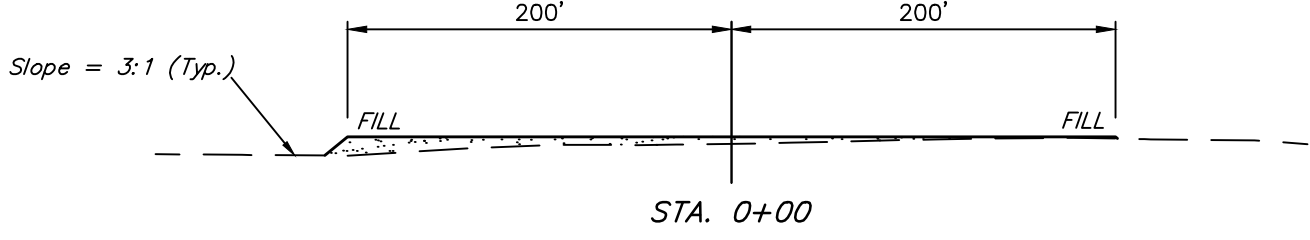
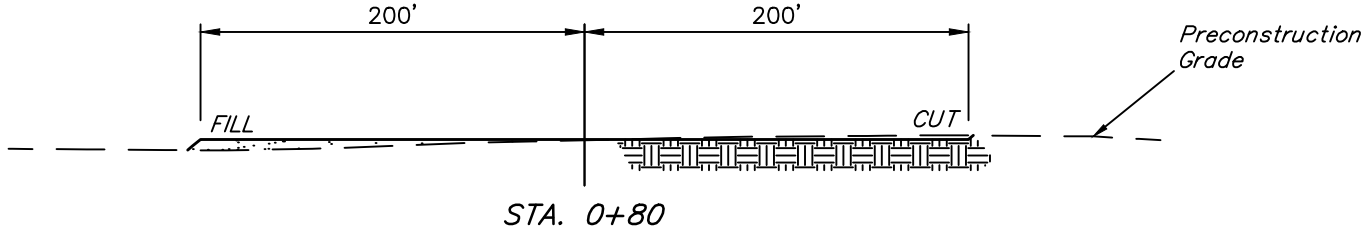
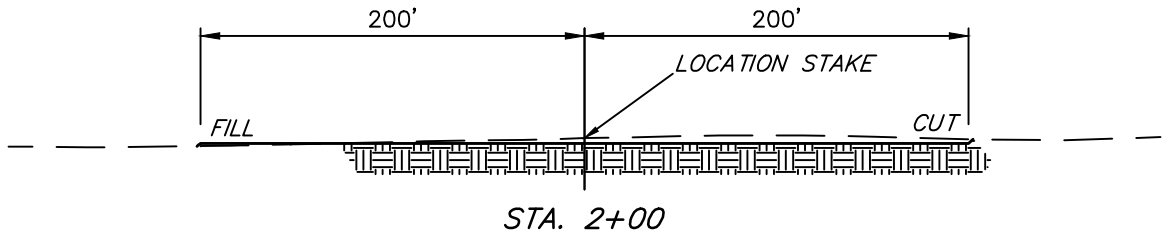
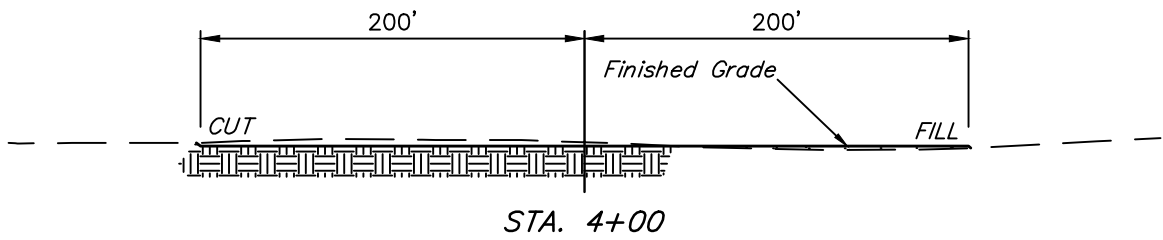

NOTE:
Topsoil should not be
Stripped Below Finished
Grade on Substructure Area.

* NOTE:
FILL QUANTITY INCLUDES
10% FOR COMPACTION

APPROXIMATE YARDAGES

(6") Topsoil Stripping	=	3,070 Cu. Yds.
Remaining Location	=	3,290 Cu. Yds.
TOTAL CUT	=	6,360 CU. YDS.
FILL	=	3,290 CU. YDS.

EXCESS MATERIAL	=	3,070 Cu. Yds.
Topsoil	=	3,070 Cu. Yds.
EXCESS UNBALANCE (After Interim Rehabilitation)	=	0 Cu. Yds.

APPROXIMATE ACREAGE	
WELL SITE DISTURBANCE	= ± 4.119 ACRES
ACCESS ROAD DISTURBANCE	= ± 1.173 ACRES
TOTAL	= ± 5.292 ACRES

UINTAH ENGINEERING & LAND SURVEYING
85 So. 200 East * Vernal, Utah 84078 * (435) 789-1017