



Lat40°, Inc. 1635 Foxtrail Drive, Suite 325 Loveland, CO 970-776-3321

LOCATION DRAWING

STATE NORTH PLATTE 0-26 PAD

SECTION: 26
TOWNSHIP: 5N
RANGE: 63W

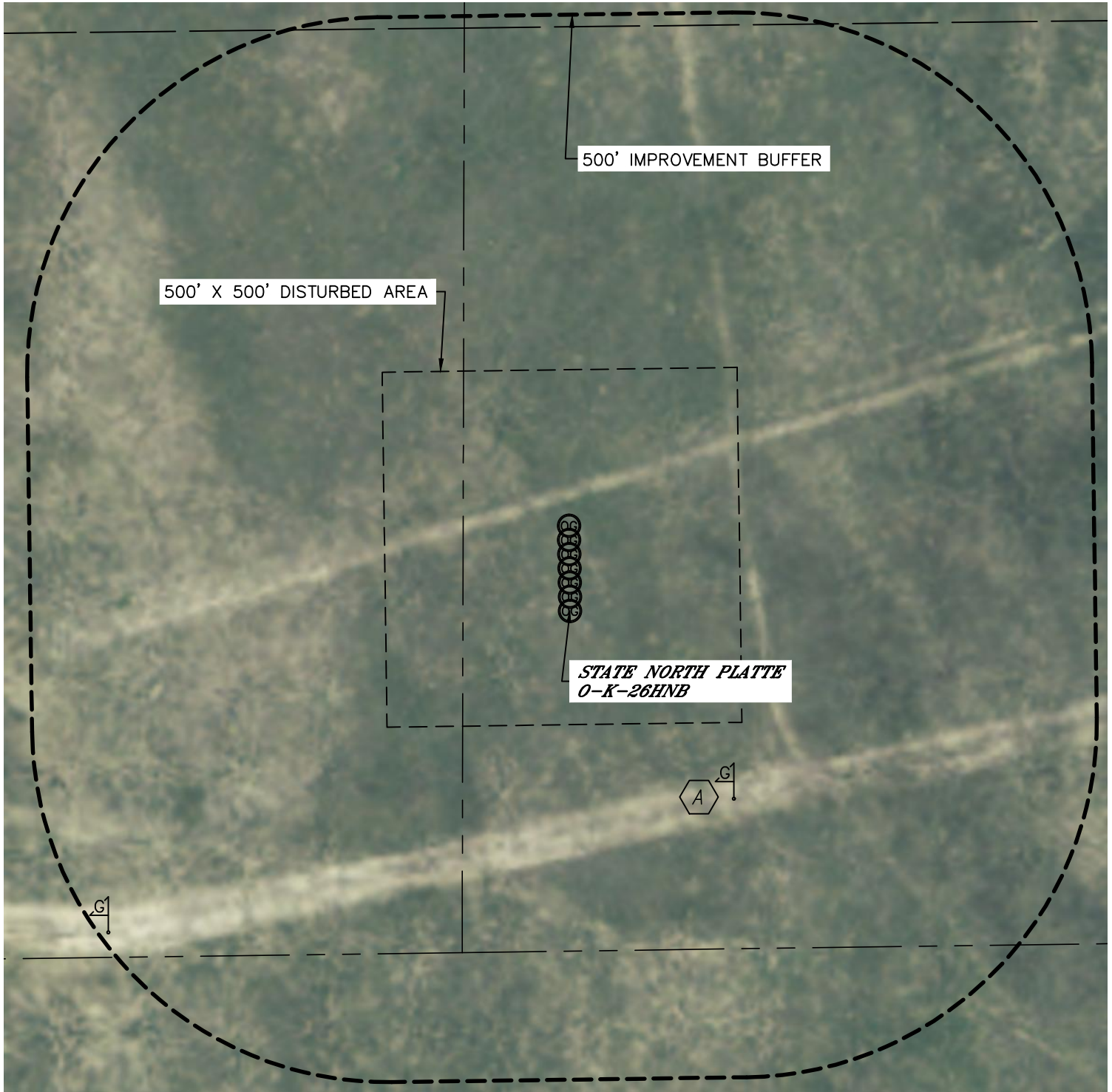

IMPROVEMENTS:
(MEASURED FROM THE PROPOSED STATE NORTH PLATTE 0-K-26HNB WELL LOCATION)

 GAS MARKER 351' SE, 792' SW



NEAREST: OUTBUILDING 1415' NE (ABANDONED), PUBLIC ROAD 2740' SW (CR 69),
ABOVE GROUND UTILITY 910' SE, RAILROAD 5280'+, PROPERTY LINE 479' S

1"=200'
DATE: rev9/20/2013
PROJECT#: 2012178