

**GREAT WESTERN OIL & GAS COMPANY**  
**POSTLE IC OFF-SITE TANK PAD**  
LOCATED IN WELD COUNTY, COLORADO  
SECTION 12, T3N, R68W, 6th P.M.

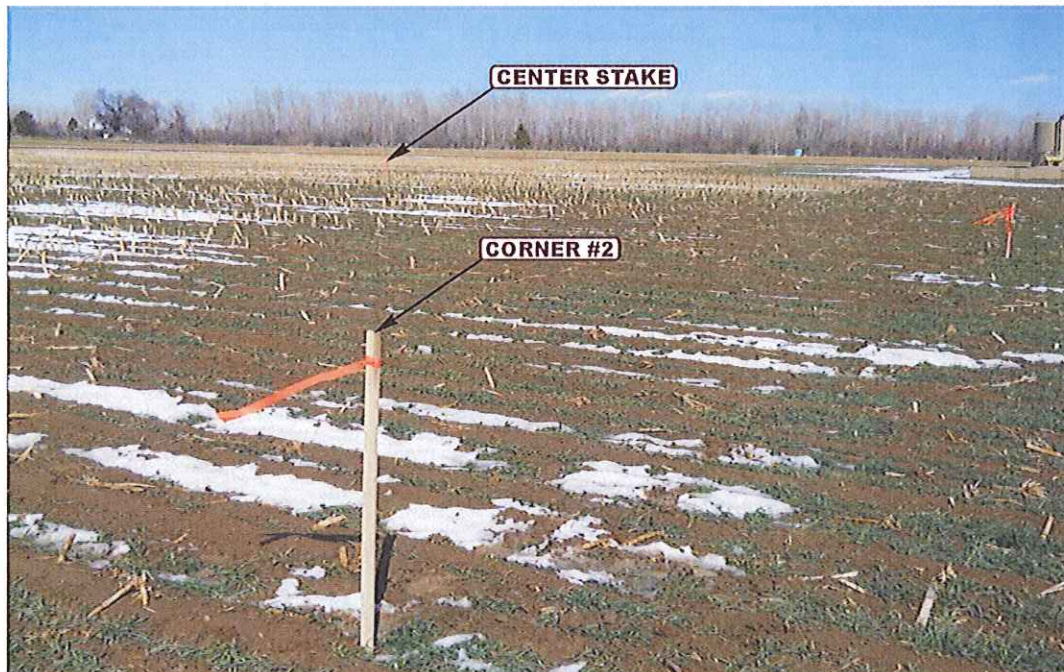

PHOTO: VIEW FROM CORNER #2 TO CENTER STAKE

CAMERA ANGLE: NORTHEASTERLY



PHOTO: VIEW FROM BEGINNING OF PROPOSED ACCESS

CAMERA ANGLE: NORTHERLY



Uintah Engineering & Land Surveying  
85 South 200 East Vernal, Utah 84078  
(435) 789-1017 \* FAX (435) 789-1813

LOCATION PHOTOS

04 24 13  
MONTH DAY YEAR

TAKEN BY: Z.B.

DRAWN BY: J.L.H.

REVISED: 00-00-00

PHOTO  
P1



**GREAT WESTERN OIL & GAS COMPANY**  
**POSTLEIC OFF-SITE TANK PAD**  
LOCATED IN WELD COUNTY, COLORADO  
SECTION 12, T3N, R68W, 6th P.M.

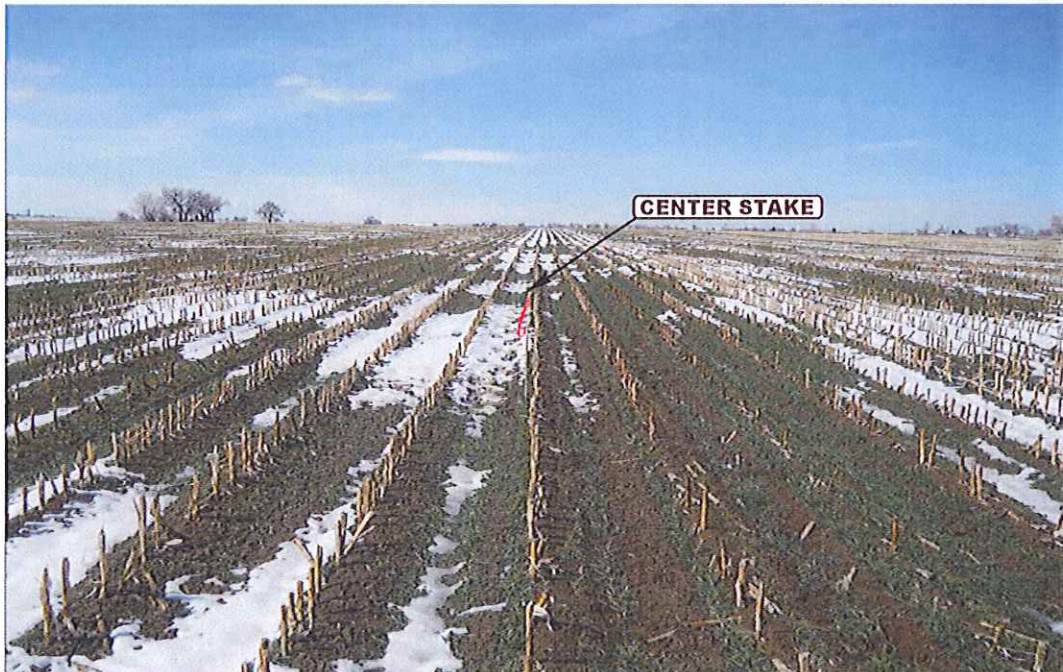

PHOTO: VIEW OF CENTER STAKE

CAMERA ANGLE: NORTHERLY



PHOTO: VIEW OF CENTER STAKE

CAMERA ANGLE: EASTERLY



**U&LS** Uintah Engineering & Land Surveying  
85 South 200 East Vernal, Utah 84078  
(435) 789-1017 \* FAX (435) 789-1813

**LOCATION PHOTOS**

<b>04</b>	<b>24</b>	<b>13</b>
MONTH	DAY	YEAR

TAKEN BY: Z.B.

DRAWN BY: J.L.H.

REVISED: 00-00-00

PHOTO  
**P2**



**GREAT WESTERN OIL & GAS COMPANY**  
**POSTLE IC OFF-SITE TANK PAD**  
LOCATED IN WELD COUNTY, COLORADO  
SECTION 12, T3N, R68W, 6th P.M.



PHOTO: VIEW OF CENTER STAKE

CAMERA ANGLE: SOUTHERLY



PHOTO: VIEW OF CENTER STAKE

CAMERA ANGLE: WESTERLY



- Since 1964 -

**UELS** Uintah Engineering & Land Surveying  
85 South 200 East Vernal, Utah 84078  
(435) 789-1017 \* FAX (435) 789-1813

**LOCATION PHOTOS**

04	24	13
MONTH	DAY	YEAR

TAKEN BY: Z.B.

DRAWN BY: J.L.H.

REVISED: 00-00-00

PHOTO  
**P3**