



Lat40°, Inc. 1635 Foxtrail Drive, Suite 325 Loveland, CO 970-776-3321

# CUT & FILL DIAGRAM

STATE NORTH PLATTE 0-26 PAD

SECTION: 26  
TOWNSHIP: 5N  
RANGE: 63W

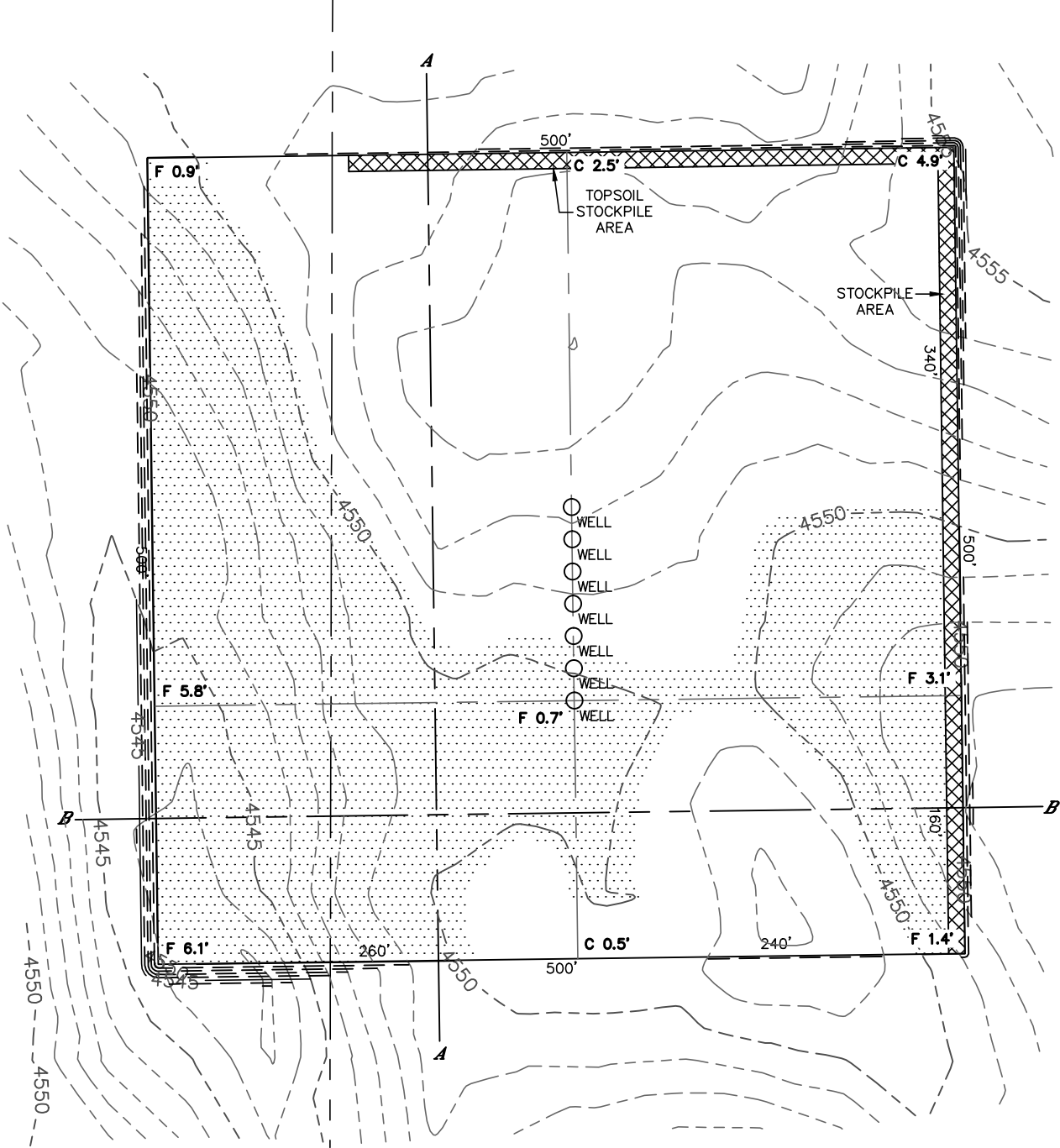

**OPERATOR: BONANZA CREEK ENERGY, INC.**

**LOCATION: 479' FSL, 2462' FEL**

**EXISTING ELEV= 4549.5'**

**PROPOSED ELEV= 4550.2'**

**DISTURBANCE= 6.0 ACRES**

**ESTIMATED EARTHWORK:**

**TOPSOIL= 9,680 CY**

**CUT= 9,494 CY**

**FILL= 9,488 CY**

**STOCKPILE:**

**EXCESS= 6 CY**

**NOTE:**

- 1) Ground elevations are based on an observed GPS elevation (NAVD 1988 DATUM).
- 2) No allowance has been made for soil expansion or compaction
- 3) Proposed elevation does not account for top soil removal.
- 4) Top soil volume assumes 12" depth across entire location.
- 5) Fill slopes 2:1
- 6) Cut slopes 1.5:1

**LEGEND**

EX. CONTOUR	---
PRO. CONTOUR	---
FILL AREA	

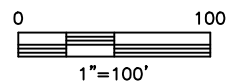

DATE: rev6/24/2013  
PROJECT#: 2012178



# CROSS SECTION DIAGRAM

STATE NORTH PLATTE 0-26 PAD

SECTION: 26  
TOWNSHIP: 5N  
RANGE: 63W

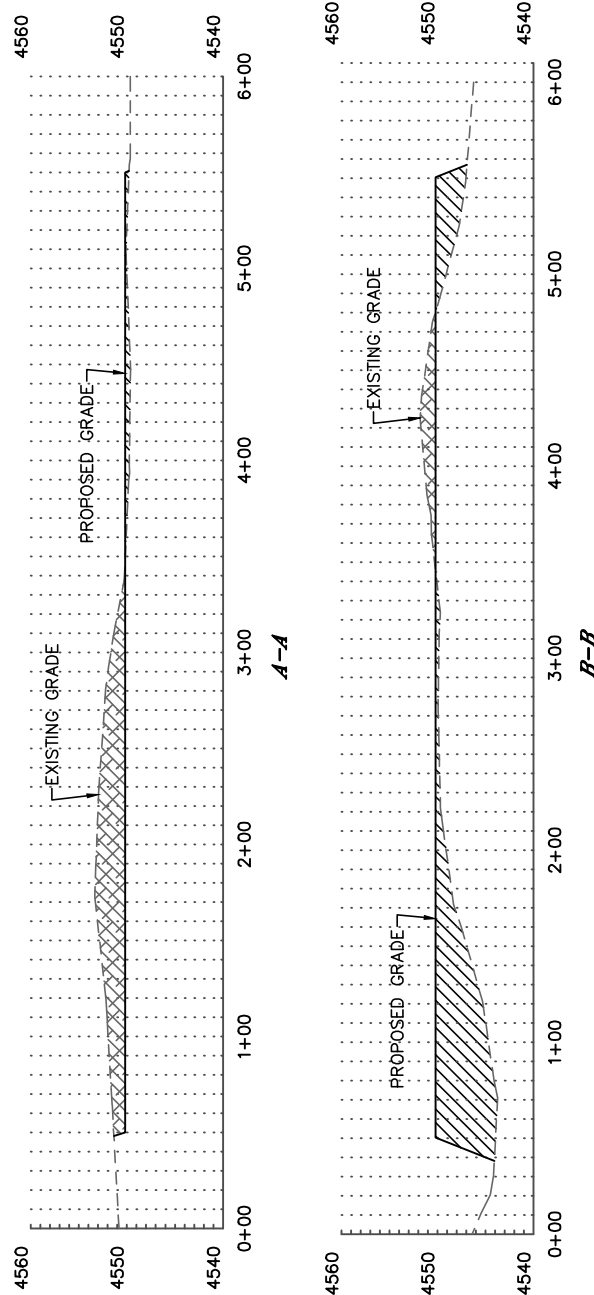

HORIZONTAL SCALE: 1"=100', VERTICAL SCALE: 1"=20'