

BILL BARRETT CORPORATION
ANSCHUTZ STATE #5-62-36-12
 LOCATED IN WELD COUNTY, COLORADO
 SECTION 36, T5N, R62W, 6th P.M.

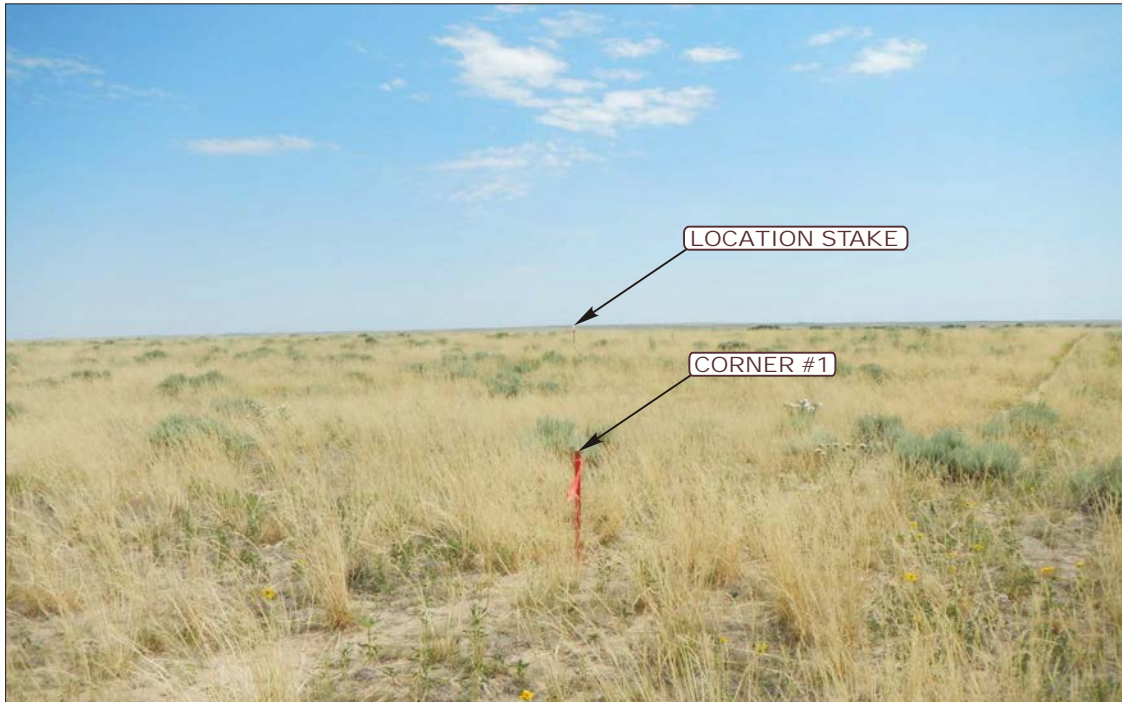

PHOTO: VIEW FROM CORNER #1 TO LOCATION STAKE

CAMERA ANGLE: NORTHEASTERLY



PHOTO: VIEW FROM BEGINNING OF PROPOSED ACCESS

CAMERA ANGLE: NORTHEASTERLY



- Since 1964 -

U&L S Uintah Engineering & Land Surveying
 85 South 200 East Vernal, Utah 84078
 (435) 789-1017 * FAX (435) 789-1813

LOCATION PHOTOS	07 MONTH	17 DAY	13 YEAR	PHOTO
TAKEN BY: J.H.	DRAWN BY: J.L.H.	REVISED: 00-00-00	P1	

BILL BARRETT CORPORATION
ANSCHUTZ STATE #5-62-36-12
 LOCATED IN WELD COUNTY, COLORADO
 SECTION 36, T5N, R62W, 6th P.M.



PHOTO: VIEW OF LOCATION STAKE

CAMERA ANGLE: NORTHERLY



PHOTO: VIEW OF LOCATION STAKE

CAMERA ANGLE: EASTERLY



- Since 1964 -

U&L S Uintah Engineering & Land Surveying
 85 South 200 East Vernal, Utah 84078
 (435) 789-1017 * FAX (435) 789-1813

LOCATION PHOTOS	07	17	13	PHOTO P2
	MONTH	DAY	YEAR	
TAKEN BY: J.H.	DRAWN BY: J.L.H.	REVISED: 00-00-00		

BILL BARRETT CORPORATION

ANSCHUTZ STATE #5-62-36-12

LOCATED IN WELD COUNTY, COLORADO

SECTION 36, T5N, R62W, 6th P.M.



PHOTO: VIEW OF LOCATION STAKE

CAMERA ANGLE: SOUTHERLY



PHOTO: VIEW OF LOCATION STAKE

CAMERA ANGLE: WESTERLY



- Since 1964 -

U
E
L
S Uintah Engineering & Land Surveying
85 South 200 East Vernal, Utah 84078
(435) 789-1017 * FAX (435) 789-1813

LOCATION PHOTOS

07
MONTH

17
DAY

13
YEAR

PHOTO

P3

TAKEN BY: J.H.

DRAWN BY: J.L.H.

REVISED: 00-00-00