

## LEGEND:

PROPOSED LOCATION



## BILL BARRETT CORPORATION

**ANSCHUTZ STATE #5-62-36-12**  
**SECTION 36, T5N, R62W, 6th P.M.**  
**1025' FNL 1820' FWL**



**Uintah Engineering & Land Surveying**  
 85 South 200 East Vernal, Utah 84078  
 (435) 789-1017 \* FAX (435) 789-1813

**ACCESS ROAD  
MAP**

**07** **17** **13**  
 MONTH DAY YEAR

SCALE: 1:100,000 DRAWN BY: J.L.H. REVISED: 00-00-00





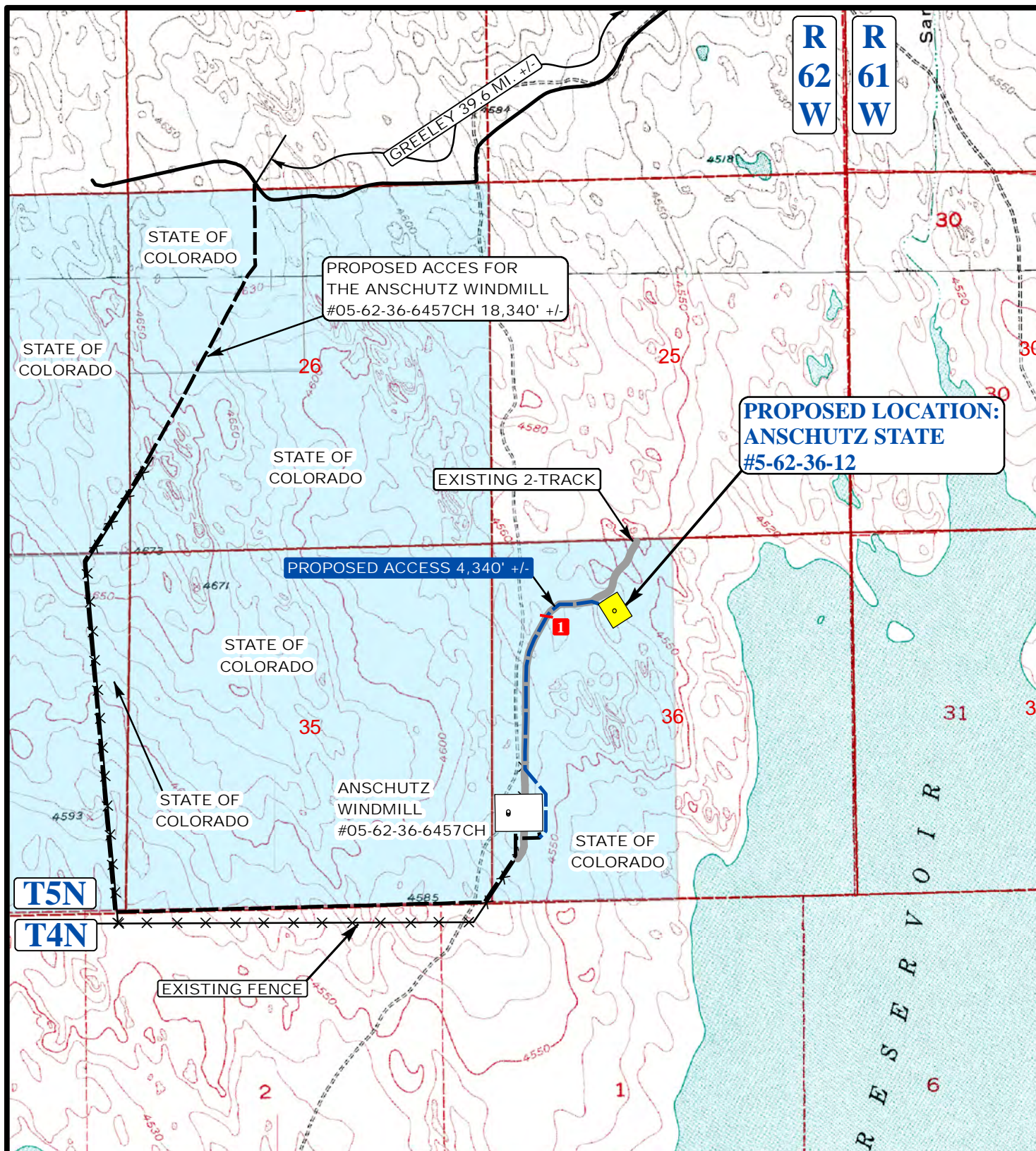

## LEGEND:

- EXISTING ROADS
- - - - - PROPOSED ACCESS ROAD
- EXISTING 2-TRACK
- x x x x x EXISTING FENCE
- 1 18" CMP REQUIRED

## BILL BARRETT CORPORATION

**ANSCHUTZ STATE #5-62-36-12**  
**SECTION 36, T5N, R62W, 6th P.M.**  
**1025' FNL 1820' FWL**



**Utah Engineering & Land Surveying**  
 85 South 200 East Vernal, Utah 84078  
 (435) 789-1017 \* FAX (435) 789-1813



**ACCESS ROAD**  
**MAP**

**07** **17** **13**  
 MONTH DAY YEAR

SCALE: 1" = 2000' DRAWN BY: J.L.H. REVISED: 00-00-00

