

State of Colorado  
**Oil and Gas Conservation Commission**



1120 Lincoln Street, Suite 801, Denver, Colorado 80203 (303)894-2100 Fax: (303)894-2109

FOR OGCC USE ONLY

**RECEIVED**  
**8/9/2013**

**SPILL/RELEASE REPORT**

This form is to be submitted by the party responsible for the oil and gas spill or release. Any spill or release which may impact waters of the State must be reported as soon as practicable; any spill over 20 bbls must be reported within 24 hours and all spills over five bbls must be reported within ten days. Submit a Site Investigation and Remediation Workplan (Form 27) when requested by the Director.

Spill report taken by:

FACILITY ID:

**OPERATOR INFORMATION**

Name of Operator: <u>Encana Oil &amp; Gas (USA) Inc.</u>	OGCC Operator No: <u>100185</u>	Phone Numbers
Address: <u>143 Diamond Avenue</u>		No: <u>970.285.2735</u>
City: <u>Parachute</u> State: <u>CO</u> Zip: <u>81635</u>		Fax: <u>970.285.2705</u>
Contact Person: <u>Charles Jensen</u>		E-Mail: <u>charles.jensen@encana.com</u>

**DESCRIPTION OF SPILL OR RELEASE**

Date of Incident: <u>8/6/2013</u>	Facility Name & No.: <u>Middle Fork Water Facility #120803</u>	County: <u>Garfield</u>
Type of Facility (well, tank battery, flow line, pit): <u>waste facility</u>		QtrQtr: <u>SWSW</u> Section: <u>30</u>
Well Name and Number: <u>NA</u>		Township: <u>5S</u> Range: <u>95W</u>
API Number: <u>NA</u>		Meridian: <u>6</u>
Specify volume spilled and recovered (in bbls) for the following materials:		
Oil spilled: _____ Oil recov'd: _____	Water spilled: _____ Water recov'd: _____	Other spilled: <u>50 (sludge)</u> Other recov'd: <u>50 (sludge)</u>
Ground Water impacted? <input type="checkbox"/> Yes <input checked="" type="checkbox"/> No	Surface Water impacted? <input type="checkbox"/> Yes <input checked="" type="checkbox"/> No	
Contained within berm? <input checked="" type="checkbox"/> Yes <input type="checkbox"/> No	Area and vertical extent of spill: <u>6000 ft2</u> x <u>0.5 inch</u>	
Current land use: <u>rangeland in area, spill within facility boundary</u>	Weather conditions: <u>cloudy, rain</u>	
Soil/geology description: <u>Nihill Channery loam, 1 to 6 percent slopes</u>		
IF LESS THAN A MILE, report distance IN FEET to nearest.... Surface water: <u>250</u> wetlands: <u>NA</u> buildings: <u>250 (facility office)</u>		
Livestock: <u>NA</u> water wells: <u>1200</u> Depth to shallowest ground water: <u>15 feet</u>		
Cause of spill (e.g., equipment failure, human error, etc.): <u>equipment failure</u> Detailed description of the spill/release incident:		
A site glass broke on a truck hauling sludge. The truck was transferring sludge from a pit location to offload into a tank at the facility when the site glass broke. Vacuum trucks and a spill kit was used to clean up the spill.		

**CORRECTIVE ACTION**

Describe immediate response (how stopped, contained and recovered):  
Vacuum trucks and the use of a spill kit was used to contain and remove the sludge. The facility's BMPs also contained some of the spill until vac trucks were used to remove any residual staining.

Describe any emergency pits constructed:  
NA

How was the extent of contamination determined:  
Visual observations.

Further remediation activities proposed (attach separate sheet if needed):  
All spilled sludge was accounted for during clean-up. No further remediation is warranted.

Describe measures taken to prevent problem from reoccurring:  
The trucking company is in the process of changing out dated site glass and fittings on the trucks.

**OTHER NOTIFICATIONS**

List the parties and agencies notified (County, BLM, EPA, DOT, Local Emergency Planning Coordinator or other).

Date	Agency	Contact	Phone	Response
8/6/13	COGCC	Carlos Lujan	970-625-2497, ext.7	Verbal notification.

Spill/Release Tracking No: **2145796**



1 inch = 3,000 feet

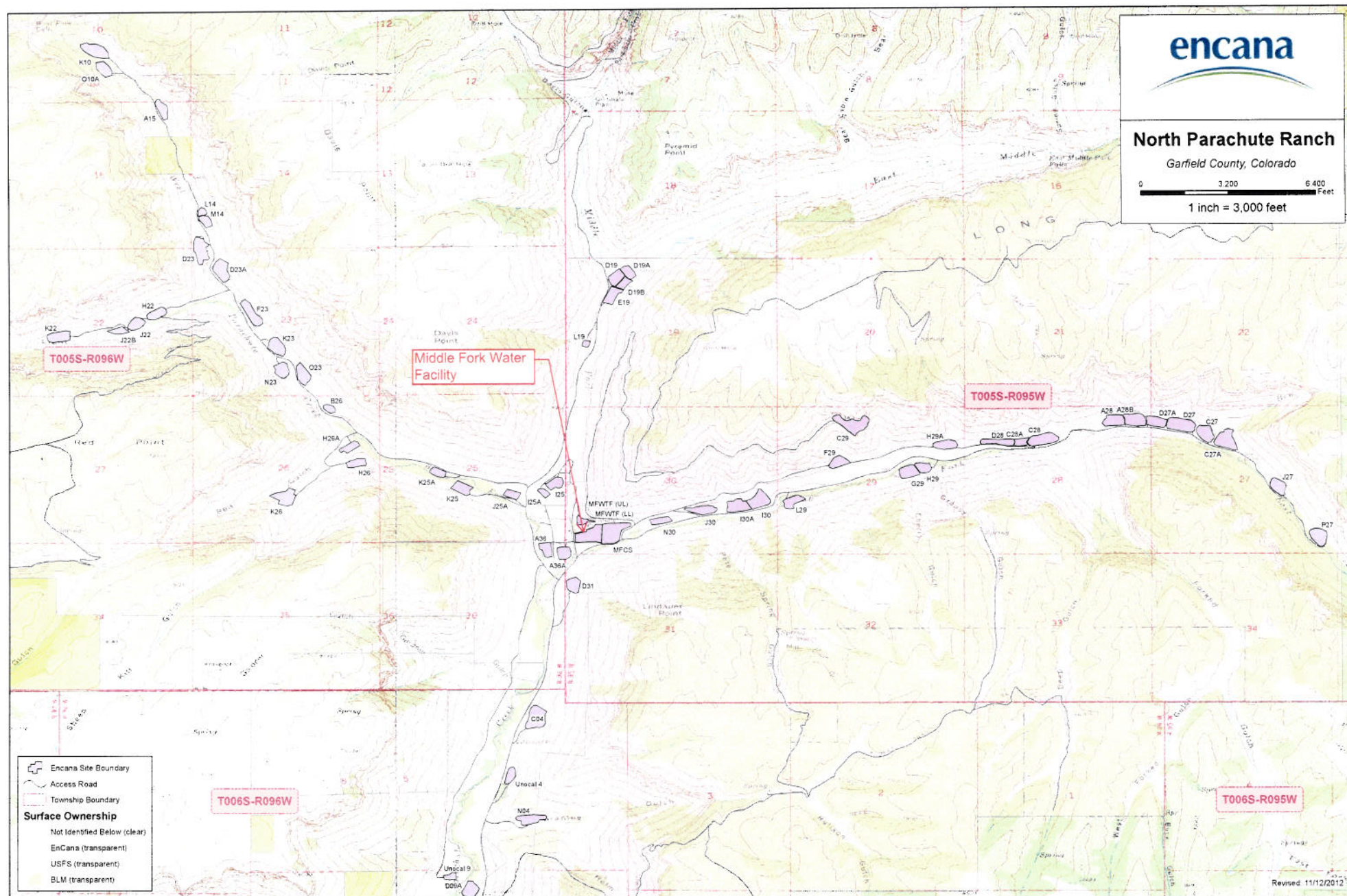

Revised 11/12/2012