

## Lease Map

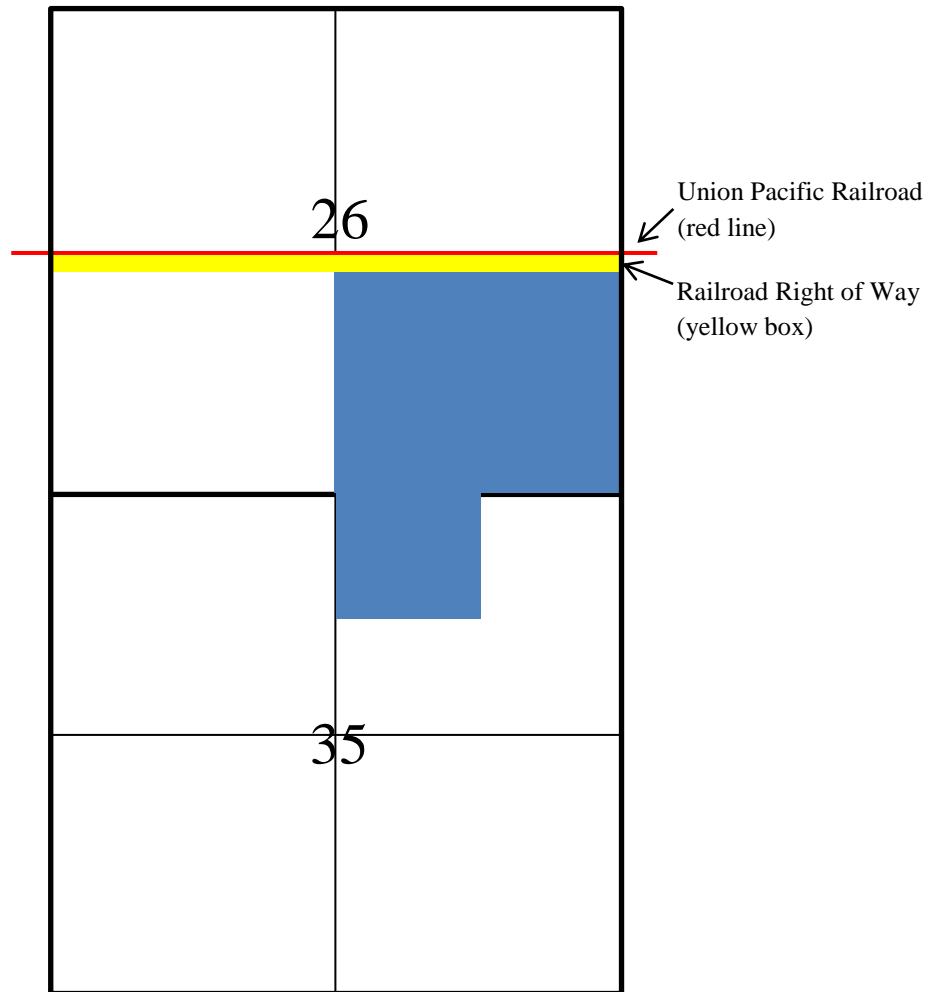

Lease description:

T6N, R65W

Section 35: NW/4NE/4

Section 26: SE/4 less and except that certain tract of land recorded in an instrument in Book 292, Page 371 of the records of Weld County, Colorado, more particularly described as follows: All that part of the North half of the Southeast quarter (N/2SE/4) of Section Twenty six (26) in Township Six (6) North of Range Sixty-five (65) West of the Sixth Principal Meridian, which lies northerly of a line drawn parallel with and one hundred (100) feet distant southerly from the center line of the main track of Union Pacific Railroad (Known as line east from Greeley) as the same has been surveyed, located and staked out through, upon over and across said quarter section and containing an area of 10.66 acres more or less