

# KERR-MCGEE OIL & GAS ONSHORE LP

Location: COLORADO Slot: SLOT#01 DOVE 40N-13HZ (365' FNL & 528' FEL, SEC.12)  
 Field: WELD COUNTY (KERR MCGEE) Well: DOVE 40N-13HZ  
 Facility: SEC.12-T2N-R66W Wellbore: DOVE 40N-13HZ PWB

Plot reference wellpath is DOVE 40N-13HZ (REV-B.0) PWP

True vertical depths are referenced to XTREME 20 (RKB)	Grid System: NAD83 / Lambert Colorado SP, Northern Zone (501), US feet
Measured depths are referenced to XTREME 20 (RKB)	North Reference: True north
XTREME 20 (RKB) to Mean Sea Level: 4983 feet	Scale: True distance
Mean Sea Level to Mud line (At Slot: SLOT#01 DOVE 40N-13HZ (365' FNL & 528' FEL, SEC.12)): 0 feet	Depths are in feet
Coordinates are in feet referenced to Slot	Created by: robiele01 on 06/Jun/2013

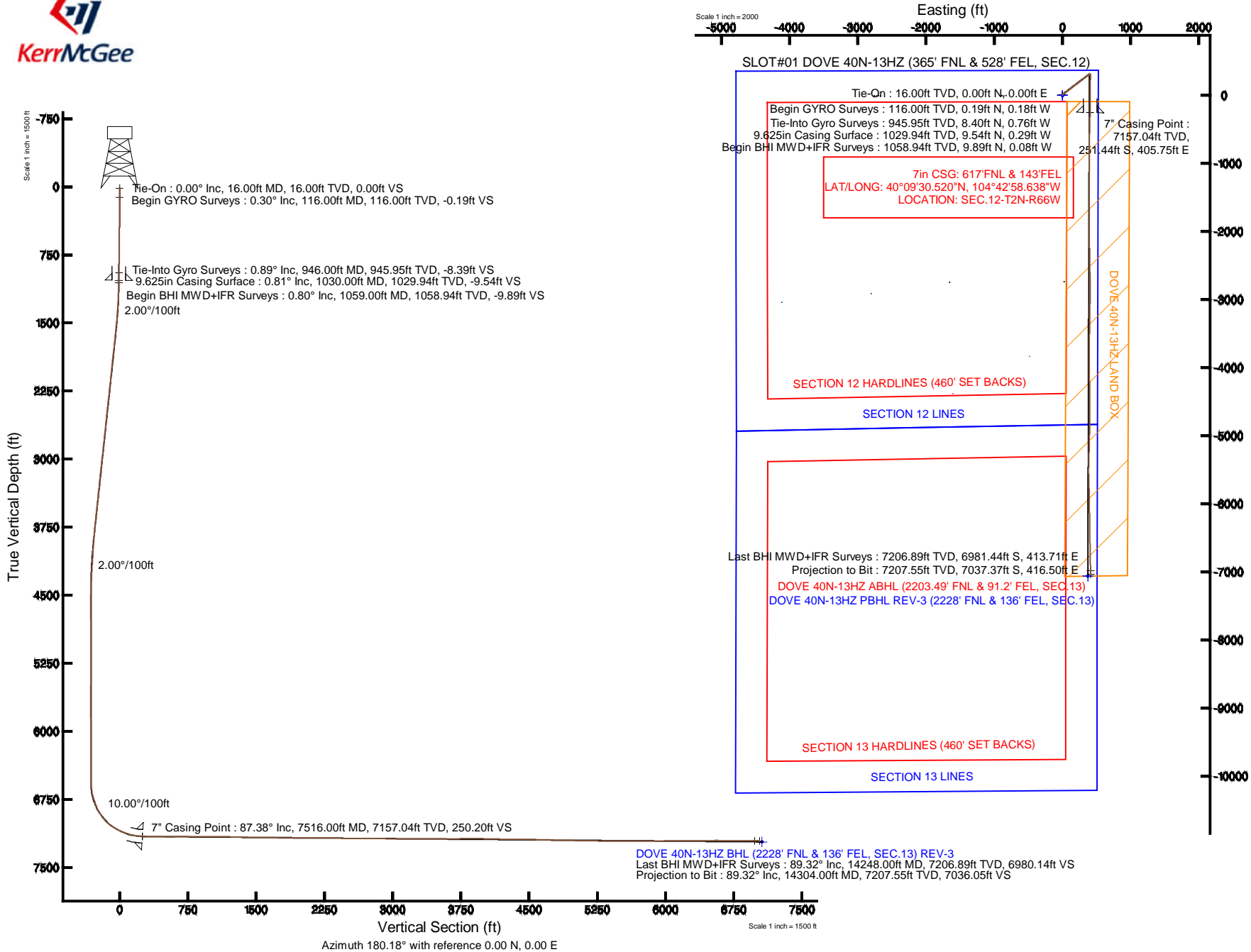



# Actual Wellpath Report

DOVE 40N-13HZ AWP

Page 1 of 7



## REFERENCE WELLPATH IDENTIFICATION

Operator	<b>KERR-MCGEE OIL &amp; GAS ONSHORE LP</b>	Slot	<b>SLOT#01 DOVE 40N-13HZ (365' FNL &amp; 528' FEL, SEC.12)</b>
Area	<b>COLORADO</b>	Well	<b>DOVE 40N-13HZ</b>
Field	<b>WELD COUNTY (KERR MCGEE)</b>	Wellbore	<b>DOVE 40N-13HZ AWB</b>
Facility	<b>SEC.12-T2N-R66W</b>		

## REPORT SETUP INFORMATION

Projection System	<b>NAD83 / Lambert Colorado SP, Northern Zone (501), US feet</b>	Software System	<b>WellArchitect® 4.0.0</b>
North Reference	<b>True</b>	User	<b>Robiale01</b>
Scale	<b>0.999958</b>	Report Generated	<b>06/Jun/2013 at 13:54</b>
Convergence at slot	<b>n/a</b>	Database/Source file	<b>WA_ANADARKO/DOVE_40N-13HZ_AWB.xml</b>

## WELLPATH LOCATION

	Local coordinates		Grid coordinates		Geographic coordinates	
	North[ft]	East[ft]	Easting[US ft]	Northing[US ft]	Latitude	Longitude
Slot Location	2260.79	2130.36	3218638.62	1301792.50	<b>40°09'33.005"N</b>	<b>104°43'03.864"W</b>
Facility Reference Pt			<b>3216528.18</b>	<b>1299513.29</b>	40°09'10.665"N	104°43'31.302"W
Field Reference Pt			<b>3197771.84</b>	<b>1268891.29</b>	40°04'09.600"N	104°47'36.000"W

## WELLPATH DATUM

Calculation method	<b>Minimum curvature</b>	XTREME 20 (RKB) to Facility Vertical Datum	<b>4983.00ft</b>
Horizontal Reference Pt	<b>Slot</b>	XTREME 20 (RKB) to Mean Sea Level	<b>4983.00ft</b>
Vertical Reference Pt	<b>XTREME 20 (RKB)</b>	XTREME 20 (RKB) to Mud Line at Slot (SLOT#01 DOVE 40N-13HZ (365' FNL & 528' FEL, SEC.12))	<b>4983.00ft</b>
MD Reference Pt	<b>XTREME 20 (RKB)</b>	Section Origin	<b>N 0.00, E 0.00 ft</b>
Field Vertical Reference	<b>Mean Sea Level</b>	Section Azimuth	<b>180.18°</b>



# Actual Wellpath Report

DOVE 40N-13HZ AWP

Page 2 of 7



REFERENCE WELLPATH IDENTIFICATION			
Operator	KERR-MCGEE OIL & GAS ONSHORE LP	Slot	SLOT#01 DOVE 40N-13HZ (365' FNL & 528' FEL, SEC.12)
Area	COLORADO	Well	DOVE 40N-13HZ
Field	WELD COUNTY (KERR MCGEE)	Wellbore	DOVE 40N-13HZ AWB
Facility	SEC.12-T2N-R66W		

WELLPATH DATA (180 stations) † = interpolated/extrapolated station										
MD [ft]	Inclination [°]	Azimuth [°]	TVD [ft]	Vert Sect [ft]	North [ft]	East [ft]	Latitude	Longitude	DLS [°/100ft]	Comments
0.00†	0.000	317.420	0.00	0.00	0.00	0.00	40°09'33.005"N	104°43'03.864"W	0.00	
16.00	0.000	317.420	16.00	0.00	0.00	0.00	40°09'33.005"N	104°43'03.864"W	0.00	Tie-On
116.00	0.300	317.420	116.00	-0.19	0.19	-0.18	40°09'33.007"N	104°43'03.866"W	0.30	Begin GYRO Surveys
216.00	0.370	286.050	216.00	-0.47	0.47	-0.66	40°09'33.010"N	104°43'03.873"W	0.19	
316.00	0.530	1.490	316.00	-1.02	1.03	-0.96	40°09'33.015"N	104°43'03.876"W	0.56	
416.00	0.550	318.010	415.99	-1.84	1.85	-1.27	40°09'33.023"N	104°43'03.880"W	0.40	
516.00	0.950	4.830	515.98	-3.02	3.03	-1.52	40°09'33.035"N	104°43'03.884"W	0.70	
616.00	0.510	15.040	615.98	-4.28	4.28	-1.34	40°09'33.047"N	104°43'03.881"W	0.46	
716.00	0.900	354.170	715.97	-5.49	5.50	-1.30	40°09'33.059"N	104°43'03.881"W	0.46	
816.00	0.530	20.850	815.96	-6.71	6.71	-1.22	40°09'33.071"N	104°43'03.880"W	0.49	
916.00	0.930	12.410	915.95	-7.93	7.93	-0.88	40°09'33.083"N	104°43'03.875"W	0.41	
946.00	0.890	15.650	945.95	-8.39	8.40	-0.76	40°09'33.088"N	104°43'03.874"W	0.22	Tie-Into Gyro Surveys
1059.00	0.800	34.880	1058.94	-9.89	9.89	-0.08	40°09'33.103"N	104°43'03.865"W	0.26	Begin BHI MWD+IFR Surveys
1151.00	2.520	43.720	1150.89	-11.88	11.88	1.69	40°09'33.122"N	104°43'03.842"W	1.88	
1243.00	4.420	48.450	1242.72	-15.71	15.69	5.74	40°09'33.160"N	104°43'03.790"W	2.09	
1335.00	6.070	53.900	1334.33	-20.95	20.91	12.33	40°09'33.212"N	104°43'03.705"W	1.87	
1423.00	7.770	54.840	1421.69	-27.14	27.08	20.95	40°09'33.273"N	104°43'03.594"W	1.94	
1508.00	9.920	55.640	1505.67	-34.61	34.52	31.69	40°09'33.346"N	104°43'03.456"W	2.53	
1593.00	9.830	55.570	1589.41	-42.89	42.75	43.72	40°09'33.427"N	104°43'03.301"W	0.11	
1678.00	10.020	55.950	1673.14	-51.17	50.99	55.83	40°09'33.509"N	104°43'03.145"W	0.24	
1763.00	10.160	50.020	1756.83	-60.16	59.95	67.70	40°09'33.597"N	104°43'02.992"W	1.23	
1848.00	9.610	48.060	1840.57	-69.75	69.51	78.73	40°09'33.692"N	104°43'02.850"W	0.76	
1934.00	9.070	47.530	1925.43	-79.16	78.89	89.07	40°09'33.785"N	104°43'02.717"W	0.64	
2019.00	9.290	54.160	2009.34	-87.73	87.43	99.57	40°09'33.869"N	104°43'02.582"W	1.27	
2104.00	9.700	51.550	2093.18	-96.24	95.90	110.74	40°09'33.953"N	104°43'02.438"W	0.70	
2189.00	9.930	50.560	2176.93	-105.38	105.01	122.01	40°09'34.043"N	104°43'02.293"W	0.34	
2274.00	9.250	49.200	2260.74	-114.53	114.13	132.84	40°09'34.133"N	104°43'02.153"W	0.84	
2360.00	9.740	52.600	2345.57	-123.50	123.06	143.85	40°09'34.221"N	104°43'02.011"W	0.87	
2445.00	10.660	53.350	2429.22	-132.60	132.12	155.87	40°09'34.311"N	104°43'01.856"W	1.09	
2530.00	9.520	53.050	2512.91	-141.55	141.04	167.80	40°09'34.399"N	104°43'01.703"W	1.34	
2615.00	9.500	53.170	2596.74	-150.02	149.47	179.03	40°09'34.482"N	104°43'01.558"W	0.03	
2701.00	9.810	53.900	2681.52	-158.63	158.04	190.63	40°09'34.567"N	104°43'01.409"W	0.39	
2786.00	10.110	52.870	2765.24	-167.43	166.81	202.43	40°09'34.653"N	104°43'01.257"W	0.41	
2871.00	9.630	51.610	2848.98	-176.39	175.73	213.95	40°09'34.742"N	104°43'01.108"W	0.62	
2956.00	10.680	52.970	2932.65	-185.58	184.89	225.81	40°09'34.832"N	104°43'00.956"W	1.27	
3041.00	10.970	53.490	3016.14	-195.17	194.44	238.60	40°09'34.926"N	104°43'00.791"W	0.36	
3127.00	10.630	53.300	3100.61	-204.82	204.05	251.53	40°09'35.021"N	104°43'00.624"W	0.40	
3212.00	10.170	54.230	3184.22	-213.93	213.12	263.91	40°09'35.111"N	104°43'00.465"W	0.58	
3297.00	9.220	53.930	3268.00	-222.36	221.52	275.50	40°09'35.194"N	104°43'00.316"W	1.12	
3382.00	9.290	52.220	3351.89	-230.61	229.73	286.43	40°09'35.275"N	104°43'00.175"W	0.33	
3467.00	9.490	50.120	3435.76	-239.34	238.43	297.23	40°09'35.361"N	104°43'00.036"W	0.47	
3552.00	9.770	52.020	3519.56	-248.30	247.36	308.29	40°09'35.449"N	104°42'59.893"W	0.50	
3637.00	10.020	55.470	3603.29	-256.97	255.99	320.07	40°09'35.535"N	104°42'59.742"W	0.76	
3722.00	9.460	53.300	3687.07	-265.37	264.35	331.76	40°09'35.617"N	104°42'59.591"W	0.79	
3808.00	9.290	54.040	3771.92	-273.71	272.65	343.04	40°09'35.699"N	104°42'59.446"W	0.24	



# Actual Wellpath Report

DOVE 40N-13HZ AWP

Page 3 of 7



## REFERENCE WELLPATH IDENTIFICATION

Operator	KERR-MCGEE OIL & GAS ONSHORE LP	Slot	SLOT#01 DOVE 40N-13HZ (365' FNL & 528' FEL, SEC.12)
Area	COLORADO	Well	DOVE 40N-13HZ
Field	WELD COUNTY (KERR MCGEE)	Wellbore	DOVE 40N-13HZ AWB
Facility	SEC.12-T2N-R66W		

## WELLPATH DATA (180 stations)

MD [ft]	Inclination [°]	Azimuth [°]	TVD [ft]	Vert Sect [ft]	North [ft]	East [ft]	Latitude	Longitude	DLS [°/100ft]	Comments
3893.00	8.880	56.620	3855.85	-281.38	280.29	354.08	40°09'35.775"N	104°42'59.304"W	0.68	
3978.00	8.080	59.550	3939.92	-288.05	286.93	364.70	40°09'35.840"N	104°42'59.167"W	1.07	
4064.00	7.170	62.840	4025.16	-293.59	292.44	374.69	40°09'35.895"N	104°42'59.038"W	1.17	
4149.00	6.960	64.230	4109.52	-298.28	297.10	384.05	40°09'35.941"N	104°42'58.918"W	0.32	
4234.00	6.640	57.000	4193.92	-303.22	302.02	392.81	40°09'35.990"N	104°42'58.805"W	1.07	
4320.00	5.260	56.000	4279.46	-308.16	306.93	400.24	40°09'36.038"N	104°42'58.709"W	1.61	
4405.00	3.570	50.850	4364.20	-312.03	310.78	405.53	40°09'36.076"N	104°42'58.641"W	2.04	
4490.00	2.430	31.180	4449.09	-315.25	313.99	408.51	40°09'36.108"N	104°42'58.602"W	1.79	
4575.00	1.120	15.800	4534.04	-317.59	316.34	409.67	40°09'36.131"N	104°42'58.588"W	1.63	
4660.00	0.500	225.030	4619.04	-318.13	316.87	409.64	40°09'36.136"N	104°42'58.588"W	1.85	
4746.00	0.940	230.880	4705.03	-317.42	316.16	408.82	40°09'36.129"N	104°42'58.598"W	0.52	
4830.00	1.050	233.780	4789.02	-316.52	315.27	407.67	40°09'36.121"N	104°42'58.613"W	0.14	
4915.00	0.980	224.350	4874.01	-315.54	314.29	406.53	40°09'36.111"N	104°42'58.628"W	0.21	
5000.00	0.980	210.230	4958.99	-314.39	313.15	405.66	40°09'36.099"N	104°42'58.639"W	0.28	
5085.00	0.880	206.940	5043.98	-313.18	311.94	404.99	40°09'36.088"N	104°42'58.648"W	0.13	
5170.00	0.700	298.960	5128.98	-312.84	311.60	404.24	40°09'36.084"N	104°42'58.657"W	1.35	
5256.00	0.860	309.320	5214.97	-313.51	312.27	403.29	40°09'36.091"N	104°42'58.670"W	0.25	
5341.00	0.960	311.340	5299.96	-314.38	313.14	402.26	40°09'36.099"N	104°42'58.683"W	0.12	
5426.00	1.230	302.860	5384.94	-315.34	314.11	400.96	40°09'36.109"N	104°42'58.700"W	0.37	
5511.00	1.550	302.500	5469.92	-316.45	315.22	399.22	40°09'36.120"N	104°42'58.722"W	0.38	
5596.00	0.530	298.050	5554.90	-317.24	316.02	397.90	40°09'36.128"N	104°42'58.739"W	1.20	
5681.00	0.370	281.190	5639.90	-317.48	316.26	397.29	40°09'36.130"N	104°42'58.747"W	0.24	
5767.00	0.310	221.400	5725.90	-317.36	316.14	396.86	40°09'36.129"N	104°42'58.753"W	0.40	
5852.00	0.310	187.400	5810.90	-316.96	315.74	396.68	40°09'36.125"N	104°42'58.755"W	0.21	
5937.00	0.490	168.050	5895.90	-316.37	315.16	396.73	40°09'36.119"N	104°42'58.754"W	0.26	
6022.00	0.940	158.760	5980.89	-315.37	314.15	397.05	40°09'36.109"N	104°42'58.750"W	0.54	
6107.00	0.250	171.720	6065.88	-314.54	313.32	397.33	40°09'36.101"N	104°42'58.746"W	0.82	
6193.00	0.030	319.720	6151.88	-314.37	313.15	397.35	40°09'36.100"N	104°42'58.746"W	0.32	
6278.00	0.180	176.870	6236.88	-314.25	313.03	397.34	40°09'36.098"N	104°42'58.746"W	0.24	
6363.00	0.480	122.990	6321.88	-313.93	312.71	397.64	40°09'36.095"N	104°42'58.742"W	0.47	
6448.00	0.780	100.160	6406.88	-313.63	312.41	398.51	40°09'36.092"N	104°42'58.731"W	0.45	
6549.00	1.180	89.750	6507.86	-313.52	312.29	400.23	40°09'36.091"N	104°42'58.709"W	0.43	
6624.00	2.540	130.690	6582.82	-312.45	311.21	402.26	40°09'36.080"N	104°42'58.683"W	2.43	
6666.00	7.180	161.020	6624.67	-309.36	308.12	403.82	40°09'36.050"N	104°42'58.663"W	12.26	
6709.00	11.130	156.100	6667.11	-303.03	301.78	406.38	40°09'35.987"N	104°42'58.630"W	9.36	
6751.00	14.850	161.130	6708.03	-294.24	292.98	409.76	40°09'35.900"N	104°42'58.586"W	9.25	
6794.00	17.480	173.140	6749.34	-282.62	281.35	412.32	40°09'35.785"N	104°42'58.553"W	9.86	
6836.00	19.300	184.210	6789.20	-269.43	268.16	412.56	40°09'35.655"N	104°42'58.550"W	9.36	
6879.00	22.510	183.480	6829.37	-254.12	252.85	411.54	40°09'35.504"N	104°42'58.563"W	7.49	
6921.00	26.430	185.360	6867.59	-236.77	235.52	410.18	40°09'35.332"N	104°42'58.581"W	9.51	
6964.00	30.080	184.610	6905.46	-216.49	215.24	408.42	40°09'35.132"N	104°42'58.604"W	8.53	
7006.00	35.910	184.100	6940.67	-193.69	192.44	406.69	40°09'34.907"N	104°42'58.626"W	13.90	
7050.00	40.790	182.810	6975.17	-166.44	165.20	405.06	40°09'34.637"N	104°42'58.647"W	11.24	
7092.00	47.080	181.590	7005.40	-137.34	136.10	403.96	40°09'34.350"N	104°42'58.661"W	15.11	
7135.00	52.270	179.930	7033.21	-104.57	103.33	403.54	40°09'34.026"N	104°42'58.666"W	12.42	



# Actual Wellpath Report

DOVE 40N-13HZ AWP

Page 4 of 7



## REFERENCE WELLPATH IDENTIFICATION

Operator	KERR-MCGEE OIL & GAS ONSHORE LP	Slot	SLOT#01 DOVE 40N-13HZ (365' FNL & 528' FEL, SEC.12)
Area	COLORADO	Well	DOVE 40N-13HZ
Field	WELD COUNTY (KERR MCGEE)	Wellbore	DOVE 40N-13HZ AWB
Facility	SEC.12-T2N-R66W		

## WELLPATH DATA (180 stations) † = interpolated/extrapolated station

MD [ft]	Inclination [°]	Azimuth [°]	TVD [ft]	Vert Sect [ft]	North [ft]	East [ft]	Latitude	Longitude	DLS [°/100ft]	Comments
7177.00	58.040	178.130	7057.20	-70.12	68.88	404.15	40°09'33.686"N	104°42'58.659"W	14.18	
7220.00	62.200	178.200	7078.62	-32.87	31.63	405.34	40°09'33.317"N	104°42'58.643"W	9.68	
7262.00	66.500	179.040	7096.80	4.97	-6.22	406.25	40°09'32.944"N	104°42'58.632"W	10.40	
7306.00	69.710	178.970	7113.20	45.78	-47.03	406.96	40°09'32.540"N	104°42'58.623"W	7.30	
7348.00	71.910	178.640	7127.01	85.43	-86.69	407.78	40°09'32.148"N	104°42'58.612"W	5.29	
7391.00	75.790	179.570	7138.97	126.72	-127.98	408.43	40°09'31.740"N	104°42'58.604"W	9.26	
7433.00	80.700	181.390	7147.52	167.82	-169.08	408.08	40°09'31.334"N	104°42'58.608"W	12.44	
7470.00	82.310	181.640	7152.99	204.41	-205.66	407.11	40°09'30.973"N	104°42'58.621"W	4.40	
7514.00	87.350	181.750	7156.95	248.20	-249.45	405.81	40°09'30.540"N	104°42'58.637"W	11.46	
7516.00†	87.378	181.760	7157.04	250.20	-251.44	405.75	40°09'30.520"N	104°42'58.638"W	1.47	7" Casing Point
7592.00	88.430	182.130	7159.82	326.11	-327.35	403.17	40°09'29.770"N	104°42'58.671"W	1.47	
7684.00	89.480	181.440	7161.50	418.05	-419.29	400.31	40°09'28.862"N	104°42'58.708"W	1.37	
7775.00	89.230	181.650	7162.52	509.02	-510.25	397.85	40°09'27.963"N	104°42'58.740"W	0.36	
7867.00	90.680	180.830	7162.60	601.00	-602.22	395.86	40°09'27.054"N	104°42'58.766"W	1.81	
7959.00	90.950	179.770	7161.29	692.99	-694.21	395.38	40°09'26.145"N	104°42'58.772"W	1.19	
8050.00	90.520	180.790	7160.12	783.98	-785.20	394.94	40°09'25.246"N	104°42'58.778"W	1.22	
8142.00	89.540	181.570	7160.07	875.97	-877.18	393.04	40°09'24.337"N	104°42'58.802"W	1.36	
8233.00	90.000	179.660	7160.44	966.96	-968.17	392.07	40°09'23.437"N	104°42'58.815"W	2.16	
8325.00	89.630	179.650	7160.73	1058.95	-1060.17	392.62	40°09'22.528"N	104°42'58.807"W	0.40	
8416.00	89.290	179.730	7161.59	1149.95	-1151.16	393.11	40°09'21.629"N	104°42'58.801"W	0.38	
8507.00	89.050	179.530	7162.91	1240.93	-1242.15	393.70	40°09'20.730"N	104°42'58.794"W	0.34	
8598.00	88.430	180.270	7164.91	1331.91	-1333.13	393.86	40°09'19.831"N	104°42'58.792"W	1.06	
8683.00	87.910	179.630	7167.63	1416.86	-1418.08	393.93	40°09'18.991"N	104°42'58.791"W	0.97	
8769.00	88.550	179.480	7170.28	1502.82	-1504.04	394.60	40°09'18.142"N	104°42'58.782"W	0.76	
8854.00	89.170	180.030	7171.97	1587.80	-1589.02	394.96	40°09'17.302"N	104°42'58.777"W	0.97	
8939.00	90.150	179.760	7172.48	1672.79	-1674.02	395.12	40°09'16.462"N	104°42'58.775"W	1.20	
9024.00	89.690	179.520	7172.60	1757.79	-1759.01	395.65	40°09'15.622"N	104°42'58.769"W	0.61	
9109.00	89.320	180.970	7173.33	1842.78	-1844.01	395.29	40°09'14.782"N	104°42'58.773"W	1.76	
9194.00	88.860	179.980	7174.68	1927.77	-1928.99	394.59	40°09'13.943"N	104°42'58.782"W	1.28	
9280.00	90.030	179.940	7175.51	2013.77	-2014.99	394.65	40°09'13.093"N	104°42'58.782"W	1.36	
9365.00	90.650	180.520	7175.01	2098.76	-2099.98	394.30	40°09'12.253"N	104°42'58.786"W	1.00	
9450.00	89.780	178.520	7174.69	2183.75	-2184.98	395.02	40°09'11.413"N	104°42'58.777"W	2.57	
9535.00	89.420	178.370	7175.28	2268.71	-2269.94	397.32	40°09'10.573"N	104°42'58.747"W	0.46	
9621.00	89.110	177.930	7176.39	2354.65	-2355.89	400.10	40°09'09.724"N	104°42'58.711"W	0.63	
9706.00	89.350	180.160	7177.53	2439.62	-2440.86	401.52	40°09'08.884"N	104°42'58.693"W	2.64	
9791.00	89.500	179.180	7178.38	2524.61	-2525.86	402.01	40°09'08.044"N	104°42'58.687"W	1.17	
9876.00	89.660	179.080	7179.01	2609.59	-2610.85	403.30	40°09'07.204"N	104°42'58.670"W	0.22	
9961.00	89.130	180.340	7179.90	2694.59	-2695.84	403.73	40°09'06.365"N	104°42'58.665"W	1.61	
10046.00	89.070	179.700	7181.24	2779.57	-2780.83	403.70	40°09'05.525"N	104°42'58.665"W	0.76	
10132.00	89.590	180.190	7182.24	2865.57	-2866.82	403.78	40°09'04.675"N	104°42'58.664"W	0.83	
10216.00	90.030	180.200	7182.52	2949.57	-2950.82	403.49	40°09'03.845"N	104°42'58.668"W	0.52	
10302.00	89.690	180.030	7182.73	3035.57	-3036.82	403.32	40°09'02.995"N	104°42'58.670"W	0.44	
10387.00	89.630	180.960	7183.24	3120.56	-3121.81	402.59	40°09'02.155"N	104°42'58.680"W	1.10	
10472.00	89.540	180.170	7183.85	3205.56	-3206.81	401.75	40°09'01.315"N	104°42'58.690"W	0.94	
10557.00	89.600	180.810	7184.49	3290.55	-3291.80	401.02	40°09'00.475"N	104°42'58.700"W	0.76	



# Actual Wellpath Report

DOVE 40N-13HZ AWP

Page 5 of 7



REFERENCE WELLPATH IDENTIFICATION				
Operator	KERR-MCGEE OIL & GAS ONSHORE LP		Slot	SLOT#01 DOVE 40N-13HZ (365' FNL & 528' FEL, SEC.12)
Area	COLORADO		Well	DOVE 40N-13HZ
Field	WELD COUNTY (KERR MCGEE)		Wellbore	DOVE 40N-13HZ AWB
Facility	SEC.12-T2N-R66W			

WELLPATH DATA (180 stations)										
MD [ft]	Inclination [°]	Azimuth [°]	TVD [ft]	Vert Sect [ft]	North [ft]	East [ft]	Latitude	Longitude	DLS [°/100ft]	Comments
10642.00	90.250	181.540	7184.60	3375.54	-3376.78	399.28	40°08'59.635"N	104°42'58.722"W	1.15	
10727.00	89.910	181.120	7184.48	3460.52	-3461.76	397.31	40°08'58.796"N	104°42'58.748"W	0.64	
10812.00	90.310	180.170	7184.32	3545.52	-3546.75	396.35	40°08'57.956"N	104°42'58.760"W	1.21	
10897.00	90.370	180.160	7183.82	3630.52	-3631.75	396.10	40°08'57.116"N	104°42'58.763"W	0.07	
10982.00	90.860	180.410	7182.90	3715.51	-3716.74	395.68	40°08'56.276"N	104°42'58.769"W	0.65	
11068.00	90.860	181.360	7181.61	3801.49	-3802.72	394.35	40°08'55.426"N	104°42'58.786"W	1.10	
11153.00	90.120	178.810	7180.88	3886.48	-3887.71	394.23	40°08'54.586"N	104°42'58.787"W	3.12	
11238.00	88.580	179.150	7181.85	3971.46	-3972.69	395.74	40°08'53.747"N	104°42'58.768"W	1.86	
11323.00	88.460	179.820	7184.04	4056.42	-4057.66	396.50	40°08'52.907"N	104°42'58.758"W	0.80	
11408.00	88.110	180.730	7186.59	4141.38	-4142.62	396.10	40°08'52.067"N	104°42'58.763"W	1.15	
11494.00	88.710	177.460	7188.98	4227.32	-4228.56	397.45	40°08'51.218"N	104°42'58.746"W	3.86	
11579.00	89.380	177.510	7190.39	4312.21	-4313.47	401.18	40°08'50.379"N	104°42'58.698"W	0.79	
11664.00	89.720	180.350	7191.06	4397.18	-4398.44	402.77	40°08'49.539"N	104°42'58.677"W	3.36	
11750.00	89.690	180.450	7191.50	4483.18	-4484.44	402.17	40°08'48.689"N	104°42'58.685"W	0.12	
11835.00	89.190	180.670	7192.33	4568.18	-4569.43	401.34	40°08'47.850"N	104°42'58.696"W	0.64	
11920.00	88.210	179.750	7194.26	4653.15	-4654.41	401.03	40°08'47.010"N	104°42'58.700"W	1.58	
12005.00	88.640	179.140	7196.60	4738.11	-4739.37	401.85	40°08'46.170"N	104°42'58.689"W	0.88	
12090.00	88.460	181.010	7198.75	4823.08	-4824.34	401.74	40°08'45.331"N	104°42'58.691"W	2.21	
12175.00	88.980	182.670	7200.65	4908.02	-4909.27	399.01	40°08'44.491"N	104°42'58.726"W	2.05	
12260.00	88.650	181.480	7202.41	4992.95	-4994.19	395.93	40°08'43.652"N	104°42'58.766"W	1.45	
12346.00	89.050	182.100	7204.13	5078.90	-5080.13	393.25	40°08'42.803"N	104°42'58.800"W	0.86	
12431.00	89.040	181.060	7205.55	5163.86	-5165.09	390.90	40°08'41.963"N	104°42'58.830"W	1.22	
12516.00	88.610	180.430	7207.29	5248.84	-5250.06	389.80	40°08'41.124"N	104°42'58.845"W	0.90	
12601.00	89.660	182.400	7208.58	5333.81	-5335.02	387.70	40°08'40.284"N	104°42'58.872"W	2.63	
12686.00	89.750	181.750	7209.01	5418.76	-5419.96	384.62	40°08'39.445"N	104°42'58.911"W	0.77	
12771.00	88.770	180.300	7210.11	5503.74	-5504.94	383.10	40°08'38.605"N	104°42'58.931"W	2.06	
12856.00	89.840	178.460	7211.14	5588.72	-5589.92	384.02	40°08'37.765"N	104°42'58.919"W	2.50	
12941.00	90.240	178.530	7211.08	5673.68	-5674.89	386.25	40°08'36.925"N	104°42'58.890"W	0.48	
13026.00	90.460	177.480	7210.56	5758.62	-5759.84	389.21	40°08'36.086"N	104°42'58.852"W	1.26	
13111.00	90.700	179.040	7209.70	5843.56	-5844.79	391.79	40°08'35.246"N	104°42'58.819"W	1.86	
13196.00	91.100	179.110	7208.37	5928.54	-5929.77	393.17	40°08'34.407"N	104°42'58.801"W	0.48	
13281.00	91.630	178.460	7206.34	6013.49	-6014.73	394.97	40°08'33.567"N	104°42'58.778"W	0.99	
13366.00	90.430	179.690	7204.81	6098.45	-6099.70	396.34	40°08'32.727"N	104°42'58.761"W	2.02	
13451.00	90.210	179.440	7204.34	6183.45	-6184.70	396.99	40°08'31.887"N	104°42'58.752"W	0.39	
13536.00	90.210	179.890	7204.03	6268.44	-6269.69	397.48	40°08'31.047"N	104°42'58.746"W	0.53	
13621.00	90.220	178.820	7203.71	6353.43	-6354.69	398.44	40°08'30.208"N	104°42'58.734"W	1.26	
13706.00	90.400	178.910	7203.25	6438.41	-6439.67	400.12	40°08'29.368"N	104°42'58.712"W	0.24	
13791.00	90.490	178.420	7202.59	6523.38	-6524.64	402.10	40°08'28.528"N	104°42'58.686"W	0.59	
13876.00	89.200	179.150	7202.82	6608.35	-6609.62	403.91	40°08'27.688"N	104°42'58.663"W	1.74	
13961.00	89.200	179.260	7204.01	6693.33	-6694.60	405.08	40°08'26.848"N	104°42'58.648"W	0.13	
14046.00	89.260	178.810	7205.15	6778.30	-6779.58	406.52	40°08'26.009"N	104°42'58.630"W	0.53	
14132.00	89.480	178.190	7206.09	6864.26	-6865.55	408.77	40°08'25.159"N	104°42'58.601"W	0.76	
14217.00	89.780	177.210	7206.64	6949.18	-6950.48	412.18	40°08'24.320"N	104°42'58.557"W	1.21	
14248.00	89.320	177.140	7206.89	6980.14	-6981.44	413.71	40°08'24.014"N	104°42'58.537"W	1.50	Last BHI MWD+IFR Surveys
14304.00	89.320	177.140	7207.55	7036.05	-7037.37	416.50	40°08'23.461"N	104°42'58.501"W	0.00	Projection to Bit



# Actual Wellpath Report

DOVE 40N-13HZ AWP

Page 6 of 7



## REFERENCE WELLPATH IDENTIFICATION

Operator	KERR-MCGEE OIL & GAS ONSHORE LP	Slot	SLOT#01 DOVE 40N-13HZ (365' FNL & 528' FEL, SEC.12)
Area	COLORADO	Well	DOVE 40N-13HZ
Field	WELD COUNTY (KERR MCGEE)	Wellbore	DOVE 40N-13HZ AWB
Facility	SEC.12-T2N-R66W		

## HOLE & CASING SECTIONS - Ref Wellbore: DOVE 40N-13HZ AWB Ref Wellpath: DOVE 40N-13HZ AWP

String/Diameter	Start MD [ft]	End MD [ft]	Interval [ft]	Start TVD [ft]	End TVD [ft]	Start N/S [ft]	Start E/W [ft]	End N/S [ft]	End E/W [ft]
13.5in Open Hole	16.00	1041.00	1025.00	16.00	1040.94	0.00	0.00	9.68	-0.21
9.625in Casing Surface	16.00	1030.00	1014.00	16.00	1029.94	0.00	0.00	9.54	-0.29
8.75in Open Hole	1041.00	7528.00	6487.00	1040.94	7157.57	9.68	-0.21	-263.43	405.38
7in Casing Intermediate	16.00	7516.00	7500.00	16.00	7157.04	0.00	0.00	-251.44	405.75
6.125in Open Hole	7528.00	14304.00	6776.00	7157.57	7207.55	-263.43	405.38	-7037.37	416.50

## TARGETS

Name	MD [ft]	TVD [ft]	North [ft]	East [ft]	Grid East [US ft]	Grid North [US ft]	Latitude	Longitude	Shape
DOVE 1-12HZ PAD SECTION 12 HARDLINES (460' SET BACKS)		4983.00	0.00	0.00	3218638.62	1301792.50	40°09'33.005"N	104°43'03.864"W	polygon
DOVE 1-12HZ PAD SECTION 12 LINES		4983.00	0.00	0.00	3218638.62	1301792.50	40°09'33.005"N	104°43'03.864"W	polygon
DOVE 1-12HZ PAD SECTION 13 HARDLINES (460' SET BACKS)		4983.00	0.00	0.00	3218638.62	1301792.50	40°09'33.005"N	104°43'03.864"W	polygon
DOVE 1-12HZ PAD SECTION 13 LINES		4983.00	0.00	0.00	3218638.62	1301792.50	40°09'33.005"N	104°43'03.864"W	polygon
DOVE 40N-13HZ LAND BOX		4983.00	0.00	0.00	3218638.62	1301792.50	40°09'33.005"N	104°43'03.864"W	polygon
DOVE 40N-13HZ BHL (2228' FNL & 136' FEL, SEC.13) REV-2		7155.00	-7061.88	371.68	3219072.56	1294734.48	40°08'23.219"N	104°42'59.078"W	point
DOVE 40N-13HZ BHL ON PLAT (2228' FNL & 50' FEL, SEC.13) REV-1		7155.00	-7061.88	457.69	3219158.57	1294735.24	40°08'23.219"N	104°42'57.971"W	point
DOVE 40N-13HZ BHL (2228' FNL & 136' FEL, SEC.13) REV-3		7218.00	-7061.88	371.70	3219072.58	1294734.48	40°08'23.219"N	104°42'59.078"W	point

## WELLPATH COMPOSITION - Ref Wellbore: DOVE 40N-13HZ AWB Ref Wellpath: DOVE 40N-13HZ AWP

Start MD [ft]	End MD [ft]	Positional Uncertainty Model	Log Name/Comment	Wellbore
16.00	946.00	Generic gyro - continuous (Standard)	MS ENERGY WIRELINE/GYRO <116-946>	DOVE 40N-13HZ AWB
946.00	7470.00	NaviTrak (MAGCORR,IFR)	BHI MWD+IFR 8 3/4" HOLE SURVEYS <516-7470>	DOVE 40N-13HZ AWB
7470.00	14248.00	OnTrak (MAGCORR,IFR)	BHI MWD+IFR SURVEYS 6 1/8" HOLE <7514-14248>	DOVE 40N-13HZ AWB
14248.00	14304.00	Blind Drilling (std)	Projection to bit	DOVE 40N-13HZ AWB



# Actual Wellpath Report

DOVE 40N-13HZ AWP

Page 7 of 7



## REFERENCE WELLPATH IDENTIFICATION

Operator	KERR-MCGEE OIL & GAS ONSHORE LP	Slot	SLOT#01 DOVE 40N-13HZ (365' FNL & 528' FEL, SEC.12)
Area	COLORADO	Well	DOVE 40N-13HZ
Field	WELD COUNTY (KERR MCGEE)	Wellbore	DOVE 40N-13HZ AWB
Facility	SEC.12-T2N-R66W		

## WELLPATH COMMENTS

MD [ft]	Inclination [°]	Azimuth [°]	TVD [ft]	Comment
16.00	0.000	317.420	16.00	Tie-On
116.00	0.300	317.420	116.00	Begin GYRO Surveys
946.00	0.890	15.650	945.95	Tie-Into Gyro Surveys
1059.00	0.800	34.880	1058.94	Begin BHI MWD+IFR Surveys
7516.00	87.378	181.760	7157.04	7" Casing Point
14248.00	89.320	177.140	7206.89	Last BHI MWD+IFR Surveys
14304.00	89.320	177.140	7207.55	Projection to Bit