

5D Plan Report**ANADARKO**

Field Name: *WATTENBERG_ANADARKO_NAD83*
Site Name: *CLINE PAD*
Well Name: *CLINE 26C-2HZ*
Plan: *WP01 - PERMIT*

04 June 2013

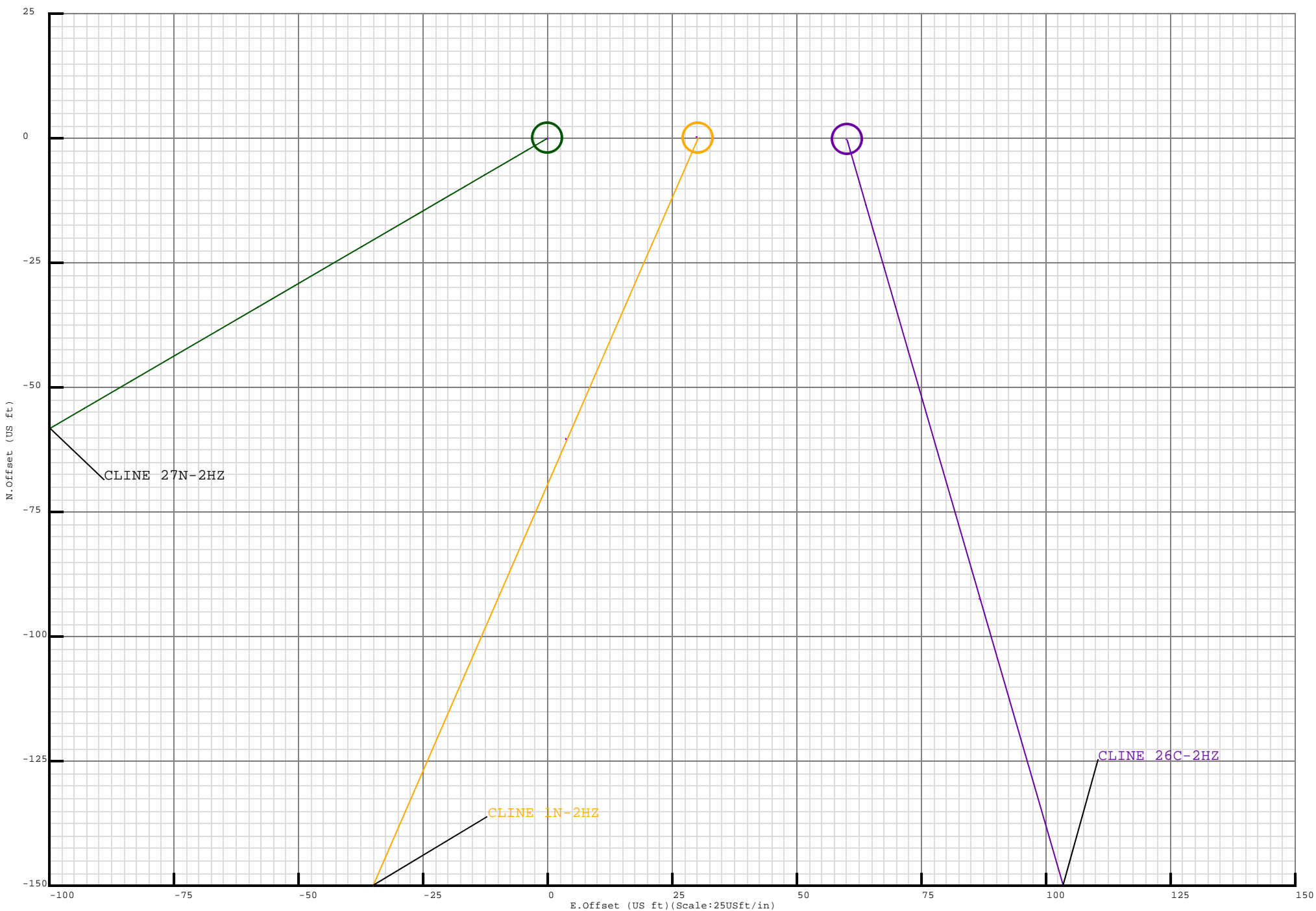



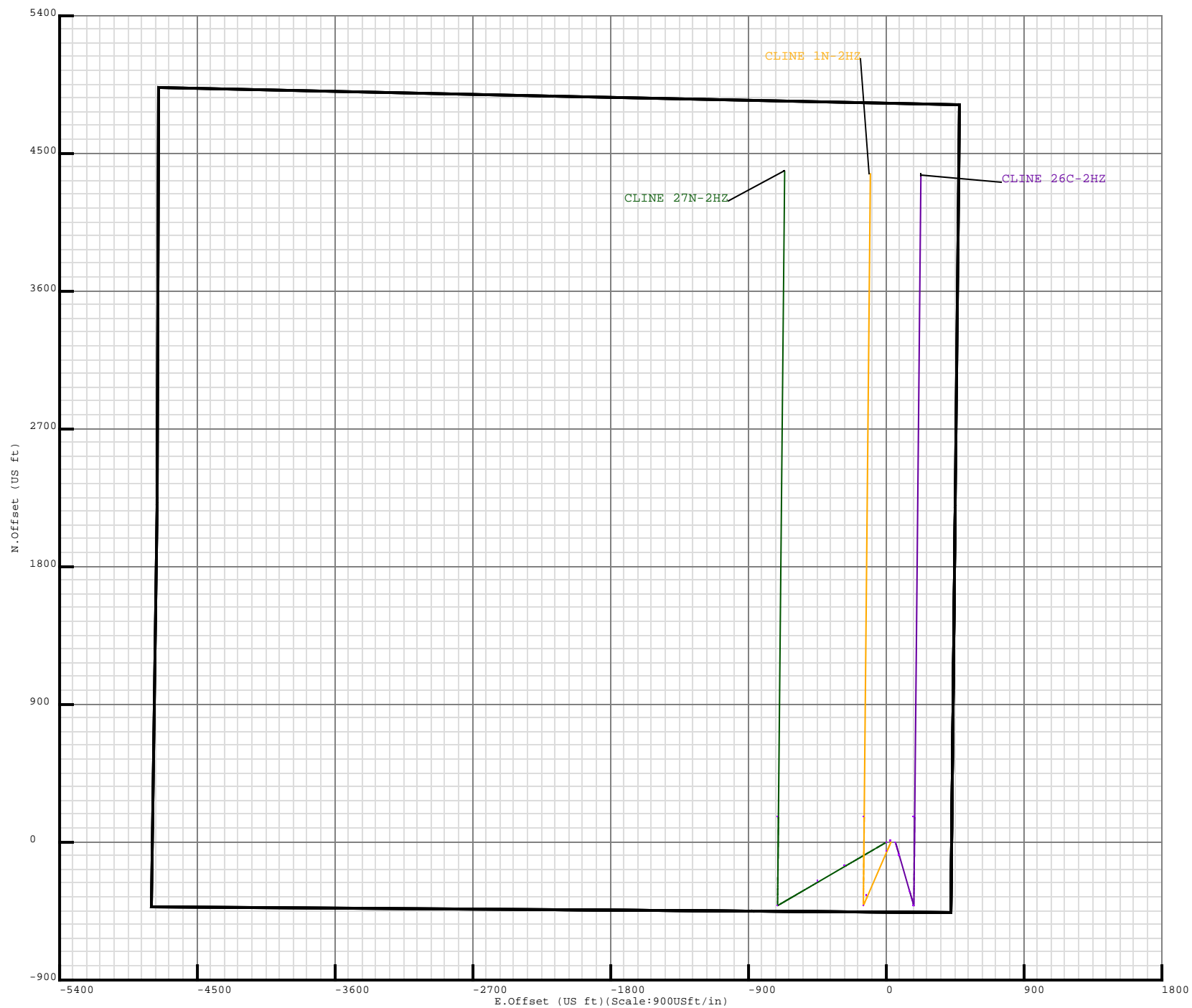

SPIDER PLOT - EXPANDED VIEW
CLINE PAD

Plan Data for CLINE 26C-2HZ

Field: WATTENBERG_ANADARKO_NAD83

Map Unit: USft

Vertical Reference Datum (VRD): Mean Sea Level

Projected Coordinate System: NAD83 / Colorado North (ftUS)

Site: CLINE PAD

Unit: USFeet

TVD Reference:

Company Name: ANADARKO

Position: Northing: 1302164.62USft Latitude: 40.161009°
Easting: 3181675.55USft Longitude: -104.849974°

North Reference: True Grid Convergence: 0.42°

Elevation Above VRD: 0.00USft

Slot: CLINE 26C-2HZ

Position:

Offset is from Site centre

+N/-S: -0.36USft Northing: 1302164.70USft Latitude: 40.161008°
+E/-W: 60.09USft Easting: 3181735.64USft Longitude: -104.849759°
Elevation Above VRD: 4853.00USft

Plan Point Information:

DogLeg Severity Unit: °/100.00ft

MD	Inc	Az	TVD	Lat	Long	VSec	DLS	Toolface	Build	Turn
(USft)	(°)	(°)	(USft)	(°)	(°)	(USft)	(DLSU)	(°)	(DLSU)	(DLSU)
0.00	0.00	0.00	0.00	40.161008	-104.849759	0.00	0.00	0.0R	0.00	0.00
4150.00	0.00	0.00	4150.00	40.161008	-104.849759	0.00	0.00	0.0R	0.00	0.00
4981.56	13.30	163.84	4974.11	40.160755	-104.849663	-92.06	1.60	163.8R	1.60	0.00
6019.24	13.30	163.84	5983.93	40.160125	-104.849425	-320.77	0.00	0.0R	0.00	0.00
6850.80	0.00	0.00	6808.04	40.159872	-104.849330	-412.83	1.60	180.0R	-1.60	0.00
7752.03	90.12	0.55	7381.00	40.161448	-104.849310	161.36	10.00	0.6R	10.00	0.00
11952.16	90.12	0.55	7372.00	40.172977	-104.849165	4361.48	0.00	0.0R	0.00	0.00

Target Set Information:

Name: 3

Position offsets from Slot centre

Name	TVD	+N/-S	+E/-W	Lat	Long
(USft)	(USft)	(USft)	(USft)	(°)	(°)
PBHL	7372.00	4360.08	165.98	40.172977	-104.849165

Casing Point Information:

Name	MD	TVD
	(USft)	(USft)
9 5/8 in	4060.00	4060.00
7 in	7752.03	7381.00

Formation Point Information:

Name	TVD	Elevation	MD
(USft)	(USft)	(USft)	(USft)
PARKMAN	3891.00	979.00	3891.00
FOX HILLS BASE	4010.00	860.00	4010.00
SUSSEX	4245.00	625.00	4245.01
SHARON SPRINGS	7030.00	-2160.00	7078.72
NIOBRARA A	7114.00	-2244.00	7173.56
NIOBRARA B	7135.00	-2265.00	7198.76
NIOBRARA C	7221.00	-2351.00	7311.96
FORT HAYS	7354.00	-2484.00	7574.21
CODELL	7376.00	-2506.00	7675.07

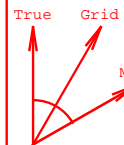

Grid Convergence: 0.42°
Mag Declination: 8.65°
Bearing:
True = Mag + 8.65°
Grid = True - 0.42°

LINER TOP - 6750.80' MD
KOP - 6850.80' MD

7" CASING - 7752.03' MD
~545' FSL, ~246' FEL

TOTAL DEPTH - 11952.16' MD
~460' FNL, ~250' FEL

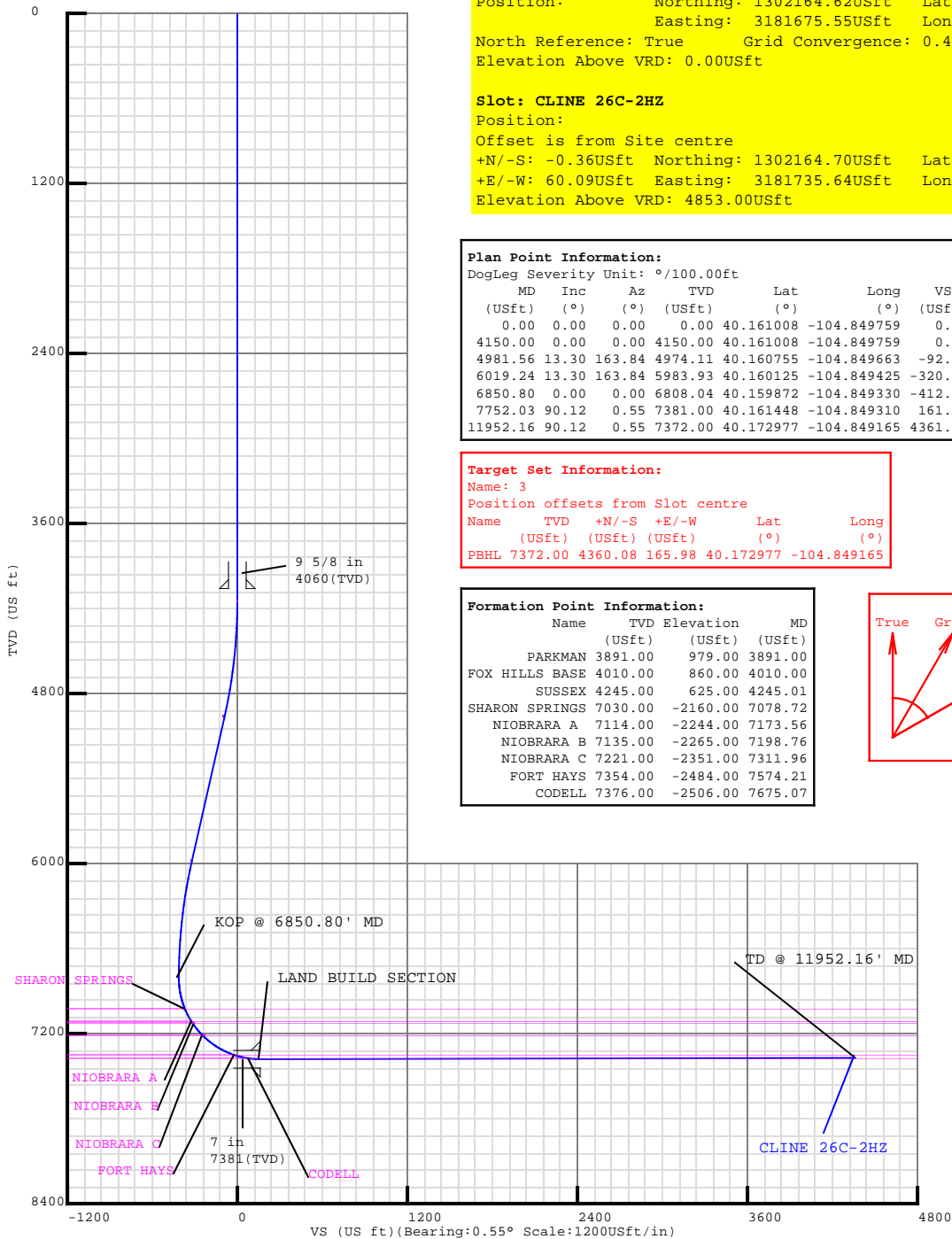

Weatherford®

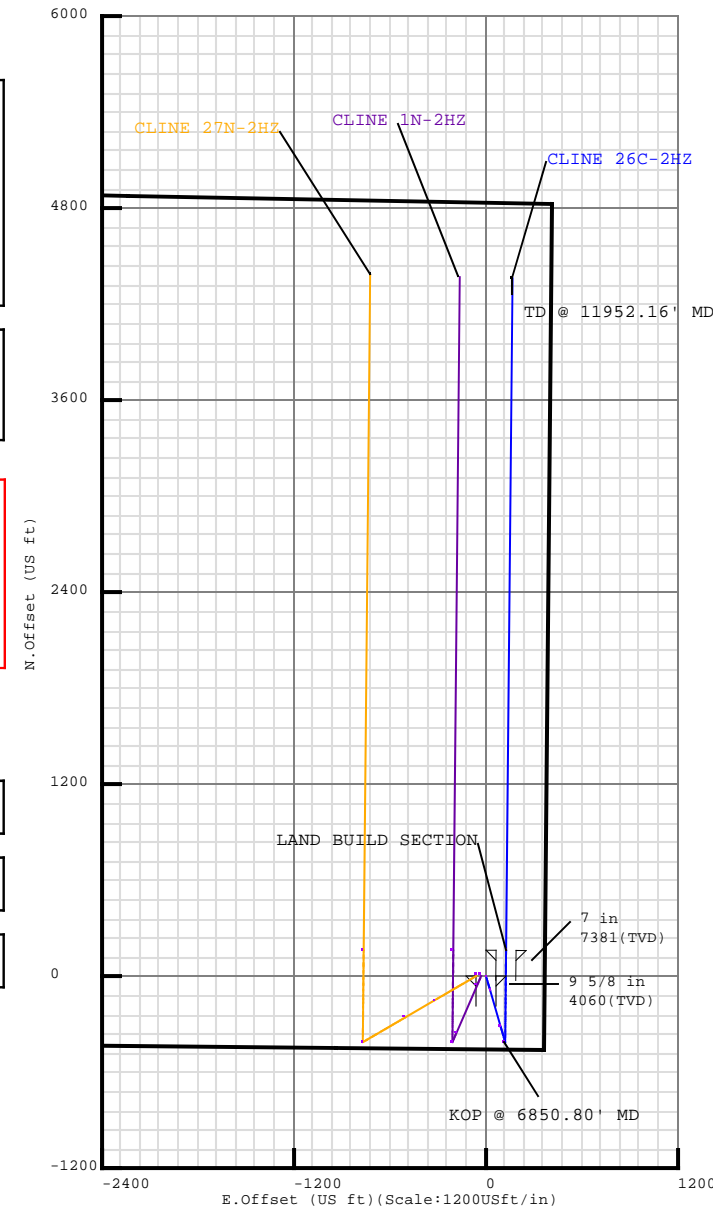

CLINE 26C-2HZ

Field Name WATTENBERG_ANADAR KO_NAD83	Map Units : US ft		Company Name : ANADARKO	
	Vertical Reference Datum (VRD) : Mean Sea Level			
	Projected Coordinate System : NAD83 / Colorado North (ftUS)			
	Comment :			
Site Name CLINE PAD	Units : US ft	North Reference : True	Convergence Angle : 0.42	
	Position	Northing : 1302164.62 US ft	Latitude : 40.161009	
		Easting : 3181675.55 US ft	Longitude : -104.849974	
	Elevation above Mean Sea Level: 4853.00 US ft		Comment :	
Slot Name CLINE 26C-2HZ	Position (Offsets relative to Site Centre)			
	+N / -S : -0.36 US ft	Northing : 1302164.70 US ft	Latitude : 40.161008	
	+E / -W : 60.09 US ft	Easting : 3181735.64 US ft	Longitude : -104.849759	
	Slot TVD Reference : Ground Elevation			
	Elevation above Mean Sea Level : 4853.00 US ft			
Well Name CLINE 26C-2HZ	Comment :			
	Type : Main well		UWI :	Plan : WP01 - PERMIT
	Rig Height <i>Drill Floor</i> : 17.00 US ft		Comment :	
	Relative to Mean Sea Level: 4870.00 US ft		Closure Azimuth : 2.18012°	
	Closure Distance : 4363.24 US ft		Az : 0.55°	
	Vertical Section (Position of Origin Relative to Slot)			
	+N / -S : 0.36 US ft		+E / -W : -60.09 US ft	Dip : 66.77°
	Magnetic Parameters			
	Model : BGGM	Field Strength : 52762.9nT	Dec : 8.65°	Date : 04/Jun/2013
	Plan Archive			
Plan Folder	Date	Comment	Plans	
P1	04/Jun/2013		Plan WP01 - PERMIT	Date 04/Jun/2013 Comment
Target Set				
Name : 3		Number of Targets : 1		

5D Plan Report

Target Set

Comment :

TargetName:	Position (Relative to Slot centre)			
PBHL	+N / -S : 4360.08US ft		Northing : 1306525.88 US ft	
Shape:	+E / -W : 165.98 US ft		Latitude : 40°10'22.717200"	
Cuboid	TVD (Drill Floor) : 7372.00 US ft		Longitude : -104°50'56.994000"	
	Orientation	Azimuth : 0.00°	Inclination : 0.00°	
	Dimensions	Length : 1.00 US ft	Breadth : 1.00 US ft	Height : 1.00 US ft

Casing Points (Relative to Slot centre, TVD relative to Drill Floor)

Name	MD (US ft)	Inc (°)	Az (°)	TVD (US ft)	N.Offset (US ft)	E.Offset (US ft)
9 5/8 in	4060.00	0.00	0.00	4060.00	0.00	0.00
7 in	7752.03	90.12	0.55	7381.00	160.16	125.53

Well path created using minimum curvature

Salient Points (Relative to Slot centre, TVD relative to Drill Floor)

MD (US ft)	Inc (°)	Az (°)	TVD (US ft)	N.Offset (US ft)	E.Offset (US ft)	DLS (°/100 US ft)
0.00	0.00	0.00	0.00	0.00	0.00	0.00
3891.00	0.00	0.00	3891.00	0.00	0.00	0.00
4010.00	0.00	0.00	4010.00	0.00	0.00	0.00
4060.00	0.00	0.00	4060.00	0.00	0.00	0.00
4150.00	0.00	0.00	4150.00	0.00	0.00	0.00
4245.01	1.52	163.84	4245.00	-1.21	0.35	1.60
4981.56	13.30	163.84	4974.11	-92.32	26.76	1.60
6019.24	13.30	163.84	5983.93	-321.68	93.24	0.00
6850.80	0.00	0.00	6808.04	-414.00	120.00	1.60
7078.72	22.79	0.55	7030.00	-369.26	120.43	10.00
7173.56	32.28	0.55	7114.00	-325.47	120.85	10.00
7198.76	34.80	0.55	7135.00	-311.55	120.99	10.00
7311.96	46.12	0.55	7221.00	-238.22	121.69	10.00
7574.21	72.34	0.55	7354.00	-14.87	123.84	10.00
7675.07	82.43	0.55	7376.00	83.42	124.79	10.00
7752.03	90.12	0.55	7381.00	160.16	125.53	10.00
7752.03	90.12	0.55	7381.00	160.16	125.53	0.00
11952.16	90.12	0.55	7372.00	4360.08	165.98	0.00

5D Plan Report

Interpolated Points (Relative to Slot centre, TVD relative to Drill Floor)							
MD (US ft)	Inc (°)	Az (°)	TVD (US ft)	N.Offset (US ft)	E.Offset (US ft)	DLS (°/100 US ft)	Comment
0.00	0.00	0.00	0.00	0.00	0.00	0.00	
98.43	0.00	0.00	98.43	0.00	0.00	0.00	
196.85	0.00	0.00	196.85	0.00	0.00	0.00	
295.28	0.00	0.00	295.28	0.00	0.00	0.00	
393.70	0.00	0.00	393.70	0.00	0.00	0.00	
492.13	0.00	0.00	492.13	0.00	0.00	0.00	
590.55	0.00	0.00	590.55	0.00	0.00	0.00	
688.98	0.00	0.00	688.98	0.00	0.00	0.00	
787.40	0.00	0.00	787.40	0.00	0.00	0.00	
885.83	0.00	0.00	885.83	0.00	0.00	0.00	
984.25	0.00	0.00	984.25	0.00	0.00	0.00	
1082.68	0.00	0.00	1082.68	0.00	0.00	0.00	
1181.10	0.00	0.00	1181.10	0.00	0.00	0.00	
1279.53	0.00	0.00	1279.53	0.00	0.00	0.00	
1377.95	0.00	0.00	1377.95	0.00	0.00	0.00	
1476.38	0.00	0.00	1476.38	0.00	0.00	0.00	
1574.80	0.00	0.00	1574.80	0.00	0.00	0.00	
1673.23	0.00	0.00	1673.23	0.00	0.00	0.00	
1771.65	0.00	0.00	1771.65	0.00	0.00	0.00	
1870.08	0.00	0.00	1870.08	0.00	0.00	0.00	
1968.50	0.00	0.00	1968.50	0.00	0.00	0.00	
2066.93	0.00	0.00	2066.93	0.00	0.00	0.00	
2165.35	0.00	0.00	2165.35	0.00	0.00	0.00	
2263.78	0.00	0.00	2263.78	0.00	0.00	0.00	
2362.20	0.00	0.00	2362.20	0.00	0.00	0.00	
2460.63	0.00	0.00	2460.63	0.00	0.00	0.00	
2559.05	0.00	0.00	2559.05	0.00	0.00	0.00	
2657.48	0.00	0.00	2657.48	0.00	0.00	0.00	
2755.90	0.00	0.00	2755.90	0.00	0.00	0.00	
2854.33	0.00	0.00	2854.33	0.00	0.00	0.00	
2952.75	0.00	0.00	2952.75	0.00	0.00	0.00	
3051.18	0.00	0.00	3051.18	0.00	0.00	0.00	
3149.60	0.00	0.00	3149.60	0.00	0.00	0.00	
3248.03	0.00	0.00	3248.03	0.00	0.00	0.00	
3346.45	0.00	0.00	3346.45	0.00	0.00	0.00	
3444.88	0.00	0.00	3444.88	0.00	0.00	0.00	
3543.30	0.00	0.00	3543.30	0.00	0.00	0.00	
3641.73	0.00	0.00	3641.73	0.00	0.00	0.00	
3740.15	0.00	0.00	3740.15	0.00	0.00	0.00	
3838.58	0.00	0.00	3838.58	0.00	0.00	0.00	

5D Plan Report

Interpolated Points (Relative to Slot centre, TVD relative to Drill Floor)							Comment
MD (US ft)	Inc (°)	Az (°)	TVD (US ft)	N.Offset (US ft)	E.Offset (US ft)	DLS (°/100 US ft)	
3937.00	0.00	0.00	3937.00	0.00	0.00	0.00	
4035.43	0.00	0.00	4035.43	0.00	0.00	0.00	
4133.85	0.00	0.00	4133.85	0.00	0.00	0.00	
4150.00	0.00	0.00	4150.00	0.00	0.00	0.00	
4232.28	1.32	163.84	4232.27	-0.91	0.26	1.60	
4330.70	2.89	163.84	4330.62	-4.38	1.27	1.60	
4429.13	4.47	163.84	4428.84	-10.44	3.03	1.60	
4527.55	6.04	163.84	4526.85	-19.10	5.54	1.60	
4625.98	7.62	163.84	4624.57	-30.34	8.79	1.60	
4724.40	9.19	163.84	4721.94	-44.15	12.80	1.60	
4822.83	10.77	163.84	4818.87	-60.53	17.55	1.60	
4921.25	12.34	163.84	4915.30	-79.46	23.03	1.60	
4981.56	13.30	163.84	4974.11	-92.32	26.76	1.60	
5019.68	13.30	163.84	5011.20	-100.74	29.20	0.00	
5118.10	13.30	163.84	5106.98	-122.50	35.51	0.00	
5216.53	13.30	163.84	5202.76	-144.25	41.81	0.00	
5314.95	13.30	163.84	5298.55	-166.01	48.12	0.00	
5413.38	13.30	163.84	5394.33	-187.76	54.42	0.00	
5511.80	13.30	163.84	5490.11	-209.52	60.73	0.00	
5610.23	13.30	163.84	5585.90	-231.28	67.04	0.00	
5708.65	13.30	163.84	5681.68	-253.03	73.34	0.00	
5807.08	13.30	163.84	5777.46	-274.79	79.65	0.00	
5905.50	13.30	163.84	5873.25	-296.54	85.95	0.00	
6003.93	13.30	163.84	5969.03	-318.30	92.26	0.00	
6019.24	13.30	163.84	5983.93	-321.68	93.24	0.00	
6102.35	11.98	163.84	6065.03	-339.15	98.30	1.60	
6200.78	10.40	163.84	6161.58	-357.49	103.62	1.60	
6299.20	8.83	163.84	6258.62	-373.28	108.20	1.60	
6397.63	7.25	163.84	6356.07	-386.50	112.03	1.60	
6496.05	5.68	163.84	6453.87	-397.14	115.11	1.60	
6594.48	4.10	163.84	6551.93	-405.19	117.45	1.60	
6692.90	2.53	163.84	6650.19	-410.66	119.03	1.60	
6791.33	0.95	163.84	6748.57	-413.53	119.86	1.60	
6850.80	0.00	0.00	6808.04	-414.00	120.00	1.60	KOP @ 6850.80' MD
6889.75	3.90	0.55	6846.96	-412.68	120.01	10.00	
6988.18	13.74	0.55	6944.10	-397.61	120.16	10.00	
7086.60	23.58	0.55	7037.24	-366.16	120.46	10.00	
7185.03	33.42	0.55	7123.63	-319.25	120.91	10.00	
7283.45	43.27	0.55	7200.73	-258.27	121.50	10.00	
7381.88	53.11	0.55	7266.27	-185.01	122.21	10.00	
7480.30	62.95	0.55	7318.32	-101.62	123.01	10.00	

5D Plan Report

Interpolated Points (Relative to Slot centre, TVD relative to Drill Floor)							Comment
MD (US ft)	Inc (°)	Az (°)	TVD (US ft)	N.Offset (US ft)	E.Offset (US ft)	DLS (°/100 US ft)	
7578.73	72.79	0.55	7355.35	-10.56	123.89	10.00	LAND BUILD SECTION
7677.15	82.64	0.55	7376.27	85.49	124.81	10.00	
7752.03	90.12	0.55	7381.00	160.16	125.53	10.00	
7775.58	90.12	0.55	7380.95	183.71	125.76	0.00	
7874.00	90.12	0.55	7380.74	282.13	126.70	0.00	
7972.43	90.12	0.55	7380.52	380.55	127.65	0.00	
8070.85	90.12	0.55	7380.31	478.97	128.60	0.00	
8169.28	90.12	0.55	7380.10	577.39	129.55	0.00	
8267.70	90.12	0.55	7379.89	675.81	130.50	0.00	
8366.13	90.12	0.55	7379.68	774.23	131.44	0.00	
8464.55	90.12	0.55	7379.47	872.65	132.39	0.00	
8562.98	90.12	0.55	7379.26	971.07	133.34	0.00	
8661.40	90.12	0.55	7379.05	1069.49	134.29	0.00	
8759.83	90.12	0.55	7378.84	1167.91	135.24	0.00	
8858.25	90.12	0.55	7378.63	1266.33	136.18	0.00	
8956.68	90.12	0.55	7378.42	1364.75	137.13	0.00	
9055.10	90.12	0.55	7378.21	1463.17	138.08	0.00	
9153.53	90.12	0.55	7377.99	1561.59	139.03	0.00	
9251.95	90.12	0.55	7377.78	1660.01	139.98	0.00	
9350.38	90.12	0.55	7377.57	1758.43	140.92	0.00	
9448.80	90.12	0.55	7377.36	1856.85	141.87	0.00	
9547.23	90.12	0.55	7377.15	1955.27	142.82	0.00	
9645.65	90.12	0.55	7376.94	2053.69	143.77	0.00	
9744.08	90.12	0.55	7376.73	2152.11	144.72	0.00	
9842.50	90.12	0.55	7376.52	2250.53	145.66	0.00	
9940.93	90.12	0.55	7376.31	2348.95	146.61	0.00	
10039.35	90.12	0.55	7376.10	2447.37	147.56	0.00	
10137.78	90.12	0.55	7375.89	2545.79	148.51	0.00	
10236.20	90.12	0.55	7375.68	2644.21	149.46	0.00	
10334.63	90.12	0.55	7375.46	2742.63	150.40	0.00	
10433.05	90.12	0.55	7375.25	2841.05	151.35	0.00	
10531.48	90.12	0.55	7375.04	2939.47	152.30	0.00	
10629.90	90.12	0.55	7374.83	3037.89	153.25	0.00	
10728.33	90.12	0.55	7374.62	3136.31	154.20	0.00	
10826.75	90.12	0.55	7374.41	3234.73	155.14	0.00	
10925.18	90.12	0.55	7374.20	3333.15	156.09	0.00	
11023.60	90.12	0.55	7373.99	3431.57	157.04	0.00	
11122.03	90.12	0.55	7373.78	3529.99	157.99	0.00	
11220.45	90.12	0.55	7373.57	3628.41	158.94	0.00	
11318.88	90.12	0.55	7373.36	3726.83	159.88	0.00	
11417.30	90.12	0.55	7373.15	3825.25	160.83	0.00	

5D Plan Report

Interpolated Points (Relative to Slot centre, TVD relative to Drill Floor)							
MD (US ft)	Inc (°)	Az (°)	TVD (US ft)	N.Offset (US ft)	E.Offset (US ft)	DLS (°/100 US ft)	Comment
11515.73	90.12	0.55	7372.93	3923.67	161.78	0.00	
11614.15	90.12	0.55	7372.72	4022.09	162.73	0.00	
11712.58	90.12	0.55	7372.51	4120.51	163.68	0.00	
11811.00	90.12	0.55	7372.30	4218.93	164.62	0.00	
11909.43	90.12	0.55	7372.09	4317.35	165.57	0.00	
11952.16	90.12	0.55	7372.00	4360.08	165.98	0.00	TD @ 11952.16' MD

Formation Points (Relative to Slot centre, TVD relative to Drill Floor)								
Name	MD (US ft)	Inc (°)	Az (°)	TVD (US ft)	N.Offset (US ft)	E.Offset (US ft)	F.Dip (°)	F.Dir (°)
PARKMAN	3891.00	0.00	0.00	3891.00	0.00	0.00	0	0
FOX HILLS BASE	4010.00	0.00	0.00	4010.00	0.00	0.00	0	0
SUSSEX	4245.01	1.52	163.84	4245.00	-1.21	0.35	0	0
SHARON SPRINGS	7078.72	22.79	0.55	7030.00	-369.26	120.43	0	0
NIOBRARA A	7173.56	32.28	0.55	7114.00	-325.47	120.85	0	0
NIOBRARA B	7198.76	34.80	0.55	7135.00	-311.55	120.99	0	0
NIOBRARA C	7311.96	46.12	0.55	7221.00	-238.22	121.69	0	0
FORT HAYS	7574.21	72.34	0.55	7354.00	-14.87	123.84	0	0
CODELL	7675.07	82.43	0.55	7376.00	83.42	124.79	0	0