

5D Plan Report**ANADARKO**

Field Name: *WATTENBERG_ANADARKO_NAD83*
Site Name: *CLINE PAD*
Well Name: *CLINE 1N-2HZ*
Plan: *WP01 - PERMIT*

04 June 2013

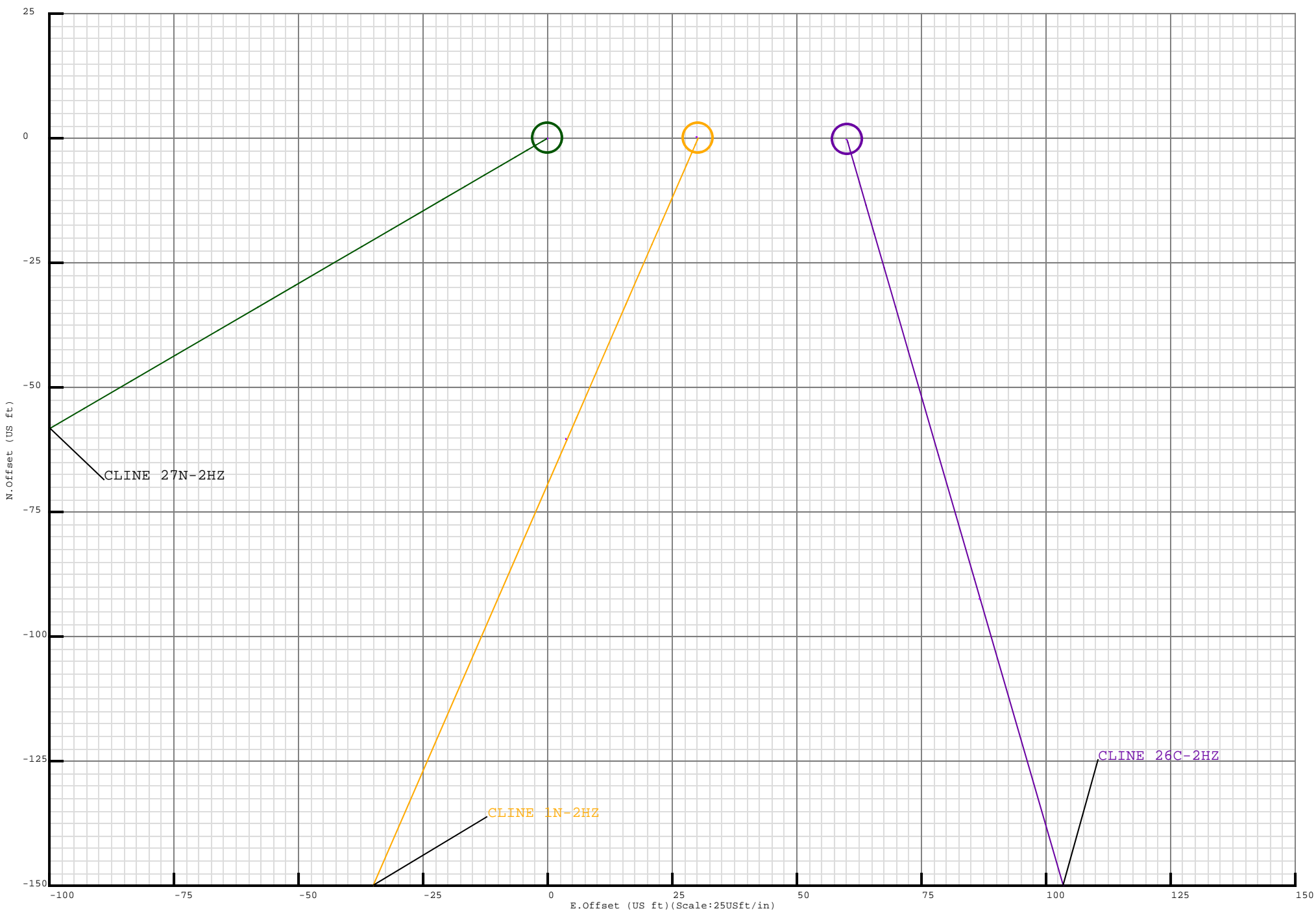



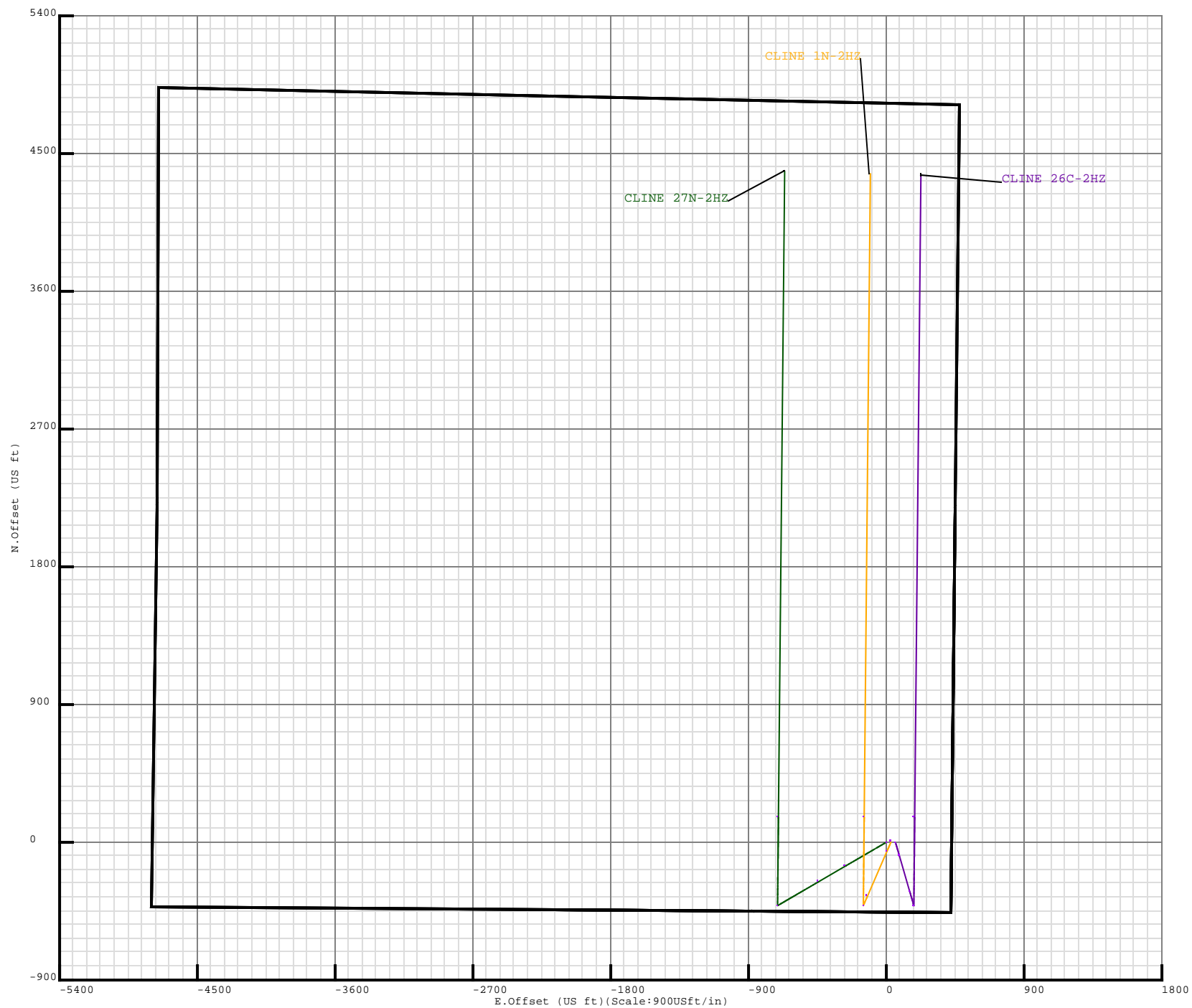

SPIDER PLOT - EXPANDED VIEW
CLINE PAD

Plan Data for CLINE 1N-2HZ

Field: WATTENBERG_ANADARKO_NAD83

Map Unit: USFt Vertical Reference Datum (VRD): Mean Sea Level
Projected Coordinate System: NAD83 / Colorado North (ftUS)

Site: CLINE PAD

Unit: USFeet TVD Reference:
Company Name: ANADARKO
Position: Northing: 1302164.62USft Latitude: 40.161009°
Easting: 3181675.55USft Longitude: -104.849974°
North Reference: True Grid Convergence: 0.42°
Elevation Above VRD: 0.00USft

Slot: CLINE 1N-2HZ

Position:
Offset is from Site centre
+N/-S: 0.00USft Northing: 1302164.85USft Latitude: 40.161009°
+E/-W: 30.19USft Easting: 3181705.74USft Longitude: -104.849866°
Elevation Above VRD: 4853.00USft

Plan Point Information:

DogLeg Severity Unit: °/100.00ft											
MD	Inc	Az	TVD	Lat	Long	VSec	DLS	Toolface	Build	Turn	
(USft)	(°)	(°)	(USft)	(°)	(°)	(USft)	(DLSU)	(°)	(DLSU)	(DLSU)	
0.00	0.00	0.00	0.00	40.161009	-104.849866	0.00	0.00	0.0R	0.00	0.00	
4150.00	0.00	0.00	4150.00	40.161009	-104.849866	0.00	0.00	0.0R	0.00	0.00	
4712.68	13.50	203.50	4707.49	40.160843	-104.849960	-60.78	2.40	156.5L	2.40	0.00	
6080.57	13.50	203.50	6037.55	40.160039	-104.850416	-354.93	0.00	0.0R	0.00	0.00	
6643.25	0.00	0.00	6595.04	40.159873	-104.850510	-415.71	2.40	180.0R	-2.40	0.00	
7543.93	90.07	0.55	7168.00	40.161447	-104.850490	157.93	10.00	0.5R	10.00	0.00	
11751.52	90.07	0.55	7163.00	40.172997	-104.850346	4365.51	0.00	0.0R	0.00	0.00	

Target Set Information:

Name: 2
Position offsets from Slot centre
Name TVD +N/-S +E/-W Lat Long
(USft) (USft) (USft) (°) (°)
PBHL 7163.00 4367.00 -134.14 40.172997 -104.850346

Casing Point Information:

Name	MD	TVD
	(USft)	(USft)
9 5/8 in	4060.00	4060.00
7 in	7543.93	7168.00

Formation Point Information:

Name	TVD	Elevation	MD
	(USft)	(USft)	(USft)
NIOBRARA C	N/A	N/A	N/A
PARKMAN	3888.00	982.00	3888.00
FOX HILLS BASE	4010.00	860.00	4010.00
SUSSEX	4242.00	628.00	4242.02
SHARON SPRINGS	7027.00	-2157.00	7132.55
NIOBRARA A	7111.00	-2241.00	7285.52
NIOBRARA B	7132.00	-2262.00	7339.07

True Grid
Mag
Grid Convergence: 0.42°
Mag Declination: 8.65°
Bearing:
True = Mag + 8.65°
Grid = True - 0.42°

LINER TOP - 6543.25' MD
KOP - 6643.25' MD

7" CASING - 7543.93' MD
~750' FSL, ~576' FEL

TOTAL DEPTH - 11751.52' MD
~460' FNL, ~580' FEL

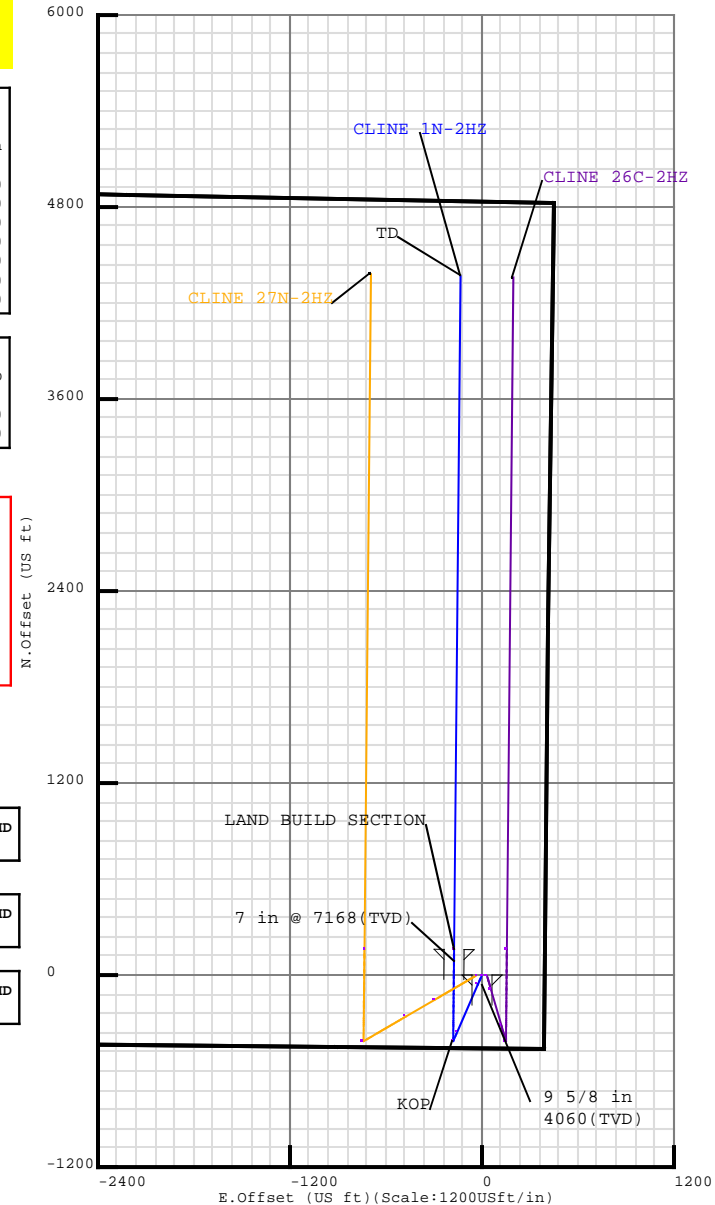
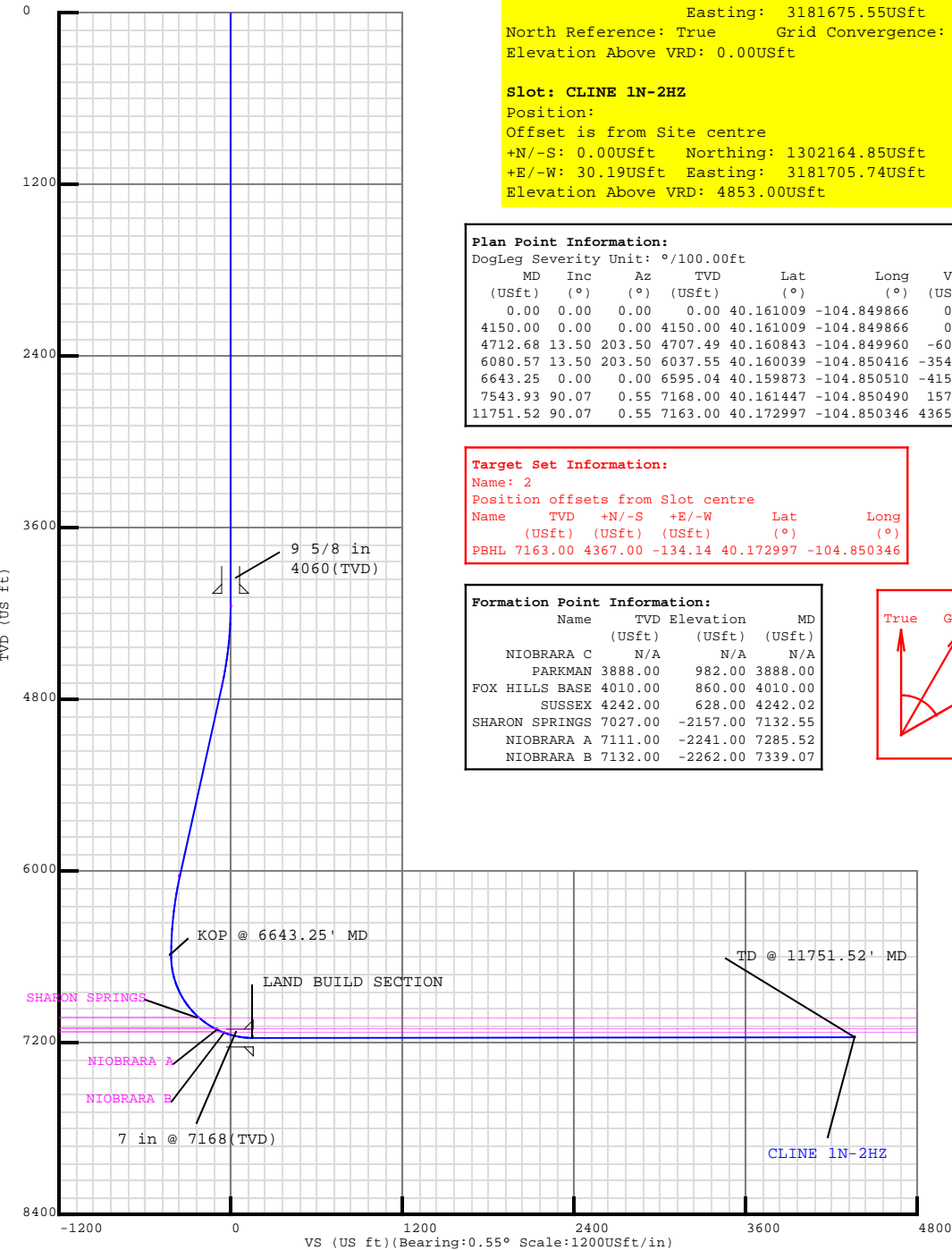

CLINE 1N-2HZ

Field Name WATTENBERG_ANADAR KO_NAD83	Map Units : US ft		Company Name : ANADARKO				
	Vertical Reference Datum (VRD) : Mean Sea Level						
	Projected Coordinate System : NAD83 / Colorado North (ftUS)						
	Comment :						
Site Name CLINE PAD	Units : US ft		North Reference : True		Convergence Angle : 0.42		
	Position	Northing : 1302164.62 US ft		Latitude : 40.161009			
		Easting : 3181675.55 US ft		Longitude : -104.849974			
	Elevation above Mean Sea Level:4853.00 US ft						
Comment :							
Slot Name CLINE 1N-2HZ	Position (Offsets relative to Site Centre)						
	+N / -S : 0.00 US ft		Northing :1302164.85 US ft		Latitude : 40.161009		
	+E / -W : 30.19 US ft		Easting :3181705.74 US ft		Longitude : -104.849866		
	Slot TVD Reference : Ground Elevation						
	Elevation above Mean Sea Level : 4853.00 US ft						
	Comment :						
Well Name CLINE 1N-2HZ	Type : Main well		UWI :		Plan : WP01 - PERMIT		
	Rig Height		Drill Floor : 17.00 US ft		Comment :		
	Relative to Mean Sea Level: 4870.00 US ft						
	Closure Distance : 4369.06 US ft		Closure Azimuth : 358.241°				
	Vertical Section (Position of Origin Relative to Slot)						
	+N / -S : -0.00 US ft		+E / -W : -30.19 US ft		Az :0.55°		
	Magnetic Parameters						
	Model : BGGM		Field Strength : 52762.9nT		Dec : 8.65°		Dip : 66.77°

Plan Archive				
Plan Folder	Date	Comment	Plans	
P1	04/Jun/2013		Plan WP01 - PERMIT	Date 04/Jun/2013
			Comment	

Target Set

Name : 2

Number of Targets : 1

5D Plan Report

Target Set

Comment :

TargetName:	Position (Relative to Slot centre)			
PBHL	+N / -S : 4367.00US ft		Northing : 1306530.75 US ft	
Shape:	+E / -W : -134.14 US ft		Latitude : 40°10'22.789200"	
Cuboid	TVD (Drill Floor) : 7163.00 US ft		Longitude : -104°51'1.245600"	
	Orientation	Azimuth : 0.00°	Inclination : 0.00°	
	Dimensions	Length : 1.00 US ft	Breadth : 1.00 US ft	Height : 1.00 US ft

Casing Points (Relative to Slot centre, TVD relative to Drill Floor)

Name	MD (US ft)	Inc (°)	Az (°)	TVD (US ft)	N.Offset (US ft)	E.Offset (US ft)
9 5/8 in	4060.00	0.00	0.00	4060.00	0.00	0.00
7 in	7543.93	90.07	0.55	7168.00	159.61	-174.50

Well path created using minimum curvature

Salient Points (Relative to Slot centre, TVD relative to Drill Floor)

MD (US ft)	Inc (°)	Az (°)	TVD (US ft)	N.Offset (US ft)	E.Offset (US ft)	DLS (°/100 US ft)
0.00	0.00	0.00	0.00	0.00	0.00	0.00
3888.00	0.00	0.00	3888.00	0.00	0.00	0.00
4010.00	0.00	0.00	4010.00	0.00	0.00	0.00
4060.00	0.00	0.00	4060.00	0.00	0.00	0.00
4150.00	0.00	0.00	4150.00	0.00	0.00	0.00
4242.02	2.21	203.50	4242.00	-1.63	-0.71	2.40
4712.68	13.50	203.50	4707.49	-60.53	-26.32	2.40
6080.57	13.50	203.50	6037.55	-353.47	-153.68	0.00
6643.25	0.00	0.00	6595.04	-414.00	-180.00	2.40
7132.55	48.93	0.55	7027.00	-217.47	-178.12	10.00
7285.52	64.23	0.55	7111.00	-90.19	-176.89	10.00
7339.07	69.58	0.55	7132.00	-40.95	-176.42	10.00
7543.93	90.07	0.55	7168.00	159.61	-174.50	10.00
11751.52	90.07	0.55	7163.00	4367.00	-134.14	0.00

5D Plan Report

Interpolated Points (Relative to Slot centre, TVD relative to Drill Floor)							
MD (US ft)	Inc (°)	Az (°)	TVD (US ft)	N.Offset (US ft)	E.Offset (US ft)	DLS (°/100 US ft)	Comment
0.00	0.00	0.00	0.00	0.00	0.00	0.00	
98.43	0.00	0.00	98.43	0.00	0.00	0.00	
196.85	0.00	0.00	196.85	0.00	0.00	0.00	
295.28	0.00	0.00	295.28	0.00	0.00	0.00	
393.70	0.00	0.00	393.70	0.00	0.00	0.00	
492.13	0.00	0.00	492.13	0.00	0.00	0.00	
590.55	0.00	0.00	590.55	0.00	0.00	0.00	
688.98	0.00	0.00	688.98	0.00	0.00	0.00	
787.40	0.00	0.00	787.40	0.00	0.00	0.00	
885.83	0.00	0.00	885.83	0.00	0.00	0.00	
984.25	0.00	0.00	984.25	0.00	0.00	0.00	
1082.68	0.00	0.00	1082.68	0.00	0.00	0.00	
1181.10	0.00	0.00	1181.10	0.00	0.00	0.00	
1279.53	0.00	0.00	1279.53	0.00	0.00	0.00	
1377.95	0.00	0.00	1377.95	0.00	0.00	0.00	
1476.38	0.00	0.00	1476.38	0.00	0.00	0.00	
1574.80	0.00	0.00	1574.80	0.00	0.00	0.00	
1673.23	0.00	0.00	1673.23	0.00	0.00	0.00	
1771.65	0.00	0.00	1771.65	0.00	0.00	0.00	
1870.08	0.00	0.00	1870.08	0.00	0.00	0.00	
1968.50	0.00	0.00	1968.50	0.00	0.00	0.00	
2066.93	0.00	0.00	2066.93	0.00	0.00	0.00	
2165.35	0.00	0.00	2165.35	0.00	0.00	0.00	
2263.78	0.00	0.00	2263.78	0.00	0.00	0.00	
2362.20	0.00	0.00	2362.20	0.00	0.00	0.00	
2460.63	0.00	0.00	2460.63	0.00	0.00	0.00	
2559.05	0.00	0.00	2559.05	0.00	0.00	0.00	
2657.48	0.00	0.00	2657.48	0.00	0.00	0.00	
2755.90	0.00	0.00	2755.90	0.00	0.00	0.00	
2854.33	0.00	0.00	2854.33	0.00	0.00	0.00	
2952.75	0.00	0.00	2952.75	0.00	0.00	0.00	
3051.18	0.00	0.00	3051.18	0.00	0.00	0.00	
3149.60	0.00	0.00	3149.60	0.00	0.00	0.00	
3248.03	0.00	0.00	3248.03	0.00	0.00	0.00	
3346.45	0.00	0.00	3346.45	0.00	0.00	0.00	
3444.88	0.00	0.00	3444.88	0.00	0.00	0.00	
3543.30	0.00	0.00	3543.30	0.00	0.00	0.00	
3641.73	0.00	0.00	3641.73	0.00	0.00	0.00	
3740.15	0.00	0.00	3740.15	0.00	0.00	0.00	
3838.58	0.00	0.00	3838.58	0.00	0.00	0.00	
3937.00	0.00	0.00	3937.00	0.00	0.00	0.00	

5D Plan Report

Interpolated Points (Relative to Slot centre, TVD relative to Drill Floor)							Comment
MD (US ft)	Inc (°)	Az (°)	TVD (US ft)	N.Offset (US ft)	E.Offset (US ft)	DLS (°/100 US ft)	
4035.43	0.00	0.00	4035.43	0.00	0.00	0.00	
4133.85	0.00	0.00	4133.85	0.00	0.00	0.00	
4150.00	0.00	0.00	4150.00	0.00	0.00	0.00	
4232.28	1.97	203.50	4232.26	-1.30	-0.57	2.40	
4330.70	4.34	203.50	4330.53	-6.27	-2.73	2.40	
4429.13	6.70	203.50	4428.49	-14.95	-6.50	2.40	
4527.55	9.06	203.50	4525.98	-27.32	-11.88	2.40	
4625.98	11.42	203.50	4622.83	-43.37	-18.86	2.40	
4712.68	13.50	203.50	4707.49	-60.53	-26.32	2.40	
4724.40	13.50	203.50	4718.88	-63.04	-27.41	0.00	
4822.83	13.50	203.50	4814.58	-84.12	-36.57	0.00	
4921.25	13.50	203.50	4910.29	-105.20	-45.74	0.00	
5019.68	13.50	203.50	5005.99	-126.27	-54.90	0.00	
5118.10	13.50	203.50	5101.70	-147.35	-64.07	0.00	
5216.53	13.50	203.50	5197.40	-168.43	-73.23	0.00	
5314.95	13.50	203.50	5293.10	-189.51	-82.40	0.00	
5413.38	13.50	203.50	5388.81	-210.59	-91.56	0.00	
5511.80	13.50	203.50	5484.51	-231.67	-100.72	0.00	
5610.23	13.50	203.50	5580.21	-252.74	-109.89	0.00	
5708.65	13.50	203.50	5675.92	-273.82	-119.05	0.00	
5807.08	13.50	203.50	5771.62	-294.90	-128.22	0.00	
5905.50	13.50	203.50	5867.33	-315.98	-137.38	0.00	
6003.93	13.50	203.50	5963.03	-337.06	-146.55	0.00	
6080.57	13.50	203.50	6037.55	-353.47	-153.68	0.00	
6102.35	12.98	203.50	6058.76	-358.05	-155.67	2.40	
6200.78	10.62	203.50	6155.09	-376.50	-163.70	2.40	
6299.20	8.26	203.50	6252.18	-391.30	-170.13	2.40	
6397.63	5.90	203.50	6349.85	-402.42	-174.97	2.40	
6496.05	3.53	203.50	6447.93	-409.84	-178.19	2.40	
6594.48	1.17	203.50	6546.27	-413.54	-179.80	2.40	
6643.25	0.00	0.00	6595.04	-414.00	-180.00	2.40	KOP
6692.90	4.96	0.55	6644.63	-411.85	-179.98	10.00	
6791.33	14.81	0.55	6741.47	-394.97	-179.82	10.00	
6889.75	24.65	0.55	6834.01	-361.79	-179.50	10.00	
6988.18	34.49	0.55	6919.50	-313.28	-179.03	10.00	
7086.60	44.33	0.55	6995.45	-250.87	-178.44	10.00	
7185.03	54.18	0.55	7059.61	-176.39	-177.72	10.00	
7283.45	64.02	0.55	7110.10	-92.05	-176.91	10.00	
7381.88	73.86	0.55	7145.42	-0.31	-176.03	10.00	
7480.30	83.70	0.55	7164.54	96.11	-175.11	10.00	
7543.93	90.07	0.55	7168.00	159.61	-174.50	10.00	LAND BUILD SECTION

5D Plan Report

Interpolated Points (Relative to Slot centre, TVD relative to Drill Floor)							
MD (US ft)	Inc (°)	Az (°)	TVD (US ft)	N.Offset (US ft)	E.Offset (US ft)	DLS (°/100 US ft)	Comment
7578.73	90.07	0.55	7167.96	194.40	-174.16	0.00	
7677.15	90.07	0.55	7167.84	292.82	-173.22	0.00	
7775.58	90.07	0.55	7167.72	391.24	-172.28	0.00	
7874.00	90.07	0.55	7167.61	489.67	-171.33	0.00	
7972.43	90.07	0.55	7167.49	588.09	-170.39	0.00	
8070.85	90.07	0.55	7167.37	686.51	-169.44	0.00	
8169.28	90.07	0.55	7167.25	784.93	-168.50	0.00	
8267.70	90.07	0.55	7167.14	883.35	-167.56	0.00	
8366.13	90.07	0.55	7167.02	981.77	-166.61	0.00	
8464.55	90.07	0.55	7166.90	1080.19	-165.67	0.00	
8562.98	90.07	0.55	7166.79	1178.61	-164.72	0.00	
8661.40	90.07	0.55	7166.67	1277.03	-163.78	0.00	
8759.83	90.07	0.55	7166.55	1375.45	-162.84	0.00	
8858.25	90.07	0.55	7166.44	1473.87	-161.89	0.00	
8956.68	90.07	0.55	7166.32	1572.29	-160.95	0.00	
9055.10	90.07	0.55	7166.20	1670.71	-160.00	0.00	
9153.53	90.07	0.55	7166.09	1769.13	-159.06	0.00	
9251.95	90.07	0.55	7165.97	1867.55	-158.12	0.00	
9350.38	90.07	0.55	7165.85	1965.97	-157.17	0.00	
9448.80	90.07	0.55	7165.73	2064.39	-156.23	0.00	
9547.23	90.07	0.55	7165.62	2162.81	-155.28	0.00	
9645.65	90.07	0.55	7165.50	2261.23	-154.34	0.00	
9744.08	90.07	0.55	7165.38	2359.65	-153.40	0.00	
9842.50	90.07	0.55	7165.27	2458.07	-152.45	0.00	
9940.93	90.07	0.55	7165.15	2556.49	-151.51	0.00	
10039.35	90.07	0.55	7165.03	2654.91	-150.56	0.00	
10137.78	90.07	0.55	7164.92	2753.33	-149.62	0.00	
10236.20	90.07	0.55	7164.80	2851.75	-148.68	0.00	
10334.63	90.07	0.55	7164.68	2950.18	-147.73	0.00	
10433.05	90.07	0.55	7164.57	3048.60	-146.79	0.00	
10531.48	90.07	0.55	7164.45	3147.02	-145.84	0.00	
10629.90	90.07	0.55	7164.33	3245.44	-144.90	0.00	
10728.33	90.07	0.55	7164.22	3343.86	-143.96	0.00	
10826.75	90.07	0.55	7164.10	3442.28	-143.01	0.00	
10925.18	90.07	0.55	7163.98	3540.70	-142.07	0.00	
11023.60	90.07	0.55	7163.86	3639.12	-141.12	0.00	
11122.03	90.07	0.55	7163.75	3737.54	-140.18	0.00	
11220.45	90.07	0.55	7163.63	3835.96	-139.23	0.00	
11318.88	90.07	0.55	7163.51	3934.38	-138.29	0.00	
11417.30	90.07	0.55	7163.40	4032.80	-137.35	0.00	
11515.73	90.07	0.55	7163.28	4131.22	-136.40	0.00	

5D Plan Report

Interpolated Points (Relative to Slot centre, TVD relative to Drill Floor)							
MD (US ft)	Inc (°)	Az (°)	TVD (US ft)	N.Offset (US ft)	E.Offset (US ft)	DLS (°/100 US ft)	Comment
11614.15	90.07	0.55	7163.16	4229.64	-135.46	0.00	
11712.58	90.07	0.55	7163.05	4328.06	-134.51	0.00	
11751.52	90.07	0.55	7163.00	4367.00	-134.14	0.00	TD

Formation Points (Relative to Slot centre, TVD relative to Drill Floor)								
Name	MD (US ft)	Inc (°)	Az (°)	TVD (US ft)	N.Offset (US ft)	E.Offset (US ft)	F.Dip (°)	F.Dir (°)
NIOBRARA C	N/A	N/A	N/A	7218.00	N/A	N/A	0	0
PARKMAN	3888.00	0.00	0.00	3888.00	0.00	0.00	0	0
FOX HILLS BASE	4010.00	0.00	0.00	4010.00	0.00	0.00	0	0
SUSSEX	4242.02	2.21	203.50	4242.00	-1.63	-0.71	0	0
SHARON SPRINGS	7132.55	48.93	0.55	7027.00	-217.47	-178.12	0	0
NIOBRARA A	7285.52	64.23	0.55	7111.00	-90.19	-176.89	0	0
NIOBRARA B	7339.07	69.58	0.55	7132.00	-40.95	-176.42	0	0