

LAND SURVEYOR'S CERTIFICATION

LAMP, RYNEARSON & ASSOCIATES, INC., OF FT. COLLINS, COLORADO HAS IN ACCORDANCE WITH A REQUEST FROM COLLIN RICHARDSON FOR MINERAL RESOURCES, INC., DETERMINED THE SURFACE LOCATION OF THE WELL DESIGNATED AS STONEY 7-1-2 TO BE 2146' FROM THE NORTH LINE AND 1193' FROM THE EAST LINE OF SECTION 2, TOWNSHIP 5 NORTH, RANGE 66 WEST OF THE 6TH P.M., WELD COUNTY, COLORADO.

DAVID JOHN BERGLUND
 COLORADO PLS 38199
 DATE OF SURVEY: 8/19/2010 (SECTION CONTROL)
 DATE OF SURVEY: 4/29/2011 (WELL LOCATION)

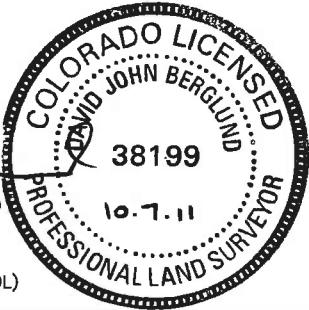

LEGEND

- ALIQUOT CORNER
- ⊙ BOTTOM HOLE
- △ COMPUTED ALIQUOT FROM MONUMENT ACCESSORIES
- ⊙ PROPOSED WELL
- A.C. ALUMINUM CAP
- R.B. RANGE BOX

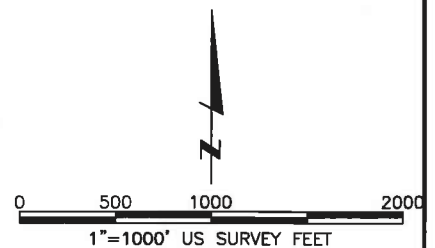

**LAMP RYNEARSON
& ASSOCIATES**

4715 Innovation Drive 970.226.0342 | P
 Fort Collins, CO 80525 970.226.0879 | F
 www.LRA-inc.com

Proposed Well Location Exhibit
 Stoney 7-1-2

drawn by
 KJW

date
 7/18/11

cogcc id

project - task number
 0210013.00

book and page
 MR-01 5-6

surface - location
 SE 1/4, NE 1/4, SEC 2 T5N
 R66W

path\filename P:_Engineering\0210013 MRI Bestway\DRAWINGS\EXHIBITS\0210013EXWP.dwg