

**PROPOSED LOCATION:
ANSCHUTZ STATE #5-62-27-0857BH ON
EXISTING ANSCHUTZ WINDMILL #4-22H**

SEE TOPO "B"

4.7 MI. +/-

2.0 MI. +/-

2.4 MI. +/-

3.4 MI. +/-

GREELEY 25.4 MI. +/-

HIGHWAY 34

LEGEND:

 **PROPOSED LOCATION**



BILL BARRETT CORPORATION

ANSCHUTZ STATE #5-62-27-0857BH ON
EXISTING ANSCHUTZ WINDMILL #4-22H
SECTION 22, T5N, R62W, 6th P.M.
338' FNL 444' FEL



Uintah Engineering & Land Surveying
85 South 200 East Vernal, Utah 84078
(435) 789-1017 * FAX (435) 789-1813

**ACCESS ROAD
M A P**

12 06 10
MONTH DAY YEAR



SCALE: 1:100,000 DRAWN BY: Z.L. REV: 07-11-13 B.D.H.

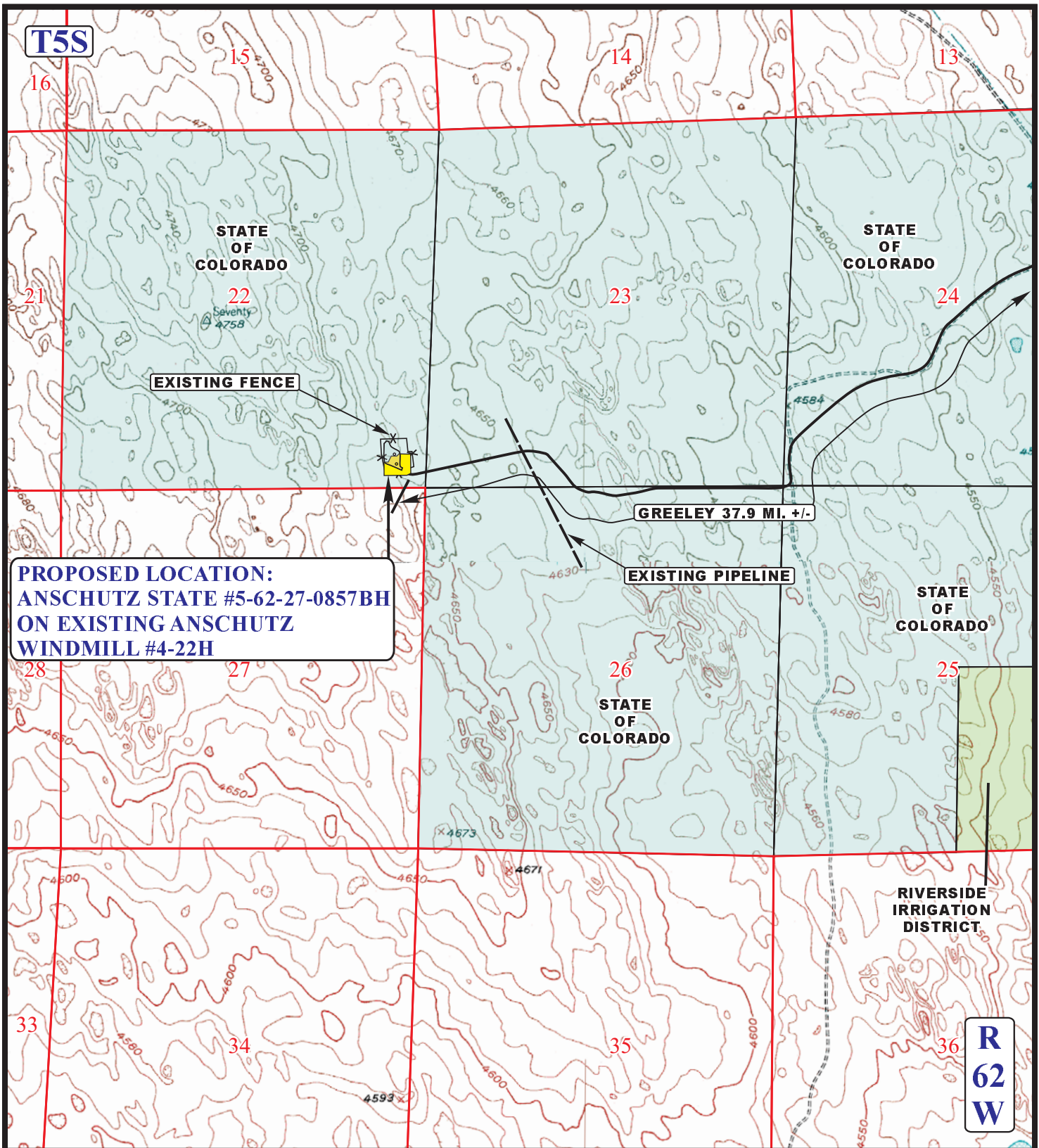

**PROPOSED LOCATION:
ANSCHUTZ STATE #5-62-27-0857BH
ON EXISTING ANSCHUTZ
WINDMILL #4-22H**

LEGEND:

-  EXISTING ROAD
-  EXISTING PIPELINE

UES
Uintah Engineering & Land Surveying
 85 South 200 East Vernal, Utah 84078
 (435) 789-1017 * FAX (435) 789-1813



BILL BARRETT CORPORATION

**ANSCHUTZ STATE #5-62-27-0857BH ON
EXISTING ANSCHUTZ WINDMILL #4-22H
SECTION 22, T5N, R62W, 6th P.M.
338' FNL 444' FEL**

ACCESS ROAD MAP	12	06	10	B TOPO
	MONTH	DAY	YEAR	
SCALE: 1" = 2000'	DRAWN BY: Z.L.	REV: 07-15-13 B.D.H.		