

HYDROLOGY MAP

CHANDLER STATE D15-72-1HN

SECTION: 15
TOWNSHIP: 3N
RANGE: 64W

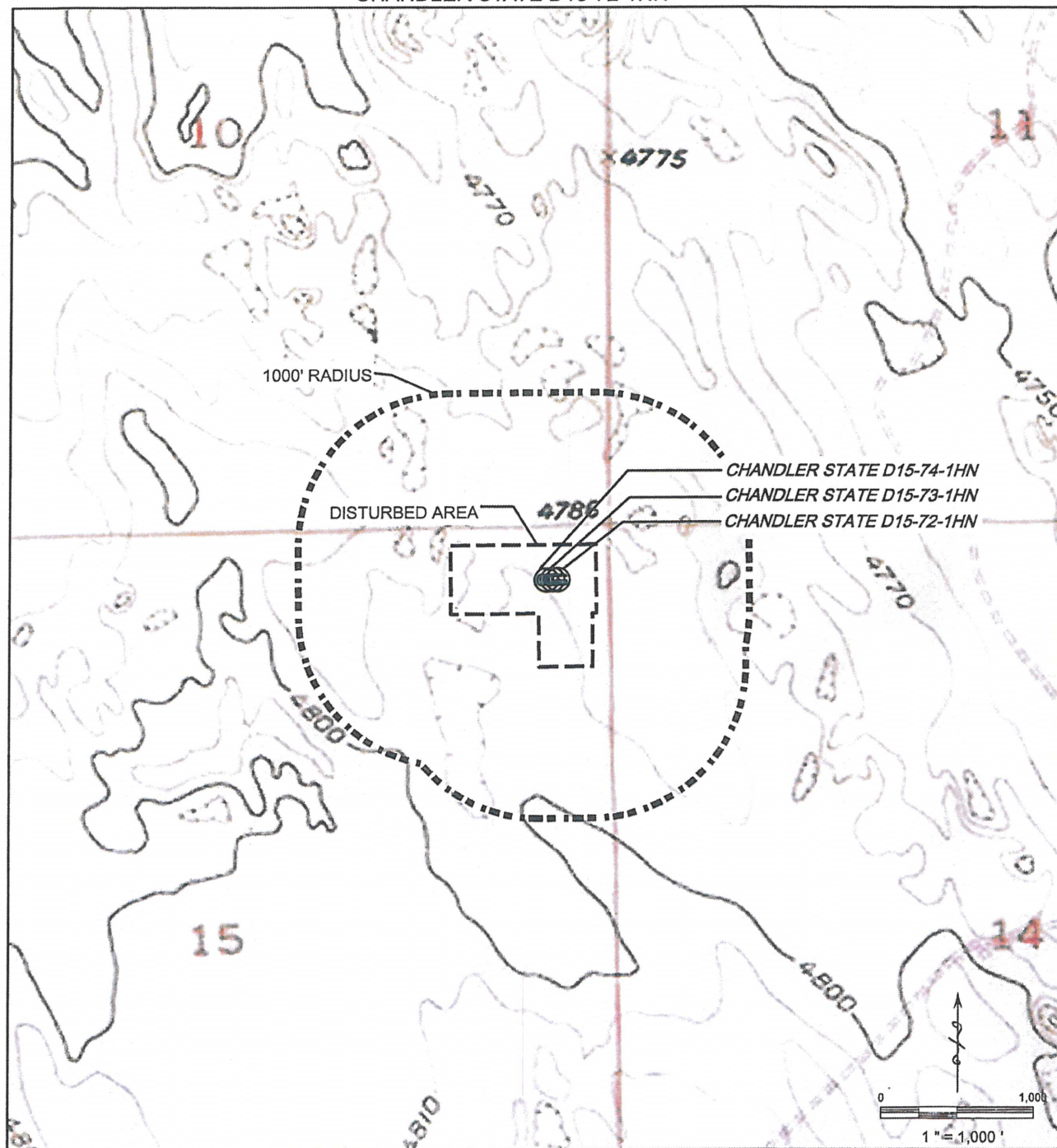

THERE ARE NO SURFACE WATERS WITHIN A 1000' RADIUS OF THE DISTURBANCE AREA OF THE PROPOSED OIL AND GAS LOCATION.