

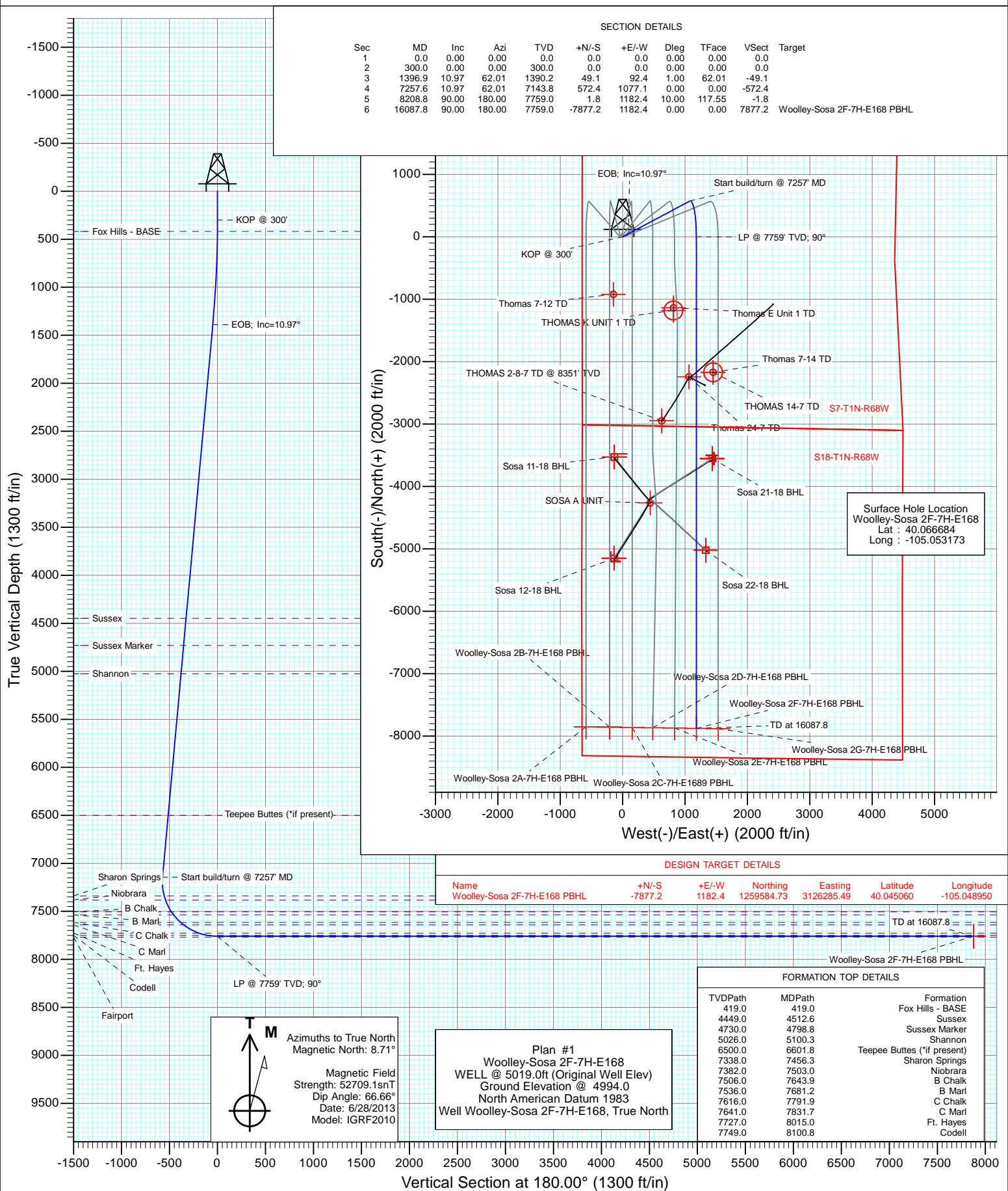

Project: DJ Wattenberg
Site: S7-T1N-R68W (Woolley-Sosa)
Well: Woolley-Sosa 2F-7H-E168
Wellbore: HZ
Design: Plan #1



Planning Report

| | | | |
|------------------|-----------------------------|-------------------------------------|--------------------------------------|
| Database: | USA EDM 5000 Multi Users DB | Local Co-ordinate Reference: | Well Woolley-Sosa 2F-7H-E168 |
| Company: | EnCana Oil & Gas (USA) Inc | TVD Reference: | WELL @ 5019.0ft (Original Well Elev) |
| Project: | DJ Wattenberg | MD Reference: | WELL @ 5019.0ft (Original Well Elev) |
| Site: | S7-T1N-R68W (Woolley-Sosa) | North Reference: | True |
| Well: | Woolley-Sosa 2F-7H-E168 | Survey Calculation Method: | Minimum Curvature |
| Wellbore: | HZ | | |
| Design: | Plan #1 | | |

| | | | |
|--------------------|---------------------------|----------------------|----------------|
| Project | DJ Wattenberg | | |
| Map System: | US State Plane 1983 | System Datum: | Mean Sea Level |
| Geo Datum: | North American Datum 1983 | | |
| Map Zone: | Colorado Northern Zone | | |

| | | | | | |
|-----------------------|----------|----------------------------|-----------------|-------------------|-------------|
| Site | | S7-T1N-R68W (Woolley-Sosa) | | | |
| Site Position: | | Northing: | 1,265,219.42 ft | Latitude: | 40.060530 |
| From: | Lat/Long | Easting: | 3,126,139.27 ft | Longitude: | -105.049370 |
| Position Uncertainty: | 0.0 ft | Slot Radius: | 13.200 in | Grid Convergence: | 0.29 ° |

| | | | | | | |
|----------------------|-------------------------|--------|---------------------|-----------------|---------------|-------------|
| Well | Woolley-Sosa 2F-7H-E168 | | | | | |
| Well Position | +N/-S | 0.0 ft | Northing: | 1,267,455.90 ft | Latitude: | 40.066684 |
| | +E/-W | 0.0 ft | Easting: | 3,125,063.39 ft | Longitude: | -105.053173 |
| Position Uncertainty | | 0.0 ft | Wellhead Elevation: | ft | Ground Level: | 4,994.0 ft |

| | | | | | |
|------------------|-------------------|--------------------|--------------------|------------------|-----------------------|
| Wellbore | HZ | | | | |
| Magnetics | Model Name | Sample Date | Declination | Dip Angle | Field Strength |
| | | | (°) | (°) | (nT) |
| | IGRF2010 | 6/28/2013 | 8.71 | 66.66 | 52,709 |

| | | | | |
|--------------------------|-------------------------|--------------|----------------------|------------------|
| Design | Plan #1 | | | |
| Audit Notes: | | | | |
| Version: | Phase: | PLAN | Tie On Depth: | 0.0 |
| Vertical Section: | Depth From (TVD) | +N/-S | +E/-W | Direction |
| | (ft) | (ft) | (ft) | (°) |
| | 0.0 | 0.0 | 0.0 | 180.00 |

| | | | | | | | | | | |
|-----------------------|--------------------|----------------|-----------------------|--------------|--------------|--------------------|-------------------|------------------|------------|---------------------|
| Plan Sections | | | | | | | | | | |
| Measured Depth | Inclination | Azimuth | Vertical Depth | +N/-S | +E/-W | Dogleg Rate | Build Rate | Turn Rate | TFO | Target |
| (ft) | (°) | (°) | (ft) | (ft) | (ft) | (°/100ft) | (°/100ft) | (°/100ft) | (°) | |
| 0.0 | 0.00 | 0.00 | 0.0 | 0.0 | 0.0 | 0.00 | 0.00 | 0.00 | 0.00 | |
| 300.0 | 0.00 | 0.00 | 300.0 | 0.0 | 0.0 | 0.00 | 0.00 | 0.00 | 0.00 | |
| 1,396.9 | 10.97 | 62.01 | 1,390.2 | 49.1 | 92.4 | 1.00 | 1.00 | 0.00 | 62.01 | |
| 7,257.6 | 10.97 | 62.01 | 7,143.8 | 572.4 | 1,077.1 | 0.00 | 0.00 | 0.00 | 0.00 | |
| 8,208.8 | 90.00 | 180.00 | 7,759.0 | 1.8 | 1,182.4 | 10.00 | 8.31 | 12.40 | 117.55 | |
| 16,087.8 | 90.00 | 180.00 | 7,759.0 | -7,877.2 | 1,182.4 | 0.00 | 0.00 | 0.00 | 0.00 | Woolley-Sosa 2F-7H- |

Planning Report

| | | | |
|------------------|-----------------------------|-------------------------------------|--------------------------------------|
| Database: | USA EDM 5000 Multi Users DB | Local Co-ordinate Reference: | Well Woolley-Sosa 2F-7H-E168 |
| Company: | EnCana Oil & Gas (USA) Inc | TVD Reference: | WELL @ 5019.0ft (Original Well Elev) |
| Project: | DJ Wattenberg | MD Reference: | WELL @ 5019.0ft (Original Well Elev) |
| Site: | S7-T1N-R68W (Woolley-Sosa) | North Reference: | True |
| Well: | Woolley-Sosa 2F-7H-E168 | Survey Calculation Method: | Minimum Curvature |
| Wellbore: | HZ | | |
| Design: | Plan #1 | | |

| Planned Survey | | | | | | | | | |
|---------------------|-----------------|-------------|---------------------|------------|------------|-----------------------|-----------------------|----------------------|-----------------------|
| Measured Depth (ft) | Inclination (°) | Azimuth (°) | Vertical Depth (ft) | +N/-S (ft) | +E/-W (ft) | Vertical Section (ft) | Dogleg Rate (°/100ft) | Build Rate (°/100ft) | Comments / Formations |
| 0.0 | 0.00 | 0.00 | 0.0 | 0.0 | 0.0 | 0.0 | 0.00 | 0.00 | |
| 100.0 | 0.00 | 0.00 | 100.0 | 0.0 | 0.0 | 0.0 | 0.00 | 0.00 | |
| 200.0 | 0.00 | 0.00 | 200.0 | 0.0 | 0.0 | 0.0 | 0.00 | 0.00 | |
| 300.0 | 0.00 | 0.00 | 300.0 | 0.0 | 0.0 | 0.0 | 0.00 | 0.00 | KOP @ 300' |
| 400.0 | 1.00 | 62.01 | 400.0 | 0.4 | 0.8 | -0.4 | 1.00 | 1.00 | |
| 419.0 | 1.19 | 62.01 | 419.0 | 0.6 | 1.1 | -0.6 | 1.00 | 1.00 | Fox Hills - BASE |
| 500.0 | 2.00 | 62.01 | 500.0 | 1.6 | 3.1 | -1.6 | 1.00 | 1.00 | |
| 600.0 | 3.00 | 62.01 | 599.9 | 3.7 | 6.9 | -3.7 | 1.00 | 1.00 | |
| 700.0 | 4.00 | 62.01 | 699.7 | 6.5 | 12.3 | -6.5 | 1.00 | 1.00 | |
| 800.0 | 5.00 | 62.01 | 799.4 | 10.2 | 19.3 | -10.2 | 1.00 | 1.00 | |
| 900.0 | 6.00 | 62.01 | 898.9 | 14.7 | 27.7 | -14.7 | 1.00 | 1.00 | |
| 1,000.0 | 7.00 | 62.01 | 998.3 | 20.0 | 37.7 | -20.0 | 1.00 | 1.00 | |
| 1,100.0 | 8.00 | 62.01 | 1,097.4 | 26.2 | 49.2 | -26.2 | 1.00 | 1.00 | |
| 1,200.0 | 9.00 | 62.01 | 1,196.3 | 33.1 | 62.3 | -33.1 | 1.00 | 1.00 | |
| 1,300.0 | 10.00 | 62.01 | 1,294.9 | 40.8 | 76.9 | -40.8 | 1.00 | 1.00 | |
| 1,396.9 | 10.97 | 62.01 | 1,390.2 | 49.1 | 92.4 | -49.1 | 1.00 | 1.00 | EOB; Inc=10.97° |
| 1,400.0 | 10.97 | 62.01 | 1,393.3 | 49.4 | 93.0 | -49.4 | 0.00 | 0.00 | |
| 1,500.0 | 10.97 | 62.01 | 1,491.4 | 58.3 | 109.8 | -58.3 | 0.00 | 0.00 | |
| 1,600.0 | 10.97 | 62.01 | 1,589.6 | 67.3 | 126.6 | -67.3 | 0.00 | 0.00 | |
| 1,700.0 | 10.97 | 62.01 | 1,687.8 | 76.2 | 143.4 | -76.2 | 0.00 | 0.00 | |
| 1,800.0 | 10.97 | 62.01 | 1,785.9 | 85.1 | 160.2 | -85.1 | 0.00 | 0.00 | |
| 1,900.0 | 10.97 | 62.01 | 1,884.1 | 94.0 | 177.0 | -94.0 | 0.00 | 0.00 | |
| 2,000.0 | 10.97 | 62.01 | 1,982.3 | 103.0 | 193.8 | -103.0 | 0.00 | 0.00 | |
| 2,100.0 | 10.97 | 62.01 | 2,080.5 | 111.9 | 210.6 | -111.9 | 0.00 | 0.00 | |
| 2,200.0 | 10.97 | 62.01 | 2,178.6 | 120.8 | 227.4 | -120.8 | 0.00 | 0.00 | |
| 2,300.0 | 10.97 | 62.01 | 2,276.8 | 129.8 | 244.2 | -129.8 | 0.00 | 0.00 | |
| 2,400.0 | 10.97 | 62.01 | 2,375.0 | 138.7 | 261.0 | -138.7 | 0.00 | 0.00 | |
| 2,500.0 | 10.97 | 62.01 | 2,473.2 | 147.6 | 277.8 | -147.6 | 0.00 | 0.00 | |
| 2,600.0 | 10.97 | 62.01 | 2,571.3 | 156.6 | 294.6 | -156.6 | 0.00 | 0.00 | |
| 2,700.0 | 10.97 | 62.01 | 2,669.5 | 165.5 | 311.4 | -165.5 | 0.00 | 0.00 | |
| 2,800.0 | 10.97 | 62.01 | 2,767.7 | 174.4 | 328.2 | -174.4 | 0.00 | 0.00 | |
| 2,900.0 | 10.97 | 62.01 | 2,865.9 | 183.3 | 345.0 | -183.3 | 0.00 | 0.00 | |
| 3,000.0 | 10.97 | 62.01 | 2,964.0 | 192.3 | 361.8 | -192.3 | 0.00 | 0.00 | |
| 3,100.0 | 10.97 | 62.01 | 3,062.2 | 201.2 | 378.6 | -201.2 | 0.00 | 0.00 | |
| 3,200.0 | 10.97 | 62.01 | 3,160.4 | 210.1 | 395.4 | -210.1 | 0.00 | 0.00 | |
| 3,300.0 | 10.97 | 62.01 | 3,258.5 | 219.1 | 412.2 | -219.1 | 0.00 | 0.00 | |
| 3,400.0 | 10.97 | 62.01 | 3,356.7 | 228.0 | 429.0 | -228.0 | 0.00 | 0.00 | |
| 3,500.0 | 10.97 | 62.01 | 3,454.9 | 236.9 | 445.8 | -236.9 | 0.00 | 0.00 | |
| 3,600.0 | 10.97 | 62.01 | 3,553.1 | 245.8 | 462.6 | -245.8 | 0.00 | 0.00 | |
| 3,700.0 | 10.97 | 62.01 | 3,651.2 | 254.8 | 479.4 | -254.8 | 0.00 | 0.00 | |
| 3,800.0 | 10.97 | 62.01 | 3,749.4 | 263.7 | 496.2 | -263.7 | 0.00 | 0.00 | |
| 3,900.0 | 10.97 | 62.01 | 3,847.6 | 272.6 | 513.0 | -272.6 | 0.00 | 0.00 | |
| 4,000.0 | 10.97 | 62.01 | 3,945.8 | 281.6 | 529.8 | -281.6 | 0.00 | 0.00 | |
| 4,100.0 | 10.97 | 62.01 | 4,043.9 | 290.5 | 546.6 | -290.5 | 0.00 | 0.00 | |
| 4,200.0 | 10.97 | 62.01 | 4,142.1 | 299.4 | 563.4 | -299.4 | 0.00 | 0.00 | |
| 4,300.0 | 10.97 | 62.01 | 4,240.3 | 308.4 | 580.2 | -308.4 | 0.00 | 0.00 | |
| 4,400.0 | 10.97 | 62.01 | 4,338.4 | 317.3 | 597.0 | -317.3 | 0.00 | 0.00 | |
| 4,500.0 | 10.97 | 62.01 | 4,436.6 | 326.2 | 613.8 | -326.2 | 0.00 | 0.00 | |
| 4,512.6 | 10.97 | 62.01 | 4,449.0 | 327.3 | 615.9 | -327.3 | 0.00 | 0.00 | Sussex |
| 4,600.0 | 10.97 | 62.01 | 4,534.8 | 335.1 | 630.6 | -335.1 | 0.00 | 0.00 | |
| 4,700.0 | 10.97 | 62.01 | 4,633.0 | 344.1 | 647.4 | -344.1 | 0.00 | 0.00 | |
| 4,798.8 | 10.97 | 62.01 | 4,730.0 | 352.9 | 664.0 | -352.9 | 0.00 | 0.00 | Sussex Marker |

Planning Report

| | | | |
|------------------|-----------------------------|-------------------------------------|--------------------------------------|
| Database: | USA EDM 5000 Multi Users DB | Local Co-ordinate Reference: | Well Woolley-Sosa 2F-7H-E168 |
| Company: | EnCana Oil & Gas (USA) Inc | TVD Reference: | WELL @ 5019.0ft (Original Well Elev) |
| Project: | DJ Wattenberg | MD Reference: | WELL @ 5019.0ft (Original Well Elev) |
| Site: | S7-T1N-R68W (Woolley-Sosa) | North Reference: | True |
| Well: | Woolley-Sosa 2F-7H-E168 | Survey Calculation Method: | Minimum Curvature |
| Wellbore: | HZ | | |
| Design: | Plan #1 | | |

| Planned Survey | | | | | | | | | |
|---------------------|-----------------|-------------|---------------------|------------|------------|-----------------------|-----------------------|----------------------|-----------------------------|
| Measured Depth (ft) | Inclination (°) | Azimuth (°) | Vertical Depth (ft) | +N/-S (ft) | +E/-W (ft) | Vertical Section (ft) | Dogleg Rate (°/100ft) | Build Rate (°/100ft) | Comments / Formations |
| 4,800.0 | 10.97 | 62.01 | 4,731.1 | 353.0 | 664.2 | -353.0 | 0.00 | 0.00 | |
| 4,900.0 | 10.97 | 62.01 | 4,829.3 | 361.9 | 681.0 | -361.9 | 0.00 | 0.00 | |
| 5,000.0 | 10.97 | 62.01 | 4,927.5 | 370.9 | 697.8 | -370.9 | 0.00 | 0.00 | |
| 5,100.0 | 10.97 | 62.01 | 5,025.7 | 379.8 | 714.6 | -379.8 | 0.00 | 0.00 | |
| 5,100.3 | 10.97 | 62.01 | 5,026.0 | 379.8 | 714.7 | -379.8 | 0.00 | 0.00 | Shannon |
| 5,200.0 | 10.97 | 62.01 | 5,123.8 | 388.7 | 731.4 | -388.7 | 0.00 | 0.00 | |
| 5,300.0 | 10.97 | 62.01 | 5,222.0 | 397.6 | 748.2 | -397.6 | 0.00 | 0.00 | |
| 5,400.0 | 10.97 | 62.01 | 5,320.2 | 406.6 | 765.0 | -406.6 | 0.00 | 0.00 | |
| 5,500.0 | 10.97 | 62.01 | 5,418.4 | 415.5 | 781.8 | -415.5 | 0.00 | 0.00 | |
| 5,600.0 | 10.97 | 62.01 | 5,516.5 | 424.4 | 798.6 | -424.4 | 0.00 | 0.00 | |
| 5,700.0 | 10.97 | 62.01 | 5,614.7 | 433.4 | 815.4 | -433.4 | 0.00 | 0.00 | |
| 5,800.0 | 10.97 | 62.01 | 5,712.9 | 442.3 | 832.2 | -442.3 | 0.00 | 0.00 | |
| 5,900.0 | 10.97 | 62.01 | 5,811.0 | 451.2 | 849.0 | -451.2 | 0.00 | 0.00 | |
| 6,000.0 | 10.97 | 62.01 | 5,909.2 | 460.1 | 865.8 | -460.1 | 0.00 | 0.00 | |
| 6,100.0 | 10.97 | 62.01 | 6,007.4 | 469.1 | 882.6 | -469.1 | 0.00 | 0.00 | |
| 6,200.0 | 10.97 | 62.01 | 6,105.6 | 478.0 | 899.4 | -478.0 | 0.00 | 0.00 | |
| 6,300.0 | 10.97 | 62.01 | 6,203.7 | 486.9 | 916.2 | -486.9 | 0.00 | 0.00 | |
| 6,400.0 | 10.97 | 62.01 | 6,301.9 | 495.9 | 933.1 | -495.9 | 0.00 | 0.00 | |
| 6,500.0 | 10.97 | 62.01 | 6,400.1 | 504.8 | 949.9 | -504.8 | 0.00 | 0.00 | |
| 6,600.0 | 10.97 | 62.01 | 6,498.3 | 513.7 | 966.7 | -513.7 | 0.00 | 0.00 | |
| 6,601.8 | 10.97 | 62.01 | 6,500.0 | 513.9 | 967.0 | -513.9 | 0.00 | 0.00 | Teepee Buttes (*if present) |
| 6,700.0 | 10.97 | 62.01 | 6,596.4 | 522.7 | 983.5 | -522.7 | 0.00 | 0.00 | |
| 6,800.0 | 10.97 | 62.01 | 6,694.6 | 531.6 | 1,000.3 | -531.6 | 0.00 | 0.00 | |
| 6,900.0 | 10.97 | 62.01 | 6,792.8 | 540.5 | 1,017.1 | -540.5 | 0.00 | 0.00 | |
| 7,000.0 | 10.97 | 62.01 | 6,891.0 | 549.4 | 1,033.9 | -549.4 | 0.00 | 0.00 | |
| 7,100.0 | 10.97 | 62.01 | 6,989.1 | 558.4 | 1,050.7 | -558.4 | 0.00 | 0.00 | |
| 7,200.0 | 10.97 | 62.01 | 7,087.3 | 567.3 | 1,067.5 | -567.3 | 0.00 | 0.00 | |
| 7,257.6 | 10.97 | 62.01 | 7,143.8 | 572.4 | 1,077.1 | -572.4 | 0.00 | 0.00 | Start build/turn @ 7257' MD |
| 7,300.0 | 9.75 | 84.79 | 7,185.6 | 574.7 | 1,084.3 | -574.7 | 10.00 | -2.87 | |
| 7,400.0 | 13.29 | 133.58 | 7,283.8 | 567.5 | 1,101.1 | -567.5 | 10.00 | 3.54 | |
| 7,456.3 | 17.60 | 147.34 | 7,338.0 | 555.9 | 1,110.4 | -555.9 | 10.00 | 7.65 | Sharon Springs |
| 7,500.0 | 21.36 | 154.05 | 7,379.2 | 543.1 | 1,117.4 | -543.1 | 10.00 | 8.61 | |
| 7,503.0 | 21.63 | 154.43 | 7,382.0 | 542.1 | 1,117.9 | -542.1 | 10.00 | 8.88 | Niobrara |
| 7,600.0 | 30.56 | 163.15 | 7,469.1 | 502.3 | 1,132.8 | -502.3 | 10.00 | 9.21 | |
| 7,643.9 | 34.73 | 165.70 | 7,506.0 | 479.5 | 1,139.1 | -479.5 | 10.00 | 9.50 | B Chalk |
| 7,681.2 | 38.31 | 167.49 | 7,536.0 | 457.9 | 1,144.3 | -457.9 | 10.00 | 9.59 | B Marl |
| 7,700.0 | 40.12 | 168.28 | 7,550.6 | 446.3 | 1,146.8 | -446.3 | 10.00 | 9.64 | |
| 7,791.9 | 49.04 | 171.46 | 7,616.0 | 382.8 | 1,158.0 | -382.8 | 10.00 | 9.70 | C Chalk |
| 7,800.0 | 49.83 | 171.69 | 7,621.2 | 376.8 | 1,158.8 | -376.8 | 10.00 | 9.75 | |
| 7,831.7 | 52.92 | 172.57 | 7,641.0 | 352.3 | 1,162.2 | -352.3 | 10.00 | 9.76 | C Marl |
| 7,900.0 | 59.61 | 174.24 | 7,678.9 | 295.8 | 1,168.7 | -295.8 | 10.00 | 9.79 | |
| 8,000.0 | 69.43 | 176.32 | 7,721.9 | 206.0 | 1,176.1 | -206.0 | 10.00 | 9.82 | |
| 8,015.0 | 70.91 | 176.60 | 7,727.0 | 191.9 | 1,176.9 | -191.9 | 10.00 | 9.84 | Ft. Hayes |
| 8,100.0 | 79.28 | 178.14 | 7,748.8 | 109.9 | 1,180.7 | -109.9 | 10.00 | 9.85 | |
| 8,100.8 | 79.36 | 178.16 | 7,749.0 | 109.1 | 1,180.7 | -109.1 | 10.00 | 9.85 | Codell |
| 8,200.0 | 89.13 | 179.85 | 7,758.9 | 10.6 | 1,182.4 | -10.6 | 10.00 | 9.85 | |
| 8,208.8 | 90.00 | 180.00 | 7,759.0 | 1.8 | 1,182.4 | -1.8 | 10.00 | 9.86 | LP @ 7759' TVD; 90° |
| 8,300.0 | 90.00 | 180.00 | 7,759.0 | -89.4 | 1,182.4 | 89.4 | 0.00 | 0.00 | |
| 8,400.0 | 90.00 | 180.00 | 7,759.0 | -189.4 | 1,182.4 | 189.4 | 0.00 | 0.00 | |
| 8,500.0 | 90.00 | 180.00 | 7,759.0 | -289.4 | 1,182.4 | 289.4 | 0.00 | 0.00 | |
| 8,600.0 | 90.00 | 180.00 | 7,759.0 | -389.4 | 1,182.4 | 389.4 | 0.00 | 0.00 | |
| 8,700.0 | 90.00 | 180.00 | 7,759.0 | -489.4 | 1,182.4 | 489.4 | 0.00 | 0.00 | |

Planning Report

| | | | |
|------------------|-----------------------------|-------------------------------------|--------------------------------------|
| Database: | USA EDM 5000 Multi Users DB | Local Co-ordinate Reference: | Well Woolley-Sosa 2F-7H-E168 |
| Company: | EnCana Oil & Gas (USA) Inc | TVD Reference: | WELL @ 5019.0ft (Original Well Elev) |
| Project: | DJ Wattenberg | MD Reference: | WELL @ 5019.0ft (Original Well Elev) |
| Site: | S7-T1N-R68W (Woolley-Sosa) | North Reference: | True |
| Well: | Woolley-Sosa 2F-7H-E168 | Survey Calculation Method: | Minimum Curvature |
| Wellbore: | HZ | | |
| Design: | Plan #1 | | |

| Planned Survey | | | | | | | | | |
|---------------------|-----------------|-------------|---------------------|------------|------------|-----------------------|-----------------------|----------------------|-----------------------|
| Measured Depth (ft) | Inclination (°) | Azimuth (°) | Vertical Depth (ft) | +N/-S (ft) | +E/-W (ft) | Vertical Section (ft) | Dogleg Rate (°/100ft) | Build Rate (°/100ft) | Comments / Formations |
| 8,800.0 | 90.00 | 180.00 | 7,759.0 | -589.4 | 1,182.4 | 589.4 | 0.00 | 0.00 | |
| 8,900.0 | 90.00 | 180.00 | 7,759.0 | -689.4 | 1,182.4 | 689.4 | 0.00 | 0.00 | |
| 9,000.0 | 90.00 | 180.00 | 7,759.0 | -789.4 | 1,182.4 | 789.4 | 0.00 | 0.00 | |
| 9,100.0 | 90.00 | 180.00 | 7,759.0 | -889.4 | 1,182.4 | 889.4 | 0.00 | 0.00 | |
| 9,200.0 | 90.00 | 180.00 | 7,759.0 | -989.4 | 1,182.4 | 989.4 | 0.00 | 0.00 | |
| 9,300.0 | 90.00 | 180.00 | 7,759.0 | -1,089.4 | 1,182.4 | 1,089.4 | 0.00 | 0.00 | |
| 9,400.0 | 90.00 | 180.00 | 7,759.0 | -1,189.4 | 1,182.4 | 1,189.4 | 0.00 | 0.00 | |
| 9,500.0 | 90.00 | 180.00 | 7,759.0 | -1,289.4 | 1,182.4 | 1,289.4 | 0.00 | 0.00 | |
| 9,600.0 | 90.00 | 180.00 | 7,759.0 | -1,389.4 | 1,182.4 | 1,389.4 | 0.00 | 0.00 | |
| 9,700.0 | 90.00 | 180.00 | 7,759.0 | -1,489.4 | 1,182.4 | 1,489.4 | 0.00 | 0.00 | |
| 9,800.0 | 90.00 | 180.00 | 7,759.0 | -1,589.4 | 1,182.4 | 1,589.4 | 0.00 | 0.00 | |
| 9,900.0 | 90.00 | 180.00 | 7,759.0 | -1,689.4 | 1,182.4 | 1,689.4 | 0.00 | 0.00 | |
| 10,000.0 | 90.00 | 180.00 | 7,759.0 | -1,789.4 | 1,182.4 | 1,789.4 | 0.00 | 0.00 | |
| 10,100.0 | 90.00 | 180.00 | 7,759.0 | -1,889.4 | 1,182.4 | 1,889.4 | 0.00 | 0.00 | |
| 10,200.0 | 90.00 | 180.00 | 7,759.0 | -1,989.4 | 1,182.4 | 1,989.4 | 0.00 | 0.00 | |
| 10,300.0 | 90.00 | 180.00 | 7,759.0 | -2,089.4 | 1,182.4 | 2,089.4 | 0.00 | 0.00 | |
| 10,400.0 | 90.00 | 180.00 | 7,759.0 | -2,189.4 | 1,182.4 | 2,189.4 | 0.00 | 0.00 | |
| 10,500.0 | 90.00 | 180.00 | 7,759.0 | -2,289.4 | 1,182.4 | 2,289.4 | 0.00 | 0.00 | |
| 10,600.0 | 90.00 | 180.00 | 7,759.0 | -2,389.4 | 1,182.4 | 2,389.4 | 0.00 | 0.00 | |
| 10,700.0 | 90.00 | 180.00 | 7,759.0 | -2,489.4 | 1,182.4 | 2,489.4 | 0.00 | 0.00 | |
| 10,800.0 | 90.00 | 180.00 | 7,759.0 | -2,589.4 | 1,182.4 | 2,589.4 | 0.00 | 0.00 | |
| 10,900.0 | 90.00 | 180.00 | 7,759.0 | -2,689.4 | 1,182.4 | 2,689.4 | 0.00 | 0.00 | |
| 11,000.0 | 90.00 | 180.00 | 7,759.0 | -2,789.4 | 1,182.4 | 2,789.4 | 0.00 | 0.00 | |
| 11,100.0 | 90.00 | 180.00 | 7,759.0 | -2,889.4 | 1,182.4 | 2,889.4 | 0.00 | 0.00 | |
| 11,200.0 | 90.00 | 180.00 | 7,759.0 | -2,989.4 | 1,182.4 | 2,989.4 | 0.00 | 0.00 | |
| 11,300.0 | 90.00 | 180.00 | 7,759.0 | -3,089.4 | 1,182.4 | 3,089.4 | 0.00 | 0.00 | |
| 11,400.0 | 90.00 | 180.00 | 7,759.0 | -3,189.4 | 1,182.4 | 3,189.4 | 0.00 | 0.00 | |
| 11,500.0 | 90.00 | 180.00 | 7,759.0 | -3,289.4 | 1,182.4 | 3,289.4 | 0.00 | 0.00 | |
| 11,600.0 | 90.00 | 180.00 | 7,759.0 | -3,389.4 | 1,182.4 | 3,389.4 | 0.00 | 0.00 | |
| 11,700.0 | 90.00 | 180.00 | 7,759.0 | -3,489.4 | 1,182.4 | 3,489.4 | 0.00 | 0.00 | |
| 11,800.0 | 90.00 | 180.00 | 7,759.0 | -3,589.4 | 1,182.4 | 3,589.4 | 0.00 | 0.00 | |
| 11,900.0 | 90.00 | 180.00 | 7,759.0 | -3,689.4 | 1,182.4 | 3,689.4 | 0.00 | 0.00 | |
| 12,000.0 | 90.00 | 180.00 | 7,759.0 | -3,789.4 | 1,182.4 | 3,789.4 | 0.00 | 0.00 | |
| 12,100.0 | 90.00 | 180.00 | 7,759.0 | -3,889.4 | 1,182.4 | 3,889.4 | 0.00 | 0.00 | |
| 12,200.0 | 90.00 | 180.00 | 7,759.0 | -3,989.4 | 1,182.4 | 3,989.4 | 0.00 | 0.00 | |
| 12,300.0 | 90.00 | 180.00 | 7,759.0 | -4,089.4 | 1,182.4 | 4,089.4 | 0.00 | 0.00 | |
| 12,400.0 | 90.00 | 180.00 | 7,759.0 | -4,189.4 | 1,182.4 | 4,189.4 | 0.00 | 0.00 | |
| 12,500.0 | 90.00 | 180.00 | 7,759.0 | -4,289.4 | 1,182.4 | 4,289.4 | 0.00 | 0.00 | |
| 12,600.0 | 90.00 | 180.00 | 7,759.0 | -4,389.4 | 1,182.4 | 4,389.4 | 0.00 | 0.00 | |
| 12,700.0 | 90.00 | 180.00 | 7,759.0 | -4,489.4 | 1,182.4 | 4,489.4 | 0.00 | 0.00 | |
| 12,800.0 | 90.00 | 180.00 | 7,759.0 | -4,589.4 | 1,182.4 | 4,589.4 | 0.00 | 0.00 | |
| 12,900.0 | 90.00 | 180.00 | 7,759.0 | -4,689.4 | 1,182.4 | 4,689.4 | 0.00 | 0.00 | |
| 13,000.0 | 90.00 | 180.00 | 7,759.0 | -4,789.4 | 1,182.4 | 4,789.4 | 0.00 | 0.00 | |
| 13,100.0 | 90.00 | 180.00 | 7,759.0 | -4,889.4 | 1,182.4 | 4,889.4 | 0.00 | 0.00 | |
| 13,200.0 | 90.00 | 180.00 | 7,759.0 | -4,989.4 | 1,182.4 | 4,989.4 | 0.00 | 0.00 | |
| 13,300.0 | 90.00 | 180.00 | 7,759.0 | -5,089.4 | 1,182.4 | 5,089.4 | 0.00 | 0.00 | |
| 13,400.0 | 90.00 | 180.00 | 7,759.0 | -5,189.4 | 1,182.4 | 5,189.4 | 0.00 | 0.00 | |
| 13,500.0 | 90.00 | 180.00 | 7,759.0 | -5,289.4 | 1,182.4 | 5,289.4 | 0.00 | 0.00 | |
| 13,600.0 | 90.00 | 180.00 | 7,759.0 | -5,389.4 | 1,182.4 | 5,389.4 | 0.00 | 0.00 | |
| 13,700.0 | 90.00 | 180.00 | 7,759.0 | -5,489.4 | 1,182.4 | 5,489.4 | 0.00 | 0.00 | |
| 13,800.0 | 90.00 | 180.00 | 7,759.0 | -5,589.4 | 1,182.4 | 5,589.4 | 0.00 | 0.00 | |
| 13,900.0 | 90.00 | 180.00 | 7,759.0 | -5,689.4 | 1,182.4 | 5,689.4 | 0.00 | 0.00 | |

Planning Report

| | | | |
|------------------|-----------------------------|-------------------------------------|--------------------------------------|
| Database: | USA EDM 5000 Multi Users DB | Local Co-ordinate Reference: | Well Woolley-Sosa 2F-7H-E168 |
| Company: | EnCana Oil & Gas (USA) Inc | TVD Reference: | WELL @ 5019.0ft (Original Well Elev) |
| Project: | DJ Wattenberg | MD Reference: | WELL @ 5019.0ft (Original Well Elev) |
| Site: | S7-T1N-R68W (Woolley-Sosa) | North Reference: | True |
| Well: | Woolley-Sosa 2F-7H-E168 | Survey Calculation Method: | Minimum Curvature |
| Wellbore: | HZ | | |
| Design: | Plan #1 | | |

Planned Survey

| Measured Depth (ft) | Inclination (°) | Azimuth (°) | Vertical Depth (ft) | +N/-S (ft) | +E/-W (ft) | Vertical Section (ft) | Dogleg Rate (°/100ft) | Build Rate (°/100ft) | Comments / Formations |
|---------------------|-----------------|-------------|---------------------|------------|------------|-----------------------|-----------------------|----------------------|-----------------------|
| 14,000.0 | 90.00 | 180.00 | 7,759.0 | -5,789.4 | 1,182.4 | 5,789.4 | 0.00 | 0.00 | |
| 14,100.0 | 90.00 | 180.00 | 7,759.0 | -5,889.4 | 1,182.4 | 5,889.4 | 0.00 | 0.00 | |
| 14,200.0 | 90.00 | 180.00 | 7,759.0 | -5,989.4 | 1,182.4 | 5,989.4 | 0.00 | 0.00 | |
| 14,300.0 | 90.00 | 180.00 | 7,759.0 | -6,089.4 | 1,182.4 | 6,089.4 | 0.00 | 0.00 | |
| 14,400.0 | 90.00 | 180.00 | 7,759.0 | -6,189.4 | 1,182.4 | 6,189.4 | 0.00 | 0.00 | |
| 14,500.0 | 90.00 | 180.00 | 7,759.0 | -6,289.4 | 1,182.4 | 6,289.4 | 0.00 | 0.00 | |
| 14,600.0 | 90.00 | 180.00 | 7,759.0 | -6,389.4 | 1,182.4 | 6,389.4 | 0.00 | 0.00 | |
| 14,700.0 | 90.00 | 180.00 | 7,759.0 | -6,489.4 | 1,182.4 | 6,489.4 | 0.00 | 0.00 | |
| 14,800.0 | 90.00 | 180.00 | 7,759.0 | -6,589.4 | 1,182.4 | 6,589.4 | 0.00 | 0.00 | |
| 14,900.0 | 90.00 | 180.00 | 7,759.0 | -6,689.4 | 1,182.4 | 6,689.4 | 0.00 | 0.00 | |
| 15,000.0 | 90.00 | 180.00 | 7,759.0 | -6,789.4 | 1,182.4 | 6,789.4 | 0.00 | 0.00 | |
| 15,100.0 | 90.00 | 180.00 | 7,759.0 | -6,889.4 | 1,182.4 | 6,889.4 | 0.00 | 0.00 | |
| 15,200.0 | 90.00 | 180.00 | 7,759.0 | -6,989.4 | 1,182.4 | 6,989.4 | 0.00 | 0.00 | |
| 15,300.0 | 90.00 | 180.00 | 7,759.0 | -7,089.4 | 1,182.4 | 7,089.4 | 0.00 | 0.00 | |
| 15,400.0 | 90.00 | 180.00 | 7,759.0 | -7,189.4 | 1,182.4 | 7,189.4 | 0.00 | 0.00 | |
| 15,500.0 | 90.00 | 180.00 | 7,759.0 | -7,289.4 | 1,182.4 | 7,289.4 | 0.00 | 0.00 | |
| 15,600.0 | 90.00 | 180.00 | 7,759.0 | -7,389.4 | 1,182.4 | 7,389.4 | 0.00 | 0.00 | |
| 15,700.0 | 90.00 | 180.00 | 7,759.0 | -7,489.4 | 1,182.4 | 7,489.4 | 0.00 | 0.00 | |
| 15,800.0 | 90.00 | 180.00 | 7,759.0 | -7,589.4 | 1,182.4 | 7,589.4 | 0.00 | 0.00 | |
| 15,900.0 | 90.00 | 180.00 | 7,759.0 | -7,689.4 | 1,182.4 | 7,689.4 | 0.00 | 0.00 | |
| 16,000.0 | 90.00 | 180.00 | 7,759.0 | -7,789.4 | 1,182.4 | 7,789.4 | 0.00 | 0.00 | |
| 16,087.8 | 90.00 | 180.00 | 7,759.0 | -7,877.2 | 1,182.4 | 7,877.2 | 0.00 | 0.00 | TD at 16087.8 |

Targets

| Target Name | Dip Angle (°) | Dip Dir. (°) | TVD (ft) | +N/-S (ft) | +E/-W (ft) | Northing (ft) | Easting (ft) | Latitude | Longitude |
|---------------------------|---------------|--------------|----------|------------|------------|---------------|--------------|-----------|-------------|
| - hit/miss target | | | | | | | | | |
| - Shape | | | | | | | | | |
| Woolley-Sosa 2F-7H-E1 | 0.00 | 0.00 | 7,759.0 | -7,877.2 | 1,182.4 | 1,259,584.73 | 3,126,285.49 | 40.045060 | -105.048950 |
| - plan hits target center | | | | | | | | | |
| - Point | | | | | | | | | |

Planning Report

| | | | |
|------------------|-----------------------------|-------------------------------------|--------------------------------------|
| Database: | USA EDM 5000 Multi Users DB | Local Co-ordinate Reference: | Well Woolley-Sosa 2F-7H-E168 |
| Company: | EnCana Oil & Gas (USA) Inc | TVD Reference: | WELL @ 5019.0ft (Original Well Elev) |
| Project: | DJ Wattenberg | MD Reference: | WELL @ 5019.0ft (Original Well Elev) |
| Site: | S7-T1N-R68W (Woolley-Sosa) | North Reference: | True |
| Well: | Woolley-Sosa 2F-7H-E168 | Survey Calculation Method: | Minimum Curvature |
| Wellbore: | HZ | | |
| Design: | Plan #1 | | |

| Formations | | | | | | |
|---------------------|---------------------|-----------------------------|-----------|---------|-------------------|--|
| Measured Depth (ft) | Vertical Depth (ft) | Name | Lithology | Dip (°) | Dip Direction (°) | |
| 419.0 | 419.0 | Fox Hills - BASE | | | | |
| 4,512.6 | 4,449.0 | Sussex | | | | |
| 4,798.8 | 4,730.0 | Sussex Marker | | | | |
| 5,100.3 | 5,026.0 | Shannon | | | | |
| 6,601.8 | 6,500.0 | Teepee Buttes (*if present) | | | | |
| 7,456.3 | 7,338.0 | Sharon Springs | | | | |
| 7,503.0 | 7,382.0 | Niobrara | | | | |
| 7,643.9 | 7,506.0 | B Chalk | | | | |
| 7,681.2 | 7,536.0 | B Marl | | | | |
| 7,791.9 | 7,616.0 | C Chalk | | | | |
| 7,831.7 | 7,641.0 | C Marl | | | | |
| 8,015.0 | 7,727.0 | Ft. Hayes | | | | |
| 8,100.8 | 7,749.0 | Codell | | | | |

| Plan Annotations | | | | | |
|---------------------|---------------------|-------------------|------------|-----------------------------|--|
| Measured Depth (ft) | Vertical Depth (ft) | Local Coordinates | | | |
| | | +N/-S (ft) | +E/-W (ft) | Comment | |
| 300.0 | 300.0 | 0.0 | 0.0 | KOP @ 300' | |
| 1,396.9 | 1,390.2 | 49.1 | 92.4 | EOB; Inc=10.97° | |
| 7,257.6 | 7,143.8 | 572.4 | 1,077.1 | Start build/turn @ 7257' MD | |
| 8,208.8 | 7,759.0 | 1.8 | 1,182.4 | LP @ 7759' TVD; 90° | |
| 16,087.8 | 7,759.0 | -7,877.2 | 1,182.4 | TD at 16087.8 | |

EnCana Oil & Gas (USA) Inc

DJ Wattenberg

S7-T1N-R68W (Woolley-Sosa)

Woolley-Sosa 2F-7H-E168

HZ

Plan #1

Anticollision Report

28 June, 2013

Anticollision Report

| | | | |
|---------------------------|----------------------------|-------------------------------------|--------------------------------------|
| Company: | EnCana Oil & Gas (USA) Inc | Local Co-ordinate Reference: | Well Woolley-Sosa 2F-7H-E168 |
| Project: | DJ Wattenberg | TVD Reference: | WELL @ 5019.0ft (Original Well Elev) |
| Reference Site: | S7-T1N-R68W (Woolley-Sosa) | MD Reference: | WELL @ 5019.0ft (Original Well Elev) |
| Site Error: | 0.0ft | North Reference: | True |
| Reference Well: | Woolley-Sosa 2F-7H-E168 | Survey Calculation Method: | Minimum Curvature |
| Well Error: | 0.0ft | Output errors are at | 2.00 sigma |
| Reference Wellbore | HZ | Database: | USA EDM 5000 Multi Users DB |
| Reference Design: | Plan #1 | Offset TVD Reference: | Offset Datum |

| Reference | Plan #1 | | |
|------------------------------|---|----------------|---------------------|
| Filter type: | NO GLOBAL FILTER: Using user defined selection & filtering criteria | | |
| Interpolation Method: | MD Interval 100.0ft | Error Model: | Systematic Ellipse |
| Depth Range: | Unlimited | Scan Method: | Closest Approach 3D |
| Results Limited by: | Maximum center-center distance of 500.0ft | Error Surface: | Elliptical Conic |
| Warning Levels Evaluated at: | 2.00 Sigma | | |

| Survey Tool Program | | Date | 6/28/2013 | | |
|---------------------|------------|-------------------|-------------|-------------|--|
| From (ft) | To (ft) | Survey (Wellbore) | Tool Name | Description | |
| 0.0 | 16,087.8 | Plan #1 (HZ) | Geolink MWD | Geolink MWD | |

| Summary | | | | | | |
|---|-------------------------------|----------------------------|-------------------------------|--------------------------------|-------------------|---------------------|
| Site Name | Reference Measured Depth (ft) | Offset Measured Depth (ft) | Distance Between Centres (ft) | Distance Between Ellipses (ft) | Separation Factor | Warning |
| Offset Well - Wellbore - Design | | | | | | |
| S7-T1N-R68W (Woolley-Sosa) | | | | | | |
| Sosa 11-18 - DD - DD | | | | | | Out of range |
| Sosa 11-18 - DD - Plan #1 | | | | | | Out of range |
| Sosa 12-18 - DD - DD | | | | | | Out of range |
| Sosa 12-18 - DD - Plan #3 | | | | | | Out of range |
| Sosa 21-18 - DD (Gyro) - DD | | | | | | Out of range |
| Sosa 21-18 - DD (MWD) - DD | 11,755.2 | 7,918.1 | 243.3 | 159.7 | 2.911 | CC, ES, SF |
| Sosa 21-18 - DD (MWD) - Plan #2 | 11,763.9 | 7,899.2 | 254.9 | 171.3 | 3.049 | CC, ES, SF |
| Sosa 22-18 - DD - DD | 13,249.0 | 7,904.0 | 168.4 | 57.0 | 1.512 | CC, ES, SF |
| Sosa 22-18 - DD - Plan #2 | 13,231.9 | 7,893.1 | 151.0 | 40.2 | 1.362 | Level 3, CC, ES, SF |
| Sosa A #1 (Existing) - DD - DD | | | | | | Out of range |
| THOMAS 14-7(EXISTING) - EXISTING - NO SURVEY | | | | | | Out of range |
| THOMAS 24-7 (EXISTING) - ENCANA WELL - SURVEY | 10,582.2 | 7,769.7 | 136.1 | 76.7 | 2.293 | CC, ES, SF |
| THOMAS 24-7 (Existing) - Existing - NO SURVEYS | 10,453.2 | 7,742.0 | 118.7 | 61.7 | 2.081 | CC, ES, SF |
| THOMAS 2-8-7 (EXISTING) - ENCANA WELL - SURVEY | | | | | | Out of range |
| THOMAS 33-7 (EXISTING) - ENCANA WELL - SURVEY | | | | | | Out of range |
| Thomas 7-12 (Existing) - Existing - NO SURVEYS | | | | | | Out of range |
| Thomas 7-14 (Existing) - Existing - NO SURVEYS | | | | | | Out of range |
| THOMAS E UNIT 1 (EXISTING) - Existing - NO SURVEY | 9,347.6 | 7,741.0 | 366.4 | 327.0 | 9.287 | CC, ES |
| THOMAS E UNIT 1 (EXISTING) - Existing - NO SURVEY | 9,400.0 | 7,741.0 | 370.1 | 329.9 | 9.202 | SF |
| THOMAS K UNIT 1 (EXISTING) - EXISTING - NO SURV | | | | | | Out of range |
| Woolley-Sosa 2A-7H-E168 - Hz - Plan #1 | 200.0 | 200.0 | 35.5 | 34.9 | 58.132 | CC, ES |
| Woolley-Sosa 2A-7H-E168 - Hz - Plan #1 | 600.0 | 597.8 | 51.1 | 49.1 | 25.171 | SF |
| Woolley-Sosa 2B-7H-E168 - HZ - Plan #1 | 300.0 | 300.0 | 30.0 | 29.0 | 31.252 | CC, ES |
| Woolley-Sosa 2B-7H-E168 - HZ - Plan #1 | 600.0 | 599.2 | 39.3 | 37.3 | 19.412 | SF |
| Woolley-Sosa 2C-7H-E168 - HZ - Plan #1 | 300.0 | 300.0 | 25.7 | 24.7 | 26.783 | CC, ES |
| Woolley-Sosa 2C-7H-E168 - HZ - Plan #1 | 800.0 | 800.6 | 40.5 | 37.8 | 14.763 | SF |
| Woolley-Sosa 2D-7H-E168 - HZ - Plan #1 | 300.0 | 300.0 | 20.0 | 19.0 | 20.835 | CC, ES |
| Woolley-Sosa 2D-7H-E168 - HZ - Plan #1 | 900.0 | 901.1 | 39.2 | 36.1 | 12.693 | SF |
| Woolley-Sosa 2E-7H-E168 - HZ - Plan #1 | 300.0 | 300.0 | 7.8 | 6.9 | 8.136 | CC, ES |
| Woolley-Sosa 2E-7H-E168 - HZ - Plan #1 | 16,087.8 | 16,034.4 | 350.0 | 68.9 | 1.245 | Level 2, SF |
| Woolley-Sosa 2G-7H-E168 - HZ - Plan #1 | 200.0 | 200.0 | 7.8 | 7.2 | 12.786 | CC |
| Woolley-Sosa 2G-7H-E168 - HZ - Plan #1 | 300.0 | 299.9 | 8.1 | 7.2 | 8.450 | ES |
| Woolley-Sosa 2G-7H-E168 - HZ - Plan #1 | 16,087.8 | 16,145.1 | 350.0 | 68.7 | 1.244 | Level 2, SF |

Anticollision Report

| | | | |
|---------------------------|----------------------------|-------------------------------------|--------------------------------------|
| Company: | EnCana Oil & Gas (USA) Inc | Local Co-ordinate Reference: | Well Woolley-Sosa 2F-7H-E168 |
| Project: | DJ Wattenberg | TVD Reference: | WELL @ 5019.0ft (Original Well Elev) |
| Reference Site: | S7-T1N-R68W (Woolley-Sosa) | MD Reference: | WELL @ 5019.0ft (Original Well Elev) |
| Site Error: | 0.0ft | North Reference: | True |
| Reference Well: | Woolley-Sosa 2F-7H-E168 | Survey Calculation Method: | Minimum Curvature |
| Well Error: | 0.0ft | Output errors are at | 2.00 sigma |
| Reference Wellbore | HZ | Database: | USA EDM 5000 Multi Users DB |
| Reference Design: | Plan #1 | Offset TVD Reference: | Offset Datum |

| Offset Design S7-T1N-R68W (Woolley-Sosa) - Sosa 21-18 - DD (MWD) - DD | | | | | | | | | | | | Offset Site Error: | 0.0 ft |
|--|------------------------|------------------------|------------------------|-------------------|----------------|--------------------------|---|---------------|-------------------------|--------------------------|---------------------------|---------------------------|---------|
| Survey Program: 814-MWD | | | | | | | | | | | | Offset Well Error: | 0.0 ft |
| Reference | | Offset | | Semi Major Axis | | | Distance | | | | | | |
| Measured Depth (ft) | Vertical Depth (ft) | Measured Depth (ft) | Vertical Depth (ft) | Reference (ft) | Offset (ft) | Highside Toolface (°) | Offset Wellbore Centre +N/-S (ft) | +E/-W (ft) | Between Centres (ft) | Between Ellipses (ft) | Total Uncertainty Axis | Separation Factor | Warning |
| 11,400.0 | 7,759.0 | 7,925.3 | 7,782.1 | 63.0 | 25.5 | -92.84 | -3,544.5 | 1,425.5 | 430.5 | 353.1 | 77.41 | 5.561 | |
| 11,500.0 | 7,759.0 | 7,923.3 | 7,780.1 | 64.6 | 25.5 | -92.37 | -3,544.6 | 1,425.5 | 352.6 | 273.4 | 79.15 | 4.454 | |
| 11,600.0 | 7,759.0 | 7,921.2 | 7,778.0 | 66.2 | 25.5 | -91.89 | -3,544.6 | 1,425.6 | 288.6 | 207.7 | 80.88 | 3.568 | |
| 11,700.0 | 7,759.0 | 7,919.2 | 7,776.0 | 67.8 | 25.5 | -91.41 | -3,544.6 | 1,425.6 | 249.5 | 166.8 | 82.62 | 3.019 | |
| 11,755.2 | 7,759.0 | 7,918.1 | 7,774.9 | 68.7 | 25.4 | -91.15 | -3,544.7 | 1,425.6 | 243.3 | 159.7 | 83.58 | 2.911 CC, ES, SF | |
| 11,800.0 | 7,759.0 | 7,917.2 | 7,774.0 | 69.5 | 25.4 | -90.94 | -3,544.7 | 1,425.7 | 247.3 | 163.0 | 84.35 | 2.932 | |
| 11,900.0 | 7,759.0 | 7,915.1 | 7,772.0 | 71.1 | 25.4 | -90.46 | -3,544.7 | 1,425.7 | 283.1 | 197.0 | 86.08 | 3.288 | |
| 12,000.0 | 7,759.0 | 7,913.1 | 7,769.9 | 72.7 | 25.4 | -89.98 | -3,544.8 | 1,425.7 | 345.0 | 257.2 | 87.81 | 3.930 | |
| 12,100.0 | 7,759.0 | 7,911.1 | 7,767.9 | 74.4 | 25.4 | -89.50 | -3,544.8 | 1,425.8 | 421.9 | 332.3 | 89.53 | 4.712 | |

Anticollision Report

| | | | |
|---------------------------|----------------------------|-------------------------------------|--------------------------------------|
| Company: | EnCana Oil & Gas (USA) Inc | Local Co-ordinate Reference: | Well Woolley-Sosa 2F-7H-E168 |
| Project: | DJ Wattenberg | TVD Reference: | WELL @ 5019.0ft (Original Well Elev) |
| Reference Site: | S7-T1N-R68W (Woolley-Sosa) | MD Reference: | WELL @ 5019.0ft (Original Well Elev) |
| Site Error: | 0.0ft | North Reference: | True |
| Reference Well: | Woolley-Sosa 2F-7H-E168 | Survey Calculation Method: | Minimum Curvature |
| Well Error: | 0.0ft | Output errors are at | 2.00 sigma |
| Reference Wellbore | HZ | Database: | USA EDM 5000 Multi Users DB |
| Reference Design: | Plan #1 | Offset TVD Reference: | Offset Datum |

| Offset Design | | | | | | | | | | | S7-T1N-R68W (Woolley-Sosa) - Sosa 21-18 - DD (MWD) - Plan #2 | | | Offset Site Error: | | 0.0 ft | |
|---------------------|---------------------|---------------------|---------------------|-----------------|-------------|-----------------------|-----------------------------------|------------|----------------------|-----------------------|--|-------------------|------------|--------------------|--------------------|--------|--------|
| Survey Program: | | | | 0-MWD | | | | | | | | | | | Offset Well Error: | | 0.0 ft |
| Reference | | Offset | | Semi Major Axis | | | Distance | | | | | | | | | | |
| Measured Depth (ft) | Vertical Depth (ft) | Measured Depth (ft) | Vertical Depth (ft) | Reference (ft) | Offset (ft) | Highside Toolface (°) | Offset Wellbore Centre +N/-S (ft) | +E/-W (ft) | Between Centres (ft) | Between Ellipses (ft) | Total Uncertainty Axis | Separation Factor | Warning | | | | |
| 11,400.0 | 7,759.0 | 7,899.2 | 7,770.0 | 63.0 | 25.5 | -90.00 | -3,553.3 | 1,437.3 | 444.3 | 366.9 | 77.39 | 5.741 | | | | | |
| 11,500.0 | 7,759.0 | 7,899.2 | 7,770.0 | 64.6 | 25.5 | -90.00 | -3,553.3 | 1,437.3 | 366.9 | 287.8 | 79.09 | 4.639 | | | | | |
| 11,600.0 | 7,759.0 | 7,899.2 | 7,770.0 | 66.2 | 25.5 | -90.00 | -3,553.3 | 1,437.3 | 303.0 | 222.2 | 80.80 | 3.750 | | | | | |
| 11,700.0 | 7,759.0 | 7,899.2 | 7,770.0 | 67.8 | 25.5 | -90.00 | -3,553.3 | 1,437.3 | 262.8 | 180.3 | 82.51 | 3.185 | | | | | |
| 11,763.9 | 7,759.0 | 7,899.2 | 7,770.0 | 68.9 | 25.5 | -90.00 | -3,553.3 | 1,437.3 | 254.9 | 171.3 | 83.61 | 3.049 | CC, ES, SF | | | | |
| 11,800.0 | 7,759.0 | 7,899.2 | 7,770.0 | 69.5 | 25.5 | -90.00 | -3,553.3 | 1,437.3 | 257.5 | 173.2 | 84.22 | 3.057 | | | | | |
| 11,900.0 | 7,759.0 | 7,899.2 | 7,770.0 | 71.1 | 25.5 | -90.00 | -3,553.3 | 1,437.3 | 289.0 | 203.1 | 85.94 | 3.363 | | | | | |
| 12,000.0 | 7,759.0 | 7,899.2 | 7,770.0 | 72.7 | 25.5 | -90.00 | -3,553.3 | 1,437.3 | 347.5 | 259.8 | 87.66 | 3.964 | | | | | |
| 12,100.0 | 7,759.0 | 7,899.2 | 7,770.0 | 74.4 | 25.5 | -90.00 | -3,553.3 | 1,437.3 | 421.9 | 332.5 | 89.37 | 4.720 | | | | | |

Anticollision Report

| | | | |
|---------------------------|----------------------------|-------------------------------------|--------------------------------------|
| Company: | EnCana Oil & Gas (USA) Inc | Local Co-ordinate Reference: | Well Woolley-Sosa 2F-7H-E168 |
| Project: | DJ Wattenberg | TVD Reference: | WELL @ 5019.0ft (Original Well Elev) |
| Reference Site: | S7-T1N-R68W (Woolley-Sosa) | MD Reference: | WELL @ 5019.0ft (Original Well Elev) |
| Site Error: | 0.0ft | North Reference: | True |
| Reference Well: | Woolley-Sosa 2F-7H-E168 | Survey Calculation Method: | Minimum Curvature |
| Well Error: | 0.0ft | Output errors are at | 2.00 sigma |
| Reference Wellbore | HZ | Database: | USA EDM 5000 Multi Users DB |
| Reference Design: | Plan #1 | Offset TVD Reference: | Offset Datum |

| Offset Design S7-T1N-R68W (Woolley-Sosa) - Sosa 22-18 - DD - DD | | | | | | | | | | | | | Offset Site Error: | 0.0 ft |
|---|------------------------|------------------------|------------------------|-------------------|----------------|-----------------------------|---|---------------|----------------------------|-----------------------------|------------------------------|----------------------|--------------------|---------|
| Survey Program: 41-MWD | | | | | | | | | | | | | Offset Well Error: | 0.0 ft |
| Reference | | Offset | | Semi Major Axis | | | Distance | | | | | | | Warning |
| Measured Depth (ft) | Vertical Depth (ft) | Measured Depth (ft) | Vertical Depth (ft) | Reference (ft) | Offset (ft) | Highside Toolface (°) | Offset Wellbore Centre +N/-S (ft) | +E/-W (ft) | Between Centres (ft) | Between Ellipses (ft) | Total Uncertainty Axis | Separation Factor | | |
| 12,800.0 | 7,759.0 | 7,904.0 | 7,768.1 | 86.1 | 25.7 | -89.36 | -5,038.4 | 1,350.8 | 479.5 | 375.9 | 103.60 | 4.628 | | |
| 12,900.0 | 7,759.0 | 7,904.0 | 7,768.1 | 87.7 | 25.7 | -89.36 | -5,038.4 | 1,350.8 | 387.5 | 282.1 | 105.33 | 3.679 | | |
| 13,000.0 | 7,759.0 | 7,904.0 | 7,768.1 | 89.4 | 25.7 | -89.36 | -5,038.4 | 1,350.8 | 300.6 | 193.5 | 107.06 | 2.807 | | |
| 13,100.0 | 7,759.0 | 7,904.0 | 7,768.1 | 91.1 | 25.7 | -89.36 | -5,038.4 | 1,350.8 | 224.8 | 116.0 | 108.79 | 2.067 | | |
| 13,200.0 | 7,759.0 | 7,904.0 | 7,768.1 | 92.8 | 25.7 | -89.36 | -5,038.4 | 1,350.8 | 175.4 | 64.9 | 110.52 | 1.587 | | |
| 13,249.0 | 7,759.0 | 7,904.0 | 7,768.1 | 93.6 | 25.7 | -89.36 | -5,038.4 | 1,350.8 | 168.4 | 57.0 | 111.37 | 1.512 CC, ES, SF | | |
| 13,300.0 | 7,759.0 | 7,904.0 | 7,768.1 | 94.5 | 25.7 | -89.36 | -5,038.4 | 1,350.8 | 176.0 | 63.7 | 112.26 | 1.568 | | |
| 13,400.0 | 7,759.0 | 7,904.0 | 7,768.1 | 96.2 | 25.7 | -89.36 | -5,038.4 | 1,350.8 | 226.2 | 112.2 | 113.99 | 1.985 | | |
| 13,500.0 | 7,759.0 | 7,904.0 | 7,768.1 | 97.9 | 25.7 | -89.36 | -5,038.4 | 1,350.8 | 302.3 | 186.6 | 115.72 | 2.612 | | |
| 13,600.0 | 7,759.0 | 7,904.0 | 7,768.1 | 99.6 | 25.7 | -89.37 | -5,038.4 | 1,350.8 | 389.3 | 271.9 | 117.46 | 3.315 | | |
| 13,700.0 | 7,759.0 | 7,904.0 | 7,768.1 | 101.3 | 25.7 | -89.37 | -5,038.4 | 1,350.8 | 481.5 | 362.3 | 119.19 | 4.039 | | |

Anticollision Report

| | | | |
|---------------------------|----------------------------|-------------------------------------|--------------------------------------|
| Company: | EnCana Oil & Gas (USA) Inc | Local Co-ordinate Reference: | Well Woolley-Sosa 2F-7H-E168 |
| Project: | DJ Wattenberg | TVD Reference: | WELL @ 5019.0ft (Original Well Elev) |
| Reference Site: | S7-T1N-R68W (Woolley-Sosa) | MD Reference: | WELL @ 5019.0ft (Original Well Elev) |
| Site Error: | 0.0ft | North Reference: | True |
| Reference Well: | Woolley-Sosa 2F-7H-E168 | Survey Calculation Method: | Minimum Curvature |
| Well Error: | 0.0ft | Output errors are at | 2.00 sigma |
| Reference Wellbore | HZ | Database: | USA EDM 5000 Multi Users DB |
| Reference Design: | Plan #1 | Offset TVD Reference: | Offset Datum |

| Offset Design | | | | | | | | | | | | S7-T1N-R68W (Woolley-Sosa) - Sosa 22-18 - DD - Plan #2 | | Offset Site Error: | | 0.0 ft |
|-----------------|----------------|----------------|----------------|-----------------|--------|-------------------|------------------------|-----------------|------------------|------------------------|-------------------|--|---------------------|--------------------|--|--------|
| Survey Program: | | | | | | | | | | | | 0-MWD | | Offset Well Error: | | 0.0 ft |
| Reference | | Offset | | Semi Major Axis | | | Distance | | | | | | | Warning | | |
| Measured Depth | Vertical Depth | Measured Depth | Vertical Depth | Reference | Offset | Highside Toolface | Offset Wellbore Centre | Between Centres | Between Ellipses | Total Uncertainty Axis | Separation Factor | | | | | |
| (ft) | (ft) | (ft) | (ft) | (ft) | (ft) | (°) | +N/-S (ft) | +E/-W (ft) | (ft) | (ft) | | | | | | |
| 12,800.0 | 7,759.0 | 7,893.1 | 7,770.0 | 86.1 | 25.3 | -90.00 | -5,021.3 | 1,333.5 | 457.5 | 354.1 | 103.40 | 4.425 | | | | |
| 12,900.0 | 7,759.0 | 7,893.1 | 7,770.0 | 87.7 | 25.3 | -90.00 | -5,021.3 | 1,333.5 | 364.6 | 259.5 | 105.13 | 3.469 | | | | |
| 13,000.0 | 7,759.0 | 7,893.1 | 7,770.0 | 89.4 | 25.3 | -90.00 | -5,021.3 | 1,333.5 | 276.7 | 169.9 | 106.86 | 2.590 | | | | |
| 13,100.0 | 7,759.0 | 7,893.1 | 7,770.0 | 91.1 | 25.3 | -90.00 | -5,021.3 | 1,333.5 | 200.5 | 91.9 | 108.59 | 1.847 | | | | |
| 13,200.0 | 7,759.0 | 7,893.1 | 7,770.0 | 92.8 | 25.3 | -90.00 | -5,021.3 | 1,333.5 | 154.4 | 44.0 | 110.32 | 1.399 | Level 3 | | | |
| 13,231.9 | 7,759.0 | 7,893.1 | 7,770.0 | 93.3 | 25.3 | -90.00 | -5,021.3 | 1,333.5 | 151.0 | 40.2 | 110.88 | 1.362 | Level 3, CC, ES, SF | | | |
| 13,300.0 | 7,759.0 | 7,893.1 | 7,770.0 | 94.5 | 25.3 | -90.00 | -5,021.3 | 1,333.5 | 165.7 | 53.6 | 112.06 | 1.478 | Level 3 | | | |
| 13,400.0 | 7,759.0 | 7,893.1 | 7,770.0 | 96.2 | 25.3 | -90.00 | -5,021.3 | 1,333.5 | 226.0 | 112.2 | 113.79 | 1.986 | | | | |
| 13,500.0 | 7,759.0 | 7,893.1 | 7,770.0 | 97.9 | 25.3 | -90.00 | -5,021.3 | 1,333.5 | 307.7 | 192.2 | 115.52 | 2.664 | | | | |
| 13,600.0 | 7,759.0 | 7,893.1 | 7,770.0 | 99.6 | 25.3 | -90.00 | -5,021.3 | 1,333.5 | 397.9 | 280.6 | 117.26 | 3.393 | | | | |
| 13,700.0 | 7,759.0 | 7,893.1 | 7,770.0 | 101.3 | 25.3 | -90.00 | -5,021.3 | 1,333.5 | 491.9 | 372.9 | 118.99 | 4.133 | | | | |

Anticollision Report

| | | | |
|---------------------------|----------------------------|-------------------------------------|--------------------------------------|
| Company: | EnCana Oil & Gas (USA) Inc | Local Co-ordinate Reference: | Well Woolley-Sosa 2F-7H-E168 |
| Project: | DJ Wattenberg | TVD Reference: | WELL @ 5019.0ft (Original Well Elev) |
| Reference Site: | S7-T1N-R68W (Woolley-Sosa) | MD Reference: | WELL @ 5019.0ft (Original Well Elev) |
| Site Error: | 0.0ft | North Reference: | True |
| Reference Well: | Woolley-Sosa 2F-7H-E168 | Survey Calculation Method: | Minimum Curvature |
| Well Error: | 0.0ft | Output errors are at | 2.00 sigma |
| Reference Wellbore | HZ | Database: | USA EDM 5000 Multi Users DB |
| Reference Design: | Plan #1 | Offset TVD Reference: | Offset Datum |

| Offset Design S7-T1N-R68W (Woolley-Sosa) - THOMAS 24-7 (EXISTING) - ENCANA WELL - SURVEYS | | | | | | | | | | | | | Offset Site Error: | 0.0 ft |
|---|---------------------|---------------------|---------------------|-----------------|-------------|-----------------------|-----------------------------------|------------|----------------------|-----------------------|------------------------|-------------------|--------------------|---------|
| Survey Program: 1024-MWD | | | | | | | | | | | | | Offset Well Error: | 0.0 ft |
| Reference | | Offset | | Semi Major Axis | | | Distance | | | | | | | Warning |
| Measured Depth (ft) | Vertical Depth (ft) | Measured Depth (ft) | Vertical Depth (ft) | Reference (ft) | Offset (ft) | Highside Toolface (°) | Offset Wellbore Centre +N/-S (ft) | +E/-W (ft) | Between Centres (ft) | Between Ellipses (ft) | Total Uncertainty Axis | Separation Factor | | |
| 10,200.0 | 7,759.0 | 7,771.0 | 7,758.5 | 44.5 | 14.4 | -90.20 | -2,371.7 | 1,318.5 | 405.7 | 352.7 | 53.03 | 7.651 | | |
| 10,300.0 | 7,759.0 | 7,770.7 | 7,758.1 | 45.9 | 14.4 | -90.06 | -2,371.7 | 1,318.5 | 313.3 | 258.7 | 54.67 | 5.731 | | |
| 10,400.0 | 7,759.0 | 7,770.3 | 7,757.8 | 47.4 | 14.4 | -89.91 | -2,371.7 | 1,318.5 | 227.4 | 171.1 | 56.33 | 4.038 | | |
| 10,500.0 | 7,759.0 | 7,770.0 | 7,757.5 | 48.9 | 14.4 | -89.77 | -2,371.7 | 1,318.5 | 159.0 | 101.0 | 57.99 | 2.742 | | |
| 10,582.2 | 7,759.0 | 7,769.7 | 7,757.2 | 50.2 | 14.4 | -89.65 | -2,371.7 | 1,318.5 | 136.1 | 76.7 | 59.36 | 2.293 CC, ES, SF | | |
| 10,600.0 | 7,759.0 | 7,769.6 | 7,757.1 | 50.4 | 14.4 | -89.63 | -2,371.7 | 1,318.5 | 137.2 | 77.6 | 59.65 | 2.301 | | |
| 10,700.0 | 7,759.0 | 7,769.3 | 7,756.8 | 52.0 | 14.4 | -89.48 | -2,371.7 | 1,318.5 | 180.0 | 118.6 | 61.32 | 2.935 | | |
| 10,800.0 | 7,759.0 | 7,769.0 | 7,756.4 | 53.5 | 14.4 | -89.34 | -2,371.7 | 1,318.5 | 256.8 | 193.8 | 63.00 | 4.076 | | |
| 10,900.0 | 7,759.0 | 7,768.6 | 7,756.1 | 55.0 | 14.4 | -89.19 | -2,371.7 | 1,318.5 | 345.7 | 281.0 | 64.68 | 5.344 | | |
| 11,000.0 | 7,759.0 | 7,768.3 | 7,755.8 | 56.6 | 14.4 | -89.05 | -2,371.7 | 1,318.5 | 439.4 | 373.0 | 66.37 | 6.620 | | |

Anticollision Report

| | | | |
|---------------------------|----------------------------|-------------------------------------|--------------------------------------|
| Company: | EnCana Oil & Gas (USA) Inc | Local Co-ordinate Reference: | Well Woolley-Sosa 2F-7H-E168 |
| Project: | DJ Wattenberg | TVD Reference: | WELL @ 5019.0ft (Original Well Elev) |
| Reference Site: | S7-T1N-R68W (Woolley-Sosa) | MD Reference: | WELL @ 5019.0ft (Original Well Elev) |
| Site Error: | 0.0ft | North Reference: | True |
| Reference Well: | Woolley-Sosa 2F-7H-E168 | Survey Calculation Method: | Minimum Curvature |
| Well Error: | 0.0ft | Output errors are at | 2.00 sigma |
| Reference Wellbore | HZ | Database: | USA EDM 5000 Multi Users DB |
| Reference Design: | Plan #1 | Offset TVD Reference: | Offset Datum |

| Offset Design S7-T1N-R68W (Woolley-Sosa) - THOMAS 24-7 (Existing) - Existing - NO SURVEYS | | | | | | | | | | | | | Offset Site Error: 0.0 ft | |
|---|---------------------|---------------------|---------------------|-----------------|-------------|-----------------------|-----------------------------------|------------|----------------------|-----------------------|------------------------|-------------------|---------------------------|--|
| Survey Program: 8365-Geolink MWD | | | | | | | | | | | | | Offset Well Error: 0.0 ft | |
| Reference | | Offset | | Semi Major Axis | | | Distance | | | | | | | |
| Measured Depth (ft) | Vertical Depth (ft) | Measured Depth (ft) | Vertical Depth (ft) | Reference (ft) | Offset (ft) | Highside Toolface (°) | Offset Wellbore Centre +N/-S (ft) | +E/-W (ft) | Between Centres (ft) | Between Ellipses (ft) | Total Uncertainty Axis | Separation Factor | Warning | |
| 10,000.0 | 7,759.0 | 7,742.0 | 7,742.0 | 41.6 | 13.5 | 90.00 | -2,242.6 | 1,063.8 | 468.5 | 418.9 | 49.59 | 9.447 | | |
| 10,100.0 | 7,759.0 | 7,742.0 | 7,742.0 | 43.1 | 13.5 | 90.00 | -2,242.6 | 1,063.8 | 372.6 | 321.4 | 51.21 | 7.276 | | |
| 10,200.0 | 7,759.0 | 7,742.0 | 7,742.0 | 44.5 | 13.5 | 90.00 | -2,242.6 | 1,063.8 | 279.6 | 226.8 | 52.84 | 5.292 | | |
| 10,300.0 | 7,759.0 | 7,742.0 | 7,742.0 | 45.9 | 13.5 | 90.00 | -2,242.6 | 1,063.8 | 193.8 | 139.3 | 54.48 | 3.557 | | |
| 10,400.0 | 7,759.0 | 7,742.0 | 7,742.0 | 47.4 | 13.5 | 90.00 | -2,242.6 | 1,063.8 | 130.0 | 73.9 | 56.13 | 2.317 | | |
| 10,453.2 | 7,759.0 | 7,742.0 | 7,742.0 | 48.2 | 13.5 | 90.00 | -2,242.6 | 1,063.8 | 118.7 | 61.7 | 57.02 | 2.081 | CC, ES, SF | |
| 10,500.0 | 7,759.0 | 7,742.0 | 7,742.0 | 48.9 | 13.5 | 90.00 | -2,242.6 | 1,063.8 | 127.6 | 69.8 | 57.79 | 2.207 | | |
| 10,600.0 | 7,759.0 | 7,742.0 | 7,742.0 | 50.4 | 13.5 | 90.00 | -2,242.6 | 1,063.8 | 188.8 | 129.3 | 59.46 | 3.175 | | |
| 10,700.0 | 7,759.0 | 7,742.0 | 7,742.0 | 52.0 | 13.5 | 90.00 | -2,242.6 | 1,063.8 | 273.9 | 212.7 | 61.13 | 4.480 | | |
| 10,800.0 | 7,759.0 | 7,742.0 | 7,742.0 | 53.5 | 13.5 | 90.00 | -2,242.6 | 1,063.8 | 366.5 | 303.7 | 62.81 | 5.836 | | |
| 10,900.0 | 7,759.0 | 7,742.0 | 7,742.0 | 55.0 | 13.5 | 90.00 | -2,242.6 | 1,063.8 | 462.3 | 397.8 | 64.49 | 7.168 | | |

Anticollision Report

| | | | |
|---------------------------|----------------------------|-------------------------------------|--------------------------------------|
| Company: | EnCana Oil & Gas (USA) Inc | Local Co-ordinate Reference: | Well Woolley-Sosa 2F-7H-E168 |
| Project: | DJ Wattenberg | TVD Reference: | WELL @ 5019.0ft (Original Well Elev) |
| Reference Site: | S7-T1N-R68W (Woolley-Sosa) | MD Reference: | WELL @ 5019.0ft (Original Well Elev) |
| Site Error: | 0.0ft | North Reference: | True |
| Reference Well: | Woolley-Sosa 2F-7H-E168 | Survey Calculation Method: | Minimum Curvature |
| Well Error: | 0.0ft | Output errors are at | 2.00 sigma |
| Reference Wellbore | HZ | Database: | USA EDM 5000 Multi Users DB |
| Reference Design: | Plan #1 | Offset TVD Reference: | Offset Datum |

| Offset Design | | | | | | | | | | | | | S7-T1N-R68W (Woolley-Sosa) - THOMAS E UNIT 1 (EXISTING) - Existing - NO SURVEYS | | Offset Site Error: | | 0.0 ft |
|-----------------|----------------|----------------|----------------|-----------------|--------|-------------------|------------------------|-------|-----------------|------------------|-------------------|--------------|---|--|--------------------|--|--------|
| Survey Program: | | | | | | | | | | | | | 8332-Geolink MWD | | Offset Well Error: | | 0.0 ft |
| Reference | | Offset | | Semi Major Axis | | | Distance | | | | | | | | | | |
| Measured Depth | Vertical Depth | Measured Depth | Vertical Depth | Reference | Offset | Highside Toolface | Offset Wellbore Centre | | Between Centres | Between Ellipses | Total Uncertainty | Separation | Warning | | | | |
| (ft) | (ft) | (ft) | (ft) | (ft) | (ft) | (°) | +N/-S | +E/-W | (ft) | (ft) | Axis | Factor | | | | | |
| 9,100.0 | 7,759.0 | 7,741.0 | 7,741.0 | 30.6 | 13.5 | 90.00 | -1,137.0 | 816.0 | 442.2 | 406.3 | 35.93 | 12.307 | | | | | |
| 9,200.0 | 7,759.0 | 7,741.0 | 7,741.0 | 31.7 | 13.5 | 90.00 | -1,137.0 | 816.0 | 395.0 | 357.7 | 37.32 | 10.585 | | | | | |
| 9,300.0 | 7,759.0 | 7,741.0 | 7,741.0 | 32.7 | 13.5 | 90.00 | -1,137.0 | 816.0 | 369.5 | 330.7 | 38.75 | 9.535 | | | | | |
| 9,347.6 | 7,759.0 | 7,741.0 | 7,741.0 | 33.3 | 13.5 | 90.00 | -1,137.0 | 816.0 | 366.4 | 327.0 | 39.45 | 9.287 CC, ES | | | | | |
| 9,400.0 | 7,759.0 | 7,741.0 | 7,741.0 | 33.9 | 13.5 | 90.00 | -1,137.0 | 816.0 | 370.1 | 329.9 | 40.23 | 9.202 SF | | | | | |
| 9,500.0 | 7,759.0 | 7,741.0 | 7,741.0 | 35.1 | 13.5 | 90.00 | -1,137.0 | 816.0 | 396.8 | 355.1 | 41.73 | 9.510 | | | | | |
| 9,600.0 | 7,759.0 | 7,741.0 | 7,741.0 | 36.3 | 13.5 | 90.00 | -1,137.0 | 816.0 | 444.9 | 401.7 | 43.26 | 10.285 | | | | | |

Anticollision Report

| | | | |
|---------------------------|----------------------------|-------------------------------------|--------------------------------------|
| Company: | EnCana Oil & Gas (USA) Inc | Local Co-ordinate Reference: | Well Woolley-Sosa 2F-7H-E168 |
| Project: | DJ Wattenberg | TVD Reference: | WELL @ 5019.0ft (Original Well Elev) |
| Reference Site: | S7-T1N-R68W (Woolley-Sosa) | MD Reference: | WELL @ 5019.0ft (Original Well Elev) |
| Site Error: | 0.0ft | North Reference: | True |
| Reference Well: | Woolley-Sosa 2F-7H-E168 | Survey Calculation Method: | Minimum Curvature |
| Well Error: | 0.0ft | Output errors are at | 2.00 sigma |
| Reference Wellbore | HZ | Database: | USA EDM 5000 Multi Users DB |
| Reference Design: | Plan #1 | Offset TVD Reference: | Offset Datum |

| Offset Design S7-T1N-R68W (Woolley-Sosa) - Woolley-Sosa 2A-7H-E168 - Hz - Plan #1 | | | | | | | | | | | | | Offset Site Error: | 0.0 ft |
|---|---------------------------|---------------------------|---------------------------|-------------------|----------------|-----------------------------|---|---------------|------------------------------|----------------------|---------|--------|--------------------|--------|
| Survey Program: 0-Geolink MWD | | | | | | | | | | | | | Offset Well Error: | 0.0 ft |
| Reference | | Offset | | Semi Major Axis | | Highside Toolface (°) | Distance | | Total Uncertainty Axis | Separation Factor | Warning | | | |
| Measured Depth (ft) | Vertical Depth (ft) | Measured Depth (ft) | Vertical Depth (ft) | Reference (ft) | Offset (ft) | | Offset Wellbore Centre +N/-S (ft) | +E/-W (ft) | | | | | | |
| 0.0 | 0.0 | 0.0 | 0.0 | 0.0 | 0.0 | -99.44 | -5.8 | -35.0 | 35.5 | | | | | |
| 100.0 | 100.0 | 100.0 | 100.0 | 0.1 | 0.1 | -99.44 | -5.8 | -35.0 | 35.5 | | | | | |
| 200.0 | 200.0 | 200.0 | 200.0 | 0.3 | 0.3 | -99.44 | -5.8 | -35.0 | 35.5 | | | | | |
| 300.0 | 300.0 | 299.7 | 299.7 | 0.5 | 0.5 | -98.26 | -5.2 | -35.6 | 36.0 | 0.26 | 135.640 | CC, ES | | |
| 400.0 | 400.0 | 399.3 | 399.2 | 0.7 | 0.7 | -157.44 | -3.2 | -37.3 | 38.3 | 0.96 | 37.471 | | | |
| 500.0 | 500.0 | 498.7 | 498.5 | 0.8 | 0.8 | -154.09 | 0.0 | -40.1 | 43.3 | 1.31 | 29.164 | | | |
| 600.0 | 599.9 | 597.8 | 597.5 | 1.0 | 1.0 | -150.91 | 4.6 | -44.1 | 51.1 | 1.67 | 25.949 | | | |
| 700.0 | 699.7 | 696.5 | 695.9 | 1.2 | 1.3 | -148.26 | 10.4 | -49.2 | 61.7 | 2.03 | 25.171 | SF | | |
| 800.0 | 799.4 | 794.8 | 793.7 | 1.4 | 1.5 | -146.20 | 17.4 | -55.3 | 75.1 | 2.40 | 25.713 | | | |
| 900.0 | 898.9 | 892.8 | 891.1 | 1.7 | 1.7 | -144.69 | 25.6 | -62.5 | 91.2 | 2.78 | 27.010 | | | |
| 1,000.0 | 998.3 | 991.2 | 988.9 | 1.9 | 2.0 | -144.00 | 34.1 | -69.9 | 108.9 | 3.17 | 28.738 | | | |
| 1,100.0 | 1,097.4 | 1,089.3 | 1,086.4 | 2.2 | 2.2 | -143.94 | 42.6 | -77.3 | 128.1 | 3.57 | 30.473 | | | |
| 1,200.0 | 1,196.3 | 1,187.2 | 1,183.6 | 2.5 | 2.5 | -144.26 | 51.1 | -84.7 | 148.6 | 3.99 | 32.131 | | | |
| 1,300.0 | 1,294.9 | 1,284.7 | 1,280.5 | 2.8 | 2.7 | -144.81 | 59.5 | -92.1 | 170.6 | 4.41 | 33.723 | | | |
| 1,400.0 | 1,393.3 | 1,381.9 | 1,377.0 | 3.1 | 3.0 | -145.51 | 67.9 | -99.4 | 193.9 | 4.84 | 35.265 | | | |
| 1,500.0 | 1,491.4 | 1,479.0 | 1,473.4 | 3.5 | 3.2 | -146.28 | 76.3 | -106.7 | 218.0 | 5.27 | 36.771 | | | |
| 1,600.0 | 1,589.6 | 1,576.0 | 1,569.8 | 3.8 | 3.5 | -146.90 | 84.7 | -114.0 | 242.0 | 5.72 | 38.111 | | | |
| 1,700.0 | 1,687.8 | 1,673.0 | 1,666.2 | 4.2 | 3.7 | -147.41 | 93.0 | -121.4 | 266.1 | 6.17 | 39.253 | | | |
| 1,800.0 | 1,785.9 | 1,770.1 | 1,762.6 | 4.6 | 4.0 | -147.84 | 101.4 | -128.7 | 290.2 | 6.61 | 40.237 | | | |
| 1,900.0 | 1,884.1 | 1,867.1 | 1,859.0 | 4.9 | 4.3 | -148.19 | 109.8 | -136.0 | 314.4 | 7.06 | 41.094 | | | |
| 2,000.0 | 1,982.3 | 1,964.1 | 1,955.4 | 5.3 | 4.5 | -148.50 | 118.2 | -143.3 | 338.5 | 7.51 | 41.846 | | | |
| 2,100.0 | 2,080.5 | 2,061.1 | 2,051.8 | 5.7 | 4.8 | -148.77 | 126.6 | -150.6 | 362.6 | 7.96 | 42.511 | | | |
| 2,200.0 | 2,178.6 | 2,158.2 | 2,148.1 | 6.0 | 5.0 | -149.00 | 135.0 | -158.0 | 386.8 | 8.41 | 43.103 | | | |
| 2,300.0 | 2,276.8 | 2,255.2 | 2,244.5 | 6.4 | 5.3 | -149.21 | 143.3 | -165.3 | 411.0 | 8.86 | 43.634 | | | |
| 2,400.0 | 2,375.0 | 2,352.2 | 2,340.9 | 6.8 | 5.5 | -149.39 | 151.7 | -172.6 | 435.1 | 9.32 | 44.113 | | | |
| 2,500.0 | 2,473.2 | 2,449.3 | 2,437.3 | 7.2 | 5.8 | -149.55 | 160.1 | -179.9 | 459.3 | 9.77 | 44.546 | | | |
| 2,600.0 | 2,571.3 | 2,546.3 | 2,533.7 | 7.5 | 6.0 | -149.70 | 168.5 | -187.2 | 483.4 | 10.22 | 44.940 | | | |
| | | | | | | | | | 472.8 | 10.67 | 45.301 | | | |

Anticollision Report

| | | | |
|---------------------------|----------------------------|-------------------------------------|--------------------------------------|
| Company: | EnCana Oil & Gas (USA) Inc | Local Co-ordinate Reference: | Well Woolley-Sosa 2F-7H-E168 |
| Project: | DJ Wattenberg | TVD Reference: | WELL @ 5019.0ft (Original Well Elev) |
| Reference Site: | S7-T1N-R68W (Woolley-Sosa) | MD Reference: | WELL @ 5019.0ft (Original Well Elev) |
| Site Error: | 0.0ft | North Reference: | True |
| Reference Well: | Woolley-Sosa 2F-7H-E168 | Survey Calculation Method: | Minimum Curvature |
| Well Error: | 0.0ft | Output errors are at | 2.00 sigma |
| Reference Wellbore | HZ | Database: | USA EDM 5000 Multi Users DB |
| Reference Design: | Plan #1 | Offset TVD Reference: | Offset Datum |

| Offset Design S7-T1N-R68W (Woolley-Sosa) - Woolley-Sosa 2B-7H-E168 - HZ - Plan #1 | | | | | | | | | | | | | Offset Site Error: | 0.0 ft |
|---|---------------------------|---------------------------|---------------------------|-------------------|----------------|-----------------------------|---|---------------|------------------------------|----------------------|---------|---------------|--------------------|--------|
| Survey Program: 0-Geolink MWD | | | | | | | | | | | | | Offset Well Error: | 0.0 ft |
| Reference | | Offset | | Semi Major Axis | | Highside Toolface (°) | Distance | | Total Uncertainty Axis | Separation Factor | Warning | | | |
| Measured Depth (ft) | Vertical Depth (ft) | Measured Depth (ft) | Vertical Depth (ft) | Reference (ft) | Offset (ft) | | Offset Wellbore Centre +N/-S (ft) | +E/-W (ft) | | | | | | |
| 0.0 | 0.0 | 0.0 | 0.0 | 0.0 | 0.0 | -89.71 | 0.2 | -30.0 | 30.0 | | | | | |
| 100.0 | 100.0 | 100.0 | 100.0 | 0.1 | 0.1 | -89.71 | 0.2 | -30.0 | 30.0 | 29.7 | 114.591 | | | |
| 200.0 | 200.0 | 200.0 | 200.0 | 0.3 | 0.3 | -89.71 | 0.2 | -30.0 | 30.0 | 29.4 | 0.61 | 49.111 | | |
| 300.0 | 300.0 | 300.0 | 300.0 | 0.5 | 0.5 | -89.71 | 0.2 | -30.0 | 30.0 | 29.0 | 0.96 | 31.252 CC, ES | | |
| 400.0 | 400.0 | 399.8 | 399.8 | 0.7 | 0.7 | -150.94 | 1.0 | -30.2 | 31.0 | 29.7 | 1.31 | 23.686 | | |
| 500.0 | 500.0 | 499.6 | 499.6 | 0.8 | 0.8 | -148.86 | 3.5 | -31.0 | 34.1 | 32.4 | 1.66 | 20.502 | | |
| 600.0 | 599.9 | 599.2 | 599.1 | 1.0 | 1.0 | -146.13 | 7.7 | -32.1 | 39.3 | 37.3 | 2.02 | 19.412 SF | | |
| 700.0 | 699.7 | 698.6 | 698.3 | 1.2 | 1.2 | -143.33 | 13.5 | -33.8 | 46.7 | 44.3 | 2.40 | 19.467 | | |
| 800.0 | 799.4 | 797.8 | 797.1 | 1.4 | 1.4 | -140.81 | 20.9 | -35.9 | 56.3 | 53.5 | 2.79 | 20.187 | | |
| 900.0 | 898.9 | 897.0 | 896.0 | 1.7 | 1.6 | -139.09 | 29.5 | -38.4 | 67.8 | 64.6 | 3.19 | 21.251 | | |
| 1,000.0 | 998.3 | 996.2 | 994.7 | 1.9 | 1.9 | -138.66 | 38.1 | -40.8 | 80.7 | 77.1 | 3.60 | 22.380 | | |
| 1,100.0 | 1,097.4 | 1,095.2 | 1,093.3 | 2.2 | 2.1 | -139.02 | 46.7 | -43.3 | 94.9 | 90.8 | 4.03 | 23.538 | | |
| 1,200.0 | 1,196.3 | 1,193.9 | 1,191.7 | 2.5 | 2.3 | -139.85 | 55.2 | -45.7 | 110.4 | 105.9 | 4.46 | 24.720 | | |
| 1,300.0 | 1,294.9 | 1,292.5 | 1,289.8 | 2.8 | 2.5 | -140.95 | 63.8 | -48.2 | 127.2 | 122.3 | 4.91 | 25.928 | | |
| 1,400.0 | 1,393.3 | 1,390.7 | 1,387.7 | 3.1 | 2.8 | -142.19 | 72.3 | -50.6 | 145.5 | 140.1 | 5.35 | 27.168 | | |
| 1,500.0 | 1,491.4 | 1,488.9 | 1,485.4 | 3.5 | 3.0 | -143.42 | 80.8 | -53.0 | 164.4 | 158.6 | 5.81 | 28.317 | | |
| 1,600.0 | 1,589.6 | 1,587.0 | 1,583.2 | 3.8 | 3.2 | -144.39 | 89.3 | -55.5 | 183.5 | 177.2 | 6.26 | 29.307 | | |
| 1,700.0 | 1,687.8 | 1,685.1 | 1,680.9 | 4.2 | 3.4 | -145.18 | 97.8 | -57.9 | 202.5 | 195.8 | 6.71 | 30.166 | | |
| 1,800.0 | 1,785.9 | 1,783.3 | 1,778.6 | 4.6 | 3.7 | -145.84 | 106.3 | -60.3 | 221.6 | 214.5 | 7.17 | 30.919 | | |
| 1,900.0 | 1,884.1 | 1,881.4 | 1,876.4 | 4.9 | 3.9 | -146.39 | 114.8 | -62.8 | 240.7 | 233.1 | 7.62 | 31.584 | | |
| 2,000.0 | 1,982.3 | 1,979.5 | 1,974.1 | 5.3 | 4.1 | -146.86 | 123.3 | -65.2 | 259.9 | 251.8 | 8.08 | 32.175 | | |
| 2,100.0 | 2,080.5 | 2,077.7 | 2,071.8 | 5.7 | 4.3 | -147.26 | 131.8 | -67.6 | 279.0 | 270.5 | 8.53 | 32.704 | | |
| 2,200.0 | 2,178.6 | 2,175.8 | 2,169.6 | 6.0 | 4.6 | -147.61 | 140.3 | -70.0 | 298.2 | 289.2 | 8.99 | 33.180 | | |
| 2,300.0 | 2,276.8 | 2,273.9 | 2,267.3 | 6.4 | 4.8 | -147.92 | 148.8 | -72.5 | 317.4 | 307.9 | 9.44 | 33.610 | | |
| 2,400.0 | 2,375.0 | 2,372.0 | 2,365.0 | 6.8 | 5.0 | -148.20 | 157.3 | -74.9 | 336.5 | 326.6 | 9.90 | 34.001 | | |
| 2,500.0 | 2,473.2 | 2,470.2 | 2,462.7 | 7.2 | 5.3 | -148.44 | 165.8 | -77.3 | 355.7 | 345.4 | 10.35 | 34.358 | | |
| 2,600.0 | 2,571.3 | 2,568.3 | 2,560.5 | 7.5 | 5.5 | -148.67 | 174.3 | -79.8 | 374.9 | 364.1 | 10.81 | 34.685 | | |
| 2,700.0 | 2,669.5 | 2,666.4 | 2,658.2 | 7.9 | 5.7 | -148.86 | 182.8 | -82.2 | 394.1 | 382.9 | 11.27 | 34.985 | | |
| 2,800.0 | 2,767.7 | 2,764.6 | 2,755.9 | 8.3 | 6.0 | -149.04 | 191.3 | -84.6 | 413.3 | 401.6 | 11.72 | 35.262 | | |
| 2,900.0 | 2,865.9 | 2,862.7 | 2,853.7 | 8.7 | 6.2 | -149.21 | 199.8 | -87.1 | 432.5 | 420.3 | 12.18 | 35.519 | | |
| 3,000.0 | 2,964.0 | 2,960.8 | 2,951.4 | 9.0 | 6.4 | -149.36 | 208.3 | -89.5 | 451.7 | 439.1 | 12.63 | 35.757 | | |
| 3,100.0 | 3,062.2 | 3,059.0 | 3,049.1 | 9.4 | 6.6 | -149.50 | 216.8 | -91.9 | 470.9 | 457.9 | 13.09 | 35.978 | | |
| 3,200.0 | 3,160.4 | 3,157.1 | 3,146.9 | 9.8 | 6.9 | -149.62 | 225.3 | -94.3 | 490.2 | 476.6 | 13.55 | 36.185 | | |

Anticollision Report

| | | | |
|---------------------------|----------------------------|-------------------------------------|--------------------------------------|
| Company: | EnCana Oil & Gas (USA) Inc | Local Co-ordinate Reference: | Well Woolley-Sosa 2F-7H-E168 |
| Project: | DJ Wattenberg | TVD Reference: | WELL @ 5019.0ft (Original Well Elev) |
| Reference Site: | S7-T1N-R68W (Woolley-Sosa) | MD Reference: | WELL @ 5019.0ft (Original Well Elev) |
| Site Error: | 0.0ft | North Reference: | True |
| Reference Well: | Woolley-Sosa 2F-7H-E168 | Survey Calculation Method: | Minimum Curvature |
| Well Error: | 0.0ft | Output errors are at | 2.00 sigma |
| Reference Wellbore | HZ | Database: | USA EDM 5000 Multi Users DB |
| Reference Design: | Plan #1 | Offset TVD Reference: | Offset Datum |

| Offset Design S7-T1N-R68W (Woolley-Sosa) - Woolley-Sosa 2C-7H-E168 - HZ - Plan #1 | | | | | | | | | | | | | Offset Site Error: | 0.0 ft |
|---|---------------------------|---------------------------|---------------------------|-------------------|----------------|-----------------------------|---|---------------|------------------------------|----------------------|---------|---------------|--------------------|--------|
| Survey Program: 0-Geolink MWD | | | | | | | | | | | | | Offset Well Error: | 0.0 ft |
| Reference | | Offset | | Semi Major Axis | | Highside Toolface (°) | Distance | | Total Uncertainty Axis | Separation Factor | Warning | | | |
| Measured Depth (ft) | Vertical Depth (ft) | Measured Depth (ft) | Vertical Depth (ft) | Reference (ft) | Offset (ft) | | Offset Wellbore Centre +N/-S (ft) | +E/-W (ft) | | | | | | |
| 0.0 | 0.0 | 0.0 | 0.0 | 0.0 | 0.0 | -103.21 | -5.9 | -25.0 | 25.7 | | | | | |
| 100.0 | 100.0 | 100.0 | 100.0 | 0.1 | 0.1 | -103.21 | -5.9 | -25.0 | 25.7 | 25.4 | 0.26 | 98.205 | | |
| 200.0 | 200.0 | 200.0 | 200.0 | 0.3 | 0.3 | -103.21 | -5.9 | -25.0 | 25.7 | 25.1 | 0.61 | 42.088 | | |
| 300.0 | 300.0 | 300.0 | 300.0 | 0.5 | 0.5 | -103.21 | -5.9 | -25.0 | 25.7 | 24.7 | 0.96 | 26.783 CC, ES | | |
| 400.0 | 400.0 | 400.0 | 400.0 | 0.7 | 0.7 | -165.70 | -5.9 | -25.0 | 26.6 | 25.2 | 1.31 | 20.287 | | |
| 500.0 | 500.0 | 500.2 | 500.2 | 0.8 | 0.8 | -165.46 | -5.0 | -24.8 | 28.7 | 27.0 | 1.66 | 17.279 | | |
| 600.0 | 599.9 | 600.4 | 600.4 | 1.0 | 1.0 | -163.29 | -2.5 | -24.1 | 31.6 | 29.6 | 2.01 | 15.720 | | |
| 700.0 | 699.7 | 700.6 | 700.4 | 1.2 | 1.2 | -159.83 | 1.7 | -22.9 | 35.5 | 33.2 | 2.37 | 14.983 | | |
| 800.0 | 799.4 | 800.6 | 800.3 | 1.4 | 1.4 | -155.72 | 7.6 | -21.2 | 40.5 | 37.8 | 2.75 | 14.763 SF | | |
| 900.0 | 898.9 | 900.6 | 900.0 | 1.7 | 1.6 | -151.44 | 15.1 | -19.0 | 46.8 | 43.6 | 3.14 | 14.880 | | |
| 1,000.0 | 998.3 | 1,000.3 | 999.3 | 1.9 | 1.8 | -147.82 | 23.9 | -16.5 | 54.4 | 50.8 | 3.56 | 15.278 | | |
| 1,100.0 | 1,097.4 | 1,099.9 | 1,098.4 | 2.2 | 2.0 | -145.92 | 32.7 | -14.0 | 63.6 | 59.6 | 3.99 | 15.940 | | |
| 1,200.0 | 1,196.3 | 1,199.3 | 1,197.4 | 2.5 | 2.3 | -145.26 | 41.5 | -11.5 | 74.3 | 69.8 | 4.43 | 16.774 | | |
| 1,300.0 | 1,294.9 | 1,298.6 | 1,296.3 | 2.8 | 2.5 | -145.42 | 50.3 | -9.0 | 86.4 | 81.5 | 4.87 | 17.731 | | |
| 1,400.0 | 1,393.3 | 1,397.7 | 1,394.9 | 3.1 | 2.7 | -146.09 | 59.0 | -6.5 | 99.9 | 94.6 | 5.32 | 18.788 | | |
| 1,500.0 | 1,491.4 | 1,496.6 | 1,493.5 | 3.5 | 2.9 | -146.88 | 67.8 | -4.0 | 114.2 | 108.4 | 5.77 | 19.790 | | |
| 1,600.0 | 1,589.6 | 1,595.6 | 1,592.0 | 3.8 | 3.2 | -147.49 | 76.6 | -1.5 | 128.4 | 122.2 | 6.22 | 20.643 | | |
| 1,700.0 | 1,687.8 | 1,694.6 | 1,690.6 | 4.2 | 3.4 | -147.99 | 85.3 | 1.0 | 142.7 | 136.0 | 6.67 | 21.378 | | |
| 1,800.0 | 1,785.9 | 1,793.5 | 1,789.1 | 4.6 | 3.6 | -148.39 | 94.1 | 3.5 | 156.9 | 149.8 | 7.13 | 22.016 | | |
| 1,900.0 | 1,884.1 | 1,892.5 | 1,887.7 | 4.9 | 3.9 | -148.72 | 102.8 | 6.0 | 171.2 | 163.6 | 7.58 | 22.576 | | |
| 2,000.0 | 1,982.3 | 1,991.5 | 1,986.2 | 5.3 | 4.1 | -149.01 | 111.6 | 8.5 | 185.5 | 177.5 | 8.04 | 23.071 | | |
| 2,100.0 | 2,080.5 | 2,090.5 | 2,084.8 | 5.7 | 4.3 | -149.25 | 120.3 | 11.0 | 199.8 | 191.3 | 8.50 | 23.511 | | |
| 2,200.0 | 2,178.6 | 2,189.4 | 2,183.3 | 6.0 | 4.5 | -149.46 | 129.1 | 13.5 | 214.1 | 205.1 | 8.96 | 23.904 | | |
| 2,300.0 | 2,276.8 | 2,288.4 | 2,281.9 | 6.4 | 4.8 | -149.65 | 137.8 | 16.0 | 228.4 | 219.0 | 9.41 | 24.259 | | |
| 2,400.0 | 2,375.0 | 2,387.4 | 2,380.4 | 6.8 | 5.0 | -149.81 | 146.6 | 18.5 | 242.7 | 232.8 | 9.87 | 24.580 | | |
| 2,500.0 | 2,473.2 | 2,486.3 | 2,479.0 | 7.2 | 5.2 | -149.96 | 155.4 | 21.0 | 257.0 | 246.6 | 10.33 | 24.871 | | |
| 2,600.0 | 2,571.3 | 2,585.3 | 2,577.5 | 7.5 | 5.5 | -150.09 | 164.1 | 23.5 | 271.2 | 260.5 | 10.79 | 25.137 | | |
| 2,700.0 | 2,669.5 | 2,684.3 | 2,676.1 | 7.9 | 5.7 | -150.20 | 172.9 | 26.0 | 285.5 | 274.3 | 11.25 | 25.381 | | |
| 2,800.0 | 2,767.7 | 2,783.3 | 2,774.6 | 8.3 | 5.9 | -150.31 | 181.6 | 28.5 | 299.8 | 288.1 | 11.71 | 25.605 | | |
| 2,900.0 | 2,865.9 | 2,882.2 | 2,873.2 | 8.7 | 6.2 | -150.40 | 190.4 | 31.0 | 314.1 | 302.0 | 12.17 | 25.812 | | |
| 3,000.0 | 2,964.0 | 2,981.2 | 2,971.7 | 9.0 | 6.4 | -150.49 | 199.1 | 33.5 | 328.4 | 315.8 | 12.63 | 26.003 | | |
| 3,100.0 | 3,062.2 | 3,080.2 | 3,070.3 | 9.4 | 6.6 | -150.57 | 207.9 | 36.0 | 342.7 | 329.6 | 13.09 | 26.181 | | |
| 3,200.0 | 3,160.4 | 3,179.1 | 3,168.8 | 9.8 | 6.9 | -150.65 | 216.6 | 38.5 | 357.0 | 343.5 | 13.55 | 26.346 | | |
| 3,300.0 | 3,258.5 | 3,278.1 | 3,267.4 | 10.2 | 7.1 | -150.71 | 225.4 | 41.0 | 371.3 | 357.3 | 14.01 | 26.501 | | |
| 3,400.0 | 3,356.7 | 3,377.1 | 3,365.9 | 10.5 | 7.3 | -150.78 | 234.1 | 43.5 | 385.6 | 371.2 | 14.47 | 26.645 | | |
| 3,500.0 | 3,454.9 | 3,476.1 | 3,464.5 | 10.9 | 7.6 | -150.83 | 242.9 | 46.0 | 399.9 | 385.0 | 14.93 | 26.780 | | |
| 3,600.0 | 3,553.1 | 3,575.0 | 3,563.1 | 11.3 | 7.8 | -150.89 | 251.7 | 48.5 | 414.3 | 398.9 | 15.40 | 26.907 | | |
| 3,700.0 | 3,651.2 | 3,674.0 | 3,661.6 | 11.7 | 8.0 | -150.94 | 260.4 | 51.0 | 428.6 | 412.7 | 15.86 | 27.026 | | |
| 3,800.0 | 3,749.4 | 3,773.0 | 3,760.2 | 12.1 | 8.3 | -150.99 | 269.2 | 53.5 | 442.9 | 426.5 | 16.32 | 27.138 | | |
| 3,900.0 | 3,847.6 | 3,871.9 | 3,858.7 | 12.4 | 8.5 | -151.03 | 277.9 | 56.0 | 457.2 | 440.4 | 16.78 | 27.245 | | |
| 4,000.0 | 3,945.8 | 3,970.9 | 3,957.3 | 12.8 | 8.7 | -151.07 | 286.7 | 58.5 | 471.5 | 454.2 | 17.24 | 27.345 | | |
| 4,100.0 | 4,043.9 | 4,069.9 | 4,055.8 | 13.2 | 9.0 | -151.11 | 295.4 | 61.0 | 485.8 | 468.1 | 17.70 | 27.440 | | |

Anticollision Report

| | | | |
|---------------------------|----------------------------|-------------------------------------|--------------------------------------|
| Company: | EnCana Oil & Gas (USA) Inc | Local Co-ordinate Reference: | Well Woolley-Sosa 2F-7H-E168 |
| Project: | DJ Wattenberg | TVD Reference: | WELL @ 5019.0ft (Original Well Elev) |
| Reference Site: | S7-T1N-R68W (Woolley-Sosa) | MD Reference: | WELL @ 5019.0ft (Original Well Elev) |
| Site Error: | 0.0ft | North Reference: | True |
| Reference Well: | Woolley-Sosa 2F-7H-E168 | Survey Calculation Method: | Minimum Curvature |
| Well Error: | 0.0ft | Output errors are at | 2.00 sigma |
| Reference Wellbore | HZ | Database: | USA EDM 5000 Multi Users DB |
| Reference Design: | Plan #1 | Offset TVD Reference: | Offset Datum |

| Offset Design S7-T1N-R68W (Woolley-Sosa) - Woolley-Sosa 2D-7H-E168 - HZ - Plan #1 | | | | | | | | | | | | | Offset Site Error: | 0.0 ft |
|---|---------------------|---------------------|---------------------|-----------------|-------------|-----------------------|-----------------------------------|------------|----------------------|-----------------------|------------------------|-------------------|--------------------|---------|
| Survey Program: O-Geolink MWD | | | | | | | | | | | | | Offset Well Error: | 0.0 ft |
| Reference | | Offset | | Semi Major Axis | | | Distance | | | | | | | Warning |
| Measured Depth (ft) | Vertical Depth (ft) | Measured Depth (ft) | Vertical Depth (ft) | Reference (ft) | Offset (ft) | Highside Toolface (°) | Offset Wellbore Centre +N/-S (ft) | +E/-W (ft) | Between Centres (ft) | Between Ellipses (ft) | Total Uncertainty Axis | Separation Factor | | |
| 0.0 | 0.0 | 0.0 | 0.0 | 0.0 | 0.0 | -89.71 | 0.1 | -20.0 | 20.0 | | | | | |
| 100.0 | 100.0 | 100.0 | 100.0 | 0.1 | 0.1 | -89.71 | 0.1 | -20.0 | 20.0 | 19.7 | 0.26 | 76.394 | | |
| 200.0 | 200.0 | 200.0 | 200.0 | 0.3 | 0.3 | -89.71 | 0.1 | -20.0 | 20.0 | 19.4 | 0.61 | 32.740 | | |
| 300.0 | 300.0 | 300.0 | 300.0 | 0.5 | 0.5 | -89.71 | 0.1 | -20.0 | 20.0 | 19.0 | 0.96 | 20.835 CC, ES | | |
| 400.0 | 400.0 | 400.0 | 400.0 | 0.7 | 0.7 | -152.86 | 0.1 | -20.0 | 20.8 | 19.5 | 1.31 | 15.869 | | |
| 500.0 | 500.0 | 500.0 | 500.0 | 0.8 | 0.8 | -155.81 | 0.1 | -20.0 | 23.1 | 21.5 | 1.66 | 13.949 | | |
| 600.0 | 599.9 | 600.2 | 600.2 | 1.0 | 1.0 | -158.27 | 0.8 | -19.5 | 26.5 | 24.5 | 2.01 | 13.216 | | |
| 700.0 | 699.7 | 700.5 | 700.4 | 1.2 | 1.2 | -159.02 | 2.8 | -17.8 | 30.4 | 28.0 | 2.36 | 12.861 | | |
| 800.0 | 799.4 | 800.8 | 800.7 | 1.4 | 1.4 | -158.59 | 6.3 | -15.1 | 34.6 | 31.9 | 2.72 | 12.716 | | |
| 900.0 | 898.9 | 901.1 | 900.8 | 1.7 | 1.6 | -157.39 | 11.1 | -11.2 | 39.2 | 36.1 | 3.09 | 12.693 SF | | |
| 1,000.0 | 998.3 | 1,001.5 | 1,000.9 | 1.9 | 1.8 | -155.67 | 17.2 | -6.3 | 44.2 | 40.7 | 3.47 | 12.742 | | |
| 1,100.0 | 1,097.4 | 1,101.9 | 1,100.8 | 2.2 | 2.0 | -153.64 | 24.8 | -0.3 | 49.7 | 45.8 | 3.87 | 12.829 | | |
| 1,200.0 | 1,196.3 | 1,202.0 | 1,200.3 | 2.5 | 2.2 | -151.56 | 33.6 | 6.7 | 55.7 | 51.4 | 4.30 | 12.960 | | |
| 1,300.0 | 1,294.9 | 1,301.7 | 1,299.3 | 2.8 | 2.5 | -150.44 | 42.5 | 13.9 | 63.1 | 58.4 | 4.74 | 13.327 | | |
| 1,400.0 | 1,393.3 | 1,401.3 | 1,398.3 | 3.1 | 2.7 | -150.25 | 51.5 | 21.1 | 72.1 | 66.9 | 5.18 | 13.917 | | |
| 1,500.0 | 1,491.4 | 1,500.9 | 1,497.1 | 3.5 | 3.0 | -150.42 | 60.5 | 28.3 | 81.7 | 76.1 | 5.62 | 14.528 | | |
| 1,600.0 | 1,589.6 | 1,600.4 | 1,596.0 | 3.8 | 3.2 | -150.55 | 69.5 | 35.4 | 91.4 | 85.3 | 6.07 | 15.041 | | |
| 1,700.0 | 1,687.8 | 1,699.9 | 1,694.9 | 4.2 | 3.5 | -150.66 | 78.4 | 42.6 | 101.0 | 94.5 | 6.53 | 15.476 | | |
| 1,800.0 | 1,785.9 | 1,799.5 | 1,793.7 | 4.6 | 3.7 | -150.75 | 87.4 | 49.8 | 110.7 | 103.7 | 6.98 | 15.849 | | |
| 1,900.0 | 1,884.1 | 1,899.0 | 1,892.6 | 4.9 | 4.0 | -150.82 | 96.4 | 57.0 | 120.3 | 112.9 | 7.44 | 16.172 | | |
| 2,000.0 | 1,982.3 | 1,998.5 | 1,991.5 | 5.3 | 4.2 | -150.89 | 105.4 | 64.1 | 130.0 | 122.1 | 7.90 | 16.455 | | |
| 2,100.0 | 2,080.5 | 2,098.1 | 2,090.3 | 5.7 | 4.5 | -150.94 | 114.3 | 71.3 | 139.6 | 131.3 | 8.36 | 16.704 | | |
| 2,200.0 | 2,178.6 | 2,197.6 | 2,189.2 | 6.0 | 4.7 | -150.99 | 123.3 | 78.5 | 149.3 | 140.5 | 8.82 | 16.925 | | |
| 2,300.0 | 2,276.8 | 2,297.1 | 2,288.1 | 6.4 | 5.0 | -151.03 | 132.3 | 85.6 | 158.9 | 149.7 | 9.28 | 17.123 | | |
| 2,400.0 | 2,375.0 | 2,396.7 | 2,387.0 | 6.8 | 5.3 | -151.07 | 141.3 | 92.8 | 168.6 | 158.9 | 9.75 | 17.300 | | |
| 2,500.0 | 2,473.2 | 2,496.2 | 2,485.8 | 7.2 | 5.5 | -151.10 | 150.2 | 100.0 | 178.3 | 168.0 | 10.21 | 17.460 | | |
| 2,600.0 | 2,571.3 | 2,595.7 | 2,584.7 | 7.5 | 5.8 | -151.13 | 159.2 | 107.2 | 187.9 | 177.2 | 10.67 | 17.605 | | |
| 2,700.0 | 2,669.5 | 2,695.3 | 2,683.6 | 7.9 | 6.1 | -151.16 | 168.2 | 114.3 | 197.6 | 186.4 | 11.14 | 17.737 | | |
| 2,800.0 | 2,767.7 | 2,794.8 | 2,782.4 | 8.3 | 6.3 | -151.18 | 177.2 | 121.5 | 207.2 | 195.6 | 11.60 | 17.858 | | |
| 2,900.0 | 2,865.9 | 2,894.3 | 2,881.3 | 8.7 | 6.6 | -151.21 | 186.1 | 128.7 | 216.9 | 204.8 | 12.07 | 17.969 | | |
| 3,000.0 | 2,964.0 | 2,993.9 | 2,980.2 | 9.0 | 6.8 | -151.23 | 195.1 | 135.8 | 226.5 | 214.0 | 12.54 | 18.071 | | |
| 3,100.0 | 3,062.2 | 3,093.4 | 3,079.0 | 9.4 | 7.1 | -151.25 | 204.1 | 143.0 | 236.2 | 223.2 | 13.00 | 18.166 | | |
| 3,200.0 | 3,160.4 | 3,192.9 | 3,177.9 | 9.8 | 7.4 | -151.26 | 213.0 | 150.2 | 245.8 | 232.4 | 13.47 | 18.253 | | |
| 3,300.0 | 3,258.5 | 3,292.5 | 3,276.8 | 10.2 | 7.6 | -151.28 | 222.0 | 157.4 | 255.5 | 241.6 | 13.94 | 18.334 | | |
| 3,400.0 | 3,356.7 | 3,392.0 | 3,375.6 | 10.5 | 7.9 | -151.29 | 231.0 | 164.5 | 265.2 | 250.7 | 14.40 | 18.410 | | |
| 3,500.0 | 3,454.9 | 3,491.5 | 3,474.5 | 10.9 | 8.2 | -151.31 | 240.0 | 171.7 | 274.8 | 259.9 | 14.87 | 18.481 | | |
| 3,600.0 | 3,553.1 | 3,591.1 | 3,573.4 | 11.3 | 8.4 | -151.32 | 248.9 | 178.9 | 284.5 | 269.1 | 15.34 | 18.547 | | |
| 3,700.0 | 3,651.2 | 3,690.6 | 3,672.2 | 11.7 | 8.7 | -151.33 | 257.9 | 186.1 | 294.1 | 278.3 | 15.81 | 18.609 | | |
| 3,800.0 | 3,749.4 | 3,790.1 | 3,771.1 | 12.1 | 8.9 | -151.34 | 266.9 | 193.2 | 303.8 | 287.5 | 16.27 | 18.667 | | |
| 3,900.0 | 3,847.6 | 3,889.7 | 3,870.0 | 12.4 | 9.2 | -151.35 | 275.9 | 200.4 | 313.4 | 296.7 | 16.74 | 18.722 | | |
| 4,000.0 | 3,945.8 | 3,989.2 | 3,968.8 | 12.8 | 9.5 | -151.36 | 284.8 | 207.6 | 323.1 | 305.9 | 17.21 | 18.774 | | |
| 4,100.0 | 4,043.9 | 4,088.7 | 4,067.7 | 13.2 | 9.7 | -151.37 | 293.8 | 214.7 | 332.7 | 315.1 | 17.68 | 18.823 | | |
| 4,200.0 | 4,142.1 | 4,188.3 | 4,166.6 | 13.6 | 10.0 | -151.38 | 302.8 | 221.9 | 342.4 | 324.2 | 18.15 | 18.869 | | |
| 4,300.0 | 4,240.3 | 4,287.8 | 4,265.4 | 13.9 | 10.3 | -151.39 | 311.8 | 229.1 | 352.0 | 333.4 | 18.61 | 18.913 | | |
| 4,400.0 | 4,338.4 | 4,387.3 | 4,364.3 | 14.3 | 10.5 | -151.40 | 320.7 | 236.3 | 361.7 | 342.6 | 19.08 | 18.954 | | |
| 4,500.0 | 4,436.6 | 4,486.9 | 4,463.2 | 14.7 | 10.8 | -151.41 | 329.7 | 243.4 | 371.4 | 351.8 | 19.55 | 18.994 | | |
| 4,600.0 | 4,534.8 | 4,586.4 | 4,562.0 | 15.1 | 11.1 | -151.41 | 338.7 | 250.6 | 381.0 | 361.0 | 20.02 | 19.031 | | |
| 4,700.0 | 4,633.0 | 4,685.9 | 4,660.9 | 15.5 | 11.3 | -151.42 | 347.7 | 257.8 | 390.7 | 370.2 | 20.49 | 19.067 | | |
| 4,800.0 | 4,731.1 | 4,785.5 | 4,759.8 | 15.8 | 11.6 | -151.43 | 356.6 | 264.9 | 400.3 | 379.4 | 20.96 | 19.101 | | |
| 4,900.0 | 4,829.3 | 4,885.0 | 4,858.6 | 16.2 | 11.9 | -151.43 | 365.6 | 272.1 | 410.0 | 388.5 | 21.43 | 19.133 | | |
| 5,000.0 | 4,927.5 | 4,984.5 | 4,957.5 | 16.6 | 12.1 | -151.44 | 374.6 | 279.3 | 419.6 | 397.7 | 21.90 | 19.164 | | |
| 5,100.0 | 5,025.7 | 5,084.1 | 5,056.4 | 17.0 | 12.4 | -151.44 | 383.5 | 286.5 | 429.3 | 406.9 | 22.37 | 19.194 | | |

CC - Min centre to center distance or convergent point, SF - min separation factor, ES - min ellipse separation

Anticollision Report

| | | | |
|---------------------------|----------------------------|-------------------------------------|--------------------------------------|
| Company: | EnCana Oil & Gas (USA) Inc | Local Co-ordinate Reference: | Well Woolley-Sosa 2F-7H-E168 |
| Project: | DJ Wattenberg | TVD Reference: | WELL @ 5019.0ft (Original Well Elev) |
| Reference Site: | S7-T1N-R68W (Woolley-Sosa) | MD Reference: | WELL @ 5019.0ft (Original Well Elev) |
| Site Error: | 0.0ft | North Reference: | True |
| Reference Well: | Woolley-Sosa 2F-7H-E168 | Survey Calculation Method: | Minimum Curvature |
| Well Error: | 0.0ft | Output errors are at | 2.00 sigma |
| Reference Wellbore | HZ | Database: | USA EDM 5000 Multi Users DB |
| Reference Design: | Plan #1 | Offset TVD Reference: | Offset Datum |

| Offset Design S7-T1N-R68W (Woolley-Sosa) - Woolley-Sosa 2D-7H-E168 - HZ - Plan #1 | | | | | | | | | | | | | Offset Site Error: 0.0 ft | |
|---|---------------------|---------------------|---------------------|-----------------|-------------|-----------------------|------------------------|------------|----------------------|-----------------------|------------------------|-------------------|---------------------------|--|
| Survey Program: 0-Geolink MWD | | | | | | | | | | | | | Offset Well Error: 0.0 ft | |
| Reference | | Offset | | Semi Major Axis | | | Distance | | | | | | Warning | |
| Measured Depth (ft) | Vertical Depth (ft) | Measured Depth (ft) | Vertical Depth (ft) | Reference (ft) | Offset (ft) | Highside Toolface (°) | Offset Wellbore Centre | | Between Centres (ft) | Between Ellipses (ft) | Total Uncertainty Axis | Separation Factor | | |
| | | | | | | | +N/-S (ft) | +E/-W (ft) | | | | | | |
| 5,200.0 | 5,123.8 | 5,183.6 | 5,155.2 | 17.3 | 12.7 | -151.45 | 392.5 | 293.6 | 438.9 | 416.1 | 22.83 | 19.223 | | |
| 5,300.0 | 5,222.0 | 5,283.1 | 5,254.1 | 17.7 | 12.9 | -151.45 | 401.5 | 300.8 | 448.6 | 425.3 | 23.30 | 19.250 | | |
| 5,400.0 | 5,320.2 | 5,382.7 | 5,353.0 | 18.1 | 13.2 | -151.46 | 410.5 | 308.0 | 458.2 | 434.5 | 23.77 | 19.276 | | |
| 5,500.0 | 5,418.4 | 5,482.2 | 5,451.9 | 18.5 | 13.4 | -151.46 | 419.4 | 315.1 | 467.9 | 443.7 | 24.24 | 19.301 | | |
| 5,600.0 | 5,516.5 | 5,581.7 | 5,550.7 | 18.9 | 13.7 | -151.47 | 428.4 | 322.3 | 477.6 | 452.8 | 24.71 | 19.325 | | |
| 5,700.0 | 5,614.7 | 5,681.3 | 5,649.6 | 19.2 | 14.0 | -151.47 | 437.4 | 329.5 | 487.2 | 462.0 | 25.18 | 19.348 | | |
| 5,800.0 | 5,712.9 | 5,780.8 | 5,748.5 | 19.6 | 14.2 | -151.48 | 446.4 | 336.7 | 496.9 | 471.2 | 25.65 | 19.371 | | |

Anticollision Report

| | | | |
|---------------------------|----------------------------|-------------------------------------|--------------------------------------|
| Company: | EnCana Oil & Gas (USA) Inc | Local Co-ordinate Reference: | Well Woolley-Sosa 2F-7H-E168 |
| Project: | DJ Wattenberg | TVD Reference: | WELL @ 5019.0ft (Original Well Elev) |
| Reference Site: | S7-T1N-R68W (Woolley-Sosa) | MD Reference: | WELL @ 5019.0ft (Original Well Elev) |
| Site Error: | 0.0ft | North Reference: | True |
| Reference Well: | Woolley-Sosa 2F-7H-E168 | Survey Calculation Method: | Minimum Curvature |
| Well Error: | 0.0ft | Output errors are at | 2.00 sigma |
| Reference Wellbore | HZ | Database: | USA EDM 5000 Multi Users DB |
| Reference Design: | Plan #1 | Offset TVD Reference: | Offset Datum |

| Offset Design S7-T1N-R68W (Woolley-Sosa) - Woolley-Sosa 2E-7H-E168 - HZ - Plan #1 | | | | | | | | | | | | | Offset Site Error: | 0.0 ft |
|---|---------------------------|---------------------------|---------------------------|-------------------|----------------|-----------------------------|---|---------------|----------------------------|-----------------------------|------------------------------|----------------------|--------------------|--------|
| Survey Program: O-Geolink MWD | | | | | | | | | | | | | Offset Well Error: | 0.0 ft |
| Reference | | Offset | | Semi Major Axis | | | Distance | | | | Total Uncertainty Axis | Separation Factor | Warning | |
| Measured Depth (ft) | Vertical Depth (ft) | Measured Depth (ft) | Vertical Depth (ft) | Reference (ft) | Offset (ft) | Highside Toolface (°) | Offset Wellbore Centre +N/-S (ft) | +E/-W (ft) | Between Centres (ft) | Between Ellipses (ft) | | | | |
| 0.0 | 0.0 | 0.0 | 0.0 | 0.0 | 0.0 | -139.91 | -6.0 | -5.0 | 7.8 | | | | | |
| 100.0 | 100.0 | 100.0 | 100.0 | 0.1 | 0.1 | -139.91 | -6.0 | -5.0 | 7.8 | 7.5 | 0.26 | 29.833 | CC, ES | |
| 200.0 | 200.0 | 200.0 | 200.0 | 0.3 | 0.3 | -139.91 | -6.0 | -5.0 | 7.8 | 7.2 | 0.61 | 12.786 | | |
| 300.0 | 300.0 | 300.0 | 300.0 | 0.5 | 0.5 | -139.91 | -6.0 | -5.0 | 7.8 | 6.9 | 0.96 | 8.136 | | |
| 400.0 | 400.0 | 400.0 | 400.0 | 0.7 | 0.7 | 160.24 | -6.0 | -5.0 | 8.6 | 7.3 | 1.31 | 6.590 | | |
| 500.0 | 500.0 | 500.0 | 500.0 | 0.8 | 0.8 | 164.80 | -6.0 | -5.0 | 11.1 | 9.5 | 1.66 | 6.711 | | |
| 600.0 | 599.9 | 599.9 | 599.9 | 1.0 | 1.0 | 169.06 | -6.0 | -5.0 | 15.4 | 13.4 | 2.01 | 7.665 | | |
| 700.0 | 699.7 | 699.7 | 699.7 | 1.2 | 1.2 | 172.15 | -6.0 | -5.0 | 21.4 | 19.0 | 2.35 | 9.094 | | |
| 800.0 | 799.4 | 799.4 | 799.4 | 1.4 | 1.4 | 174.25 | -6.0 | -5.0 | 29.2 | 26.5 | 2.70 | 10.813 | | |
| 900.0 | 898.9 | 898.9 | 898.9 | 1.7 | 1.5 | 175.66 | -6.0 | -5.0 | 38.7 | 35.7 | 3.05 | 12.722 | | |
| 1,000.0 | 998.3 | 998.3 | 998.3 | 1.9 | 1.7 | 176.63 | -6.0 | -5.0 | 50.0 | 46.6 | 3.39 | 14.763 | | |
| 1,100.0 | 1,097.4 | 1,098.5 | 1,098.5 | 2.2 | 1.9 | 177.42 | -5.5 | -4.4 | 62.2 | 58.5 | 3.73 | 16.669 | | |
| 1,200.0 | 1,196.3 | 1,198.9 | 1,198.9 | 2.5 | 2.1 | 178.16 | -3.9 | -2.3 | 74.5 | 70.4 | 4.08 | 18.259 | | |
| 1,300.0 | 1,294.9 | 1,299.6 | 1,299.4 | 2.8 | 2.2 | 178.89 | -1.2 | 1.2 | 86.7 | 82.3 | 4.42 | 19.607 | | |
| 1,400.0 | 1,393.3 | 1,400.4 | 1,400.1 | 3.1 | 2.4 | 179.60 | 2.5 | 6.1 | 98.9 | 94.2 | 4.77 | 20.764 | | |
| 1,500.0 | 1,491.4 | 1,501.6 | 1,500.9 | 3.5 | 2.6 | -179.70 | 7.3 | 12.5 | 110.3 | 105.2 | 5.12 | 21.551 | | |
| 1,600.0 | 1,589.6 | 1,603.1 | 1,602.0 | 3.8 | 2.8 | -178.98 | 13.2 | 20.3 | 119.9 | 114.4 | 5.47 | 21.915 | | |
| 1,700.0 | 1,687.8 | 1,705.0 | 1,703.2 | 4.2 | 3.1 | -178.22 | 20.2 | 29.5 | 127.8 | 122.0 | 5.83 | 21.929 | | |
| 1,800.0 | 1,785.9 | 1,807.0 | 1,804.4 | 4.6 | 3.3 | -177.39 | 28.3 | 40.2 | 134.0 | 127.8 | 6.19 | 21.652 | | |
| 1,900.0 | 1,884.1 | 1,909.3 | 1,905.5 | 4.9 | 3.6 | -176.47 | 37.5 | 52.4 | 138.5 | 131.9 | 6.55 | 21.129 | | |
| 2,000.0 | 1,982.3 | 2,010.2 | 2,005.0 | 5.3 | 3.9 | -175.48 | 47.4 | 65.5 | 141.6 | 134.7 | 6.92 | 20.452 | | |
| 2,100.0 | 2,080.5 | 2,110.1 | 2,103.6 | 5.7 | 4.1 | -174.53 | 57.4 | 78.7 | 144.6 | 137.3 | 7.29 | 19.823 | | |
| 2,200.0 | 2,178.6 | 2,210.0 | 2,202.1 | 6.0 | 4.4 | -173.62 | 67.3 | 91.8 | 147.6 | 140.0 | 7.67 | 19.246 | | |
| 2,300.0 | 2,276.8 | 2,309.9 | 2,300.7 | 6.4 | 4.7 | -172.75 | 77.3 | 104.9 | 150.7 | 142.6 | 8.05 | 18.714 | | |
| 2,400.0 | 2,375.0 | 2,409.9 | 2,399.2 | 6.8 | 5.0 | -171.91 | 87.2 | 118.1 | 153.8 | 145.4 | 8.44 | 18.222 | | |
| 2,500.0 | 2,473.2 | 2,509.8 | 2,497.8 | 7.2 | 5.4 | -171.11 | 97.2 | 131.2 | 156.9 | 148.1 | 8.84 | 17.764 | | |
| 2,600.0 | 2,571.3 | 2,609.7 | 2,596.3 | 7.5 | 5.7 | -170.34 | 107.1 | 144.3 | 160.1 | 150.9 | 9.24 | 17.337 | | |
| 2,700.0 | 2,669.5 | 2,709.7 | 2,694.9 | 7.9 | 6.0 | -169.59 | 117.1 | 157.5 | 163.3 | 153.7 | 9.64 | 16.938 | | |
| 2,800.0 | 2,767.7 | 2,809.6 | 2,793.5 | 8.3 | 6.3 | -168.88 | 127.0 | 170.6 | 166.5 | 156.5 | 10.05 | 16.564 | | |
| 2,900.0 | 2,865.9 | 2,909.5 | 2,892.0 | 8.7 | 6.6 | -168.19 | 137.0 | 183.8 | 169.8 | 159.3 | 10.47 | 16.213 | | |
| 3,000.0 | 2,964.0 | 3,009.4 | 2,990.6 | 9.0 | 6.9 | -167.53 | 146.9 | 196.9 | 173.1 | 162.2 | 10.90 | 15.882 | | |
| 3,100.0 | 3,062.2 | 3,109.4 | 3,089.1 | 9.4 | 7.3 | -166.90 | 156.9 | 210.0 | 176.4 | 165.0 | 11.33 | 15.570 | | |
| 3,200.0 | 3,160.4 | 3,209.3 | 3,187.7 | 9.8 | 7.6 | -166.29 | 166.8 | 223.2 | 179.7 | 167.9 | 11.76 | 15.276 | | |
| 3,300.0 | 3,258.5 | 3,309.2 | 3,286.3 | 10.2 | 7.9 | -165.69 | 176.8 | 236.3 | 183.0 | 170.8 | 12.20 | 14.998 | | |
| 3,400.0 | 3,356.7 | 3,409.1 | 3,384.8 | 10.5 | 8.2 | -165.13 | 186.7 | 249.4 | 186.4 | 173.7 | 12.65 | 14.734 | | |
| 3,500.0 | 3,454.9 | 3,509.1 | 3,483.4 | 10.9 | 8.6 | -164.58 | 196.7 | 262.6 | 189.7 | 176.6 | 13.10 | 14.484 | | |
| 3,600.0 | 3,553.1 | 3,609.0 | 3,581.9 | 11.3 | 8.9 | -164.05 | 206.6 | 275.7 | 193.1 | 179.6 | 13.56 | 14.247 | | |
| 3,700.0 | 3,651.2 | 3,708.9 | 3,680.5 | 11.7 | 9.2 | -163.54 | 216.6 | 288.8 | 196.5 | 182.5 | 14.02 | 14.022 | | |
| 3,800.0 | 3,749.4 | 3,808.8 | 3,779.1 | 12.1 | 9.6 | -163.04 | 226.5 | 302.0 | 200.0 | 185.5 | 14.48 | 13.808 | | |
| 3,900.0 | 3,847.6 | 3,908.8 | 3,877.6 | 12.4 | 9.9 | -162.56 | 236.4 | 315.1 | 203.4 | 188.4 | 14.95 | 13.604 | | |
| 4,000.0 | 3,945.8 | 4,008.7 | 3,976.2 | 12.8 | 10.2 | -162.10 | 246.4 | 328.3 | 206.8 | 191.4 | 15.42 | 13.410 | | |
| 4,100.0 | 4,043.9 | 4,108.6 | 4,074.7 | 13.2 | 10.6 | -161.66 | 256.3 | 341.4 | 210.3 | 194.4 | 15.90 | 13.225 | | |
| 4,200.0 | 4,142.1 | 4,208.6 | 4,173.3 | 13.6 | 10.9 | -161.22 | 266.3 | 354.5 | 213.8 | 197.4 | 16.38 | 13.049 | | |
| 4,300.0 | 4,240.3 | 4,308.5 | 4,271.8 | 13.9 | 11.2 | -160.81 | 276.2 | 367.7 | 217.3 | 200.4 | 16.87 | 12.880 | | |
| 4,400.0 | 4,338.4 | 4,408.4 | 4,370.4 | 14.3 | 11.6 | -160.40 | 286.2 | 380.8 | 220.8 | 203.4 | 17.36 | 12.720 | | |
| 4,500.0 | 4,436.6 | 4,508.3 | 4,469.0 | 14.7 | 11.9 | -160.01 | 296.1 | 393.9 | 224.3 | 206.4 | 17.85 | 12.566 | | |
| 4,600.0 | 4,534.8 | 4,608.3 | 4,567.5 | 15.1 | 12.2 | -159.63 | 306.1 | 407.1 | 227.8 | 209.4 | 18.34 | 12.419 | | |
| 4,700.0 | 4,633.0 | 4,708.2 | 4,666.1 | 15.5 | 12.6 | -159.26 | 316.0 | 420.2 | 231.3 | 212.5 | 18.84 | 12.278 | | |
| 4,800.0 | 4,731.1 | 4,808.1 | 4,764.6 | 15.8 | 12.9 | -158.90 | 326.0 | 433.4 | 234.8 | 215.5 | 19.34 | 12.143 | | |
| 4,900.0 | 4,829.3 | 4,908.0 | 4,863.2 | 16.2 | 13.2 | -158.56 | 335.9 | 446.5 | 238.4 | 218.5 | 19.84 | 12.014 | | |
| 5,000.0 | 4,927.5 | 5,008.0 | 4,961.8 | 16.6 | 13.6 | -158.22 | 345.9 | 459.6 | 241.9 | 221.6 | 20.35 | 11.890 | | |
| 5,100.0 | 5,025.7 | 5,107.9 | 5,060.3 | 17.0 | 13.9 | -157.89 | 355.8 | 472.8 | 245.5 | 224.6 | 20.86 | 11.771 | | |

CC - Min centre to center distance or convergent point, SF - min separation factor, ES - min ellipse separation

Anticollision Report

| | | | |
|---------------------------|----------------------------|-------------------------------------|--------------------------------------|
| Company: | EnCana Oil & Gas (USA) Inc | Local Co-ordinate Reference: | Well Woolley-Sosa 2F-7H-E168 |
| Project: | DJ Wattenberg | TVD Reference: | WELL @ 5019.0ft (Original Well Elev) |
| Reference Site: | S7-T1N-R68W (Woolley-Sosa) | MD Reference: | WELL @ 5019.0ft (Original Well Elev) |
| Site Error: | 0.0ft | North Reference: | True |
| Reference Well: | Woolley-Sosa 2F-7H-E168 | Survey Calculation Method: | Minimum Curvature |
| Well Error: | 0.0ft | Output errors are at | 2.00 sigma |
| Reference Wellbore | HZ | Database: | USA EDM 5000 Multi Users DB |
| Reference Design: | Plan #1 | Offset TVD Reference: | Offset Datum |

| Offset Design S7-T1N-R68W (Woolley-Sosa) - Woolley-Sosa 2E-7H-E168 - HZ - Plan #1 | | | | | | | | | | | | | Offset Site Error: | 0.0 ft |
|---|---------------------------|---------------------------|---------------------------|-------------------|----------------|-----------------------------|---|---------------|----------------------------|-----------------------------|------------------------------|----------------------|--------------------|--------|
| Survey Program: O-Geolink MWD | | | | | | | | | | | | | Offset Well Error: | 0.0 ft |
| Reference | | Offset | | Semi Major Axis | | | Distance | | | | Total Uncertainty Axis | Separation Factor | Warning | |
| Measured Depth (ft) | Vertical Depth (ft) | Measured Depth (ft) | Vertical Depth (ft) | Reference (ft) | Offset (ft) | Highside Toolface (°) | Offset Wellbore Centre +N/-S (ft) | +E/-W (ft) | Between Centres (ft) | Between Ellipses (ft) | | | | |
| 5,200.0 | 5,123.8 | 5,207.8 | 5,158.9 | 17.3 | 14.2 | -157.58 | 365.8 | 485.9 | 249.1 | 227.7 | 21.37 | 11.656 | | |
| 5,300.0 | 5,222.0 | 5,307.7 | 5,257.4 | 17.7 | 14.6 | -157.27 | 375.7 | 499.0 | 252.7 | 230.8 | 21.88 | 11.546 | | |
| 5,400.0 | 5,320.2 | 5,407.7 | 5,356.0 | 18.1 | 14.9 | -156.97 | 385.7 | 512.2 | 256.2 | 233.8 | 22.40 | 11.441 | | |
| 5,500.0 | 5,418.4 | 5,507.6 | 5,454.6 | 18.5 | 15.2 | -156.68 | 395.6 | 525.3 | 259.8 | 236.9 | 22.91 | 11.339 | | |
| 5,600.0 | 5,516.5 | 5,607.5 | 5,553.1 | 18.9 | 15.6 | -156.39 | 405.5 | 538.4 | 263.4 | 240.0 | 23.43 | 11.241 | | |
| 5,700.0 | 5,614.7 | 5,707.5 | 5,651.7 | 19.2 | 15.9 | -156.12 | 415.5 | 551.6 | 267.0 | 243.1 | 23.95 | 11.147 | | |
| 5,800.0 | 5,712.9 | 5,807.4 | 5,750.2 | 19.6 | 16.2 | -155.85 | 425.4 | 564.7 | 270.6 | 246.2 | 24.48 | 11.056 | | |
| 5,900.0 | 5,811.0 | 5,907.3 | 5,848.8 | 20.0 | 16.6 | -155.59 | 435.4 | 577.9 | 274.3 | 249.3 | 25.00 | 10.969 | | |
| 6,000.0 | 5,909.2 | 6,007.2 | 5,947.3 | 20.4 | 16.9 | -155.33 | 445.3 | 591.0 | 277.9 | 252.3 | 25.53 | 10.885 | | |
| 6,100.0 | 6,007.4 | 6,107.2 | 6,045.9 | 20.8 | 17.2 | -155.08 | 455.3 | 604.1 | 281.5 | 255.4 | 26.06 | 10.803 | | |
| 6,200.0 | 6,105.6 | 6,207.1 | 6,144.5 | 21.1 | 17.6 | -154.84 | 465.2 | 617.3 | 285.1 | 258.5 | 26.59 | 10.724 | | |
| 6,300.0 | 6,203.7 | 6,307.0 | 6,243.0 | 21.5 | 17.9 | -154.60 | 475.2 | 630.4 | 288.8 | 261.7 | 27.12 | 10.648 | | |
| 6,400.0 | 6,301.9 | 6,406.9 | 6,341.6 | 21.9 | 18.2 | -154.37 | 485.1 | 643.5 | 292.4 | 264.8 | 27.65 | 10.575 | | |
| 6,500.0 | 6,400.1 | 6,506.9 | 6,440.1 | 22.3 | 18.6 | -154.15 | 495.1 | 656.7 | 296.1 | 267.9 | 28.19 | 10.504 | | |
| 6,600.0 | 6,498.3 | 6,606.8 | 6,538.7 | 22.6 | 18.9 | -153.93 | 505.0 | 669.8 | 299.7 | 271.0 | 28.72 | 10.435 | | |
| 6,700.0 | 6,596.4 | 6,706.7 | 6,637.3 | 23.0 | 19.3 | -153.72 | 515.0 | 683.0 | 303.4 | 274.1 | 29.26 | 10.369 | | |
| 6,800.0 | 6,694.6 | 6,806.7 | 6,735.8 | 23.4 | 19.6 | -153.51 | 524.9 | 696.1 | 307.0 | 277.2 | 29.79 | 10.305 | | |
| 6,900.0 | 6,792.8 | 6,906.6 | 6,834.4 | 23.8 | 19.9 | -153.31 | 534.9 | 709.2 | 310.7 | 280.4 | 30.33 | 10.242 | | |
| 7,000.0 | 6,891.0 | 7,006.5 | 6,932.9 | 24.2 | 20.3 | -153.11 | 544.8 | 722.4 | 314.4 | 283.5 | 30.87 | 10.182 | | |
| 7,100.0 | 6,989.1 | 7,106.4 | 7,031.5 | 24.5 | 20.6 | -152.91 | 554.8 | 735.5 | 318.0 | 286.6 | 31.41 | 10.123 | | |
| 7,200.0 | 7,087.3 | 7,206.4 | 7,130.1 | 24.9 | 20.9 | -152.72 | 564.7 | 748.6 | 321.7 | 289.7 | 31.96 | 10.067 | | |
| 7,300.0 | 7,185.6 | 7,305.4 | 7,228.0 | 25.3 | 21.2 | -176.22 | 566.8 | 761.7 | 325.5 | 293.6 | 31.89 | 10.205 | | |
| 7,400.0 | 7,283.8 | 7,403.0 | 7,323.6 | 25.5 | 21.3 | 134.13 | 552.2 | 774.4 | 329.4 | 298.1 | 31.30 | 10.526 | | |
| 7,500.0 | 7,379.2 | 7,500.0 | 7,414.8 | 25.6 | 21.2 | 112.93 | 521.7 | 786.6 | 333.4 | 302.9 | 30.56 | 10.911 | | |
| 7,600.0 | 7,469.1 | 7,594.7 | 7,497.6 | 25.6 | 21.1 | 103.31 | 477.4 | 797.6 | 337.3 | 307.5 | 29.81 | 11.317 | | |
| 7,700.0 | 7,550.6 | 7,689.1 | 7,571.9 | 25.6 | 20.9 | 97.90 | 420.1 | 807.5 | 340.9 | 311.8 | 29.12 | 11.706 | | |
| 7,800.0 | 7,621.2 | 7,782.8 | 7,635.4 | 25.5 | 20.8 | 94.49 | 351.9 | 816.0 | 344.1 | 315.5 | 28.58 | 12.037 | | |
| 7,900.0 | 7,678.9 | 7,875.9 | 7,686.8 | 25.4 | 20.6 | 92.26 | 274.6 | 822.8 | 346.6 | 318.4 | 28.22 | 12.281 | | |
| 8,000.0 | 7,721.9 | 7,968.7 | 7,725.0 | 25.3 | 20.5 | 90.86 | 190.4 | 827.9 | 348.5 | 320.4 | 28.07 | 12.416 | | |
| 8,100.0 | 7,748.8 | 8,061.2 | 7,749.2 | 25.3 | 20.4 | 90.13 | 101.3 | 831.2 | 349.6 | 321.5 | 28.13 | 12.431 | | |
| 8,200.0 | 7,758.9 | 8,153.6 | 7,758.8 | 25.4 | 20.5 | 89.98 | 9.4 | 832.4 | 350.0 | 321.6 | 28.40 | 12.325 | | |
| 8,255.2 | 7,759.5 | 8,207.6 | 7,759.0 | 25.4 | 20.6 | 89.91 | -44.6 | 832.5 | 350.1 | 321.3 | 28.70 | 12.196 | | |
| 8,300.0 | 7,759.0 | 8,252.5 | 7,759.0 | 25.5 | 20.7 | 90.00 | -89.4 | 832.5 | 350.0 | 320.9 | 29.02 | 12.061 | | |
| 8,400.0 | 7,759.0 | 8,352.5 | 7,759.0 | 25.8 | 21.0 | 90.00 | -189.4 | 832.5 | 350.0 | 319.9 | 30.01 | 11.661 | | |
| 8,500.0 | 7,759.0 | 8,452.5 | 7,759.0 | 26.2 | 21.5 | 90.00 | -289.4 | 832.5 | 350.0 | 318.6 | 31.37 | 11.156 | | |
| 8,600.0 | 7,759.0 | 8,559.8 | 7,759.0 | 26.7 | 22.2 | 90.00 | -396.7 | 833.1 | 349.4 | 316.3 | 33.11 | 10.554 | | |
| 8,700.0 | 7,759.0 | 8,670.7 | 7,759.0 | 27.3 | 23.1 | 90.00 | -507.5 | 837.5 | 345.4 | 310.3 | 35.17 | 9.823 | | |
| 8,800.0 | 7,759.0 | 8,770.5 | 7,759.0 | 28.0 | 24.0 | 90.00 | -607.2 | 842.7 | 340.2 | 302.8 | 37.37 | 9.104 | | |
| 8,900.0 | 7,759.0 | 8,870.4 | 7,759.0 | 28.8 | 25.0 | 90.00 | -706.9 | 847.9 | 335.0 | 295.2 | 39.75 | 8.427 | | |
| 9,000.0 | 7,759.0 | 8,970.3 | 7,759.0 | 29.7 | 26.1 | 90.00 | -806.7 | 853.2 | 329.7 | 287.4 | 42.28 | 7.798 | | |
| 9,100.0 | 7,759.0 | 9,070.1 | 7,759.0 | 30.6 | 27.2 | 90.00 | -906.4 | 858.4 | 324.5 | 279.5 | 44.95 | 7.219 | | |
| 9,200.0 | 7,759.0 | 9,170.0 | 7,759.0 | 31.7 | 28.4 | 90.00 | -1,006.1 | 863.6 | 319.3 | 271.5 | 47.73 | 6.689 | | |
| 9,300.0 | 7,759.0 | 9,269.8 | 7,759.0 | 32.7 | 29.7 | 90.00 | -1,105.9 | 868.8 | 314.0 | 263.4 | 50.60 | 6.206 | | |
| 9,400.0 | 7,759.0 | 9,369.7 | 7,759.0 | 33.9 | 31.0 | 90.00 | -1,205.6 | 874.1 | 308.8 | 255.3 | 53.54 | 5.767 | | |
| 9,500.0 | 7,759.0 | 9,462.9 | 7,759.0 | 35.1 | 32.2 | 90.00 | -1,298.7 | 878.2 | 304.3 | 247.9 | 56.45 | 5.391 | | |
| 9,596.3 | 7,759.0 | 9,550.0 | 7,759.0 | 36.3 | 33.4 | 90.00 | -1,385.8 | 879.6 | 302.9 | 243.6 | 59.25 | 5.111 | | |
| 9,600.0 | 7,759.0 | 9,553.3 | 7,759.0 | 36.3 | 33.5 | 90.00 | -1,389.1 | 879.6 | 302.9 | 243.5 | 59.36 | 5.102 | | |
| 9,700.0 | 7,759.0 | 9,651.4 | 7,759.0 | 37.6 | 34.8 | 90.00 | -1,487.2 | 878.9 | 303.5 | 241.1 | 62.44 | 4.861 | | |
| 9,800.0 | 7,759.0 | 9,751.4 | 7,759.0 | 38.9 | 36.2 | 90.00 | -1,587.2 | 878.2 | 304.3 | 238.7 | 65.59 | 4.639 | | |
| 9,900.0 | 7,759.0 | 9,851.4 | 7,759.0 | 40.3 | 37.7 | 90.00 | -1,687.2 | 877.5 | 305.0 | 236.2 | 68.78 | 4.434 | | |
| 10,000.0 | 7,759.0 | 9,951.4 | 7,759.0 | 41.6 | 39.1 | 90.00 | -1,787.2 | 876.7 | 305.7 | 233.7 | 71.99 | 4.247 | | |
| 10,100.0 | 7,759.0 | 10,051.4 | 7,759.0 | 43.1 | 40.6 | 90.00 | -1,887.2 | 876.0 | 306.4 | 231.2 | 75.23 | 4.073 | | |

CC - Min centre to center distance or convergent point, SF - min separation factor, ES - min ellipse separation

Anticollision Report

| | | | |
|---------------------------|----------------------------|-------------------------------------|--------------------------------------|
| Company: | EnCana Oil & Gas (USA) Inc | Local Co-ordinate Reference: | Well Woolley-Sosa 2F-7H-E168 |
| Project: | DJ Wattenberg | TVD Reference: | WELL @ 5019.0ft (Original Well Elev) |
| Reference Site: | S7-T1N-R68W (Woolley-Sosa) | MD Reference: | WELL @ 5019.0ft (Original Well Elev) |
| Site Error: | 0.0ft | North Reference: | True |
| Reference Well: | Woolley-Sosa 2F-7H-E168 | Survey Calculation Method: | Minimum Curvature |
| Well Error: | 0.0ft | Output errors are at | 2.00 sigma |
| Reference Wellbore | HZ | Database: | USA EDM 5000 Multi Users DB |
| Reference Design: | Plan #1 | Offset TVD Reference: | Offset Datum |

| Offset Design S7-T1N-R68W (Woolley-Sosa) - Woolley-Sosa 2E-7H-E168 - HZ - Plan #1 | | | | | | | | | | | | | Offset Site Error: | 0.0 ft |
|---|---------------------------|---------------------------|---------------------------|-------------------|----------------|-----------------------------|---|---------------|----------------------------|-----------------------------|------------------------------|----------------------|--------------------|--------|
| Survey Program: 0-Geolink MWD | | | | | | | | | | | | | Offset Well Error: | 0.0 ft |
| Reference | | Offset | | Semi Major Axis | | | Distance | | | | Total Uncertainty Axis | Separation Factor | Warning | |
| Measured Depth (ft) | Vertical Depth (ft) | Measured Depth (ft) | Vertical Depth (ft) | Reference (ft) | Offset (ft) | Highside Toolface (°) | Offset Wellbore Centre +N/-S (ft) | +E/-W (ft) | Between Centres (ft) | Between Ellipses (ft) | | | | |
| 10,200.0 | 7,759.0 | 10,151.4 | 7,759.0 | 44.5 | 42.1 | 90.00 | -1,987.2 | 875.3 | 307.2 | 228.7 | 78.49 | 3.913 | | |
| 10,300.0 | 7,759.0 | 10,251.4 | 7,759.0 | 45.9 | 43.6 | 90.00 | -2,087.2 | 874.5 | 307.9 | 226.1 | 81.78 | 3.765 | | |
| 10,400.0 | 7,759.0 | 10,351.4 | 7,759.0 | 47.4 | 45.2 | 90.00 | -2,187.2 | 873.8 | 308.6 | 223.5 | 85.08 | 3.628 | | |
| 10,500.0 | 7,759.0 | 10,451.4 | 7,759.0 | 48.9 | 46.7 | 90.00 | -2,287.2 | 873.1 | 309.3 | 221.0 | 88.39 | 3.500 | | |
| 10,600.0 | 7,759.0 | 10,551.4 | 7,759.0 | 50.4 | 48.3 | 90.00 | -2,387.2 | 872.4 | 310.1 | 218.4 | 91.72 | 3.380 | | |
| 10,700.0 | 7,759.0 | 10,651.4 | 7,759.0 | 52.0 | 49.9 | 90.00 | -2,487.2 | 871.6 | 310.8 | 215.7 | 95.07 | 3.269 | | |
| 10,800.0 | 7,759.0 | 10,751.4 | 7,759.0 | 53.5 | 51.5 | 90.00 | -2,587.2 | 870.9 | 311.5 | 213.1 | 98.42 | 3.165 | | |
| 10,900.0 | 7,759.0 | 10,851.4 | 7,759.0 | 55.0 | 53.1 | 90.00 | -2,687.1 | 870.2 | 312.3 | 210.5 | 101.79 | 3.068 | | |
| 11,000.0 | 7,759.0 | 10,951.4 | 7,759.0 | 56.6 | 54.7 | 90.00 | -2,787.1 | 869.4 | 313.0 | 207.8 | 105.17 | 2.976 | | |
| 11,100.0 | 7,759.0 | 11,051.4 | 7,759.0 | 58.2 | 56.3 | 90.00 | -2,887.1 | 868.7 | 313.7 | 205.2 | 108.55 | 2.890 | | |
| 11,200.0 | 7,759.0 | 11,151.4 | 7,759.0 | 59.8 | 58.0 | 90.00 | -2,987.1 | 868.0 | 314.4 | 202.5 | 111.94 | 2.809 | | |
| 11,300.0 | 7,759.0 | 11,251.4 | 7,759.0 | 61.4 | 59.6 | 90.00 | -3,087.1 | 867.3 | 315.2 | 199.8 | 115.34 | 2.733 | | |
| 11,400.0 | 7,759.0 | 11,351.4 | 7,759.0 | 63.0 | 61.2 | 90.00 | -3,187.1 | 866.5 | 315.9 | 197.2 | 118.74 | 2.660 | | |
| 11,500.0 | 7,759.0 | 11,451.4 | 7,759.0 | 64.6 | 62.9 | 90.00 | -3,287.1 | 865.8 | 316.6 | 194.5 | 122.15 | 2.592 | | |
| 11,600.0 | 7,759.0 | 11,551.4 | 7,759.0 | 66.2 | 64.5 | 90.00 | -3,387.1 | 865.1 | 317.4 | 191.8 | 125.57 | 2.527 | | |
| 11,700.0 | 7,759.0 | 11,651.4 | 7,759.0 | 67.8 | 66.2 | 90.00 | -3,487.1 | 864.4 | 318.1 | 189.1 | 128.99 | 2.466 | | |
| 11,800.0 | 7,759.0 | 11,751.4 | 7,759.0 | 69.5 | 67.9 | 90.00 | -3,587.1 | 863.6 | 318.8 | 186.4 | 132.42 | 2.408 | | |
| 11,900.0 | 7,759.0 | 11,851.4 | 7,759.0 | 71.1 | 69.5 | 90.00 | -3,687.1 | 862.9 | 319.5 | 183.7 | 135.85 | 2.352 | | |
| 12,000.0 | 7,759.0 | 11,951.4 | 7,759.0 | 72.7 | 71.2 | 90.00 | -3,787.1 | 862.2 | 320.3 | 181.0 | 139.28 | 2.299 | | |
| 12,100.0 | 7,759.0 | 12,051.4 | 7,759.0 | 74.4 | 72.9 | 90.00 | -3,887.1 | 861.4 | 321.0 | 178.3 | 142.72 | 2.249 | | |
| 12,200.0 | 7,759.0 | 12,151.4 | 7,759.0 | 76.1 | 74.6 | 90.00 | -3,987.1 | 860.7 | 321.7 | 175.6 | 146.16 | 2.201 | | |
| 12,300.0 | 7,759.0 | 12,251.4 | 7,759.0 | 77.7 | 76.3 | 90.00 | -4,087.1 | 860.0 | 322.4 | 172.8 | 149.60 | 2.155 | | |
| 12,400.0 | 7,759.0 | 12,351.4 | 7,759.0 | 79.4 | 77.9 | 90.00 | -4,187.1 | 859.3 | 323.2 | 170.1 | 153.05 | 2.112 | | |
| 12,500.0 | 7,759.0 | 12,451.4 | 7,759.0 | 81.0 | 79.6 | 90.00 | -4,287.1 | 858.5 | 323.9 | 167.4 | 156.50 | 2.070 | | |
| 12,600.0 | 7,759.0 | 12,551.4 | 7,759.0 | 82.7 | 81.3 | 90.00 | -4,387.1 | 857.8 | 324.6 | 164.7 | 159.95 | 2.030 | | |
| 12,700.0 | 7,759.0 | 12,651.4 | 7,759.0 | 84.4 | 83.0 | 90.00 | -4,487.1 | 857.1 | 325.4 | 162.0 | 163.40 | 1.991 | | |
| 12,800.0 | 7,759.0 | 12,751.4 | 7,759.0 | 86.1 | 84.7 | 90.00 | -4,587.0 | 856.4 | 326.1 | 159.2 | 166.86 | 1.954 | | |
| 12,900.0 | 7,759.0 | 12,851.4 | 7,759.0 | 87.7 | 86.4 | 90.00 | -4,687.0 | 855.6 | 326.8 | 156.5 | 170.32 | 1.919 | | |
| 13,000.0 | 7,759.0 | 12,951.4 | 7,759.0 | 89.4 | 88.1 | 90.00 | -4,787.0 | 854.9 | 327.5 | 153.8 | 173.78 | 1.885 | | |
| 13,100.0 | 7,759.0 | 13,051.4 | 7,759.0 | 91.1 | 89.8 | 90.00 | -4,887.0 | 854.2 | 328.3 | 151.0 | 177.24 | 1.852 | | |
| 13,200.0 | 7,759.0 | 13,151.4 | 7,759.0 | 92.8 | 91.5 | 90.00 | -4,987.0 | 853.4 | 329.0 | 148.3 | 180.70 | 1.821 | | |
| 13,300.0 | 7,759.0 | 13,251.4 | 7,759.0 | 94.5 | 93.2 | 90.00 | -5,087.0 | 852.7 | 329.7 | 145.6 | 184.17 | 1.790 | | |
| 13,400.0 | 7,759.0 | 13,351.3 | 7,759.0 | 96.2 | 94.9 | 90.00 | -5,187.0 | 852.0 | 330.4 | 142.8 | 187.64 | 1.761 | | |
| 13,500.0 | 7,759.0 | 13,451.3 | 7,759.0 | 97.9 | 96.7 | 90.00 | -5,287.0 | 851.3 | 331.2 | 140.1 | 191.11 | 1.733 | | |
| 13,600.0 | 7,759.0 | 13,551.3 | 7,759.0 | 99.6 | 98.4 | 90.00 | -5,387.0 | 850.5 | 331.9 | 137.3 | 194.58 | 1.706 | | |
| 13,700.0 | 7,759.0 | 13,651.3 | 7,759.0 | 101.3 | 100.1 | 90.00 | -5,487.0 | 849.8 | 332.6 | 134.6 | 198.05 | 1.680 | | |
| 13,800.0 | 7,759.0 | 13,751.3 | 7,759.0 | 103.0 | 101.8 | 90.00 | -5,587.0 | 849.1 | 333.4 | 131.8 | 201.52 | 1.654 | | |
| 13,900.0 | 7,759.0 | 13,851.3 | 7,759.0 | 104.7 | 103.5 | 90.00 | -5,687.0 | 848.3 | 334.1 | 129.1 | 205.00 | 1.630 | | |
| 14,000.0 | 7,759.0 | 13,951.3 | 7,759.0 | 106.4 | 105.2 | 90.00 | -5,787.0 | 847.6 | 334.8 | 126.3 | 208.47 | 1.606 | | |
| 14,100.0 | 7,759.0 | 14,051.3 | 7,759.0 | 108.1 | 106.9 | 90.00 | -5,887.0 | 846.9 | 335.5 | 123.6 | 211.95 | 1.583 | | |
| 14,200.0 | 7,759.0 | 14,151.3 | 7,759.0 | 109.8 | 108.7 | 90.00 | -5,987.0 | 846.2 | 336.3 | 120.8 | 215.42 | 1.561 | | |
| 14,300.0 | 7,759.0 | 14,251.3 | 7,759.0 | 111.5 | 110.4 | 90.00 | -6,087.0 | 845.4 | 337.0 | 118.1 | 218.90 | 1.539 | | |
| 14,400.0 | 7,759.0 | 14,351.3 | 7,759.0 | 113.2 | 112.1 | 90.00 | -6,187.0 | 844.7 | 337.7 | 115.3 | 222.38 | 1.519 | | |
| 14,500.0 | 7,759.0 | 14,451.3 | 7,759.0 | 114.9 | 113.8 | 90.00 | -6,287.0 | 844.0 | 338.5 | 112.6 | 225.86 | 1.498 Level 3 | | |
| 14,600.0 | 7,759.0 | 14,551.3 | 7,759.0 | 116.6 | 115.6 | 90.00 | -6,387.0 | 843.3 | 339.2 | 109.8 | 229.34 | 1.479 Level 3 | | |
| 14,700.0 | 7,759.0 | 14,651.3 | 7,759.0 | 118.3 | 117.3 | 90.00 | -6,486.9 | 842.5 | 339.9 | 107.1 | 232.82 | 1.460 Level 3 | | |
| 14,800.0 | 7,759.0 | 14,751.3 | 7,759.0 | 120.0 | 119.0 | 90.00 | -6,586.9 | 841.8 | 340.6 | 104.3 | 236.31 | 1.441 Level 3 | | |
| 14,900.0 | 7,759.0 | 14,851.3 | 7,759.0 | 121.8 | 120.7 | 90.00 | -6,686.9 | 841.1 | 341.4 | 101.6 | 239.79 | 1.424 Level 3 | | |
| 15,000.0 | 7,759.0 | 14,951.3 | 7,759.0 | 123.5 | 122.5 | 90.00 | -6,786.9 | 840.3 | 342.1 | 98.8 | 243.27 | 1.406 Level 3 | | |
| 15,100.0 | 7,759.0 | 15,051.3 | 7,759.0 | 125.2 | 124.2 | 90.00 | -6,886.9 | 839.6 | 342.8 | 96.1 | 246.76 | 1.389 Level 3 | | |
| 15,200.0 | 7,759.0 | 15,151.3 | 7,759.0 | 126.9 | 125.9 | 90.00 | -6,986.9 | 838.9 | 343.5 | 93.3 | 250.24 | 1.373 Level 3 | | |
| 15,300.0 | 7,759.0 | 15,251.3 | 7,759.0 | 128.6 | 127.6 | 90.00 | -7,086.9 | 838.2 | 344.3 | 90.5 | 253.73 | 1.357 Level 3 | | |

CC - Min centre to center distance or convergent point, SF - min separation factor, ES - min ellipse separation

Anticollision Report

| | | | |
|---------------------------|----------------------------|-------------------------------------|--------------------------------------|
| Company: | EnCana Oil & Gas (USA) Inc | Local Co-ordinate Reference: | Well Woolley-Sosa 2F-7H-E168 |
| Project: | DJ Wattenberg | TVD Reference: | WELL @ 5019.0ft (Original Well Elev) |
| Reference Site: | S7-T1N-R68W (Woolley-Sosa) | MD Reference: | WELL @ 5019.0ft (Original Well Elev) |
| Site Error: | 0.0ft | North Reference: | True |
| Reference Well: | Woolley-Sosa 2F-7H-E168 | Survey Calculation Method: | Minimum Curvature |
| Well Error: | 0.0ft | Output errors are at | 2.00 sigma |
| Reference Wellbore | HZ | Database: | USA EDM 5000 Multi Users DB |
| Reference Design: | Plan #1 | Offset TVD Reference: | Offset Datum |

| Offset Design | | | | | | | | | | | | | S7-T1N-R68W (Woolley-Sosa) - Woolley-Sosa 2E-7H-E168 - HZ - Plan #1 | | Offset Site Error: | | 0.0 ft |
|---------------------|---------------------|---------------------|---------------------|-----------------|-------------|-----------------------|-----------------------------------|------------|----------------------|-----------------------|------------------------|-------------------|---|--|--------------------|--|--------|
| Survey Program: | | | | | | | | | | | | | 0-Geolink MWD | | Offset Well Error: | | 0.0 ft |
| Reference | | Offset | | Semi Major Axis | | | Distance | | | | | | | | | | |
| Measured Depth (ft) | Vertical Depth (ft) | Measured Depth (ft) | Vertical Depth (ft) | Reference (ft) | Offset (ft) | Highside Toolface (°) | Offset Wellbore Centre +N/-S (ft) | +E/-W (ft) | Between Centres (ft) | Between Ellipses (ft) | Total Uncertainty Axis | Separation Factor | Warning | | | | |
| 15,400.0 | 7,759.0 | 15,351.3 | 7,759.0 | 130.4 | 129.4 | 90.00 | -7,186.9 | 837.4 | 345.0 | 87.8 | 257.22 | 1.341 | Level 3 | | | | |
| 15,500.0 | 7,759.0 | 15,451.3 | 7,759.0 | 132.1 | 131.1 | 90.00 | -7,286.9 | 836.7 | 345.7 | 85.0 | 260.70 | 1.326 | Level 3 | | | | |
| 15,600.0 | 7,759.0 | 15,551.3 | 7,759.0 | 133.8 | 132.8 | 90.00 | -7,386.9 | 836.0 | 346.5 | 82.3 | 264.19 | 1.311 | Level 3 | | | | |
| 15,700.0 | 7,759.0 | 15,651.3 | 7,759.0 | 135.5 | 134.6 | 90.00 | -7,486.9 | 835.3 | 347.2 | 79.5 | 267.68 | 1.297 | Level 3 | | | | |
| 15,800.0 | 7,759.0 | 15,751.3 | 7,759.0 | 137.2 | 136.3 | 90.00 | -7,586.9 | 834.5 | 347.9 | 76.7 | 271.17 | 1.283 | Level 3 | | | | |
| 15,900.0 | 7,759.0 | 15,851.3 | 7,759.0 | 139.0 | 138.0 | 90.00 | -7,686.9 | 833.8 | 348.6 | 74.0 | 274.66 | 1.269 | Level 3 | | | | |
| 16,000.0 | 7,759.0 | 15,951.3 | 7,759.0 | 140.7 | 139.8 | 90.00 | -7,786.9 | 833.1 | 349.4 | 71.2 | 278.15 | 1.256 | Level 3 | | | | |
| 16,087.8 | 7,759.0 | 16,034.4 | 7,759.0 | 142.2 | 141.2 | 90.00 | -7,870.0 | 832.5 | 350.0 | 68.9 | 281.13 | 1.245 | Level 2, SF | | | | |

Anticollision Report

| | | | |
|---------------------------|----------------------------|-------------------------------------|--------------------------------------|
| Company: | EnCana Oil & Gas (USA) Inc | Local Co-ordinate Reference: | Well Woolley-Sosa 2F-7H-E168 |
| Project: | DJ Wattenberg | TVD Reference: | WELL @ 5019.0ft (Original Well Elev) |
| Reference Site: | S7-T1N-R68W (Woolley-Sosa) | MD Reference: | WELL @ 5019.0ft (Original Well Elev) |
| Site Error: | 0.0ft | North Reference: | True |
| Reference Well: | Woolley-Sosa 2F-7H-E168 | Survey Calculation Method: | Minimum Curvature |
| Well Error: | 0.0ft | Output errors are at | 2.00 sigma |
| Reference Wellbore | HZ | Database: | USA EDM 5000 Multi Users DB |
| Reference Design: | Plan #1 | Offset TVD Reference: | Offset Datum |

| Offset Design S7-T1N-R68W (Woolley-Sosa) - Woolley-Sosa 2G-7H-E168 - HZ - Plan #1 | | | | | | | | | | | | | Offset Site Error: | 0.0 ft |
|---|---------------------------|---------------------------|---------------------------|-------------------|----------------|-----------------------------|---|---------------|------------------------------|----------------------|---------|-----------|--------------------|--------|
| Survey Program: O-Geolink MWD | | | | | | | | | | | | | Offset Well Error: | 0.0 ft |
| Reference | | Offset | | Semi Major Axis | | Highside Toolface (°) | Distance | | Total Uncertainty Axis | Separation Factor | Warning | | | |
| Measured Depth (ft) | Vertical Depth (ft) | Measured Depth (ft) | Vertical Depth (ft) | Reference (ft) | Offset (ft) | | Offset Wellbore Centre +N/-S (ft) | +E/-W (ft) | | | | | | |
| 0.0 | 0.0 | 0.0 | 0.0 | 0.0 | 0.0 | 140.48 | -6.0 | 5.0 | 7.8 | | | | | |
| 100.0 | 100.0 | 100.0 | 100.0 | 0.1 | 0.1 | 140.48 | -6.0 | 5.0 | 7.8 | 7.5 | 0.26 | 29.833 | | |
| 200.0 | 200.0 | 200.0 | 200.0 | 0.3 | 0.3 | 140.48 | -6.0 | 5.0 | 7.8 | 7.2 | 0.61 | 12.786 CC | | |
| 300.0 | 300.0 | 299.9 | 299.9 | 0.5 | 0.5 | 134.59 | -5.7 | 5.8 | 8.1 | 7.2 | 0.96 | 8.450 ES | | |
| 400.0 | 400.0 | 399.9 | 399.8 | 0.7 | 0.7 | 62.52 | -4.7 | 8.2 | 9.0 | 7.7 | 1.31 | 6.861 | | |
| 500.0 | 500.0 | 499.7 | 499.6 | 0.8 | 0.8 | 55.09 | -3.0 | 12.2 | 10.3 | 8.6 | 1.67 | 6.144 | | |
| 600.0 | 599.9 | 599.6 | 599.3 | 1.0 | 1.0 | 49.94 | -0.7 | 17.9 | 11.8 | 9.8 | 2.04 | 5.787 | | |
| 700.0 | 699.7 | 699.4 | 698.8 | 1.2 | 1.3 | 46.52 | 2.2 | 25.1 | 13.5 | 11.1 | 2.41 | 5.597 | | |
| 800.0 | 799.4 | 799.2 | 798.1 | 1.4 | 1.5 | 44.37 | 5.9 | 33.9 | 15.4 | 12.6 | 2.80 | 5.489 | | |
| 900.0 | 898.9 | 899.0 | 897.2 | 1.7 | 1.7 | 43.12 | 10.2 | 44.4 | 17.3 | 14.1 | 3.20 | 5.422 | | |
| 1,000.0 | 998.3 | 998.7 | 996.1 | 1.9 | 2.0 | 42.53 | 15.1 | 56.4 | 19.4 | 15.8 | 3.62 | 5.372 | | |
| 1,100.0 | 1,097.4 | 1,098.4 | 1,094.7 | 2.2 | 2.3 | 42.40 | 20.7 | 70.0 | 21.6 | 17.6 | 4.06 | 5.328 | | |
| 1,200.0 | 1,196.3 | 1,198.0 | 1,193.0 | 2.5 | 2.6 | 42.62 | 26.9 | 85.2 | 23.9 | 19.4 | 4.53 | 5.283 | | |
| 1,300.0 | 1,294.9 | 1,297.7 | 1,291.0 | 2.8 | 3.0 | 43.08 | 33.8 | 101.9 | 26.3 | 21.3 | 5.04 | 5.231 | | |
| 1,400.0 | 1,393.3 | 1,397.2 | 1,388.6 | 3.1 | 3.4 | 43.73 | 41.3 | 120.3 | 28.9 | 23.3 | 5.58 | 5.172 | | |
| 1,500.0 | 1,491.4 | 1,496.8 | 1,485.7 | 3.5 | 3.8 | 43.37 | 49.5 | 140.1 | 32.1 | 26.0 | 6.12 | 5.256 | | |
| 1,600.0 | 1,589.6 | 1,596.4 | 1,582.7 | 3.8 | 4.2 | 41.61 | 58.2 | 161.4 | 36.7 | 30.1 | 6.60 | 5.558 | | |
| 1,700.0 | 1,687.8 | 1,696.3 | 1,679.8 | 4.2 | 4.6 | 40.05 | 67.1 | 183.0 | 41.4 | 34.4 | 7.07 | 5.859 | | |
| 1,800.0 | 1,785.9 | 1,796.2 | 1,776.9 | 4.6 | 5.1 | 38.80 | 76.0 | 204.5 | 46.2 | 38.7 | 7.54 | 6.126 | | |
| 1,900.0 | 1,884.1 | 1,896.1 | 1,874.1 | 4.9 | 5.5 | 37.80 | 84.8 | 226.1 | 51.0 | 43.0 | 8.01 | 6.364 | | |
| 2,000.0 | 1,982.3 | 1,995.9 | 1,971.2 | 5.3 | 5.9 | 36.96 | 93.7 | 247.7 | 55.8 | 47.3 | 8.49 | 6.576 | | |
| 2,100.0 | 2,080.5 | 2,095.8 | 2,068.3 | 5.7 | 6.4 | 36.26 | 102.5 | 269.2 | 60.6 | 51.7 | 8.96 | 6.768 | | |
| 2,200.0 | 2,178.6 | 2,195.7 | 2,165.4 | 6.0 | 6.8 | 35.66 | 111.4 | 290.8 | 65.5 | 56.0 | 9.43 | 6.941 | | |
| 2,300.0 | 2,276.8 | 2,295.6 | 2,262.6 | 6.4 | 7.3 | 35.14 | 120.2 | 312.3 | 70.3 | 60.4 | 9.90 | 7.098 | | |
| 2,400.0 | 2,375.0 | 2,395.5 | 2,359.7 | 6.8 | 7.7 | 34.69 | 129.1 | 333.9 | 75.1 | 64.8 | 10.37 | 7.241 | | |
| 2,500.0 | 2,473.2 | 2,495.4 | 2,456.8 | 7.2 | 8.2 | 34.29 | 137.9 | 355.5 | 80.0 | 69.1 | 10.85 | 7.372 | | |
| 2,600.0 | 2,571.3 | 2,595.2 | 2,553.9 | 7.5 | 8.6 | 33.94 | 146.8 | 377.0 | 84.8 | 73.5 | 11.32 | 7.493 | | |
| 2,700.0 | 2,669.5 | 2,695.1 | 2,651.0 | 7.9 | 9.1 | 33.63 | 155.6 | 398.6 | 89.7 | 77.9 | 11.79 | 7.604 | | |
| 2,800.0 | 2,767.7 | 2,795.0 | 2,748.2 | 8.3 | 9.5 | 33.35 | 164.5 | 420.1 | 94.5 | 82.2 | 12.27 | 7.706 | | |
| 2,900.0 | 2,865.9 | 2,894.9 | 2,845.3 | 8.7 | 9.9 | 33.10 | 173.4 | 441.7 | 99.4 | 86.6 | 12.74 | 7.801 | | |
| 3,000.0 | 2,964.0 | 2,994.8 | 2,942.4 | 9.0 | 10.4 | 32.87 | 182.2 | 463.2 | 104.2 | 91.0 | 13.21 | 7.889 | | |
| 3,100.0 | 3,062.2 | 3,094.6 | 3,039.5 | 9.4 | 10.8 | 32.66 | 191.1 | 484.8 | 109.1 | 95.4 | 13.68 | 7.972 | | |
| 3,200.0 | 3,160.4 | 3,194.5 | 3,136.7 | 9.8 | 11.3 | 32.47 | 199.9 | 506.4 | 113.9 | 99.8 | 14.16 | 8.048 | | |
| 3,300.0 | 3,258.5 | 3,294.4 | 3,233.8 | 10.2 | 11.7 | 32.29 | 208.8 | 527.9 | 118.8 | 104.2 | 14.63 | 8.120 | | |
| 3,400.0 | 3,356.7 | 3,394.3 | 3,330.9 | 10.5 | 12.2 | 32.13 | 217.6 | 549.5 | 123.7 | 108.6 | 15.10 | 8.188 | | |
| 3,500.0 | 3,454.9 | 3,494.2 | 3,428.0 | 10.9 | 12.6 | 31.98 | 226.5 | 571.0 | 128.5 | 112.9 | 15.58 | 8.251 | | |
| 3,600.0 | 3,553.1 | 3,594.0 | 3,525.2 | 11.3 | 13.1 | 31.84 | 235.3 | 592.6 | 133.4 | 117.3 | 16.05 | 8.311 | | |
| 3,700.0 | 3,651.2 | 3,693.9 | 3,622.3 | 11.7 | 13.5 | 31.71 | 244.2 | 614.2 | 138.2 | 121.7 | 16.52 | 8.367 | | |
| 3,800.0 | 3,749.4 | 3,793.8 | 3,719.4 | 12.1 | 14.0 | 31.59 | 253.1 | 635.7 | 143.1 | 126.1 | 16.99 | 8.420 | | |
| 3,900.0 | 3,847.6 | 3,893.7 | 3,816.5 | 12.4 | 14.4 | 31.48 | 261.9 | 657.3 | 148.0 | 130.5 | 17.47 | 8.471 | | |
| 4,000.0 | 3,945.8 | 3,993.6 | 3,913.7 | 12.8 | 14.9 | 31.37 | 270.8 | 678.8 | 152.8 | 134.9 | 17.94 | 8.518 | | |
| 4,100.0 | 4,043.9 | 4,093.5 | 4,010.8 | 13.2 | 15.3 | 31.27 | 279.6 | 700.4 | 157.7 | 139.3 | 18.41 | 8.563 | | |
| 4,200.0 | 4,142.1 | 4,193.3 | 4,107.9 | 13.6 | 15.8 | 31.18 | 288.5 | 722.0 | 162.6 | 143.7 | 18.89 | 8.606 | | |
| 4,300.0 | 4,240.3 | 4,293.2 | 4,205.0 | 13.9 | 16.2 | 31.09 | 297.3 | 743.5 | 167.4 | 148.1 | 19.36 | 8.647 | | |
| 4,400.0 | 4,338.4 | 4,393.1 | 4,302.2 | 14.3 | 16.7 | 31.01 | 306.2 | 765.1 | 172.3 | 152.5 | 19.83 | 8.686 | | |
| 4,500.0 | 4,436.6 | 4,493.0 | 4,399.3 | 14.7 | 17.1 | 30.93 | 315.0 | 786.6 | 177.2 | 156.8 | 20.31 | 8.723 | | |
| 4,600.0 | 4,534.8 | 4,592.9 | 4,496.4 | 15.1 | 17.6 | 30.86 | 323.9 | 808.2 | 182.0 | 161.2 | 20.78 | 8.759 | | |
| 4,700.0 | 4,633.0 | 4,692.7 | 4,593.5 | 15.5 | 18.0 | 30.79 | 332.8 | 829.7 | 186.9 | 165.6 | 21.25 | 8.793 | | |
| 4,800.0 | 4,731.1 | 4,792.6 | 4,690.7 | 15.8 | 18.5 | 30.72 | 341.6 | 851.3 | 191.8 | 170.0 | 21.73 | 8.825 | | |
| 4,900.0 | 4,829.3 | 4,892.5 | 4,787.8 | 16.2 | 18.9 | 30.66 | 350.5 | 872.9 | 196.6 | 174.4 | 22.20 | 8.856 | | |
| 5,000.0 | 4,927.5 | 4,992.4 | 4,884.9 | 16.6 | 19.4 | 30.60 | 359.3 | 894.4 | 201.5 | 178.8 | 22.67 | 8.886 | | |
| 5,100.0 | 5,025.7 | 5,092.3 | 4,982.0 | 17.0 | 19.8 | 30.54 | 368.2 | 916.0 | 206.4 | 183.2 | 23.15 | 8.914 | | |

CC - Min centre to center distance or convergent point, SF - min separation factor, ES - min ellipse separation

Anticollision Report

| | | | |
|---------------------------|----------------------------|-------------------------------------|--------------------------------------|
| Company: | EnCana Oil & Gas (USA) Inc | Local Co-ordinate Reference: | Well Woolley-Sosa 2F-7H-E168 |
| Project: | DJ Wattenberg | TVD Reference: | WELL @ 5019.0ft (Original Well Elev) |
| Reference Site: | S7-T1N-R68W (Woolley-Sosa) | MD Reference: | WELL @ 5019.0ft (Original Well Elev) |
| Site Error: | 0.0ft | North Reference: | True |
| Reference Well: | Woolley-Sosa 2F-7H-E168 | Survey Calculation Method: | Minimum Curvature |
| Well Error: | 0.0ft | Output errors are at | 2.00 sigma |
| Reference Wellbore | HZ | Database: | USA EDM 5000 Multi Users DB |
| Reference Design: | Plan #1 | Offset TVD Reference: | Offset Datum |

| Offset Design S7-T1N-R68W (Woolley-Sosa) - Woolley-Sosa 2G-7H-E168 - HZ - Plan #1 | | | | | | | | | | | | Offset Site Error: | 0.0 ft |
|---|---------------------|---------------------|---------------------|-----------------|-------------|-----------------------|-----------------------------------|------------|----------------------|-----------------------|------------------|--------------------|--------|
| Survey Program: O-Geolink MWD | | | | | | | | | | | | Offset Well Error: | 0.0 ft |
| Reference | | Offset | | Semi Major Axis | | Distance | | Total | | Separation | | Warning | |
| Measured Depth (ft) | Vertical Depth (ft) | Measured Depth (ft) | Vertical Depth (ft) | Reference (ft) | Offset (ft) | Highside Toolface (°) | Offset Wellbore Centre +N/-S (ft) | +E/-W (ft) | Between Centres (ft) | Between Ellipses (ft) | Uncertainty Axis | Factor | |
| 5,200.0 | 5,123.8 | 5,192.1 | 5,079.1 | 17.3 | 20.3 | 30.49 | 377.0 | 937.5 | 211.2 | 187.6 | 23.62 | 8.942 | |
| 5,300.0 | 5,222.0 | 5,292.0 | 5,176.3 | 17.7 | 20.7 | 30.44 | 385.9 | 959.1 | 216.1 | 192.0 | 24.10 | 8.968 | |
| 5,400.0 | 5,320.2 | 5,391.9 | 5,273.4 | 18.1 | 21.2 | 30.39 | 394.7 | 980.7 | 221.0 | 196.4 | 24.57 | 8.993 | |
| 5,500.0 | 5,418.4 | 5,491.8 | 5,370.5 | 18.5 | 21.6 | 30.34 | 403.6 | 1,002.2 | 225.8 | 200.8 | 25.04 | 9.018 | |
| 5,600.0 | 5,516.5 | 5,591.7 | 5,467.6 | 18.9 | 22.1 | 30.29 | 412.5 | 1,023.8 | 230.7 | 205.2 | 25.52 | 9.041 | |
| 5,700.0 | 5,614.7 | 5,691.6 | 5,564.8 | 19.2 | 22.5 | 30.25 | 421.3 | 1,045.3 | 235.6 | 209.6 | 25.99 | 9.064 | |
| 5,800.0 | 5,712.9 | 5,791.4 | 5,661.9 | 19.6 | 23.0 | 30.21 | 430.2 | 1,066.9 | 240.4 | 214.0 | 26.46 | 9.086 | |
| 5,900.0 | 5,811.0 | 5,891.3 | 5,759.0 | 20.0 | 23.4 | 30.17 | 439.0 | 1,088.4 | 245.3 | 218.4 | 26.94 | 9.107 | |
| 6,000.0 | 5,909.2 | 5,991.2 | 5,866.1 | 20.4 | 23.9 | 30.13 | 447.9 | 1,110.0 | 250.2 | 222.8 | 27.41 | 9.127 | |
| 6,100.0 | 6,007.4 | 6,091.1 | 5,953.3 | 20.8 | 24.3 | 30.09 | 456.7 | 1,131.6 | 255.0 | 227.2 | 27.88 | 9.146 | |
| 6,200.0 | 6,105.6 | 6,191.0 | 6,050.4 | 21.1 | 24.8 | 30.06 | 465.6 | 1,153.1 | 259.9 | 231.5 | 28.36 | 9.165 | |
| 6,300.0 | 6,203.7 | 6,290.8 | 6,147.5 | 21.5 | 25.2 | 30.02 | 474.4 | 1,174.7 | 264.8 | 235.9 | 28.83 | 9.184 | |
| 6,400.0 | 6,301.9 | 6,390.7 | 6,244.6 | 21.9 | 25.7 | 29.99 | 483.3 | 1,196.2 | 269.6 | 240.3 | 29.30 | 9.201 | |
| 6,500.0 | 6,400.1 | 6,490.6 | 6,341.8 | 22.3 | 26.1 | 29.96 | 492.2 | 1,217.8 | 274.5 | 244.7 | 29.78 | 9.219 | |
| 6,600.0 | 6,498.3 | 6,590.5 | 6,438.9 | 22.6 | 26.6 | 29.92 | 501.0 | 1,239.4 | 279.4 | 249.1 | 30.25 | 9.235 | |
| 6,700.0 | 6,596.4 | 6,690.4 | 6,536.0 | 23.0 | 27.0 | 29.89 | 509.9 | 1,260.9 | 284.3 | 253.5 | 30.73 | 9.251 | |
| 6,800.0 | 6,694.6 | 6,790.2 | 6,633.1 | 23.4 | 27.5 | 29.87 | 518.7 | 1,282.5 | 289.1 | 257.9 | 31.20 | 9.267 | |
| 6,900.0 | 6,792.8 | 6,890.1 | 6,730.3 | 23.8 | 27.9 | 29.84 | 527.6 | 1,304.0 | 294.0 | 262.3 | 31.67 | 9.282 | |
| 7,000.0 | 6,891.0 | 6,990.0 | 6,827.4 | 24.2 | 28.4 | 29.81 | 536.4 | 1,325.6 | 298.9 | 266.7 | 32.15 | 9.297 | |
| 7,100.0 | 6,989.1 | 7,089.9 | 6,924.5 | 24.5 | 28.8 | 29.78 | 545.3 | 1,347.2 | 303.7 | 271.1 | 32.62 | 9.311 | |
| 7,200.0 | 7,087.3 | 7,189.8 | 7,021.6 | 24.9 | 29.3 | 29.76 | 554.1 | 1,368.7 | 308.6 | 275.5 | 33.09 | 9.325 | |
| 7,300.0 | 7,185.6 | 7,289.6 | 7,118.7 | 25.3 | 29.7 | 7.23 | 563.0 | 1,390.3 | 313.4 | 279.9 | 33.49 | 9.359 | |
| 7,400.0 | 7,283.8 | 7,388.3 | 7,214.8 | 25.5 | 30.1 | -42.43 | 567.9 | 1,411.6 | 318.1 | 285.2 | 33.82 | 9.692 | |
| 7,500.0 | 7,379.2 | 7,488.5 | 7,311.9 | 25.6 | 30.4 | -63.89 | 566.4 | 1,433.2 | 323.1 | 291.3 | 31.83 | 10.151 | |
| 7,600.0 | 7,469.1 | 7,591.2 | 7,407.8 | 25.6 | 30.7 | -73.87 | 527.0 | 1,454.4 | 328.3 | 297.6 | 30.77 | 10.671 | |
| 7,700.0 | 7,550.6 | 7,696.4 | 7,499.1 | 25.6 | 30.8 | -79.70 | 479.1 | 1,474.7 | 333.6 | 303.8 | 29.79 | 11.197 | |
| 7,800.0 | 7,621.2 | 7,804.1 | 7,582.1 | 25.5 | 30.8 | -83.59 | 413.3 | 1,493.1 | 338.5 | 309.5 | 29.00 | 11.673 | |
| 7,900.0 | 7,678.9 | 7,914.1 | 7,653.0 | 25.4 | 30.8 | -86.31 | 330.8 | 1,508.9 | 342.9 | 314.4 | 28.47 | 12.045 | |
| 8,000.0 | 7,721.9 | 8,026.3 | 7,708.0 | 25.3 | 30.8 | -88.19 | 234.1 | 1,521.1 | 346.4 | 318.2 | 28.22 | 12.277 | |
| 8,100.0 | 7,748.8 | 8,140.1 | 7,744.1 | 25.3 | 30.8 | -89.39 | 126.6 | 1,529.1 | 348.8 | 320.6 | 28.24 | 12.352 | |
| 8,200.0 | 7,758.9 | 8,254.9 | 7,758.7 | 25.4 | 30.9 | -89.97 | 12.9 | 1,532.3 | 349.9 | 321.4 | 28.52 | 12.269 | |
| 8,300.0 | 7,759.0 | 8,357.3 | 7,759.0 | 25.5 | 31.0 | -90.00 | -89.4 | 1,532.4 | 350.0 | 320.8 | 29.14 | 12.008 | |
| 8,400.0 | 7,759.0 | 8,457.3 | 7,759.0 | 25.8 | 31.2 | -90.00 | -189.4 | 1,532.4 | 350.0 | 319.8 | 30.14 | 11.612 | |
| 8,500.0 | 7,759.0 | 8,557.3 | 7,759.0 | 26.2 | 31.5 | -90.00 | -289.4 | 1,532.4 | 350.0 | 318.5 | 31.49 | 11.113 | |
| 8,600.0 | 7,759.0 | 8,657.3 | 7,759.0 | 26.7 | 31.9 | -90.00 | -389.4 | 1,532.4 | 350.0 | 316.8 | 33.16 | 10.553 | |
| 8,700.0 | 7,759.0 | 8,757.3 | 7,759.0 | 27.3 | 32.4 | -90.00 | -489.4 | 1,532.4 | 350.0 | 314.9 | 35.11 | 9.968 | |
| 8,800.0 | 7,759.0 | 8,857.3 | 7,759.0 | 28.0 | 33.0 | -90.00 | -589.4 | 1,532.4 | 350.0 | 312.7 | 37.28 | 9.387 | |
| 8,900.0 | 7,759.0 | 8,957.3 | 7,759.0 | 28.8 | 33.6 | -90.00 | -689.4 | 1,532.4 | 350.0 | 310.3 | 39.64 | 8.827 | |
| 9,000.0 | 7,759.0 | 9,057.3 | 7,759.0 | 29.7 | 34.4 | -90.00 | -789.4 | 1,532.4 | 350.0 | 307.8 | 42.17 | 8.299 | |
| 9,100.0 | 7,759.0 | 9,157.3 | 7,759.0 | 30.6 | 35.2 | -90.00 | -889.4 | 1,532.4 | 350.0 | 305.1 | 44.83 | 7.807 | |
| 9,200.0 | 7,759.0 | 9,257.3 | 7,759.0 | 31.7 | 36.1 | -90.00 | -989.4 | 1,532.4 | 350.0 | 302.4 | 47.59 | 7.353 | |
| 9,300.0 | 7,759.0 | 9,357.3 | 7,759.0 | 32.7 | 37.0 | -90.00 | -1,089.4 | 1,532.4 | 350.0 | 299.5 | 50.46 | 6.936 | |
| 9,400.0 | 7,759.0 | 9,457.3 | 7,759.0 | 33.9 | 38.0 | -90.00 | -1,189.4 | 1,532.4 | 350.0 | 296.6 | 53.39 | 6.554 | |
| 9,500.0 | 7,759.0 | 9,557.3 | 7,759.0 | 35.1 | 39.0 | -90.00 | -1,289.4 | 1,532.4 | 350.0 | 293.6 | 56.40 | 6.205 | |
| 9,600.0 | 7,759.0 | 9,657.3 | 7,759.0 | 36.3 | 40.2 | -90.00 | -1,389.4 | 1,532.4 | 350.0 | 290.5 | 59.45 | 5.886 | |
| 9,700.0 | 7,759.0 | 9,757.3 | 7,759.0 | 37.6 | 41.3 | -90.00 | -1,489.4 | 1,532.4 | 350.0 | 287.4 | 62.56 | 5.594 | |
| 9,800.0 | 7,759.0 | 9,857.3 | 7,759.0 | 38.9 | 42.5 | -90.00 | -1,589.4 | 1,532.4 | 350.0 | 284.3 | 65.71 | 5.326 | |
| 9,900.0 | 7,759.0 | 9,957.3 | 7,759.0 | 40.3 | 43.7 | -90.00 | -1,689.4 | 1,532.4 | 350.0 | 281.1 | 68.89 | 5.080 | |
| 10,000.0 | 7,759.0 | 10,057.3 | 7,759.0 | 41.6 | 45.0 | -90.00 | -1,789.4 | 1,532.4 | 350.0 | 277.9 | 72.10 | 4.854 | |
| 10,100.0 | 7,759.0 | 10,157.3 | 7,759.0 | 43.1 | 46.3 | -90.00 | -1,889.4 | 1,532.4 | 350.0 | 274.6 | 75.34 | 4.645 | |
| 10,200.0 | 7,759.0 | 10,257.3 | 7,759.0 | 44.5 | 47.6 | -90.00 | -1,989.4 | 1,532.4 | 350.0 | 271.4 | 78.60 | 4.453 | |
| 10,300.0 | 7,759.0 | 10,357.3 | 7,759.0 | 45.9 | 49.0 | -90.00 | -2,089.4 | 1,532.4 | 350.0 | 268.1 | 81.88 | 4.274 | |

CC - Min centre to center distance or convergent point, SF - min separation factor, ES - min ellipse separation

Anticollision Report

| | | | |
|---------------------------|----------------------------|-------------------------------------|--------------------------------------|
| Company: | EnCana Oil & Gas (USA) Inc | Local Co-ordinate Reference: | Well Woolley-Sosa 2F-7H-E168 |
| Project: | DJ Wattenberg | TVD Reference: | WELL @ 5019.0ft (Original Well Elev) |
| Reference Site: | S7-T1N-R68W (Woolley-Sosa) | MD Reference: | WELL @ 5019.0ft (Original Well Elev) |
| Site Error: | 0.0ft | North Reference: | True |
| Reference Well: | Woolley-Sosa 2F-7H-E168 | Survey Calculation Method: | Minimum Curvature |
| Well Error: | 0.0ft | Output errors are at | 2.00 sigma |
| Reference Wellbore | HZ | Database: | USA EDM 5000 Multi Users DB |
| Reference Design: | Plan #1 | Offset TVD Reference: | Offset Datum |

| Offset Design S7-T1N-R68W (Woolley-Sosa) - Woolley-Sosa 2G-7H-E168 - HZ - Plan #1 | | | | | | | | | | | | | Offset Site Error: | 0.0 ft |
|---|---------------------------|---------------------------|---------------------------|-------------------|----------------|-----------------------------|---|---------------|----------------------------|-----------------------------|------------------------------|----------------------|--------------------|--------|
| Survey Program: 0-Geolink MWD | | | | | | | | | | | | | Offset Well Error: | 0.0 ft |
| Reference | | Offset | | Semi Major Axis | | | Distance | | | | Total Uncertainty Axis | Separation Factor | Warning | |
| Measured Depth (ft) | Vertical Depth (ft) | Measured Depth (ft) | Vertical Depth (ft) | Reference (ft) | Offset (ft) | Highside Toolface (°) | Offset Wellbore Centre +N/-S (ft) | +E/-W (ft) | Between Centres (ft) | Between Ellipses (ft) | | | | |
| 10,400.0 | 7,759.0 | 10,457.3 | 7,759.0 | 47.4 | 50.4 | -90.00 | -2,189.4 | 1,532.4 | 350.0 | 264.8 | 85.18 | 4.109 | | |
| 10,500.0 | 7,759.0 | 10,557.3 | 7,759.0 | 48.9 | 51.8 | -90.00 | -2,289.4 | 1,532.4 | 350.0 | 261.5 | 88.49 | 3.955 | | |
| 10,600.0 | 7,759.0 | 10,657.3 | 7,759.0 | 50.4 | 53.2 | -90.00 | -2,389.4 | 1,532.4 | 350.0 | 258.1 | 91.82 | 3.811 | | |
| 10,700.0 | 7,759.0 | 10,757.3 | 7,759.0 | 52.0 | 54.6 | -90.00 | -2,489.4 | 1,532.4 | 350.0 | 254.8 | 95.17 | 3.677 | | |
| 10,800.0 | 7,759.0 | 10,857.3 | 7,759.0 | 53.5 | 56.1 | -90.00 | -2,589.4 | 1,532.4 | 350.0 | 251.4 | 98.52 | 3.552 | | |
| 10,900.0 | 7,759.0 | 10,957.3 | 7,759.0 | 55.0 | 57.6 | -90.00 | -2,689.4 | 1,532.4 | 350.0 | 248.1 | 101.89 | 3.435 | | |
| 11,000.0 | 7,759.0 | 11,057.3 | 7,759.0 | 56.6 | 59.1 | -90.00 | -2,789.4 | 1,532.4 | 350.0 | 244.7 | 105.26 | 3.325 | | |
| 11,100.0 | 7,759.0 | 11,157.3 | 7,759.0 | 58.2 | 60.6 | -90.00 | -2,889.4 | 1,532.4 | 350.0 | 241.3 | 108.64 | 3.221 | | |
| 11,200.0 | 7,759.0 | 11,257.3 | 7,759.0 | 59.8 | 62.1 | -90.00 | -2,989.4 | 1,532.4 | 350.0 | 237.9 | 112.03 | 3.124 | | |
| 11,300.0 | 7,759.0 | 11,357.3 | 7,759.0 | 61.4 | 63.6 | -90.00 | -3,089.4 | 1,532.4 | 350.0 | 234.5 | 115.43 | 3.032 | | |
| 11,400.0 | 7,759.0 | 11,457.3 | 7,759.0 | 63.0 | 65.2 | -90.00 | -3,189.4 | 1,532.4 | 350.0 | 231.1 | 118.83 | 2.945 | | |
| 11,500.0 | 7,759.0 | 11,557.3 | 7,759.0 | 64.6 | 66.7 | -90.00 | -3,289.4 | 1,532.4 | 350.0 | 227.7 | 122.24 | 2.863 | | |
| 11,600.0 | 7,759.0 | 11,657.3 | 7,759.0 | 66.2 | 68.3 | -90.00 | -3,389.4 | 1,532.4 | 350.0 | 224.3 | 125.66 | 2.785 | | |
| 11,700.0 | 7,759.0 | 11,757.3 | 7,759.0 | 67.8 | 69.9 | -90.00 | -3,489.4 | 1,532.4 | 350.0 | 220.9 | 129.08 | 2.711 | | |
| 11,800.0 | 7,759.0 | 11,857.3 | 7,759.0 | 69.5 | 71.4 | -90.00 | -3,589.4 | 1,532.4 | 350.0 | 217.5 | 132.50 | 2.641 | | |
| 11,900.0 | 7,759.0 | 11,957.3 | 7,759.0 | 71.1 | 73.0 | -90.00 | -3,689.4 | 1,532.4 | 350.0 | 214.0 | 135.93 | 2.575 | | |
| 12,000.0 | 7,759.0 | 12,057.3 | 7,759.0 | 72.7 | 74.6 | -90.00 | -3,789.4 | 1,532.4 | 350.0 | 210.6 | 139.36 | 2.511 | | |
| 12,100.0 | 7,759.0 | 12,157.3 | 7,759.0 | 74.4 | 76.2 | -90.00 | -3,889.4 | 1,532.4 | 350.0 | 207.2 | 142.80 | 2.451 | | |
| 12,200.0 | 7,759.0 | 12,257.3 | 7,759.0 | 76.1 | 77.9 | -90.00 | -3,989.4 | 1,532.4 | 350.0 | 203.7 | 146.24 | 2.393 | | |
| 12,300.0 | 7,759.0 | 12,357.3 | 7,759.0 | 77.7 | 79.5 | -90.00 | -4,089.4 | 1,532.4 | 350.0 | 200.3 | 149.68 | 2.338 | | |
| 12,400.0 | 7,759.0 | 12,457.3 | 7,759.0 | 79.4 | 81.1 | -90.00 | -4,189.4 | 1,532.4 | 350.0 | 196.8 | 153.13 | 2.285 | | |
| 12,500.0 | 7,759.0 | 12,557.3 | 7,759.0 | 81.0 | 82.7 | -90.00 | -4,289.4 | 1,532.4 | 350.0 | 193.4 | 156.58 | 2.235 | | |
| 12,600.0 | 7,759.0 | 12,657.3 | 7,759.0 | 82.7 | 84.4 | -90.00 | -4,389.4 | 1,532.4 | 350.0 | 189.9 | 160.03 | 2.187 | | |
| 12,700.0 | 7,759.0 | 12,757.3 | 7,759.0 | 84.4 | 86.0 | -90.00 | -4,489.4 | 1,532.4 | 350.0 | 186.5 | 163.48 | 2.141 | | |
| 12,800.0 | 7,759.0 | 12,857.3 | 7,759.0 | 86.1 | 87.6 | -90.00 | -4,589.4 | 1,532.4 | 350.0 | 183.0 | 166.94 | 2.096 | | |
| 12,900.0 | 7,759.0 | 12,957.3 | 7,759.0 | 87.7 | 89.3 | -90.00 | -4,689.4 | 1,532.4 | 350.0 | 179.6 | 170.40 | 2.054 | | |
| 13,000.0 | 7,759.0 | 13,057.3 | 7,759.0 | 89.4 | 90.9 | -90.00 | -4,789.4 | 1,532.4 | 350.0 | 176.1 | 173.86 | 2.013 | | |
| 13,100.0 | 7,759.0 | 13,157.3 | 7,759.0 | 91.1 | 92.6 | -90.00 | -4,889.4 | 1,532.4 | 350.0 | 172.6 | 177.32 | 1.974 | | |
| 13,200.0 | 7,759.0 | 13,257.3 | 7,759.0 | 92.8 | 94.2 | -90.00 | -4,989.4 | 1,532.4 | 350.0 | 169.2 | 180.78 | 1.936 | | |
| 13,300.0 | 7,759.0 | 13,357.3 | 7,759.0 | 94.5 | 95.9 | -90.00 | -5,089.4 | 1,532.4 | 350.0 | 165.7 | 184.25 | 1.899 | | |
| 13,400.0 | 7,759.0 | 13,457.3 | 7,759.0 | 96.2 | 97.6 | -90.00 | -5,189.4 | 1,532.4 | 350.0 | 162.2 | 187.72 | 1.864 | | |
| 13,500.0 | 7,759.0 | 13,557.3 | 7,759.0 | 97.9 | 99.2 | -90.00 | -5,289.4 | 1,532.4 | 350.0 | 158.8 | 191.18 | 1.830 | | |
| 13,600.0 | 7,759.0 | 13,657.3 | 7,759.0 | 99.6 | 100.9 | -90.00 | -5,389.4 | 1,532.4 | 350.0 | 155.3 | 194.65 | 1.798 | | |
| 13,700.0 | 7,759.0 | 13,757.3 | 7,759.0 | 101.3 | 102.6 | -90.00 | -5,489.4 | 1,532.4 | 350.0 | 151.8 | 198.13 | 1.766 | | |
| 13,800.0 | 7,759.0 | 13,857.3 | 7,759.0 | 103.0 | 104.3 | -90.00 | -5,589.4 | 1,532.4 | 350.0 | 148.4 | 201.60 | 1.736 | | |
| 13,900.0 | 7,759.0 | 13,957.3 | 7,759.0 | 104.7 | 105.9 | -90.00 | -5,689.4 | 1,532.4 | 350.0 | 144.9 | 205.07 | 1.707 | | |
| 14,000.0 | 7,759.0 | 14,057.3 | 7,759.0 | 106.4 | 107.6 | -90.00 | -5,789.4 | 1,532.4 | 350.0 | 141.4 | 208.55 | 1.678 | | |
| 14,100.0 | 7,759.0 | 14,157.3 | 7,759.0 | 108.1 | 109.3 | -90.00 | -5,889.4 | 1,532.4 | 350.0 | 137.9 | 212.02 | 1.651 | | |
| 14,200.0 | 7,759.0 | 14,257.3 | 7,759.0 | 109.8 | 111.0 | -90.00 | -5,989.4 | 1,532.4 | 350.0 | 134.5 | 215.50 | 1.624 | | |
| 14,300.0 | 7,759.0 | 14,357.3 | 7,759.0 | 111.5 | 112.7 | -90.00 | -6,089.4 | 1,532.4 | 350.0 | 131.0 | 218.98 | 1.598 | | |
| 14,400.0 | 7,759.0 | 14,457.3 | 7,759.0 | 113.2 | 114.4 | -90.00 | -6,189.4 | 1,532.4 | 350.0 | 127.5 | 222.46 | 1.573 | | |
| 14,500.0 | 7,759.0 | 14,557.3 | 7,759.0 | 114.9 | 116.1 | -90.00 | -6,289.4 | 1,532.4 | 350.0 | 124.0 | 225.94 | 1.549 | | |
| 14,600.0 | 7,759.0 | 14,657.3 | 7,759.0 | 116.6 | 117.8 | -90.00 | -6,389.4 | 1,532.4 | 350.0 | 120.5 | 229.42 | 1.525 | | |
| 14,700.0 | 7,759.0 | 14,757.3 | 7,759.0 | 118.3 | 119.5 | -90.00 | -6,489.4 | 1,532.4 | 350.0 | 117.1 | 232.90 | 1.503 | | |
| 14,800.0 | 7,759.0 | 14,857.3 | 7,759.0 | 120.0 | 121.2 | -90.00 | -6,589.4 | 1,532.4 | 350.0 | 113.6 | 236.38 | 1.480 Level 3 | | |
| 14,900.0 | 7,759.0 | 14,957.3 | 7,759.0 | 121.8 | 122.9 | -90.00 | -6,689.4 | 1,532.4 | 350.0 | 110.1 | 239.86 | 1.459 Level 3 | | |
| 15,000.0 | 7,759.0 | 15,057.3 | 7,759.0 | 123.5 | 124.6 | -90.00 | -6,789.4 | 1,532.4 | 350.0 | 106.6 | 243.35 | 1.438 Level 3 | | |
| 15,100.0 | 7,759.0 | 15,157.3 | 7,759.0 | 125.2 | 126.3 | -90.00 | -6,889.4 | 1,532.4 | 350.0 | 103.1 | 246.83 | 1.418 Level 3 | | |
| 15,200.0 | 7,759.0 | 15,257.3 | 7,759.0 | 126.9 | 128.0 | -90.00 | -6,989.4 | 1,532.4 | 350.0 | 99.6 | 250.32 | 1.398 Level 3 | | |
| 15,300.0 | 7,759.0 | 15,357.3 | 7,759.0 | 128.6 | 129.7 | -90.00 | -7,089.4 | 1,532.4 | 350.0 | 96.2 | 253.80 | 1.379 Level 3 | | |
| 15,400.0 | 7,759.0 | 15,457.3 | 7,759.0 | 130.4 | 131.4 | -90.00 | -7,189.4 | 1,532.4 | 350.0 | 92.7 | 257.29 | 1.360 Level 3 | | |
| 15,500.0 | 7,759.0 | 15,557.3 | 7,759.0 | 132.1 | 133.1 | -90.00 | -7,289.4 | 1,532.4 | 350.0 | 89.2 | 260.78 | 1.342 Level 3 | | |

CC - Min centre to center distance or convergent point, SF - min separation factor, ES - min ellipse separation

Anticollision Report

| | | | |
|---------------------------|----------------------------|-------------------------------------|--------------------------------------|
| Company: | EnCana Oil & Gas (USA) Inc | Local Co-ordinate Reference: | Well Woolley-Sosa 2F-7H-E168 |
| Project: | DJ Wattenberg | TVD Reference: | WELL @ 5019.0ft (Original Well Elev) |
| Reference Site: | S7-T1N-R68W (Woolley-Sosa) | MD Reference: | WELL @ 5019.0ft (Original Well Elev) |
| Site Error: | 0.0ft | North Reference: | True |
| Reference Well: | Woolley-Sosa 2F-7H-E168 | Survey Calculation Method: | Minimum Curvature |
| Well Error: | 0.0ft | Output errors are at | 2.00 sigma |
| Reference Wellbore | HZ | Database: | USA EDM 5000 Multi Users DB |
| Reference Design: | Plan #1 | Offset TVD Reference: | Offset Datum |

| Offset Design | | | | | | | | | | | S7-T1N-R68W (Woolley-Sosa) - Woolley-Sosa 2G-7H-E168 - HZ - Plan #1 | | | Offset Site Error: | | 0.0 ft |
|-----------------|----------------|----------------|----------------|-----------------|--------|-------------------|------------------------------|---------|-----------------|------------------|---|-------------------|-------------|--------------------|--|--------|
| Survey Program: | | | | | | | | | | | 0-Geolink MWD | | | Offset Well Error: | | 0.0 ft |
| Reference | | Offset | | Semi Major Axis | | | Distance | | | | | | | | | |
| Measured Depth | Vertical Depth | Measured Depth | Vertical Depth | Reference | Offset | Highside Toolface | Offset Wellbore Centre +N/-S | +E/-W | Between Centres | Between Ellipses | Total Uncertainty Axis | Separation Factor | Warning | | | |
| (ft) | (ft) | (ft) | (ft) | (ft) | (ft) | (°) | (ft) | (ft) | (ft) | (ft) | | | | | | |
| 15,600.0 | 7,759.0 | 15,657.3 | 7,759.0 | 133.8 | 134.8 | -90.00 | -7,389.4 | 1,532.4 | 350.0 | 85.7 | 264.27 | 1.324 | Level 3 | | | |
| 15,700.0 | 7,759.0 | 15,757.3 | 7,759.0 | 135.5 | 136.5 | -90.00 | -7,489.4 | 1,532.4 | 350.0 | 82.2 | 267.75 | 1.307 | Level 3 | | | |
| 15,800.0 | 7,759.0 | 15,857.3 | 7,759.0 | 137.2 | 138.2 | -90.00 | -7,589.4 | 1,532.4 | 350.0 | 78.7 | 271.24 | 1.290 | Level 3 | | | |
| 15,900.0 | 7,759.0 | 15,957.3 | 7,759.0 | 139.0 | 139.9 | -90.00 | -7,689.4 | 1,532.4 | 350.0 | 75.2 | 274.73 | 1.274 | Level 3 | | | |
| 16,000.0 | 7,759.0 | 16,057.3 | 7,759.0 | 140.7 | 141.6 | -90.00 | -7,789.4 | 1,532.4 | 350.0 | 71.7 | 278.22 | 1.258 | Level 3 | | | |
| 16,087.8 | 7,759.0 | 16,145.1 | 7,759.0 | 142.2 | 143.1 | -90.00 | -7,877.2 | 1,532.4 | 350.0 | 68.7 | 281.29 | 1.244 | Level 2, SF | | | |

Anticollision Report

| | | | |
|---------------------------|----------------------------|-------------------------------------|--------------------------------------|
| Company: | EnCana Oil & Gas (USA) Inc | Local Co-ordinate Reference: | Well Woolley-Sosa 2F-7H-E168 |
| Project: | DJ Wattenberg | TVD Reference: | WELL @ 5019.0ft (Original Well Elev) |
| Reference Site: | S7-T1N-R68W (Woolley-Sosa) | MD Reference: | WELL @ 5019.0ft (Original Well Elev) |
| Site Error: | 0.0ft | North Reference: | True |
| Reference Well: | Woolley-Sosa 2F-7H-E168 | Survey Calculation Method: | Minimum Curvature |
| Well Error: | 0.0ft | Output errors are at | 2.00 sigma |
| Reference Wellbore | HZ | Database: | USA EDM 5000 Multi Users DB |
| Reference Design: | Plan #1 | Offset TVD Reference: | Offset Datum |

Reference Depths are relative to WELL @ 5019.0ft (Original Well Elev)

Offset Depths are relative to Offset Datum

Central Meridian is -105.500000 °

Coordinates are relative to: Woolley-Sosa 2F-7H-E168

Coordinate System is US State Plane 1983, Colorado Northern Zone

Grid Convergence at Surface is: 0.29°

