

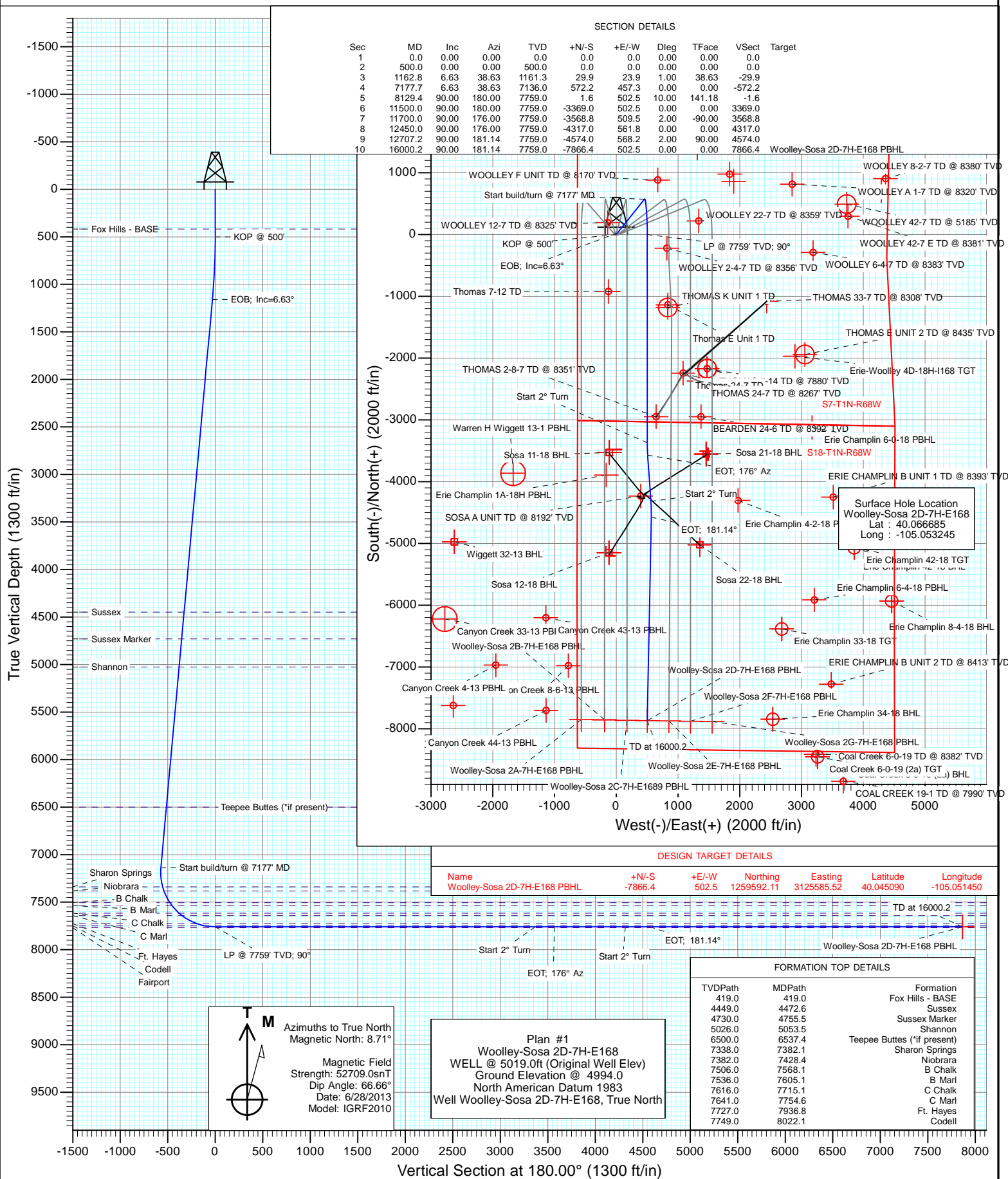

Project: DJ Wattenberg  
Site: S7-T1N-R68W (Woolley-Sosa/Becky)  
Well: Woolley-Sosa 2D-7H-E168  
Wellbore: HZ  
Design: Plan #1



## Planning Report

<b>Database:</b>	USA EDM 5000 Multi Users DB	<b>Local Co-ordinate Reference:</b>	Well Woolley-Sosa 2D-7H-E168
<b>Company:</b>	EnCana Oil & Gas (USA) Inc	<b>TVD Reference:</b>	WELL @ 5019.0ft (Original Well Elev)
<b>Project:</b>	DJ Wattenberg	<b>MD Reference:</b>	WELL @ 5019.0ft (Original Well Elev)
<b>Site:</b>	S7-T1N-R68W (Woolley-Sosa/Becky)	<b>North Reference:</b>	True
<b>Well:</b>	Woolley-Sosa 2D-7H-E168	<b>Survey Calculation Method:</b>	Minimum Curvature
<b>Wellbore:</b>	HZ		
<b>Design:</b>	Plan #1		

<b>Project</b>	DJ Wattenberg		
<b>Map System:</b>	US State Plane 1983	<b>System Datum:</b>	Mean Sea Level
<b>Geo Datum:</b>	North American Datum 1983		
<b>Map Zone:</b>	Colorado Northern Zone		

Site		S7-T1N-R68W (Woolley-Sosa/Becky)			
Site Position:		Northing:	1,265,219.42 ft	Latitude:	40.060530
From:	Lat/Long	Easting:	3,126,139.27 ft	Longitude:	-105.049370
Position Uncertainty:	0.0 ft	Slot Radius:	13.200 in	Grid Convergence:	0.29 °

Well	Woolley-Sosa 2D-7H-E168					
Well Position	+N/-S	0.0 ft	Northing:	1,267,455.90 ft	Latitude:	40.066685
	+E/-W	0.0 ft	Easting:	3,125,043.39 ft	Longitude:	-105.053245
Position Uncertainty		0.0 ft	Wellhead Elevation:	ft	Ground Level:	4,994.0 ft

<b>Wellbore</b>	HZ				
<b>Magnetics</b>	<b>Model Name</b>	<b>Sample Date</b>	<b>Declination</b>	<b>Dip Angle</b>	<b>Field Strength</b>
			(°)	(°)	(nT)
	IGRF2010	6/28/2013	8.71	66.66	52,709

<b>Design</b>	Plan #1			
<b>Audit Notes:</b>				
<b>Version:</b>	<b>Phase:</b>	PLAN	<b>Tie On Depth:</b>	0.0
<b>Vertical Section:</b>	<b>Depth From (TVD)</b>	<b>+N/-S</b>	<b>+E/-W</b>	<b>Direction</b>
	(ft)	(ft)	(ft)	(°)
	0.0	0.0	0.0	180.00

<b>Plan Sections</b>										
Measured Depth (ft)	Inclination (°)	Azimuth (°)	Vertical Depth (ft)	+N/-S (ft)	+E/-W (ft)	Dogleg Rate (°/100ft)	Build Rate (°/100ft)	Turn Rate (°/100ft)	TFO (°)	Target
0.0	0.00	0.00	0.0	0.0	0.0	0.00	0.00	0.00	0.00	
500.0	0.00	0.00	500.0	0.0	0.0	0.00	0.00	0.00	0.00	
1,162.8	6.63	38.63	1,161.3	29.9	23.9	1.00	1.00	0.00	38.63	
7,177.7	6.63	38.63	7,136.0	572.2	457.3	0.00	0.00	0.00	0.00	
8,129.4	90.00	180.00	7,759.0	1.6	502.5	10.00	8.76	14.85	141.18	
11,500.0	90.00	180.00	7,759.0	-3,369.0	502.5	0.00	0.00	0.00	0.00	
11,700.0	90.00	176.00	7,759.0	-3,568.8	509.5	2.00	0.00	-2.00	-90.00	
12,450.0	90.00	176.00	7,759.0	-4,317.0	561.8	0.00	0.00	0.00	0.00	
12,707.2	90.00	181.14	7,759.0	-4,574.0	568.2	2.00	0.00	2.00	90.00	
16,000.2	90.00	181.14	7,759.0	-7,866.4	502.5	0.00	0.00	0.00	0.00	Woolley-Sosa 2D-7H-

# Planning Report

<b>Database:</b>	USA EDM 5000 Multi Users DB	<b>Local Co-ordinate Reference:</b>	Well Woolley-Sosa 2D-7H-E168
<b>Company:</b>	EnCana Oil & Gas (USA) Inc	<b>TVD Reference:</b>	WELL @ 5019.0ft (Original Well Elev)
<b>Project:</b>	DJ Wattenberg	<b>MD Reference:</b>	WELL @ 5019.0ft (Original Well Elev)
<b>Site:</b>	S7-T1N-R68W (Woolley-Sosa/Becky)	<b>North Reference:</b>	True
<b>Well:</b>	Woolley-Sosa 2D-7H-E168	<b>Survey Calculation Method:</b>	Minimum Curvature
<b>Wellbore:</b>	HZ		
<b>Design:</b>	Plan #1		

## Planned Survey

Measured Depth (ft)	Inclination (°)	Azimuth (°)	Vertical Depth (ft)	+N/-S (ft)	+E/-W (ft)	Vertical Section (ft)	Dogleg Rate (°/100ft)	Build Rate (°/100ft)	Comments / Formations
0.0	0.00	0.00	0.0	0.0	0.0	0.0	0.00	0.00	
100.0	0.00	0.00	100.0	0.0	0.0	0.0	0.00	0.00	
200.0	0.00	0.00	200.0	0.0	0.0	0.0	0.00	0.00	
300.0	0.00	0.00	300.0	0.0	0.0	0.0	0.00	0.00	
400.0	0.00	0.00	400.0	0.0	0.0	0.0	0.00	0.00	
419.0	0.00	0.00	419.0	0.0	0.0	0.0	0.00	0.00	Fox Hills - BASE
500.0	0.00	0.00	500.0	0.0	0.0	0.0	0.00	0.00	KOP @ 500'
600.0	1.00	38.63	600.0	0.7	0.5	-0.7	1.00	1.00	
700.0	2.00	38.63	700.0	2.7	2.2	-2.7	1.00	1.00	
800.0	3.00	38.63	799.9	6.1	4.9	-6.1	1.00	1.00	
900.0	4.00	38.63	899.7	10.9	8.7	-10.9	1.00	1.00	
1,000.0	5.00	38.63	999.4	17.0	13.6	-17.0	1.00	1.00	
1,100.0	6.00	38.63	1,098.9	24.5	19.6	-24.5	1.00	1.00	
1,162.8	6.63	38.63	1,161.3	29.9	23.9	-29.9	1.00	1.00	EOB; Inc=6.63°
1,200.0	6.63	38.63	1,198.3	33.3	26.6	-33.3	0.00	0.00	
1,300.0	6.63	38.63	1,297.6	42.3	33.8	-42.3	0.00	0.00	
1,400.0	6.63	38.63	1,396.9	51.3	41.0	-51.3	0.00	0.00	
1,500.0	6.63	38.63	1,496.3	60.3	48.2	-60.3	0.00	0.00	
1,600.0	6.63	38.63	1,595.6	69.3	55.4	-69.3	0.00	0.00	
1,700.0	6.63	38.63	1,694.9	78.3	62.6	-78.3	0.00	0.00	
1,800.0	6.63	38.63	1,794.3	87.4	69.8	-87.4	0.00	0.00	
1,900.0	6.63	38.63	1,893.6	96.4	77.0	-96.4	0.00	0.00	
2,000.0	6.63	38.63	1,992.9	105.4	84.2	-105.4	0.00	0.00	
2,100.0	6.63	38.63	2,092.3	114.4	91.4	-114.4	0.00	0.00	
2,200.0	6.63	38.63	2,191.6	123.4	98.6	-123.4	0.00	0.00	
2,300.0	6.63	38.63	2,290.9	132.4	105.9	-132.4	0.00	0.00	
2,400.0	6.63	38.63	2,390.3	141.5	113.1	-141.5	0.00	0.00	
2,500.0	6.63	38.63	2,489.6	150.5	120.3	-150.5	0.00	0.00	
2,600.0	6.63	38.63	2,588.9	159.5	127.5	-159.5	0.00	0.00	
2,700.0	6.63	38.63	2,688.3	168.5	134.7	-168.5	0.00	0.00	
2,800.0	6.63	38.63	2,787.6	177.5	141.9	-177.5	0.00	0.00	
2,900.0	6.63	38.63	2,886.9	186.5	149.1	-186.5	0.00	0.00	
3,000.0	6.63	38.63	2,986.2	195.6	156.3	-195.6	0.00	0.00	
3,100.0	6.63	38.63	3,085.6	204.6	163.5	-204.6	0.00	0.00	
3,200.0	6.63	38.63	3,184.9	213.6	170.7	-213.6	0.00	0.00	
3,300.0	6.63	38.63	3,284.2	222.6	177.9	-222.6	0.00	0.00	
3,400.0	6.63	38.63	3,383.6	231.6	185.1	-231.6	0.00	0.00	
3,500.0	6.63	38.63	3,482.9	240.6	192.3	-240.6	0.00	0.00	
3,600.0	6.63	38.63	3,582.2	249.6	199.5	-249.6	0.00	0.00	
3,700.0	6.63	38.63	3,681.6	258.7	206.7	-258.7	0.00	0.00	
3,800.0	6.63	38.63	3,780.9	267.7	213.9	-267.7	0.00	0.00	
3,900.0	6.63	38.63	3,880.2	276.7	221.1	-276.7	0.00	0.00	
4,000.0	6.63	38.63	3,979.6	285.7	228.3	-285.7	0.00	0.00	
4,100.0	6.63	38.63	4,078.9	294.7	235.6	-294.7	0.00	0.00	
4,200.0	6.63	38.63	4,178.2	303.7	242.8	-303.7	0.00	0.00	
4,300.0	6.63	38.63	4,277.6	312.8	250.0	-312.8	0.00	0.00	
4,400.0	6.63	38.63	4,376.9	321.8	257.2	-321.8	0.00	0.00	
4,472.6	6.63	38.63	4,449.0	328.3	262.4	-328.3	0.00	0.00	Sussex
4,500.0	6.63	38.63	4,476.2	330.8	264.4	-330.8	0.00	0.00	
4,600.0	6.63	38.63	4,575.6	339.8	271.6	-339.8	0.00	0.00	
4,700.0	6.63	38.63	4,674.9	348.8	278.8	-348.8	0.00	0.00	
4,755.5	6.63	38.63	4,730.0	353.8	282.8	-353.8	0.00	0.00	Sussex Marker

# Planning Report

<b>Database:</b>	USA EDM 5000 Multi Users DB	<b>Local Co-ordinate Reference:</b>	Well Woolley-Sosa 2D-7H-E168
<b>Company:</b>	EnCana Oil & Gas (USA) Inc	<b>TVD Reference:</b>	WELL @ 5019.0ft (Original Well Elev)
<b>Project:</b>	DJ Wattenberg	<b>MD Reference:</b>	WELL @ 5019.0ft (Original Well Elev)
<b>Site:</b>	S7-T1N-R68W (Woolley-Sosa/Becky)	<b>North Reference:</b>	True
<b>Well:</b>	Woolley-Sosa 2D-7H-E168	<b>Survey Calculation Method:</b>	Minimum Curvature
<b>Wellbore:</b>	HZ		
<b>Design:</b>	Plan #1		

Planned Survey									
Measured Depth (ft)	Inclination (°)	Azimuth (°)	Vertical Depth (ft)	+N/-S (ft)	+E/-W (ft)	Vertical Section (ft)	Dogleg Rate (°/100ft)	Build Rate (°/100ft)	Comments / Formations
4,800.0	6.63	38.63	4,774.2	357.8	286.0	-357.8	0.00	0.00	
4,900.0	6.63	38.63	4,873.5	366.8	293.2	-366.8	0.00	0.00	
5,000.0	6.63	38.63	4,972.9	375.9	300.4	-375.9	0.00	0.00	
5,053.5	6.63	38.63	5,026.0	380.7	304.3	-380.7	0.00	0.00	Shannon
5,100.0	6.63	38.63	5,072.2	384.9	307.6	-384.9	0.00	0.00	
5,200.0	6.63	38.63	5,171.5	393.9	314.8	-393.9	0.00	0.00	
5,300.0	6.63	38.63	5,270.9	402.9	322.0	-402.9	0.00	0.00	
5,400.0	6.63	38.63	5,370.2	411.9	329.2	-411.9	0.00	0.00	
5,500.0	6.63	38.63	5,469.5	420.9	336.4	-420.9	0.00	0.00	
5,600.0	6.63	38.63	5,568.9	430.0	343.6	-430.0	0.00	0.00	
5,700.0	6.63	38.63	5,668.2	439.0	350.8	-439.0	0.00	0.00	
5,800.0	6.63	38.63	5,767.5	448.0	358.0	-448.0	0.00	0.00	
5,900.0	6.63	38.63	5,866.9	457.0	365.3	-457.0	0.00	0.00	
6,000.0	6.63	38.63	5,966.2	466.0	372.5	-466.0	0.00	0.00	
6,100.0	6.63	38.63	6,065.5	475.0	379.7	-475.0	0.00	0.00	
6,200.0	6.63	38.63	6,164.9	484.1	386.9	-484.1	0.00	0.00	
6,300.0	6.63	38.63	6,264.2	493.1	394.1	-493.1	0.00	0.00	
6,400.0	6.63	38.63	6,363.5	502.1	401.3	-502.1	0.00	0.00	
6,500.0	6.63	38.63	6,462.9	511.1	408.5	-511.1	0.00	0.00	
6,537.4	6.63	38.63	6,500.0	514.5	411.2	-514.5	0.00	0.00	Teepee Buttes (*if present)
6,600.0	6.63	38.63	6,562.2	520.1	415.7	-520.1	0.00	0.00	
6,700.0	6.63	38.63	6,661.5	529.1	422.9	-529.1	0.00	0.00	
6,800.0	6.63	38.63	6,760.9	538.1	430.1	-538.1	0.00	0.00	
6,900.0	6.63	38.63	6,860.2	547.2	437.3	-547.2	0.00	0.00	
7,000.0	6.63	38.63	6,959.5	556.2	444.5	-556.2	0.00	0.00	
7,100.0	6.63	38.63	7,058.8	565.2	451.7	-565.2	0.00	0.00	
7,177.7	6.63	38.63	7,136.0	572.2	457.3	-572.2	0.00	0.00	Start build/turn @ 7177' MD
7,200.0	5.08	54.61	7,158.2	573.8	458.9	-573.8	10.00	-6.92	
7,300.0	8.18	149.70	7,257.8	570.2	466.1	-570.2	10.00	3.10	
7,382.1	15.81	165.15	7,338.0	554.3	472.0	-554.3	10.00	9.29	Sharon Springs
7,400.0	17.54	166.73	7,355.2	549.3	473.2	-549.3	10.00	9.68	
7,428.4	20.30	168.69	7,382.0	540.3	475.2	-540.3	10.00	9.75	Niobrara
7,500.0	27.35	171.94	7,447.5	511.8	479.9	-511.8	10.00	9.83	
7,568.1	34.09	173.85	7,506.0	477.3	484.2	-477.3	10.00	9.90	B Chalk
7,600.0	37.26	174.53	7,531.9	458.8	486.0	-458.8	10.00	9.92	
7,605.1	37.77	174.63	7,536.0	455.7	486.3	-455.7	10.00	9.93	B Marl
7,700.0	47.20	176.15	7,605.9	391.9	491.4	-391.9	10.00	9.94	
7,715.1	48.70	176.35	7,616.0	380.7	492.1	-380.7	10.00	9.95	C Chalk
7,754.6	52.63	176.82	7,641.0	350.3	493.9	-350.3	10.00	9.96	C Marl
7,800.0	57.16	177.32	7,667.1	313.1	495.8	-313.1	10.00	9.96	
7,900.0	67.12	178.25	7,713.8	224.9	499.2	-224.9	10.00	9.97	
7,936.8	70.79	178.55	7,727.0	190.6	500.2	-190.6	10.00	9.97	Ft. Hayes
8,000.0	77.09	179.05	7,744.5	129.9	501.5	-129.9	10.00	9.97	
8,022.1	79.29	179.21	7,749.0	108.3	501.8	-108.3	10.00	9.97	Codell
8,100.0	87.07	179.79	7,758.2	31.0	502.5	-31.0	10.00	9.97	
8,129.4	90.00	180.00	7,759.0	1.6	502.5	-1.6	10.00	9.97	LP @ 7759' TVD; 90°
8,200.0	90.00	180.00	7,759.0	-69.0	502.5	69.0	0.00	0.00	
8,300.0	90.00	180.00	7,759.0	-169.0	502.5	169.0	0.00	0.00	
8,400.0	90.00	180.00	7,759.0	-269.0	502.5	269.0	0.00	0.00	
8,500.0	90.00	180.00	7,759.0	-369.0	502.5	369.0	0.00	0.00	
8,600.0	90.00	180.00	7,759.0	-469.0	502.5	469.0	0.00	0.00	
8,700.0	90.00	180.00	7,759.0	-569.0	502.5	569.0	0.00	0.00	

# Planning Report

<b>Database:</b>	USA EDM 5000 Multi Users DB	<b>Local Co-ordinate Reference:</b>	Well Woolley-Sosa 2D-7H-E168
<b>Company:</b>	EnCana Oil & Gas (USA) Inc	<b>TVD Reference:</b>	WELL @ 5019.0ft (Original Well Elev)
<b>Project:</b>	DJ Wattenberg	<b>MD Reference:</b>	WELL @ 5019.0ft (Original Well Elev)
<b>Site:</b>	S7-T1N-R68W (Woolley-Sosa/Becky)	<b>North Reference:</b>	True
<b>Well:</b>	Woolley-Sosa 2D-7H-E168	<b>Survey Calculation Method:</b>	Minimum Curvature
<b>Wellbore:</b>	HZ		
<b>Design:</b>	Plan #1		

Planned Survey									
Measured Depth (ft)	Inclination (°)	Azimuth (°)	Vertical Depth (ft)	+N/-S (ft)	+E/-W (ft)	Vertical Section (ft)	Dogleg Rate (°/100ft)	Build Rate (°/100ft)	Comments / Formations
8,800.0	90.00	180.00	7,759.0	-669.0	502.5	669.0	0.00	0.00	
8,900.0	90.00	180.00	7,759.0	-769.0	502.5	769.0	0.00	0.00	
9,000.0	90.00	180.00	7,759.0	-869.0	502.5	869.0	0.00	0.00	
9,100.0	90.00	180.00	7,759.0	-969.0	502.5	969.0	0.00	0.00	
9,200.0	90.00	180.00	7,759.0	-1,069.0	502.5	1,069.0	0.00	0.00	
9,300.0	90.00	180.00	7,759.0	-1,169.0	502.5	1,169.0	0.00	0.00	
9,400.0	90.00	180.00	7,759.0	-1,269.0	502.5	1,269.0	0.00	0.00	
9,500.0	90.00	180.00	7,759.0	-1,369.0	502.5	1,369.0	0.00	0.00	
9,600.0	90.00	180.00	7,759.0	-1,469.0	502.5	1,469.0	0.00	0.00	
9,700.0	90.00	180.00	7,759.0	-1,569.0	502.5	1,569.0	0.00	0.00	
9,800.0	90.00	180.00	7,759.0	-1,669.0	502.5	1,669.0	0.00	0.00	
9,900.0	90.00	180.00	7,759.0	-1,769.0	502.5	1,769.0	0.00	0.00	
10,000.0	90.00	180.00	7,759.0	-1,869.0	502.5	1,869.0	0.00	0.00	
10,100.0	90.00	180.00	7,759.0	-1,969.0	502.5	1,969.0	0.00	0.00	
10,200.0	90.00	180.00	7,759.0	-2,069.0	502.5	2,069.0	0.00	0.00	
10,300.0	90.00	180.00	7,759.0	-2,169.0	502.5	2,169.0	0.00	0.00	
10,400.0	90.00	180.00	7,759.0	-2,269.0	502.5	2,269.0	0.00	0.00	
10,500.0	90.00	180.00	7,759.0	-2,369.0	502.5	2,369.0	0.00	0.00	
10,600.0	90.00	180.00	7,759.0	-2,469.0	502.5	2,469.0	0.00	0.00	
10,700.0	90.00	180.00	7,759.0	-2,569.0	502.5	2,569.0	0.00	0.00	
10,800.0	90.00	180.00	7,759.0	-2,669.0	502.5	2,669.0	0.00	0.00	
10,900.0	90.00	180.00	7,759.0	-2,769.0	502.5	2,769.0	0.00	0.00	
11,000.0	90.00	180.00	7,759.0	-2,869.0	502.5	2,869.0	0.00	0.00	
11,100.0	90.00	180.00	7,759.0	-2,969.0	502.5	2,969.0	0.00	0.00	
11,200.0	90.00	180.00	7,759.0	-3,069.0	502.5	3,069.0	0.00	0.00	
11,300.0	90.00	180.00	7,759.0	-3,169.0	502.5	3,169.0	0.00	0.00	
11,400.0	90.00	180.00	7,759.0	-3,269.0	502.5	3,269.0	0.00	0.00	
11,500.0	90.00	180.00	7,759.0	-3,369.0	502.5	3,369.0	0.00	0.00	Start 2° Turn
11,600.0	90.00	178.00	7,759.0	-3,469.0	504.3	3,469.0	2.00	0.00	
11,700.0	90.00	176.00	7,759.0	-3,568.8	509.5	3,568.8	2.00	0.00	EOT; 176° Az
11,800.0	90.00	176.00	7,759.0	-3,668.6	516.5	3,668.6	0.00	0.00	
11,900.0	90.00	176.00	7,759.0	-3,768.4	523.4	3,768.4	0.00	0.00	
12,000.0	90.00	176.00	7,759.0	-3,868.1	530.4	3,868.1	0.00	0.00	
12,100.0	90.00	176.00	7,759.0	-3,967.9	537.4	3,967.9	0.00	0.00	
12,200.0	90.00	176.00	7,759.0	-4,067.6	544.4	4,067.6	0.00	0.00	
12,300.0	90.00	176.00	7,759.0	-4,167.4	551.3	4,167.4	0.00	0.00	
12,400.0	90.00	176.00	7,759.0	-4,267.1	558.3	4,267.1	0.00	0.00	
12,450.0	90.00	176.00	7,759.0	-4,317.0	561.8	4,317.0	0.00	0.00	Start 2° Turn
12,500.0	90.00	177.00	7,759.0	-4,366.9	564.9	4,366.9	2.00	0.00	
12,600.0	90.00	179.00	7,759.0	-4,466.9	568.3	4,466.9	2.00	0.00	
12,700.0	90.00	181.00	7,759.0	-4,566.8	568.3	4,566.8	2.00	0.00	
12,707.2	90.00	181.14	7,759.0	-4,574.0	568.2	4,574.0	1.99	0.00	EOT; 181.14°
12,800.0	90.00	181.14	7,759.0	-4,666.8	566.4	4,666.8	0.00	0.00	
12,900.0	90.00	181.14	7,759.0	-4,766.8	564.4	4,766.8	0.00	0.00	
13,000.0	90.00	181.14	7,759.0	-4,866.8	562.4	4,866.8	0.00	0.00	
13,100.0	90.00	181.14	7,759.0	-4,966.8	560.4	4,966.8	0.00	0.00	
13,200.0	90.00	181.14	7,759.0	-5,066.7	558.4	5,066.7	0.00	0.00	
13,300.0	90.00	181.14	7,759.0	-5,166.7	556.4	5,166.7	0.00	0.00	
13,400.0	90.00	181.14	7,759.0	-5,266.7	554.4	5,266.7	0.00	0.00	
13,500.0	90.00	181.14	7,759.0	-5,366.7	552.4	5,366.7	0.00	0.00	
13,600.0	90.00	181.14	7,759.0	-5,466.7	550.4	5,466.7	0.00	0.00	
13,700.0	90.00	181.14	7,759.0	-5,566.6	548.4	5,566.6	0.00	0.00	

## Planning Report

<b>Database:</b>	USA EDM 5000 Multi Users DB	<b>Local Co-ordinate Reference:</b>	Well Woolley-Sosa 2D-7H-E168
<b>Company:</b>	EnCana Oil & Gas (USA) Inc	<b>TVD Reference:</b>	WELL @ 5019.0ft (Original Well Elev)
<b>Project:</b>	DJ Wattenberg	<b>MD Reference:</b>	WELL @ 5019.0ft (Original Well Elev)
<b>Site:</b>	S7-T1N-R68W (Woolley-Sosa/Becky)	<b>North Reference:</b>	True
<b>Well:</b>	Woolley-Sosa 2D-7H-E168	<b>Survey Calculation Method:</b>	Minimum Curvature
<b>Wellbore:</b>	HZ		
<b>Design:</b>	Plan #1		

Planned Survey									
Measured Depth (ft)	Inclination (°)	Azimuth (°)	Vertical Depth (ft)	+N/-S (ft)	+E/-W (ft)	Vertical Section (ft)	Dogleg Rate (°/100ft)	Build Rate (°/100ft)	Comments / Formations
13,800.0	90.00	181.14	7,759.0	-5,666.6	546.4	5,666.6	0.00	0.00	
13,900.0	90.00	181.14	7,759.0	-5,766.6	544.4	5,766.6	0.00	0.00	
14,000.0	90.00	181.14	7,759.0	-5,866.6	542.4	5,866.6	0.00	0.00	
14,100.0	90.00	181.14	7,759.0	-5,966.6	540.4	5,966.6	0.00	0.00	
14,200.0	90.00	181.14	7,759.0	-6,066.5	538.4	6,066.5	0.00	0.00	
14,300.0	90.00	181.14	7,759.0	-6,166.5	536.4	6,166.5	0.00	0.00	
14,400.0	90.00	181.14	7,759.0	-6,266.5	534.4	6,266.5	0.00	0.00	
14,500.0	90.00	181.14	7,759.0	-6,366.5	532.4	6,366.5	0.00	0.00	
14,600.0	90.00	181.14	7,759.0	-6,466.5	530.4	6,466.5	0.00	0.00	
14,700.0	90.00	181.14	7,759.0	-6,566.4	528.5	6,566.4	0.00	0.00	
14,800.0	90.00	181.14	7,759.0	-6,666.4	526.5	6,666.4	0.00	0.00	
14,900.0	90.00	181.14	7,759.0	-6,766.4	524.5	6,766.4	0.00	0.00	
15,000.0	90.00	181.14	7,759.0	-6,866.4	522.5	6,866.4	0.00	0.00	
15,100.0	90.00	181.14	7,759.0	-6,966.4	520.5	6,966.4	0.00	0.00	
15,200.0	90.00	181.14	7,759.0	-7,066.4	518.5	7,066.4	0.00	0.00	
15,300.0	90.00	181.14	7,759.0	-7,166.3	516.5	7,166.3	0.00	0.00	
15,400.0	90.00	181.14	7,759.0	-7,266.3	514.5	7,266.3	0.00	0.00	
15,500.0	90.00	181.14	7,759.0	-7,366.3	512.5	7,366.3	0.00	0.00	
15,600.0	90.00	181.14	7,759.0	-7,466.3	510.5	7,466.3	0.00	0.00	
15,700.0	90.00	181.14	7,759.0	-7,566.3	508.5	7,566.3	0.00	0.00	
15,800.0	90.00	181.14	7,759.0	-7,666.2	506.5	7,666.2	0.00	0.00	
15,900.0	90.00	181.14	7,759.0	-7,766.2	504.5	7,766.2	0.00	0.00	
16,000.0	90.00	181.14	7,759.0	-7,866.2	502.5	7,866.2	0.00	0.00	
16,000.2	90.00	181.14	7,759.0	-7,866.4	502.5	7,866.4	0.00	0.00	TD at 16000.2 - Woolley-Sosa 2D-7H-E168 PBI

Targets									
Target Name	Dip Angle (°)	Dip Dir. (°)	TVD (ft)	+N/-S (ft)	+E/-W (ft)	Northing (ft)	Easting (ft)	Latitude	Longitude
Woolley-Sosa 2D-7H-E1	0.00	0.00	7,759.0	-7,866.4	502.5	1,259,592.11	3,125,585.52	40.045090	-105.051450
- hit/miss target									
- Shape									
- plan hits target center									
- Point									

## Planning Report

<b>Database:</b>	USA EDM 5000 Multi Users DB	<b>Local Co-ordinate Reference:</b>	Well Woolley-Sosa 2D-7H-E168
<b>Company:</b>	EnCana Oil & Gas (USA) Inc	<b>TVD Reference:</b>	WELL @ 5019.0ft (Original Well Elev)
<b>Project:</b>	DJ Wattenberg	<b>MD Reference:</b>	WELL @ 5019.0ft (Original Well Elev)
<b>Site:</b>	S7-T1N-R68W (Woolley-Sosa/Becky)	<b>North Reference:</b>	True
<b>Well:</b>	Woolley-Sosa 2D-7H-E168	<b>Survey Calculation Method:</b>	Minimum Curvature
<b>Wellbore:</b>	HZ		
<b>Design:</b>	Plan #1		

### Formations

Measured Depth (ft)	Vertical Depth (ft)	Name	Lithology	Dip (°)	Dip Direction (°)
419.0	419.0	Fox Hills - BASE			
4,472.6	4,449.0	Sussex			
4,755.5	4,730.0	Sussex Marker			
5,053.5	5,026.0	Shannon			
6,537.4	6,500.0	Teepee Buttes (*if present)			
7,382.1	7,338.0	Sharon Springs			
7,428.4	7,382.0	Niobrara			
7,568.1	7,506.0	B Chalk			
7,605.1	7,536.0	B Marl			
7,715.1	7,616.0	C Chalk			
7,754.6	7,641.0	C Marl			
7,936.8	7,727.0	Ft. Hayes			
8,022.1	7,749.0	Codell			

### Plan Annotations

Measured Depth (ft)	Vertical Depth (ft)	Local Coordinates		Comment
		+N/-S (ft)	+E/-W (ft)	
500.0	500.0	0.0	0.0	KOP @ 500'
1,162.8	1,161.3	29.9	23.9	EOB; Inc=6.63°
7,177.7	7,136.0	572.2	457.3	Start build/turn @ 7177' MD
8,129.4	7,759.0	1.6	502.5	LP @ 7759' TVD; 90°
11,500.0	7,759.0	-3,369.0	502.5	Start 2° Turn
11,700.0	7,759.0	-3,568.8	509.5	EOT; 176° Az
12,450.0	7,759.0	-4,317.0	561.8	Start 2° Turn
12,707.2	7,759.0	-4,574.0	568.2	EOT; 181.14°
16,000.2	7,759.0	-7,866.4	502.5	TD at 16000.2

# **EnCana Oil & Gas (USA) Inc**

**DJ Wattenberg**

**S7-T1N-R68W (Woolley-Sosa/Becky)**

**Woolley-Sosa 2D-7H-E168**

**HZ**

**Plan #1**

## **Anticollision Report**

**22 July, 2013**



## Anticollision Report

<b>Company:</b>	EnCana Oil & Gas (USA) Inc	<b>Local Co-ordinate Reference:</b>	Well Woolley-Sosa 2D-7H-E168
<b>Project:</b>	DJ Wattenberg	<b>TVD Reference:</b>	WELL @ 5019.0ft (Original Well Elev)
<b>Reference Site:</b>	S7-T1N-R68W (Woolley-Sosa/Becky)	<b>MD Reference:</b>	WELL @ 5019.0ft (Original Well Elev)
<b>Site Error:</b>	0.0ft	<b>North Reference:</b>	True
<b>Reference Well:</b>	Woolley-Sosa 2D-7H-E168	<b>Survey Calculation Method:</b>	Minimum Curvature
<b>Well Error:</b>	0.0ft	<b>Output errors are at</b>	2.00 sigma
<b>Reference Wellbore</b>	HZ	<b>Database:</b>	USA EDM 5000 Multi Users DB
<b>Reference Design:</b>	Plan #1	<b>Offset TVD Reference:</b>	Offset Datum

<b>Reference</b>	Plan #1		
<b>Filter type:</b>	NO GLOBAL FILTER: Using user defined selection & filtering criteria		
<b>Interpolation Method:</b>	MD Interval 100.0ft	<b>Error Model:</b>	Systematic Ellipse
<b>Depth Range:</b>	Unlimited	<b>Scan Method:</b>	Closest Approach 3D
<b>Results Limited by:</b>	Maximum center-center distance of 500.0ft	<b>Error Surface:</b>	Elliptical Conic
<b>Warning Levels Evaluated at:</b>	2.00 Sigma		

<b>Survey Tool Program</b>		<b>Date</b>	6/28/2013		
<b>From (ft)</b>	<b>To (ft)</b>	<b>Survey (Wellbore)</b>	<b>Tool Name</b>	<b>Description</b>	
0.0	16,000.2	Plan #1 (HZ)	Geolink MWD	Geolink MWD	

# Anticollision Report

<b>Company:</b>	EnCana Oil & Gas (USA) Inc	<b>Local Co-ordinate Reference:</b>	Well Woolley-Sosa 2D-7H-E168
<b>Project:</b>	DJ Wattenberg	<b>TVD Reference:</b>	WELL @ 5019.0ft (Original Well Elev)
<b>Reference Site:</b>	S7-T1N-R68W (Woolley-Sosa/Becky)	<b>MD Reference:</b>	WELL @ 5019.0ft (Original Well Elev)
<b>Site Error:</b>	0.0ft	<b>North Reference:</b>	True
<b>Reference Well:</b>	Woolley-Sosa 2D-7H-E168	<b>Survey Calculation Method:</b>	Minimum Curvature
<b>Well Error:</b>	0.0ft	<b>Output errors are at</b>	2.00 sigma
<b>Reference Wellbore</b>	HZ	<b>Database:</b>	USA EDM 5000 Multi Users DB
<b>Reference Design:</b>	Plan #1	<b>Offset TVD Reference:</b>	Offset Datum

## Summary

Site Name	Reference Measured Depth (ft)	Offset Measured Depth (ft)	Distance Between Centres (ft)	Distance Between Ellipses (ft)	Separation Factor	Warning
<b>Offset Well - Wellbore - Design</b>						
S7-T1N-R68W (Woolley-Sosa/Becky)						
Sosa 11-18 - DD - DD						Out of range
Sosa 12-18 - DD - DD						Out of range
Sosa 21-18 - DD (Gyro) - DD						Out of range
Sosa 21-18 - DD (MWD) - DD						Out of range
Sosa 22-18 - DD - DD						Out of range
SOSA A UNIT 1 (EXISTING) - EXISTING - EXISTING	12,357.8	7,758.4	162.9	71.8	1.787	CC, ES, SF
THOMAS 14-7(EXISTING) - EXISTING - NO SURVEY						Out of range
THOMAS 24-7 (EXISTING) - ENCANA WELL - Plan #1						Out of range
THOMAS 24-7 (EXISTING) - ENCANA WELL - Plan #2						Out of range
THOMAS 24-7 (EXISTING) - ENCANA WELL - SURVEY						Out of range
THOMAS 24-7 (Existing) - Existing - NO SURVEYS						Out of range
THOMAS 2-8-7 (EXISTING) - ENCANA WELL - Plan #1	11,108.8	7,818.0	148.3	74.0	1.998	CC, ES, SF
THOMAS 2-8-7 (EXISTING) - ENCANA WELL - SURVEY	11,077.7	7,821.4	141.0	67.7	1.924	CC, ES, SF
THOMAS 33-7 (EXISTING) - ENCANA WELL - Plan #1						Out of range
THOMAS 33-7 (EXISTING) - ENCANA WELL - Plan #2						Out of range
THOMAS 33-7 (EXISTING) - ENCANA WELL - Plan #3						Out of range
THOMAS 33-7 (EXISTING) - ENCANA WELL - SURVEY						Out of range
Thomas 7-12 (Existing) - Existing - NO SURVEYS						Out of range
Thomas 7-14 (Existing) - Existing - NO SURVEYS						Out of range
THOMAS E UNIT 1 (EXISTING) - Existing - NO SURVEY	9,268.1	7,741.0	333.5	294.1	8.467	CC, ES
THOMAS E UNIT 1 (EXISTING) - Existing - NO SURVEY	9,300.0	7,741.0	335.0	295.2	8.406	SF
THOMAS K UNIT 1 (EXISTING) - EXISTING - NO SURV						Out of range
Woolley-Sosa 2A-7H-E168 - Hz - Plan #1	200.0	200.0	16.2	15.5	26.447	CC
Woolley-Sosa 2A-7H-E168 - Hz - Plan #1	300.0	299.9	16.5	15.5	17.143	ES
Woolley-Sosa 2A-7H-E168 - Hz - Plan #1	500.0	499.4	20.2	18.5	12.039	SF
Woolley-Sosa 2B-7H-E168 - HZ - Plan #1	300.0	300.0	10.0	9.0	10.417	CC
Woolley-Sosa 2B-7H-E168 - HZ - Plan #1	400.0	399.9	10.3	9.0	7.849	ES
Woolley-Sosa 2B-7H-E168 - HZ - Plan #1	500.0	499.8	11.5	9.8	6.901	SF
Woolley-Sosa 2C-7H-E168 - HZ - Plan #1	686.9	687.1	5.2	2.8	2.225	CC
Woolley-Sosa 2C-7H-E168 - HZ - Plan #1	700.0	700.2	5.2	2.8	2.186	ES
Woolley-Sosa 2C-7H-E168 - HZ - Plan #1	16,000.2	15,974.5	327.6	47.1	1.168	Level 2, SF
Woolley-Sosa 2E-7H-E168 - HZ - Plan #1	729.6	729.5	15.5	13.0	6.282	CC, ES
Woolley-Sosa 2E-7H-E168 - HZ - Plan #1	16,000.2	16,033.3	350.0	69.6	1.248	Level 2, SF
Woolley-Sosa 2F-7H-E168 - HZ - Plan #1	300.0	300.0	20.0	19.0	20.835	CC, ES
Woolley-Sosa 2F-7H-E168 - HZ - Plan #1	900.0	897.0	39.1	36.0	12.672	SF
Woolley-Sosa 2G-7H-E168 - HZ - Plan #1	200.0	200.0	25.7	25.1	42.088	CC, ES
Woolley-Sosa 2G-7H-E168 - HZ - Plan #1	900.0	895.2	55.6	52.5	17.924	SF

# Anticollision Report

<b>Company:</b>	EnCana Oil & Gas (USA) Inc	<b>Local Co-ordinate Reference:</b>	Well Woolley-Sosa 2D-7H-E168
<b>Project:</b>	DJ Wattenberg	<b>TVD Reference:</b>	WELL @ 5019.0ft (Original Well Elev)
<b>Reference Site:</b>	S7-T1N-R68W (Woolley-Sosa/Becky)	<b>MD Reference:</b>	WELL @ 5019.0ft (Original Well Elev)
<b>Site Error:</b>	0.0ft	<b>North Reference:</b>	True
<b>Reference Well:</b>	Woolley-Sosa 2D-7H-E168	<b>Survey Calculation Method:</b>	Minimum Curvature
<b>Well Error:</b>	0.0ft	<b>Output errors are at</b>	2.00 sigma
<b>Reference Wellbore</b>	HZ	<b>Database:</b>	USA EDM 5000 Multi Users DB
<b>Reference Design:</b>	Plan #1	<b>Offset TVD Reference:</b>	Offset Datum

Offset Design		S7-T1N-R68W (Woolley-Sosa/Becky) - SOSA A UNIT 1 (EXISTING) - EXISTING - EXISTING										Offset Site Error:		0.0 ft	
Survey Program:		100-Geolink MWD										Offset Well Error:		0.0 ft	
Reference		Offset		Semi Major Axis			Distance							Warning	
Measured Depth Depth (ft)	Vertical Depth (ft)	Measured Depth (ft)	Vertical Depth (ft)	Reference (ft)	Offset (ft)	Highside Toolface (°)	Offset Wellbore Centre +N/-S (ft)	+E/-W (ft)	Between Centres (ft)	Between Ellipses (ft)	Total Uncertainty Axis	Separation Factor			
11,900.0	7,759.0	7,755.9	7,754.0	69.9	13.6	90.70	-4,236.4	392.8	485.9	402.6	83.33	5.832			
12,000.0	7,759.0	7,756.4	7,754.5	71.7	13.6	90.90	-4,236.4	392.8	393.1	308.1	85.04	4.623			
12,100.0	7,759.0	7,757.0	7,755.1	73.4	13.6	91.09	-4,236.4	392.8	305.0	218.2	86.76	3.515			
12,200.0	7,759.0	7,757.5	7,755.6	75.1	13.6	91.28	-4,236.4	392.9	226.8	138.3	88.48	2.564			
12,300.0	7,759.0	7,758.1	7,756.2	76.8	13.6	91.47	-4,236.4	392.9	172.9	82.7	90.20	1.917			
12,357.8	7,759.0	7,758.4	7,756.5	77.8	13.6	91.58	-4,236.4	392.9	162.9	71.8	91.19	1.787	CC, ES, SF		
12,400.0	7,759.0	7,758.6	7,756.7	78.5	13.6	91.66	-4,236.4	392.9	168.3	76.4	91.92	1.831			
12,500.0	7,759.0	7,759.1	7,757.2	80.3	13.6	91.82	-4,236.4	392.9	215.9	122.4	93.55	2.308			
12,600.0	7,759.0	7,759.5	7,757.7	82.0	13.6	91.89	-4,236.4	392.9	289.7	194.7	95.02	3.049			
12,700.0	7,759.0	7,759.9	7,758.0	83.7	13.6	91.89	-4,236.4	392.9	374.2	277.8	96.41	3.881			
12,800.0	7,759.0	7,760.1	7,758.2	85.4	13.6	91.97	-4,236.4	392.9	464.1	366.0	98.11	4.730			

# Anticollision Report

<b>Company:</b>	EnCana Oil & Gas (USA) Inc	<b>Local Co-ordinate Reference:</b>	Well Woolley-Sosa 2D-7H-E168
<b>Project:</b>	DJ Wattenberg	<b>TVD Reference:</b>	WELL @ 5019.0ft (Original Well Elev)
<b>Reference Site:</b>	S7-T1N-R68W (Woolley-Sosa/Becky)	<b>MD Reference:</b>	WELL @ 5019.0ft (Original Well Elev)
<b>Site Error:</b>	0.0ft	<b>North Reference:</b>	True
<b>Reference Well:</b>	Woolley-Sosa 2D-7H-E168	<b>Survey Calculation Method:</b>	Minimum Curvature
<b>Well Error:</b>	0.0ft	<b>Output errors are at</b>	2.00 sigma
<b>Reference Wellbore</b>	HZ	<b>Database:</b>	USA EDM 5000 Multi Users DB
<b>Reference Design:</b>	Plan #1	<b>Offset TVD Reference:</b>	Offset Datum

Offset Design													S7-T1N-R68W (Woolley-Sosa/Becky) - THOMAS 2-8-7 (EXISTING) - ENCANA WELL - Plan #1		Offset Site Error:		0.0 ft	
Survey Program:													0-MWD		Offset Well Error:		0.0 ft	
Reference		Offset		Semi Major Axis			Distance							Warning				
Measured Depth (ft)	Vertical Depth (ft)	Measured Depth (ft)	Vertical Depth (ft)	Reference (ft)	Offset (ft)	Highside Toolface (°)	Offset Wellbore Centre +N/-S (ft)	+E/-W (ft)	Between Centres (ft)	Between Ellipses (ft)	Total Uncertainty Axis	Separation Factor						
10,700.0	7,759.0	7,818.0	7,758.0	49.7	19.9	-90.00	-2,977.8	650.8	434.9	367.6	67.30	6.462						
10,800.0	7,759.0	7,818.0	7,758.0	51.4	19.9	-90.00	-2,977.8	650.8	342.6	273.6	68.98	4.966						
10,900.0	7,759.0	7,818.0	7,758.0	53.0	19.9	-90.00	-2,977.8	650.8	256.1	185.4	70.67	3.624						
11,000.0	7,759.0	7,818.0	7,758.0	54.7	19.9	-90.00	-2,977.8	650.8	183.9	111.5	72.36	2.542						
11,100.0	7,759.0	7,818.0	7,758.0	56.4	19.9	-90.00	-2,977.8	650.8	148.5	74.5	74.06	2.005						
11,108.8	7,759.0	7,818.0	7,758.0	56.5	19.9	-90.00	-2,977.8	650.8	148.3	74.0	74.21	1.998	CC, ES, SF					
11,200.0	7,759.0	7,818.0	7,758.0	58.0	19.9	-90.00	-2,977.8	650.8	174.0	98.3	75.76	2.297						
11,300.0	7,759.0	7,818.0	7,758.0	59.7	19.9	-90.00	-2,977.8	650.8	241.9	164.5	77.46	3.123						
11,400.0	7,759.0	7,818.0	7,758.0	61.4	19.9	-90.00	-2,977.8	650.8	326.7	247.6	79.17	4.127						
11,500.0	7,759.0	7,818.0	7,758.0	63.1	19.9	-90.00	-2,977.8	650.8	418.3	337.4	80.87	5.173						

# Anticollision Report

<b>Company:</b>	EnCana Oil & Gas (USA) Inc	<b>Local Co-ordinate Reference:</b>	Well Woolley-Sosa 2D-7H-E168
<b>Project:</b>	DJ Wattenberg	<b>TVD Reference:</b>	WELL @ 5019.0ft (Original Well Elev)
<b>Reference Site:</b>	S7-T1N-R68W (Woolley-Sosa/Becky)	<b>MD Reference:</b>	WELL @ 5019.0ft (Original Well Elev)
<b>Site Error:</b>	0.0ft	<b>North Reference:</b>	True
<b>Reference Well:</b>	Woolley-Sosa 2D-7H-E168	<b>Survey Calculation Method:</b>	Minimum Curvature
<b>Well Error:</b>	0.0ft	<b>Output errors are at</b>	2.00 sigma
<b>Reference Wellbore</b>	HZ	<b>Database:</b>	USA EDM 5000 Multi Users DB
<b>Reference Design:</b>	Plan #1	<b>Offset TVD Reference:</b>	Offset Datum

Offset Design S7-T1N-R68W (Woolley-Sosa/Becky) - THOMAS 2-8-7 (EXISTING) - ENCANA WELL - SURVEYS													Offset Site Error: 0.0 ft
Survey Program: 838-MWD													Offset Well Error: 0.0 ft
Reference		Offset		Semi Major Axis		Distance							
Measured Depth (ft)	Vertical Depth (ft)	Measured Depth (ft)	Vertical Depth (ft)	Reference (ft)	Offset (ft)	Highside Toolface (°)	Offset Wellbore Centre +N/-S (ft)	+E/-W (ft)	Between Centres (ft)	Between Ellipses (ft)	Total Uncertainty Axis	Separation Factor	Warning
10,600.0	7,759.0	7,822.5	7,758.7	48.0	19.6	-90.29	-2,946.7	643.5	498.0	432.8	65.22	7.637	
10,700.0	7,759.0	7,822.3	7,758.5	49.7	19.6	-90.20	-2,946.7	643.5	403.1	336.2	66.89	6.026	
10,800.0	7,759.0	7,822.1	7,758.3	51.4	19.6	-90.11	-2,946.7	643.5	311.4	242.8	68.58	4.541	
10,900.0	7,759.0	7,821.9	7,758.1	53.0	19.6	-90.02	-2,946.7	643.5	226.8	156.6	70.26	3.228	
11,000.0	7,759.0	7,821.6	7,757.8	54.7	19.6	-89.92	-2,946.7	643.5	161.0	89.0	71.95	2.237	
11,077.7	7,759.0	7,821.4	7,757.6	56.0	19.6	-89.85	-2,946.7	643.5	141.0	67.7	73.27	1.924 CC, ES, SF	
11,100.0	7,759.0	7,821.4	7,757.6	56.4	19.6	-89.83	-2,946.7	643.5	142.7	69.1	73.65	1.938	
11,200.0	7,759.0	7,821.2	7,757.4	58.0	19.6	-89.74	-2,946.7	643.5	186.6	111.3	75.35	2.477	
11,300.0	7,759.0	7,820.9	7,757.1	59.7	19.6	-89.65	-2,946.7	643.5	263.3	186.2	77.05	3.417	
11,400.0	7,759.0	7,820.7	7,756.9	61.4	19.6	-89.55	-2,946.7	643.5	351.8	273.1	78.75	4.467	
11,500.0	7,759.0	7,820.5	7,756.7	63.1	19.6	-89.46	-2,946.7	643.5	445.2	364.8	80.46	5.534	

## Anticollision Report

<b>Company:</b>	EnCana Oil & Gas (USA) Inc	<b>Local Co-ordinate Reference:</b>	Well Woolley-Sosa 2D-7H-E168
<b>Project:</b>	DJ Wattenberg	<b>TVD Reference:</b>	WELL @ 5019.0ft (Original Well Elev)
<b>Reference Site:</b>	S7-T1N-R68W (Woolley-Sosa/Becky)	<b>MD Reference:</b>	WELL @ 5019.0ft (Original Well Elev)
<b>Site Error:</b>	0.0ft	<b>North Reference:</b>	True
<b>Reference Well:</b>	Woolley-Sosa 2D-7H-E168	<b>Survey Calculation Method:</b>	Minimum Curvature
<b>Well Error:</b>	0.0ft	<b>Output errors are at</b>	2.00 sigma
<b>Reference Wellbore</b>	HZ	<b>Database:</b>	USA EDM 5000 Multi Users DB
<b>Reference Design:</b>	Plan #1	<b>Offset TVD Reference:</b>	Offset Datum

Offset Design												S7-T1N-R68W (Woolley-Sosa/Becky) - THOMAS E UNIT 1 (EXISTING) - Existing - NO SURVEYS		Offset Site Error:		0.0 ft	
Survey Program:												8332-Geolink MWD		Offset Well Error:		0.0 ft	
Reference				Offset		Semi Major Axis			Distance					Warning			
Measured Depth (ft)	Vertical Depth (ft)	Measured Depth (ft)	Vertical Depth (ft)	Reference (ft)	Offset (ft)	Highside Toolface (°)	Offset Wellbore Centre +N/-S (ft)	+E/-W (ft)	Between Centres (ft)	Between Ellipses (ft)	Total Uncertainty Axis	Separation Factor					
8,900.0	7,759.0	7,741.0	7,741.0	22.5	13.5	-90.00	-1,137.1	836.0	496.7	462.5	34.25	14.501					
9,000.0	7,759.0	7,741.0	7,741.0	23.8	13.5	-90.00	-1,137.1	836.0	427.9	392.3	35.58	12.028					
9,100.0	7,759.0	7,741.0	7,741.0	25.1	13.5	-90.00	-1,137.1	836.0	373.5	336.5	36.96	10.105					
9,200.0	7,759.0	7,741.0	7,741.0	26.4	13.5	-90.00	-1,137.1	836.0	340.4	302.0	38.39	8.867					
9,268.1	7,759.0	7,741.0	7,741.0	27.3	13.5	-90.00	-1,137.1	836.0	333.5	294.1	39.39	8.467 CC, ES					
9,300.0	7,759.0	7,741.0	7,741.0	27.8	13.5	-90.00	-1,137.1	836.0	335.0	295.2	39.85	8.406 SF					
9,400.0	7,759.0	7,741.0	7,741.0	29.2	13.5	-90.00	-1,137.1	836.0	358.6	317.3	41.35	8.672					
9,500.0	7,759.0	7,741.0	7,741.0	30.7	13.5	-90.00	-1,137.1	836.0	406.2	363.3	42.88	9.472					
9,600.0	7,759.0	7,741.0	7,741.0	32.2	13.5	-90.00	-1,137.1	836.0	470.5	426.0	44.43	10.588					

# Anticollision Report

<b>Company:</b>	EnCana Oil & Gas (USA) Inc	<b>Local Co-ordinate Reference:</b>	Well Woolley-Sosa 2D-7H-E168
<b>Project:</b>	DJ Wattenberg	<b>TVD Reference:</b>	WELL @ 5019.0ft (Original Well Elev)
<b>Reference Site:</b>	S7-T1N-R68W (Woolley-Sosa/Becky)	<b>MD Reference:</b>	WELL @ 5019.0ft (Original Well Elev)
<b>Site Error:</b>	0.0ft	<b>North Reference:</b>	True
<b>Reference Well:</b>	Woolley-Sosa 2D-7H-E168	<b>Survey Calculation Method:</b>	Minimum Curvature
<b>Well Error:</b>	0.0ft	<b>Output errors are at</b>	2.00 sigma
<b>Reference Wellbore</b>	HZ	<b>Database:</b>	USA EDM 5000 Multi Users DB
<b>Reference Design:</b>	Plan #1	<b>Offset TVD Reference:</b>	Offset Datum

Offset Design S7-T1N-R68W (Woolley-Sosa/Becky) - Woolley-Sosa 2A-7H-E168 - Hz - Plan #1													Offset Site Error:	0.0 ft
Survey Program: 0-Geolink MWD													Offset Well Error:	0.0 ft
Reference		Offset		Semi Major Axis		Highside Toolface (°)	Distance		Total Uncertainty Axis	Separation Factor	Warning			
Measured Depth (ft)	Vertical Depth (ft)	Measured Depth (ft)	Vertical Depth (ft)	Reference (ft)	Offset (ft)		Offset Wellbore Centre +N/-S (ft)	+E/-W (ft)						
0.0	0.0	0.0	0.0	0.0	0.0	-111.51	-5.9	-15.0	16.2					
100.0	100.0	100.0	100.0	0.1	0.1	-111.51	-5.9	-15.0	16.2	15.9	0.26	61.709		
200.0	200.0	200.0	200.0	0.3	0.3	-111.51	-5.9	-15.0	16.2	15.5	0.61	26.447 CC		
300.0	300.0	299.9	299.9	0.5	0.5	-108.66	-5.3	-15.6	16.5	15.5	0.96	17.143 ES		
400.0	400.0	399.7	399.7	0.7	0.7	-100.80	-3.3	-17.3	17.6	16.3	1.31	13.413		
500.0	500.0	499.4	499.3	0.8	0.8	-90.09	0.0	-20.2	20.2	18.5	1.68	12.039 SF		
600.0	600.0	599.0	598.7	1.0	1.0	-119.72	4.5	-24.2	25.0	23.0	2.02	12.371		
700.0	700.0	698.3	697.7	1.2	1.3	-114.80	10.4	-29.3	32.5	30.1	2.38	13.611		
800.0	799.9	797.3	796.2	1.4	1.5	-112.64	17.5	-35.5	42.1	39.4	2.75	15.298		
900.0	899.7	896.2	894.5	1.6	1.7	-112.07	25.8	-42.7	53.8	50.7	3.14	17.164		
1,000.0	999.4	995.4	993.0	1.8	2.0	-112.91	34.4	-50.2	66.5	62.9	3.53	18.800		
1,100.0	1,098.9	1,094.4	1,091.4	2.0	2.2	-114.60	42.9	-57.7	79.8	75.9	3.95	20.188		
1,200.0	1,198.3	1,193.4	1,189.7	2.2	2.5	-116.70	51.5	-65.2	93.9	89.5	4.39	21.402		
1,300.0	1,297.6	1,292.3	1,288.0	2.5	2.7	-118.48	60.0	-72.6	108.3	103.5	4.83	22.416		
1,400.0	1,396.9	1,391.2	1,386.2	2.7	3.0	-119.84	68.6	-80.1	122.8	117.5	5.28	23.257		
1,500.0	1,496.3	1,490.1	1,484.5	3.0	3.3	-120.91	77.1	-87.6	137.3	131.6	5.73	23.966		
1,600.0	1,595.6	1,589.0	1,582.8	3.2	3.5	-121.78	85.7	-95.0	151.9	145.7	6.18	24.569		
1,700.0	1,694.9	1,687.9	1,681.0	3.5	3.8	-122.49	94.2	-102.5	166.4	159.8	6.63	25.088		
1,800.0	1,794.3	1,786.8	1,779.3	3.7	4.0	-123.09	102.8	-109.9	181.0	174.0	7.09	25.539		
1,900.0	1,893.6	1,885.8	1,877.5	4.0	4.3	-123.60	111.3	-117.4	195.7	188.1	7.54	25.935		
2,000.0	1,992.9	1,984.7	1,975.8	4.2	4.6	-124.04	119.9	-124.9	210.3	202.3	8.00	26.284		
2,100.0	2,092.3	2,083.6	2,074.0	4.5	4.8	-124.43	128.4	-132.3	225.0	216.5	8.46	26.595		
2,200.0	2,191.6	2,182.5	2,172.3	4.8	5.1	-124.76	137.0	-139.8	239.6	230.7	8.92	26.873		
2,300.0	2,290.9	2,281.4	2,270.6	5.0	5.3	-125.06	145.5	-147.3	254.3	244.9	9.37	27.124		
2,400.0	2,390.3	2,380.3	2,368.8	5.3	5.6	-125.32	154.1	-154.7	268.9	259.1	9.83	27.351		
2,500.0	2,489.6	2,479.2	2,467.1	5.5	5.9	-125.56	162.6	-162.2	283.6	273.3	10.29	27.557		
2,600.0	2,588.9	2,578.1	2,565.3	5.8	6.1	-125.77	171.2	-169.7	298.3	287.5	10.75	27.745		
2,700.0	2,688.3	2,677.0	2,663.6	6.1	6.4	-125.97	179.7	-177.1	313.0	301.8	11.21	27.917		
2,800.0	2,787.6	2,776.0	2,761.9	6.3	6.7	-126.14	188.2	-184.6	327.6	316.0	11.67	28.075		
2,900.0	2,886.9	2,874.9	2,860.1	6.6	6.9	-126.31	196.8	-192.0	342.3	330.2	12.13	28.221		
3,000.0	2,986.2	2,973.8	2,958.4	6.9	7.2	-126.45	205.3	-199.5	357.0	344.4	12.59	28.357		
3,100.0	3,085.6	3,072.7	3,056.6	7.1	7.4	-126.59	213.9	-207.0	371.7	358.7	13.05	28.482		
3,200.0	3,184.9	3,171.6	3,154.9	7.4	7.7	-126.72	222.4	-214.4	386.4	372.9	13.51	28.599		
3,300.0	3,284.2	3,270.5	3,253.1	7.6	8.0	-126.83	231.0	-221.9	401.1	387.1	13.97	28.708		
3,400.0	3,383.6	3,369.4	3,351.4	7.9	8.2	-126.94	239.5	-229.4	415.8	401.4	14.43	28.810		
3,500.0	3,482.9	3,468.3	3,449.7	8.2	8.5	-127.04	248.1	-236.8	430.5	415.6	14.89	28.906		
3,600.0	3,582.2	3,567.3	3,547.9	8.4	8.8	-127.14	256.6	-244.3	445.2	429.8	15.35	28.995		
3,700.0	3,681.6	3,666.2	3,646.2	8.7	9.0	-127.23	265.2	-251.8	459.9	444.1	15.82	29.079		
3,800.0	3,780.9	3,765.1	3,744.4	9.0	9.3	-127.31	273.7	-259.2	474.6	458.3	16.28	29.159		
3,900.0	3,880.2	3,864.0	3,842.7	9.2	9.5	-127.39	282.3	-266.7	489.3	472.6	16.74	29.234		

# Anticollision Report

<b>Company:</b>	EnCana Oil & Gas (USA) Inc	<b>Local Co-ordinate Reference:</b>	Well Woolley-Sosa 2D-7H-E168
<b>Project:</b>	DJ Wattenberg	<b>TVD Reference:</b>	WELL @ 5019.0ft (Original Well Elev)
<b>Reference Site:</b>	S7-T1N-R68W (Woolley-Sosa/Becky)	<b>MD Reference:</b>	WELL @ 5019.0ft (Original Well Elev)
<b>Site Error:</b>	0.0ft	<b>North Reference:</b>	True
<b>Reference Well:</b>	Woolley-Sosa 2D-7H-E168	<b>Survey Calculation Method:</b>	Minimum Curvature
<b>Well Error:</b>	0.0ft	<b>Output errors are at</b>	2.00 sigma
<b>Reference Wellbore</b>	HZ	<b>Database:</b>	USA EDM 5000 Multi Users DB
<b>Reference Design:</b>	Plan #1	<b>Offset TVD Reference:</b>	Offset Datum

Offset Design S7-T1N-R68W (Woolley-Sosa/Becky) - Woolley-Sosa 2B-7H-E168 - HZ - Plan #1													Offset Site Error:	0.0 ft
Survey Program: 0-Geolink MWD													Offset Well Error:	0.0 ft
Reference		Offset		Semi Major Axis		Distance		Total		Separation		Warning		
Measured Depth (ft)	Vertical Depth (ft)	Measured Depth (ft)	Vertical Depth (ft)	Reference (ft)	Offset (ft)	Highside Toolface (°)	Offset Wellbore Centre +N/-S (ft)	+E/-W (ft)	Between Centres (ft)	Between Ellipses (ft)	Uncertainty Axis	Factor		
0.0	0.0	0.0	0.0	0.0	0.0	-89.71	0.1	-10.0	10.0					
100.0	100.0	100.0	100.0	0.1	0.1	-89.71	0.1	-10.0	10.0	9.7	0.26	38.197		
200.0	200.0	200.0	200.0	0.3	0.3	-89.71	0.1	-10.0	10.0	9.4	0.61	16.370		
300.0	300.0	300.0	300.0	0.5	0.5	-89.71	0.1	-10.0	10.0	9.0	0.96	10.417 CC		
400.0	400.0	399.9	399.9	0.7	0.7	-85.04	0.9	-10.2	10.3	9.0	1.31	7.849 ES		
500.0	500.0	499.8	499.8	0.8	0.8	-72.76	3.4	-11.0	11.5	9.8	1.66	6.901 SF		
600.0	600.0	599.6	599.5	1.0	1.0	-100.08	7.6	-12.2	14.5	12.4	2.02	7.175		
700.0	700.0	699.3	698.9	1.2	1.2	-94.77	13.4	-13.8	19.3	16.9	2.37	8.116		
800.0	799.9	798.8	798.1	1.4	1.4	-93.12	20.9	-16.0	25.6	22.9	2.74	9.336		
900.0	899.7	898.4	897.4	1.6	1.6	-93.89	29.5	-18.4	33.0	29.9	3.13	10.539		
1,000.0	999.4	998.1	996.7	1.8	1.9	-96.80	38.2	-20.9	40.5	37.0	3.54	11.467		
1,100.0	1,098.9	1,097.7	1,095.9	2.0	2.1	-100.80	46.8	-23.4	48.5	44.5	3.96	12.226		
1,200.0	1,198.3	1,197.3	1,195.0	2.2	2.3	-105.26	55.4	-25.8	57.0	52.6	4.41	12.913		
1,300.0	1,297.6	1,296.8	1,294.2	2.5	2.5	-108.88	64.0	-28.3	65.9	61.0	4.87	13.533		
1,400.0	1,396.9	1,396.4	1,393.3	2.7	2.8	-111.62	72.7	-30.7	74.9	69.6	5.32	14.078		
1,500.0	1,496.3	1,495.9	1,492.4	3.0	3.0	-113.77	81.3	-33.2	84.2	78.4	5.78	14.557		
1,600.0	1,595.6	1,595.4	1,591.5	3.2	3.2	-115.49	89.9	-35.7	93.5	87.2	6.24	14.979		
1,700.0	1,694.9	1,694.9	1,690.7	3.5	3.5	-116.90	98.5	-38.1	102.8	96.1	6.70	15.352		
1,800.0	1,794.3	1,794.5	1,789.8	3.7	3.7	-118.08	107.2	-40.6	112.3	105.1	7.16	15.683		
1,900.0	1,893.6	1,894.0	1,888.9	4.0	3.9	-119.07	115.8	-43.1	121.7	114.1	7.62	15.979		
2,000.0	1,992.9	1,993.5	1,988.0	4.2	4.2	-119.92	124.4	-45.5	131.2	123.2	8.08	16.244		
2,100.0	2,092.3	2,093.1	2,087.2	4.5	4.4	-120.65	133.0	-48.0	140.8	132.2	8.54	16.483		
2,200.0	2,191.6	2,192.6	2,186.3	4.8	4.6	-121.29	141.6	-50.5	150.3	141.3	9.00	16.700		
2,300.0	2,290.9	2,292.1	2,285.4	5.0	4.8	-121.86	150.3	-52.9	159.9	150.4	9.46	16.897		
2,400.0	2,390.3	2,391.7	2,384.6	5.3	5.1	-122.36	158.9	-55.4	169.4	159.5	9.92	17.076		
2,500.0	2,489.6	2,491.2	2,483.7	5.5	5.3	-122.81	167.5	-57.9	179.0	168.6	10.38	17.241		
2,600.0	2,588.9	2,590.7	2,582.8	5.8	5.5	-123.21	176.1	-60.3	188.6	177.8	10.85	17.392		
2,700.0	2,688.3	2,690.2	2,681.9	6.1	5.8	-123.57	184.8	-62.8	198.2	186.9	11.31	17.532		
2,800.0	2,787.6	2,789.8	2,781.1	6.3	6.0	-123.90	193.4	-65.3	207.8	196.1	11.77	17.661		
2,900.0	2,886.9	2,889.3	2,880.2	6.6	6.2	-124.20	202.0	-67.7	217.5	205.2	12.23	17.781		
3,000.0	2,986.2	2,988.8	2,979.3	6.9	6.5	-124.48	210.6	-70.2	227.1	214.4	12.69	17.893		
3,100.0	3,085.6	3,088.4	3,078.4	7.1	6.7	-124.73	219.3	-72.6	236.7	223.6	13.15	17.997		
3,200.0	3,184.9	3,187.9	3,177.6	7.4	6.9	-124.96	227.9	-75.1	246.3	232.7	13.61	18.094		
3,300.0	3,284.2	3,287.4	3,276.7	7.6	7.2	-125.18	236.5	-77.6	256.0	241.9	14.08	18.185		
3,400.0	3,383.6	3,387.0	3,375.8	7.9	7.4	-125.37	245.1	-80.0	265.6	251.1	14.54	18.270		
3,500.0	3,482.9	3,486.5	3,474.9	8.2	7.6	-125.56	253.8	-82.5	275.2	260.2	15.00	18.351		
3,600.0	3,582.2	3,586.0	3,574.1	8.4	7.9	-125.73	262.4	-85.0	284.9	269.4	15.46	18.426		
3,700.0	3,681.6	3,685.6	3,673.2	8.7	8.1	-125.89	271.0	-87.4	294.5	278.6	15.92	18.498		
3,800.0	3,780.9	3,785.1	3,772.3	9.0	8.3	-126.05	279.6	-89.9	304.2	287.8	16.38	18.565		
3,900.0	3,880.2	3,884.6	3,871.4	9.2	8.6	-126.19	288.2	-92.4	313.8	297.0	16.85	18.629		
4,000.0	3,979.6	3,984.1	3,970.6	9.5	8.8	-126.32	296.9	-94.8	323.5	306.2	17.31	18.689		
4,100.0	4,078.9	4,083.7	4,069.7	9.8	9.0	-126.45	305.5	-97.3	333.1	315.4	17.77	18.747		
4,200.0	4,178.2	4,183.2	4,168.8	10.0	9.3	-126.57	314.1	-99.8	342.8	324.6	18.23	18.801		
4,300.0	4,277.6	4,282.7	4,267.9	10.3	9.5	-126.68	322.7	-102.2	352.5	333.8	18.69	18.853		
4,400.0	4,376.9	4,382.3	4,367.1	10.6	9.7	-126.79	331.4	-104.7	362.1	343.0	19.16	18.903		
4,500.0	4,476.2	4,481.8	4,466.2	10.8	10.0	-126.89	340.0	-107.1	371.8	352.2	19.62	18.950		
4,600.0	4,575.6	4,581.3	4,565.3	11.1	10.2	-126.98	348.6	-109.6	381.4	361.3	20.08	18.995		
4,700.0	4,674.9	4,680.9	4,664.4	11.4	10.4	-127.07	357.2	-112.1	391.1	370.5	20.54	19.038		
4,800.0	4,774.2	4,780.4	4,763.6	11.6	10.7	-127.16	365.9	-114.5	400.8	379.7	21.00	19.079		
4,900.0	4,873.5	4,879.9	4,862.7	11.9	10.9	-127.24	374.5	-117.0	410.4	388.9	21.47	19.119		
5,000.0	4,972.9	4,979.4	4,961.8	12.2	11.1	-127.32	383.1	-119.5	420.1	398.1	21.93	19.156		
5,100.0	5,072.2	5,079.0	5,060.9	12.4	11.4	-127.40	391.7	-121.9	429.7	407.4	22.39	19.193		

CC - Min centre to center distance or convergent point, SF - min separation factor, ES - min ellipse separation



## Anticollision Report

<b>Company:</b>	EnCana Oil & Gas (USA) Inc	<b>Local Co-ordinate Reference:</b>	Well Woolley-Sosa 2D-7H-E168
<b>Project:</b>	DJ Wattenberg	<b>TVD Reference:</b>	WELL @ 5019.0ft (Original Well Elev)
<b>Reference Site:</b>	S7-T1N-R68W (Woolley-Sosa/Becky)	<b>MD Reference:</b>	WELL @ 5019.0ft (Original Well Elev)
<b>Site Error:</b>	0.0ft	<b>North Reference:</b>	True
<b>Reference Well:</b>	Woolley-Sosa 2D-7H-E168	<b>Survey Calculation Method:</b>	Minimum Curvature
<b>Well Error:</b>	0.0ft	<b>Output errors are at</b>	2.00 sigma
<b>Reference Wellbore</b>	HZ	<b>Database:</b>	USA EDM 5000 Multi Users DB
<b>Reference Design:</b>	Plan #1	<b>Offset TVD Reference:</b>	Offset Datum

Offset Design													S7-T1N-R68W (Woolley-Sosa/Becky) - Woolley-Sosa 2B-7H-E168 - HZ - Plan #1		Offset Site Error:		0.0 ft	
Survey Program:													0-Geolink MWD		Offset Well Error:		0.0 ft	
Reference		Offset		Semi Major Axis			Distance							Warning				
Measured Depth	Vertical Depth	Measured Depth	Vertical Depth	Reference	Offset	Highside Toolface	Offset Wellbore Centre		Between Centres	Between Ellipses	Total Uncertainty	Separation						
(ft)	(ft)	(ft)	(ft)	(ft)	(ft)	(°)	+N/-S (ft)	+E/-W (ft)	(ft)	(ft)	Axis	Factor						
5,200.0	5,171.5	5,178.5	5,160.1	12.7	11.6	-127.47	400.4	-124.4	439.4	416.6	22.85	19.227						
5,300.0	5,270.9	5,278.0	5,259.2	13.0	11.8	-127.54	409.0	-126.9	449.1	425.8	23.32	19.261						
5,400.0	5,370.2	5,377.6	5,358.3	13.2	12.1	-127.60	417.6	-129.3	458.7	435.0	23.78	19.293						
5,500.0	5,469.5	5,477.1	5,457.4	13.5	12.3	-127.66	426.2	-131.8	468.4	444.2	24.24	19.324						
5,600.0	5,568.9	5,576.6	5,556.6	13.8	12.5	-127.73	434.8	-134.3	478.1	453.4	24.70	19.354						
5,700.0	5,668.2	5,676.2	5,655.7	14.0	12.8	-127.78	443.5	-136.7	487.7	462.6	25.16	19.383						
5,800.0	5,767.5	5,775.7	5,754.8	14.3	13.0	-127.84	452.1	-139.2	497.4	471.8	25.63	19.410						

# Anticollision Report

<b>Company:</b>	EnCana Oil & Gas (USA) Inc	<b>Local Co-ordinate Reference:</b>	Well Woolley-Sosa 2D-7H-E168
<b>Project:</b>	DJ Wattenberg	<b>TVD Reference:</b>	WELL @ 5019.0ft (Original Well Elev)
<b>Reference Site:</b>	S7-T1N-R68W (Woolley-Sosa/Becky)	<b>MD Reference:</b>	WELL @ 5019.0ft (Original Well Elev)
<b>Site Error:</b>	0.0ft	<b>North Reference:</b>	True
<b>Reference Well:</b>	Woolley-Sosa 2D-7H-E168	<b>Survey Calculation Method:</b>	Minimum Curvature
<b>Well Error:</b>	0.0ft	<b>Output errors are at</b>	2.00 sigma
<b>Reference Wellbore</b>	HZ	<b>Database:</b>	USA EDM 5000 Multi Users DB
<b>Reference Design:</b>	Plan #1	<b>Offset TVD Reference:</b>	Offset Datum

Offset Design S7-T1N-R68W (Woolley-Sosa/Becky) - Woolley-Sosa 2C-7H-E168 - HZ - Plan #1													Offset Site Error:	0.0 ft
Survey Program: 0-Geolink MWD													Offset Well Error:	0.0 ft
Reference		Offset		Semi Major Axis			Distance							
Measured Depth (ft)	Vertical Depth (ft)	Measured Depth (ft)	Vertical Depth (ft)	Reference (ft)	Offset (ft)	Highside Toolface (°)	Offset Wellbore Centre +N/-S (ft)	+E/-W (ft)	Between Centres (ft)	Between Ellipses (ft)	Total Uncertainty Axis	Separation Factor	Warning	
0.0	0.0	0.0	0.0	0.0	0.0	-139.91	-6.0	-5.0	7.8					
100.0	100.0	100.0	100.0	0.1	0.1	-139.91	-6.0	-5.0	7.8	7.5	0.26	29.833		
200.0	200.0	200.0	200.0	0.3	0.3	-139.91	-6.0	-5.0	7.8	7.2	0.61	12.786		
300.0	300.0	300.0	300.0	0.5	0.5	-139.91	-6.0	-5.0	7.8	6.9	0.96	8.136		
400.0	400.0	400.0	400.0	0.7	0.7	-139.91	-6.0	-5.0	7.8	6.5	1.31	5.967		
500.0	500.0	500.1	500.1	0.8	0.8	-136.98	-5.1	-4.8	7.0	5.4	1.66	4.235		
600.0	600.0	600.2	600.1	1.0	1.0	-164.16	-2.6	-4.1	5.7	3.7	2.01	2.823		
686.9	686.9	687.1	687.0	1.2	1.2	-144.84	0.9	-3.1	5.2	2.8	2.32	2.225 CC		
700.0	700.0	700.2	700.1	1.2	1.2	-141.36	1.6	-2.9	5.2	2.8	2.37	2.186 ES		
800.0	799.9	800.2	799.9	1.4	1.4	-116.34	7.5	-1.2	6.2	3.5	2.75	2.270		
900.0	899.7	900.2	899.5	1.6	1.6	-100.67	15.0	1.0	8.8	5.6	3.15	2.787		
1,000.0	999.4	1,000.1	999.0	1.8	1.8	-94.85	23.8	3.5	12.2	8.6	3.56	3.422		
1,100.0	1,098.9	1,100.0	1,098.5	2.0	2.0	-97.69	32.6	6.0	15.8	11.8	4.00	3.959		
1,200.0	1,198.3	1,199.9	1,198.0	2.2	2.3	-104.09	41.5	8.5	19.8	15.4	4.46	4.453		
1,300.0	1,297.6	1,299.8	1,297.5	2.5	2.5	-109.09	50.3	11.0	24.1	19.2	4.91	4.911		
1,400.0	1,396.9	1,399.7	1,396.9	2.7	2.7	-112.57	59.1	13.6	28.5	23.2	5.37	5.315		
1,500.0	1,496.3	1,499.6	1,496.4	3.0	2.9	-115.12	68.0	16.1	33.0	27.2	5.82	5.669		
1,600.0	1,595.6	1,599.5	1,595.9	3.2	3.2	-117.05	76.8	18.6	37.6	31.3	6.28	5.979		
1,700.0	1,694.9	1,699.4	1,695.3	3.5	3.4	-118.56	85.6	21.1	42.1	35.4	6.74	6.251		
1,800.0	1,794.3	1,799.2	1,794.8	3.7	3.6	-119.78	94.5	23.7	46.7	39.5	7.20	6.492		
1,900.0	1,893.6	1,899.1	1,894.3	4.0	3.9	-120.78	103.3	26.2	51.3	43.7	7.65	6.705		
2,000.0	1,992.9	1,999.0	1,993.7	4.2	4.1	-121.61	112.1	28.7	55.9	47.8	8.11	6.896		
2,100.0	2,092.3	2,098.9	2,093.2	4.5	4.3	-122.32	121.0	31.2	60.6	52.0	8.57	7.067		
2,200.0	2,191.6	2,198.8	2,192.7	4.8	4.6	-122.92	129.8	33.7	65.2	56.2	9.03	7.221		
2,300.0	2,290.9	2,298.7	2,292.1	5.0	4.8	-123.45	138.7	36.3	69.9	60.4	9.49	7.361		
2,400.0	2,390.3	2,398.6	2,391.6	5.3	5.0	-123.91	147.5	38.8	74.5	64.6	9.95	7.488		
2,500.0	2,489.6	2,498.5	2,491.1	5.5	5.3	-124.32	156.3	41.3	79.2	68.8	10.41	7.604		
2,600.0	2,588.9	2,598.4	2,590.5	5.8	5.5	-124.68	165.2	43.8	83.8	73.0	10.87	7.710		
2,700.0	2,688.3	2,698.3	2,690.0	6.1	5.7	-125.00	174.0	46.4	88.5	77.2	11.33	7.808		
2,800.0	2,787.6	2,798.1	2,789.5	6.3	6.0	-125.29	182.8	48.9	93.2	81.4	11.80	7.898		
2,900.0	2,886.9	2,898.0	2,888.9	6.6	6.2	-125.55	191.7	51.4	97.8	85.6	12.26	7.982		
3,000.0	2,986.2	2,997.9	2,988.4	6.9	6.4	-125.79	200.5	53.9	102.5	89.8	12.72	8.059		
3,100.0	3,085.6	3,097.8	3,087.9	7.1	6.7	-126.01	209.3	56.5	107.2	94.0	13.18	8.131		
3,200.0	3,184.9	3,197.7	3,187.3	7.4	6.9	-126.21	218.2	59.0	111.8	98.2	13.64	8.199		
3,300.0	3,284.2	3,297.6	3,286.8	7.6	7.2	-126.39	227.0	61.5	116.5	102.4	14.10	8.262		
3,400.0	3,383.6	3,397.5	3,386.3	7.9	7.4	-126.56	235.9	64.0	121.2	106.6	14.57	8.321		
3,500.0	3,482.9	3,497.4	3,485.7	8.2	7.6	-126.72	244.7	66.5	125.9	110.8	15.03	8.376		
3,600.0	3,582.2	3,597.3	3,585.2	8.4	7.9	-126.87	253.5	69.1	130.5	115.1	15.49	8.428		
3,700.0	3,681.6	3,697.2	3,684.7	8.7	8.1	-127.00	262.4	71.6	135.2	119.3	15.95	8.477		
3,800.0	3,780.9	3,797.0	3,784.1	9.0	8.3	-127.13	271.2	74.1	139.9	123.5	16.41	8.523		
3,900.0	3,880.2	3,896.9	3,883.6	9.2	8.6	-127.25	280.0	76.6	144.6	127.7	16.88	8.567		
4,000.0	3,979.6	3,996.8	3,983.1	9.5	8.8	-127.36	288.9	79.2	149.3	131.9	17.34	8.608		
4,100.0	4,078.9	4,096.7	4,082.5	9.8	9.0	-127.46	297.7	81.7	153.9	136.1	17.80	8.648		
4,200.0	4,178.2	4,196.6	4,182.0	10.0	9.3	-127.56	306.5	84.2	158.6	140.4	18.26	8.685		
4,300.0	4,277.6	4,296.5	4,281.5	10.3	9.5	-127.65	315.4	86.7	163.3	144.6	18.73	8.720		
4,400.0	4,376.9	4,396.4	4,380.9	10.6	9.8	-127.74	324.2	89.3	168.0	148.8	19.19	8.754		
4,500.0	4,476.2	4,496.3	4,480.4	10.8	10.0	-127.82	333.1	91.8	172.7	153.0	19.65	8.786		
4,600.0	4,575.6	4,596.2	4,579.9	11.1	10.2	-127.90	341.9	94.3	177.3	157.2	20.11	8.817		
4,700.0	4,674.9	4,696.1	4,679.3	11.4	10.5	-127.97	350.7	96.8	182.0	161.4	20.58	8.846		
4,800.0	4,774.2	4,795.9	4,778.8	11.6	10.7	-128.04	359.6	99.3	186.7	165.7	21.04	8.874		
4,900.0	4,873.5	4,895.8	4,878.3	11.9	10.9	-128.11	368.4	101.9	191.4	169.9	21.50	8.901		
5,000.0	4,972.9	4,995.7	4,977.7	12.2	11.2	-128.18	377.2	104.4	196.1	174.1	21.97	8.927		

CC - Min centre to center distance or convergent point, SF - min separation factor, ES - min ellipse separation

# Anticollision Report

<b>Company:</b>	EnCana Oil & Gas (USA) Inc	<b>Local Co-ordinate Reference:</b>	Well Woolley-Sosa 2D-7H-E168
<b>Project:</b>	DJ Wattenberg	<b>TVD Reference:</b>	WELL @ 5019.0ft (Original Well Elev)
<b>Reference Site:</b>	S7-T1N-R68W (Woolley-Sosa/Becky)	<b>MD Reference:</b>	WELL @ 5019.0ft (Original Well Elev)
<b>Site Error:</b>	0.0ft	<b>North Reference:</b>	True
<b>Reference Well:</b>	Woolley-Sosa 2D-7H-E168	<b>Survey Calculation Method:</b>	Minimum Curvature
<b>Well Error:</b>	0.0ft	<b>Output errors are at</b>	2.00 sigma
<b>Reference Wellbore</b>	HZ	<b>Database:</b>	USA EDM 5000 Multi Users DB
<b>Reference Design:</b>	Plan #1	<b>Offset TVD Reference:</b>	Offset Datum

Offset Design S7-T1N-R68W (Woolley-Sosa/Becky) - Woolley-Sosa 2C-7H-E168 - HZ - Plan #1													Offset Site Error:	0.0 ft
Survey Program: O-Geolink MWD													Offset Well Error:	0.0 ft
Reference		Offset		Semi Major Axis		Distance		Total		Separation		Warning		
Measured Depth (ft)	Vertical Depth (ft)	Measured Depth (ft)	Vertical Depth (ft)	Reference (ft)	Offset (ft)	Highside Toolface (°)	Offset Wellbore Centre +N/-S (ft)	+E/-W (ft)	Between Centres (ft)	Between Ellipses (ft)	Uncertainty Axis			
5,100.0	5,072.2	5,095.6	5,077.2	12.4	11.4	-128.24	386.1	106.9	200.8	178.3	22.43	8.951		
5,200.0	5,171.5	5,195.5	5,176.7	12.7	11.6	-128.29	394.9	109.4	205.4	182.5	22.89	8.975		
5,300.0	5,270.9	5,295.4	5,276.1	13.0	11.9	-128.35	403.7	112.0	210.1	186.8	23.35	8.997		
5,400.0	5,370.2	5,395.3	5,375.6	13.2	12.1	-128.40	412.6	114.5	214.8	191.0	23.82	9.019		
5,500.0	5,469.5	5,495.2	5,475.1	13.5	12.4	-128.45	421.4	117.0	219.5	195.2	24.28	9.040		
5,600.0	5,568.9	5,595.1	5,574.5	13.8	12.6	-128.50	430.2	119.5	224.2	199.4	24.74	9.060		
5,700.0	5,668.2	5,695.0	5,674.0	14.0	12.8	-128.55	439.1	122.1	228.9	203.7	25.21	9.080		
5,800.0	5,767.5	5,794.8	5,773.5	14.3	13.1	-128.59	447.9	124.6	233.5	207.9	25.67	9.098		
5,900.0	5,866.9	5,894.7	5,872.9	14.6	13.3	-128.64	456.8	127.1	238.2	212.1	26.13	9.116		
6,000.0	5,966.2	5,994.6	5,972.4	14.8	13.5	-128.68	465.6	129.6	242.9	216.3	26.59	9.134		
6,100.0	6,065.5	6,094.5	6,071.9	15.1	13.8	-128.72	474.4	132.1	247.6	220.5	27.06	9.151		
6,200.0	6,164.9	6,194.4	6,171.3	15.4	14.0	-128.76	483.3	134.7	252.3	224.8	27.52	9.167		
6,300.0	6,264.2	6,294.3	6,270.8	15.6	14.2	-128.79	492.1	137.2	257.0	229.0	27.98	9.183		
6,400.0	6,363.5	6,394.2	6,370.3	15.9	14.5	-128.83	500.9	139.7	261.7	233.2	28.45	9.198		
6,500.0	6,462.9	6,494.1	6,469.7	16.2	14.7	-128.86	509.8	142.2	266.3	237.4	28.91	9.213		
6,600.0	6,562.2	6,594.0	6,569.2	16.4	15.0	-128.90	518.6	144.8	271.0	241.6	29.37	9.227		
6,700.0	6,661.5	6,693.9	6,668.7	16.7	15.2	-128.93	527.4	147.3	275.7	245.9	29.84	9.241		
6,800.0	6,760.9	6,793.7	6,768.1	17.0	15.4	-128.96	536.3	149.8	280.4	250.1	30.30	9.254		
6,900.0	6,860.2	6,893.6	6,867.6	17.2	15.7	-128.99	545.1	152.3	285.1	254.3	30.76	9.267		
7,000.0	6,959.5	6,993.5	6,967.1	17.5	15.9	-129.02	554.0	154.9	289.8	258.5	31.23	9.280		
7,100.0	7,058.8	7,093.4	7,066.5	17.8	16.1	-129.05	562.8	157.4	294.4	262.8	31.69	9.292		
7,200.0	7,158.2	7,193.2	7,165.9	18.0	16.4	-145.15	570.8	159.9	299.1	267.0	32.10	9.319		
7,300.0	7,257.8	7,292.4	7,264.8	18.1	16.4	119.38	565.7	162.4	303.9	271.8	32.10	9.467		
7,400.0	7,355.2	7,391.4	7,361.2	18.1	16.3	102.02	543.8	164.9	308.5	276.7	31.77	9.710		
7,500.0	7,447.5	7,490.2	7,452.2	17.9	16.0	96.56	505.7	167.2	312.8	281.7	31.18	10.033		
7,600.0	7,531.9	7,588.8	7,535.2	17.6	15.6	93.82	452.6	169.3	316.8	286.4	30.42	10.414		
7,700.0	7,605.9	7,687.3	7,607.7	17.3	15.2	92.16	386.2	171.1	320.3	290.7	29.61	10.818		
7,800.0	7,667.1	7,785.8	7,667.8	16.9	14.8	91.10	308.3	172.6	323.2	294.4	28.86	11.199		
7,900.0	7,713.8	7,884.2	7,713.8	16.7	14.5	90.44	221.4	173.8	325.4	297.1	28.31	11.497		
8,000.0	7,744.5	7,982.7	7,744.1	16.6	14.4	90.08	127.9	174.6	326.9	298.8	28.05	11.655		
8,100.0	7,758.2	8,081.2	7,758.1	16.6	14.4	89.98	30.5	174.9	327.5	299.4	28.15	11.633		
8,200.0	7,759.0	8,180.7	7,759.0	16.9	14.7	90.00	-69.0	174.9	327.6	298.9	28.67	11.424		
8,300.0	7,759.0	8,280.7	7,759.0	17.2	15.1	90.00	-169.0	174.9	327.6	298.0	29.60	11.068		
8,400.0	7,759.0	8,380.7	7,759.0	17.8	15.7	90.00	-269.0	174.9	327.6	296.7	30.89	10.604		
8,500.0	7,759.0	8,480.7	7,759.0	18.5	16.5	90.00	-369.0	174.9	327.6	295.1	32.51	10.075		
8,600.0	7,759.0	8,580.7	7,759.0	19.4	17.5	90.00	-469.0	174.9	327.6	293.1	34.42	9.518		
8,700.0	7,759.0	8,680.7	7,759.0	20.3	18.5	90.00	-569.0	174.9	327.6	291.0	36.56	8.960		
8,800.0	7,759.0	8,780.7	7,759.0	21.4	19.7	90.00	-669.0	174.9	327.6	288.7	38.90	8.421		
8,900.0	7,759.0	8,880.7	7,759.0	22.5	20.9	90.00	-769.0	174.9	327.6	286.2	41.41	7.911		
9,000.0	7,759.0	8,980.7	7,759.0	23.8	22.2	90.00	-869.0	174.9	327.6	283.5	44.05	7.436		
9,100.0	7,759.0	9,080.7	7,759.0	25.1	23.6	90.00	-969.0	174.9	327.6	280.8	46.81	6.998		
9,200.0	7,759.0	9,180.7	7,759.0	26.4	25.0	90.00	-1,069.0	174.9	327.6	277.9	49.66	6.596		
9,300.0	7,759.0	9,280.7	7,759.0	27.8	26.4	90.00	-1,169.0	174.9	327.6	275.0	52.59	6.228		
9,400.0	7,759.0	9,380.7	7,759.0	29.2	27.9	90.00	-1,269.0	174.9	327.6	272.0	55.59	5.892		
9,500.0	7,759.0	9,480.7	7,759.0	30.7	29.4	90.00	-1,369.0	174.9	327.6	268.9	58.64	5.586		
9,600.0	7,759.0	9,580.7	7,759.0	32.2	31.0	90.00	-1,469.0	174.9	327.6	265.8	61.75	5.305		
9,700.0	7,759.0	9,680.7	7,759.0	33.7	32.6	90.00	-1,569.0	174.9	327.6	262.7	64.89	5.048		
9,800.0	7,759.0	9,780.7	7,759.0	35.2	34.1	90.00	-1,669.0	174.9	327.6	259.5	68.07	4.812		
9,900.0	7,759.0	9,880.7	7,759.0	36.8	35.7	90.00	-1,769.0	174.9	327.6	256.3	71.28	4.595		
10,000.0	7,759.0	9,980.7	7,759.0	38.3	37.3	90.00	-1,869.0	174.9	327.6	253.0	74.52	4.396		
10,100.0	7,759.0	10,080.7	7,759.0	39.9	39.0	90.00	-1,969.0	174.9	327.6	249.8	77.78	4.211		
10,200.0	7,759.0	10,180.7	7,759.0	41.5	40.6	90.00	-2,069.0	174.9	327.6	246.5	81.06	4.041		

CC - Min centre to center distance or convergent point, SF - min separation factor, ES - min ellipse separation

# Anticollision Report

<b>Company:</b>	EnCana Oil & Gas (USA) Inc	<b>Local Co-ordinate Reference:</b>	Well Woolley-Sosa 2D-7H-E168
<b>Project:</b>	DJ Wattenberg	<b>TVD Reference:</b>	WELL @ 5019.0ft (Original Well Elev)
<b>Reference Site:</b>	S7-T1N-R68W (Woolley-Sosa/Becky)	<b>MD Reference:</b>	WELL @ 5019.0ft (Original Well Elev)
<b>Site Error:</b>	0.0ft	<b>North Reference:</b>	True
<b>Reference Well:</b>	Woolley-Sosa 2D-7H-E168	<b>Survey Calculation Method:</b>	Minimum Curvature
<b>Well Error:</b>	0.0ft	<b>Output errors are at</b>	2.00 sigma
<b>Reference Wellbore</b>	HZ	<b>Database:</b>	USA EDM 5000 Multi Users DB
<b>Reference Design:</b>	Plan #1	<b>Offset TVD Reference:</b>	Offset Datum

Offset Design S7-T1N-R68W (Woolley-Sosa/Becky) - Woolley-Sosa 2C-7H-E168 - HZ - Plan #1													Offset Site Error:	0.0 ft
Survey Program: 0-Geolink MWD													Offset Well Error:	0.0 ft
Reference		Offset		Semi Major Axis			Distance						Warning	
Measured Depth (ft)	Vertical Depth (ft)	Measured Depth (ft)	Vertical Depth (ft)	Reference (ft)	Offset (ft)	Highside Toolface (°)	Offset Wellbore Centre +N/-S (ft)	+E/-W (ft)	Between Centres (ft)	Between Ellipses (ft)	Total Uncertainty Axis	Separation Factor		
10,300.0	7,759.0	10,280.7	7,759.0	43.1	42.2	90.00	-2,169.0	174.9	327.6	243.2	84.36	3.883		
10,400.0	7,759.0	10,380.7	7,759.0	44.8	43.9	90.00	-2,269.0	174.9	327.6	239.9	87.68	3.736		
10,500.0	7,759.0	10,480.7	7,759.0	46.4	45.6	90.00	-2,369.0	174.9	327.6	236.6	91.01	3.599		
10,600.0	7,759.0	10,580.7	7,759.0	48.0	47.2	90.00	-2,469.0	174.9	327.6	233.2	94.36	3.472		
10,700.0	7,759.0	10,680.7	7,759.0	49.7	48.9	90.00	-2,569.0	174.9	327.6	229.9	97.71	3.352		
10,800.0	7,759.0	10,780.7	7,759.0	51.4	50.6	90.00	-2,669.0	174.9	327.6	226.5	101.08	3.241		
10,900.0	7,759.0	10,880.7	7,759.0	53.0	52.3	90.00	-2,769.0	174.9	327.6	223.1	104.45	3.136		
11,000.0	7,759.0	10,980.7	7,759.0	54.7	54.0	90.00	-2,869.0	174.9	327.6	219.7	107.83	3.038		
11,100.0	7,759.0	11,080.7	7,759.0	56.4	55.7	90.00	-2,969.0	174.9	327.6	216.3	111.22	2.945		
11,200.0	7,759.0	11,180.7	7,759.0	58.0	57.3	90.00	-3,069.0	174.9	327.6	212.9	114.62	2.858		
11,300.0	7,759.0	11,280.7	7,759.0	59.7	59.0	90.00	-3,169.0	174.9	327.6	209.5	118.03	2.775		
11,400.0	7,759.0	11,380.7	7,759.0	61.4	60.7	90.00	-3,269.0	174.9	327.6	206.1	121.44	2.697		
11,500.0	7,759.0	11,480.7	7,759.0	63.1	62.5	90.00	-3,369.0	174.9	327.6	202.7	124.85	2.624		
11,600.0	7,759.0	11,580.7	7,759.0	64.8	64.2	90.00	-3,469.0	174.9	329.3	200.7	128.60	2.561		
11,700.0	7,759.0	11,680.5	7,759.0	66.5	65.9	90.00	-3,568.8	174.9	334.5	202.3	132.21	2.530		
11,800.0	7,759.0	11,780.3	7,759.0	68.2	67.6	90.00	-3,668.6	174.9	341.5	205.9	135.63	2.518		
11,900.0	7,759.0	11,880.1	7,759.0	69.9	69.3	90.00	-3,768.4	174.9	348.5	209.4	139.06	2.506		
12,000.0	7,759.0	11,979.8	7,759.0	71.7	71.0	90.00	-3,868.1	174.9	355.5	213.0	142.49	2.495		
12,100.0	7,759.0	12,079.6	7,759.0	73.4	72.7	90.00	-3,967.9	174.9	362.4	216.5	145.92	2.484		
12,200.0	7,759.0	12,179.3	7,759.0	75.1	74.4	90.00	-4,067.6	174.9	369.4	220.1	149.36	2.473		
12,300.0	7,759.0	12,279.1	7,759.0	76.8	76.2	90.00	-4,167.4	174.9	376.4	223.6	152.80	2.463		
12,400.0	7,759.0	12,378.8	7,759.0	78.5	77.9	90.00	-4,267.1	174.9	383.4	227.1	156.24	2.454		
12,500.0	7,759.0	12,478.6	7,759.0	80.3	79.6	90.00	-4,366.9	174.9	389.9	230.3	159.62	2.443		
12,600.0	7,759.0	12,578.6	7,759.0	82.0	81.3	90.00	-4,466.9	174.9	393.4	230.6	162.81	2.416		
12,700.0	7,759.0	12,678.6	7,759.0	83.7	83.0	90.00	-4,566.8	174.9	393.4	227.6	165.83	2.372		
12,800.0	7,759.0	12,778.5	7,759.0	85.4	84.8	90.00	-4,666.8	174.9	391.4	222.2	169.25	2.313		
12,900.0	7,759.0	12,878.5	7,759.0	87.1	86.5	90.00	-4,766.8	174.9	389.4	216.7	172.71	2.255		
13,000.0	7,759.0	12,978.5	7,759.0	88.8	88.2	90.00	-4,866.8	174.9	387.4	211.3	176.17	2.199		
13,100.0	7,759.0	13,078.5	7,759.0	90.5	90.0	90.00	-4,966.8	174.9	385.4	205.8	179.63	2.146		
13,200.0	7,759.0	13,178.5	7,759.0	92.3	91.7	90.00	-5,066.7	174.9	383.4	200.3	183.10	2.094		
13,300.0	7,759.0	13,278.4	7,759.0	94.0	93.4	90.00	-5,166.7	174.9	381.4	194.9	186.56	2.045		
13,400.0	7,759.0	13,378.4	7,759.0	95.7	95.2	90.00	-5,266.7	174.9	379.4	189.4	190.03	1.997		
13,500.0	7,759.0	13,478.4	7,759.0	97.4	96.9	90.00	-5,366.7	174.9	377.4	183.9	193.50	1.951		
13,600.0	7,759.0	13,578.4	7,759.0	99.2	98.6	90.00	-5,466.7	174.9	375.5	178.5	196.97	1.906		
13,700.0	7,759.0	13,678.4	7,759.0	100.9	100.4	90.00	-5,566.6	174.9	373.5	173.0	200.45	1.863		
13,800.0	7,759.0	13,778.3	7,759.0	102.6	102.1	90.00	-5,666.6	174.9	371.5	167.5	203.92	1.822		
13,900.0	7,759.0	13,878.3	7,759.0	104.3	103.8	90.00	-5,766.6	174.9	369.5	162.1	207.39	1.781		
14,000.0	7,759.0	13,978.3	7,759.0	106.1	105.6	90.00	-5,866.6	174.9	367.5	156.6	210.87	1.743		
14,100.0	7,759.0	14,078.3	7,759.0	107.8	107.3	90.00	-5,966.6	174.9	365.5	151.1	214.35	1.705		
14,200.0	7,759.0	14,178.3	7,759.0	109.5	109.0	90.00	-6,066.5	174.9	363.5	145.7	217.83	1.669		
14,300.0	7,759.0	14,278.2	7,759.0	111.3	110.8	90.00	-6,166.5	174.9	361.5	140.2	221.30	1.633		
14,400.0	7,759.0	14,378.2	7,759.0	113.0	112.5	90.00	-6,266.5	174.9	359.5	134.7	224.78	1.599		
14,500.0	7,759.0	14,478.2	7,759.0	114.7	114.3	90.00	-6,366.5	174.9	357.5	129.2	228.26	1.566		
14,600.0	7,759.0	14,578.2	7,759.0	116.4	116.0	90.00	-6,466.5	174.9	355.5	123.8	231.75	1.534		
14,700.0	7,759.0	14,678.2	7,759.0	118.2	117.7	90.00	-6,566.4	174.9	353.5	118.3	235.23	1.503		
14,800.0	7,759.0	14,778.1	7,759.0	119.9	119.5	90.00	-6,666.4	174.9	351.5	112.8	238.71	1.473 Level 3		
14,900.0	7,759.0	14,878.1	7,759.0	121.6	121.2	90.00	-6,766.4	174.9	349.5	107.3	242.19	1.443 Level 3		
15,000.0	7,759.0	14,978.1	7,759.0	123.4	123.0	90.00	-6,866.4	174.9	347.5	101.8	245.68	1.415 Level 3		
15,100.0	7,759.0	15,078.1	7,759.0	125.1	124.7	90.00	-6,966.4	174.9	345.5	96.4	249.16	1.387 Level 3		
15,200.0	7,759.0	15,178.1	7,759.0	126.9	126.5	90.00	-7,066.4	174.9	343.5	90.9	252.65	1.360 Level 3		
15,300.0	7,759.0	15,278.0	7,759.0	128.6	128.2	90.00	-7,166.3	174.9	341.5	85.4	256.14	1.333 Level 3		
15,400.0	7,759.0	15,378.0	7,759.0	130.3	129.9	90.00	-7,266.3	174.9	339.5	79.9	259.62	1.308 Level 3		

CC - Min centre to center distance or convergent point, SF - min separation factor, ES - min ellipse separation

# Anticollision Report

<b>Company:</b>	EnCana Oil & Gas (USA) Inc	<b>Local Co-ordinate Reference:</b>	Well Woolley-Sosa 2D-7H-E168
<b>Project:</b>	DJ Wattenberg	<b>TVD Reference:</b>	WELL @ 5019.0ft (Original Well Elev)
<b>Reference Site:</b>	S7-T1N-R68W (Woolley-Sosa/Becky)	<b>MD Reference:</b>	WELL @ 5019.0ft (Original Well Elev)
<b>Site Error:</b>	0.0ft	<b>North Reference:</b>	True
<b>Reference Well:</b>	Woolley-Sosa 2D-7H-E168	<b>Survey Calculation Method:</b>	Minimum Curvature
<b>Well Error:</b>	0.0ft	<b>Output errors are at</b>	2.00 sigma
<b>Reference Wellbore</b>	HZ	<b>Database:</b>	USA EDM 5000 Multi Users DB
<b>Reference Design:</b>	Plan #1	<b>Offset TVD Reference:</b>	Offset Datum

<b>Offset Design</b> S7-T1N-R68W (Woolley-Sosa/Becky) - Woolley-Sosa 2C-7H-E168 - HZ - Plan #1												<b>Offset Site Error:</b>	0.0 ft
Survey Program: 0-Geolink MWD												<b>Offset Well Error:</b>	0.0 ft
Reference		Offset		Semi Major Axis		Distance							
Measured Depth (ft)	Vertical Depth (ft)	Measured Depth (ft)	Vertical Depth (ft)	Reference (ft)	Offset (ft)	Highside Toolface (°)	Offset Wellbore Centre +N/-S (ft)	+E/-W (ft)	Between Centres (ft)	Between Ellipses (ft)	Total Uncertainty Axis	Separation Factor	Warning
15,500.0	7,759.0	15,478.0	7,759.0	132.1	131.7	90.00	-7,366.3	174.9	337.5	74.4	263.11	1.283	Level 3
15,600.0	7,759.0	15,578.0	7,759.0	133.8	133.4	90.00	-7,466.3	174.9	335.5	69.0	266.60	1.259	Level 3
15,700.0	7,759.0	15,678.0	7,759.0	135.5	135.2	90.00	-7,566.3	174.9	333.6	63.5	270.09	1.235	Level 2
15,800.0	7,759.0	15,777.9	7,759.0	137.3	136.9	90.00	-7,666.2	174.9	331.6	58.0	273.58	1.212	Level 2
15,900.0	7,759.0	15,877.9	7,759.0	139.0	138.7	90.00	-7,766.2	174.9	329.6	52.5	277.07	1.189	Level 2
16,000.0	7,759.0	15,974.5	7,759.0	140.8	140.3	90.00	-7,862.8	174.9	327.6	47.1	280.50	1.168	Level 2
16,000.2	7,759.0	15,974.5	7,759.0	140.8	140.3	90.00	-7,862.8	174.9	327.6	47.1	280.50	1.168	Level 2, SF

# Anticollision Report

<b>Company:</b>	EnCana Oil & Gas (USA) Inc	<b>Local Co-ordinate Reference:</b>	Well Woolley-Sosa 2D-7H-E168
<b>Project:</b>	DJ Wattenberg	<b>TVD Reference:</b>	WELL @ 5019.0ft (Original Well Elev)
<b>Reference Site:</b>	S7-T1N-R68W (Woolley-Sosa/Becky)	<b>MD Reference:</b>	WELL @ 5019.0ft (Original Well Elev)
<b>Site Error:</b>	0.0ft	<b>North Reference:</b>	True
<b>Reference Well:</b>	Woolley-Sosa 2D-7H-E168	<b>Survey Calculation Method:</b>	Minimum Curvature
<b>Well Error:</b>	0.0ft	<b>Output errors are at</b>	2.00 sigma
<b>Reference Wellbore</b>	HZ	<b>Database:</b>	USA EDM 5000 Multi Users DB
<b>Reference Design:</b>	Plan #1	<b>Offset TVD Reference:</b>	Offset Datum

Offset Design S7-T1N-R68W (Woolley-Sosa/Becky) - Woolley-Sosa 2E-7H-E168 - HZ - Plan #1													Offset Site Error:	0.0 ft
Survey Program: O-Geolink MWD													Offset Well Error:	0.0 ft
Reference		Offset		Semi Major Axis			Distance						Warning	
Measured Depth (ft)	Vertical Depth (ft)	Measured Depth (ft)	Vertical Depth (ft)	Reference (ft)	Offset (ft)	Highside Toolface (°)	Offset Wellbore Centre +N/-S (ft)	+E/-W (ft)	Between Centres (ft)	Between Ellipses (ft)	Total Uncertainty Axis	Separation Factor		
0.0	0.0	0.0	0.0	0.0	0.0	112.09	-6.1	15.0	16.2					
100.0	100.0	100.0	100.0	0.1	0.1	112.09	-6.1	15.0	16.2	15.9	0.26	61.709		
200.0	200.0	200.0	200.0	0.3	0.3	112.09	-6.1	15.0	16.2	15.5	0.61	26.447		
300.0	300.0	300.0	300.0	0.5	0.5	112.09	-6.1	15.0	16.2	15.2	0.96	16.830		
400.0	400.0	400.0	400.0	0.7	0.7	112.09	-6.1	15.0	16.2	14.8	1.31	12.342		
500.0	500.0	500.0	500.0	0.8	0.8	112.09	-6.1	15.0	16.2	14.5	1.66	9.744		
600.0	600.0	600.0	600.0	1.0	1.0	76.47	-6.1	15.0	15.9	13.9	2.01	7.935		
700.0	700.0	700.0	700.0	1.2	1.2	85.90	-6.1	15.0	15.5	13.2	2.36	6.580		
729.6	729.5	729.5	729.5	1.2	1.2	90.00	-6.1	15.0	15.5	13.0	2.47	6.282 CC, ES		
800.0	799.9	799.9	799.9	1.4	1.4	101.84	-6.1	15.0	15.8	13.1	2.72	5.825		
900.0	899.7	899.7	899.7	1.6	1.5	121.08	-6.1	15.0	18.1	15.0	3.07	5.885		
1,000.0	999.4	999.4	999.4	1.8	1.7	137.90	-6.1	15.0	23.1	19.7	3.43	6.756		
1,100.0	1,098.9	1,099.3	1,099.3	2.0	1.9	148.73	-5.6	15.7	30.3	26.6	3.77	8.040		
1,200.0	1,198.3	1,199.3	1,199.3	2.2	2.1	154.67	-4.0	17.7	38.3	34.2	4.12	9.292		
1,300.0	1,297.6	1,299.6	1,299.5	2.5	2.2	157.42	-1.3	21.2	45.4	41.0	4.48	10.150		
1,400.0	1,396.9	1,400.2	1,399.8	2.7	2.4	158.30	2.4	26.1	51.2	46.4	4.84	10.588		
1,500.0	1,496.3	1,500.8	1,500.2	3.0	2.6	157.95	7.1	32.4	55.6	50.4	5.21	10.674		
1,600.0	1,595.6	1,601.6	1,600.5	3.2	2.8	156.62	13.0	40.1	58.6	53.0	5.60	10.472		
1,700.0	1,694.9	1,702.4	1,700.6	3.5	3.1	154.37	19.9	49.2	60.2	54.2	6.00	10.038		
1,800.0	1,794.3	1,803.1	1,800.5	3.7	3.3	151.12	27.8	59.8	60.7	54.2	6.44	9.423		
1,900.0	1,893.6	1,903.7	1,900.0	4.0	3.6	146.72	36.9	71.7	60.1	53.2	6.93	8.677		
2,000.0	1,992.9	2,003.9	1,998.8	4.2	3.8	141.14	46.7	84.7	59.0	51.5	7.48	7.888		
2,100.0	2,092.3	2,103.7	2,097.2	4.5	4.1	135.27	56.7	97.8	58.3	50.2	8.07	7.225		
2,154.0	2,145.9	2,157.6	2,150.4	4.6	4.3	132.06	62.0	104.9	58.2	49.8	8.41	6.922		
2,200.0	2,191.6	2,203.5	2,195.7	4.8	4.4	129.33	66.6	110.9	58.3	49.6	8.71	6.696		
2,300.0	2,290.9	2,303.3	2,294.1	5.0	4.7	123.45	76.5	124.1	58.9	49.5	9.36	6.289		
2,400.0	2,390.3	2,403.1	2,392.6	5.3	5.0	117.74	86.5	137.2	60.1	50.1	10.03	5.991		
2,500.0	2,489.6	2,503.0	2,491.0	5.5	5.3	112.31	96.4	150.3	61.9	51.2	10.69	5.786		
2,600.0	2,588.9	2,602.8	2,589.5	5.8	5.6	107.23	106.3	163.4	64.2	52.8	11.34	5.659		
2,700.0	2,688.3	2,702.6	2,687.9	6.1	6.0	102.53	116.3	176.6	66.9	55.0	11.97	5.595		
2,800.0	2,787.6	2,802.4	2,786.4	6.3	6.3	98.23	126.2	189.7	70.1	57.6	12.57	5.581		
2,900.0	2,886.9	2,902.2	2,884.8	6.6	6.6	94.32	136.1	202.8	73.7	60.5	13.14	5.607		
3,000.0	2,986.2	3,002.0	2,983.3	6.9	6.9	90.79	146.1	215.9	77.5	63.8	13.69	5.662		
3,100.0	3,085.6	3,101.9	3,081.7	7.1	7.2	87.60	156.0	229.0	81.7	67.4	14.23	5.740		
3,200.0	3,184.9	3,201.7	3,180.2	7.4	7.6	84.72	166.0	242.2	86.0	71.3	14.74	5.835		
3,300.0	3,284.2	3,301.5	3,278.6	7.6	7.9	82.13	175.9	255.3	90.6	75.3	15.24	5.942		
3,400.0	3,383.6	3,401.3	3,377.1	7.9	8.2	79.78	185.8	268.4	95.3	79.5	15.73	6.057		
3,500.0	3,482.9	3,501.1	3,475.5	8.2	8.5	77.67	195.8	281.5	100.1	83.9	16.21	6.178		
3,600.0	3,582.2	3,600.9	3,574.0	8.4	8.9	75.75	205.7	294.7	105.1	88.4	16.68	6.302		
3,700.0	3,681.6	3,700.8	3,672.4	8.7	9.2	74.00	215.6	307.8	110.2	93.1	17.14	6.429		
3,800.0	3,780.9	3,800.6	3,770.9	9.0	9.5	72.41	225.6	320.9	115.4	97.8	17.60	6.556		
3,900.0	3,880.2	3,900.4	3,869.3	9.2	9.9	70.96	235.5	334.0	120.6	102.6	18.06	6.682		
4,000.0	3,979.6	4,000.2	3,967.8	9.5	10.2	69.63	245.4	347.1	126.0	107.5	18.51	6.808		
4,100.0	4,078.9	4,100.0	4,066.2	9.8	10.5	68.41	255.4	360.3	131.4	112.4	18.95	6.931		
4,200.0	4,178.2	4,199.8	4,164.7	10.0	10.9	67.28	265.3	373.4	136.8	117.4	19.40	7.053		
4,300.0	4,277.6	4,299.7	4,263.1	10.3	11.2	66.25	275.3	386.5	142.3	122.5	19.84	7.172		
4,400.0	4,376.9	4,399.5	4,361.6	10.6	11.5	65.29	285.2	399.6	147.9	127.6	20.29	7.289		
4,500.0	4,476.2	4,499.3	4,460.0	10.8	11.9	64.39	295.1	412.8	153.5	132.7	20.73	7.403		
4,600.0	4,575.6	4,599.1	4,558.5	11.1	12.2	63.57	305.1	425.9	159.1	137.9	21.17	7.514		
4,700.0	4,674.9	4,698.9	4,656.9	11.4	12.5	62.79	315.0	439.0	164.7	143.1	21.61	7.623		
4,800.0	4,774.2	4,798.7	4,755.4	11.6	12.9	62.07	324.9	452.1	170.4	148.3	22.05	7.728		
4,900.0	4,873.5	4,898.6	4,853.8	11.9	13.2	61.40	334.9	465.2	176.1	153.6	22.49	7.831		

CC - Min centre to center distance or convergent point, SF - min separation factor, ES - min ellipse separation

# Anticollision Report

<b>Company:</b>	EnCana Oil & Gas (USA) Inc	<b>Local Co-ordinate Reference:</b>	Well Woolley-Sosa 2D-7H-E168
<b>Project:</b>	DJ Wattenberg	<b>TVD Reference:</b>	WELL @ 5019.0ft (Original Well Elev)
<b>Reference Site:</b>	S7-T1N-R68W (Woolley-Sosa/Becky)	<b>MD Reference:</b>	WELL @ 5019.0ft (Original Well Elev)
<b>Site Error:</b>	0.0ft	<b>North Reference:</b>	True
<b>Reference Well:</b>	Woolley-Sosa 2D-7H-E168	<b>Survey Calculation Method:</b>	Minimum Curvature
<b>Well Error:</b>	0.0ft	<b>Output errors are at</b>	2.00 sigma
<b>Reference Wellbore</b>	HZ	<b>Database:</b>	USA EDM 5000 Multi Users DB
<b>Reference Design:</b>	Plan #1	<b>Offset TVD Reference:</b>	Offset Datum

Offset Design S7-T1N-R68W (Woolley-Sosa/Becky) - Woolley-Sosa 2E-7H-E168 - HZ - Plan #1													Offset Site Error:	0.0 ft
Survey Program: O-Geolink MWD													Offset Well Error:	0.0 ft
Reference		Offset		Semi Major Axis			Distance							
Measured Depth (ft)	Vertical Depth (ft)	Measured Depth (ft)	Vertical Depth (ft)	Reference (ft)	Offset (ft)	Highside Toolface (°)	Offset Wellbore Centre +N/-S (ft)	+E/-W (ft)	Between Centres (ft)	Between Ellipses (ft)	Total Uncertainty Axis	Separation Factor	Warning	
5,000.0	4,972.9	4,998.4	4,952.3	12.2	13.5	60.77	344.8	478.4	181.8	158.9	22.93	7.930		
5,100.0	5,072.2	5,098.2	5,050.7	12.4	13.9	60.18	354.7	491.5	187.6	164.2	23.37	8.027		
5,200.0	5,171.5	5,198.0	5,149.2	12.7	14.2	59.62	364.7	504.6	193.3	169.5	23.80	8.122		
5,300.0	5,270.9	5,297.8	5,247.6	13.0	14.5	59.09	374.6	517.7	199.1	174.9	24.24	8.213		
5,400.0	5,370.2	5,397.6	5,346.1	13.2	14.9	58.60	384.6	530.9	204.9	180.2	24.68	8.303		
5,500.0	5,469.5	5,497.5	5,444.5	13.5	15.2	58.13	394.5	544.0	210.7	185.6	25.12	8.389		
5,600.0	5,568.9	5,597.3	5,543.0	13.8	15.5	57.69	404.4	557.1	216.5	191.0	25.55	8.473		
5,700.0	5,668.2	5,697.1	5,641.4	14.0	15.9	57.27	414.4	570.2	222.4	196.4	25.99	8.555		
5,800.0	5,767.5	5,796.9	5,739.9	14.3	16.2	56.87	424.3	583.3	228.2	201.8	26.43	8.635		
5,900.0	5,866.9	5,896.7	5,838.3	14.6	16.5	56.49	434.2	596.5	234.1	207.2	26.87	8.712		
6,000.0	5,966.2	5,996.5	5,936.8	14.8	16.9	56.13	444.2	609.6	239.9	212.6	27.31	8.787		
6,100.0	6,065.5	6,096.4	6,035.2	15.1	17.2	55.79	454.1	622.7	245.8	218.1	27.74	8.860		
6,200.0	6,164.9	6,196.2	6,133.7	15.4	17.5	55.46	464.0	635.8	251.7	223.5	28.18	8.931		
6,300.0	6,264.2	6,296.0	6,232.1	15.6	17.9	55.15	474.0	649.0	257.6	229.0	28.62	9.001		
6,400.0	6,363.5	6,395.8	6,330.6	15.9	18.2	54.85	483.9	662.1	263.5	234.4	29.06	9.068		
6,500.0	6,462.9	6,495.6	6,429.0	16.2	18.5	54.56	493.9	675.2	269.4	239.9	29.50	9.134		
6,600.0	6,562.2	6,595.4	6,527.5	16.4	18.9	54.29	503.8	688.3	275.3	245.4	29.93	9.197		
6,700.0	6,661.5	6,695.3	6,625.9	16.7	19.2	54.03	513.7	701.4	281.2	250.9	30.37	9.260		
6,800.0	6,760.9	6,795.1	6,724.4	17.0	19.6	53.78	523.7	714.6	287.2	256.3	30.81	9.320		
6,900.0	6,860.2	6,894.9	6,822.8	17.2	19.9	53.54	533.6	727.7	293.1	261.8	31.25	9.379		
7,000.0	6,959.5	6,994.7	6,921.3	17.5	20.2	53.31	543.5	740.8	299.0	267.3	31.69	9.437		
7,100.0	7,058.8	7,094.5	7,019.7	17.8	20.6	53.09	553.5	753.9	305.0	272.8	32.13	9.493		
7,200.0	7,158.2	7,194.3	7,118.2	18.0	20.9	37.03	563.4	767.1	310.9	278.3	32.57	9.546		
7,300.0	7,257.8	7,293.0	7,215.8	18.1	21.2	-58.51	567.4	780.1	316.7	284.2	32.57	9.725		
7,400.0	7,355.2	7,392.7	7,313.7	18.1	21.3	-76.02	554.4	793.1	322.6	290.4	32.19	10.021		
7,500.0	7,447.5	7,493.8	7,409.2	17.9	21.2	-81.67	524.0	805.8	328.4	296.9	31.54	10.411		
7,600.0	7,531.9	7,596.5	7,499.1	17.6	21.1	-84.63	476.3	817.8	333.9	303.2	30.71	10.870		
7,700.0	7,605.9	7,700.6	7,580.2	17.3	20.9	-86.54	412.2	828.6	338.8	309.0	29.82	11.361		
7,800.0	7,667.1	7,806.0	7,649.4	16.9	20.7	-87.88	333.3	837.9	343.1	314.1	29.01	11.827		
7,900.0	7,713.8	7,912.7	7,703.5	16.7	20.5	-88.85	241.9	845.1	346.4	318.0	28.40	12.197		
8,000.0	7,744.5	8,020.4	7,740.3	16.6	20.4	-89.51	140.9	850.0	348.7	320.6	28.12	12.402		
8,100.0	7,758.2	8,128.8	7,757.7	16.6	20.5	-89.92	34.1	852.3	349.8	321.6	28.22	12.396		
8,200.0	7,759.0	8,232.0	7,759.0	16.9	20.6	-90.00	-69.0	852.5	350.0	321.2	28.75	12.171		
8,300.0	7,759.0	8,332.0	7,759.0	17.2	20.9	-90.00	-169.0	852.5	350.0	320.3	29.67	11.795		
8,400.0	7,759.0	8,432.0	7,759.0	17.8	21.4	-90.00	-269.0	852.5	350.0	319.0	30.96	11.303		
8,445.5	7,759.0	8,477.4	7,759.0	18.1	21.6	-90.00	-314.5	852.5	350.0	318.3	31.67	11.049		
8,500.0	7,759.0	8,528.5	7,759.0	18.5	22.0	-90.00	-365.5	852.6	350.1	317.6	32.55	10.757		
8,600.0	7,759.0	8,617.5	7,759.0	19.4	22.6	-90.00	-454.5	854.9	352.7	318.3	34.32	10.275		
8,700.0	7,759.0	8,713.4	7,759.0	20.3	23.4	-90.00	-550.3	859.7	357.7	321.3	36.40	9.827		
8,800.0	7,759.0	8,813.3	7,759.0	21.4	24.4	-90.00	-650.0	864.9	362.9	324.2	38.71	9.374		
8,900.0	7,759.0	8,913.1	7,759.0	22.5	25.4	-90.00	-749.7	870.2	368.2	327.0	41.20	8.936		
9,000.0	7,759.0	9,013.0	7,759.0	23.8	26.5	-90.00	-849.5	875.4	373.4	329.6	43.82	8.520		
9,100.0	7,759.0	9,112.9	7,759.0	25.1	27.7	-90.00	-949.2	880.6	378.6	332.1	46.56	8.131		
9,200.0	7,759.0	9,212.7	7,759.0	26.4	29.0	-90.00	-1,048.9	885.8	383.9	334.5	49.40	7.770		
9,300.0	7,759.0	9,312.6	7,759.0	27.8	30.2	-90.00	-1,148.6	891.1	389.1	336.8	52.32	7.437		
9,400.0	7,759.0	9,414.4	7,759.0	29.2	31.6	-90.00	-1,250.4	896.4	394.3	339.0	55.34	7.125		
9,500.0	7,759.0	9,530.4	7,759.0	30.7	33.2	-90.00	-1,366.3	899.5	397.0	338.4	58.63	6.771		
9,600.0	7,759.0	9,636.0	7,759.0	32.2	34.6	-90.00	-1,471.9	899.0	396.5	334.7	61.82	6.414		
9,700.0	7,759.0	9,736.0	7,759.0	33.7	36.0	-90.00	-1,571.9	898.3	395.8	330.8	64.97	6.092		
9,800.0	7,759.0	9,836.0	7,759.0	35.2	37.4	-90.00	-1,671.9	897.6	395.1	326.9	68.14	5.797		
9,900.0	7,759.0	9,936.0	7,759.0	36.8	38.9	-90.00	-1,771.9	896.8	394.3	323.0	71.36	5.526		
10,000.0	7,759.0	10,036.0	7,759.0	38.3	40.4	-90.00	-1,871.9	896.1	393.6	319.0	74.59	5.277		

CC - Min centre to center distance or convergent point, SF - min separation factor, ES - min ellipse separation

# Anticollision Report

<b>Company:</b>	EnCana Oil & Gas (USA) Inc	<b>Local Co-ordinate Reference:</b>	Well Woolley-Sosa 2D-7H-E168
<b>Project:</b>	DJ Wattenberg	<b>TVD Reference:</b>	WELL @ 5019.0ft (Original Well Elev)
<b>Reference Site:</b>	S7-T1N-R68W (Woolley-Sosa/Becky)	<b>MD Reference:</b>	WELL @ 5019.0ft (Original Well Elev)
<b>Site Error:</b>	0.0ft	<b>North Reference:</b>	True
<b>Reference Well:</b>	Woolley-Sosa 2D-7H-E168	<b>Survey Calculation Method:</b>	Minimum Curvature
<b>Well Error:</b>	0.0ft	<b>Output errors are at</b>	2.00 sigma
<b>Reference Wellbore</b>	HZ	<b>Database:</b>	USA EDM 5000 Multi Users DB
<b>Reference Design:</b>	Plan #1	<b>Offset TVD Reference:</b>	Offset Datum

Offset Design S7-T1N-R68W (Woolley-Sosa/Becky) - Woolley-Sosa 2E-7H-E168 - HZ - Plan #1													Offset Site Error:	0.0 ft
Survey Program: 0-Geolink MWD													Offset Well Error:	0.0 ft
Reference		Offset		Semi Major Axis			Distance				Total Uncertainty Axis	Separation Factor	Warning	
Measured Depth (ft)	Vertical Depth (ft)	Measured Depth (ft)	Vertical Depth (ft)	Reference (ft)	Offset (ft)	Highside Toolface (°)	Offset Wellbore Centre +N/-S (ft)	+E/-W (ft)	Between Centres (ft)	Between Ellipses (ft)				
10,100.0	7,759.0	10,136.0	7,759.0	39.9	41.9	-90.00	-1,971.9	895.4	392.9	315.0	77.85	5.046		
10,200.0	7,759.0	10,236.0	7,759.0	41.5	43.4	-90.00	-2,071.9	894.7	392.2	311.0	81.13	4.833		
10,300.0	7,759.0	10,336.0	7,759.0	43.1	44.9	-90.00	-2,171.8	893.9	391.4	307.0	84.43	4.636		
10,400.0	7,759.0	10,436.0	7,759.0	44.8	46.5	-90.00	-2,271.8	893.2	390.7	303.0	87.75	4.452		
10,500.0	7,759.0	10,536.0	7,759.0	46.4	48.1	-90.00	-2,371.8	892.5	390.0	298.9	91.08	4.282		
10,600.0	7,759.0	10,636.0	7,759.0	48.0	49.7	-90.00	-2,471.8	891.7	389.2	294.8	94.42	4.122		
10,700.0	7,759.0	10,736.0	7,759.0	49.7	51.2	-90.00	-2,571.8	891.0	388.5	290.7	97.78	3.973		
10,800.0	7,759.0	10,836.0	7,759.0	51.4	52.8	-90.00	-2,671.8	890.3	387.8	286.6	101.14	3.834		
10,900.0	7,759.0	10,936.0	7,759.0	53.0	54.5	-90.00	-2,771.8	889.6	387.1	282.5	104.52	3.703		
11,000.0	7,759.0	11,036.0	7,759.0	54.7	56.1	-90.00	-2,871.8	888.8	386.3	278.4	107.90	3.581		
11,100.0	7,759.0	11,136.0	7,759.0	56.4	57.7	-90.00	-2,971.8	888.1	385.6	274.3	111.29	3.465		
11,200.0	7,759.0	11,236.0	7,759.0	58.0	59.3	-90.00	-3,071.8	887.4	384.9	270.2	114.69	3.356		
11,300.0	7,759.0	11,336.0	7,759.0	59.7	61.0	-90.00	-3,171.8	886.7	384.2	266.1	118.09	3.253		
11,400.0	7,759.0	11,436.0	7,759.0	61.4	62.6	-90.00	-3,271.8	885.9	383.4	261.9	121.50	3.156		
11,500.0	7,759.0	11,536.0	7,759.0	63.1	64.3	-90.00	-3,371.8	885.2	382.7	257.8	124.92	3.064		
11,600.0	7,759.0	11,635.9	7,759.0	64.8	65.9	-90.00	-3,471.7	884.5	380.2	251.2	129.07	2.946		
11,700.0	7,759.0	11,735.8	7,759.0	66.5	67.6	-90.00	-3,571.6	883.7	374.3	241.2	133.08	2.812		
11,800.0	7,759.0	11,835.5	7,759.0	68.2	69.3	-90.00	-3,671.3	883.0	366.6	230.1	136.50	2.685		
11,900.0	7,759.0	11,935.2	7,759.0	69.9	70.9	-90.00	-3,771.0	882.3	358.9	218.9	139.93	2.565		
12,000.0	7,759.0	12,034.9	7,759.0	71.7	72.6	-90.00	-3,870.7	881.6	351.2	207.8	143.36	2.450		
12,100.0	7,759.0	12,134.6	7,759.0	73.4	74.3	-90.00	-3,970.4	880.8	343.5	196.7	146.79	2.340		
12,200.0	7,759.0	12,234.3	7,759.0	75.1	76.0	-90.00	-4,070.1	880.1	335.8	185.5	150.22	2.235		
12,300.0	7,759.0	12,334.0	7,759.0	76.8	77.6	-90.00	-4,169.8	879.4	328.1	174.4	153.66	2.135		
12,400.0	7,759.0	12,433.7	7,759.0	78.5	79.3	-90.00	-4,269.5	878.7	320.4	163.3	157.10	2.039		
12,500.0	7,759.0	12,533.4	7,759.0	80.3	81.0	-90.00	-4,369.2	877.9	313.1	152.8	160.28	1.953		
12,600.0	7,759.0	12,633.3	7,759.0	82.0	82.7	-90.00	-4,469.1	877.2	308.9	145.8	163.07	1.894		
12,670.8	7,759.0	12,704.1	7,759.0	83.2	83.9	-90.00	-4,539.9	876.7	308.0	143.1	164.94	1.867		
12,700.0	7,759.0	12,733.3	7,759.0	83.7	84.4	-90.00	-4,569.1	876.5	308.1	142.5	165.68	1.860		
12,800.0	7,759.0	12,833.3	7,759.0	85.4	86.1	-90.00	-4,669.1	875.8	309.4	140.3	169.07	1.830		
12,900.0	7,759.0	12,933.3	7,759.0	87.1	87.8	-90.00	-4,769.1	875.0	310.7	138.1	172.53	1.801		
13,000.0	7,759.0	13,033.3	7,759.0	88.8	89.5	-90.00	-4,869.1	874.3	311.9	136.0	175.99	1.772		
13,100.0	7,759.0	13,133.3	7,759.0	90.5	91.2	-90.00	-4,969.0	873.6	313.2	133.8	179.45	1.745		
13,200.0	7,759.0	13,233.3	7,759.0	92.3	92.9	-90.00	-5,069.0	872.8	314.5	131.6	182.92	1.719		
13,300.0	7,759.0	13,333.3	7,759.0	94.0	94.6	-90.00	-5,169.0	872.1	315.7	129.4	186.39	1.694		
13,400.0	7,759.0	13,433.3	7,759.0	95.7	96.3	-90.00	-5,269.0	871.4	317.0	127.2	189.85	1.670		
13,500.0	7,759.0	13,533.2	7,759.0	97.4	98.1	-90.00	-5,369.0	870.7	318.3	125.0	193.32	1.646		
13,600.0	7,759.0	13,633.2	7,759.0	99.2	99.8	-90.00	-5,469.0	869.9	319.5	122.8	196.80	1.624		
13,700.0	7,759.0	13,733.2	7,759.0	100.9	101.5	-90.00	-5,569.0	869.2	320.8	120.5	200.27	1.602		
13,800.0	7,759.0	13,833.2	7,759.0	102.6	103.2	-90.00	-5,669.0	868.5	322.1	118.3	203.74	1.581		
13,900.0	7,759.0	13,933.2	7,759.0	104.3	104.9	-90.00	-5,769.0	867.8	323.4	116.1	207.22	1.560		
14,000.0	7,759.0	14,033.2	7,759.0	106.1	106.6	-90.00	-5,869.0	867.0	324.6	113.9	210.69	1.541		
14,100.0	7,759.0	14,133.2	7,759.0	107.8	108.4	-90.00	-5,968.9	866.3	325.9	111.7	214.17	1.522		
14,200.0	7,759.0	14,233.2	7,759.0	109.5	110.1	-90.00	-6,068.9	865.6	327.2	109.5	217.65	1.503		
14,300.0	7,759.0	14,333.2	7,759.0	111.3	111.8	-90.00	-6,168.9	864.8	328.4	107.3	221.13	1.485 Level 3		
14,400.0	7,759.0	14,433.2	7,759.0	113.0	113.5	-90.00	-6,268.9	864.1	329.7	105.1	224.61	1.468 Level 3		
14,500.0	7,759.0	14,533.2	7,759.0	114.7	115.2	-90.00	-6,368.9	863.4	331.0	102.9	228.09	1.451 Level 3		
14,600.0	7,759.0	14,633.2	7,759.0	116.4	117.0	-90.00	-6,468.9	862.7	332.2	100.7	231.57	1.435 Level 3		
14,700.0	7,759.0	14,733.1	7,759.0	118.2	118.7	-90.00	-6,568.9	861.9	333.5	98.4	235.05	1.419 Level 3		
14,800.0	7,759.0	14,833.1	7,759.0	119.9	120.4	-90.00	-6,668.9	861.2	334.8	96.2	238.54	1.403 Level 3		
14,900.0	7,759.0	14,933.1	7,759.0	121.6	122.1	-90.00	-6,768.9	860.5	336.0	94.0	242.02	1.388 Level 3		
15,000.0	7,759.0	15,033.1	7,759.0	123.4	123.9	-90.00	-6,868.8	859.8	337.3	91.8	245.51	1.374 Level 3		
15,100.0	7,759.0	15,133.1	7,759.0	125.1	125.6	-90.00	-6,968.8	859.0	338.6	89.6	248.99	1.360 Level 3		

CC - Min centre to center distance or convergent point, SF - min separation factor, ES - min ellipse separation



# Anticollision Report

<b>Company:</b>	EnCana Oil & Gas (USA) Inc	<b>Local Co-ordinate Reference:</b>	Well Woolley-Sosa 2D-7H-E168
<b>Project:</b>	DJ Wattenberg	<b>TVD Reference:</b>	WELL @ 5019.0ft (Original Well Elev)
<b>Reference Site:</b>	S7-T1N-R68W (Woolley-Sosa/Becky)	<b>MD Reference:</b>	WELL @ 5019.0ft (Original Well Elev)
<b>Site Error:</b>	0.0ft	<b>North Reference:</b>	True
<b>Reference Well:</b>	Woolley-Sosa 2D-7H-E168	<b>Survey Calculation Method:</b>	Minimum Curvature
<b>Well Error:</b>	0.0ft	<b>Output errors are at</b>	2.00 sigma
<b>Reference Wellbore</b>	HZ	<b>Database:</b>	USA EDM 5000 Multi Users DB
<b>Reference Design:</b>	Plan #1	<b>Offset TVD Reference:</b>	Offset Datum

Offset Design													S7-T1N-R68W (Woolley-Sosa/Becky) - Woolley-Sosa 2E-7H-E168 - HZ - Plan #1		Offset Site Error:		0.0 ft
Survey Program:													0-Geolink MWD		Offset Well Error:		0.0 ft
Reference		Offset		Semi Major Axis			Distance										
Measured Depth	Vertical Depth	Measured Depth	Vertical Depth	Reference	Offset	Highside Toolface	Offset Wellbore Centre		Between Centres	Between Ellipses	Total Uncertainty Axis	Separation Factor	Warning				
(ft)	(ft)	(ft)	(ft)	(ft)	(ft)	(°)	+N/-S (ft)	+E/-W (ft)	(ft)	(ft)							
15,200.0	7,759.0	15,233.1	7,759.0	126.9	127.3	-90.00	-7,068.8	858.3	339.8	87.4	252.48	1.346	Level 3				
15,300.0	7,759.0	15,333.1	7,759.0	128.6	129.1	-90.00	-7,168.8	857.6	341.1	85.1	255.96	1.333	Level 3				
15,400.0	7,759.0	15,433.1	7,759.0	130.3	130.8	-90.00	-7,268.8	856.8	342.4	82.9	259.45	1.320	Level 3				
15,500.0	7,759.0	15,533.1	7,759.0	132.1	132.5	-90.00	-7,368.8	856.1	343.6	80.7	262.94	1.307	Level 3				
15,600.0	7,759.0	15,633.1	7,759.0	133.8	134.3	-90.00	-7,468.8	855.4	344.9	78.5	266.43	1.295	Level 3				
15,700.0	7,759.0	15,733.1	7,759.0	135.5	136.0	-90.00	-7,568.8	854.7	346.2	76.3	269.92	1.283	Level 3				
15,800.0	7,759.0	15,833.1	7,759.0	137.3	137.7	-90.00	-7,668.8	853.9	347.4	74.0	273.41	1.271	Level 3				
15,900.0	7,759.0	15,933.1	7,759.0	139.0	139.5	-90.00	-7,768.7	853.2	348.7	71.8	276.89	1.259	Level 3				
16,000.0	7,759.0	16,033.0	7,759.0	140.8	141.2	-90.00	-7,868.7	852.5	350.0	69.6	280.39	1.248	Level 2				
16,000.2	7,759.0	16,033.3	7,759.0	140.8	141.2	-90.00	-7,869.0	852.5	350.0	69.6	280.39	1.248	Level 2, SF				

# Anticollision Report

<b>Company:</b>	EnCana Oil & Gas (USA) Inc	<b>Local Co-ordinate Reference:</b>	Well Woolley-Sosa 2D-7H-E168
<b>Project:</b>	DJ Wattenberg	<b>TVD Reference:</b>	WELL @ 5019.0ft (Original Well Elev)
<b>Reference Site:</b>	S7-T1N-R68W (Woolley-Sosa/Becky)	<b>MD Reference:</b>	WELL @ 5019.0ft (Original Well Elev)
<b>Site Error:</b>	0.0ft	<b>North Reference:</b>	True
<b>Reference Well:</b>	Woolley-Sosa 2D-7H-E168	<b>Survey Calculation Method:</b>	Minimum Curvature
<b>Well Error:</b>	0.0ft	<b>Output errors are at</b>	2.00 sigma
<b>Reference Wellbore</b>	HZ	<b>Database:</b>	USA EDM 5000 Multi Users DB
<b>Reference Design:</b>	Plan #1	<b>Offset TVD Reference:</b>	Offset Datum

Offset Design S7-T1N-R68W (Woolley-Sosa/Becky) - Woolley-Sosa 2F-7H-E168 - HZ - Plan #1													Offset Site Error:	0.0 ft
Survey Program: O-Geolink MWD													Offset Well Error:	0.0 ft
Reference		Offset		Semi Major Axis			Distance							Warning
Measured Depth (ft)	Vertical Depth (ft)	Measured Depth (ft)	Vertical Depth (ft)	Reference (ft)	Offset (ft)	Highside Toolface (°)	Offset Wellbore Centre +N/-S (ft)	+E/-W (ft)	Between Centres (ft)	Between Ellipses (ft)	Total Uncertainty Axis	Separation Factor		
0.0	0.0	0.0	0.0	0.0	0.0	90.29	-0.1	20.0	20.0					
100.0	100.0	100.0	100.0	0.1	0.1	90.29	-0.1	20.0	20.0	19.7	0.26	76.394		
200.0	200.0	200.0	200.0	0.3	0.3	90.29	-0.1	20.0	20.0	19.4	0.61	32.740		
300.0	300.0	300.0	300.0	0.5	0.5	90.29	-0.1	20.0	20.0	19.0	0.96	20.835 CC, ES		
400.0	400.0	399.7	399.7	0.7	0.7	89.16	0.3	20.8	20.8	19.5	1.31	15.874		
500.0	500.0	499.3	499.3	0.8	0.8	86.21	1.5	23.1	23.1	21.5	1.66	13.953		
600.0	600.0	598.8	598.7	1.0	1.0	45.11	3.6	26.9	26.5	24.5	2.01	13.211		
700.0	700.0	698.3	698.0	1.2	1.2	44.33	6.4	32.2	30.3	28.0	2.36	12.852		
800.0	799.9	797.7	797.1	1.4	1.4	44.72	10.0	39.1	34.5	31.8	2.72	12.700		
900.0	899.7	897.0	895.9	1.6	1.6	45.88	14.5	47.4	39.1	36.0	3.08	12.672 SF		
1,000.0	999.4	996.2	994.5	1.8	1.9	47.54	19.7	57.3	44.0	40.6	3.46	12.715		
1,100.0	1,098.9	1,095.3	1,092.8	2.0	2.2	49.50	25.8	68.7	49.5	45.6	3.87	12.795		
1,200.0	1,198.3	1,194.3	1,190.7	2.2	2.5	51.55	32.6	81.5	55.4	51.2	4.29	12.915		
1,300.0	1,297.6	1,293.2	1,288.2	2.5	2.8	52.68	40.2	95.8	62.8	58.0	4.73	13.261		
1,400.0	1,396.9	1,391.8	1,385.2	2.7	3.1	52.89	48.6	111.6	71.6	66.4	5.18	13.829		
1,500.0	1,496.3	1,491.2	1,482.8	3.0	3.5	52.72	57.4	128.3	81.3	75.6	5.62	14.448		
1,600.0	1,595.6	1,590.8	1,580.5	3.2	3.8	52.58	66.3	145.0	90.9	84.8	6.07	14.968		
1,700.0	1,694.9	1,690.3	1,678.3	3.5	4.2	52.47	75.2	161.7	100.6	94.0	6.53	15.409		
1,800.0	1,794.3	1,789.8	1,776.0	3.7	4.5	52.38	84.1	178.5	110.2	103.2	6.98	15.787		
1,900.0	1,893.6	1,889.4	1,873.7	4.0	4.9	52.31	93.0	195.2	119.9	112.4	7.44	16.115		
2,000.0	1,992.9	1,988.9	1,971.4	4.2	5.3	52.24	101.9	211.9	129.5	121.6	7.90	16.402		
2,100.0	2,092.3	2,088.4	2,069.1	4.5	5.6	52.19	110.8	228.6	139.2	130.8	8.36	16.654		
2,200.0	2,191.6	2,188.0	2,166.8	4.8	6.0	52.14	119.7	245.3	148.8	140.0	8.82	16.878		
2,300.0	2,290.9	2,287.5	2,264.5	5.0	6.4	52.10	128.5	262.1	158.5	149.2	9.28	17.078		
2,400.0	2,390.3	2,387.0	2,362.3	5.3	6.7	52.06	137.4	278.8	168.1	158.4	9.74	17.258		
2,500.0	2,489.6	2,486.6	2,460.0	5.5	7.1	52.03	146.3	295.5	177.8	167.6	10.21	17.420		
2,600.0	2,588.9	2,586.1	2,557.7	5.8	7.5	52.00	155.2	312.2	187.4	176.8	10.67	17.567		
2,700.0	2,688.3	2,685.6	2,655.4	6.1	7.9	51.97	164.1	329.0	197.1	186.0	11.13	17.701		
2,800.0	2,787.6	2,785.2	2,753.1	6.3	8.2	51.94	173.0	345.7	206.8	195.2	11.60	17.824		
2,900.0	2,886.9	2,884.7	2,850.8	6.6	8.6	51.92	181.9	362.4	216.4	204.3	12.07	17.936		
3,000.0	2,986.2	2,984.2	2,948.5	6.9	9.0	51.90	190.8	379.1	226.1	213.5	12.53	18.040		
3,100.0	3,085.6	3,083.8	3,046.3	7.1	9.4	51.88	199.6	395.9	235.7	222.7	13.00	18.136		
3,200.0	3,184.9	3,183.3	3,144.0	7.4	9.7	51.87	208.5	412.6	245.4	231.9	13.46	18.224		
3,300.0	3,284.2	3,282.8	3,241.7	7.6	10.1	51.85	217.4	429.3	255.0	241.1	13.93	18.307		
3,400.0	3,383.6	3,382.4	3,339.4	7.9	10.5	51.83	226.3	446.0	264.7	250.3	14.40	18.383		
3,500.0	3,482.9	3,481.9	3,437.1	8.2	10.9	51.82	235.2	462.8	274.3	259.5	14.87	18.455		
3,600.0	3,582.2	3,581.4	3,534.8	8.4	11.2	51.81	244.1	479.5	284.0	268.7	15.33	18.522		
3,700.0	3,681.6	3,681.0	3,632.5	8.7	11.6	51.80	253.0	496.2	293.6	277.8	15.80	18.585		
3,800.0	3,780.9	3,780.5	3,730.3	9.0	12.0	51.78	261.9	512.9	303.3	287.0	16.27	18.644		
3,900.0	3,880.2	3,880.0	3,828.0	9.2	12.4	51.77	270.7	529.6	313.0	296.2	16.74	18.699		
4,000.0	3,979.6	3,979.6	3,925.7	9.5	12.7	51.76	279.6	546.4	322.6	305.4	17.20	18.752		
4,100.0	4,078.9	4,079.1	4,023.4	9.8	13.1	51.76	288.5	563.1	332.3	314.6	17.67	18.801		
4,200.0	4,178.2	4,178.6	4,121.1	10.0	13.5	51.75	297.4	579.8	341.9	323.8	18.14	18.848		
4,300.0	4,277.6	4,278.2	4,218.8	10.3	13.9	51.74	306.3	596.5	351.6	333.0	18.61	18.893		
4,400.0	4,376.9	4,377.7	4,316.5	10.6	14.2	51.73	315.2	613.3	361.2	342.2	19.08	18.935		
4,500.0	4,476.2	4,477.2	4,414.3	10.8	14.6	51.72	324.1	630.0	370.9	351.3	19.55	18.975		
4,600.0	4,575.6	4,576.8	4,512.0	11.1	15.0	51.72	333.0	646.7	380.5	360.5	20.02	19.013		
4,700.0	4,674.9	4,676.3	4,609.7	11.4	15.4	51.71	341.8	663.4	390.2	369.7	20.48	19.049		
4,800.0	4,774.2	4,775.8	4,707.4	11.6	15.7	51.70	350.7	680.2	399.9	378.9	20.95	19.083		
4,900.0	4,873.5	4,875.4	4,805.1	11.9	16.1	51.70	359.6	696.9	409.5	388.1	21.42	19.116		
5,000.0	4,972.9	4,974.9	4,902.8	12.2	16.5	51.69	368.5	713.6	419.2	397.3	21.89	19.148		
5,100.0	5,072.2	5,074.4	5,000.5	12.4	16.9	51.69	377.4	730.3	428.8	406.5	22.36	19.178		

CC - Min centre to center distance or convergent point, SF - min separation factor, ES - min ellipse separation

## Anticollision Report

<b>Company:</b>	EnCana Oil & Gas (USA) Inc	<b>Local Co-ordinate Reference:</b>	Well Woolley-Sosa 2D-7H-E168
<b>Project:</b>	DJ Wattenberg	<b>TVD Reference:</b>	WELL @ 5019.0ft (Original Well Elev)
<b>Reference Site:</b>	S7-T1N-R68W (Woolley-Sosa/Becky)	<b>MD Reference:</b>	WELL @ 5019.0ft (Original Well Elev)
<b>Site Error:</b>	0.0ft	<b>North Reference:</b>	True
<b>Reference Well:</b>	Woolley-Sosa 2D-7H-E168	<b>Survey Calculation Method:</b>	Minimum Curvature
<b>Well Error:</b>	0.0ft	<b>Output errors are at</b>	2.00 sigma
<b>Reference Wellbore</b>	HZ	<b>Database:</b>	USA EDM 5000 Multi Users DB
<b>Reference Design:</b>	Plan #1	<b>Offset TVD Reference:</b>	Offset Datum

Offset Design S7-T1N-R68W (Woolley-Sosa/Becky) - Woolley-Sosa 2F-7H-E168 - HZ - Plan #1													Offset Site Error:	0.0 ft
Survey Program: 0-Geolink MWD													Offset Well Error:	0.0 ft
Reference		Offset		Semi Major Axis			Distance						Warning	
Measured Depth (ft)	Vertical Depth (ft)	Measured Depth (ft)	Vertical Depth (ft)	Reference (ft)	Offset (ft)	Highside Toolface (°)	Offset Wellbore Centre +N/-S (ft)	+E/-W (ft)	Between Centres (ft)	Between Ellipses (ft)	Total Uncertainty Axis	Separation Factor		
5,200.0	5,171.5	5,174.0	5,098.3	12.7	17.2	51.68	386.3	747.1	438.5	415.6	22.83	19.207		
5,300.0	5,270.9	5,273.5	5,196.0	13.0	17.6	51.67	395.2	763.8	448.1	424.8	23.30	19.234		
5,400.0	5,370.2	5,373.0	5,293.7	13.2	18.0	51.67	404.1	780.5	457.8	434.0	23.77	19.261		
5,500.0	5,469.5	5,472.5	5,391.4	13.5	18.4	51.67	413.0	797.2	467.4	443.2	24.24	19.286		
5,600.0	5,568.9	5,572.1	5,489.1	13.8	18.8	51.66	421.8	813.9	477.1	452.4	24.71	19.311		
5,700.0	5,668.2	5,671.6	5,586.8	14.0	19.1	51.66	430.7	830.7	486.7	461.6	25.18	19.334		
5,800.0	5,767.5	5,771.1	5,684.5	14.3	19.5	51.65	439.6	847.4	496.4	470.8	25.65	19.357		

# Anticollision Report

<b>Company:</b>	EnCana Oil & Gas (USA) Inc	<b>Local Co-ordinate Reference:</b>	Well Woolley-Sosa 2D-7H-E168
<b>Project:</b>	DJ Wattenberg	<b>TVD Reference:</b>	WELL @ 5019.0ft (Original Well Elev)
<b>Reference Site:</b>	S7-T1N-R68W (Woolley-Sosa/Becky)	<b>MD Reference:</b>	WELL @ 5019.0ft (Original Well Elev)
<b>Site Error:</b>	0.0ft	<b>North Reference:</b>	True
<b>Reference Well:</b>	Woolley-Sosa 2D-7H-E168	<b>Survey Calculation Method:</b>	Minimum Curvature
<b>Well Error:</b>	0.0ft	<b>Output errors are at</b>	2.00 sigma
<b>Reference Wellbore</b>	HZ	<b>Database:</b>	USA EDM 5000 Multi Users DB
<b>Reference Design:</b>	Plan #1	<b>Offset TVD Reference:</b>	Offset Datum

Offset Design S7-T1N-R68W (Woolley-Sosa/Becky) - Woolley-Sosa 2G-7H-E168 - HZ - Plan #1													Offset Site Error:	0.0 ft
Survey Program: 0-Geolink MWD													Offset Well Error:	0.0 ft
Reference		Offset		Semi Major Axis			Distance				Total Uncertainty Axis	Separation Factor	Warning	
Measured Depth (ft)	Vertical Depth (ft)	Measured Depth (ft)	Vertical Depth (ft)	Reference (ft)	Offset (ft)	Highside Toolface (°)	Offset Wellbore Centre +N/-S (ft)	+E/-W (ft)	Between Centres (ft)	Between Ellipses (ft)				
0.0	0.0	0.0	0.0	0.0	0.0	103.78	-6.1	25.0	25.7					
100.0	100.0	100.0	100.0	0.1	0.1	103.78	-6.1	25.0	25.7	25.4	0.26	98.205		
200.0	200.0	200.0	200.0	0.3	0.3	103.78	-6.1	25.0	25.7	25.1	0.61	42.088 CC, ES		
300.0	300.0	299.6	299.6	0.5	0.5	102.68	-5.8	25.8	26.4	25.5	0.96	27.538		
400.0	400.0	399.2	399.2	0.7	0.7	99.69	-4.8	28.2	28.6	27.3	1.31	21.865		
500.0	500.0	498.6	498.5	0.8	0.8	95.63	-3.2	32.2	32.4	30.7	1.66	19.535		
600.0	600.0	598.0	597.6	1.0	1.0	53.72	-0.9	37.7	37.3	35.3	2.01	18.545		
700.0	700.0	697.2	696.5	1.2	1.3	52.15	2.1	44.9	42.9	40.5	2.37	18.113		
800.0	799.9	796.2	795.2	1.4	1.5	51.75	5.7	53.6	49.0	46.2	2.73	17.947		
900.0	899.7	895.2	893.5	1.6	1.7	52.14	9.9	63.9	55.6	52.5	3.10	17.924 SF		
1,000.0	999.4	994.0	991.5	1.8	2.0	53.07	14.7	75.8	62.7	59.2	3.49	17.975		
1,100.0	1,098.9	1,092.7	1,089.1	2.0	2.3	54.34	20.2	89.2	70.4	66.5	3.90	18.055		
1,200.0	1,198.3	1,191.1	1,186.2	2.2	2.6	55.78	26.4	104.1	78.7	74.4	4.33	18.163		
1,300.0	1,297.6	1,289.4	1,282.8	2.5	3.0	56.65	33.1	120.5	88.4	83.6	4.78	18.487		
1,400.0	1,396.9	1,387.3	1,378.9	2.7	3.3	56.87	40.5	138.4	99.6	94.4	5.24	19.024		
1,500.0	1,496.3	1,484.9	1,474.2	3.0	3.7	56.65	48.4	157.7	112.3	106.6	5.69	19.732		
1,600.0	1,595.6	1,582.8	1,569.4	3.2	4.1	56.13	56.9	178.5	126.4	120.3	6.15	20.572		
1,700.0	1,694.9	1,681.7	1,665.6	3.5	4.6	55.64	65.7	199.8	140.9	134.3	6.60	21.337		
1,800.0	1,794.3	1,780.7	1,761.8	3.7	5.0	55.25	74.5	221.2	155.3	148.3	7.06	22.000		
1,900.0	1,893.6	1,879.6	1,858.1	4.0	5.4	54.92	83.2	242.5	169.8	162.3	7.52	22.579		
2,000.0	1,992.9	1,978.6	1,954.3	4.2	5.9	54.64	92.0	263.9	184.3	176.3	7.98	23.088		
2,100.0	2,092.3	2,077.5	2,050.5	4.5	6.3	54.41	100.8	285.3	198.7	190.3	8.44	23.540		
2,200.0	2,191.6	2,176.4	2,146.7	4.8	6.7	54.20	109.6	306.6	213.2	204.3	8.91	23.943		
2,300.0	2,290.9	2,275.4	2,242.9	5.0	7.2	54.02	118.3	328.0	227.7	218.3	9.37	24.305		
2,400.0	2,390.3	2,374.3	2,339.1	5.3	7.6	53.87	127.1	349.3	242.2	232.3	9.83	24.631		
2,500.0	2,489.6	2,473.3	2,435.3	5.5	8.1	53.73	135.9	370.7	256.7	246.4	10.30	24.927		
2,600.0	2,588.9	2,572.2	2,531.5	5.8	8.5	53.60	144.7	392.0	271.1	260.4	10.76	25.197		
2,700.0	2,688.3	2,671.2	2,627.8	6.1	8.9	53.49	153.4	413.4	285.6	274.4	11.23	25.443		
2,800.0	2,787.6	2,770.1	2,724.0	6.3	9.4	53.39	162.2	434.8	300.1	288.4	11.69	25.670		
2,900.0	2,886.9	2,869.1	2,820.2	6.6	9.8	53.30	171.0	456.1	314.6	302.4	12.16	25.878		
3,000.0	2,986.2	2,968.0	2,916.4	6.9	10.3	53.21	179.7	477.5	329.1	316.4	12.62	26.071		
3,100.0	3,085.6	3,066.9	3,012.6	7.1	10.7	53.14	188.5	498.8	343.6	330.5	13.09	26.249		
3,200.0	3,184.9	3,165.9	3,108.8	7.4	11.2	53.07	197.3	520.2	358.0	344.5	13.55	26.415		
3,300.0	3,284.2	3,264.8	3,205.0	7.6	11.6	53.00	206.1	541.5	372.5	358.5	14.02	26.569		
3,400.0	3,383.6	3,363.8	3,301.2	7.9	12.1	52.94	214.8	562.9	387.0	372.5	14.49	26.714		
3,500.0	3,482.9	3,462.7	3,397.5	8.2	12.5	52.89	223.6	584.3	401.5	386.5	14.95	26.849		
3,600.0	3,582.2	3,561.7	3,493.7	8.4	12.9	52.83	232.4	605.6	416.0	400.6	15.42	26.975		
3,700.0	3,681.6	3,660.6	3,589.9	8.7	13.4	52.79	241.1	627.0	430.5	414.6	15.89	27.094		
3,800.0	3,780.9	3,759.5	3,686.1	9.0	13.8	52.74	249.9	648.3	445.0	428.6	16.36	27.206		
3,900.0	3,880.2	3,858.5	3,782.3	9.2	14.3	52.70	258.7	669.7	459.5	442.6	16.82	27.312		
4,000.0	3,979.6	3,957.4	3,878.5	9.5	14.7	52.66	267.5	691.0	473.9	456.7	17.29	27.412		
4,100.0	4,078.9	4,056.4	3,974.7	9.8	15.2	52.62	276.2	712.4	488.4	470.7	17.76	27.506		

## Anticollision Report

<b>Company:</b>	EnCana Oil & Gas (USA) Inc	<b>Local Co-ordinate Reference:</b>	Well Woolley-Sosa 2D-7H-E168
<b>Project:</b>	DJ Wattenberg	<b>TVD Reference:</b>	WELL @ 5019.0ft (Original Well Elev)
<b>Reference Site:</b>	S7-T1N-R68W (Woolley-Sosa/Becky)	<b>MD Reference:</b>	WELL @ 5019.0ft (Original Well Elev)
<b>Site Error:</b>	0.0ft	<b>North Reference:</b>	True
<b>Reference Well:</b>	Woolley-Sosa 2D-7H-E168	<b>Survey Calculation Method:</b>	Minimum Curvature
<b>Well Error:</b>	0.0ft	<b>Output errors are at</b>	2.00 sigma
<b>Reference Wellbore</b>	HZ	<b>Database:</b>	USA EDM 5000 Multi Users DB
<b>Reference Design:</b>	Plan #1	<b>Offset TVD Reference:</b>	Offset Datum

Reference Depths are relative to WELL @ 5019.0ft (Original Well Elev)

Offset Depths are relative to Offset Datum

Central Meridian is -105.500000 °

Coordinates are relative to: Woolley-Sosa 2D-7H-E168

Coordinate System is US State Plane 1983, Colorado Northern Zone

Grid Convergence at Surface is: 0.29°

