

# LOCATION DRAWING GRAHAM 1-13

SECTION 1, TOWNSHIP 13 SOUTH, RANGE 60 WEST OF THE 6TH PRINCIPAL MERIDIAN

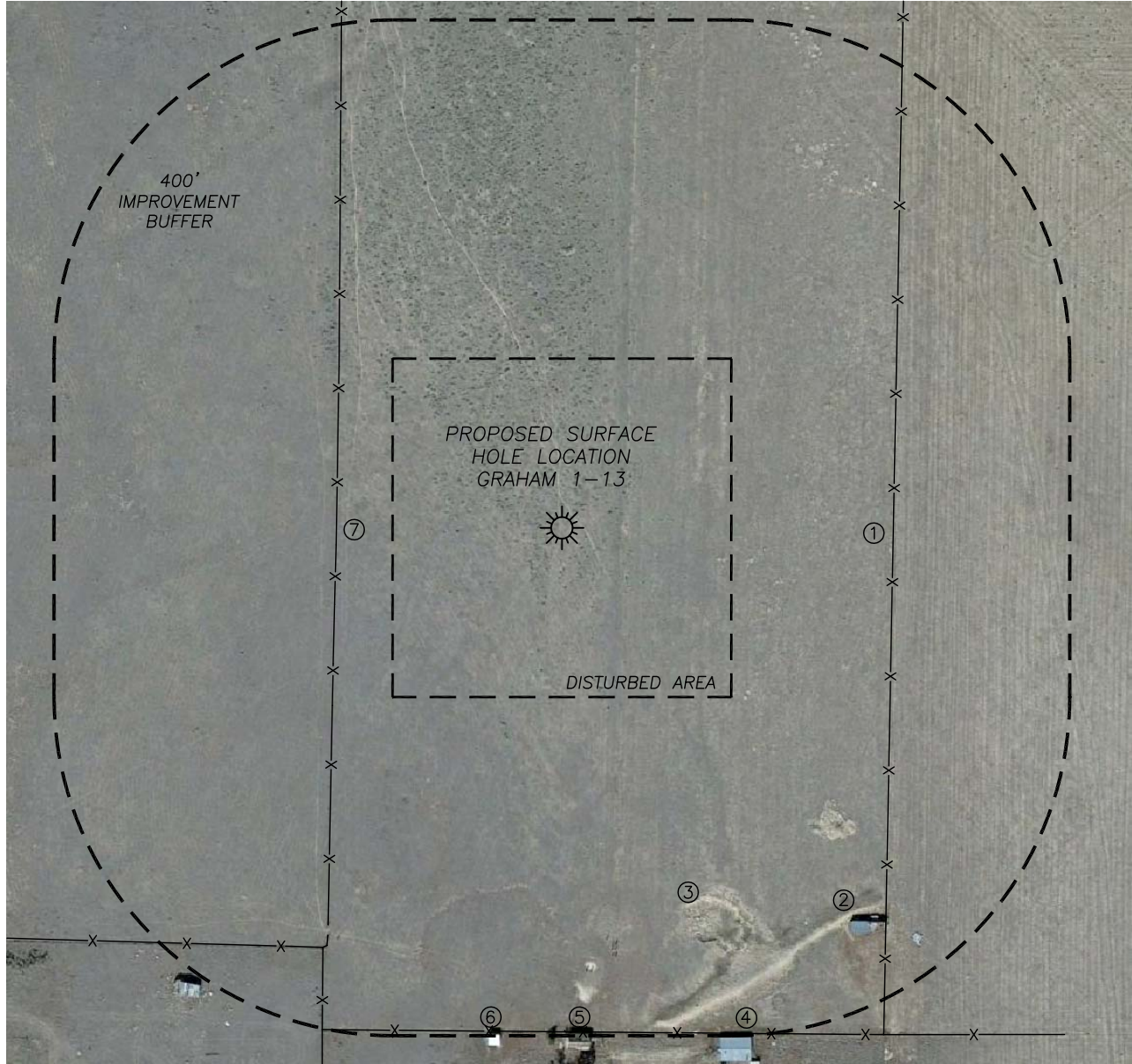

### IMPROVEMENTS

- |                |          |
|----------------|----------|
| 1. WIRE FENCE: | 392'± E  |
| 2. METAL BLD.: | 576'± SE |
| 3. DRY POND:   | 467'± SE |
| 4. METAL BLD.: | 629'± SE |
| 5. WOOD BLD.:  | 596'± S  |
| WIRE FENCE:    | 596'± S  |
| 6. WOOD SHED:  | 601'± SW |
| 7. WIRE FENCE: | 266'± W  |

### DISTANCE TO NEAREST:

- |                     |         |
|---------------------|---------|
| BUILDING:           | 596'± S |
| PUBLIC ROAD:        | 918'± W |
| ABOVE GRND UTILITY: | 780'± S |
| RAILROAD:           | 5280'+  |
| PROP. LINE:         | 509'± S |

