

LEGEND:

 PROPOSED LOCATION



BILL BARRETT CORPORATION

ANSCHUTZ STATE #5-62-36-6457CH
 SECTION 36, T5N, R62W, 6th P.M.
 1320' FNL 250' FWL



Utah Engineering & Land Surveying
 85 South 200 East Vernal, Utah 84078
 (435) 789-1017 * FAX (435) 789-1813

**ACCESS ROAD
 MAP**

06 27 13
 MONTH DAY YEAR



SCALE: 1:100,000 DRAWN BY: J.M.F. REVISED: 00-00-00

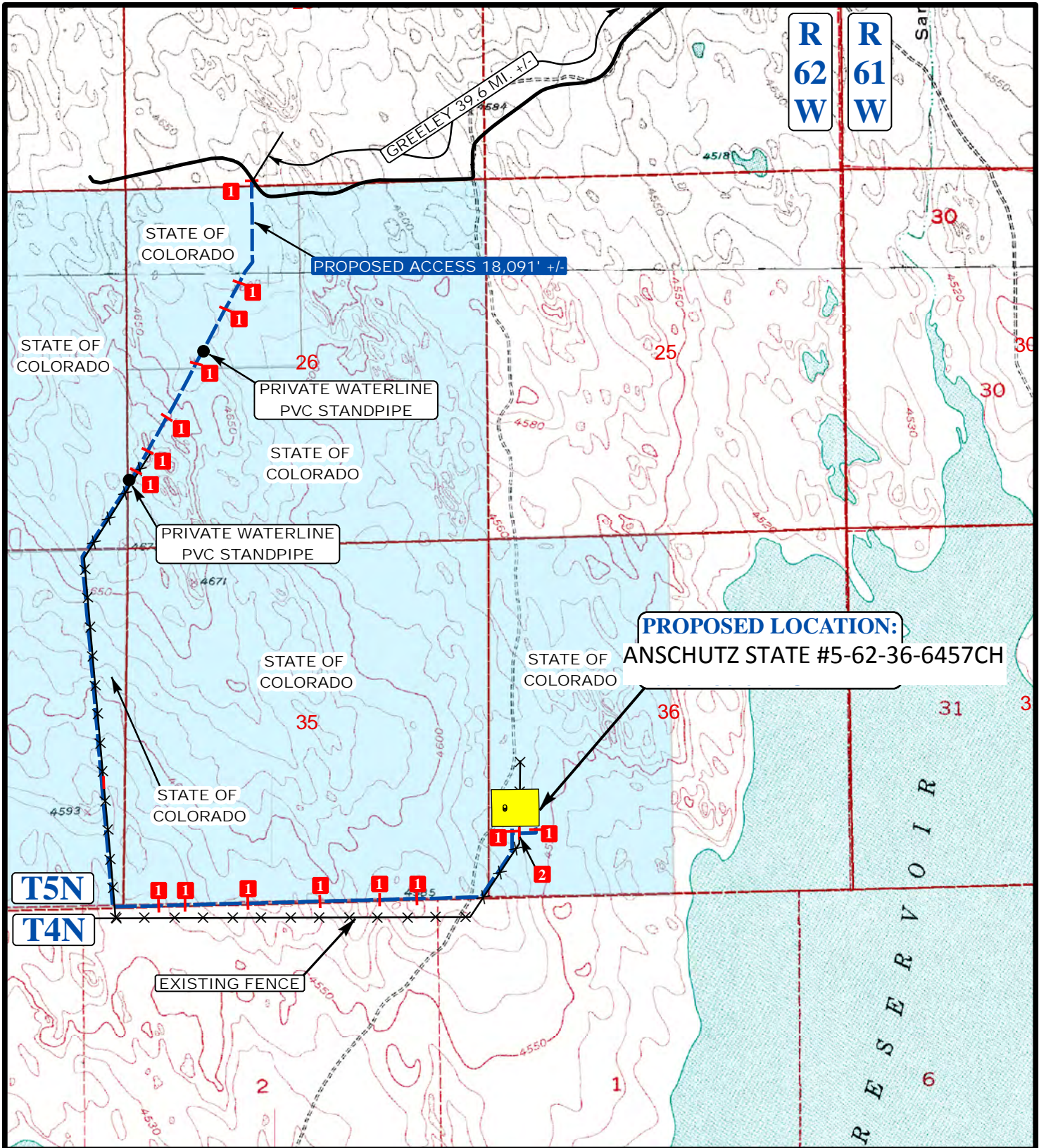

LEGEND:

- EXISTING ROADS
- PROPOSED ACCESS ROAD
- EXISTING FENCE
- 18' CMP REQUIRED
- INSTALL CATTLE GAURD



Utah Engineering & Land Surveying
 85 South 200 East Vernal, Utah 84078
 (435) 789-1017 * FAX (435) 789-1813



BILL BARRETT CORPORATION

ANSCHUTZ STATE #5-62-36-6457CH
 SECTION 36, T5N, R62W, 6th P.M.
 1320' FNL 250' FWL

**ACCESS ROAD
 MAP**

06	27	13
MONTH	DAY	YEAR

SCALE: 1" = 2000' DRAWN BY: J.M.F. REVISED: 00-00-00

