

LEGEND:

PROPOSED LOCATION



BILL BARRETT CORPORATION

ANSCHUTZ STATE #5-62-35-6457BH
SECTION 35, T5N, R62W, 6th P.M.
1470' FSL 250' FWL



Utah Engineering & Land Surveying
85 South 200 East Vernal, Utah 84078
(435) 789-1017 * FAX (435) 789-1813

**ACCESS ROAD
MAP**

06 28 13
MONTH DAY YEAR

SCALE: 1:100,000 DRAWN BY: J.M.F. REV: 07-02-13 J.M.F.



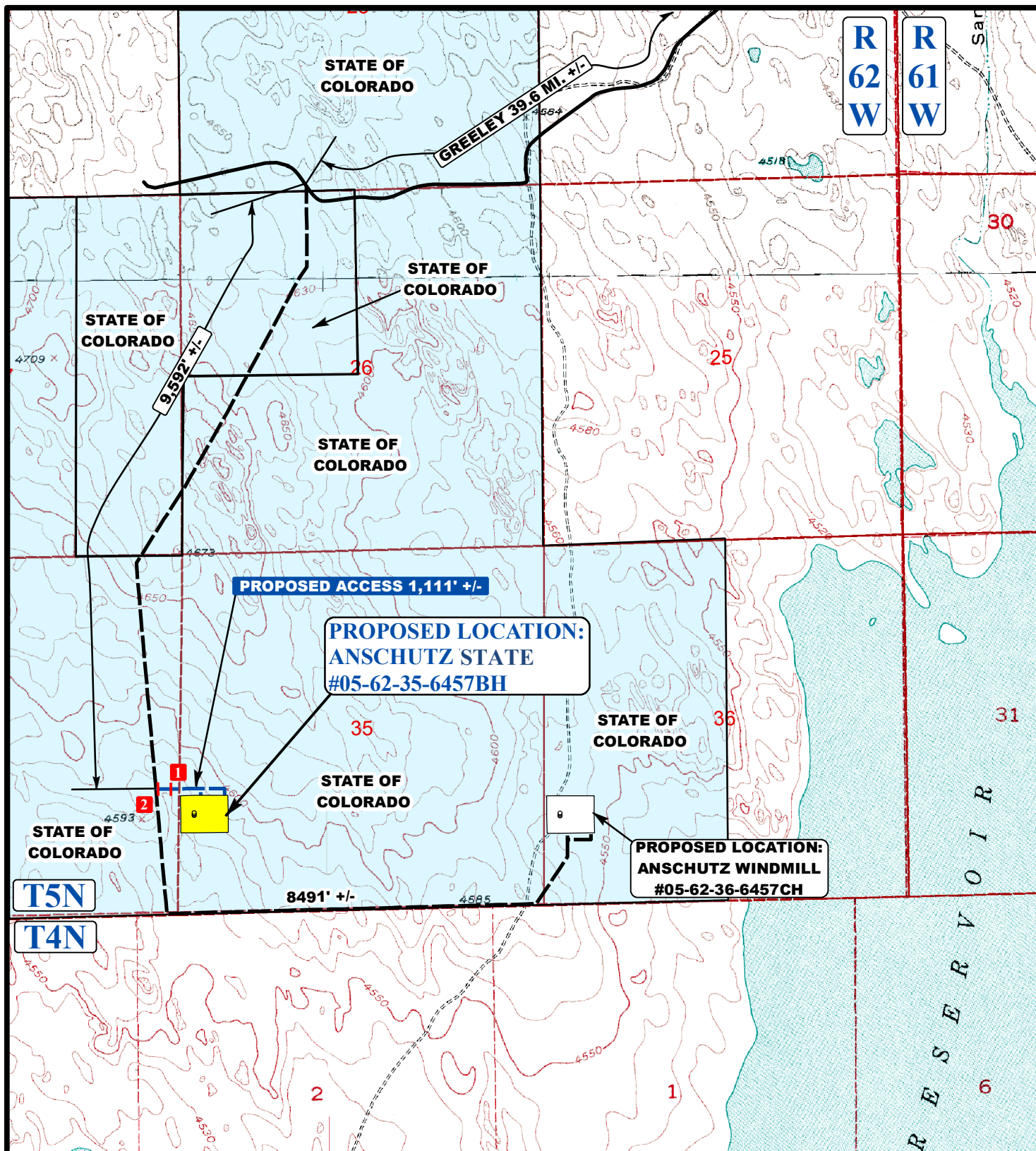

LEGEND:

- EXISTING ROADS
- - - PROPOSED ACCESS ROAD
- 1** INSTALL 24" CULVERT
- 2** INSTALL CATTLE GAURD



Uintah Engineering & Land Surveying
 85 South 200 East Vernal, Utah 84078
 (435) 789-1017 * FAX (435) 789-1813



BILL BARRETT CORPORATION

ANSCHUTZ STATE #5-62-35-6457BH
SECTION 35, T5N, R62W, 6th P.M.
1470' FSL 250' FWL

ACCESS ROAD
MAP

06 **28** **13**
 MONTH DAY YEAR

SCALE: 1" = 2000' DRAWN BY: J.M.F. REV: 07-02-13 J.M.F.

B
 TOPO