

Savage and Savage *Environmental*

practical solutions for environmental issues

4610 Haystack Drive
Windsor, Colorado 80550

970 674 8080 telephone
970 674 8088 facsimile
savageandsavage@earthlink.net



Transmittal

To: Matt Verbit
Company: Noble Energy, Inc.
Address: 2115 117th Avenue
City, State, Zip: Greeley, CO 80634
Phone: 970-304-5000

From: Edith Savage
Company: Savage and Savage, Inc.
Project: Heally Production Facility Site
Phone: 970-674-8080
Fax: 970-674-8088
Date: March 27, 2013

Attached for is a corrected letter report for the Healy Production Facility Site including a reprinted map.

Savage and Savage *Environmental*

practical solutions for environmental issues

4610 Haystack Drive
Windsor, Colorado 80550

970 674 8080 telephone
970 674 8088 facsimile
savageandsavage@earthlink.net



March 26, 2013

Matt Verbit
Noble Energy, Inc.
2115 117th Avenue
Greeley, Colorado 80634

RE: Noble Energy, Inc., Healy Production Facility Site, Wildlife Assessment

Mr. Verbit:

On March 20, 2013 Savage and Savage conducted a wildlife assessment at the proposed Healy production facility site. A standard production facility is currently located at the site and will be expanded to approximately 4.5 acres. The site is located northwest of the intersection of Weld County Roads 64 and 47. Specifically, the site is situated within the SE/4 SE/4 Section 26, Township 6 North, Range 65 West, 6th Prime Meridian, Weld County, Colorado.

The Healy development site is surrounded by agricultural fields. There are eight cottonwood trees that will be removed as part of this project. These trees skirt the outline of an old homestead foundation. Several of these trees are senescent and there are no nests located in the trees. There are other cottonwood trees in the area along Weld County Road 64 east and south of the site; no nests were identified in these trees.

Our firm conducted a pedestrian survey of a substantial tree barrier that surrounds a homestead west of the site. The tree barrier is a "U" shape that faces Weld County Road 64. This survey was conducted in order to determine if raptor nests or other species of

concern may be located in the area. During the survey one magpie nest and approximately 12 squirrel nests were identified. The landowner, Mr. Lyster, was interviewed and he indicated that he observes owls in the area.

The Healy site is scheduled for development from September through October of 2013. Most migratory bird nesting occurs in Colorado from April 1 to July 15. Great horned owl nesting season occurs from February 1 to May 31. Since the Healy site is scheduled for development in the fall, the general migratory bird nesting season and the great horned owl nesting season will be avoided.

Sincerely,

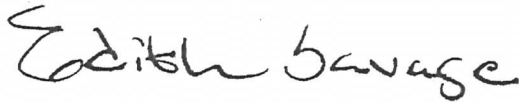
A handwritten signature in black ink that reads "Edith Savage". The signature is written in a cursive, flowing style.

Edith Savage
Principal

attachment: Noble Energy Healy Production Facility General Location Map

Noble Energy Healy Production Facility Project General Location Map

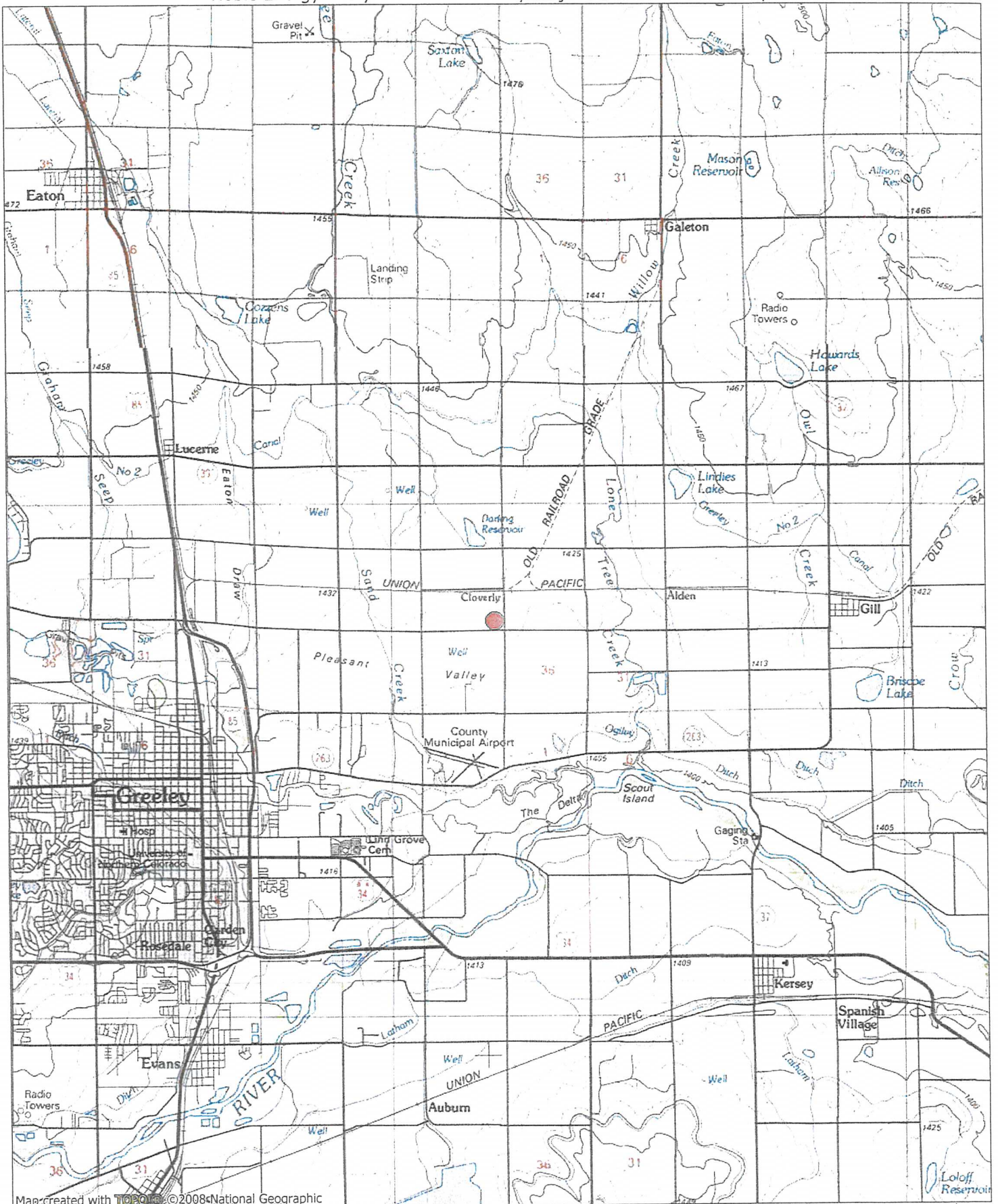

Map created with TOPO! © 2008 National Geographic



TN MN

8 1/2°

03/27/13