

1625 Broadway
Suite 2000
Denver, CO 80202

Tel: 303.228.4000
Fax: 303.228.4280
www.nobleenergyinc.com



7/23/2013

Colorado Oil and Gas Conservation Commission
The Chancery Building
1120 Lincoln Street, Suite 801
Denver, CO 80203
Attn: Mr. Matt Lepore, Director

RE: Eagle E14-79HN
Niobrara New Drill
Township 6N, Range 65 West, 6th P.M.
Section 14: 360' FSL & 530' FWL (Surface Location)
Section 14: 943' FSL & 78' FWL (Beginning of Lateral)
Section 14: 535' FNL & 75' FWL (Bottom Hole Location)
Weld County, Colorado

Dear Director:

Noble Energy, Inc. ("NEI") is planning to drill the captioned boundary well in accordance with the provisions of COGCC Rule 318A.e.

NEI's proposed wellbore spacing unit consists of the W/2W/2 of Section 14 and E/2E/2 of Section 15 in T6N R65W 6th PM creating a 320-acre wellbore spacing unit for the Niobrara formation. NEI is not the only owner within the proposed wellbore spacing unit and as such provided notice to the remaining owner(s) within said proposed spacing unit as required under COGCC Rule 318A(l).e.(6). Copies of the required notice letter(s) is/are on file at the NEI offices. The required thirty (30) day notice period has elapsed absent the receipt by NEI of an objection to said proposal by the owner(s) within the proposed spacing unit for this well.

Enclosed are copies of the following documents to assist you in your review and approval of NEI's proposed APD for the captioned well:

- Map & plat illustrating proposed wellbore spacing unit.

Thank you for your attention to the enclosed. NEI respectfully requests that the COGCC review the enclosed information and approve the Application for Permit to Drill the captioned well.

Sincerely,

A handwritten signature in blue ink, appearing to read 'Liz Lindow', written over a horizontal line.

Liz Lindow
Regulatory Analyst
Noble Energy Inc.

Eagle E14-79HN

Proposed Spacing Unit – Noble Energy, Inc
W/2W/2 of Section 14 and E/2E/2 of Section 15,
Township 6 North, Range 65 West

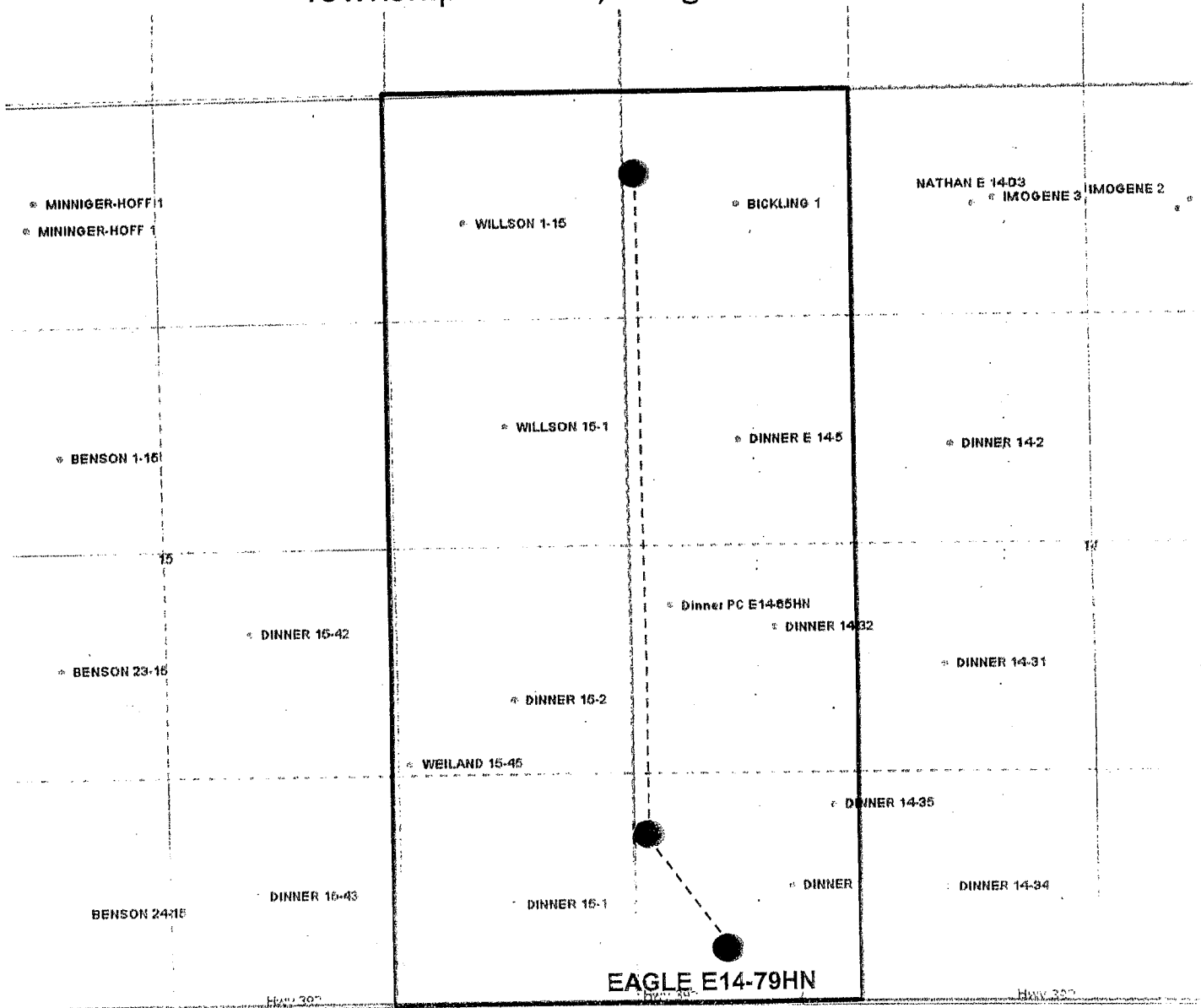

Proposed 320± acre spacing unit



Bottom Hole Location