

1625 Broadway  
Suite 2000  
Denver, CO 80202  
  
Tel: 303.228.4000  
Fax: 303.228.4280  
www.nobleenergyinc.com



7/23/2013

Colorado Oil and Gas Conservation Commission  
The Chancery Building  
1120 Lincoln Street, Suite 801  
Denver, CO 80203  
Attn: Mr. Matt Lepore, Director

RE: Reliance E23-79HN  
Niobrara New Drill  
Township 6N, Range 65 West, 6th P.M.  
Section 14: 270' FSL & 530' FWL (Surface Location)  
Section 23: 783' FNL & 75' FWL (Beginning of Lateral)  
Section 23: 225' FSL & 75' FWL (Bottom Hole Location)  
Weld County, Colorado

Dear Director:

Noble Energy, Inc. ("NEI") is planning to drill the captioned boundary well in accordance with the provisions of COGCC Rule 318A.e.

NEI's proposed wellbore spacing unit consists of the E/2E/2 of Sec 22, the W/2W/2 of Section 23, the NW/4NW/4 of Section 26, and the NE/4NE/4 of Section 27 in T6N R65W 6<sup>th</sup> PM creating a 400-acre wellbore spacing unit for the Niobrara formation. NEI is not the only owner within the proposed wellbore spacing unit and as such provided notice to the remaining owner(s) within said proposed spacing unit as required under COGCC Rule 318A(I).e.(6). Copies of the required notice letter(s) is/are on file at the NEI offices. The required thirty (30) day notice period has elapsed absent the receipt by NEI of an objection to said proposal by the owner(s) within the proposed spacing unit for this well.

Enclosed are copies of the following documents to assist you in your review and approval of NEI's proposed APD for the captioned well:

- Map & plat illustrating proposed wellbore spacing unit.

Thank you for your attention to the enclosed. NEI respectfully requests that the COGCC review the enclosed information and approve the Application for Permit to Drill the captioned well.

Sincerely,

A handwritten signature in blue ink, appearing to read 'Liz Lindow', written over a horizontal line.

Liz Lindow  
Regulatory Analyst  
Noble Energy Inc.

## Reliance E23-79HN

Proposed Spacing Unit – Noble Energy, Inc

E/2E/2 Section 22, Township 6 North, Range 65 West  
 W/2W/2 Section 23, Township 6 North, Range 65 West  
 NW/4NW/4 Section 26, Township 6 North, Range 65 West  
 NE/4NE/4 Section 27, Township 6 North, Range 65 West

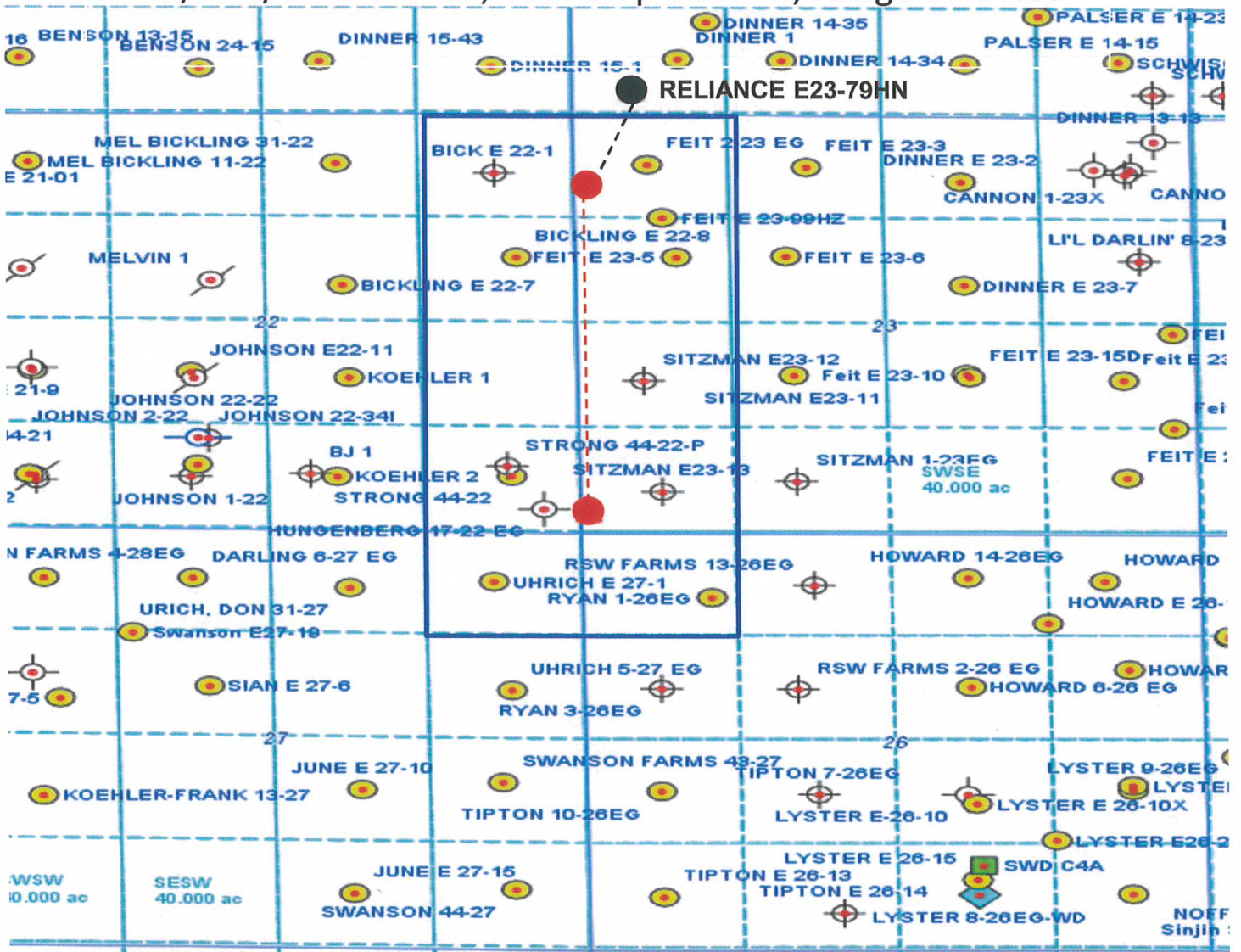

Legend



Proposed 400.00± acre spacing unit



Bottom Hole Location