

HYDROLOGY MAP

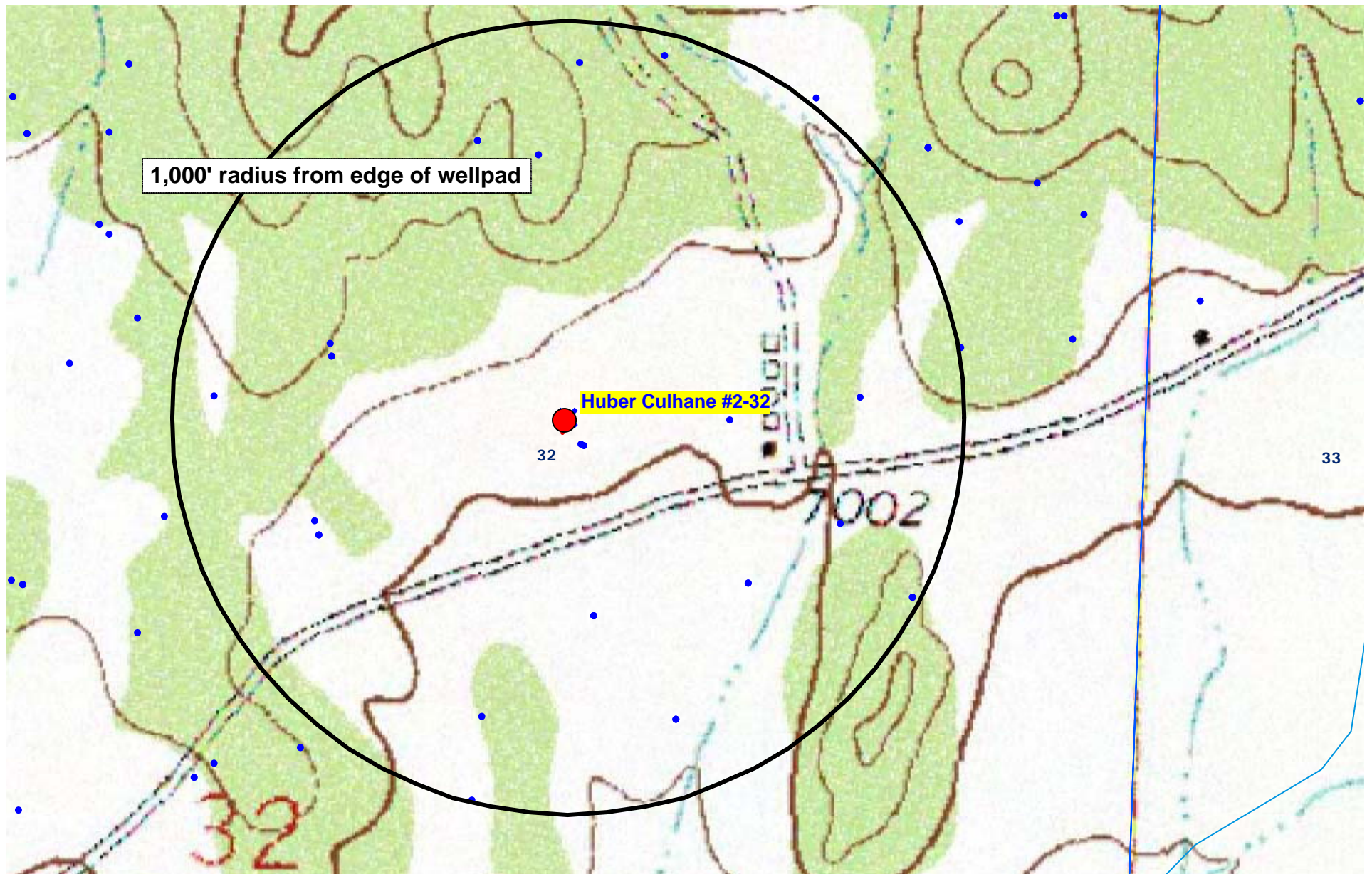

- Water Wells
- Lakes
- Major Rivers
- Streams
- 300-Foot Stream Buffer

HUBER CULHANE #2-32
1,503' FNL & 1,703' FEL
SWNE Sec. 32, T35N, R8W, N.M.P.M
La Plata County, Colorado

N
↑
Scale 1" = 400'