

## WELL LOCATION DRAWING

RELIANCE E23-63HC PAD

THIS MAP DOES NOT REPRESENT A BOUNDARY SURVEY

SECTION: 23

TOWNSHIP: 6 NORTH

RANGE: 65 WEST

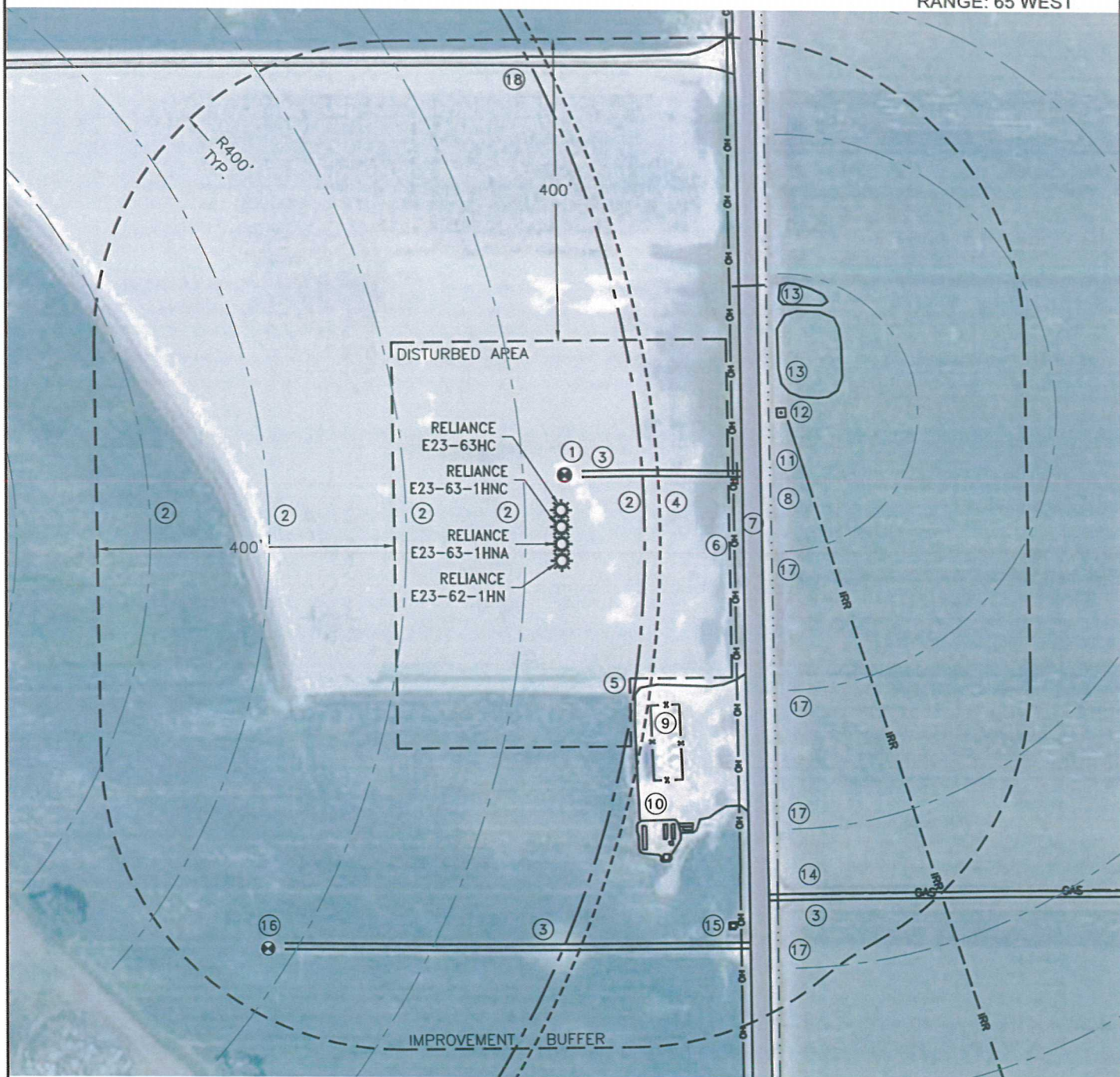

## DISTANCE TO NEAREST:

BUILDING: 592'± SE  
 PUBLIC ROAD (CR 47): 244'± E  
 OVERHEAD UTILITY: 231'± E  
 RAILROAD: MORE THAN 1 MILE AWAY  
 PROP. LINE: 256'± E

NOTE: DISTANCES SHOWN  
 ARE MEASURED FROM  
 THE PROPOSED RELIANCE  
 E23-63HC WELL UNLESS  
 OTHERWISE NOTED.

## IMPROVEMENTS:

1. FEIT E23-97HZ	47'± N	12. IRRIGATION PIVOT	323'± NE
2. PIVOT WHEEL TRACKS	49'± W, 111'± E, 209'± W, 393'± W, 553'± W	13. IRRIGATION POND	341'± NE, 405'± NE
3. DIRT ROAD	53'± NE, 577'± S, 580'± SE	14. GAS LINE	580'± SE
4. PIVOT END GUN	132'± E	15. SHACK	592'± SE
5. GRAVEL P.F. AREA	258'± SE	16. FEIT E23-16	706'± SW
6. OVERHEAD UTILITY	231'± E	17. PIVOT WHEEL TRACK	305'± SE, 386'± SE, 523'± SE, 683'± SE
7. CO. RD. 47 (PAVED)	244'± E	18. GRAVEL ROAD	590'± N
8. IRRIGATION DITCH	281'± E		
9. P.F. TANK FENCE	285'± SE		
10. P.F. EQUIP. BERM	426'± SE		
11. IRRIGATION LINE	327'± NE		



FIELD DATE: 01/03/13

PLOT DATE: 04/24/13

DRAWN BY: CJD

JOB NO.: NE12383

SHEET NO.: 3 of 11

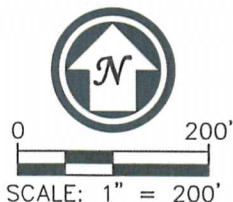

## LEGEND

- PROPOSED WELL  
 EXISTING WELL