

Notes:

Due to the small size of the original pad, there will be no interim reclaim of the pad. Facilities shown on this layout will be installed after the rig is off the pad site.

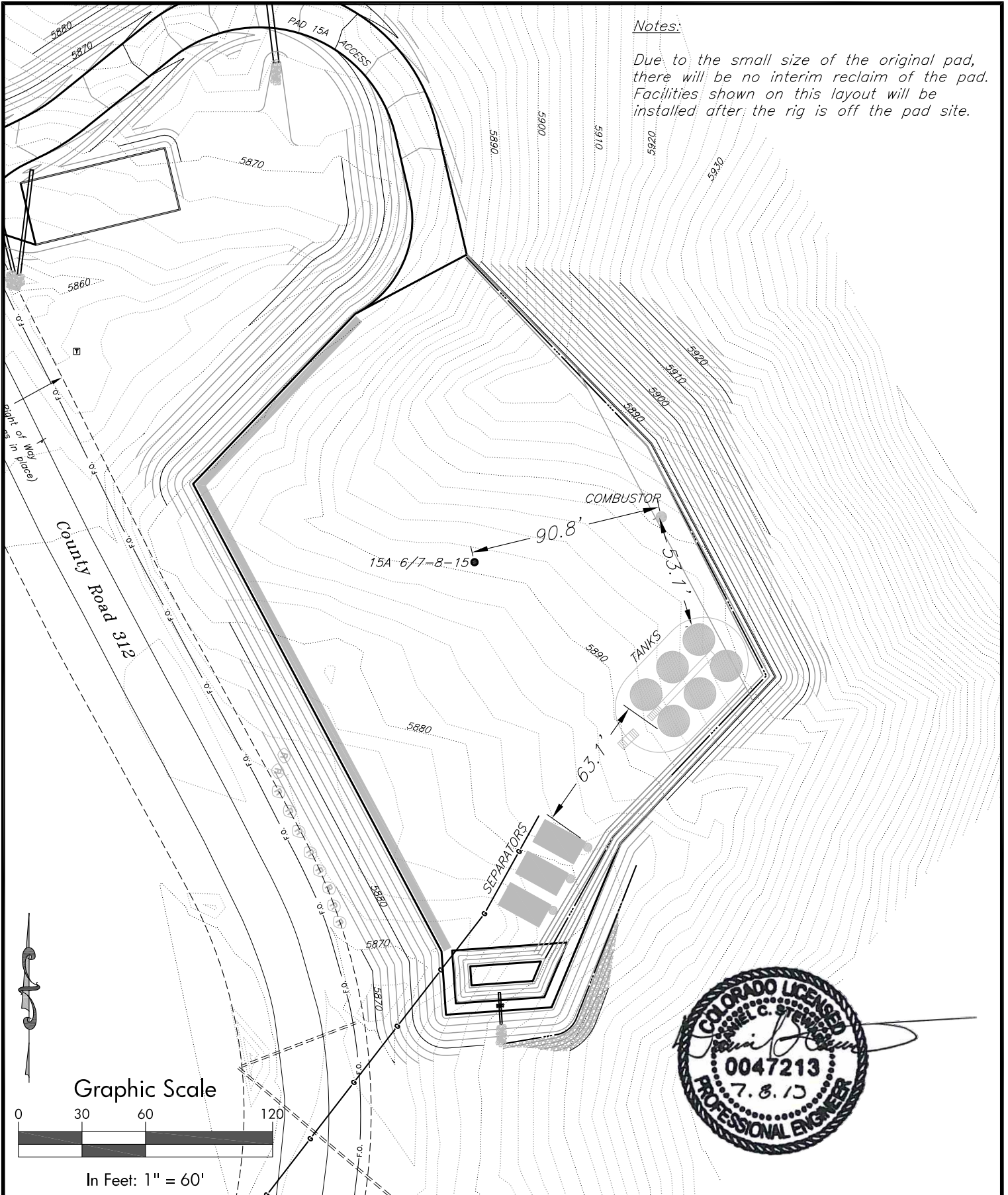

I:\2010\2010-112\Pad 15 2013 Revision\Pad 15 2013.dwg



SGM INC.

118 W. 6th Street, Suite 200
Glenwood Springs, Colorado 81601
(970) 945-1004 (FAX 945-5948)
Aspen, Colorado (970) 925-6727

Scale: 1" = 60'

Sheet 21 of 7

Pad 15A

Dejour Pad 15A Interim Reclaim & Facilities Layout

Sections 15&16, T.6 S, R. 91 W., 6th P.M., Garfield County, CO

Job# 2010-112.001

Date: 7.16.13

By: DCS

File: Pad 15 2013