

I:\2010\2010-112\Pad 15 2013 Revision\Pad 15 2013.dwg

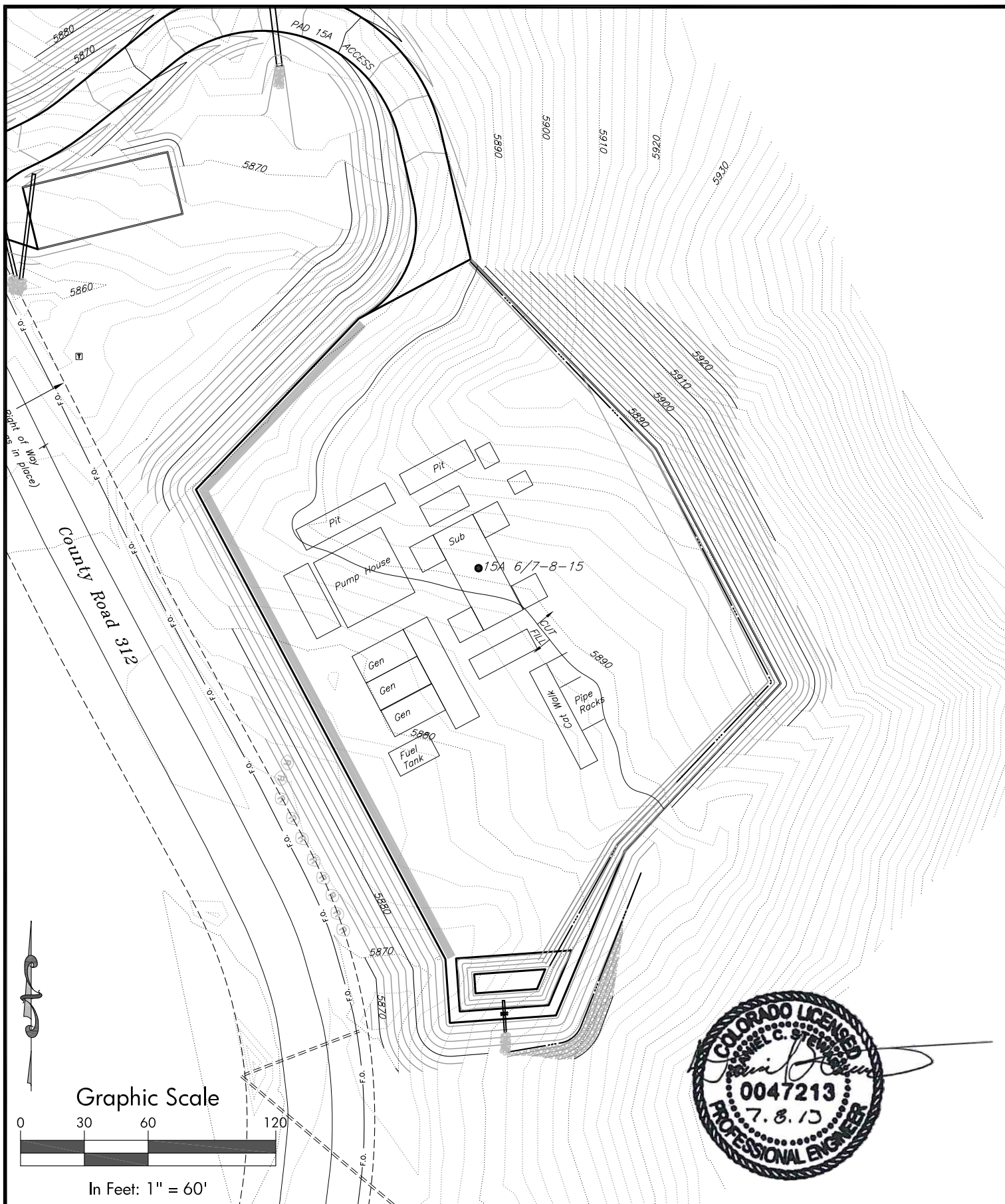

SGM INC.

118 W. 6th Street, Suite 200
Glenwood Springs, Colorado 81601
(970) 945-1004 (FAX 945-5948)
Aspen, Colorado (970) 925-6727

Scale: 1" = 60'

Sheet 2C of 7

Pad 15A

Dejour Pad 15A Rig Layout

Sections 15&16, T.6 S, R. 91 W., 6th P.M., Garfield County, CO

Job# 2010-112.001

Date: 7.16.13

By: DCS

File: Pad 15 2013