

LEGEND:

PROPOSED LOCATION



EE3 LLC.
MUTUAL #04-30H ON EXISTING #02-30H PAD
SECTION 30, T7N, R80W, 6th P.M.
SW 1/4 SE 1/4



Uintah Engineering & Land Surveying
 85 South 200 East Vernal, Utah 84078
 (435) 789-1017 * FAX (435) 789-1813

ACCESS ROAD
MAP

12 **21** **07**
 MONTH DAY YEAR

SCALE: 1:100,000 DRAWN BY: B.C. REV: 04-03-13 A.T.



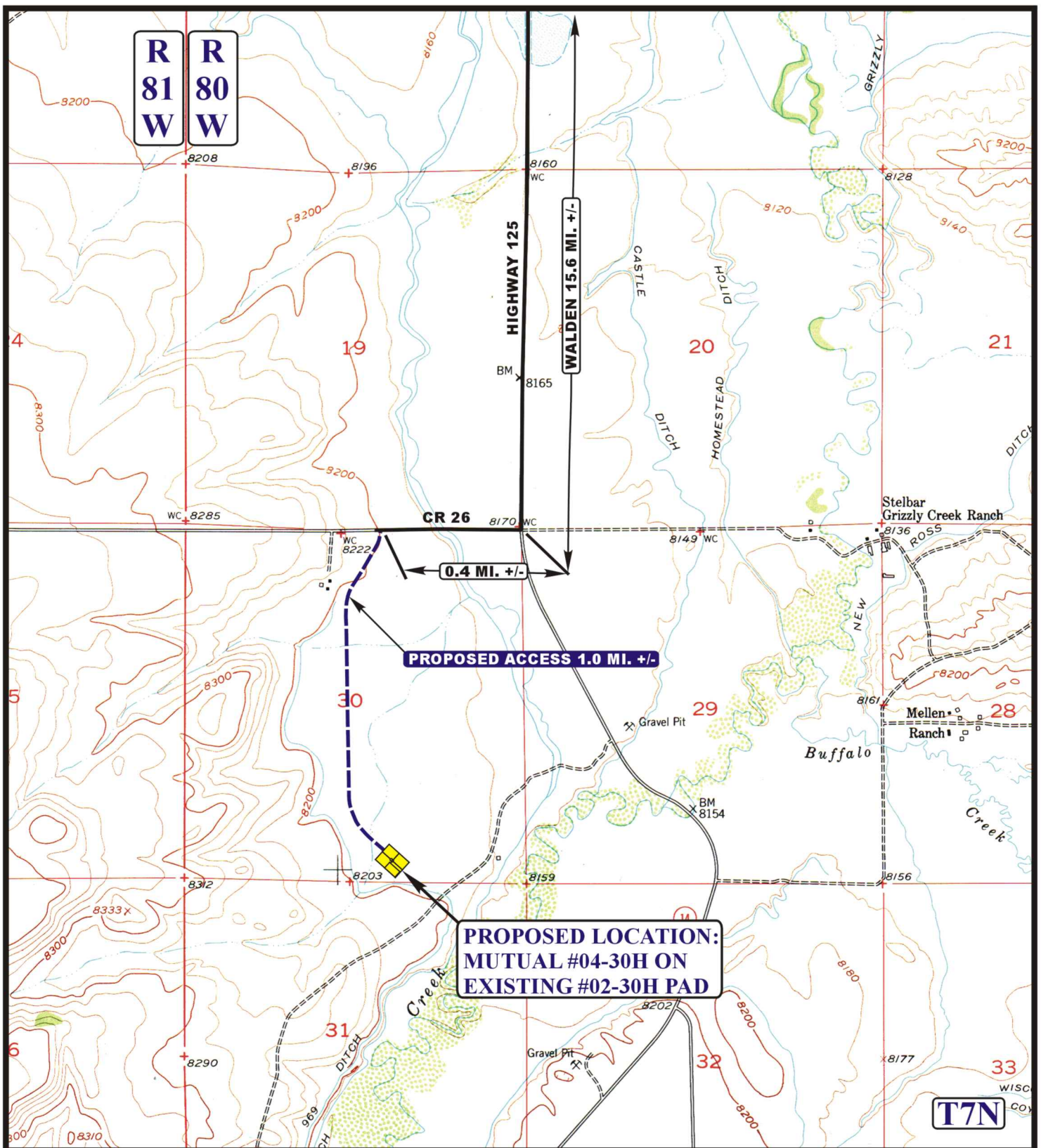

LEGEND:

EXISTING ROAD
 PROPOSED ACCESS ROAD



EE3 LLC.

MUTUAL #04-30H ON EXISTING #02-30H PAD
SECTION 30, T7N, R80W, 6th P.M.
SW 1/4 SE 1/4



Uintah Engineering & Land Surveying
 85 South 200 East Vernal, Utah 84078
 (435) 789-1017 * FAX (435) 789-1813

ACCESS ROAD
MAP

12 **21** **07**
 MONTH DAY YEAR

SCALE: 1" = 2000' DRAWN BY: B.C. REV: 04-03-13 A.T.

